

# Motion Sensor

## User Guide

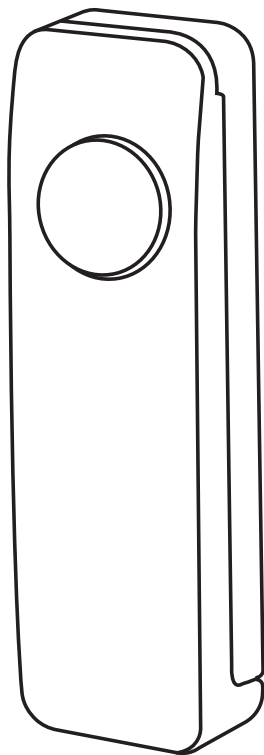

THIRD REALITY

# Contents

- Mounting Kit ..... 1
- Setting up Wireless Motion Sensor ..... 1
- Using Wireless Motion Sensor ..... 2
- Pairing with Amazon Echo ..... 3
- Pairing with Smart Things ..... 4
- Pairing with Eero ..... 5
- Pairing with Third Reality Hub ..... 6
- Pairing with Home Assistant ..... 7
- Pairing with Hubitat ..... 8

# Mounting Kit

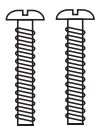

Screw x2

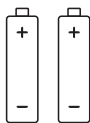

Battery x2



Double-sided Tape

①

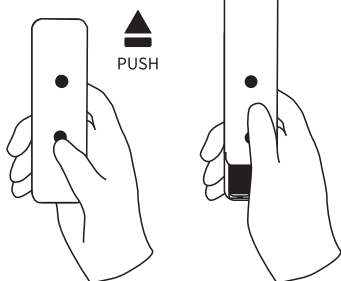

②

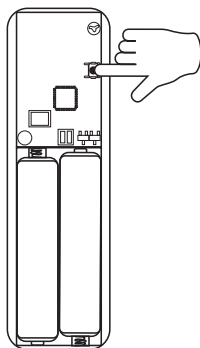

## Setting up your Wireless Motion Sensor

1. Follow instructions and get your compatible Zigbee hub setup.
2. Slide the rear cover up to open the Wireless Motion Sensor. Then insert two AAA batteries inside the sensor(Figure 1).

3. Configure the Wireless Motion Sensor with your Zigbee hub. (For help and troubleshooting related to configure device with Zigbee hub, visit the hub's user manual)
4. To factory reset the sensor, long press the inside button of the sensor to place it in pairing mode(Figure 2). Release the hold until you see the red LED turn on. After you release the hold, LED will change to a fast blinking blue light that indicates the sensor is now ready to be setup.
5. Replace the sensor's rear cover and make sure it is closed well.

## Using your Wireless Motion Sensor

Certain environmental conditions can cause false triggers. Avoid placing the Wireless Motion Sensor in direct sunlight or near heat sources like hot air vents or portable heaters or steam from showers.

1. Clean and dry the installation surface. Remove the protective layer of double-sided tape and adhere sensor in your desired installation area.  
\* Wireless motion sensor can only be applied indoors.
2. When motion is detected, you will receive a message alert on your phone.

# Pairing with Amazon Echo

Compatible Device: Echo (4th Gen), Echo Plus (1st Gen & 2nd Gen), Echo Show10 (2nd Gen & 3rd Gen) and Echo studio

App: Amazon Alexa App



## Pairing Steps:

1. Slide the rear cover up to open the Motion Sensor, insert two AAA batteries and then long press the inside button of the sensor release it until the red LED light turns on and flashes in blue rapidly, indicating that it is in pairing mode.
2. Just give Alexa a voice command, Say “**Alexa, discover my devices**”. Or you can open Alexa App, go to device page, tap “+” on top right, choose “**Add Device**”, then click “**other**” by sliding down, tap “**DISCOVER DEVICES**”, wait for few seconds, the motion sensor will be paired to Alexa.
3. After the pairing is successful, you can rename it and set the Routines in Alexa App.

# Pairing with SmartThings

Compatible Devices: SmartThings Hub 2015 & 2018, Aeotec

App: SmartThings App



## Pairing Steps:

1. Open “SmartThings” App, go to the devices page.
2. Tap “+” icon on top right, click “Add device”.
3. Slide the rear cover up to open the Motion Sensor, insert two AAA batteries and then long press the inside button of the sensor release it until the red LED light turns on and flashes in blue rapidly, indicating that it is in pairing mode.
4. Then choose “Scan for nearby devices”, SmartThings is scanning.
5. The “Motion Sensor” icon will show on the page, indicating that the pairing is completed.
6. You can rename the Motion sensor.

# Pairing with Eero

Compatible Devices: Eero 6 & Eero 6 Pro

App: Eero App    Alexa App



## Pairing Steps:

1. Make sure that the Eero App account is logged in and the gateway is properly connected.
2. Open Alexa App and register your account, then enable Eero Skill to Alexa App.
3. Slide the rear cover up to open the Motion Sensor, insert two AAA batteries and then long press the inside button of the sensor release it until the red LED light turns on and flashes in blue rapidly, indicating that it is in pairing mode.
4. Before Pairing, make sure the Echo devices have updated to the latest version, then directly say “**Alexa, discover my devices**”. Or you can open Alexa App, go to device page, tap “+” on top right, choose “**Add Device**”, then click ‘other’ by sliding down, tap “**DISCOVER DEVICES**”, wait for few seconds, the motion sensor will be paired to Alexa.
5. After the pairing is successful, you can rename the it and set the Routines in Alexa App.

# Pairing with Third Reality Hub

Compatible Devices: Third Reality Smart Hub

App: Third Reality App



## Pairing Steps:

1. Slide the rear cover up to open the Motion Sensor, insert two AAA batteries and then long press the inside button of the sensor release it until the red LED light turns on and flashes in blue rapidly, indicating that it is in pairing mode.
2. Open Third Reality App, go to device page, tap “+” belongs to the Hub, choose “**Motion Sensor**”, then click “**Pair**”.
3. After the pairing is successful, tap “**Complete**”, then back to main interface.
4. Tap “**Motion Sensor**” icon on device page, you can see the details, such as Battery, History Records and etc.
5. Open Alexa App and log in your account, follow the prompts to enable “**Third Reality Skill**” and tap “**DISCOVER DEVICES**”, then you can set Routines through Alexa App or Echo Devices.



# Pairing with Home Assistant

## Pairing Steps:

1. Slide the rear cover up to open the Motion Sensor, insert two AAA batteries and then long press the inside button of the sensor release it until the red LED light turns on and flashes in blue rapidly, indicating that it is in pairing mode.
2. Make sure Home Assistant Integrations ZigBee Home Automation Setup is ready, then click “+ Add Device” on Device Page.
3. After the pairing is successful, it will show as “Third Reality, Inc 3RSB016BZ” on the page.
4. Back to “Devices & Services” page, click the device list under the “HubZ Smart Home Controller” button, then you can find the Motion Sensor added before.
5. You can add “Automated Actions” and check device status information on the “Device” page.

# Pairing with Hubitat

Website: <http://find.hubitat.com/>

## Pairing Steps:

1. Slide the rear cover up to open the Motion Sensor, insert two AAA batteries and then long press the inside button of the sensor release it until the red LED light turns on and flashes in blue rapidly, indicating that it is in pairing mode
2. Log in the website, click '**Connect to Hub**' .
2. After pairing with Hub, choose "**Devices**", then click "**Discover Devices**", Tap "**ZigBee**", Choose "**Start ZigBee Pairing**".
4. After the pairing is successful, it will shows on page as "**Third-Reality Motion Sensor**". Click "**Label**", you can rename the it and tap save.
5. Go to the Device page, you will see the rename Motion Sensor and click in, you can see the details information.

# Trouble Shooting

## 1. Factory reset

Answer: Slide the rear cover up to open the Motion Sensor, long press the inside button of the sensor, release it until the red LED light turns on and flashes in blue rapidly, indicating that it is in pairing mode.

## 2. Doesn't pair with Echo Devices

Answer: Make sure your Echo Speaker is compatible with wireless motion sensor and update to latest version, Compatible Echo speakers include Echo (4th Gen), Echo Plus (1st Gen & 2nd Gen), Echo Show10 (2nd Gen & 3rd Gen) and Echo studio.

- Reboot the Echo speaker by unplugging the power and plugging it back in, then try to pair the motion sensor with it again.
- Factory reset the Echo speaker (Press and hold the Action button for 25 seconds. The light ring will pulse orange, then turn off. Wait for the light ring to turn back on and turn blue. The light ring then turns orange again and the device enters the set up mode), then try to pair the motion sensor with it again.

## 3. Doesn't pair with SmartThings

Answer: Make sure the SmartThings Hub is online and update to the latest version, so as the SmartThings App. And make sure the motion sensor is close to Hub as possible.

- Reboot the SmartThings Hub by unplugging the power and plugging it back in, then try to pair the motion sensor with it again.
- Factory reset the SmartThings Hub, then try to pair the motion sensor with it again.

#### 4. Check Histories and Battery Level

Answer: Open Third Reality App, tap the icon of wireless motion sensor to enter in the details page, you can see the History Records and battery level.

#### 5. The battery level is too low.

Answer: This is a software compatible issue with the current firmware, you can simply times 2 of the battery level, that is your “real” battery. We will fix this issue in future software release as soon as possible.

## FCC regulatory conformance

This device complies with Part 15 of the FCC Rules. Operation is subject to the following two conditions:

- (1) This device may not cause harmful interference.
- (2) This device must accept any interference received, including interference that may cause undesired operation.

For more information, visit [www.3reality.com/devicesupport](http://www.3reality.com/devicesupport)