

MOVEAUDIO S108 USER MANUAL

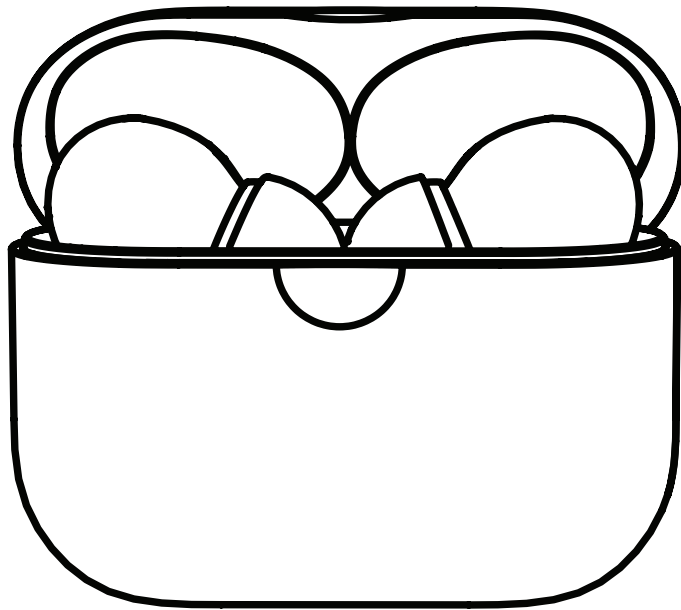

Contents

Read this first.....	iii
Chapter 1. Get started.....	1
Overview.....	1
Charge the battery	1
Replace ear tips	3
Chapter 2. Make connections.....	4
Connect with a Bluetooth device.....	4
Disconnect from a Bluetooth device.....	5
Reconnect with your devices	6
Chapter 3. Use your earbuds.....	7
Music feature.....	7
Call feature	7
Voice assist feature.....	8
Reset the earbuds.....	8
Important safety information	9
Important handling information.....	9
Hearing loss.....	9
Medical device interference	9
Choking hazard.....	9
Charging.....	9
Battery.....	10
Operating temperature.....	10
Regulatory compliance information	11
Electromagnetic fields (EMF)	11
FCC compliance statement.....	11
Declaration of conformity.....	12
Disposal and recycling information.....	12
Troubleshooting	13
Trademarks.....	16

Read this first

- Before using this documentation and the device it supports, ensure that you read and understand the "Important safety information" on page 9.
- Illustrations in this documentation might look different from your device.
- Instructions in this documentation may vary depending on your device model and software version.
- Documentation content is subject to change without notice. We make constant improvements on the documentation of your device, including this user manual.
- TCL Communication Ltd. does not assume any liability that may occur due to the use or application of the product described herein. Every effort has been made in the preparation of this documentation to ensure accuracy of the contents, but all statements, information and recommendations in this documentation do not constitute the warranty of any kind, express or implied.

Chapter 1. Get started

This manual describes everything you need to know about your [TCL MOVEAUDIO S108](#). If you need more information, visit www.tcl.com.

Overview

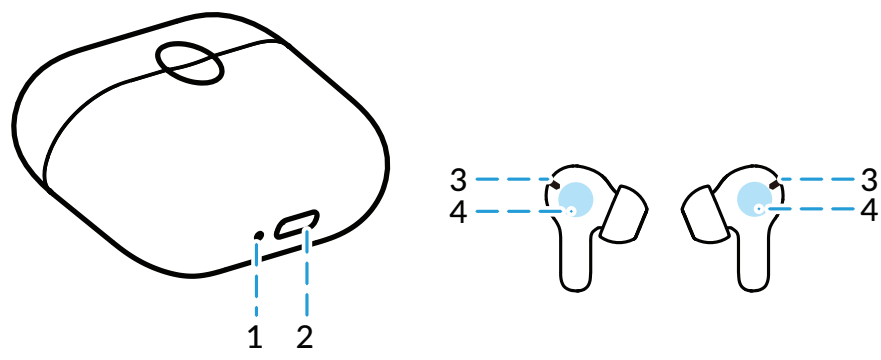

1. Case LED indicator	The indicator flashes white color to indicate the charge or communication status of the earbuds or the charging case.
2. USB Type-C™ port	Connect the charging case to a computer or a compatible USB adapter with the supplied USB Type-C cable to simultaneously charge both the earbuds and the charging case.
3. Earbud LED indicator	The indicator flashes white color to indicate the communication status of the earbud.
4. Touch control area	Tap or press to operate earbuds.

Charge the battery

Earbuds

Your charging case is a charger. To charge your earbuds, place the earbuds in the case, then close the lid.

The case LED indicator flashes in solid white when charging starts. If the case LED indicator flashes in blinking white or does not flash, it indicates that you need to charge the case as soon as possible.

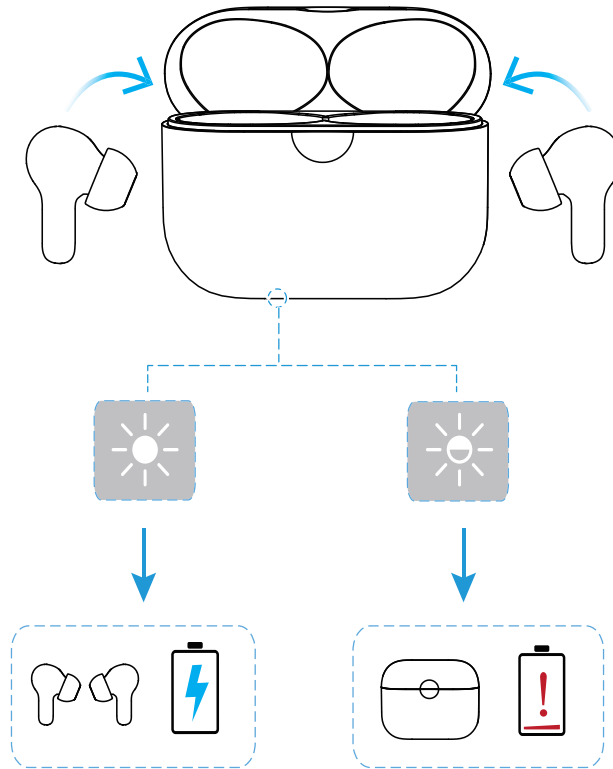

NOTES

- For best results, do not insert your earbuds in the charging case if they are wet or dirty.
- The low battery prompt tone is heard via the earbuds when the battery level for the earbuds is less than 10%.

Charging case

To charge the charging case, connect the case to a computer or a compatible USB adapter with the supplied USB Type-C cable.

The case LED indicator flashes in blinking white when charging starts, and flashes in solid white when charging is complete.

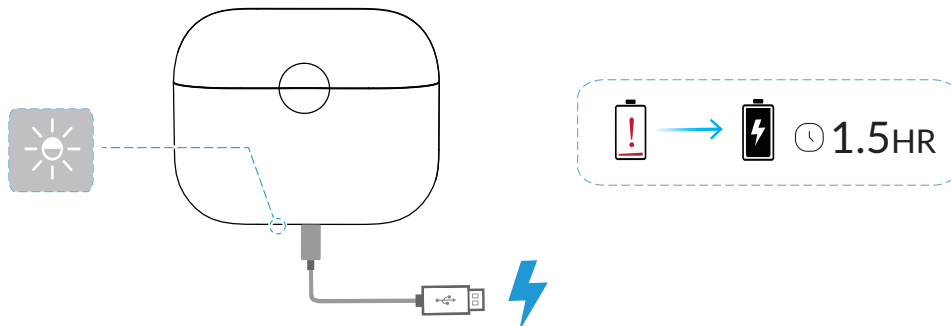



NOTES

- It takes approximately 1.5 hours to fully charge the case using the supplied USB Type-C cable. The charging time may vary depending on the battery usage conditions.
- Use only the supplied or a certified USB charging cable for charging to prevent product damage.

Replace ear tips

To get the most use and enjoyment out of your earbuds, select the most comfortable tips for your ears.

To replace an ear tip, follow these steps:

1. Pull firmly to remove the tip.
2. Choose a new tip.
3. Align the new tip with the earbud, then push until it clicks.

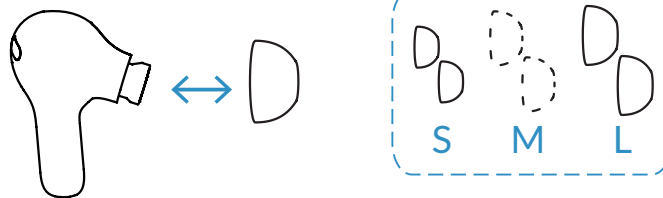

Chapter 2. Make connections

Enjoy music and hands-free calling with your earbuds by using the Bluetooth function of your device.

Connect with a Bluetooth device

Pair your Bluetooth device to use it with the earbuds for the first time. Before you make the pairing operation, make sure your earbuds and the charging case are charged sufficiently.

To pair the earbuds with your device for the first time after purchase or after resetting the earbuds, follow these steps:

1. Take out your earbuds from the charging case, and keep them next to your device. The earbud LED indicators flash in blinking white.
2. Unlock your device, and turn on the Bluetooth function on your device.
3. Select **TCL MOVEAUDIO S108** from the list of available devices to complete the connection.

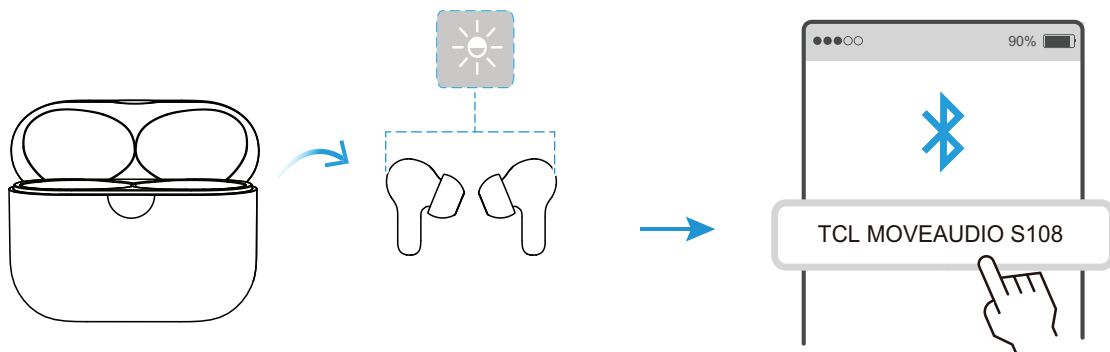

NOTES

- When you pair the earbuds with a device for the first time after purchase or after resetting the earbuds, the earbuds will enter pairing mode automatically if taken out of the charging case.
- If pairing is not established within 5 minutes, the pairing mode will be cancelled and the earbuds will turn off.

To pair the earbuds with your device manually, you have the following options.

Option 1

1. Remove both earbuds from the charging case, and wear the earbuds.
2. Disconnect the earbuds from your paired device, and the earbuds will enter pairing mode.
3. Unlock your unpaired device, and turn on the Bluetooth function.
4. Select **TCL MOVEAUDIO S108** from the list of available devices to complete the connection.

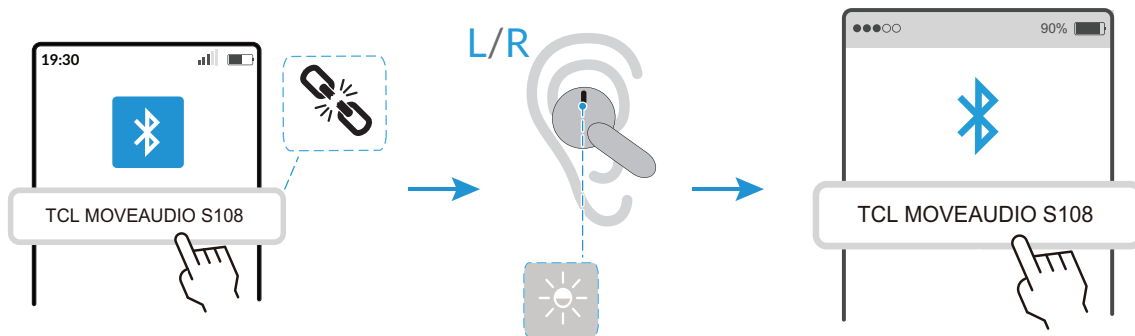

Option 2

1. Remove both earbuds from the charging case, and wear the earbuds.
2. Triple-press either earbud, and hold the third press for about 4 seconds.
3. Unlock your device, and turn on the Bluetooth function.
4. Select **TCL MOVEAUDIO S108** from the list of available devices to complete the connection.

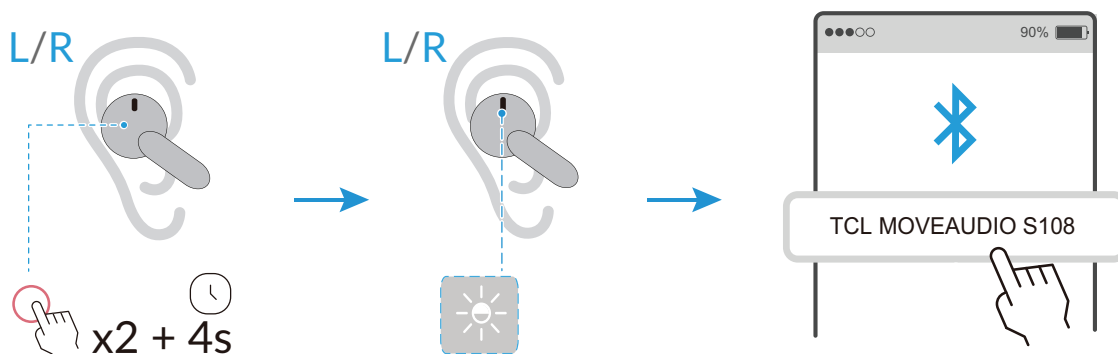

NOTE

If pairing is not established within 5 minutes, the pairing mode will be cancelled and the earbuds will turn off.

Disconnect from a Bluetooth device

Disconnect your earbuds from the Bluetooth device using these methods:

- Put both earbuds in the charging case, and close the case.
- Turn off the Bluetooth function on your device.
- Go to the Bluetooth menu of your device, tap your earbuds from the list of paired devices, and select disconnection option.

NOTE: The disconnection procedure may vary depending on your device model.

Reconnect with your devices

After successful pairing, the earbuds will automatically connect to the last paired device if taken out of the charging case.



NOTES

- The earbuds and Bluetooth device must be turned on and within connection range.
- If the earbuds cannot find and connect to the last paired device, they will enter pairing mode shortly. You can still reconnect your earbuds to the device from the Bluetooth menu of your device.

Chapter 3. Use your earbuds

Tap or press the touch control area on the earbuds to control your music, phone calls, and other useful functions without getting out your phone.

Music feature

You can perform the playback controls by tapping your earbuds.

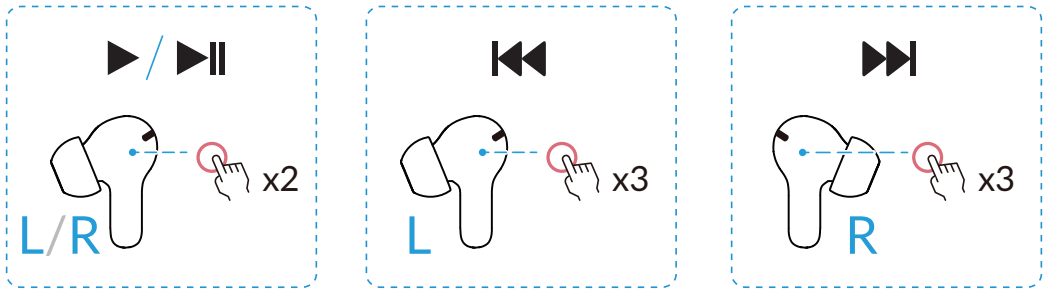

Double tap either earbud	Play or pause
Triple tap left earbud	Previous song
Triple tap right earbud	Next song

Call feature

Answer and control calls using your earbuds.

Phone controls

Manage calls by tapping and holding either of your earbuds.

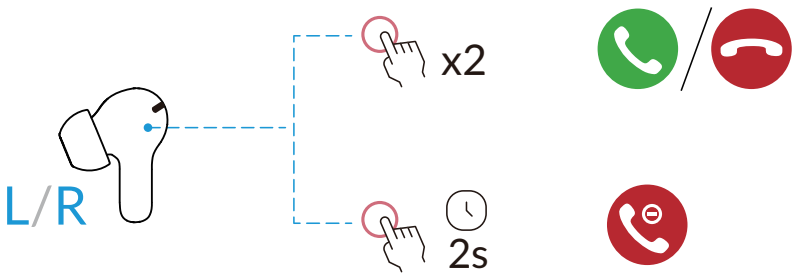

Double tap	Answer or end a call
Press and hold for 2 seconds	Reject an incoming call

Call waiting

If you receive an incoming call while on a call, you can use either earbud to perform the following operations.

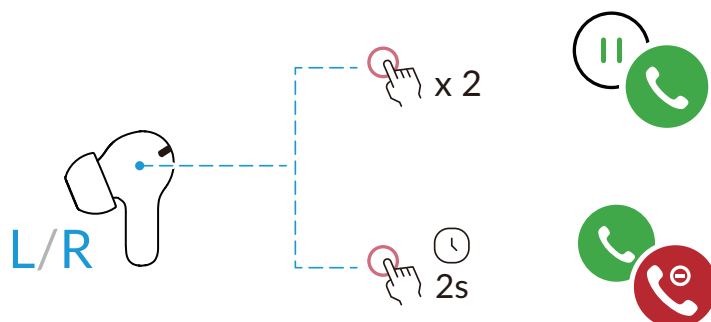

Double tap	Answer the incoming call and place the current call on hold
Press and hold for 2 seconds	Reject the incoming call and stay on the current call

Voice assist feature

Activate the voice assistant on your device by pressing and holding either earbud for 2 seconds.



Reset the earbuds

If you have to reset your earbuds due to connection or pairing issues, follow these steps:

1. Disconnect earbuds from your Bluetooth device, then tap either earbud 4 times.
2. The earbud LED indicators flash in blinking white when the earbuds enter reset process.

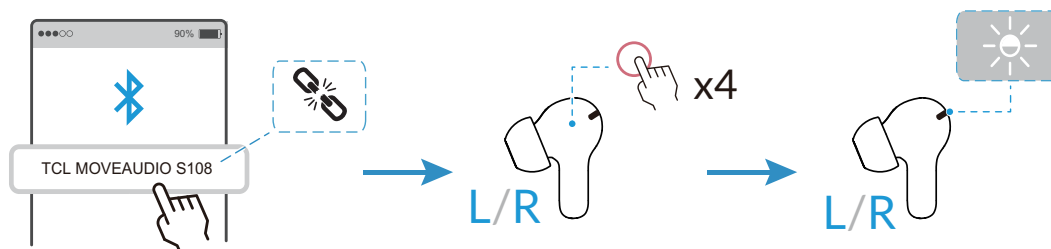

NOTE

After reset process, the earbuds will enter pairing mode automatically.

Important safety information

Read all safety information before using your product. Failure to follow these safety instructions could result in injury, or damage to your product or other property.

Important handling information

Handle your earbuds and the case with care. They contain sensitive electronic components, including batteries, and can be damaged if dropped, burned, punctured, crushed, disassembled, or if exposed to excessive heat or liquid.

Clean your device regularly with a dry and soft cloth. Do not use liquids or cleaning products.

NOTE: Before cleaning, remove earbuds from the case, and disconnect the USB cable from both the case and your computer or power adapter.

Hearing loss

Listening to sound at high volume may cause permanent hearing loss. Check the volume after inserting earbuds in your ears and before playing audio.



WARNING: To prevent possible hearing damage, do not listen at high volume levels for long periods.

Medical device interference

Your device contains magnets which may interfere with medical devices such as pacemakers, defibrillators, or other medical devices within the range of 15 cm (6 inches).

IF YOU ARE A USER OF ANY OF THESE MEDICAL DEVICES, PLEASE CONSULT WITH YOUR PHYSICIAN.

Choking hazard

Your device may present a choking hazard or cause other injury to small children. Keep them away from small children.

Charging

Charge the case with the supplied USB cable. Only charge with an adapter that is compliant with the applicable international and regional safety standards. Charging with other adapters could cause damage to the case or pose a risk of injury or death. It is important to keep your device and the power adapter in a well-ventilated area when charging. Don't use damaged cables or chargers.

If you use a third-party charger, the recommended output voltage/current of the adaptor is 5Vdc/1A.,and the adapter shall be CE approval type.

Battery

Do not attempt to replace the device batteries yourself. You may damage the batteries, which could cause overheating and injury. The batteries in your device should be serviced only by an authorized service provider.

Batteries must be recycled or disposed of separately from household waste. Don't incinerate the batteries. Check your country's local waste regulations for the proper disposal of electronic products.

CAUTION RISK OF EXPLOSION IF BATTERY IS REPLACED BY AN INCORRECT TYPE.
DISPOSE OF USED BATTERIES ACCORDING TO THE INSTRUCTIONS.

Operating temperature

Your device is designed to work and be stored in ambient temperatures between 0 °C and 45 °C (32 °F and 113 °F). Your device can be damaged and battery life shortened if stored or operated outside of these temperature ranges.

The suitable temperature for the product and accessories is 0°C - 45°C.

Regulatory compliance information

This section introduces regulatory information, certification, and compliance information specific to your product.

Electromagnetic fields (EMF)

This product complies with all applicable standards and regulations regarding exposure to electromagnetic fields.

FCC compliance statement

This equipment has been tested and found to comply with the limits for a Class B digital device, pursuant to Part 15 of the FCC Rules. These limits are designed to provide reasonable protection against harmful interference in a residential installation.

This equipment generates, uses and can radiate radio frequency energy and, if not installed and used in accordance with the instructions, may cause harmful interference to radio communications. However, there is no guarantee that interference will not occur in a particular installation.

If this equipment does cause harmful interference to radio or television reception, which can be determined by turning the equipment off and on, the user is encouraged to try to correct the interference by one or more of the following measures:

- Reorient or relocate the receiving antenna.
- Increase the separation between the equipment and receiver.
- Connect the equipment into an outlet on a circuit different from that to which the receiver is connected.
- Consult the dealer or an experienced radio/TV technician for help.

This device complies with the FCC rules. Operation is subject to the following two conditions: (1) This device may not cause harmful interference, and (2) this device must accept any interference received, including interference that may cause undesired operation.



FCC Radiation Exposure Statement:

This equipment complies with FCC radiation exposure limits set forth for an uncontrolled environment. This transmitter must not be co-located or operated in conjunction with any other antenna or transmitter.

Declaration of conformity



Hereby, TCL Communication Ltd. declares that the radio equipment type TCL TW08 is in compliance with Directive 2014/53/EU. The full text of the EU declaration of conformity is available at: <https://www.tcl.com/global/en/service-support-mobile/eu-doc.html>



Hereby, TCL Communication Ltd. declares that the radio equipment type TCL TW08 is in compliance with the Radio Equipment Regulations 2017. The full text of the UK declaration of conformity is available at: <https://www.tcl.com/global/en/service-support-mobile/eu-doc.html>

Disposal and recycling information

At TCL, we continually strive to improve our operations and products, and minimize our impact on the environment.



Your product is designed and manufactured with high quality materials and components, which can be recycled and reused. Please observe the local regulations regarding the disposal of packaging materials, exhausted batteries and old equipment. For recycling information, please visit www.tcl.com.



This symbol on your device and/or its accessories indicates that this device should not be disposed of with household waste. When this device reaches its end of life, take it to a collection point designated by local authorities. For more detailed information about device recycling, contact your local authorities, household waste disposal centers, or retail stores.

The separate collection and recycling of your device and/or its accessories at the time of disposal will help conserve natural resources and ensure that it is recycled in a manner that protects human health and the environment.



This symbol means that the product contains a built-in rechargeable battery covered by European Directive 2013/56/EU which cannot be disposed of with normal household waste. We advise you to take your product to an official collection point.

Troubleshooting

If you encounter problems while using the product, refer to the troubleshooting information to help determine the problem and find possible solutions.

General problems

Problem	Solution
I can't turn on the earbuds.	Your earbuds don't have enough battery power. Charge your earbuds.
I lost one of the earbuds.	Contact the local contact center for further advice.
The charging time and battery life are different between the two earbuds.	<ul style="list-style-type: none">• The charging time may differ between the two earbuds even if they start charging at the same time.• The charging time and remaining battery may differ between the two earbuds due to different inner components.
The actual playing time of earbuds is shorter than the specified time on the package.	Testing is conducted in the lab environment. Battery life depends on device settings, environment, usage, and many other factors.
How to dispose of my earbuds?	Check your country's local waste regulations for the proper disposal of electronic products. For more information, visit www.tcl.com .

Connection problems

Problem	Solution
I can't pair the earbuds with my device.	<ul style="list-style-type: none">• Make sure you have turned off the Bluetooth function of all previously paired devices.• Remove your earbuds from the pairing list on your device.• Follow the steps in the user manual to make pairing operation.
The earbuds can't connect to my device automatically.	<ul style="list-style-type: none">• Make sure the Bluetooth function of your device is enabled before using your earbuds.• Check if your earbuds enter pairing mode. If so, you can reconnect the earbuds to your device in the Bluetooth setting on your device.

After putting my earbuds back in the charging case, I find they are still connected to my device.	To disconnect the earbuds from your device, close the lid after putting your earbuds back in the charging case.
Can I connect my earbuds to multiple devices at the same time?	You can't connect your earbuds to multiple devices at the same time.
I can't find my earbuds on the pairing list of my device to make connection for the first time.	<ul style="list-style-type: none"> • Check if the earbuds are in the pairing mode. The earbud LED indicators flash in blinking white when the earbuds enter the pairing mode. • Turn off the Bluetooth function of your device, and turn it on again.
The earbuds keep disconnecting from my device.	<ul style="list-style-type: none"> • Your earbuds don't have enough battery power. • Make sure the earbuds and your device are within the connection range. • Remove the earbuds from the pairing list, and pair them with your device again.

Audio problems

Problem	Solution
I can't hear audio from one of the earbuds.	<ul style="list-style-type: none"> • Place both earbuds in the charging case, and ensure that the earbuds are charging and the charging case has been charged sufficiently. Then take out the earbuds, and try again. • If the problem persists, reset the earbuds.
The sound output on earbuds don't match what's happening on the connected device's screen.	<p>You may experience sound lags on your earbuds when playing videos or games.</p> <p>To minimize the delay, move the devices closer together to help improve the connection. Make sure there aren't any objects, metals, walls or people between the earbuds and other Bluetooth device.</p>
The music plays through the device speaker and not through my earbuds.	<ul style="list-style-type: none"> • Check whether your earbuds are connected to your device. • Check whether you have selected on your device the earbuds as the default playback device.
The audio quality is poor, and crackling noise can be heard.	<ul style="list-style-type: none"> • Check that your connected device is nearby, and there's no wireless interference or obstructions between the earbuds and your device. • Reconnect the earbuds.

<p>During a call using the earbuds, I can't hear the voice of the caller.</p>	<ul style="list-style-type: none"> • Some smartphones receive calls with the phone instead of the earbuds by default. You need to operate your smartphone to switch the call to your earbuds. • Increase the volume of your earbuds. • Adjust the volume of your connected Bluetooth device.
<p>During a call using the earbuds, others can't hear me speaking over a call.</p>	<ul style="list-style-type: none"> • Check your smartphone to make sure the voice is going through the earbuds. • Speak close to your earbud.

Trademarks

TCL and the TCL logo are trademarks of TCL Communication Ltd. The Bluetooth® word mark and logos are registered trademarks owned by Bluetooth SIG, Inc. and any use of such marks by TCL Communication Ltd. is under license. USB Type-C™ is a trademark of USB Implementers Forum. Google Assistant word mark and logo are trademarks or registered trademarks of Google Inc. Siri is a trademark or registered trademark of Apple Inc. registered in the U.S. and other countries. All other trademarks and trade names are the property of their respective owners.