

INSTALLATION INSTRUCTIONS

Upon receipt of fixture and accessories (packed separately) thoroughly inspect for any freight damage which should be brought to the attention of the delivery carrier. Compare the catalog description listed on the packing slip with the fixture label on the inside of the housing to be sure that you have received the correct merchandise.

SAFETY CHAIN KIT INCLUDES

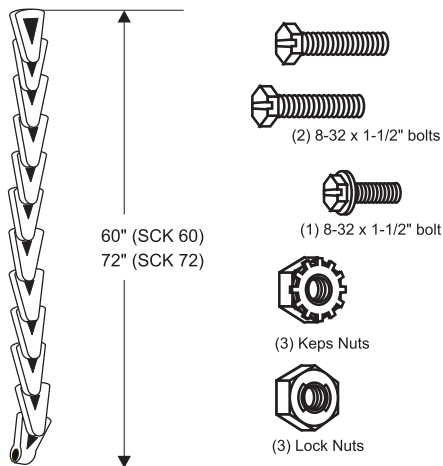

IMPORTANT SAFETY INSTRUCTIONS

(For Your Protection and Care)

- This fixture must be wired in accordance with the National Electrical Code and applicable local codes and ordinances.
 - Proper grounding is required to ensure personal safety.
 - Use approved connectors for all electrical connections.
 - ALL work should be done by a qualified electrician.
- WARNING:** NEVER disconnect any component while power supply is engaged.

Prior to Installation

Read carefully before installing light fixtures. If you do not understand these instructions, please contact your local Lithonia Lighting distributor before installing.

INSTALLATION

SCK Safety Chain Kit

STRUCTURE TO BALLAST HOUSING:

Loop safety chain over structure. Secure with 8-32 x 1- 1/2 " bolt, keps nut, and lock nut as shown in Fig. 1.

BALLAST HOUSING:

Remove 10-24 bolt from bottom hole of ballast housing flange, and replace with 8-32 x 1- 1/2 " bolt and 8-32 keps nut as shown in Fig. 2. Secure safety chain from structure to the 8-32 x 1- 1/2 " bolt with locknut.

IMPORTANT: REMOVE ALL CHAIN SLACK FROM BETWEEN CHAIN CONNECTIONS.

IMPORTANT: In the event the fixture should become dislodged, the safety chain can become fatigued. A new safety chain is to be installed with the reinstallation of the lighting fixture.

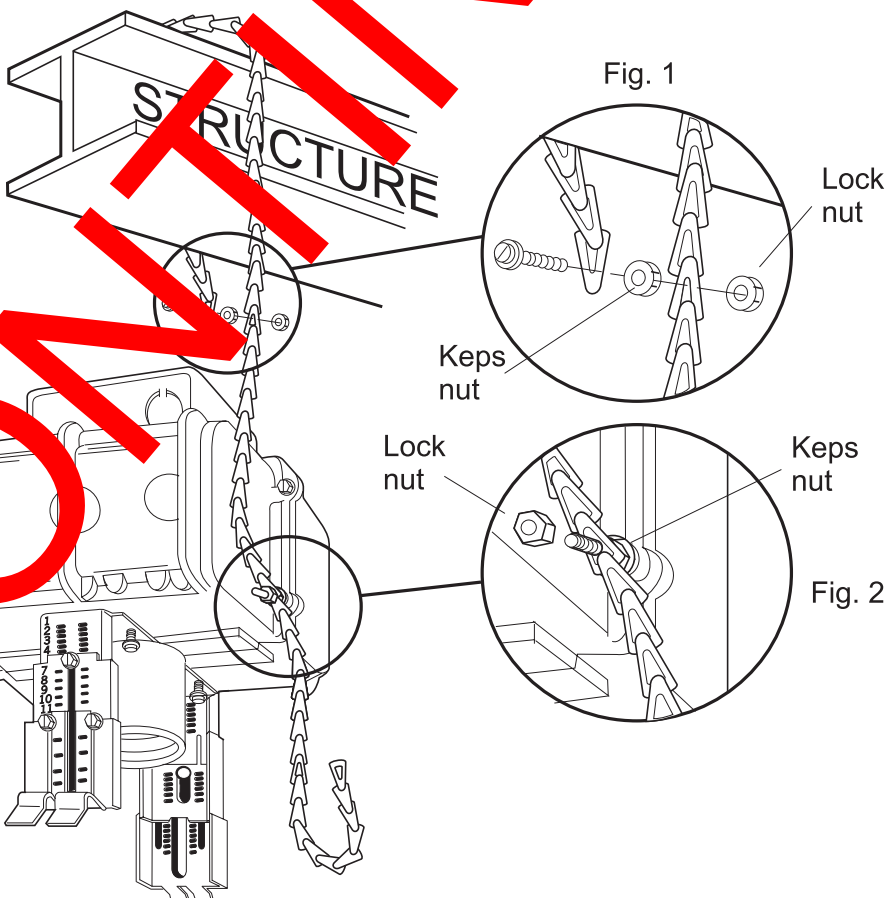

BALLAST HOUSING TO REFLECTOR: See reverse side.

INSTALLATION OF SAFETY CHAIN TO OPTICAL ASSEMBLIES

REFLECTORS WITH ADJUSTABLE LEGS

Secure safety chain to reflector with 8-32 x 1/2" bolt and 8-32 lock nut in pre-punched holes as shown.

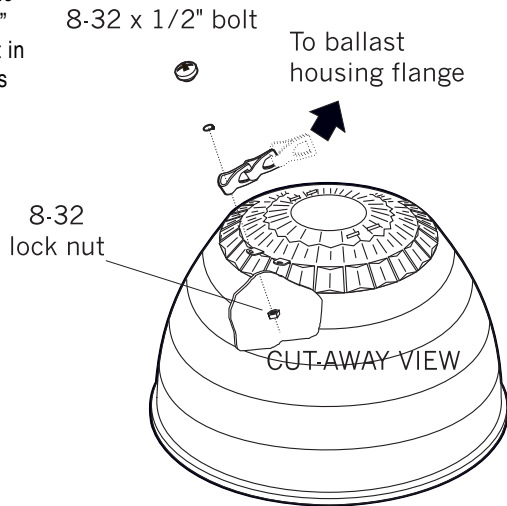

NOTE:
Length of safety chain:
A minimum of 12"
measured from bottom of
housing.

THV SERIES

Secure safety chain to reflector with 8-32 x 1/2" bolt and 8-32 lock nut in one of the holes on the reflector flange as shown.

To ballast housing,
see reverse side.

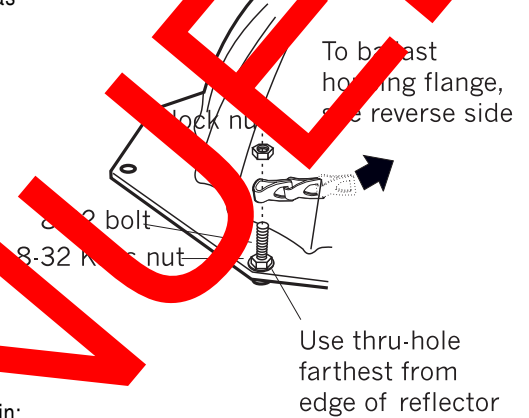

NOTE:
Length of safety chain:
A minimum of 18"
measured from bottom
of housing.

REFRACTOR/OPTICAL WITH LATCHES

Secure safety chain to latch assembly with 8-32 Keps nut as shown.

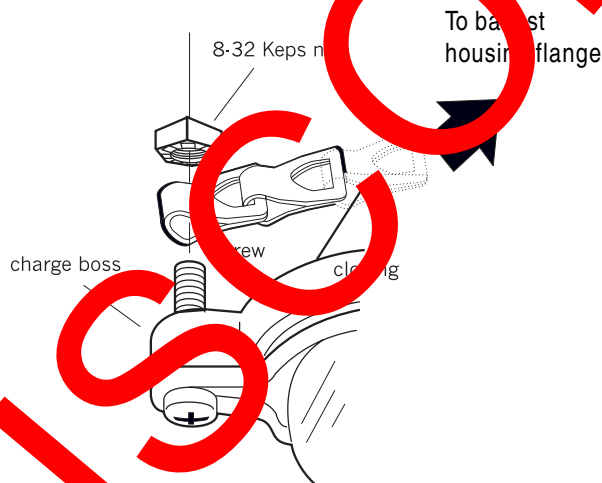

NOTE:
Length of safety chain:
A minimum of 12"
measured from bottom
of housing.

REFLECTORS WITH LATCHES

Secure safety chain to reflector hinge with 8-32 x 1/2" bolt and 8-32 lock nut as shown.

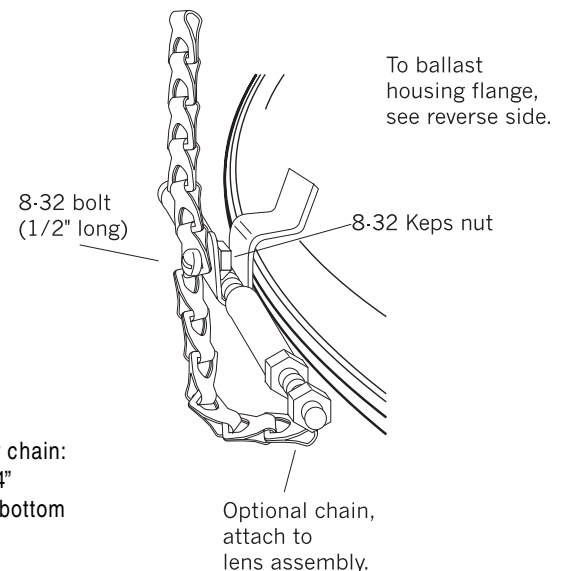

NOTE:
Length of safety chain:
A minimum of 24"
measured from bottom
of housing.