

■ 1.FUNCTION INTRODUCTION



Apple CarPlay

The iPhone's in-car infotainment system works with the centre console button to provide voice control for phone calls, messages, navigation, music and Siri voice interaction for more information. It supports both wireless and wired connections to CarPlay;

Android Auto

The original ecological Android car-machine interaction system developed by Google, voice control phone, information, navigation, music built-in voice control system;

Front/Rear/360 Input

The intelligent module supports video decoding and can be equipped with front view, rear view (with intelligent dynamic trajectory display and radar support), and 360° panoramic view;

■ 3.INSTALL MANUAL

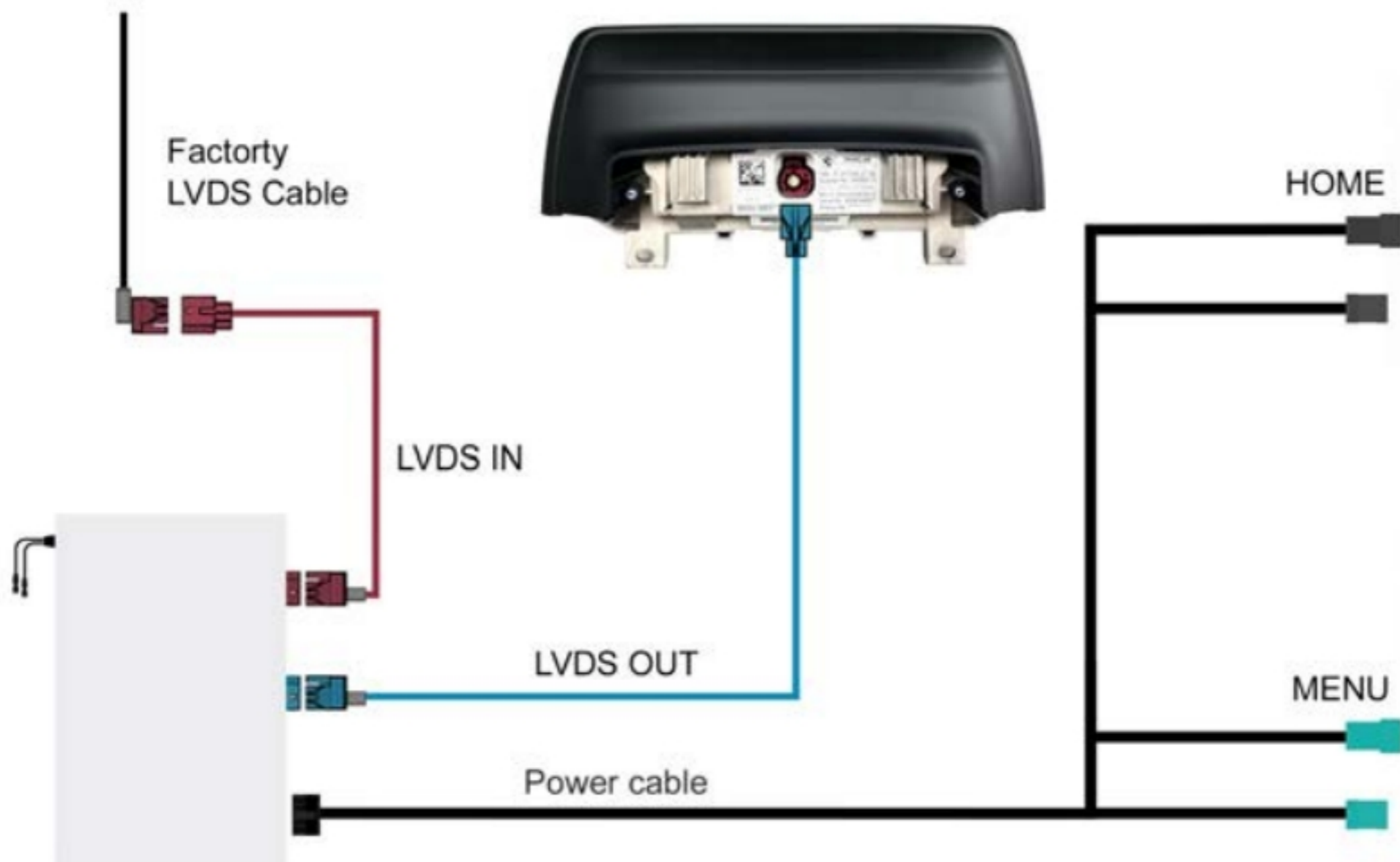

Choose the button
Home or Menu



■ 4.DIP SETTINGS & SWITCH

Here is the DIP Settings of the Alfa Romeo car model, Please according to your car model and Screen Size to Adjust.

Car System	Screen Size	Year	DIP
EVO(ID5/ID6)	6.5 inch	2017-2021	All OFF
	8.8 inch	2017-2021	8 ON
	10.25 inch	2017-2021	7 ON
MGU(ID7)	10.25/12.3 inch	2020-2024	78 ON

Note:Please note that the dial is set to "ON"



■ 4.DIP SETTINGS & SWITCH

4.2 Button Control



BUTTON	OPERATION	FUNCTION
	Short press	Answer the phone
	Long press	Wake up Siri
	Short press	Wake up Siri after setting
	Swipe up	Increase the volume
	Swipe down	Decrease the volume



BUTTON	OPERATION	FUNCTION
MENU	Long press	Switch OEM screen to interface screen OR Interface screen to the OEM screen
BACK	Rotation	Volume control system
	Short press	Control system APP
 Hazard Light	Double Click	Switch OEM screen to interface screen OR Interface screen to the OEM screen

5. WIRELESS CONNECTION

The latest technology currently in use is a wireless CarPlay and Android Auto solution that supports audio and video separation.

Before using the wireless connection, please pair your device via Bluetooth and ensure that the car audio system is set to Bluetooth Music mode for optimum connection and audio performance.

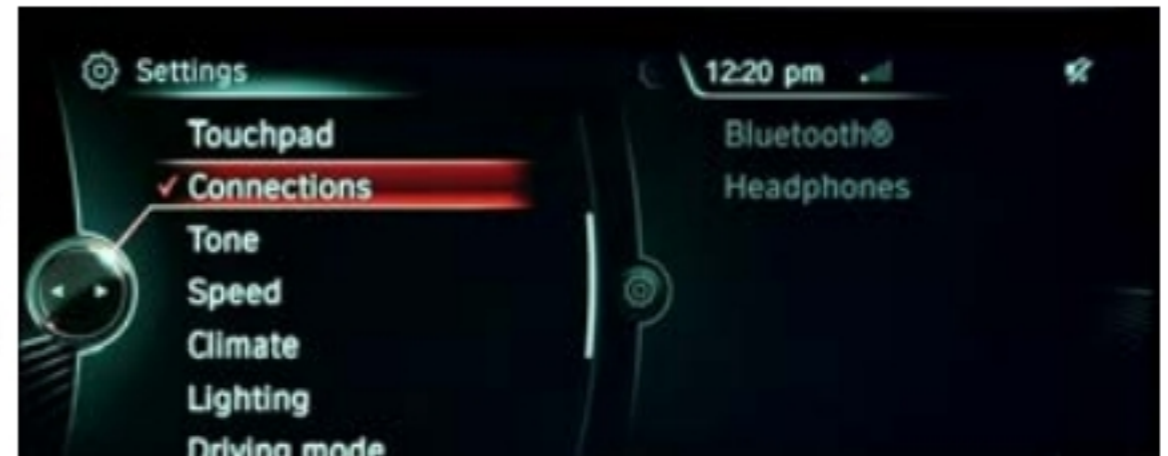
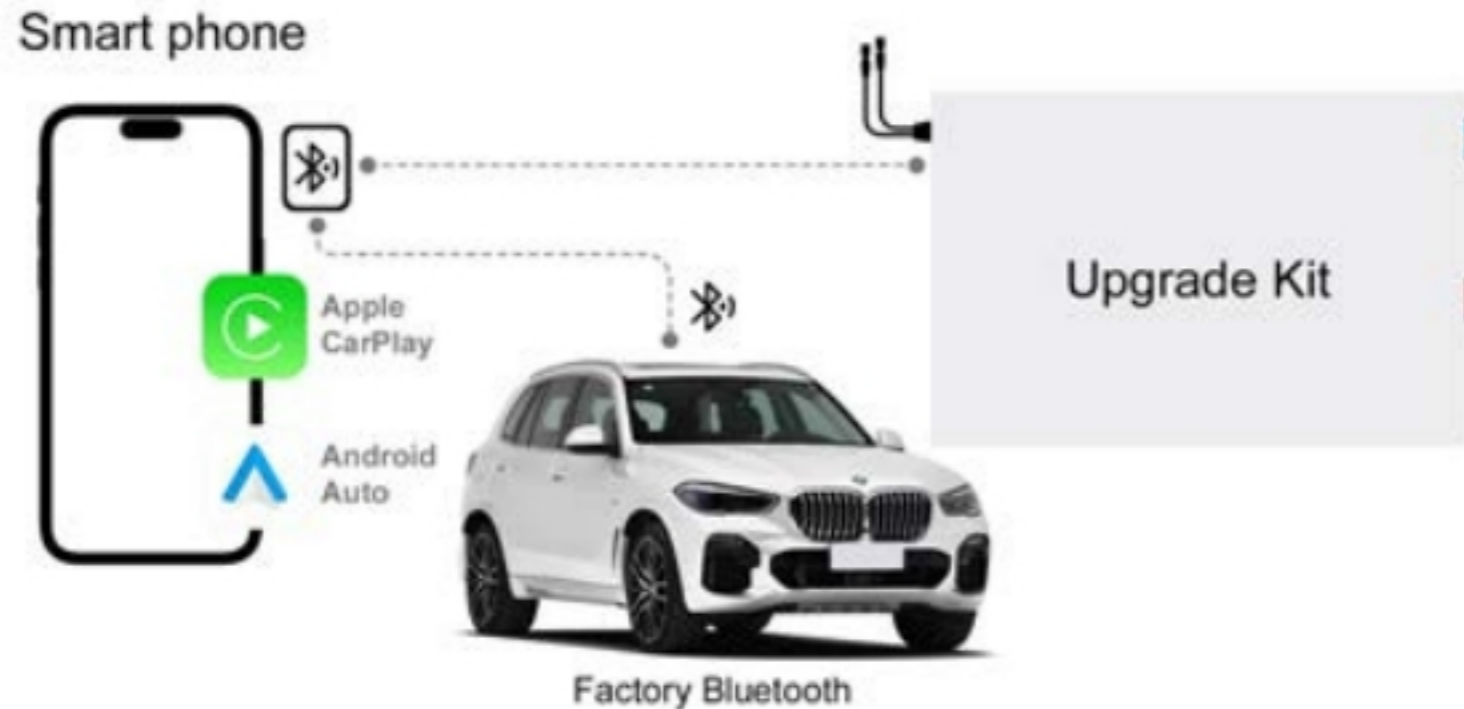

■ 5. WIRELESS CONNECTION

5.1 Wireless CarPlay

Go to Smart Box Bluetooth



Connect Step :

1. Turn on the Bluetooth and WIFI on your phone, and leave them turned on.

2. Select the Bluetooth device name as 'CAR Audio_XXXX' pair - use CarPlay while a request window pops up.

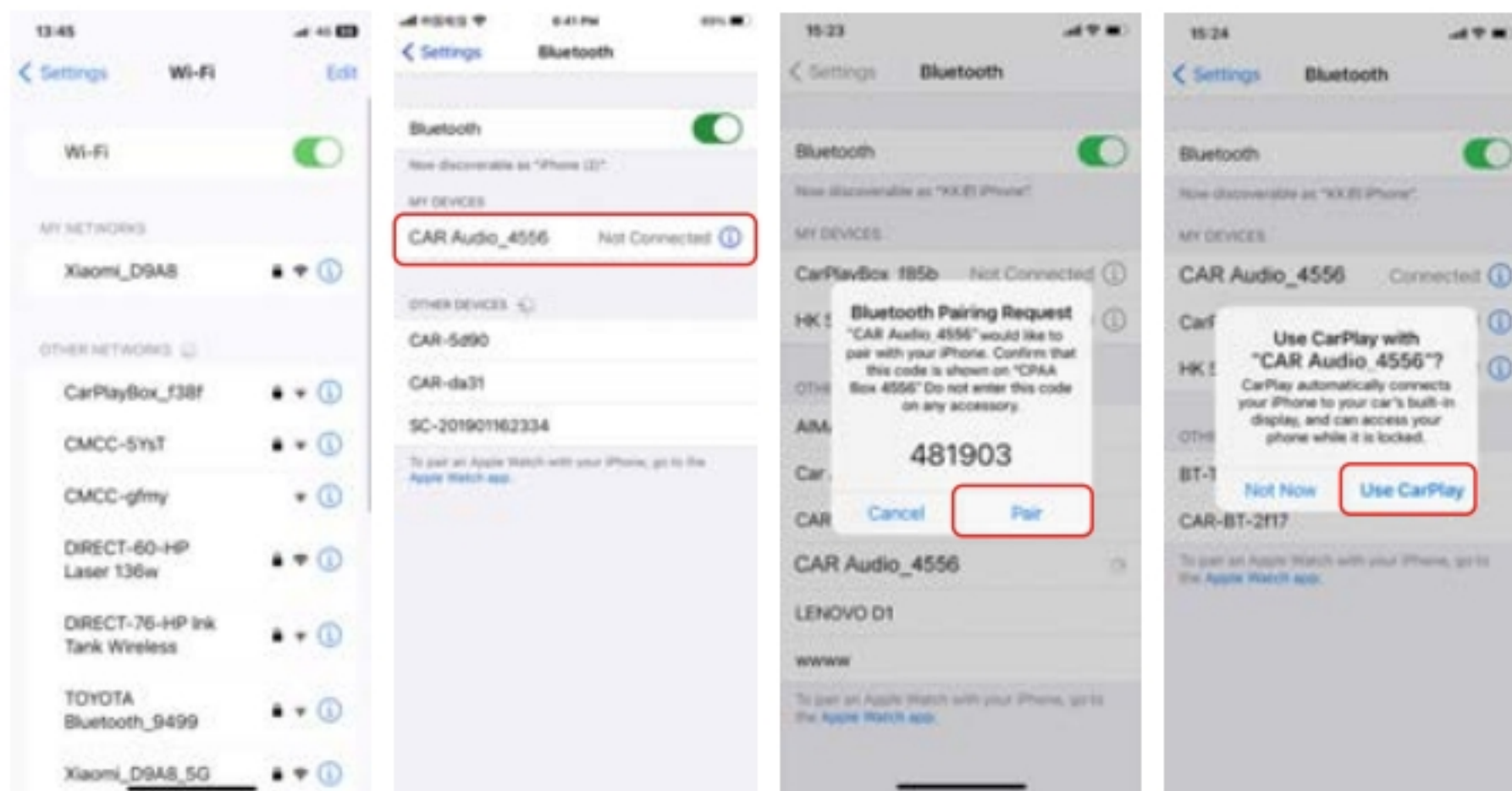

■ 5.WIRELESS CONNECTION

Audio Source

Please verify on iPhone that the sound source is the original car radio.

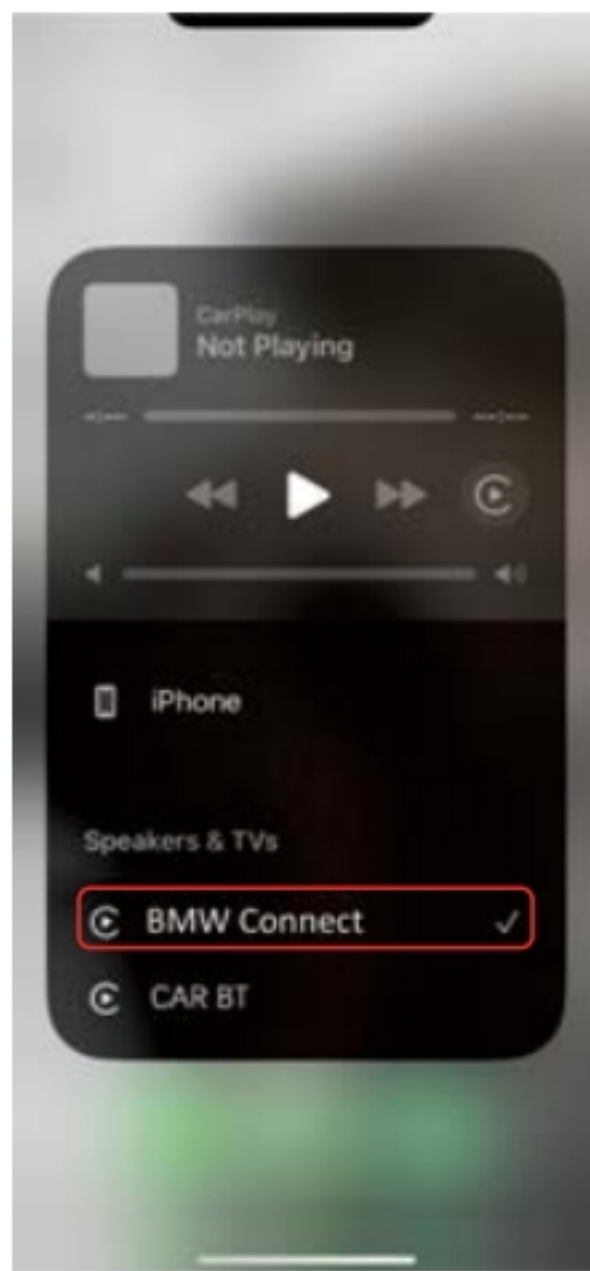

■ 5.WIRELESS CONNECTION

5.2 Wireless Android Auto

Go to Smart Box Bluetooth.

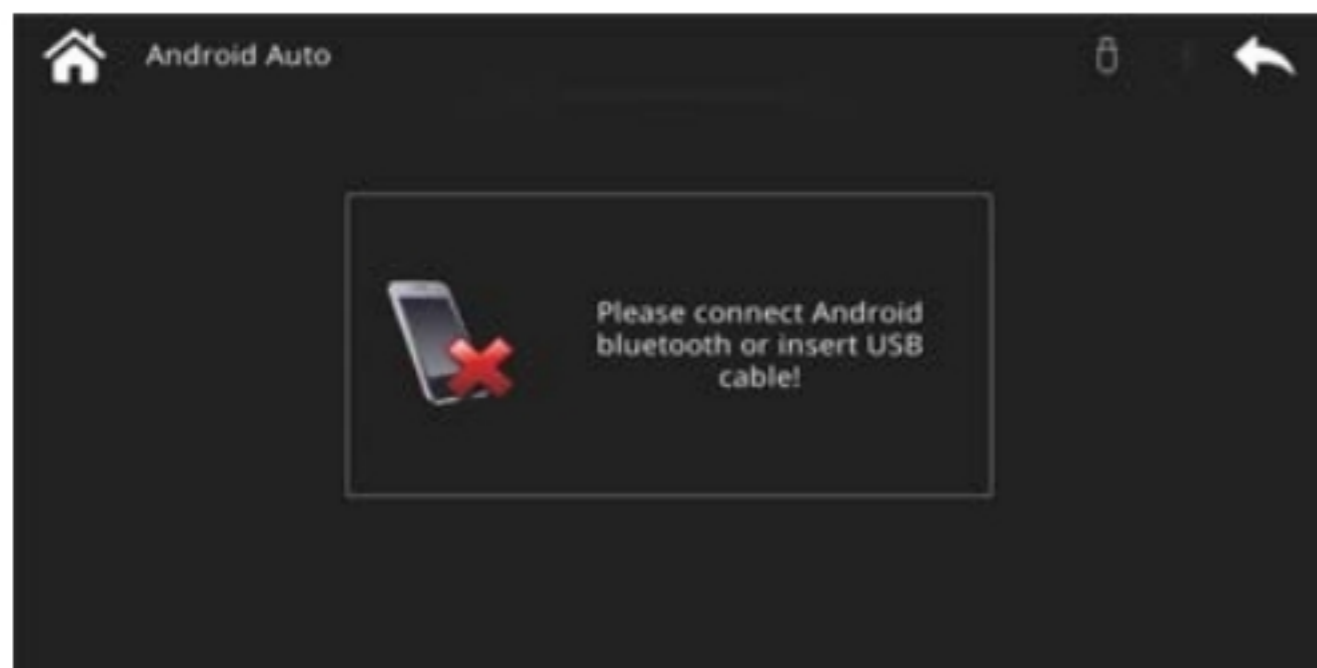

Connect Step :

1. Turn on Bluetooth and WiFi on your phone and leave them on.
2. Select Bluetooth Device name as "CAR Audio_XXXX" -Pair. After Bluetooth pairing is successful, follow the screen Android Auto connection process.

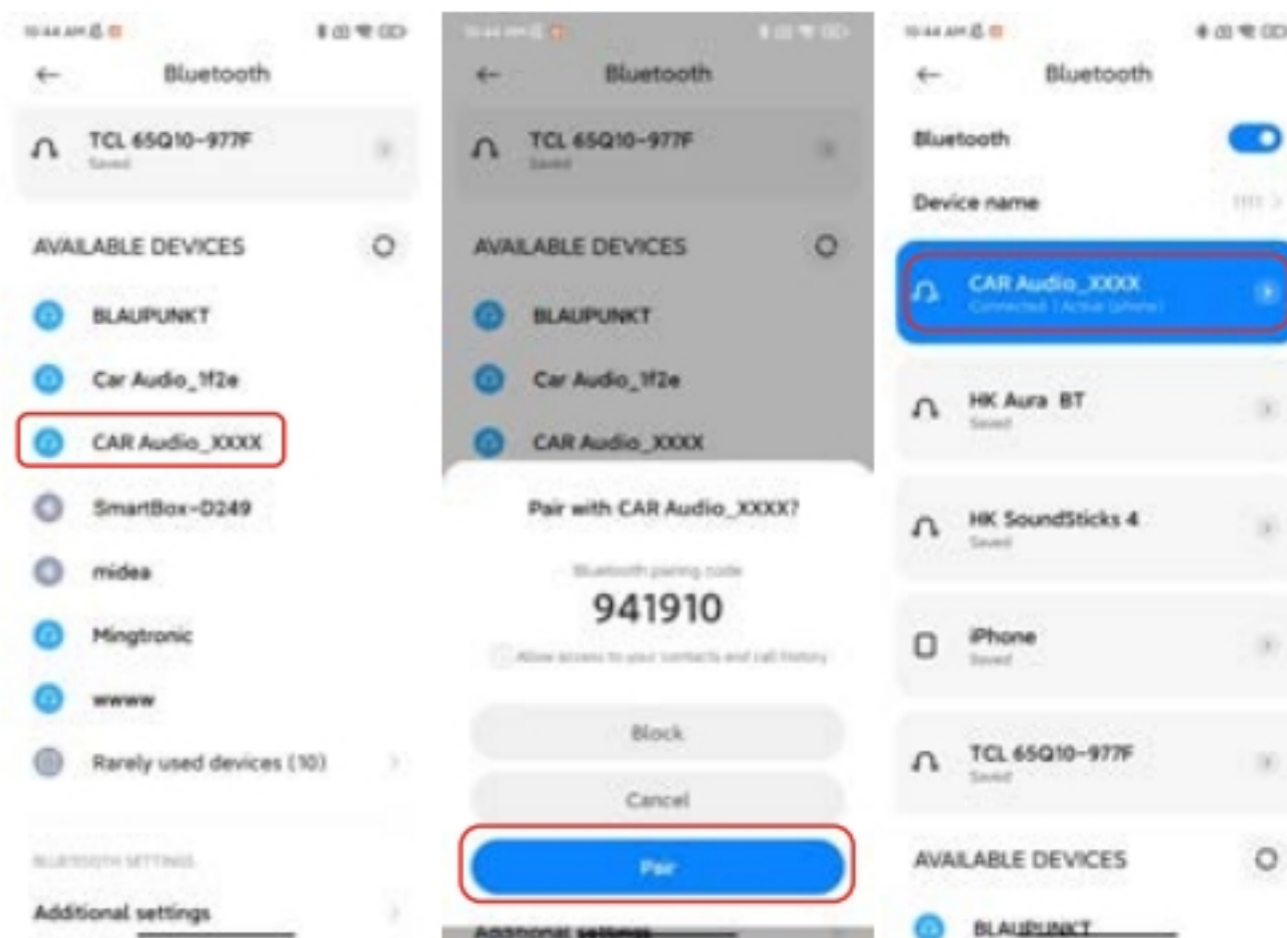

■ 6.EXTERNAL SETTINGS

6.1 Rear view camera input

This CarPlay interface supports AHD (Analog High Definition) camera input for clear rearview imagery.

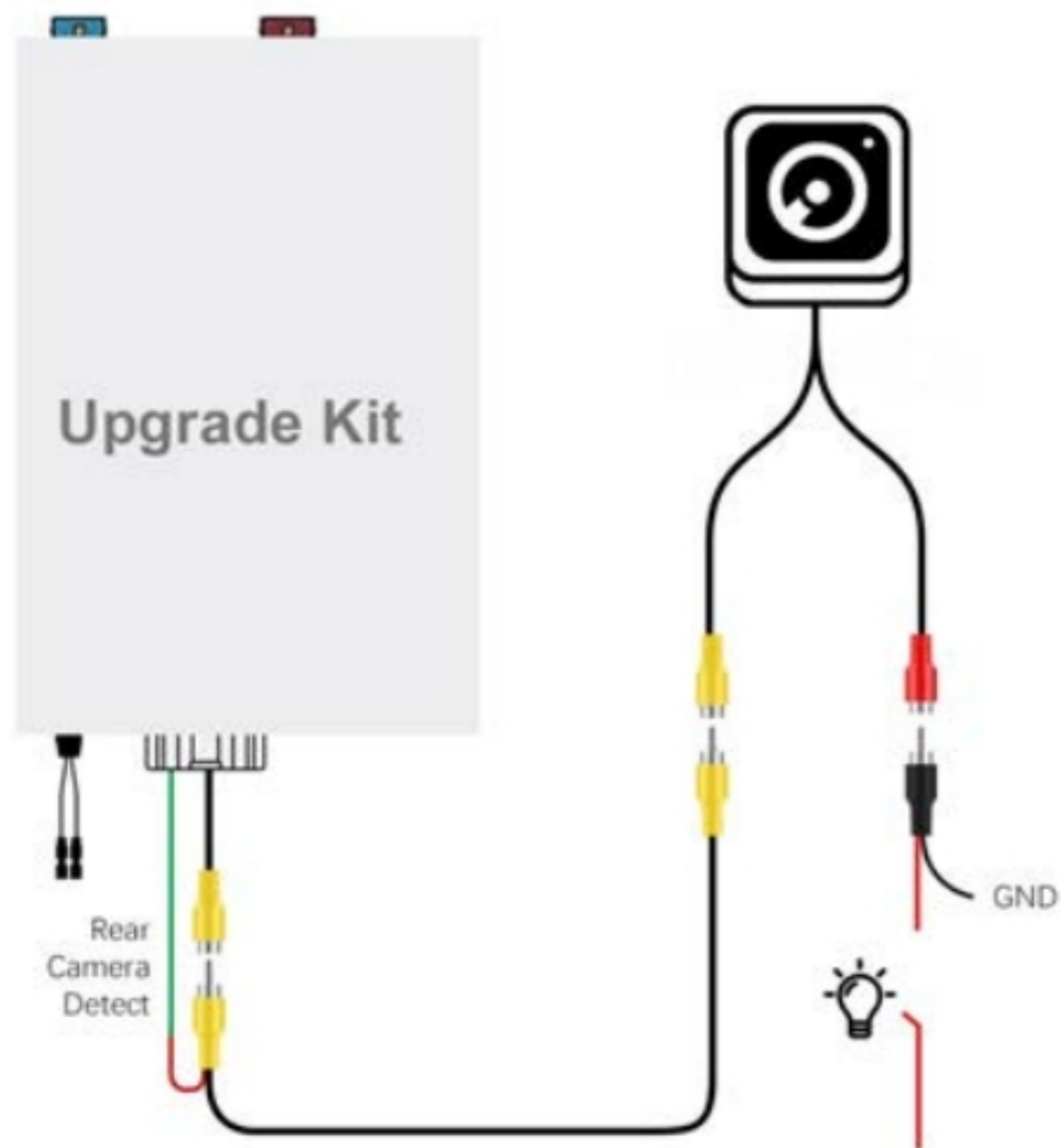

6.EXTERNAL SETTINGS

Then enter the system settings :

1. Click on "Factory mode → Advanced mode → Enter the password "888888" → MCU setup → Uncheck "A0"option.
2. Return to the previous level and click "Restart System" to successfully enable the reversing rear view function.



6.2 Radar and Trajectory

If the aftermarket camera you are installing also supports the reversing trajectory line, please uncheck the A1 box to display the reversing trajectory line. And the A2 box is the aftermarket radar option, uncheck the box to use it.

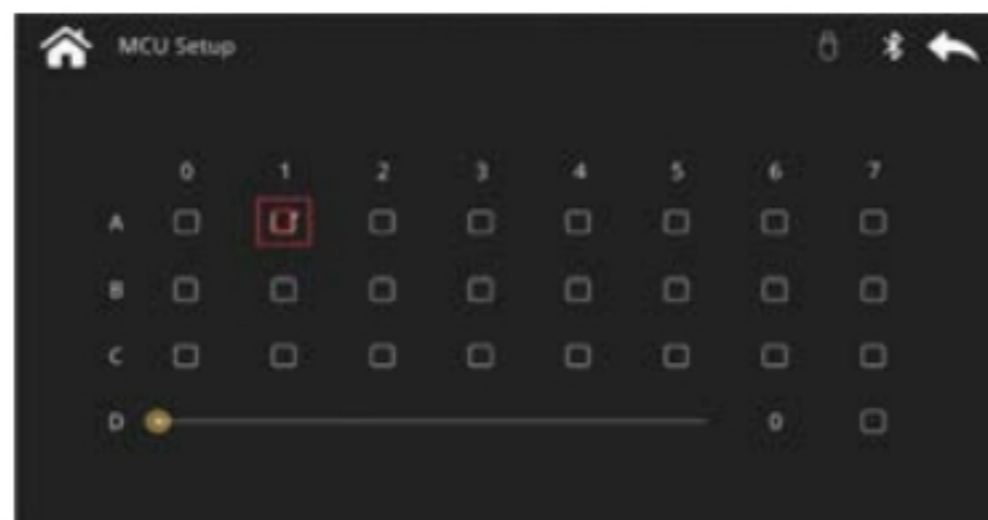

■ 8.COMMON PROBLEM

8.1 Why will the Box's Bluetooth disconnect?

Here is how wireless CarPlay works. After the device information is sent to confirmed via Bluetooth pairing, a Wi-Fi connection is established for data transfer. To avoid interference, the Bluetooth connection is disconnected. This is a normal phenomenon.

8.2 I cannot connect the CarPlay, but the Bluetooth already paired

Please forget about Bluetooth and reset Wi-Fi in iPhone (Settings > General > Transfer or Reset[Device] > Reset > Reset Network Settings)

8.3 Why the wireless CarPlay not Stable?

- 1.Ensure that the mounting position of the CarPlay box is not obstructed by metal parts, as this can affect the transmission of the Wi-Fi signal.
2. Change the WiFi channel, then enter the CarPlay box. Click: Factory Mode > Connectivity Settings > Hotspot Band > Select 1, 6 or 11, depending on the current region.