

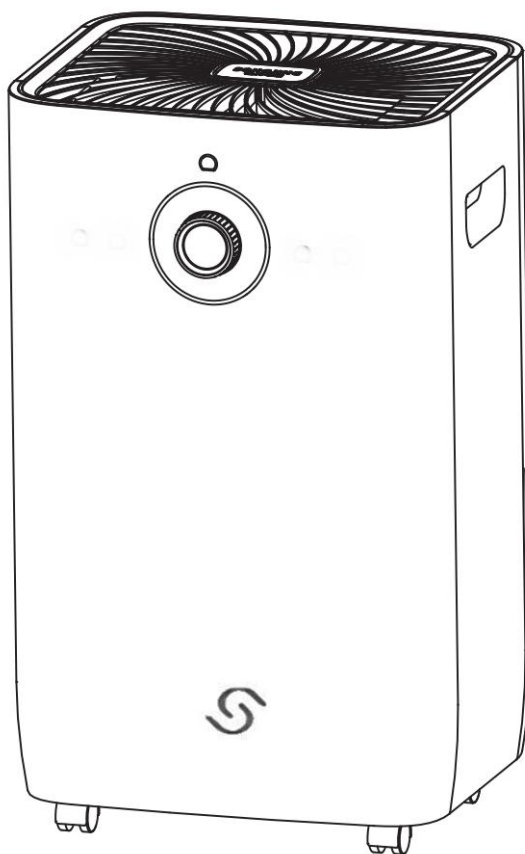

INSTRUCTION MANUAL



OY50-D024A

▼ Precautions

- Separate and count all parts and hardware.
- Read through each step carefully and follow the proper order.
- If possible, assemble the unit near where it will be placed in use, to avoid unnecessary moving.
- Always place the unit on a flat, steady and stable surface.
- Keep all small parts and packaging materials away from babies and children.
- If the supply cord is damaged, it must be replaced by the manufacturer.
- The appliance shall be disconnected from its power source during maintenance.
- Always operate the unit from a power source of equal voltage, frequency and rating as indicated on the product identification plate.
- Always use a power outlet that is grounded.
- Unplug the power cord when cleaning or when not in use.
- Don't operate with wet hands.
- Prevent water from spilling onto the unit.
- Don't immerse or expose the unit to rain, moisture or any other liquid.
- Don't leave the unit running unattended.
- Don't tilt or turn over the unit.
- Don't unplug while the unit is operating.
- Don't unplug by pulling on the power cord.
- Don't use an extension cord or an adapter plug.
- Don't put objects on the unit.
- Don't climb or sit on the unit.
- Don't insert fingers or other objects into the air outlet.
- Don't touch the air inlet or the aluminum fins of the unit.
- Don't operate the unit if it is dropped, damaged or showing signs of product malfunction.
- Don't clean the appliance with any chemicals.
- Ensure the unit is far away from fire, inflammable, or explosive objects.
- The unit shall be installed in accordance with national wiring regulations.
- Don't use means to accelerate the defrosting process or to clean, other than those recommended by the manufacturer.

- The appliance shall be stored in a room without continuously operating sources (for example: open flames, an operating gas appliance or an operating electric heater).
- The appliance shall be stored so as to prevent mechanical damage from occurring.
- Don't piece or burn, even after use.
- Pipe-work shall be protected from physical damage and shall not be installed in an unventilated space, if that space is smaller than 43 sq.ft.
- Compliance with national gas regulations shall be observed.
- Keep any required ventilation openings clear of obstruction.
- The appliance shall be stored in a well-ventilated area where the room size corresponds to the room area as specified for operation.
- Any person who is involved with working on or breaking into a refrigerant circuit should hold a current valid certificate from an industry-accredited assessment authority, which authorizes their competence to handle refrigerants safely in accordance with an industry-recognized assessment specification.

02 PRODUCT DESCRIPTION

The dehumidifier is used to remove excessive moisture from the air. The resulting reduction in relative humidity protects buildings and their contents from the adverse effects of excess humidity.

2.1 FEATURES



Powerful and Efficient moisture removal



Three modes:
Intelligent & Continuous
& Sleeping



Three drainage methods:
Manual & Continuous
& Automatic



Humidity Monitor showing
current air humidity



A 12-hour time for
automatic operation
time setting



Child Lock preventing
unwanted injuries



Air Filter for
dust removal



Quiet fan with two
speed options

2.2 PARAMETERS (HOME DEHUMIDIFIER)

Model No	OY50-D024A
Dehumidification Capacity	150Pint/D(95°F/90%RH) 100Pint/D(86°F/80%RH) 50Pint/D(65°F/60%RH)
Power Supply	115V~60Hz
Rated Input Current	5.5A
Refrigerant Charge	R410A/12.0oz
BCSC	15A

Fan Motor Power	0.077HP
Maximum Design Pressure	High-side:580psig Low-side:261psig
Sound Pressure Level	≤50dB
Full Water Quantity	1.5 Gallon
Compressor Input	RLA:3.12A/LRA:20A
Working Temp	41°F-95°F

2.3 PRODUCT DISPLAY

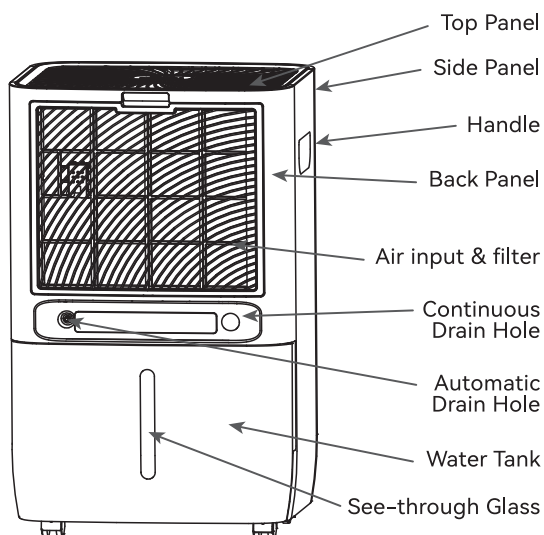
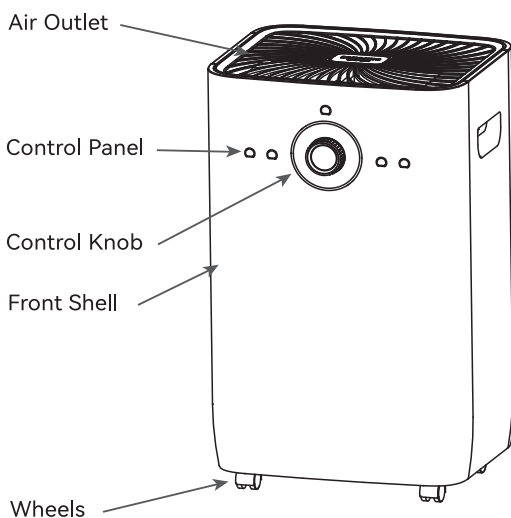

03 OPERATION

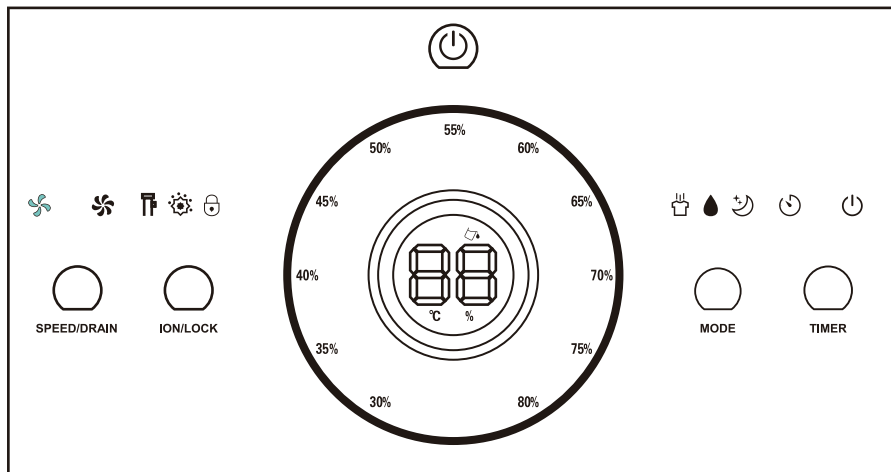

3.1 KNOB

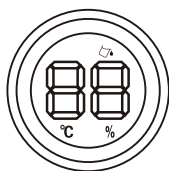

Rotate the knob to change the set humidity between 30% and 80%. The current ambient humidity is displayed on the knob's centrally integrated LED screen. The inner ring indicates the set humidity. The outer ring serves as a triple-color indicator showing the ambient humidity range:

- Blue: $AH < 45\%$
- Green: $45\% \leq AH \leq 65\%$
- Red: $AH > 65\%$

 **Water Tank Full Indicator:** turns red when the water tank is full.

3.2 BUTTONS



POWER

Press this button to turn the unit on/off. The operation indicator will light up when the unit is on, and the default settings for fan speed and humidity level are: high and 50%.



MODE

MODE

There are three mode options: Intelligent-Continuous-Sleeping

Intelligent mode: Both target humidity level and fan speed are adjustable. The fan and compressor will start working when the environmental humidity level \geq set humidity level + 3%, and will stop working when the environmental humidity level \leq set humidity level - 3%.

Continuous mode: The unit will run continuously regardless of the ambient humidity level, and the target humidity level can't be set according to one's own desire.

Sleeping mode: All indicators will turn dark, the fan speed is low, and the target humidity level can't be set according to one's own desire. The fan and compressor will start working when the environmental humidity level $\geq 63\%$, and will stop working when the environmental humidity level $\leq 57\%$. Touch any button to wake the indicators up. Press this button once to switch between the modes, and the corresponding mode indicator will light up. A long press of this button will display the ambient temperature on the knob's screen.



SPEED/DRAIN

SPEED/DRAIN

There are two fan speed options: High-Low. Press this button to switch between the speeds, and the corresponding indicator will light up. Under continuous mode, sleeping mode, or defrosting period, the fan speed is not adjustable. A long press of this button will activate the pump/drain function. The built-in pump enables convenient automatic drainage to any location up to 19 feet away.



ION/LOCK

ION/LOCK

A quick press of this button will turn on/off the ION function (for dust removal). A long press (3 seconds) of this button will turn on/off the child-lock function.



TIMER









TIMFE

The first press of this button will turn the timer on, and each further press will increase the timer by 1 hour. The timer will automatically turn off when it reaches 12 hours (shown as "00" on the LED display). In the power-on state, the timer indicates the length of operation time. In the standby state, the timer indicates the length of time until the reserved turning-on time.

NOTE:

The dehumidifier starts operating in the mode that it was last in. The dehumidifier starts dehumidifying if the room humidity is 3% higher than the selected humidity. There is a protective 3-minute time delay for the compressor. Wait 3 minutes for the dehumidifier to resume dehumidification.

3.3 INDICATORS

 Low/ High Fan Speed	 Pump/Automatic Drainage Indicator
 Ion(dust removal)	 Low/ High Fan Speed
 Continuous Mode	 Low/ High Fan Speed
 Sleeping Mode	 Low/ High Fan Speed
 The indicator will stay lit when the machine is connected to power, off when it is not. When the machine is defrosting, this indicator will blink.	

1. WATER TANK FULL ALARM

- When the tank is full, the water tank indicator turns red and the unit beeps for 5 times.
- Press any button to stop the alarm. The compressor and fan shut down and all the functions freeze until the tank is emptied and back in the right position.

2. EMPTY THE TANK

- Grab the notch at the bottom of the tank and pull it out with both hands carefully.
- Empty the water.
- Put the water tank back in position. The dehumidifier automatically resumes working.

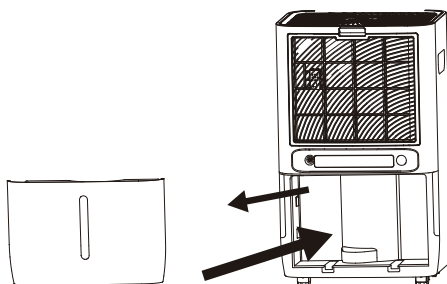

3. MANUAL DRAINAGE

- Use the water tank for drainage. Empty the tank when the Water Tank Full Indicator lights up.

4. CONTINUOUS DRAINAGE

- Remove the water tank from the body to reveal the drain hole for manual water tank drainage, which is located at the inner side of the dehumidifier (behind the water tank).
- Use the rubber stopcock to block this inner-side drain hole.
- Put the water tank back in place.
- Remove the rubber stopcock blocking the drain hole for continuous drainage. Plug a 0.43 inches (diameter) PVC drain hose into this hole to enable continuous drainage. You may connect the other end of the hose to any drainage area you desire.

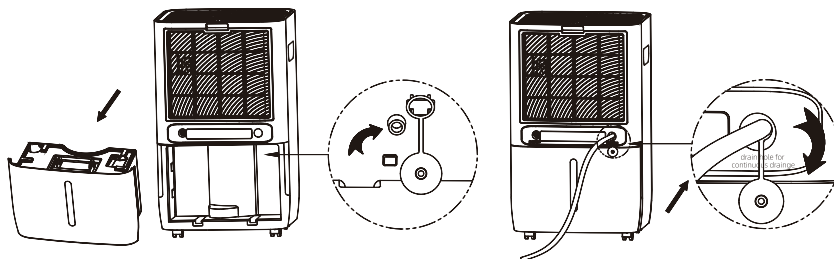

⚠ WARNING: the end of the hose should not be submerged in water to prevent it from being blocked or damaged.

5. AUTOMATIC DRAINAGE

- Remove the water tank from the body to reveal the drain hole for manual water tank drainage, which is located at the inner side of the dehumidifier (behind the water tank).
- Use the rubber stopcock to block this inner-side drain hole.
- Put the water tank back in place.
- Use the rubber stopcock to block the drain hole for continuous drainage.
- Remove the rubber stopcock blocking the drain hole for automatic drainage. Plug a 0.24 inches (diameter)PVC drain hose into this hole to enable automatic drainage.
- Hold the "Speed/Pump" button for three seconds to activate automatic drainage. The Pump/Automatic Drainage indicator will light up.

⚠ WARNING: complete the previous five steps before such activation, as water will flow to the ground otherwise

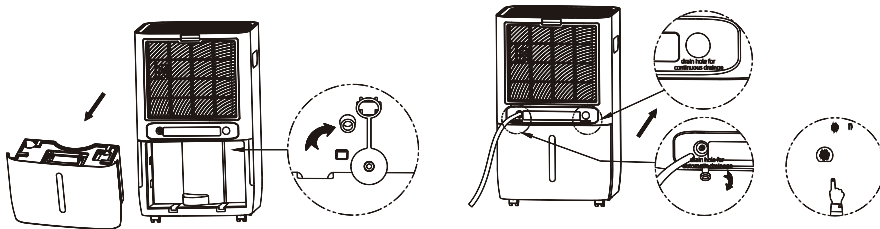

⚠ WARNING: the end of the hose should not be submerged in water to prevent it from being blocked or damaged.

05 MAINTENANCE

5.1 PRECAUTIONS

- Don't remove the magnet and plastic nail out of the tank otherwise the dehumidifier cannot function.
- Make sure to drain the water tank thoroughly and put the water tank back in place, otherwise the dehumidifier cannot function.
- If the tank is dirty, wash it with cool/warm water. Don't use cleanser, steel balls, chemically treated dust-proof cloth, gasoline, benzene, thinners, or other chemical solvents in case of damage and leakage.

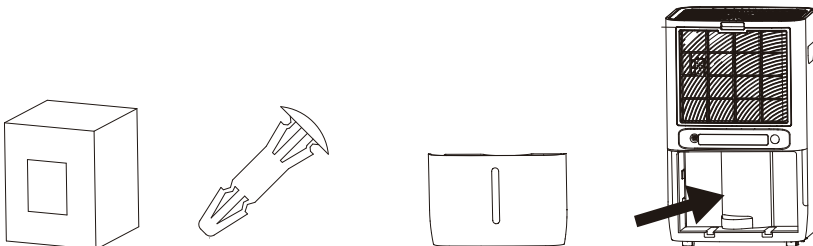

5.2 CLEANING

1. Body Cleaning

Use a soft and slightly moist cloth to clean the dehumidifier's body.

⚠ WARNING: Before cleaning or conducting maintenance, please turn off and unplug the machine to avoid the risk of electrocution.

2. Filter Cleaning

- Remove the filter frame and take off the filter.
- Submerge the filter in 100°F warm water, clean it with mild detergent. Use a vacuum cleaner to gently brush off any dust on the surface of the filter.
- If the filter is dirty, wash it with water and a soft detergent, and dry it thoroughly afterwards.
- Put the filter back.

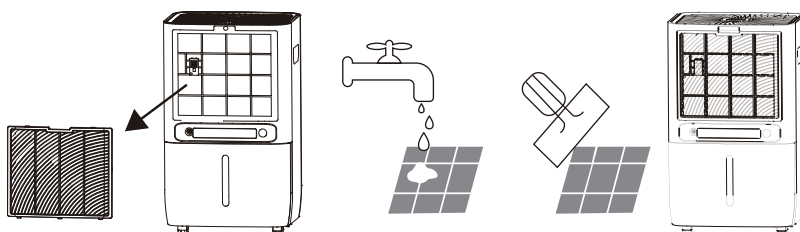

⚠ WARNING: It is strongly advised to rinse the filter every two weeks. Any dust blocking the filter will potentially affect the machine's functionality.

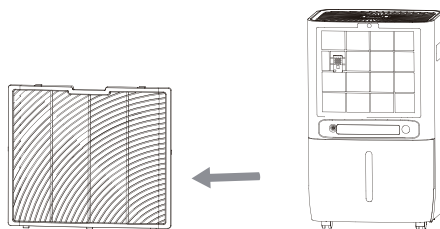

5.3 LOCATION

1. Place the appliance on a firm and horizontal surface in an area with at least 8 inches of free space around it to allow for proper air circulation.
2. Never install the appliance at a place that could be subject to:
 - Heat sources such as radiators, heat registers, stoves or other products that produce heat.
 - Possible splashing of oil or water.
 - Direct sunlight.
 - Mechanical vibration or shock.
 - Excessive dust.
 - Lack of ventilation, such as cabinet or bookcase.
 - Uneven surface.

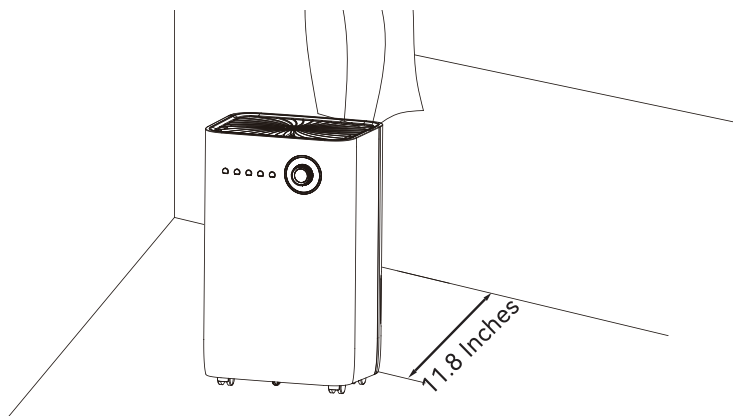

06 WATERTANK&DRAINAGE

Before contacting the customer service, please review the following troubles hooting list that includes common problems that are not the result of a defect in workmanship or materials.

Problem	Possible Cause	Solution
Not turning on	Power cord not connected properly	Make sure the power cord is properly plugged into the machine and a power source
	Water Tank Full Indicator On (Water tank is full or not in the right position)	Make sure the water tank is properly drained and is put in the right spot
	Ambient Temperature too high/low (protection mechanism triggered)	Make sure the machine is under proper temperature (40 ~ 100F)
Humidity Level not Dropping	Filter Clogged	Wash the filter thoroughly as instructed
	Remove any object blocking the intake vent or discharge duct	Remove any object blocking the intake vent or discharge duct
No Air Intake	Filter Clogged	Wash the filter thoroughly as instructed
Loud Noise	Machine tilted or upside down	Make sure the machine is standing upright
	Filter Cloggec	Wash the filter thoroughly as instructed
Error Code'E2	Humidity sensor problem	Change the sensor

Error Code'E4	If the water pump runs for 30 seconds and detects a full water tank, this code will appear and the machine will shut down	Place a container below the drain hole for manual water tank drainage.Remove the rubber stopcock blocking the hole to drain the water out
Error Code EQ	Communication line malfunction machine will shut down	Check the communication cord
Error Code'CH	When the ambient temperature is above 212F,this error code will appear, and the compressor and fan will shut down	
Error Code'LO	When the ambient humidity drops below 20%,this error code will appear and the compressor and fan will shut down	
Error Code'HI	When the ambient humidity is above 90%,this error code will appear, but the compressor and fan will keep operating	

WARNING

If the Water Tank Full indicator is always on, there may be a malfunction in the machine. Please seek technical support from professionals. If anything unexpected happens, please turn off and unplug the machine immediately, and seek technical support from certified electrical engineers.

07

WATERTANK&DRAINAGE

7.1 STORAGE

If you are not going to use the appliance for an extended period of time (more than a few weeks), it is best to clean and dry it completely before preserving the appliance in a ventilating, dry corrosive gas-free, and safe indoor space. The appliance must be kept in an upright position when in storage.

Note: In order to avoid the damage of parts and mold, the carburetor in the device must be dried. Take it out and leave it in a ventilated place for a few days to dry. Another method is to adjust the moisture level to 5% higher than the ambient moisture level, so that a fan can blow to dry the evaporator for several hours.

7.2 DISPOSAL

Don't dispose of electrical appliances as unsorted municipal waste. Instead, use designated collection facilities. Contact your local government for information regarding the available disposal collection system.



If you have any questions when using the product, you could contact us via
email:support@tiitss.com

