

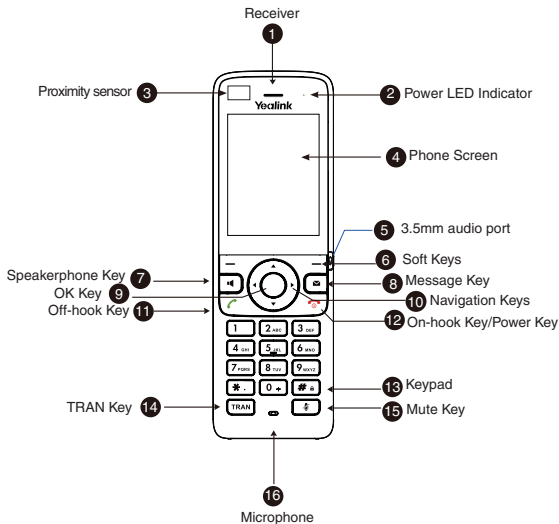

AX83H Wi-Fi IP Phone



Package Contents



AX83H Handset

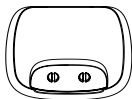

Charging Cradle



(5V/1.2A)

Power Adapter



Battery Cover



Rechargeable Battery

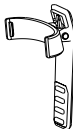

Belt Clip



Quick Start Guide



We recommend that you use the accessories provided or approved by Yealink.
The use of unapproved third-party accessories may result in reduced performance.

Assembling AX83H

1. Insert the battery into the handset.

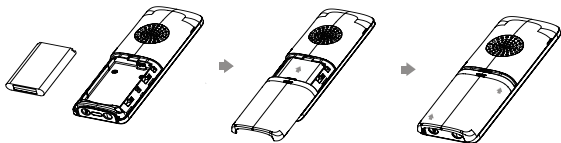

2. Attach the belt clip to the handset.

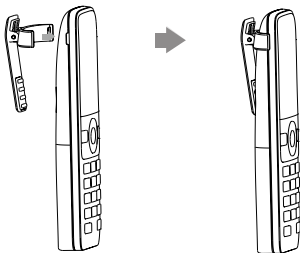

3. (Optional) Mount the charging cradle to the wall.

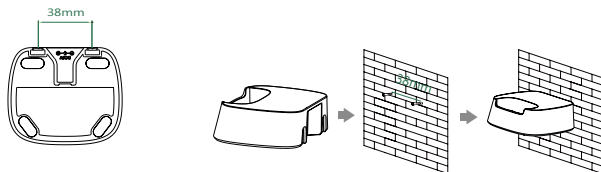

Charging

Option 1: Connect the charging cradle and charge the handset.

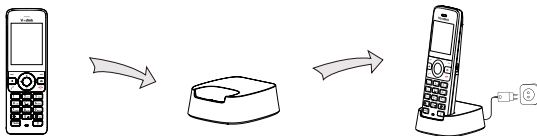

Option 2: Connect the type-C end of the charging cable to the charging port on the bottom of the AX83H. Plug the other end into a power source.

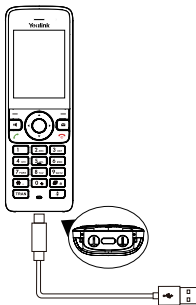

- Use Yealink-supplied power adapter (5V/1.2A). A third-party power adapter may damage the handset.
- Check the charging status on the top-right corner of the LCD screen.

LED Indicator Instructions

LED Status	Description
Off	Power off/ normal status
Solid green	Battery fully charged
Solid Red	In the process of initialization/ charging (not fully charged)
Rapidly blinking red	Incoming call
Slowly blinking red	New voicemail/missed call/text message

包装清单



AX83H

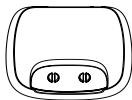

充电底座



(5V/1.2A)
电源适配器



电池后盖



可替换锂电池

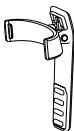

皮夹带



快速入门指南

 我们推荐使用由亿联提供或经亿联认可的配件。使用未经认可的第三方配件可能会导致性能的下降。

组装 AX83H

1. 将电池装入 AX83H。

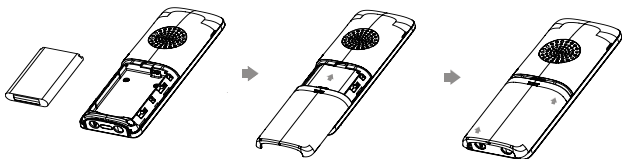

2. 将皮夹带和 AX83H 组装在一起。

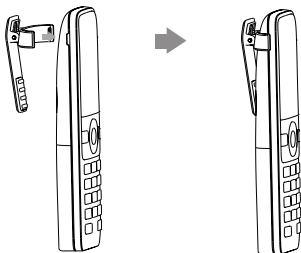

3. 使用螺丝将充电底座安装到墙上。

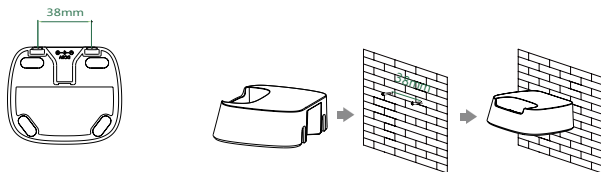

充电

方式 1：将 AX83H 放入充电底座，连接电源，为 AX83H 充电。

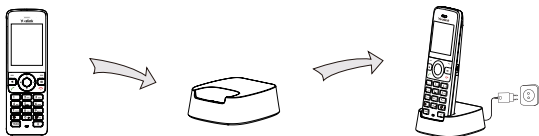

方式二：将 AX83H 放入充电底座，连接电源，为 AX83H 充电。

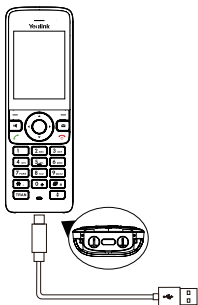

- 推荐使用亿联提供的电源适配器 (5V/1.2A). 使用未经认可的第三方配件可能会导致损坏。
- 屏幕右上角处 LED 指示灯可查看充电状态。

指示灯介绍

指示灯状态	功能说明
不亮	关机 / 正常状态
绿灯常亮	电量充满
红灯常亮	处于初始化过程 / 充电中(未充满)
红灯快闪	有来电
红灯慢闪	收到新的语音留言 / 未接电话 / 文本信息

Regulatory Notices

Operating Ambient Temperatures

- Operating temperature: +32 to 104°F (0 to 40°C)
- Relative humidity: 5% to 90%, noncondensing
- Storage temperature: -22 to +160°F (-30 to +70°C)

Warranty

Our product warranty is limited only to the unit itself, when used normally in accordance with the operating instructions and the system environment. We are not liable for damage or loss resulting from the use of this product, or for any claim from a third party. We are not liable for problems with Yealink device arising from the use of this product; we are not liable for financial damages, lost profits, claims from third parties, etc., arising from the use of this product.

Explanation of the symbols

- DC symbol
is the DC voltage symbol.
- WEEE Warning symbol

To avoid the potential effects on the environment and human health as a result of the presence of hazardous substances in electrical and electronic equipment, and users of electrical and electronic equipment should understand the meaning of the crossed-out wheeled bin symbol. Do not dispose of WEEE as unsorted municipal waste and have to collect such WEEE separately.

Restriction of Hazardous Substances Directive (RoHS)

This device complies with the requirements of the EU RoHS Directive. Statements of compliance can be obtained by contacting support@yealink.com.

Safety Instructions

Save these instructions. Read these safety instructions before use!

General Requirements

- Before you install and use the device, read the safety instructions carefully and observe the situation during operation.
- During the process of storage, transportation, and operation, please always keep the device dry and clean, avoid collision and crash.
- Please attempt not to dismantle the device by yourself. In case of any discrepancy, please contact the appointed maintenance center for repair.
- Please refer to the relevant laws and statutes while using the device. Legal rights of others should be respected as well.

Environmental Requirements

- Place the device at a well-ventilated place. Do not expose the device under direct sunlight.
- Keep the device dry and free of dusts.
- Do not place the device on or near any inflammable or fire-vulnerable object, such as rubber-made materials.
- Keep the device away from any heat source or bare fire, such as a candle or an electric heater.

Operating Requirements

- Do not let a child operate the device without guidance.
- Do not let a child play with the device or any accessory in case of accidental swallowing.
- Please use the accessories provided or authorized by the manufacturer only.
- The power supply of the device shall meet the requirements of the input voltage of the device. Please use the provided surge protection power socket only.
- Before plugging or unplugging any cable, make sure that your hands are completely dry.
- Do not spill liquid of any kind on the product or use the equipment near water, for example, near a bathtub, washbowl, kitchen sink, wet basement or near a swimming pool.
- During a thunderstorm, stop using the device and disconnect it from the power supply. Unplug the power plug and the Asymmetric Digital Subscriber Line (ADSL) twisted pair (the radio frequency cable) to avoid lightning strikes.
- If the device is left unused for a rather long time, disconnect it from the power supply and unplug the power plug.
- When there is smoke emitted from the device, or some abnormal noise or smell, disconnect the device from the power supply, and unplug the power plug immediately.
- Contact the specified maintenance center for repair.
- Do not insert any object into equipment slots that is not part of the product or auxiliary product.
- Before connecting a cable, connect the grounding cable of the device first. Do not disconnect the grounding cable until you disconnect all other cables.

Battery Requirements

- Do not immerse the battery into water, which could short-circuit and damage the battery.
- Do not expose the battery to an open flame or leave the battery where it could be subjected to extremely high temperatures, which could cause the battery to explode.
- Do power the handset off before removing the battery.

- Do not try to use the battery for the power supply of any device other than this handset.
- Do not open or mutilate the battery, released electrolyte is corrosive and may cause damage to your eyes or skin.
- Use only the rechargeable battery pack delivered with the handset or those rechargeable battery packs expressly recommended by Yealink.
- Defective or exhausted battery should never be disposed of as municipal waste. Return old battery to the battery supplier, a licensed battery dealer or a designated collection facility.



Cleaning Requirements

- Before cleaning the device, disconnect it from the power supply.
- Use a piece of soft, dry and anti-static cloth to clean the device.
- Keep the power plug clean and dry.

Troubleshooting

The unit cannot supply power to Yealink device.

There is a bad connection with the plug.

1. Clean the plug with a dry cloth.
2. Connect it to another wall outlet.
3. The usage environment is out of operating temperature range.

1. Use in the operating temperature range.

The cable between the unit and the Yealink device is connected incorrectly.

1. Connect the cable correctly.
You cannot connect the cable properly.
1. You may have connected a wrong Yealink device.
2. Use the correct power supply.

Some dust, etc., may be in the port.

1. Clean the port.

Contact your dealer or authorized service facility for any further questions.

FCC Statement

This device complies with part 15 of the FCC Rules. Operation is subject to the following two conditions: (1) This device may not cause harmful interference, and (2) this device must accept any interference received, including interference that may cause undesired operation. Any changes or modifications not expressly approved by the party responsible for compliance could void the user's authority to operate the equipment.

Note: This equipment has been tested and found to comply with the limits for a Class B digital device, pursuant to part 15 of the FCC Rules. These limits are designed to provide reasonable protection against harmful interference in a residential installation. This equipment generates, uses, and can radiate radio frequency energy and, if not installed and used in accordance with the instructions, may cause harmful interference to radio communications. However, there is no guarantee that interference will not occur in a particular installation. If this equipment does cause harmful interference to radio or television reception, which can be determined by turning the equipment off and on, the user is encouraged to try to correct the interference by one or more of the following measures:

- Reorient or relocate the receiving antenna.
- Increase the separation between the equipment and receiver.
- Connect the equipment into an outlet on a circuit different from that to which the receiver is connected.
- Consult the dealer or an experienced radio/TV technician for help.

ISED WARNING:

This device complies with Innovation, Science and Economic Development Canada licence-exempt RSS standard(s). Operation is subject to the following two conditions: (1) this device may not cause interference, and (2) this device must accept any interference, including interference that may cause undesired operation of the device.

Le présent appareil est conforme aux CNR d'Industrie Canada applicables aux appareils radio exempts de licence. L'exploitation est soumise aux deux conditions suivantes : (1) l'appareil ne doit pas produire de brouillage, et (2) l'utilisateur de l'appareil doit accepter tout brouillage radioélectrique subi, même si le brouillage est susceptible d'en compromettre le fonctionnement.

Radiation Exposure Statement:

The device has been tested and complies with FCC/ISED SAR limits. For body-worn operation, this IP Phone should be used with an accessory designed for this product or with an accessory that contains no metal and positions the handset at least 5mm from the body to meet FCC/ISED RF exposure guidelines. Failure to comply with these restrictions may result in a violation of RF exposure guidelines.

L'appareil a été testé et est conforme aux limites DAS de la FCC/ISED. Pour une utilisation sur le corps, ce téléphone IP doit être utilisé avec un accessoire conçu pour ce produit ou avec un accessoire qui ne contient pas de métal et qui place le combiné à au moins 5 mm du corps pour respecter les directives d'exposition au RF de la FCC/ISED. Le non-respect de ces restrictions peut entraîner une violation des directives d'exposition au RF.

The device for operation in the band 5150-5250 MHz is only for indoor use to reduce the potential for harmful interference to co-channel mobile satellite systems, the dispositifs fonctionnant dans la bande 5150-5250 MHz sont réservés uniquement pour une utilisation à l'intérieur afin de réduire les risques de brouillage préjudiciable aux systèmes de satellites mobiles utilisant les mêmes canaux.

This Class B digital apparatus complies with Canadian ICES-003. Cet appareil numérique de la classe B est conforme à la norme NMB-003 du Canada.

Les communications effectuées au moyen de cet appareil ne sont pas nécessairement protégées des interceptions.

This device meets CS03 Part V.

This device meets the applicable Innovation, Science and Economic Development Canada technical specifications / Ce produit répond à la innovation, des sciences et de Développement économique Canada spécifications techniques applicables.

Contact Information

YEALINK NETWORK TECHNOLOGY CO., LTD.
No.686 Hu'an Rd, Huli District Xiamen City, Fujian, P.R.C
YEALINK (EUROPE) NETWORK TECHNOLOGY B.V.
Strawinskylaan 3127, Atrium Building, 8th floor, 1077ZX Amsterdam, The Netherlands
YEALINK (USA) NETWORK TECHNOLOGY CO., LTD.
999 Peachtree Street Suite 2300, Fulton, Atlanta, GA, 30309, USA
Made in China

YEALINK(XIAMEN) NETWORK TECHNOLOGY CO.,LTD.

Web: www.yealink.com
Copyright©2024 YEALINK(XIAMEN) NETWORK
TECHNOLOGY CO.,LTD.All rights reserved.

FCC part 68 Warning:

1.This equipment complies with Part 68 of the FCC rules and the requirements adopted by the ACTA. On the bottom of this equipment is a label that contains, among other information, a product identifier in the format US:AAAEQ#TXXXX. If requested, this number must be provided to the telephone company.

2.A plug and jack used to connect this equipment to the premises wiring and telephone network must comply with the applicable FCC Part 68 rules and requirements adopted by the ACTA. A compliant telephone cord and modular plug is provided with this product. It is designed to be connected to a compatible modular jack that is also compliant. See installation instructions for details.

3.If this equipment [US: TZLIPNANAX83] causes harm to the telephone network, the telephone company will notify you in advance that temporary discontinuance of service may be required. But if advance notice isn't practical, the telephone company will notify the customer as soon as possible. Also, you will be advised of your right to file a complaint with the FCC if you believe it is necessary.

4.The telephone company may make changes in its facilities, equipment, operations or procedures that could affect the operation of the equipment. If this happens the telephone company will provide advance notice in order for you to make necessary modifications to maintain uninterrupted service.

5.If trouble is experienced with this equipment [US: TZLIPNANAX83], for repair or warranty information, Service can be facilitated through our office at:

U.S. Agent Company name: 888VoIP / American Technologies, LLC

Address: 611 Jamison Rd Suite 1059 Elma NY 14059 USA

Tel: 716-714-8002

If the equipment is causing harm to the telephone network, the telephone company may request that you disconnect the equipment until the problem is resolved.

6.Please follow instructions for repairing if any (e.g. battery replacement section); otherwise do not alternate or repair any parts of device except specified. For repair procedures, follow the instructions outlined under the limited warranty.

7.Connection to party line service is subject to state tariffs. Contact the state public utility commission, public service commission or corporation commission for information.

8.If your home has specially wired alarm equipment connected to the telephone line, ensure the installation of this [P] does not disable your alarm equipment. If you have questions about what will disable alarm equipment, consult your telephone company or a qualified installer.

9.If the telephone company requests information on what equipment is connected to their lines, inform them of:

a)The ringer equivalence number [NAN]

b)The USOC jack required [N/A]

c)Facility Interface Codes ("FIC") [N/A]

d)Service Order Codes ("SOC") [N/A]

e)The FCC Registration Number [US: TZLIPNANAX83]

10.The REN is used to determine the number of devices that may be connected to a telephone line.

Excessive RENs on a telephone line may result in the devices not ringing in response to an incoming call. In most but not all areas, the sum of RENs should not exceed five (5.0). To be certain of the number of devices that may be connected to a line, as determined by the total RENs, contact the local telephone company. The REN for this product is part of the product identifier that has the format US:AAAEQ#TXXXX. The digits represented by ## are the REN without a decimal point. For this product the FCC Registration number is [US: TZLIPNANAX83] indicates E2 the REN would be NAN.

11.We suggest the customers use a surge arrester to protect the device.