

蓝牙自拍杆 使用手册

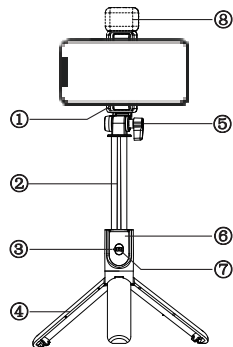

- ① 手机夹 ⑤ 锁紧装置
② 伸缩杆 ⑥ 蓝牙遥控器
③ 指示灯 ⑦ 拍照键
④ 三脚架 ⑧ 补光灯(选配)

自拍杆功能介绍

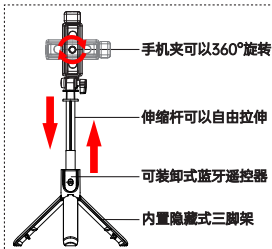

补光灯 (选配)

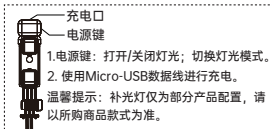

1. 电源键: 打开/关闭灯光; 切换灯光模式。
2. 使用Micro-USB数据线进行充电。

温馨提示: 补光灯仅为部分产品配置, 请以所购商品款式为准。

蓝牙遥控器的装回



蓝牙遥控使用步骤

第1步: 在手机上, 依次点击 设置 > 蓝牙, 并将手机蓝牙打开。
第2步: 长按拍照键 (约2秒) 直至指示灯闪烁后成功开机。

第3步: 当搜索到名为"Selfie"的蓝牙设备时, 点击并选择配对。

第4步: 打开相机APP, 按下拍照键即可拍摄照片或视频。

第5步: 长按拍照键 (约3秒) 直至指示灯熄灭后成功关机。

温馨提示: 此蓝牙遥控器兼容 Android 4.3, IOS 5.0及以上系统版本。

电池更换步骤

温馨提示: 本产品蓝牙遥控器含有两种型号, 请依据所购商品的样式选择对应的步骤更换电池。

1. 合盖式

借助工具 (塑料薄片, 指甲等) 从遥控器侧面的凹槽处将上壳取下, 取出电池进行更换, 随后将上壳对准位置后扣上即可。

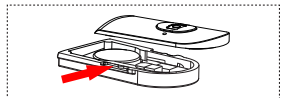

2. 滑盖式

按照图示箭头方向将后盖推开, 取出电池进行更换, 随后将后盖安装回去即可。

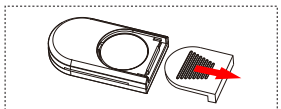

故障排除:

1. 蓝牙遥控器无法开机。
• 更换一块新电池。

2. 开机后蓝牙无法连接/无法正常工作。

• 移除手机上的蓝牙配对, 重启蓝牙遥控器后重新配对连接。

3. 安卓手机如果无法使用遥控器拍照。

I. 按下拍照键可以调节音量。

• 打开相机 App, 将"音量键功能"修改成默认或者拍照, 即可使用遥控器拍照。

II. 按下拍照键无法调节音量。

• 按照问题2的步骤重新进行配对连接。

注意事项:

1. 请勿将产品置于低温、潮湿环境保存。

2. 请勿将产品置于暴晒、火烤等高温环境。

3. 请勿在设备被限制的场所中使用, 避免违反公共秩序。

4. 更换电池时, 请将电池正负极朝外放置, 禁止将正负极反接。

5. 本产品含有电池, 请放置于婴幼儿触摸不到的地方, 防止小孩误吞。

感谢您的支持!

FC CE RoHS

合格证

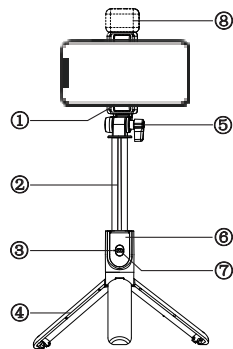

- ① Phone Clip ⑤ Fixing Knob
② Telescopic Shaft ⑥ Remote Control
③ Indicator Light ⑦ Shutter Button
④ Built-in Tripod ⑧ Fill Light (options)

Selfie Stick Introductions

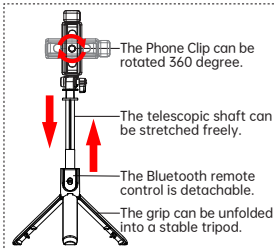

Fill Light (options)



1. Power Button: Turn on/off the light; Change the lighting mode.
2. Charging with Micro-USB Cable.

Reminder: The fill light is assembled for some models. Please refer to the model of the purchased product.

Detachable Remote

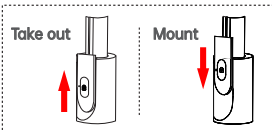

Quick Steps for Remote

Step 1: On your phone, tap Settings > Bluetooth, and then turn on the Bluetooth.

Step 2: Hold down the shutter button (about 2s) until indicator light starts flashing to turn on the remote control.

Step 3: Once the Bluetooth name of "Selfie" appears in the display, select it and tap "pair".

Step 4: Press the Shutter button to take photos.

Step 5: Hold down the shutter button (about 3s) until indicator light goes out to turn off the remote control.

Reminder: The remote control is compatible with Android 4.3, IOS 5.0 and later.

Replace the Battery

Reminder: The Bluetooth remote control has two types. Please follow the corresponding steps to replace the battery according to the type of your purchased product.

1. Covering Type

Force apart the upper shell at the groove on the side of the remote with fingernail, then replace the battery, and finally fasten the shell back.

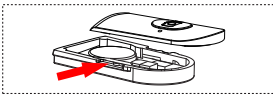

2. Sliding Type

Slide the back cover in the direction of the arrow as shown, then replace a new battery, and finally insert the cover back.

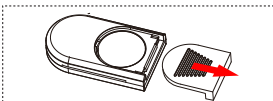

Troubleshooting:

1. If your phone is unable to connect to the remote.

• Delete the Bluetooth pairing on your phone, reboot the remote and start a new device search.

2. If your Android phone can't take photos when you press the shutter button.

• Open the camera App and change the "Volume button function" to "Default" or "Shutter".

Attention:

1. Don't store the product in icy or damp environment.

2. Don't place the product in the heat.

3. When replacing the battery, place the positive pole "+" of the battery outwards.

4. This product contains a battery, please place it out of the touch of infants to prevent children from swallowing it by mistake.

5. Don't use the product in restricted district to avoid violating public order.

Thanks for your support !

FC CE RoHS

Certificated



FCC Statement

This device complies with part 15 of the FCC Rules. Operation is subject to the following two conditions: (1) This device may not cause harmful interference, and (2) this device must accept any interference received, including interference that may cause undesired operation.

This equipment has been tested and found to comply with the limits for a Class B digital device, pursuant to part 15 of the FCC Rules. These limits are designed to provide reasonable protection against harmful interference in a residential installation. This equipment generates, uses and can radiate radio frequency energy and, if not installed and used in accordance with the instructions, may cause harmful interference to radio communications. However, there is no guarantee that interference will not occur in a particular installation. If this equipment does cause harmful interference to radio or television reception, which can be determined by turning the equipment off and on, the user is encouraged to try to correct the interference by one or more of the following measures:

- Reorient or relocate the receiving antenna.
- Increase the separation between the equipment and receiver.
- Connect the equipment into an outlet on a circuit different from that to which the receiver is connected.
- Consult the dealer or an experienced radio/TV technician for help.

Caution: Any changes or modifications to this device not explicitly approved by manufacturer could void your authority to operate this equipment.

RF Exposure Information

The device has been evaluated to meet general RF exposure requirement. The device can be used in portable exposure condition without restriction.