



Thank you for your purchase of our Gator ETX Soft Roll Up Tonneau Cover! We are committed to the quality of our products and the customer experience that comes along with them. Our experienced customer service team is ready to help quickly and easily over the phone, so please give us a call!

**SOMETHING DAMAGED? MISSING PARTS?**

**CALL US FIRST**

**GATOR ETX SOFT ROLL UP COVER**

**1-800-244-2826 (Hours: Monday - Friday, 8 AM - 5 PM CST)**

PLEASE HAVE PROOF OF PURCHASE AND SERIAL NUMBER AVAILABLE BEFORE CALLING, SERIAL NUMBER CAN BE FOUND ON THE FRONT ALUMINUM BAR ON THE DRIVER SIDE OF THE COVER

## PRODUCT FEEDBACK

We continuously work to improve our products and your valuable input is always appreciated. We're confident you're going to love your cover as much as we do, so please take the time to leave us a review by following the steps below:



1. Go to [amazon.com/review/create-review](https://amazon.com/review/create-review)
2. If prompted, log in to your account
3. Click on your Gator ETX purchase and leave a review



1. Go to [ebay.com/fdbk/leave\\_feedback](https://ebay.com/fdbk/leave_feedback)
2. If prompted, log in to your account
3. Click on your Gator ETX purchase and leave a review



1. Go to [walmart.com/account](https://walmart.com/account)
2. If prompted, log in to your account
3. On your Purchase History page, click on your Gator ETX purchase and leave a review

## WARRANTY REGISTRATION

**LIMITED LIFETIME WARRANTY / 10-YEAR TARP** - Please take the time to register your cover for our industry leading warranty and support. Our goal is to provide you with quality, innovative products and make owning and maintaining your cover as hassle free as possible. This information allows us to serve you better throughout the lifetime of the product.

To register your warranty, please visit: [www.gatorcovers.com/warranty](https://www.gatorcovers.com/warranty)

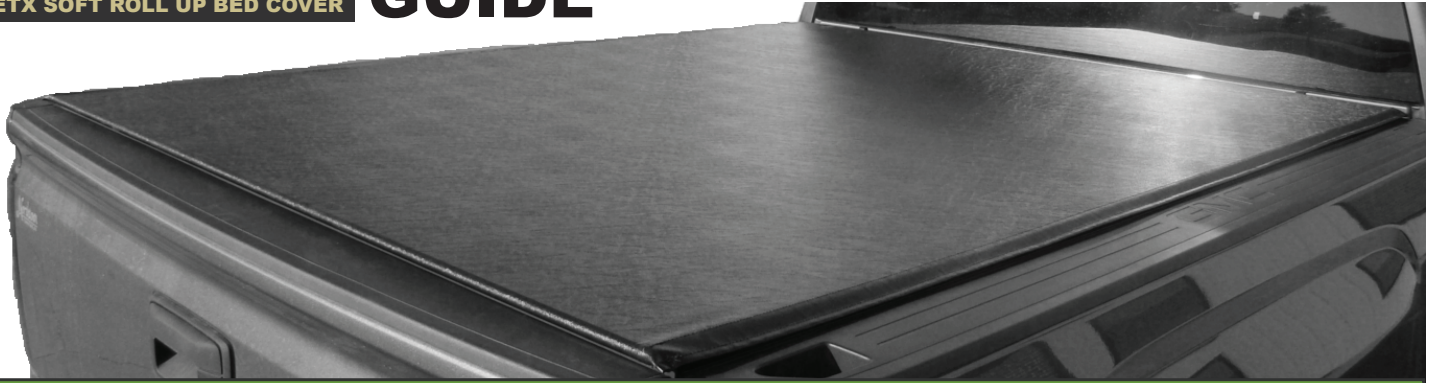

## COMPONENTS

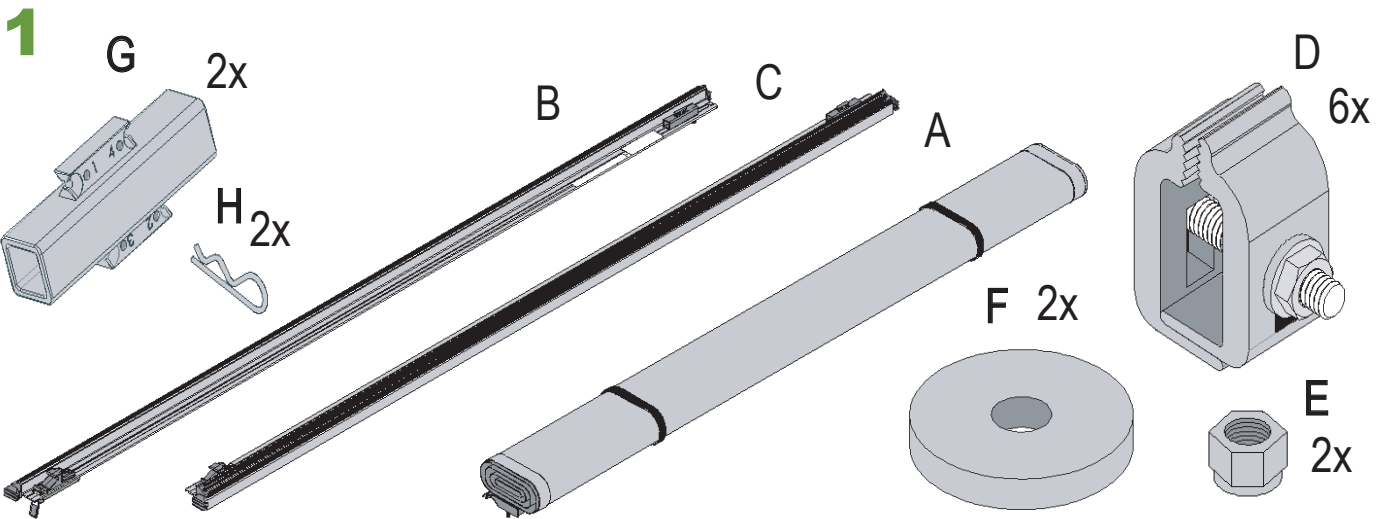

## TOOLS REQUIRED

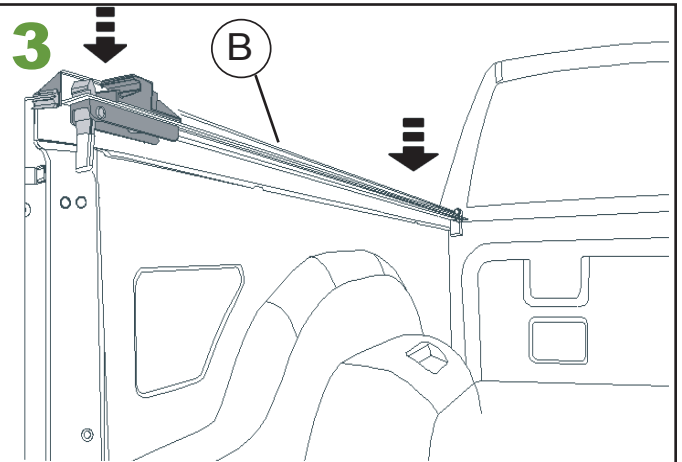
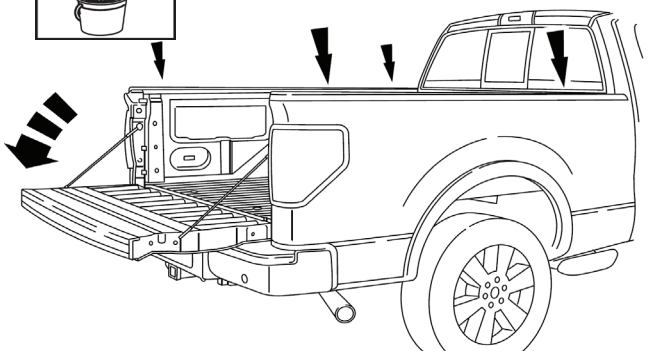
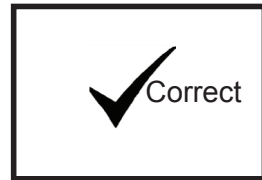

#### 4 With Tailgate Closed, Position Side Rail Compressing End Seals Equally Between Cab and Tailgate.

End Seal Compressed At Tailgate.

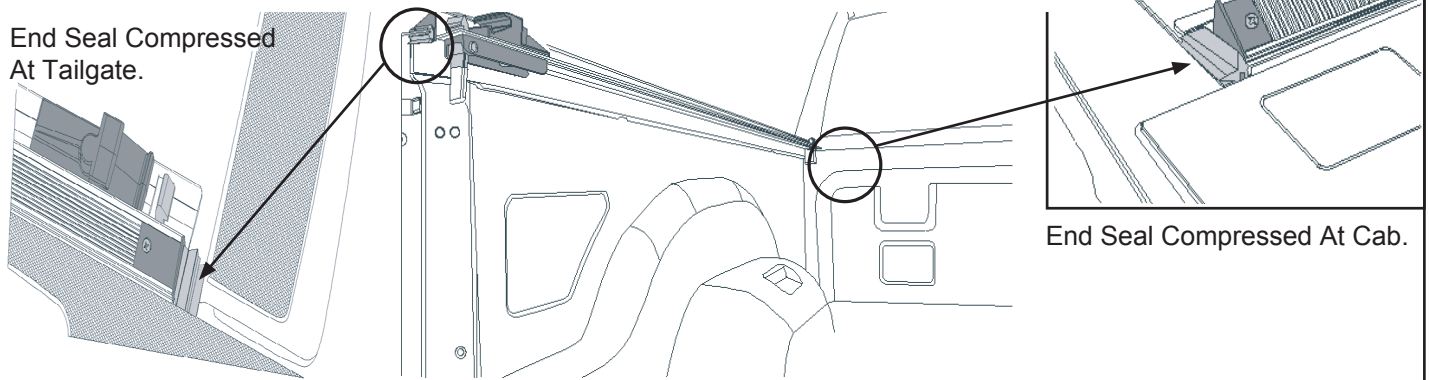

End Seal Compressed At Cab.

#### 5

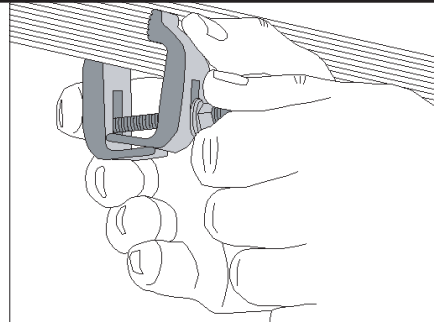
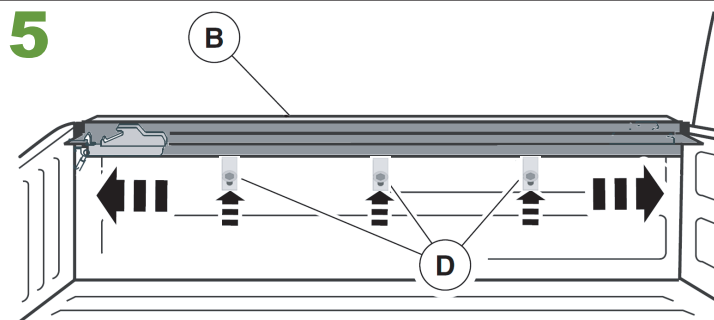

LEVEL

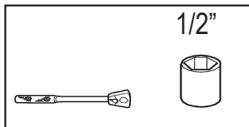
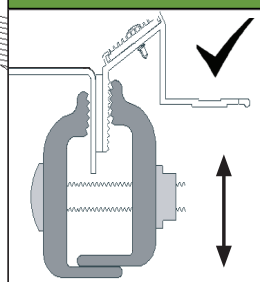

When installing clamps, finger tighten nut holding back side of clamp. Be sure the teeth of the clamp engage with the grooves of the side rail. Hold the clamp firmly with one hand to tighten the bolt. Avoid twisting or rotating the clamp during this process.



#### WARNING

Tighten clamps securely on side rails before driving vehicle.

#### 6 Repeat steps 3-5 on passenger side for item C. Proceed to step 7 when complete.

### SETTING TENSION ADJUSTMENT BLOCKS

#### 7 Cover tension is controlled by four position adjustable blocks. To start, place blocks in position shown below. With 4 on top and closest to front header. Secure blocks with hitchpin in #2 hole, this is the least amount of tension. (Position 4)

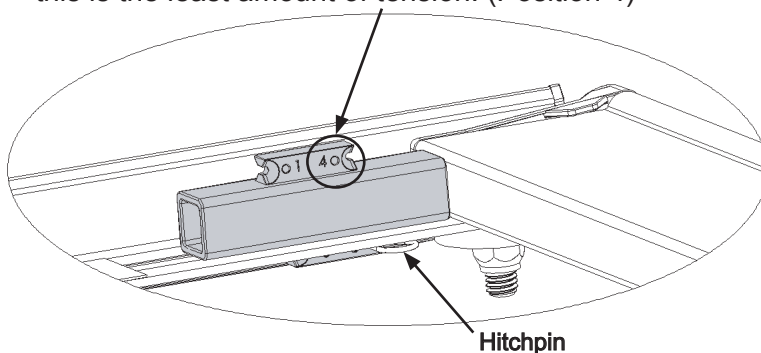

Hitchpin

#### Setting cover tension

1. Set cover tension during warmest part of the day.
2. Roll cover up to adjustable block.
3. Pull Hitchpin and rotate blocks to the next position needed. Replace Hitchpin. **(Driver and passenger blocks must always be in the same position.)**
4. Close cover and re-check adjustment. Repeat until satisfactory tension has been achieved.

Position 1  
Maximum

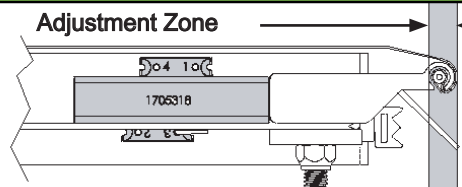

Position 2

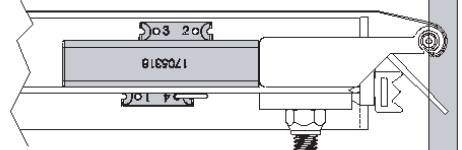

Position 3

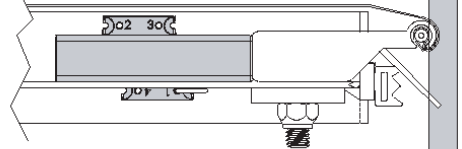

Position 4  
Minimum

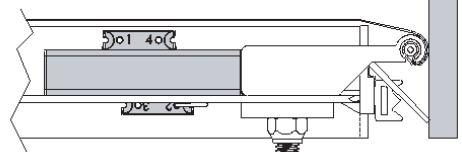

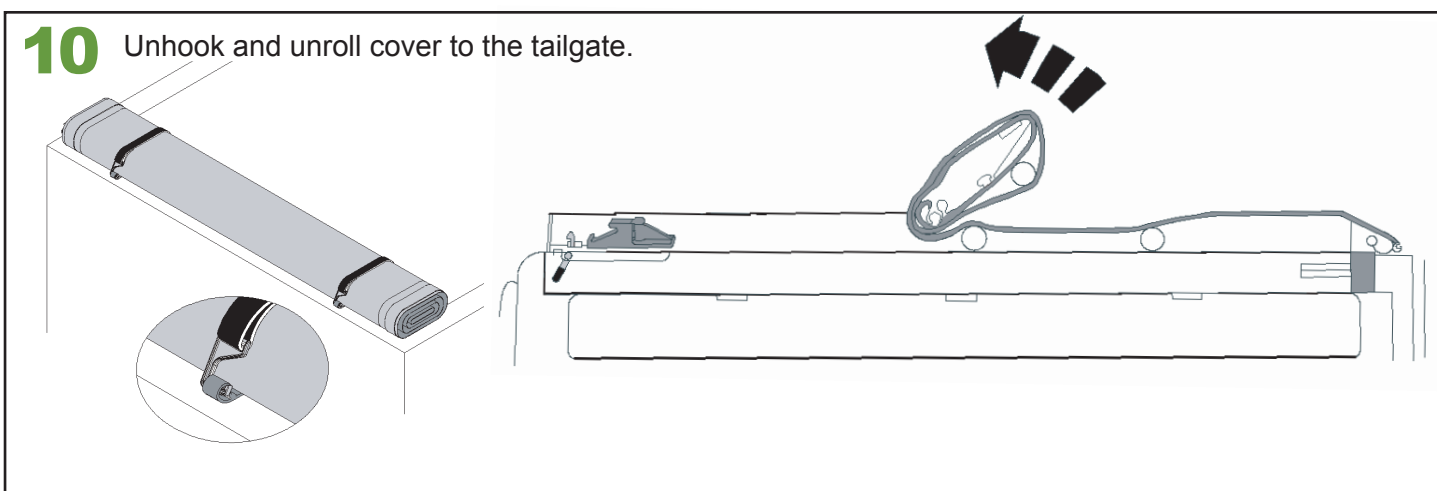
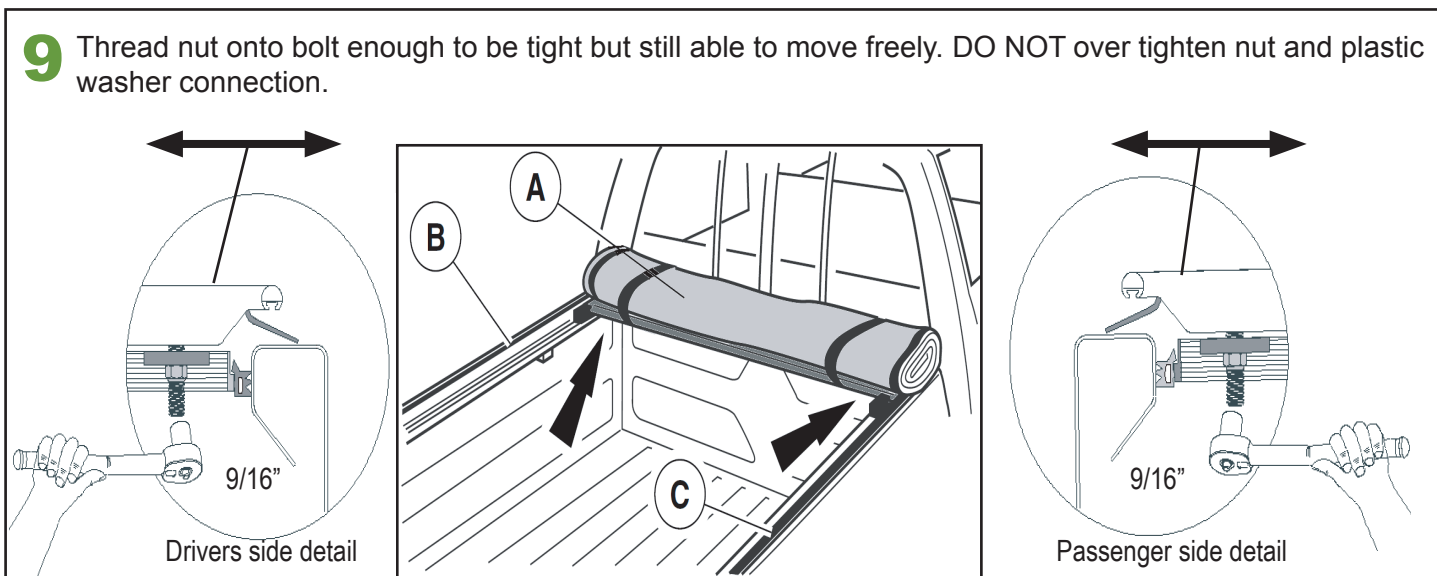
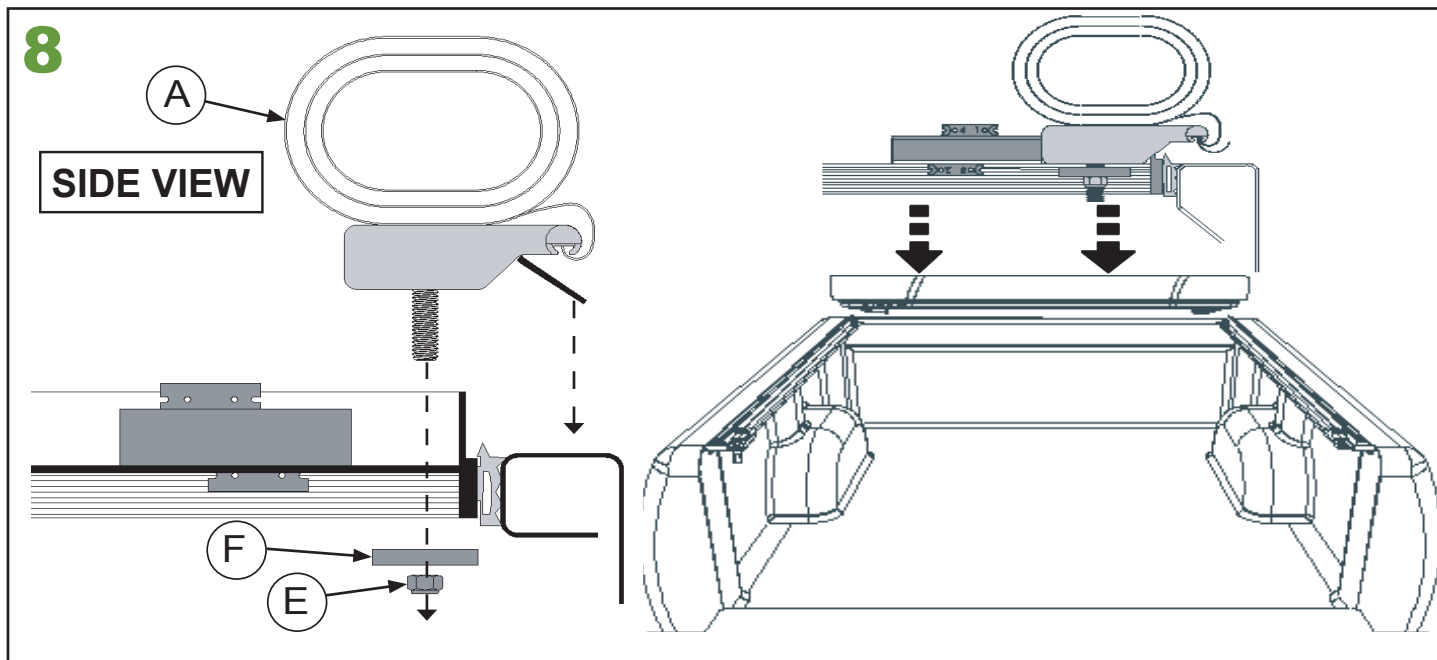

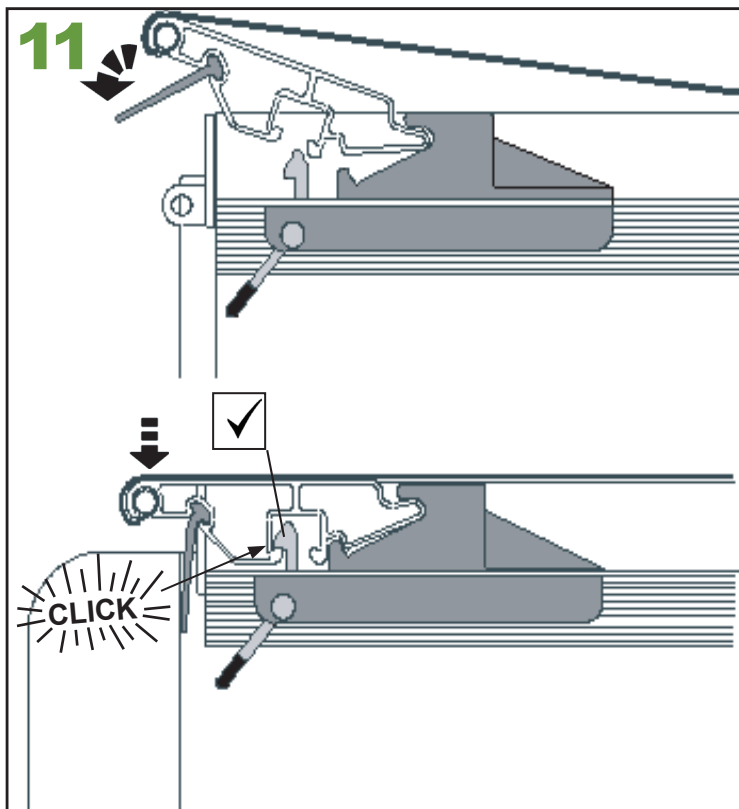

**12**

**NOTE:** Preferred method to close cover. Roll cover closed then close tailgate. Seal will be inside the tailgate. If tailgate has a key lock, truck bed cover is secured until tailgate is unlocked and opened.

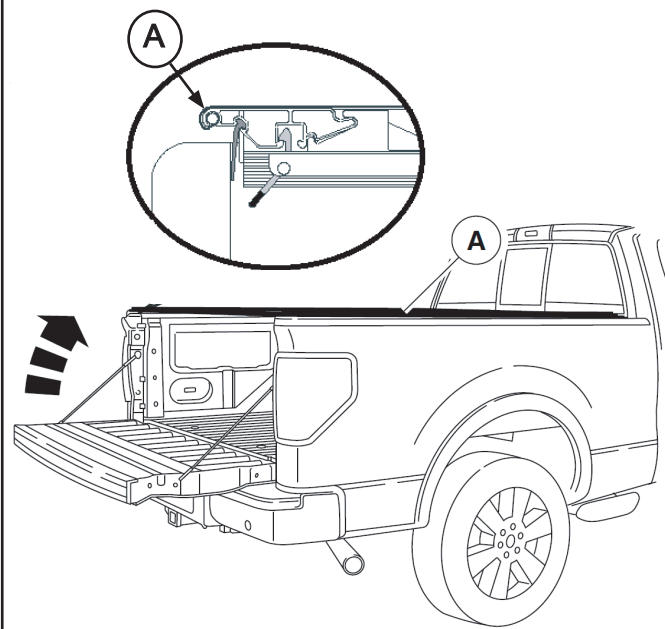

**13**

**NOTE:** Secure hook fastener and loop fastener by pressing down along entire length of both side rails before driving vehicle. This will prevent wind lifting the cover and causing damage.

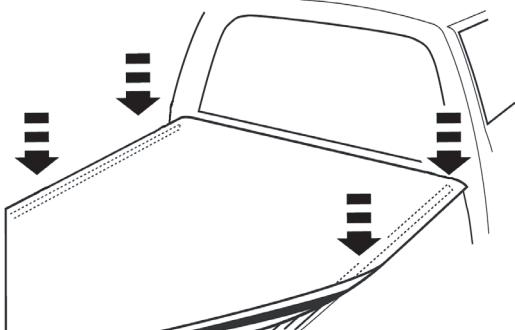

**14**

To unlatch Pull Toggle.

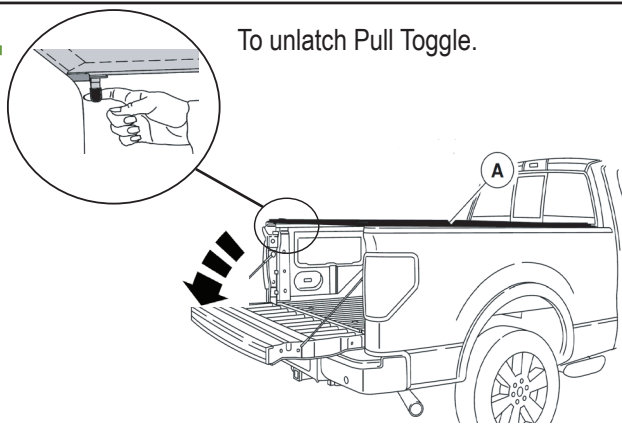

**15**

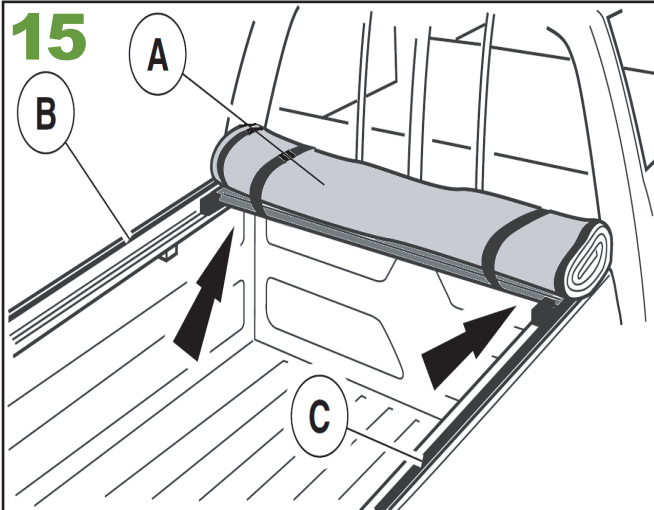

## CAUTION

ROLL COVER TIGHT AND SECURE BOTH RETAINER STRAPS. **DO NOT** STOW COVER AGAINST CAB WINDOW.

To stow cover open roll cover to the front. Secure both hooks **DO NOT** stow cover against cab window.



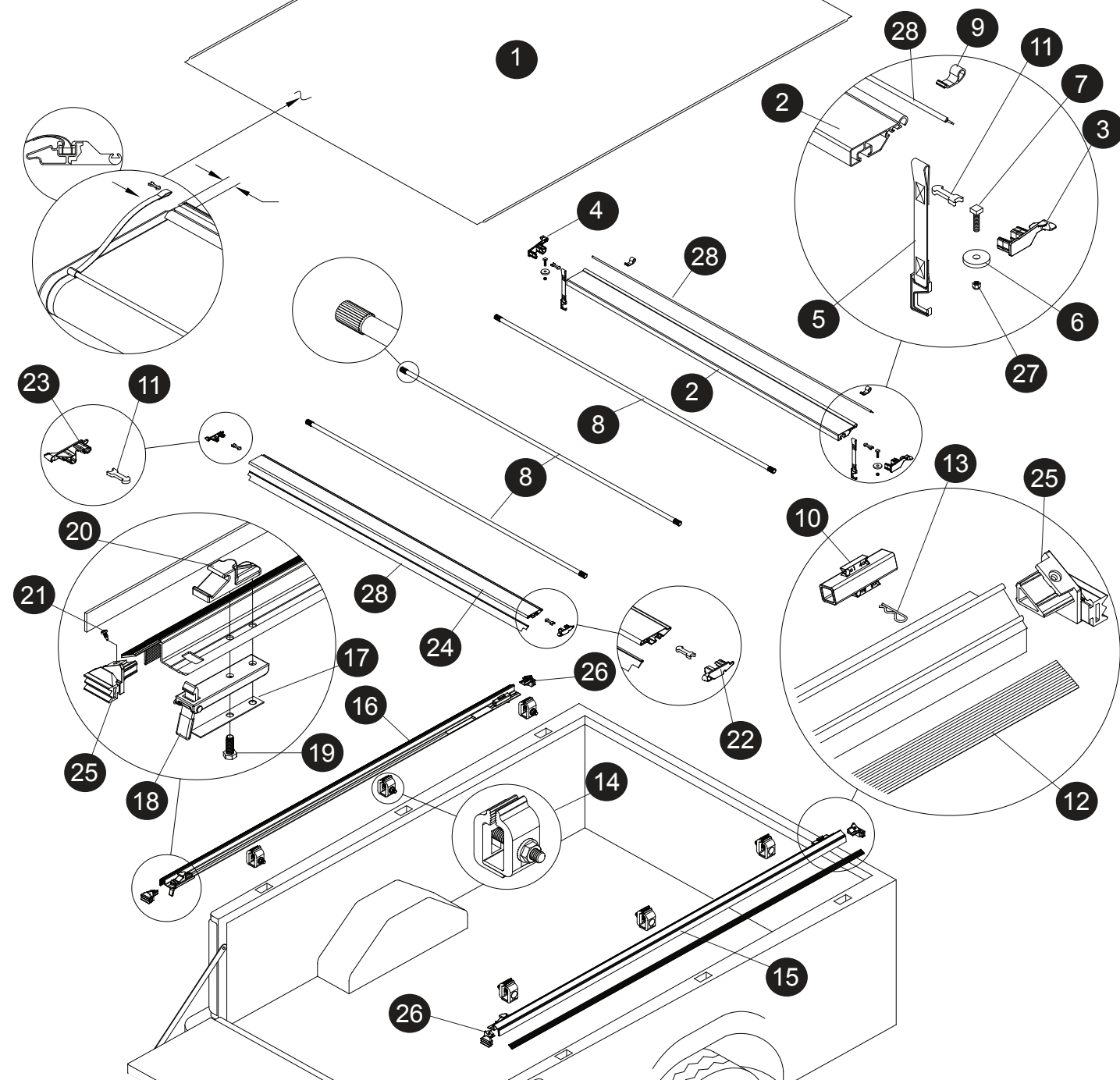

## REPLACEMENT PARTS

1	*	Replacement Cover	12	*	Hook Strip	23	1705404	Rear Header End Plug LH
2	*	Front Header	13	1703332	Hitch Pin	24	*	Rear Header
3	1705310	Front Header End Plug RH	14	1705234	Clamp Assembly (6)	25	1117958	Side Rail End Plug Assy LH
4	1705311	Front Header End Plug LH	15	*	Side Rail, Passenger's Side	26	1117959	Side Rail End Plug Assy RH
5	*	Retainer Strap	16	*	Side Rail, Driver's Side	27	1701580	Hex Nut Full Nylon Lock
6	1115745	Plastic Washer	17	1114773	Flat Spring	28	*	Extruded Header Seal
7	1703455	Square Head Cap Screw	18	1704213	Latch Assembled			
8	*	Bow Assembly	19	1703455	Cap Screw			
9	1705192	Retainer Loop	20	1705336	Header Stop			
10	1705318	Tension Adjustment Block	21	1703690	Self Drill Screw			
11	1705364	Header Insert Retainer Clip	22	1705405	Rear Header End Plug RH			

\* Please specify length or make and model of vehicle.



**LIMITED LIFETIME WARRANTY:** The full hardware kit including rails, clamps and bows carries a lifetime warranty, while the fabric cover is warranted for 10 years. Warranty is to the original consumer purchaser and is not transferrable. Gator Covers warrants this product to be free of defects in material and workmanship at the time of purchase by the original retail consumer. Gator Covers disclaim any other warranties, express or implied, including the warranty of fitness for a particular purpose or an intended use. If the product is found to be defective, Gator Covers may replace or repair the product at our option, when the product is returned prepaid, with the proof of purchase. Alteration to, improper installation, or misuse of this product voids the warranty. Gator Covers liability is limited to repair or replacement of products found to be defective, and specifically excludes liability for any incidental or consequential loss or damage

## WARNING

**Tighten clamps securely on side rails before driving vehicle, to prevent cover from blowing off.**

## SAFETY INSTRUCTIONS

1. Do not place objects on or against cover or framework.
2. Do not tie cargo to cover framework.
3. **Never** allow children or pets to occupy pickup box while cover is closed.
4. Cover is not airtight. Special care is required to keep cargo clean and dry.
5. Fabric cover won't prevent theft of contents inside truck box.
6. Cover must be rolled fully open and secured with retainer straps when towing vehicle backwards.
7. Opened cover must be secured with both retainer straps when driving vehicle.
8. Cover must be rolled fully open and secured with retainer straps if any part of the truck bed cover is worn or damaged.

## OWNER/USER RESPONSIBILITIES

It is the responsibility of the owner/user to read this manual and comply with the operating procedures. The owner/user is also responsible for inspecting their truck bed cover system, and for having parts repaired or replaced when worn or damaged.

Failure to follow safety instructions and warning labels could result in failure of your cover system and/or personal injury.

## MESSAGES TO INSTALLER

- Always wear safety glasses and/or other necessary protective equipment when installing your truck bed cover system.
- These instructions are complete for most pickup models. Additional instructions are included, if required for your pickup. Please read entire manual before installing your truck bed cover system.

## COVER MAINTENANCE

Vinyl cover can be hand washed with mild soap and water or cleaned in a car wash. Thoroughly rinse cover to remove any soap residue. Cover can be treated with any vinyl protectant made for truck bed covers. **Never use any vinyl conditioners (ie, Armor All®) that contain silicone, petroleum, or citrus based products on your truck bed cover as they may crack and shrink the vinyl.**

## DIRECT ALL WARRANTY CLAIMS TO:

### Gator Tonneau Covers

2303 SE 17th Street, Suite 102, Ocala, FL 34471

1-800-244-2826 or [etxsoftroll@gatorcovers.com](mailto:etxsoftroll@gatorcovers.com)

Hours: Monday – Friday, 8 AM - 5 PM CST