

Contact Us

For any inquiries, feel free to contact us. We will respond as soon as possible.

E-mail: customservicare@outlook.com

Tel: 1-888-880-0815

Manufacturer: Shenzhen Efercro Electronic Technology Co., Ltd

Address: Room 901, Block E, Building 1, Section 1, Chuangzhi Yuncheng, Liuxian Avenue, Xili Community, Xili Street, Nanshan District, Shenzhen



USER GUIDE

A10 PRO

L6 Bluetooth speaker charging dock

AUMI AI OS

Start something wonderful

L6 Bluetooth speaker charging dock

Tablet 10.1

Please read the manual before using this product, and save it for future use.

FUNCTION OVERVIEW

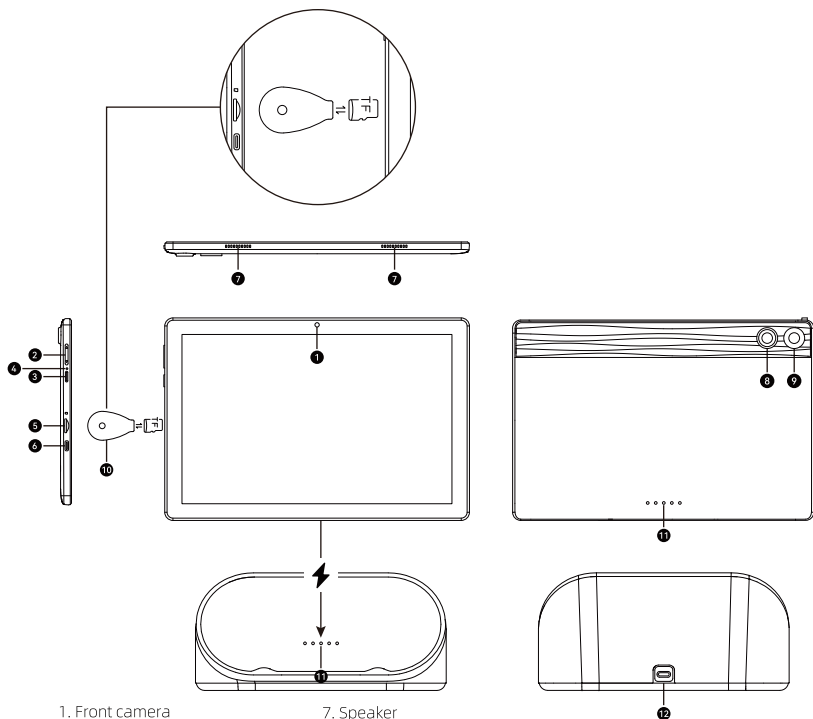

- | | |
|---------------------------|------------------------------|
| 1. Front camera | 7. Speaker |
| 2. Volume+/Volume- | 8. Dynamic Halo / Flashlight |
| 3. Power on/off | 9. Rear camera |
| 4. Reset hole | 10. Card ejector |
| 5. Mini microSD card slot | 11. Pogo pin (Keep clean) |
| 6. Type-C | 12. Type-C (5V=4A) |

Operation guide for Bluetooth speaker Charging dock:

(1) Connect the TYPE-C port of the Bluetooth speaker Charging dock device to the standard adapter and cable (do not use adapters of other specifications at will). After being powered on, the device will automatically turn on and have a prompt sound, and the lights around the bottom of the device will remain constantly on.

(2) Place the tablet at the POGO pin position of the Bluetooth speaker Charging dock. Make sure the metal contact point on the back of the tablet aligns with the POGO pin position of the Bluetooth dock. After successful charging, the tablet will display the charging icon.

(3) Turn on the Bluetooth Settings of the tablet; When charging, the Bluetooth speaker Charging dock will automatically pair and connect with the tablet's Bluetooth. After a successful pairing, the device will emit a prompt sound. At this point, the device can be used as an external speaker.

Note: Please keep POGO (Figure 11) dry and free of foreign substances; In order to maintain good contact.

AI HALO

Setting · AI Halo Setting, "ON" the AI Halo to set lighting effects for charging, music, games, and notifications.



START

Power On/Off

1. Hold down the power button for 2-3 seconds to turn on the tablet. Select the language and follow the start up guide to set up the tablet.
2. Hold down the power button for 2 seconds to display power off and restart options on the screen. Click power off to turn off the tablet.
3. When the device is on, press and hold the power button for 10 seconds to force shutdown.

Reset

When the device is on, use a pin to press down the reset button to force restart.

Battery

1. A rechargeable Li-ion battery is installed in the tablet.
2. We suggest you drain the battery completely once a month if you only use your tablet occasionally.
3. DO NOT dispose of tablet in fire.
4. Charge the device fully each time to increase the battery life.
5. You can charge the tablet, even if the tablet has some power left in it, as the lithium battery does not need to be fully drained to charge.
6. Use a 5V 4A charger for tablet charging.

Sleep Mode

Simply press the power button once to switch the tablet into Sleep Mode when the tablet is ON; press again to wake it up.

Tip:

Go to Settings > Display > Screen timeout to adjust automatic sleep settings.

TROUBLESHOOTING

Q1. The tablet doesn't power on

- Reboot your tablet after charging for 30 minutes;
- Press the power button to see if the tablet is in Sleep Mode;
- Press and hold the power button for 10 seconds to turn off the tablet, then reboot it;
- Press the reset button with a pin to reset the tablet.

Q2. The tablet doesn't charge

- Charge the device for at least 30 minutes, in case the battery was completely drained;
- Make sure the USB cable is properly plugged into the charging port;
- Try another compatible USB cable and adapter.

Q3. Error message occurs during operation

- Uninstall the app displaying the error message, then download and install again;
- Press the reset button with a pin to reset the tablet.

Q4. The tablet cannot be detected by the computer

- Make sure the tablet is powered on;
- Try another USB cable;
- Try another USB port on the computer;
- Instead of Charge this device, choose Transfer files or Transfer photos (PTP) when connecting the tablet to the computer.

Q5. The tablet cannot connect to the Wi-Fi

- Make sure the Wi-Fi on your tablet is ON;
- Make sure you input the correct password;
- Reboot the router;
- Make sure there is no filter setting or device connection limitation in the settings of the router;
- Forget the current Wi-Fi, reset the router and connect to the network again.

Q6. The storage space of the tablet is not enough

- Delete the apps you don't use;
- Clear the app cache regularly;
- Insert a microSD card to expand the storage.

Android is a trademark of Google LLC.

FCC Statement

This equipment has been tested and found to comply with the limits for a Class B digital device, pursuant to part 15 of the FCC Rules. These limits are designed to provide reasonable protection against harmful interference in a residential installation. This equipment generates, uses and can radiate radio frequency energy and, if not installed and used in accordance with the instructions, may cause harmful interference to radio communications. However, there is no guarantee that interference will not occur in a particular installation. If this equipment does cause harmful interference to radio or television reception, which can be determined by turning the equipment off and on, the user is encouraged to try to correct the interference by one or more of the following measures:

- Reorient or relocate the receiving antenna.
- Increase the separation between the equipment and receiver.
- Connect the equipment into an outlet on a circuit different from that to which the receiver is connected.
- Consult the dealer or an experienced radio/TV technician for help.

Caution: Any changes or modifications to this device not explicitly approved by manufacturer could void your authority to operate this equipment.

This device complies with part 15 of the FCC Rules. Operation is subject to the following two conditions:

(1) This device may not cause harmful interference, and (2) this device must accept any interference received, including interference that may cause undesired operation.

RF Exposure Information (for tablet)

The device has been evaluated to meet general RF exposure requirement. The device can be used in portable exposure condition without restriction.

Specific Absorption Rate (SAR) information: (for tablet)

This PC meets the government's requirements for exposure to radio waves. The guidelines are based on standards that were developed by independent scientific organizations through periodic and thorough evaluation of scientific studies. The standards include a substantial safety margin designed to assure the safety of all persons regardless of age or health. FCC RF Exposure Information and Statement the SAR limit of USA (FCC) is 1.6 W/kg averaged over one gram of tissue. Device types: PC has also been tested against this SAR limit. This device was tested for typical body-worn operations with the back of the PC kept 0mm from the body. To maintain compliance with FCC RF exposure requirements, use accessories that maintain an 0mm separation distance between the user's body and the back of the PC. The use of belt clips, holsters and similar accessories should not contain metallic components in its assembly. The use of accessories that do not satisfy these requirements may not comply with FCC RF exposure requirements, and should be avoided.

RF Exposure Information(FCC ID: 2BHWJ-L6) (for Bluetooth speaker charging dock)

This equipment complies with FCC radiation exposure limits set forth for an uncontrolled environment. This equipment should be installed and operated with minimum distance 20cm between the radiator and your body.

DISCLAIMER

EN: We reserve the right to change product specifications and update this information from time to time.

DE: Wir behalten uns das Recht vor, Produktspezifikationen zu ändern und diese Informationen von Zeit zu Zeit zu aktualisieren.

⚠ WARNING

EN: This product contains a built-in lithium-ion battery. To ensure safe operation and prevent the risk of fire, explosion, or chemical leakage, do not attempt to remove the battery. Please contact customer service for any battery-related issues.

DE: Dieses Produkt enthält einen eingebauten Lithium-Ionen-Akku. Um einen sicheren Betrieb zu gewährleisten und die Gefahr eines Brandes, einer Explosion oder des Austretens von Chemikalien zu vermeiden, versuchen Sie nicht, die Batterie zu entfernen. Bei Problemen mit der Batterie wenden Sie sich bitte an den Kundendienst.

EC DECLARATION OF CONFORMITY



EN: Scan the QR code to view details.

DE: Scannen Sie den QR-Code, um Details anzuzeigen.



Operation Frequency 2.4G, 5G
Maximum Output Power <20 dBm

UK REP SEA&MEW ACCOUNTING LTD

Electric Avenue Vision 25, Enfield EN3 7GD,
London, United Kingdom, info@seamew.net

EC REP SEA&MEW CONSULTING GMBH

Mittenhuber Strasse 4, 92318 Neumarkt Germany,
Compliance.EU@outlook.com

Made in China