

Assembly Instructions

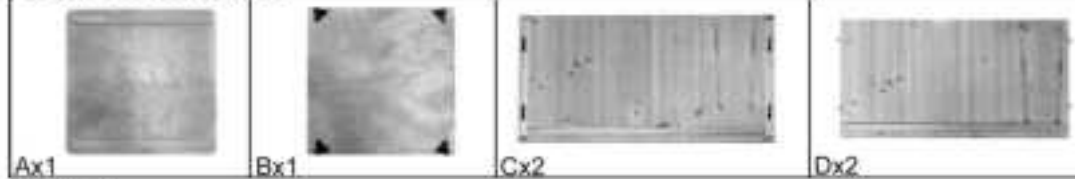

Components List



STEP 1

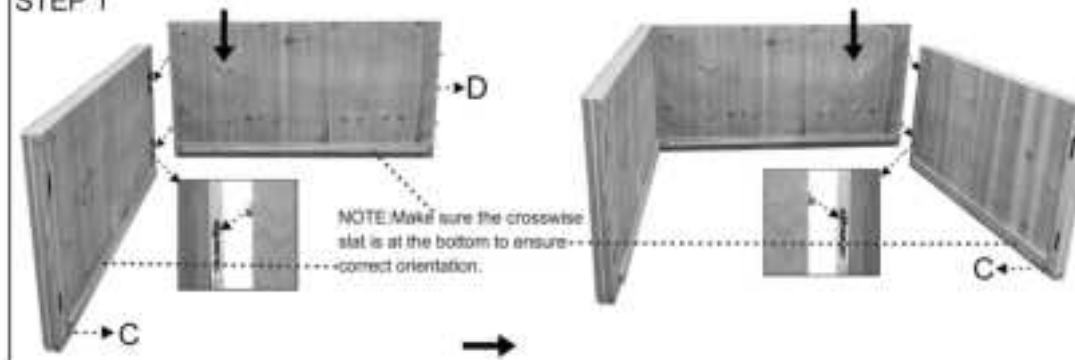

STEP 2

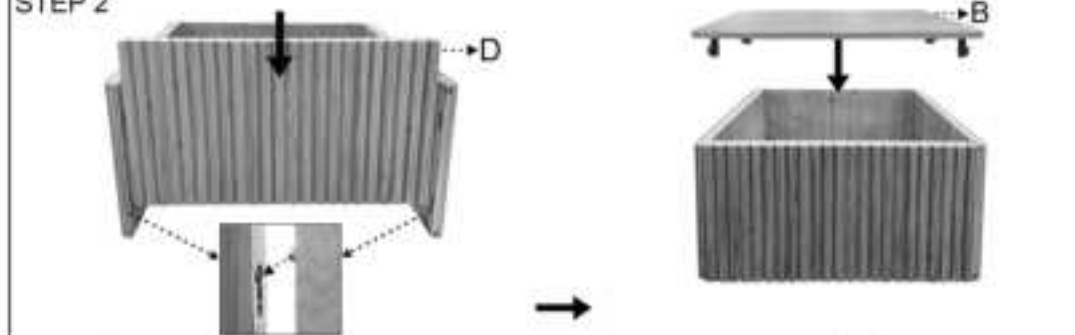

STEP 3

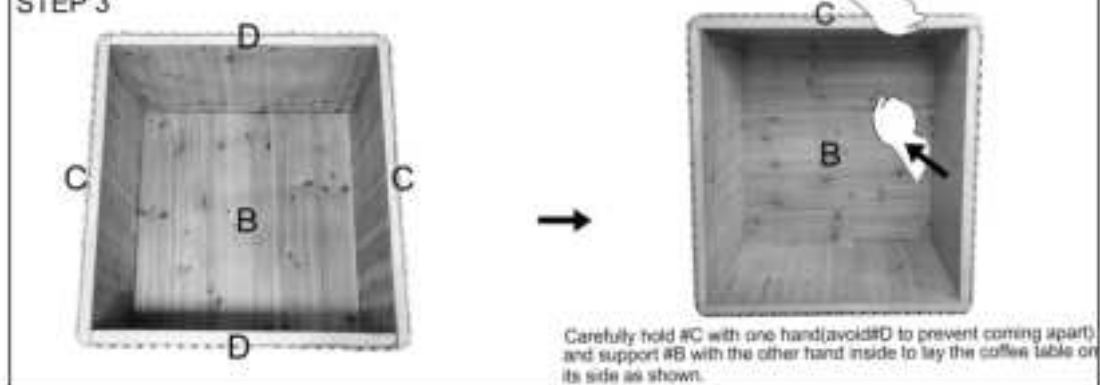

STEP 4



Keep supporting #B with one hand inside and then angle four locking tongues to 45 degrees to secure the adjacent wooden strips.

STEP 5

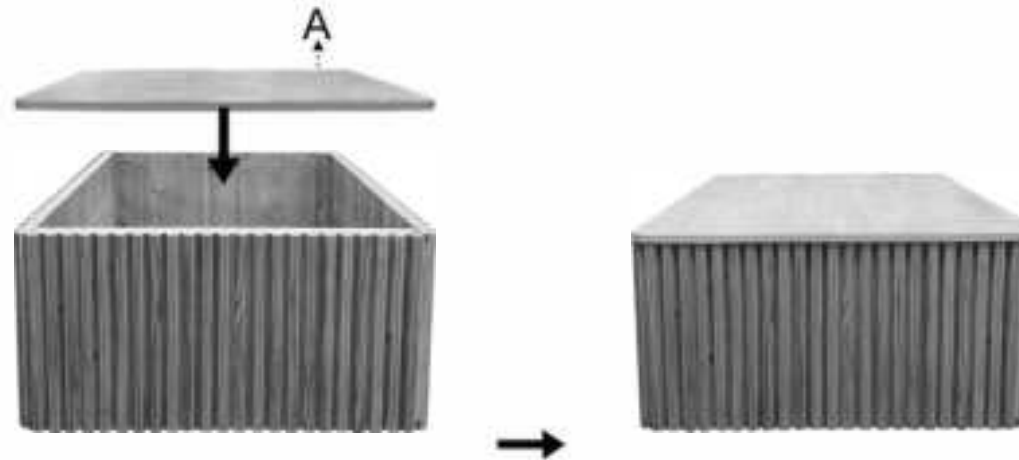

ATTENTION

If there is any missing, please kindly send us messages to let us know the name of missing part regarding to the first page of instructions. Please also provide us your full address so we can send replacement to you as soon as possible

We are concerned about each customer's experience, if there is any loss or damage, please contact us at any time, we will provide effective solutions.

Please attach your Order ID so that we can assist you better.