

FITS:

2018-Up Jeep Wrangler JL 4 Door





60-120 min



Cutting Not
Required



Drilling Not
Required

Fastener Size	Tightening Torque (ft-lbs)	Wrench Required		Allen Wrench Required	
■ 6mm	■ 7-8.5		■ 10mm		<input type="checkbox"/> 4mm
■ 8mm	■ 18-20		■ 13mm		<input type="checkbox"/> 5mm
■ 10mm	■ 35-40		■ 16mm		<input type="checkbox"/> 6mm
<input type="checkbox"/> 12mm	<input type="checkbox"/> 60-70		<input type="checkbox"/> 18mm		<input type="checkbox"/> 8mm

BEFORE INSTALLATION

REMOVE CONTENTS FROM BOX. VERIFY ALL PARTS ARE PRESENT
DEPEND ON THE PARTS LIST. READ INSTRUCTIONS CAREFULLY. BUMPER
IS HEAVY, ASSISTANCE IS HIGHLY RECOMMENDED TO AVOID POSSIBLE
INJURY OR DAMAGE TO THE VEHICLE.

Part List

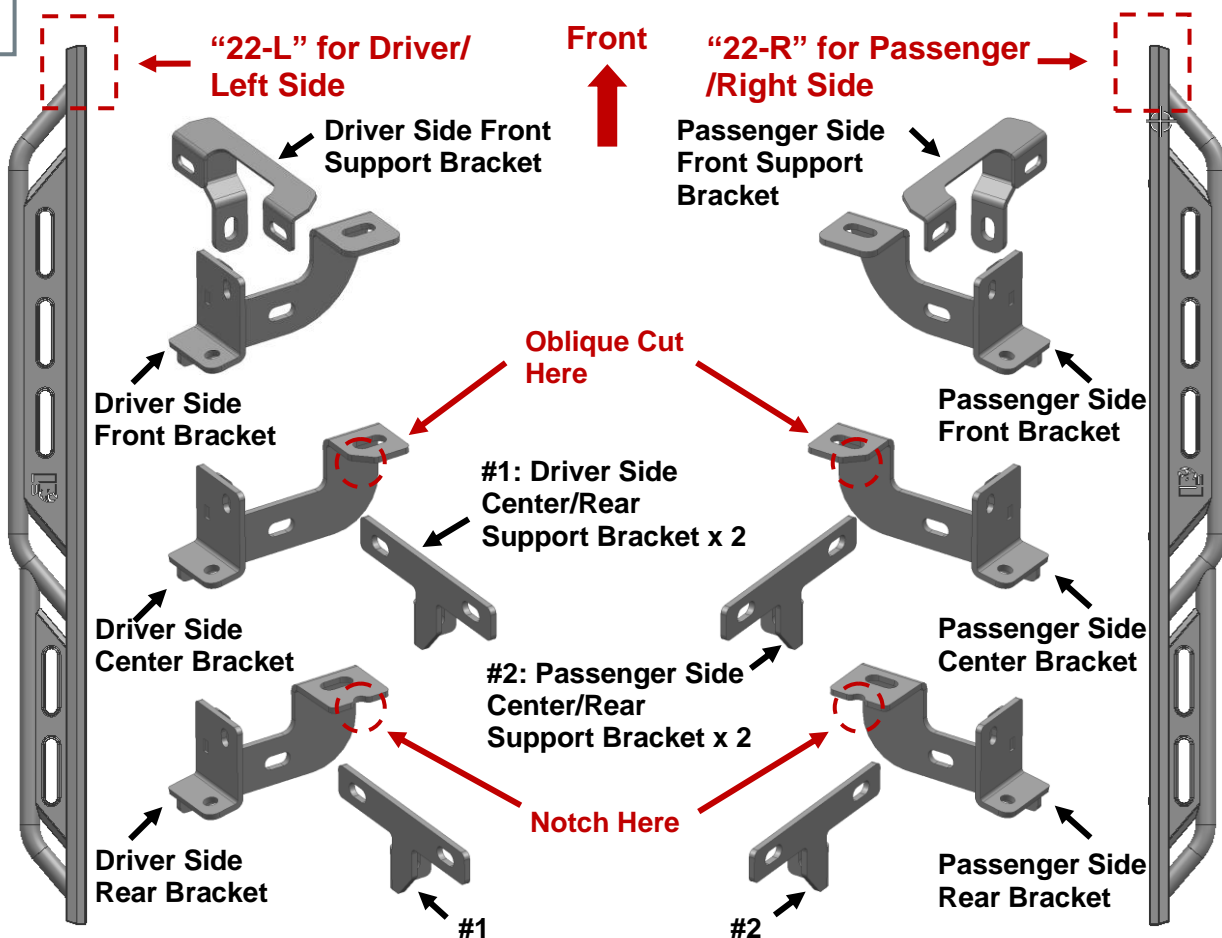

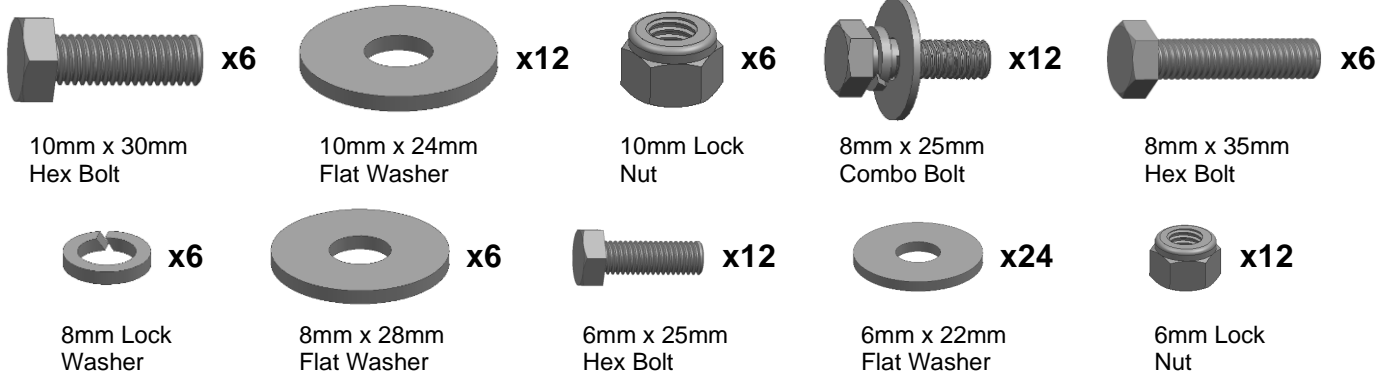

PLEASE NOTE THAT THE FOLLOWING PICTURES ARE BASED ON THE PASSENGER SIDE INSTALLATION

STEP 1

Start installation on the Passenger/Right front of the vehicle. Find the front threaded insert located in between the first pair of holes along the pinch weld, **(Fig 1)**.

FIG 1

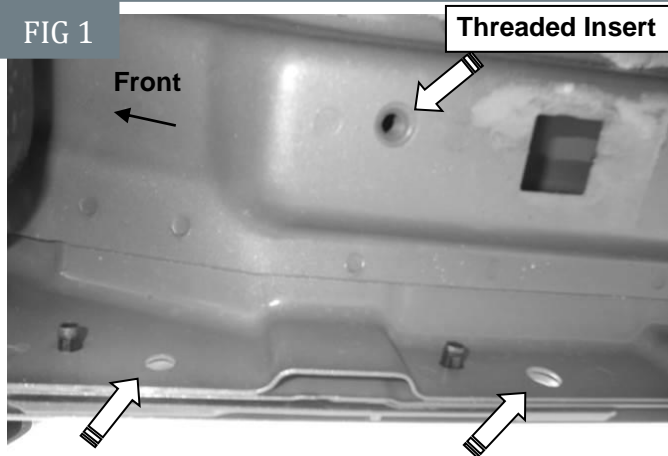

(Fig 1) Passenger/Right side front mounting location with threaded insert

STEP 2

Select the Passenger/Right Front Mounting Bracket. **IMPORTANT:** Please identify the **Front, Center, Rear Brackets** according to the illustration on **Part List**. Attach the Mounting Bracket to the threaded insert using (1) 8mm Hex Bolt, (1) 8mm Lock Washer and (1) 8mm Flat Washer, **(Fig 2)**. Do not tighten hardware.

FIG 2

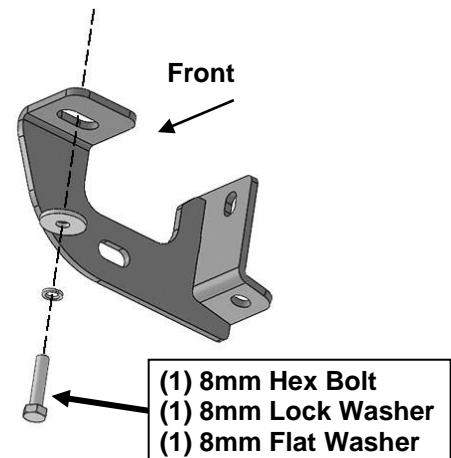

(Fig 2) Attach the Passenger/Right Front Mounting Bracket to the front location

STEP 3

Select the Passenger/Right Front Support Bracket. **IMPORTANT:** Please identify the Front, Center, Rear Support Brackets according to the illustration on Part List. Attach the Support Bracket to the pinch weld using (2) 6mm Hex Bolts, (4) 6mm Flat Washers and (2) 6mm Nylon Lock Nuts, (Fig 3). **NOTE: Insert Bolts from the outside of the pinch weld.** Attach the Support Bracket to the Mounting Bracket with (1) 10mm Hex Bolt, (2) 10mm Flat Washers and (1) 10mm Nylon Lock Nut, (Fig 4). Do not tighten hardware.

FIG 3

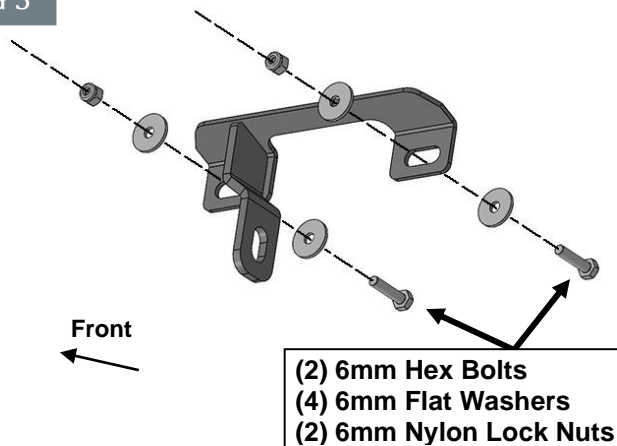

(Fig 3) Attach the Passenger/Right Front Support Bracket to the pinch trim

FIG 4

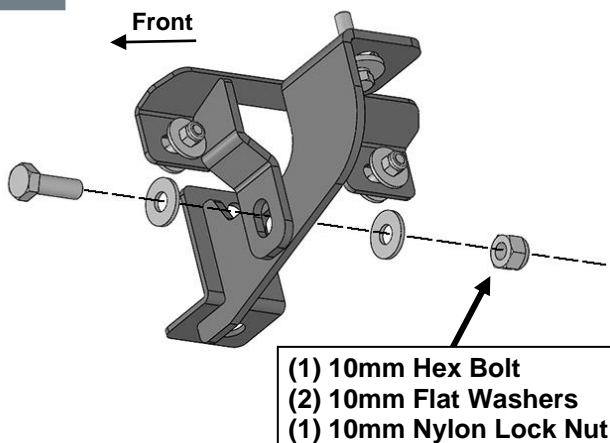

(Fig 4) Attach the Passenger/Right Front Support Bracket to the Mounting Bracket

STEP 4

Move to the center mounting location and locate the threaded insert and pair of holes in the pinch weld, (Fig 5). Repeat Steps 2 & 3 to attach the Passenger/Right Center Mounting Bracket (Fig 6) and (1) Passenger/Right Center/Rear Support Bracket (#2), (Fig 7). **IMPORTANT:** The Center Brackets has an Oblique Cut on its top surface. Please identify the Front, Center, Rear Support Brackets according to the illustration on Part List. Do not tighten hardware.

FIG 5

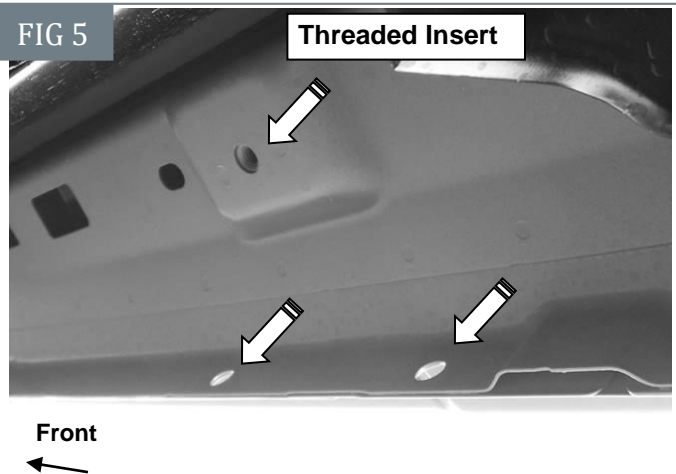

(Fig 5) Passenger/Right center mounting location

FIG 6

An Oblique Cut Here

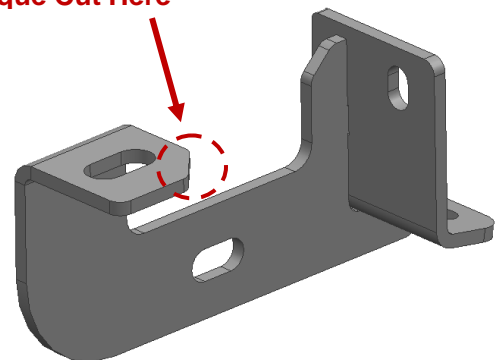

(Fig 6) Passenger/Right Center Mounting Bracket with an Oblique Cut on its top

FIG 7

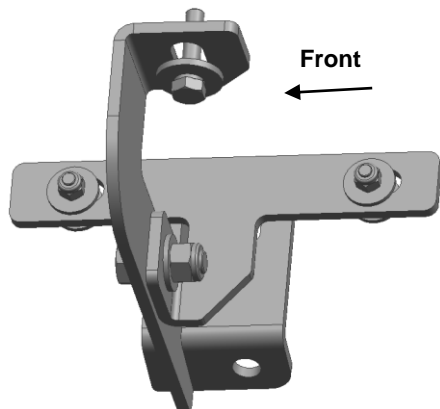

(Fig 7) Attach Passenger/Right Center Bracket and (1) Passenger/Right Center/Rear Support Bracket (#2) to the center location

FIG 9

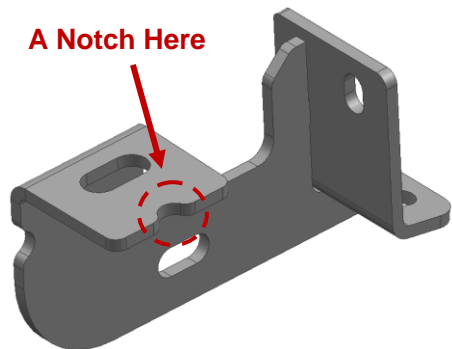

(Fig 9) Passenger/Right Rear Mounting Bracket with a **Notch** on its top

FIG 10

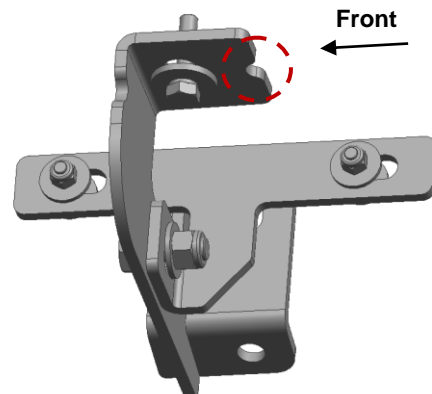

(Fig 10) Attach Passenger/Right Rear Bracket and (1) Passenger/Right Center/Rear Support Bracket (#2) to the rear location

STEP 5

Move to the rear mounting location on the rocker panel and locate the threaded insert and pair of holes in the pinch weld, (Fig 8). Repeat **Steps 2 & 3** to attach the Passenger/Right Rear Mounting Bracket (Fig 9) and (1) Center/Rear Support Bracket, (Fig 10). **IMPORTANT: The Rear Brackets has a Notch on its top. Please identify the Front, Center, Rear Support Brackets according to the illustration on Part List. Do not tighten hardware.**

FIG 8

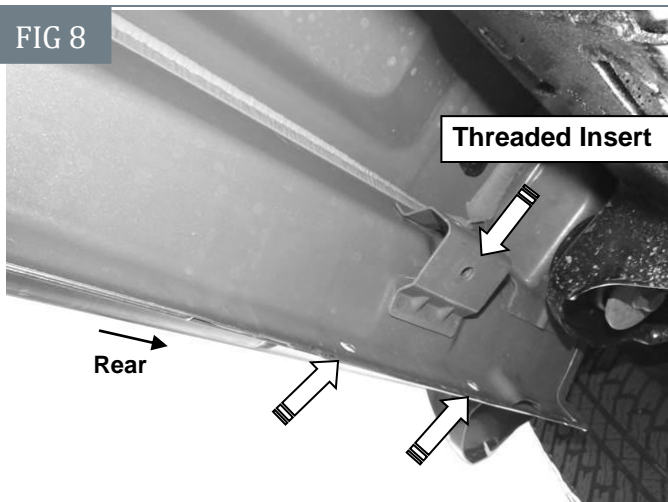

(Fig 8) Passenger/Right rear mounting location

STEP 6

Select the Passenger/Right Rocker Step.

NOTE: The Passenger/Right Rocker Step will have a "22-R" on the front. Attach the Rocker Step to the Mounting Brackets with (6) 8mm Combo Bolts, (Fig 11). **IMPORTANT: Do not slide Rocker Step on the Mounting Bracket cradles, or damage to the finish may result. Do not tighten hardware.**

FIG 11

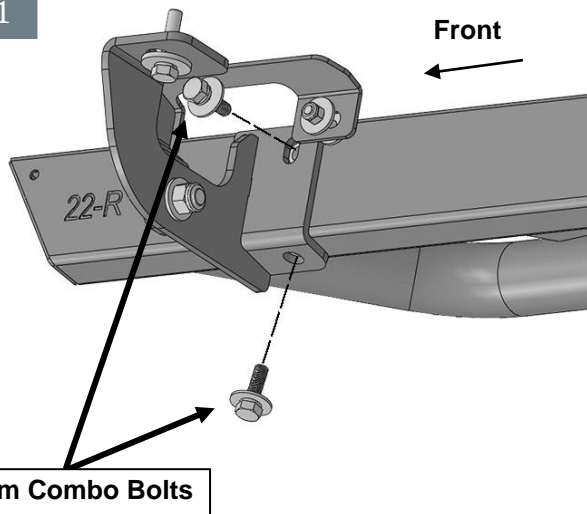

(Fig 11) Attach the Passenger/Right Rocker Step to the Mounting Brackets

STEP 7

Level and adjust the Rocker Step and tighten all hardware.

STEP 8

Repeat **Steps 1—7** to attach Driver/Left Rocker Step.

STEP 9

Do periodic inspections to the installation to make sure that all hardware is secure and tight.

Attention

To protect your investment, do not use any type of polish or wax that may contain abrasives that could damage the finish.

Mild soap may be used also to clean the Rocker step.