

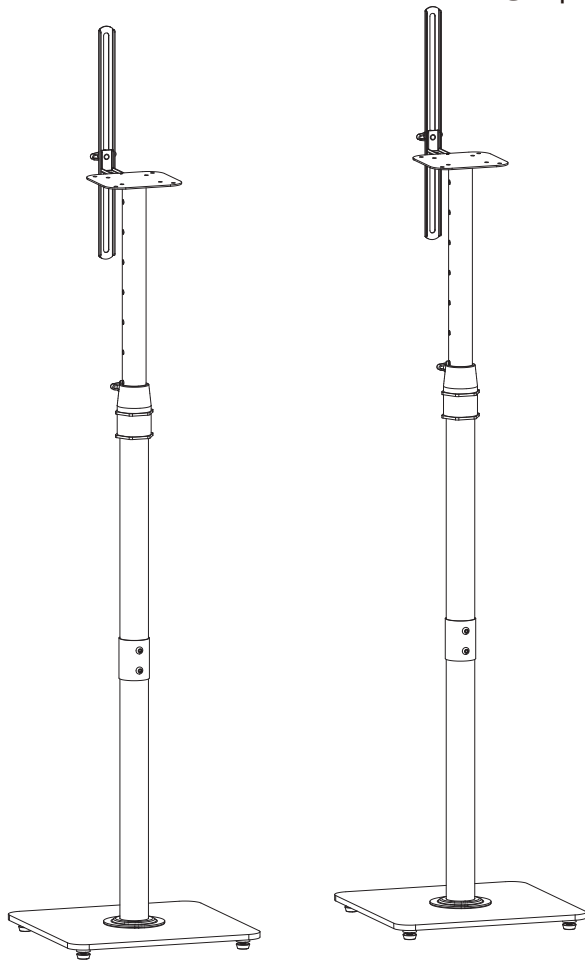

User Manual

SFM001

✉ after-sales@suptekmount.com



Warning



Please read the installation instruction carefully. We are not responsible for any damage or injury caused by improper assemble or use. Any question, please contact our customer service.

Parts

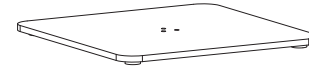

a-Base (2)



b-Lower column (2)



c-Upper column (2)



d-Crossbar (2)



e-Supporting bar (2)

Screw Package



A-Rubber feet (8)

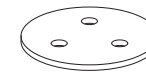

B-Pad for plate (2)



C-M6x20 (2)



D-ST4.2x13 (8)



E-Carpet nail (8)



F-M4x30 (2)



G-M6x25 (6)



H-M4x8 (2)



I-Nut M6 (2)



J1-Washer D4 (2)



J2-Spacer D8x11 (2)
J2-Spacer D8x6 (2)



K-Wrench S4 (1)

Step 1 Attach lower column to the base

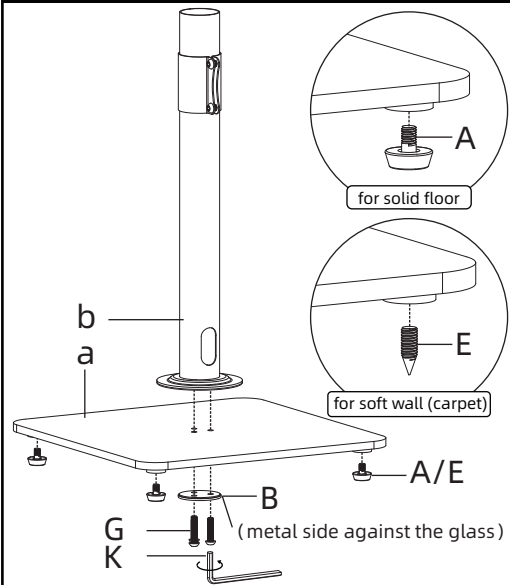

Step 2 Attach upper column

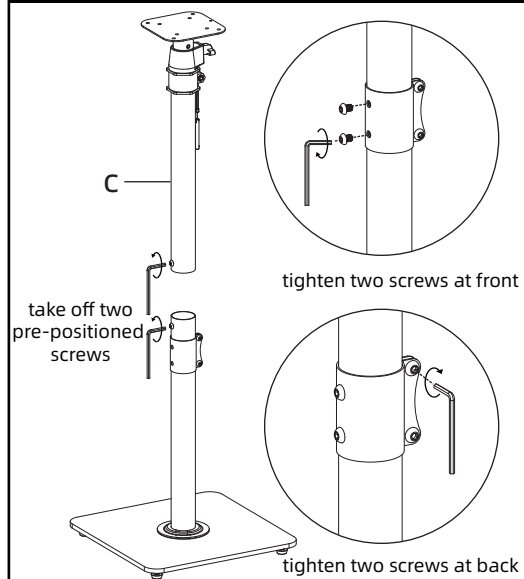

Step 3 Cable management

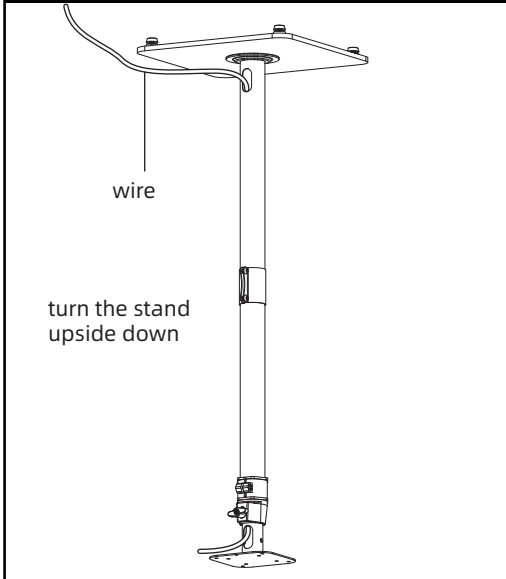

Step 4 Height adjustment

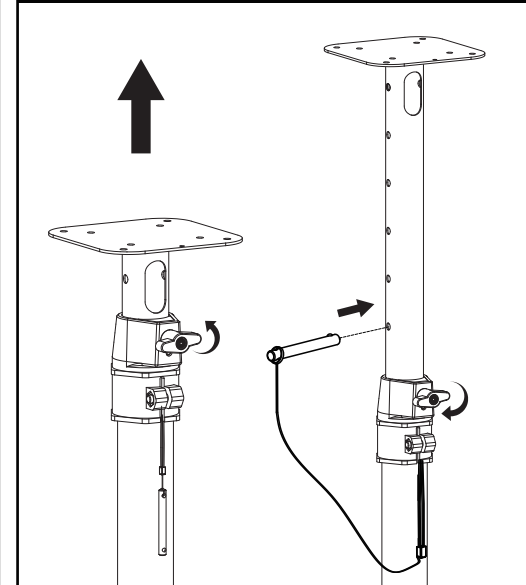

Step 5 Attach supporting bar

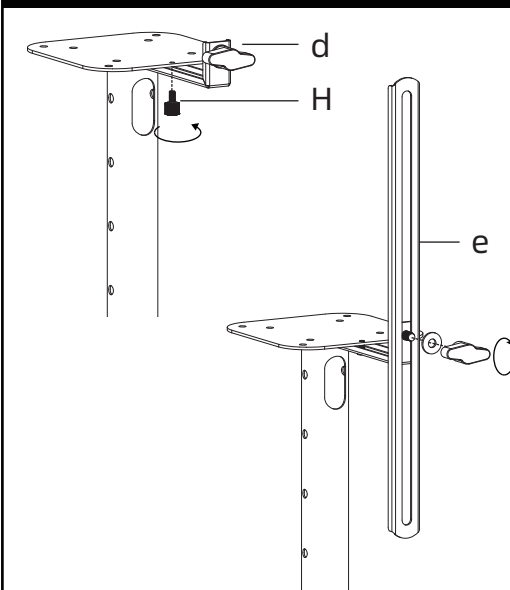

Step 6 Attach Speaker

6.1 Speaker with a key hole

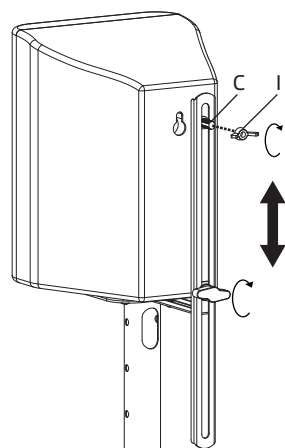

6.2 Speaker with a screw hole

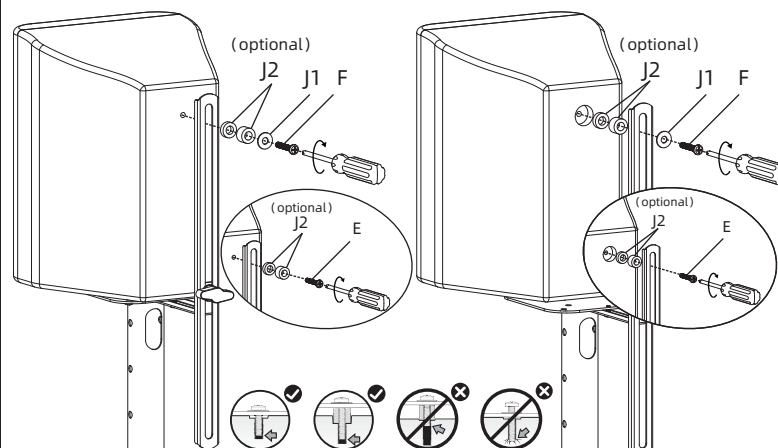

6.3 Speaker with a wooden base and no installation hole

