

Refer to the included full instruction manual "Use and Care Guide" for installation, safety, and additional information.

## Installation

### 1 Removing the mounting base



**NOTE:** This fixture comes with a mounting base. It is pre-assembled on the light fixture for shipping.

- Press the tab (1) on the top of the fixture toward the lamp heads (A).
- Slide the light fixture (B) up and out of the mounting base (D).

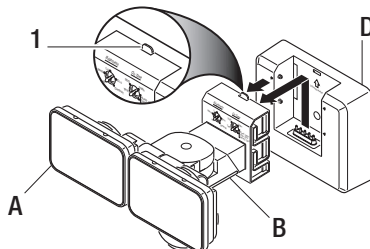

### 2 Installing the mounting bracket



**WARNING:** Turn the power off at the circuit breaker or fuse. Place tape over the circuit breaker switch and verify power is off at the light fixture.

- Remove the existing light fixture.
- Connect the ground wire on the mounting bracket (EE) to the house ground wire using a wire connector (AA).
- Install the mounting bracket (EE) with the stamped word "FRONT" facing away from the junction box. Use the mounting bracket screws (BB or CC) that best fit the junction box. If necessary, use the screws that were removed from the existing light fixture.

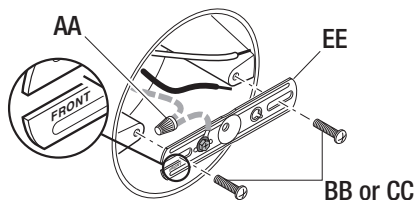

### 3 Wiring the mounting base



**WARNING:** Turn the power off at the circuit breaker or fuse. Place tape over the circuit breaker switch and verify power is off at the light fixture.



**NOTE:** If necessary, strip 3/8 in. of insulation from junction box wires.

- Hold down the "paddle" on the top of the pre-installed quick connect (2) located on the back of the mounting base (D).
- Insert the junction box wires (3) into the quick connect (2). Ensure the white (N – Neutral) wire is across from the pre-installed white wire and the black (L – Line) wire is across from the pre-installed black wire.
- Release the "paddle" and gently tug on the wires (2) to ensure that they are securely connected.

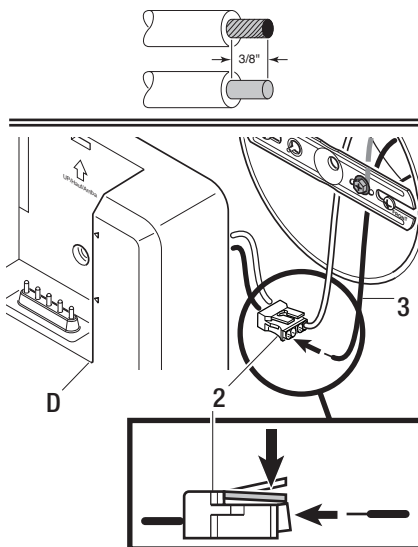

## Installation (continued)

### 4 Installing the mounting base

- Place the mounting base (D) against the junction box. Ensure the wires are pushed up into the junction box.
- When mounting to a wall, the “UP” arrow must point upward.
- When mounting to an eave, the “UP” arrow must point toward the building.
- Insert the mounting bolt (DD) through the mounting base (D) hole and thread it into the center hole of the mounting bracket (EE). Tighten the bolt (DD) securely.

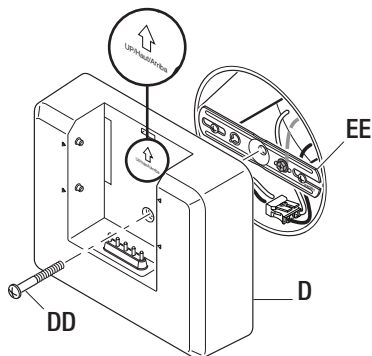

### 5 Attaching the light fixture

#### Wall Mount

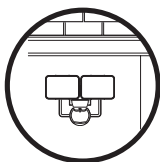

**NOTICE:** The light fixture must fully snap into place for the light to operate properly.

- Using the alignment marks (4), align the two slots (5) on each side of the light fixture's control module (6) with the pins (7) inside the mounting base (D).
- Press the light fixture (B) into the mounting base (D). Slide the light fixture (B) into the mounting base (D) until it snaps into place.

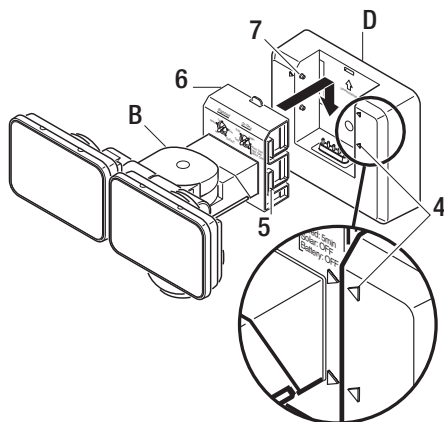

## Installation (continued)

### Eave Mount

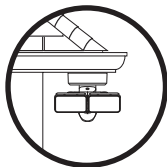

**IMPORTANT:** The light fixture and control module will only rotate one direction. Do NOT FORCE the control module if it does not turn.

**NOTICE:** The light fixture must fully snap into place for the light to operate properly.

- While holding the light fixture (B) in both hands, carefully twist the light fixture's control module (6) 180 degrees as shown.
- Using the alignment marks (4), align the two slots (5) on each side of the light fixture's control module (6) with the pins (7) inside the mounting base (D).
- Press the light fixture (B) into the mounting base (D). Slide the light fixture (B) into the mounting base (D) until it snaps into place.

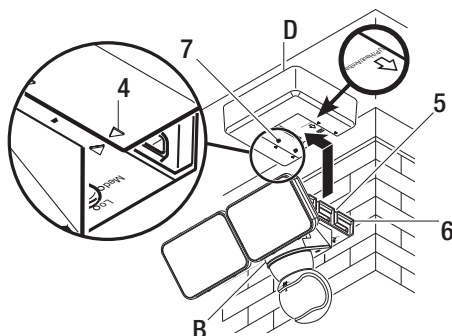
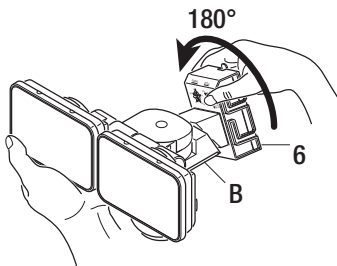

## 6 Caulking around the light fixture



**CAUTION:** Failure to completely caulk around the light fixture's mounting base could result in water seepage into the light fixture and/or junction box.

- Once the light (B) is operating correctly, caulk around the mounting base (D) and mounting surface with silicone sealant (not included).

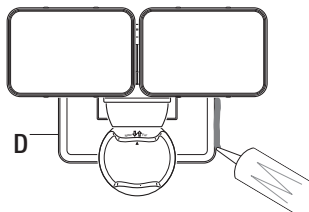

## Operation

### 1 Adjusting the lamp heads



**WARNING:** Risk of fire. Keep the lamp heads at least 2 in. (51 mm) from combustible materials.



**CAUTION:** Keep lamp heads 30° below horizontal to avoid water damage and electrical shock.

- Ensure the power is turned on for the light (B).
- If needed, gently grasp the lamp heads (A) and tilt them up or down or side to side to adjust the light coverage area.

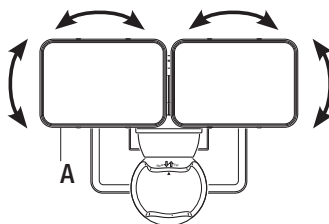

### 2 Setting the sensor for testing



**NOTE:** When the “ON-TIME” switch is set to the “TEST” position, the light fixture will operate during the day or night. The light will stay on for 8 seconds after all motion is stopped.

- Set the “ON-TIME” switch to the “TEST” position.
- Set the “Brightness” switch to the “Default” position.



**NOTE:** The motion sensor will need to completely warm up (60 seconds) before beginning the setup process.

6

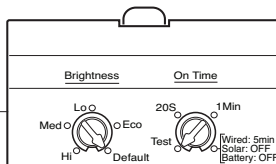

## Operation (continued)

### 3 Adjusting the motion sensor detection zone

- Perform a “walk test”: walk in an arc across the front of the motion sensor (C).
- Watch the light. The light will come on indicating motion has been detected.
- Stop, wait for the light to turn off, and then begin walking again.
- Continue this process until the detection zone has been established.

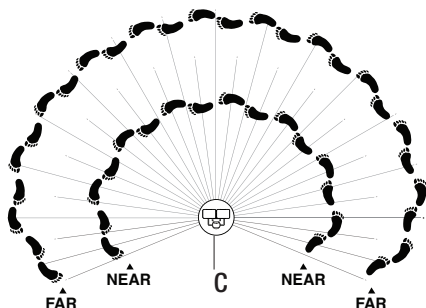

- If needed, gently grasp the motion sensor (C) and move it from side to side or up and down to adjust the detection zone.
- **Note:** Moving the motion sensor (C) “UP” increases the distance of the detection zone. Moving the motion sensor (C) “DOWN” decreases the distance of the detection zone.

There are built-in stops in the motion sensor (C). Do not rotate the motion sensor past these stops.

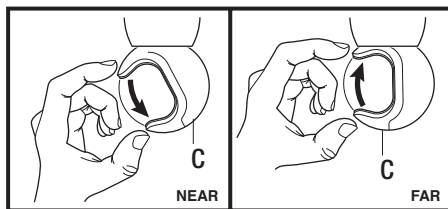

### 4 Adjusting the ON-TIME switch



**NOTE:** The “ON-TIME” switch determines the amount of time the light will stay on full bright after all motion has stopped.

- When the “On-Time” switch is set to the “20S” (seconds), “1Min” (minute), or “5Min” (minute) position, the light will function as a motion sensing light.
- **Do NOT** leave the ON-TIME switch in the “TEST” position.

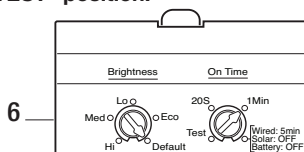

### 5 Adjusting the brightness switch

This light fixture (B) has an adjustable light level (lumen) setting. The higher the lumen number, the brighter the light output. Use the chart below to select the brightness level desired.

Brightness Setting	Lumen Output
Hi (High)	2000
Med (Medium)	1500
Lo (Low)	1000
Eco	400
Default	2000

## Troubleshooting

Problem	Possible Cause	Solution
The light will not come on.	<ul style="list-style-type: none"> <li>□ The light fixture is not properly attached to the mounting base, if this is a new installation.</li> <li>□ Daylight turn-off (photocell) is in effect.</li> <li>□ The motion sensor is aimed in the wrong direction.</li> </ul>	<ul style="list-style-type: none"> <li>□ Re-install the light fixture to the base.</li> <li>□ Recheck after dark.</li> <li>□ Re-aim the motion sensor to cover the desired area.</li> </ul>
The light comes on during the day.	The motion sensor may be installed in a relatively dark location.	The light fixture is operating normally under these circumstances.
The light comes on for no apparent reason.	The light fixture is wired through a dimmer or timer.	Do not use a dimmer or timer to control the light fixture. Replace the dimmer or timer with a standard on/off wall switch.
The lights stay on continuously.	<ul style="list-style-type: none"> <li>□ The motion sensor may be picking up a heat source, such as an air vent, dryer vent, or brightly painted, heat-reflective surface.</li> <li>□ The motion sensor is in manual mode.</li> <li>□ The light fixture is wired through a dimmer or timer.</li> <li>□ The light fixture is on the same circuit as a motor, transformer, or fluorescent bulb.</li> </ul>	<ul style="list-style-type: none"> <li>□ Reposition the motion sensor.</li> <li>□ Switch the motion sensor to auto. See <i>Using manual mode</i> in the included Use and Care Guide for additional information.</li> <li>□ Do not use a dimmer or timer to control the light fixture. Replace the dimmer or timer with a standard on/off wall switch.</li> <li>□ Install the light fixture on a circuit without motors, transformers, or fluorescent bulbs.</li> </ul>

This device complies with Part 15 of the FCC Rules. Operation is subject to the following two conditions: (1) this device may not cause harmful interference, and (2) this device must accept any interference received, including interference that may cause undesired operation.

Warning: Changes or modifications to this unit not expressly approved by the party responsible for compliance could void the user's authority to operate the equipment.

Note: This equipment has been tested and found to comply with the limits for a Class B digital device, pursuant to part 15 of the FCC Rules. These limits are designed to provide reasonable protection against harmful interference in a residential installation. This equipment generates, uses and can radiate radio frequency energy and, if not installed and used in accordance with the instructions, may cause harmful interference to radio communications. However, there is no guarantee that interference will not occur in a particular installation. If this equipment does cause harmful interference to radio or television reception, which can be determined by turning the equipment off and on, the user is encouraged to try to correct the interference by one or more of the following measures:

- Reorient or relocate the receiving antenna.
- Increase the separation between the equipment and receiver.
- Connect the equipment into an outlet on a circuit different from that to which the receiver is connected.
- Consult the dealer or an experienced radio/TV technician for help.

FCC Responsible Party Name: HeathCo LLC

Address: 2445 Nashville Road, Bowling Green, KY 42101 U.S.A.

Telephone Number: 800-858-8501

CAN ICES-005 (B)/NMB-005 (B)

211403-02