

User Manual

PACKAGE CONTENT

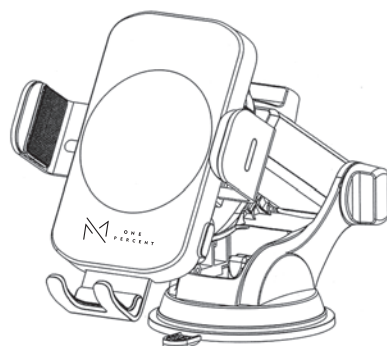

Thank you for choosing this product.
Please read the instructions carefully before using!

◀01▶

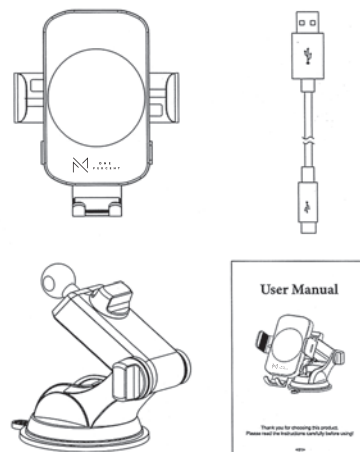

◀02▶

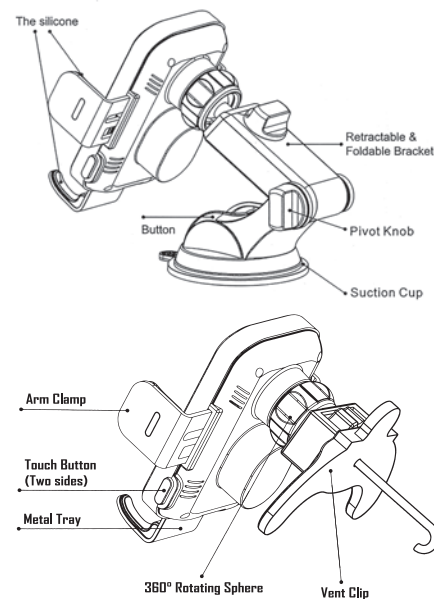

◀03▶

Operating steps

1. Put the universal ball into the nut first, then insert it into the socket on the back of the holder.

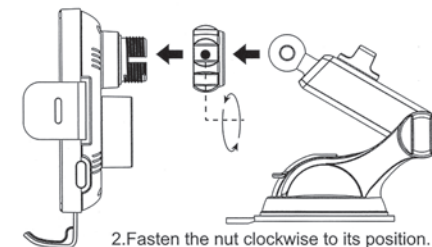

2. Fasten the nut clockwise to its position.

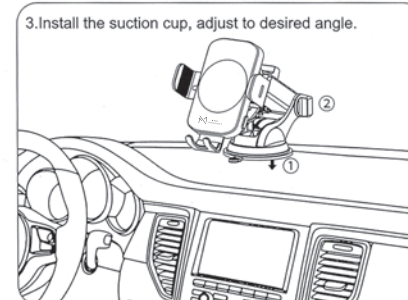

3. Install the suction cup, adjust to desired angle.

◀04▶

4. Connect phone holder to car charger using the included Type-C charging cable, the clamp arms will open automatically.

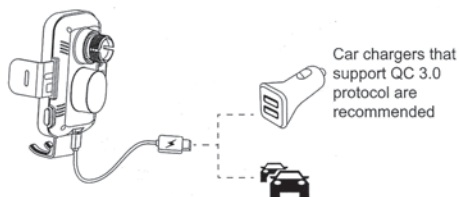

Car chargers that support QC 3.0 protocol are recommended

5. Place your phone, the clamp arms will lock it automatically.

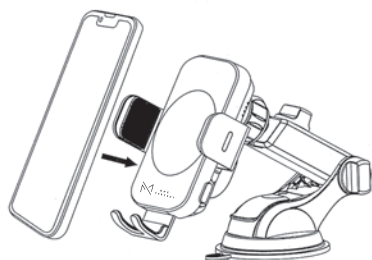

◀05▶

6. Press the clamp arms control button to open the arms and retrieve your phone.

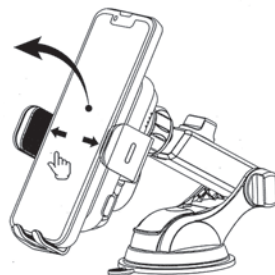

◀06▶

SPECIFICATIONS

Input: 5V=2A, 9V=1.8A
Output: 5W / 7.5W / 10W / 15W (MAX)
Charging Distance: ≤ 4MM
Input Interface: Type C

INDICATOR

POWER ON	Red light stays on
CHARGING	Blue light stay on
FOD	Red light flashes quickly

FAQ

Why doesn't this charger work?

- (1) Make sure your phone supports wireless charging function.
- (2) Use the cable came with the package to connect the power.
- (3) The thickness of the phone case does not exceed 4mm.
- (4) Make sure there is no metal material, magnetic objects, credit cards or pop holders on the back of your phone between the phone and the phone case.
- (5) If the charger's indicator does not light up after connecting the power supply, please contact us directly.

Why not fast charging or not charging?

Please use the QC3.0 car charger as its power source.

Why does the suction cup fall off the dashboard?

- (1) Make sure the dashboard is smooth, no slope and no dust.
- (2) There are two fixed knobs on the bracket, which can swing up and down and stretch. Please tighten the knob to avoid shaking.
- (3) A noteworthy detail is that before placing the product on the dashboard, you need to turn on the button, then press the suction cup where you want to place it, and finally fasten the button.

How to prevent your phone from overheating?

We suggest you close Apps to reduce power consumption and turn off phone screen during wireless charging.

◀07▶

15W / 10W / 7.5W Fast Charging

Note: Fast Charging mode requires QC3.0 Car charger (NOT INCLUDED)

15W: Fast Charging for LG V50 / V40 / V30+ / V30 / V40 ThinQ / G8 ThinQ / G8S / G7 ThinQ / G7, etc.

10W: Standard Charging for Note 20 / Note 20 Ultra / S22 / S22+ / S21 / S21+ / S20+ / S20 / Note 10+ / S10+ / Note 9 / Note 8 / S9 / S8, etc.

7.5W: Fast Charging for iPhone 13 Pro Max / 13 Pro / 13 / 13 Mini / 12 Pro Max / 12 Pro / 12 / 12 Mini / 11 / 11 Pro / 11 Pro Max / SE / XS / X / XR / 8 Plus / 8, etc.

5W: Standard Charging for all Qi-enabled phones, such as Galaxy S6 / S6 Edge, Pixel 3 / 3XL, Nexus 6P, etc.

WARRANTY CARD

Please feel free to contact us if you have any problems or suggestions with our products.

◀08▶

FCC Warning

This device complies with Part 15 of the FCC Rules. Operation is subject to the following two conditions:

(1) This device may not cause harmful interference, and (2) this device must accept any interference received, including interference that may cause undesired operation.

NOTE 1: This equipment has been tested and found to comply with the limits for a Class B digital device, pursuant to part 15 of the FCC Rules. These limits are designed to provide reasonable protection against harmful interference in a residential installation. This equipment generates, uses and can radiate radio frequency energy and, if not installed and used in accordance with the instructions, may cause harmful interference to radio communications. However, there is no guarantee that interference will not occur in a particular installation. If this equipment does cause harmful interference to radio or television reception, which can be determined by turning the equipment off and on, the user is encouraged to try to correct the interference by one or more of the following measures:

- Reorient or relocate the receiving antenna.
- Increase the separation between the equipment and receiver.
- Connect the equipment into an outlet on a circuit different from that to which the receiver is connected.
- Consult the dealer or an experienced radio/TV technician for help.

NOTE 2: Any changes or modifications to this unit not expressly approved by the party responsible for compliance could void the user's authority to operate the equipment.

RF Exposure Statement

To maintain compliance with FCC'S RF Exposure guidelines, This equipment should be installed and operated with minimum distance of 20cm between the radiator and your body. This device and its antenna(s) must not be co-located or operation in conjunction with any other antenna or transmitter.