

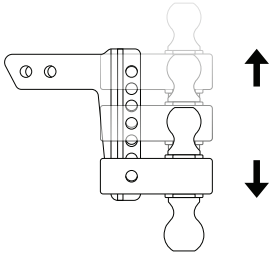

blackout
series

DROP HITCH | Operating Instructions



STEP 1: Place the Drop Hitch at the desired drop on the drawbar in order to ensure that your vehicle and trailer are properly positioned.

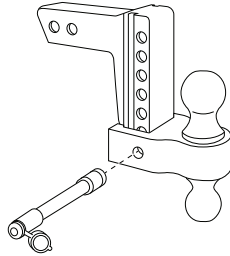

STEP 2: Insert the keylock pin into the Drop Hitch when you have achieved the desired position along the drawbar.

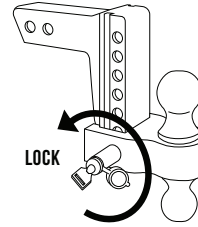

STEP 3: To lock the keylock pin in place, turn key counter clockwise. To unlock, turn key clockwise.

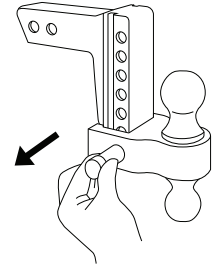

STEP 4: Pull keylock pin to ensure that it has been engaged. Do not operate without making sure keylock assembly is securely locked in place.

IMPORTANT SAFETY INFORMATION

Ensure safety chains are attached between vehicle and trailer. DO NOT attach chains directly to hitch. Do not exceed either the Tow vehicle's rated load or your Trailer Valet Drop Hitch capacity rating. Secure your Trailer Valet Drop Hitch to receiver with keylock or hitch pin.



BLACKOUT SERIES

Ball Mounts & Drop Hitches

blackout
SERIES



BSDH0010

2"

2"

N/A

STANDARD

5,000 LBS

STEEL

CLASS III



BSDH0011

2"

4"

N/A

STANDARD

6,000 LBS

STEEL

CLASS III



BSDH0020

2" AND 2-5/16"

2"

2"

REVERSIBLE

6,000/7,500 LBS

STEEL

CLASS III



BSDH0040

2" AND 2-5/16"

0-6"

5-1/4"

ADJUSTABLE

14,000 LBS

STEEL

CLASS V



BSDH0030

2" AND 2-5/16"

0-4"

0-4"

ADJUSTABLE

8,000/10,000 LBS

ALUMINUM

CLASS IV



BSDH0031

2" AND 2-5/16"

0-6"

0-6"

ADJUSTABLE

8,000/10,000 LBS

ALUMINUM

CLASS IV



BSDH0032

2" AND 2-5/16"

0-8"

0-8"

ADJUSTABLE

8,000/10,000 LBS

ALUMINUM

CLASS IV



BSDH0033

2" AND 2-5/16"

0-10"

0-10"

ADJUSTABLE

8,000/10,000 LBS

ALUMINUM

CLASS IV

SKU

BALL SIZE

DROP

RISE

TYPE

CAPACITY

MATERIAL

CLASS

SKU

BALL SIZE

DROP

RISE

TYPE

CAPACITY

MATERIAL

CLASS