

135.00

90.00



## CD PLAYER

JaekAudio C20  
Instruction

### Parts Description

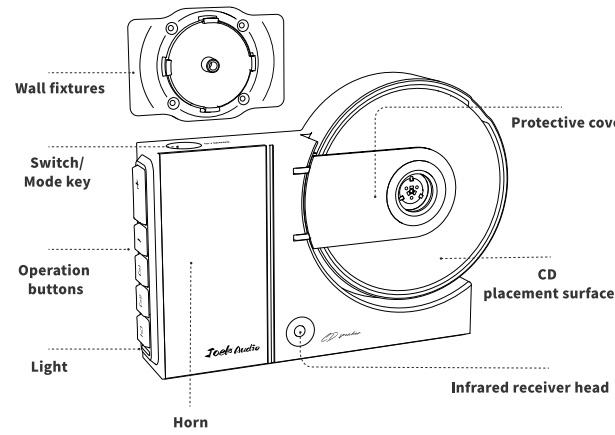

### Product list

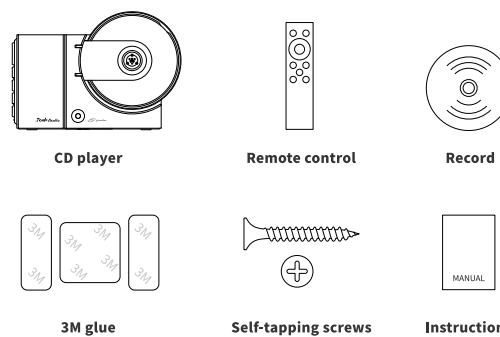

### Functional operation instructions

#### 1 CD mode (default when booted)

- Built-in speaker playback**  
(1) Long press the power button on the top, and the indicator light will be solid green  
(2) Open the protective cover and put in the CD disc  
(3) Close the protective cover

- Bluetooth output**  
(1) Press and hold the " + " button in CD mode (with a disc), and the green light will flash  
(2) Wait a few seconds to automatically connect to nearby devices  
(3) The connection is successful, long press the " - " button to switch devices  
(4) Long press the " + " button to turn off the Bluetooth output, and the green light is always on

- 3.5 Line output**  
In CD mode (with discs) connect the headphones/adaptor cables  
Plug in the " AUX " port (Bluetooth transmitter priority playback)

#### 2 Bluetooth mode

- (1) Long press the top power button to power on  
(2) Short press the top " MODE " button to switch to Bluetooth mode, Hear a voice prompt and a blue light flashes  
(3) Open your phone's Bluetooth settings  
(4) Select the device " JaekAudio C20 " to match  
(5) The pairing is successful, and the blue light is always on  
(6) Select music playback on your phone

#### 3 USB mode

- (1) Long press the top power button to power on  
(2) Short press the top " MODE " button to switch to USB mode, Hear the voice prompt and the red light is always on  
(3) Insert the USB flash drive into the " USB " port

Power on/mode

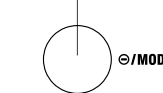

Volume +  
Bluetooth output

Volume -  
Switch Bluetooth devices

Previous song

Play/Pause

Next song

Light

Type-C charge

AUX output

USB input

### Buttons/Lights Introduced

keystroke	Short press	Press and hold
MODE	Toggle modes	Boot
+	Volume +	Bluetooth transmitter
-	Volume -	Toggle the Bluetooth transmitter device
△	Previous song	
▽	Play/Pause	
▽	Next song	

Light	Solid on	Flashing
Green light	CD mode playback	Bluetooth transmitter in CD mode
Blue light	Playback in Bluetooth mode	Bluetooth waits for connection
Red light	USB mode playback	
Pink lights	Always on when charging and off when fully charged	

### Introduction to the remote control buttons

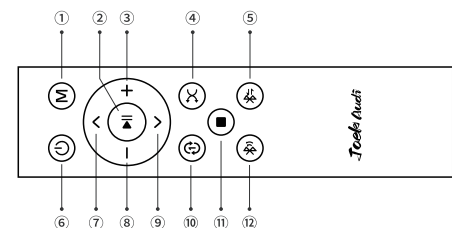

- ① Mode      ② Play/Pause      ③ Volume +      ④ Shuffle  
⑤ Toggle the Bluetooth transmitter device      ⑥ Power on and off      ⑦ Previous song      ⑧ Volume -  
⑨ Next song      ⑩ Single loop      ⑪ Stop it      ⑫ Bluetooth transmitter

### Wall mounting instructions

#### 1 Detach the wall mount

Place the wall mount on the back of the CD player counterclockwise  
Rotate 45 degrees to remove the wall mount vertically

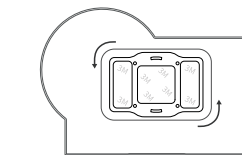

#### 2 Tear off 3M release liners

Remove three pieces of 3M adhesive release liner from the wall mount

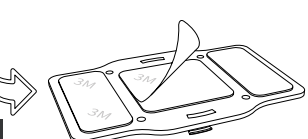

#### 3 Sticking to the wall fixture

Attach the wall fixing frame horizontally to the target wall and press it moderately to make the adhesive surface fit

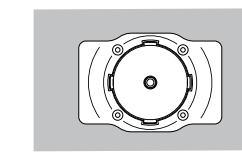

#### 4 Hole alignment

Align and insert the round table with the raised center of the wall mount and insert it into the round hole on the CD player

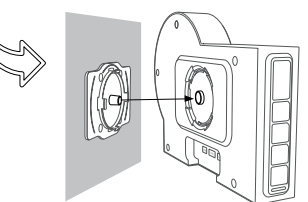

#### 5 45 degree angle snap in

Tilt the CD player to 45 degrees, shake it lightly and press to snap into the card slot

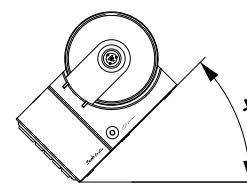

#### 6 Complete the installation

Rotate the CD player 45° clockwise to complete the installation (Disassembly can be completed by rotating 45° counterclockwise after installation)

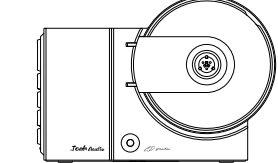

### Four ways to present

The card slot can be snapped into the card slot at a 45° angle in any direction, and four wall mounting methods can be displayed according to preference

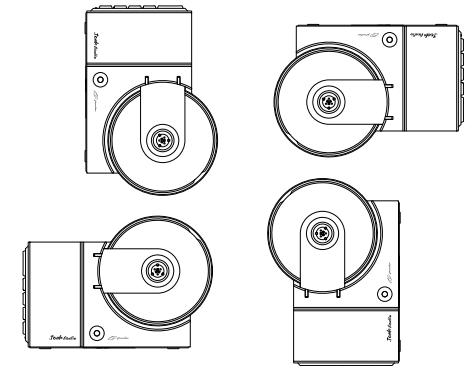

### Precautions

- Read this note carefully and keep it.
- This product is suitable for use in an indoor ventilated environment, please keep away from places with high humidity, high temperature and dust.
- Place a disc or protect the jammed paper on the device to avoid unnecessary damage to the CD bald head assembly.
- When replacing a CD, stop spinning completely and replace the disc.
- It is forbidden to touch the disc with your hands or other items while the device is running.
- Clean this product with a dry cloth only.
- Do not place the unit near a container filled with liquids or dripping water.
- Do not install near any heat source, such as radiators, hot air regulators, stoves, or other heat-generating instruments.
- Protect the power cord from being stepped on or pinched, especially at plugs, sockets, and product power outlets.
- Please use the accessories/accessories provided by the manufacturer.
- When attaching the wall mount, clean the adhesive surface and keep the adhesive surface dry and free of dust, oil stains, moisture, etc.
- Avoid touching the glued surface with your fingers, and it is recommended to stick the wall mount for 24 hours before installing the CD player.
- Please do not wall hang inferior walls, water-stained walls, rough walls, peeling walls, painted walls, or cracked walls.
- When the wall mounting height is more than 1.6 meters, please use self-tapping screws.
- When installing the CD player, make sure that the CD player is fixed in place with the holder and that there is no loosening.

### warn

If the laser beam emitted by the laser head is directly irradiated to the human body, it may cause some harm, be sure to operate the machine correctly according to this manual, and do not open the casing or repair it by yourself, so as not to be exposed to the beam.

### Product parameters

power	: 10W	Battery capacity	: 4000mah
Vocal unit	: 1.5-inch speaker 4Ω5W*2		
input	: Bluetooth input, USB input		
output	: Bluetooth output, 3.5 line output		

### FCC warning statements:

This equipment has been tested and found to comply with the limits for a Class B digital device, pursuant to part 15 of the FCC Rules. These limits are designed to provide reasonable protection against harmful interference in a residential installation. This equipment generates, uses and can radiate radio frequency energy and, if not installed and used in accordance with the instructions, may cause harmful interference to radio communications. However, there is no guarantee that interference will not occur in a particular installation. If this equipment does cause harmful interference to radio or television reception, which can be determined by turning the equipment off and on, the user is encouraged to try to correct the interference by one or more of the following measures:

- Reorient or relocate the receiving antenna.
- Increase the separation between the equipment and receiver.
- Connect the equipment into an outlet on a circuit different from that to which the receiver is connected.
- Consult the dealer or an experienced radio/TV technician for help.

Caution: Any changes or modifications to this device not explicitly approved by manufacturer could void your authority to operate this equipment.

This device complies with part 15 of the FCC Rules. Operation is subject to the following two conditions: (1) This device may not cause harmful interference, and (2) this device must accept any interference received, including interference that may cause undesired operation.

The device has been evaluated to meet general RF exposure requirement This equipment complies with FCC radiation exposure limits set forth for an uncontrolled environment. This equipment should be installed and operated with minimum distance 20cm between the radiator & your body.