

SECTION 6

EXPLODED VIEWS

Note:

- -XX and -X mean standardized parts, so they may have some difference from the original one.
- Items marked "*" are not stocked since they are seldom required for routine service. Some delay should be anticipated when ordering these items.
- The mechanical parts with no reference number in the exploded views are not supplied.
- Color Indication of Appearance Parts Example:
KNOB, BALANCE (WHITE) . . . (RED)

↑ ↑
Parts Color Cabinet's Color

6-1. MAIN CHASSIS SECTION

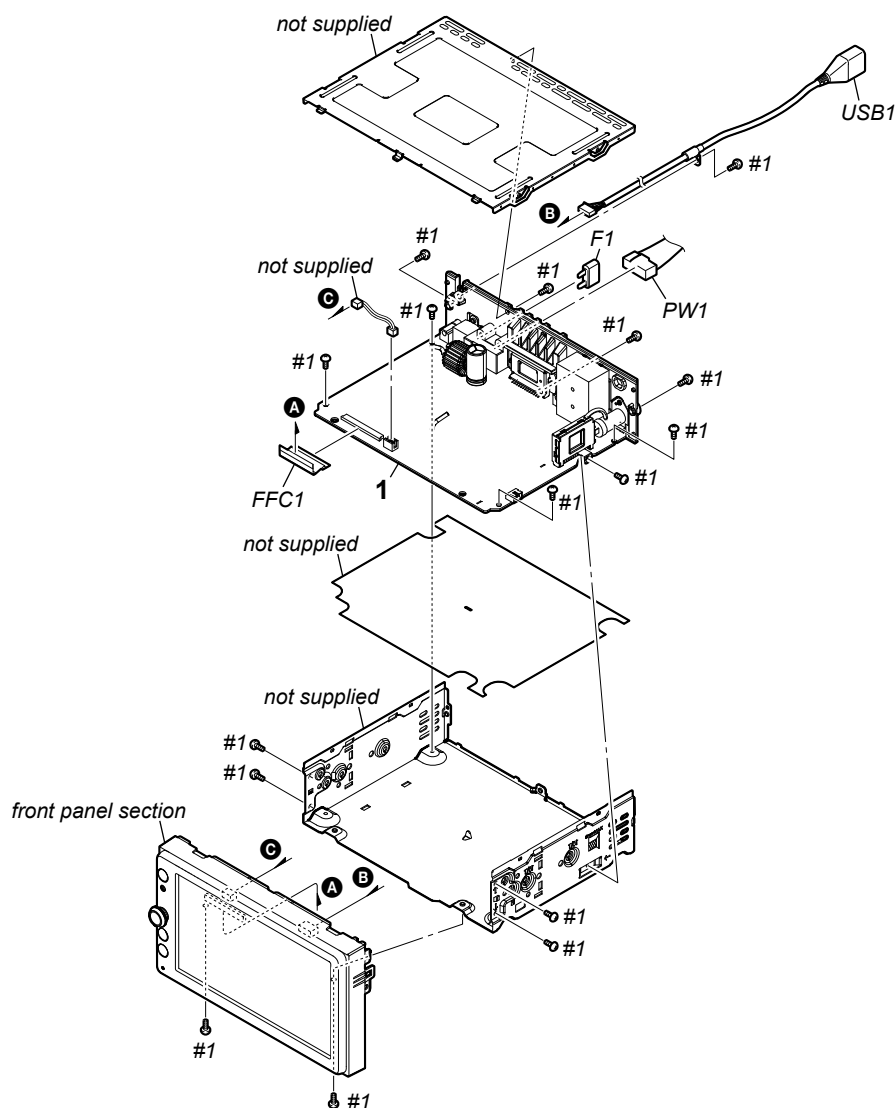

Note: When the complete MAIN board (Ref. No. 1) is replaced, be sure to refer the following, and perform them.

- DESTINATION SETTING METHOD (Except IND3 model) (page 5)
- COMMUNICATION CHECK OF Apple CarPlay AND Android Auto (page 7)
- FLICKER ADJUSTMENT (page 25)

6-2. FRONT PANEL SECTION

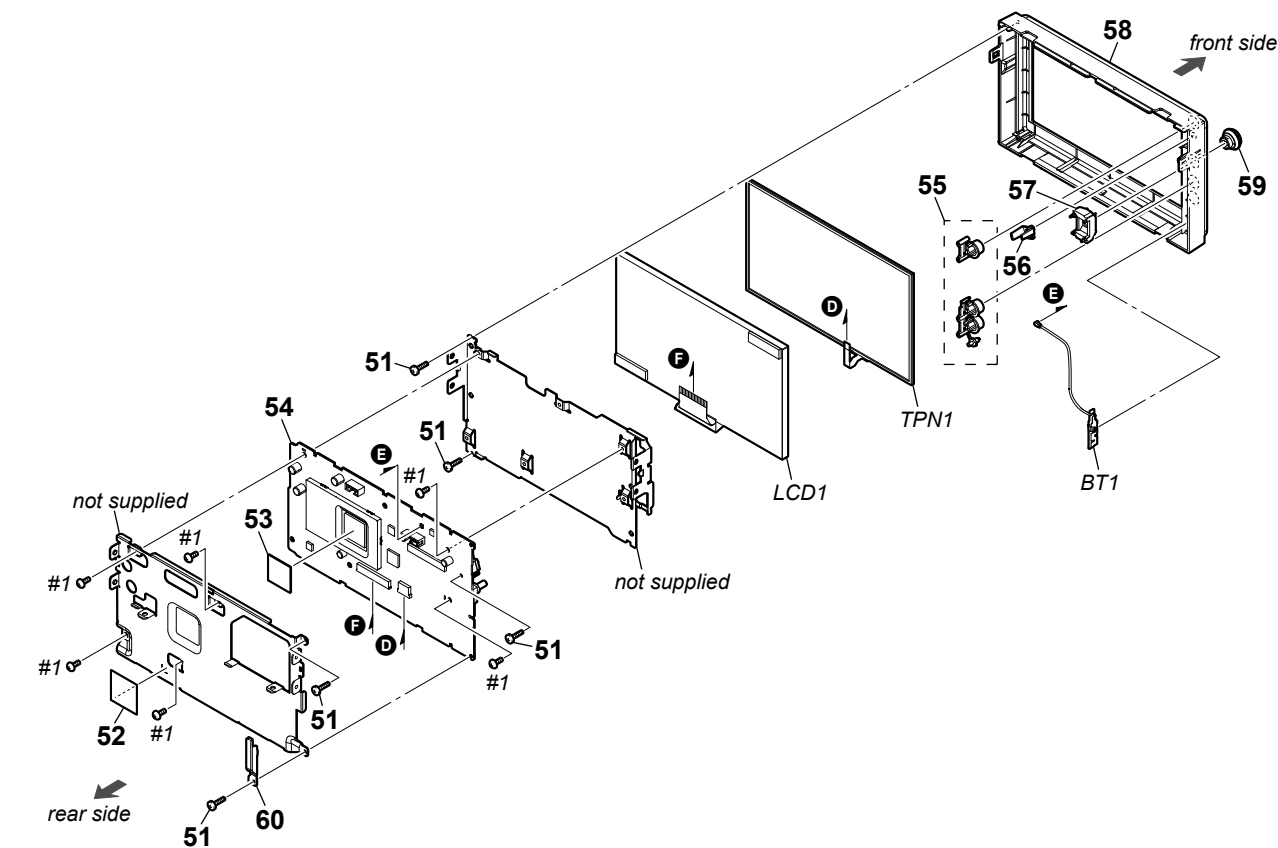

Note 1: Replaced old complete TFT board (Ref. No. 54) is destroyed with the hammer, and throw out it.

Note 2: When the complete TFT board (Ref. No. 54) is replaced, be sure to refer the following, and perform them.

- COMMUNICATION CHECK OF Apple CarPlay OR Android Auto (page 7)
- FLICKER ADJUSTMENT (page 25)

Note 3: When the TFT (6.5) (Ref. No. LCD1) is replaced, refer to “FLICKER ADJUSTMENT” on page 25.

Note 4: When the touch panel (Ref. No. TPN1) is replaced, refer to “TOUCH PANEL ADJUST” on page 9.

