

Product Assembly Guidelines

Model No.: P-002B

1. Meat grinding accessories assembly steps

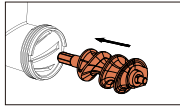

Step1

Insert the auger.

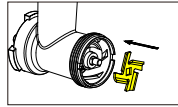

Step2

Mount the cutting blade on the front of the auger. The flat, sharpened end of the cutting blade **MUST** be facing **OUT**.

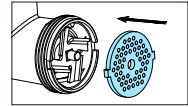

Step3

Mount the grinding plate in front of the cutting blade and make sure the tabs on the sides fit into the slots on the sides of the grinding head.

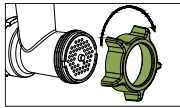

Step4

Turn and tighten the head locking screw cap.

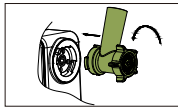

Step5

Install the accessories to the original juicer and install the tray.

2. Sausage stuffing tubes assembly steps – for minced meat

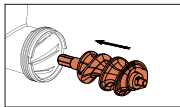

Step1

Insert the auger.

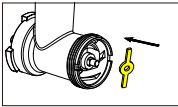

Step2

Install the adaptor ring, make sure both sides are tight.

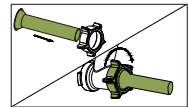

Step3

Insert stuffing tube into and through the back of the adaptor ring and push it in until it is snug. Screw the head locking screw cap onto the grinding head as shown.

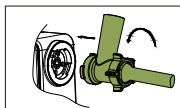

Step4

Install the accessories to the original juicer and install the tray.

3. Sausage stuffing tubes assembly steps – for chopped meat

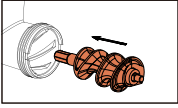

Step1

Insert the auger.

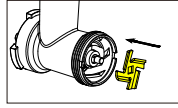

Step2

Mount the cutting blade on the front of the auger. The flat, sharpened end of the cutting blade **MUST** be facing **OUT**.

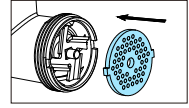

Step3

Mount the grinding plate in front of the cutting blade and make sure the tabs on the sides fit into the slots on the sides of the grinding head.

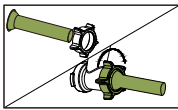

Step4

Insert stuffing tube and screw the head locking screw cap onto the grinding head as shown.

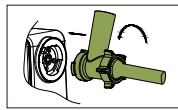

Step5

Install the accessories to the original juicer and install the tray.

4. Cleaning tips

- Do not put in the dishwasher.
- Do not use water over 50°C to clean.
- After use, please soak in water for a few minutes, and then rinse clean.
- The cleaned products should be air-dried in time and kept in a dry place.



Scan the QR code to watch the video