

Turntable System



TT-935BT + SP-106 USER MANUAL

WARNING

TO PREVENT FIRE OR SHOCK HAZARD, DO NOT USE THIS PLUG WITH AN EXTENSION CORD, RECEPTACLE OR OTHER OUTLET UNLESS THE BLADES CAN BE FULLY INSERTED TO PREVENT BLADE EXPOSURE. TO PREVENT FIRE OR SHOCK HAZARD, DO NOT EXPOSE THIS APPLIANCE TO RAIN OR MOISTURE.



THE CAUTION MARKING AND RATING LABEL ARE LOCATED AT THE BOTTOM OF THE UNIT

IMPORTANT SAFETY INSTRUCTIONS

1. Read these instructions.
2. Keep these instructions.
3. Heed all warnings.
4. Follow all instructions.
5. Do not use this apparatus near water.
6. Clean only with dry cloth.
7. Do not block any ventilation openings. Install in accordance with the manufacturer's instructions.
8. Do not install near any heat sources such as radiators, heat registers, stoves, or other apparatus (including amplifiers) that product heat.
9. Do not defeat the safety purpose of the polarized or grounding-type plug. A polarized plug has two blades with one wider than the other. A grounding type plug has two blades and a third grounding prong. The wide blade or the third prong is provided for your safety. If the provided plug does not fit into your outlet, consult an electrician for replacement of the obsolete outlet.
10. Protect the power cord from being walked on or pinched particularly at plugs, convenience receptacles, and the point where they exit from the apparatus.
11. Only use attachments/accessories specified by the manufacturer.
12. Use only with a cart, stand, tripod, bracket, or table recommended by the manufacturer, or sold with the product. When a cart is used, use caution when moving the cart/apparatus combination to avoid injury from tip-over.
13. Unplug this apparatus during lightning storms or when unused for a long periods of time.
14. Refer all servicing to qualified service personnel. Servicing is required when the apparatus has been damaged in any way, such as power-supply cord or plug is damaged, liquid has been spilled or objects have fallen into the apparatus, the apparatus has been exposed to rain or moisture, does not operate normally, or has been dropped.
15. This appliance shall not be exposed to dripping or splashing water and that no object filled with liquids such as vases shall be placed on the apparatus.
16. Do not overload wall outlet. Use only power source as indicated.
17. Use replacement part as specified by the manufacturer.
18. Upon completion of any service or repairs to this product, ask the service technician to perform safety checks.
19. Power Sources - This product should be operated only from the type of power source



indicated on the marking label. If you are not sure of the type of power supply to your home, consult your product dealer or local power company. For products intended to operate from battery power, or other sources, refer to the operating instruction.

20. Object and Liquid Entry - Never push objects of any kind into this product through openings as they may touch dangerous voltage points or short-out parts that could result in a fire or electric shock. Never spill liquid of any kind on the product.
21. Damage Requiring Service - Unplug this product from the wall outlet and refer servicing to qualified service personnel under the following conditions:
 - a) When the power-supply cord or plug is damaged,
 - b) If liquid has been spilled, or objects have fallen into the product,
 - c) If the product has been exposed to rain or water,
 - d) If the product does not operate normally by following the operating instructions. Adjust only those controls that are covered by the operating instructions as an improper adjustment of other controls may result in damage and will often require extensive work by a qualified technician to restore the product to its normal operation.
 - e) If the product has been dropped or damaged in any way, and
 - f) When the product exhibits a distinct change in performance - this indicates a need for service.
22. Mains plug is used as disconnect device and it should remain readily operable during intended use. In order to disconnect the apparatus from the mains completely, the mains plug should be disconnected from the mains socket outlet completely.
23. Excessive sound pressure from earphones and headphone can cause hearing loss.
24. Minimum distances of 10 cm around the apparatus for sufficient ventilation
25. The ventilation should not be impeded by covering the ventilation openings with items, such as newspapers, table-cloths, curtains, etc.
26. No naked flame sources, such as lighted candles, should be placed on the apparatus.
27. The use of apparatus in moderate climates.

This symbol indicates that this product incorporates double insulation between hazardous mains voltage and user accessible parts.

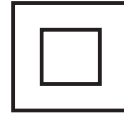

CAUTION

TO PREVENT ELECTRIC SHOCK, MATCH WIDE BLADE OF PLUG TO WIDE SLOT. FULLY INSERT THE PLUG TO MAIN POWER SOCKET.

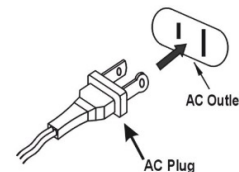

SAVE THESE INSTRUCTIONS

IMPORTANT NOTES

Avoid installing the unit in locations described below:

- Places exposed to direct sunlight or close to heat radiating appliances such as electric heaters.
- Places subject to constant vibration.
- Dusty, humid or moist places.
- Unplug the unit from the electrical power outlet immediately in case of malfunction.

This device complies with Part 15 of the FCC Rules. Operation is subject to the following two conditions:

- (1) This device may not cause harmful interference.
- (2) This device must accept any interference received, including interference that may cause undesired operation.

LOCATION OF CONTROLS

- 1) Dust Cover
- 2) Bluetooth Indicator (Blue)
- 3) Spindle Adaptor
- 4) Power Button
- 5) Volume + / - Button
- 6) Cartridge Head Shell
- 7) Tone-arm lock
- 8) N/A
- 9) Auto Stop On/Off Switch
- 10) Cueing lever
- 11) Turntable speed selector
- 12) Pitch adjust
- 13) Counter weight
- 14) Speaker jack (L/R)
- 15) DC Input Jack
- 16) AC/DC adaptor
- 17) DC plug

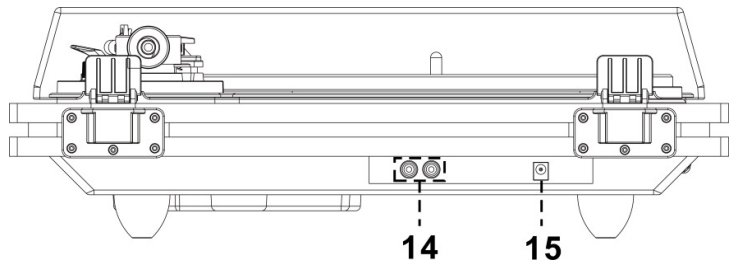
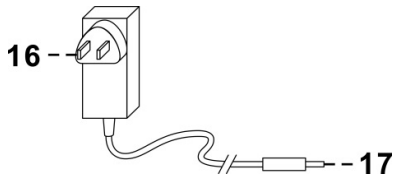
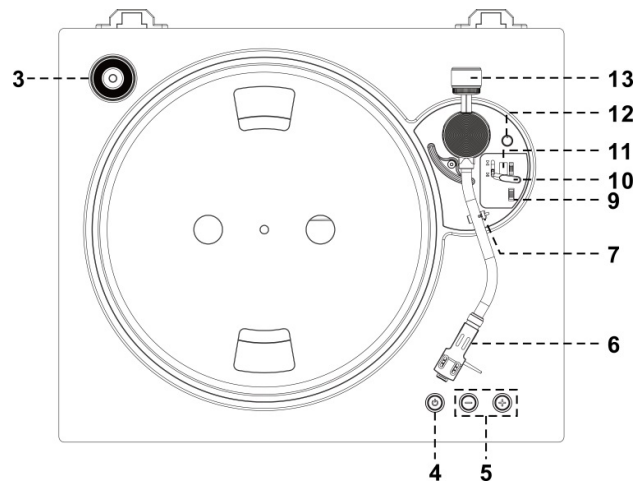
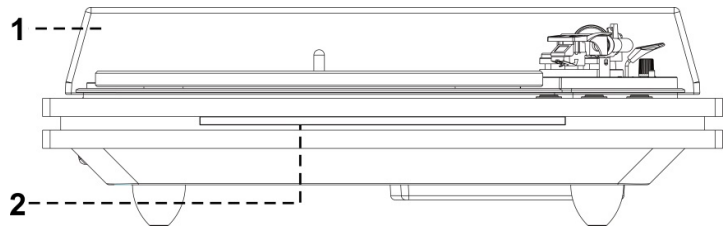

Caution:

Usage of controls or adjustments or performance of procedures other than those specified herein may result in hazardous radiation exposure.

This unit should not be adjusted or repaired by anyone except qualified service personnel.

Precautions for use

Installation

- Unpack all parts and remove protective material.
- Do not connect the unit to the mains before checking the mains voltage and before all other connections have been made.
- Do not cover any vents and make sure that there is a space of several centimeters around the unit for ventilation.

Connection

1. Plug the RCA plug of left speaker into the left speaker RCA socket (14) with the "L" mark located at back of the unit.
2. Plug the RCA plug of right speaker into the right speaker RCA socket (14) with the "R" mark.

3. Insert the DC plug (17) to the DC Input jack (15) of the main unit, then connect the AC/DC adaptor (16) to AC outlet.
4. Press the Power Button (4), the Bluetooth Indicator (2) will light up and flashing. Your system is now ready to connect your Bluetooth device. Please refer to the Operations section of this Manual for details.

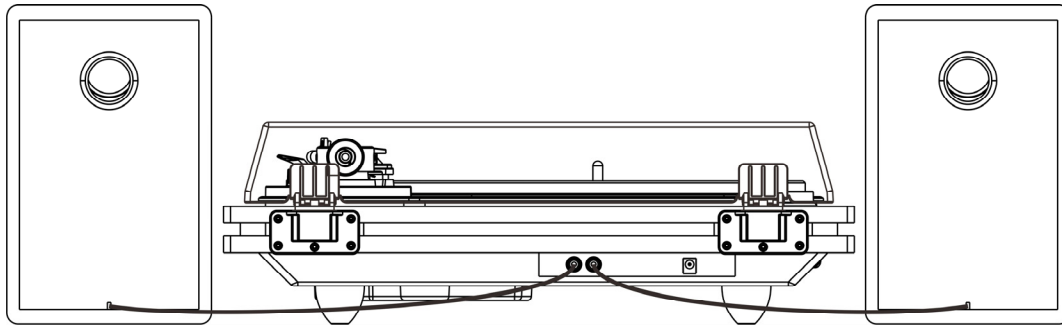

Installation of counter weight

- 1 Slide in the counter weight (13) completely into the rear of the tone arm until it reach the end, turn it clockwise until it click with pit inside.
- 2 Twist the counter weight clockwise & backward until it reach the white line as figure 2
- 3 Twist the counter marking until it reach " 1 " position
- 4 Twist the counter weight anti-clockwise & inward until it reach the appropriate working pressure.

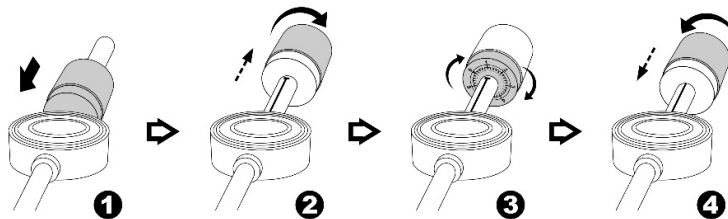

Remark : the working pressure of the provided stylus is from the range **4 – 6 grams**. According to the cartridge manufacturer. All stylus has it own working pressure and please refer to the specification respectively.

OPERATIONS

Stereo phonograph operation

Please Note - Before Use

- Push upward of the stylus protector.
- Make sure that the tone arm is unlocked and free to move from the tone arm rest prior to operating. Lock the tone arm again when not in use.

1. Press the Power Button (4) twice and the button will light up in Red color.
2. Raise the turntable dust cover (1).
3. Place the record on the platter (use the 45 RPM record adaptor if you are playing 45 RPM records).
4. Set the speed selector (11) to the proper position for the record you are playing.
5. Set the cueing lever (10) to the up position.
6. Lift the tone arm from the rest and slowly move it to the record side. The platter will start to rotate and position the tone arm over the desired position of the record.
7. Pull down the cueing lever (10). The tone arm will come slowly on the record and start playback.
8. Adjust the Volume + / - Button (5) to the desire level.
9. At the end of the record, the tone arm will automatically stop spinning. Lift the tone arm from the record and return it to the rest.
10. To stop manually, lift the tone arm from the record and return to the rest.

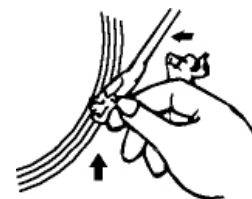

Play suspension

Set the cueing lever (10) to the up position will lift up the tone arm and then stop playback temporarily

Remark :

- Some types of records may have an auto-stop area outside the preset limit, so the turntable may stop before the last track finishes. In this case, set the Auto Stop On/Off switch (9) to the "OFF" position. This allows the record to play to the end, but please note that it will not stop automatically. You must manually raise the tone arm and place it back in the rest and then turn off the power to stop the turntable from spinning.
- Users should not change to a ceramic cartridge system, otherwise unit can't be connected anymore to an Aux-in of music-centre

Adjustments

Platter speed fine adjustment

- During playback of record, turn the Pitch Adjustment (12) to fine adjust the platter rotation speed.
- Turning clockwise (+) will increase the turning speed and anti-clockwise (-) will slow down the speed.
- Turn the Pitch Adjustment until the output sound performance is up to your satisfaction

Bluetooth connecting and Playback

1. Press the Power Button (4), the Bluetooth Indicator (2) will light up.
2. The Bluetooth LED indicator (2) will be flashing, it means the Bluetooth in non connection / searching mode.
3. Switch on the Bluetooth feature of your Bluetooth device (such as mobile phone) and select " TT-Play PLUS " Bluetooth equipment to connecting.
4. Once the connecting was finish and connect successfully, the Bluetooth LED indicator (2) will light up.
5. Start to playback your Bluetooth device and enjoy the music by the main unit.
6. Adjust the Volume + / - Button (5) to the desire level.

Remark:-

- Press the Power Button (4) to disconnect the Bluetooth connection and the unit will switch to Phono function.
- Press the play / pause / skip button of your Bluetooth device for operation.

SPECIFICATIONS

DC: 9V  2A

CARE AND MAINTENANCE

1. Avoid operating your unit under direct sunlight or in hot, humid or dusty places.
2. Keep your unit away from heating appliances and sources of electrical noise such as fluorescent lamps or motors.
3. Unplug the unit from the electrical power outlet immediately in case of malfunction.

CLEANING THE UNIT

- To prevent fire or shock hazard, disconnect your unit from the AC power source when cleaning.
- The finish on the unit may be cleaned with a dust cloth and cared for as other furniture, Use caution when cleaning and wiping the plastic parts.
- If the cabinet becomes dusty wipe it with a soft dry dust cloth. Do not use any wax or polish sprays on the cabinet.
- If the front panel becomes dirty or smudged with fingerprints it may be cleaned with a soft cloth slightly dampened with a mild soap and water solution. Never use abrasive cloths or polishes as these will damage the finish of your unit.

CAUTION: Never allow any water or other liquids to get inside the unit while cleaning.

Disclaimer

Updates to Firmware and/or hardware components are made regularly. Therefore some of the instruction, specifications and pictures in this documentation may differ slightly from your particular situation. All items described in this guide for illustration purposes only and may not apply to particular situation. No legal right or entitlements may be obtained from the description made in this manual.

Warning Statement

This device complies with part 15 of the FCC Rules. Operation is subject to the following two conditions: (1) This device may not cause harmful interference, and (2) this device must accept any interference received, including interference that may cause undesired operation.

Any Changes or modifications not expressly approved by the party responsible for compliance could void the user's authority to operate the equipment.

Note: This equipment has been tested and found to comply with the limits for a Class B digital device, pursuant to part 15 of the FCC Rules. These limits are designed to provide reasonable protection against harmful interference in a residential installation. This equipment generates uses and can radiate radio frequency energy and, if not installed and used in accordance with the instructions, may cause harmful interference to radio communications. However, there is no guarantee that interference will not occur in a particular installation. If this equipment does cause harmful interference to radio or television reception, which can be determined by turning the equipment off and on, the user is encouraged to try to correct the interference by one or more of the following measures:

- Reorient or relocate the receiving antenna.
- Increase the separation between the equipment and receiver.
- Connect the equipment into an outlet on a circuit different from that to which the receiver is connected.
- Consult the dealer or an experienced radio/TV technician for help.