

User Manual of Product 1:

VEVOR Power Benchtop Planers, Three-Blade, Two Speed, 13" Width Worktable Thickness Planer with Extended Infeeding Table, Low Noise for both hard & soft wood material removal

User Manual of Product 2:

POWERTEC UT1002 Universal Tool Stand

VEVOR®

Thicknesser

**M1B-LS-3305
USER MANUAL**

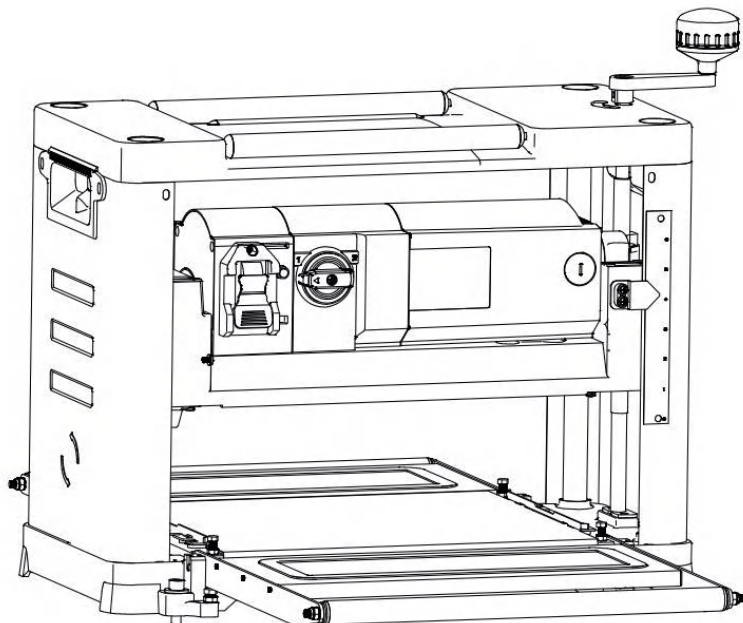

NEED HELP? CONTACT US!

Have product questions? Need technical support? Please feel free to contact us:



CustomerService@vevor.com

This is the original instruction, please read all manual instructions carefully before operating. VEVOR reserves clear interpretation of our user manual. The appearance of the product shall be subject to the product you received. Please forgive us that we won't inform you again if there is any technology or software updates on our product.

SAFETY INSTRUCTIONS

IMPORTANT: carefully read the instructions in this manual as well as the general safety instructions before using this tool.



Before using the tool, read the instruction book carefully.



Class II appliance, reinforced insulation or double insulation

Keep the packaging material out of the reach of children -- risk of suffocation.

WARNING ! Always take basic safety precautions when using power tools to safeguard against the risk of fire、 electric shock and /or personal injury.

- 1. For safe operation.** We recommend that you take appropriate measures for the protection of hearing if the sound pressure of 85dB (A) is exceeded
- 2. Keep the work area clean.** Cluttered work areas increase the risk of accidents and injuries.
- 3. Keep the workplace environment safe.** Do not use power tools in damp or wet areas. Do not expose power tools to rain. Make sure the work area is well lit. Do not use power tools in explosive environments, such as in the vicinity of flammable liquids、 gases or dust.
- 4. Protect against the risk of electric shock.** Avoid body contact with earthed surfaces, Such as pipes, radiators, cookers and refrigerators.
- 5. Keep children at a safe distance.** Do not allow onlookers to touch the tool or the extension cord. Onlookers should be kept away from the work area.
- 6. Put away tools that are not being used .** When not in use, store the tool in a dry place out of the reach of children.
- 7. Do not force the tool .** The tool does the job better and safer when used at the rate for which it was designed.
- 8. Use the correct machine.** Do not force small machines or accessories to perform jobs that require a powerful machine. Use tools only for their intended purpose.
- 9. Wear suitable clothing.** Do not wear loose clothing or jewellery. they can be caught in moving parts. Non-slip shoes are recommended when working outdoors. Wear a hair net if you have long hair.
- 10. Wear safety glasses.** Wear a dust mask if the work generates dust.
- 11. Be careful with the cable.** Never carry the tool by the cable. Do not pull the cable to disconnect the plug from the socket. Keep the cable away from heat、 oil and sharp edges.

12. Secure the workpiece. Secure the workpiece with stand. This is safer than using your hands and means you have both hands free to operate the tool.

13. Do not overreach. Always maintain a firm footing and good balance.

14. Maintain the tool in good care. Keep cutting tools sharp and clean for better, safer work. Follow the instructions for lubricating and for the replacement accessories. Check power cords regularly. If damaged, they must be replaced at an authorised service centre. Check extension cords at regular intervals and replace them if they are damaged. Keep the hands clean, dry and free from oil and grease.

15. Always unplug the power cord. when the tool is not being used, and before carrying out service work or changing accessories, such as knife blades/carbon brush/gears and so on.

16. Remove adjuster keys/spanners and other assembling tools. Remove adjuster keys/spanners and other assembling tools before starting the power tool.

17. Avoid accidental starting. Never carry a power tool with your finger on the switch when it is connected to the mains. Make sure the power switch is in the OFF position before plugging in the power cord.

18. If using the tool outdoors. only use an extension cord approved for outdoor use.

19. Stay alert . Always be careful when using the equipment. Use your common sense ,Do not use the tool if you are tired.

20. Connect dust extraction equipment . If dust extraction and dust collection equipment is provided. This should be connected and used correctly.

21. Check for damaged parts. If a guard or some other part has been damaged, check carefully before using the tool to ensure that it will operate correctly and as intended. Make sure that moving parts are properly adjusted and do not jam and that no parts are incorrectly fitted or damaged. Check for any other factors that could influence functionality. Guards or other parts that are damaged must be repaired or replaced by an authorised service centre. Unless otherwise specified in these instructions. If the power switch does not work, it must be replaced by an authorised service centre. Do not use the tool if it cannot be switched on and off using the power switch.

WARNING! The use of accessories or attachments other than those recommended in these operating instructions can result in personal injury. Repairs must only be carried out by qualified personnel. This power tool has been manufactured in compliance with current safety standards and requirements. Repair may only be carried out by qualified personnel using identical spare parts. Failure to carry out repairs correctly can result in the risk of personal injury/death or material damage.

NOTE: A temporary voltage drop can occur when starting the machine. Which could affect other equipment. If the main supply impedance Z_{max} is lower than 0.206ohms, this kind of interference is common. Contact your electricity supplier for more information.

IMPORTANT SAFETY INSTRUCTIONS

1. Wear safety glasses, Don't sent wood into outfeed side.
2. Before use, check that all screws connections are properly tightened.
3. Do not force the tool. Let the feed mechanism do the work. Never insert objects or body parts in the outfeed.
4. Check regularly that the rubber roller and iron roller are clean. If the rollers are contaminated the workpiece will not infeed correctly- risk of persona injury.
5. Do not machine workpieces with many knots or sprigs.
6. The operating position is in front of the machine. Stand by the side of the infeed table.
7. Remove any nails,screws and other metal objects from the workpiece before machining.
8. Check that the blades are correctly installed.
9. Handle the knife blades with care--risk of personal injury and/or damage to property.
10. Never start to planer until the blade shaft has reached full speed.
11. Never use blunt blades-risk of kickback.
12. Always replace or sharpen all blades at the same time. All blades must be of the same size and weight.
13. Never insert your fingers or other body parts in the chip outlet side--risk of personal injury-- DANGER.
14. Pls check the recoil claw is in the correct position.
15. If infeed wood not smooth,pls don't force the wood,check if machine have some problems.
16. Do not wear gloves to plane wood.
17. Do not plane wet wood, will cause the feed roller to slip and lead machine broken.
18. Do not plane hardness wood, will shorten the working life of the knife blades.
19. Do not plane the wood too long, the machine will be overloaded,infulence the wood planing surface effect.

TECHNICAL DATA

Model :	M1B-LS-3305	M1B-LS-3305
Specs:	For US user	For European users
Rating(s):	110V~60Hz 2000W	230V~50Hz 2000W
First Feed Speed:	≥4.3m/min	≥4.3m/min
Second Feed Speed:	≥7.0m/min	≥7.0m/min
blade:	3pcs	3pcs
Max.planing width:	330mm	330mm
Planing depth:	0-3mm	0-3mm
Planing height:	6-160mm	6-160mm
G.W:	30kg	30kg
N.W:	28kg	28kg
Working table size:	330x290mm	330x290mm
Packing size:	570×360×505mm	570×360×505mm
Tested wood width is 150mm for feeding speed		

DESCRIPTION

1. The tool is designed for planing wooden planks and dry wood. It is forbidden to plane other materials. such as metals、 plastics、 branches、 tree trunks、 wet wood and very hard wood.
2. The tool is intended for household and professional use .
3. Pls use this machine under correct operation, if don't know how to use it, pls contact with factory.

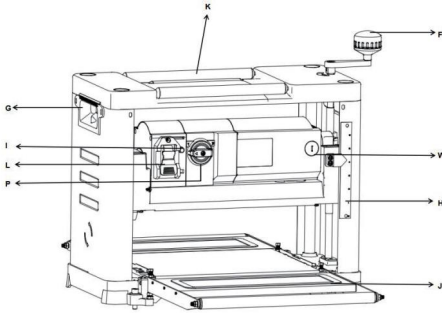

E-Knife blade bit gauge

H-depth label

K-Roller bar

N-Open spanner

P-Speed control knob

Advised wear ear protection.

Advised wear safety glasses.

Advised wear dusk mask.

F-Depth adjustment handle

I-Overcurrent protective device

L-Switch

O-Rubber feet

G-Carrying handle

J-Extension table

M-Allen wrench

W-Carbon brush cover



OPERATION STEPS

Unpacking

Carefully unpack the machine. The packaging must be recycled in accordance with local regulations.

WARNING! Turn off the machine and unplug the power cord before cleaning , performing maintenance and adjustment.

Assembly

Before using the machine must be in accordance with the requirements of the assembly complete.

Evacuation of shavings and wooddust:

The tool is equipped with a dust hood with vacuum cleaner connection (V),this dust hood at the back of the machine for connection to a vacuum cleaner connection. A flexible hose(not supplied) can be connected to the collector . Some species of wood or processed wood produce sawdust harmful to health.

Pls attention: Always use the tool must be connected to a vacuum cleaner.

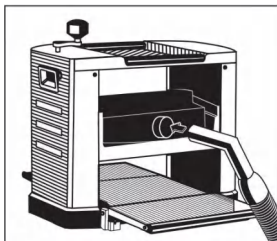

Install rubber feet (O):

If no need use foot frame to working ,pls put 4pcs rubber feet into the fourholes in the bottom of the machine.

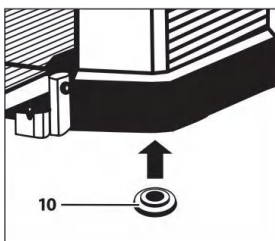

Install depth Adjustment handle

Place the depth adjustment handle (F) on the protruding shaft to the right of the machine's top surface. Push on the handle firmly and lock it with the supplied screw.



Adjust depth of the planer

In order to be able to completely correct and safe operate this machine, User must be know how to correct adjust. Very Important!!!

Rotate the depth adjustment handle(F) a circle, the machine depth can be rised or lowered by 1.5 mm.

Adjust speed controller (P)

This machine has a two-speed function. 1 and 2 speed adjustment level,

Position 1: wood feed speed 4.3M/minutes. planer big hardness wood.

Position 2: wood feed speed 7M/minutes, planer normal hardness wood.

under machine stop state, Use your thumb to press the governor button and rotate clockwise to position 2.

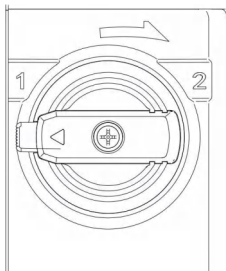

Before using, pls plane the wood a few times, that's can be ensure the surgace of the wood is completely horizontal in later use. Please refer to the correct wood width range to adjust the depth of the one-time planer:

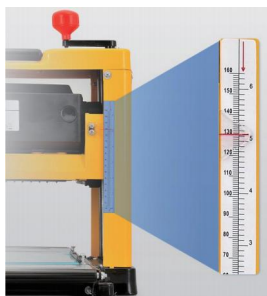

width of wood (mm)	cutting depth (mm)
0~100	0~3
160~210	0~2
210~330	0~1



At first, user needs a ruler to measure the thickness of the wood to be planed, Then observation depth label (H) to adjust the depth label to the thickness of the planer required by the user.

Such as: the thickness of wood it's 200mm, user wants to planer 2mm, so depth label pointer is at 198mm, In this way, the thickness required by the user can be reached during the one- time working process.

Pls note: The distance between the bottom of the machine and the knife shaft is the thickness of the wood when it is planed; The difference between the thickness of the wood when it comes out of the machine and the thickness when it comes in is the thickness of the wood that was shaved off.

1. Width of wood 0-100mm, we suggest cutting depth adjust 0-3mm, Max 3mm per time.
2. Width of wood 160-210mm, we suggest cutting depth adjust 0-2mm, Max 2mm per time.
3. Width of wood 210-330mm, we suggest cutting depth adjust 0-1mm, Max 1mm per time.

Warning! The length of the wood must not be less than 153mm. The thickness of the wood must not be less than 10mm.

Operate switch (power ON/OFF)

Plug the power cord into the mains supply. If you are using an extension cord, the cross section of the conductors must be sufficient for the tool's power supply. Avoid inappropriate use of cable. as this can lead to voltage drop and cause power loss and over heating.



Up press the button marked “I” to start the machine. Down press the button marked “O” to stop the machine.

OPERATION

Coarse PLANING

Coarse planing is used to provide a reference surface for machining.

1. Set a small removal setting for the best surface finish.
2. Process where possible along the grain.

Note :the surface finish is affected by various factors.

1. the wood's hardness,moisture content,fibre structure. etc.
2. Blade sharpness,machining direction,material removal per pass. etc.
3. Perform test machining to find the best setting.

PLANING

Planing involves material removal of the workpiece to the desired thickness, the machining of the surface opposite a coarse planed reference surface.

MAINTENANCE

WARNING : Turn off the machine and unplug the power cord before cleaning and maintenance, Do not use water or other liquids to clean electrical parts.

CHECK AND REPLACING THE CARBON BRUSH

1. Turn off the machine, unplug the power cord and wait until all moving parts have stopped completely.
2. Dismantle the carbon brush cover (W) as illustrated using a screw driver.
3. Fit the new carbon brushes. Always replace both carbon brush at the same time.
4. Replace the carbon brush cover (W).

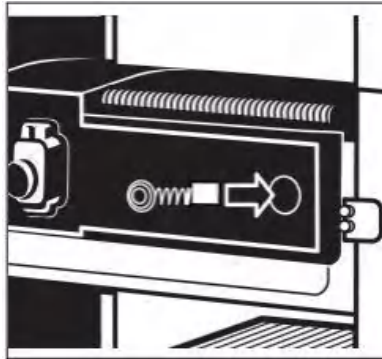

Overcurrent protective device correct use and replacement (I)

When the load power is too large, the current exceeds the load, so the overcurrent protective device will jump!

1. When the overcurrent protective device jump, first disconnect the power supply of the machine, then press the protective button to reset it
2. When press the protective button to reset it, don't reboot immediately. Need wait for the machine temperature to cool then start for use.
3. If overcurrent protective device jump frequently. Pls replacement a new.

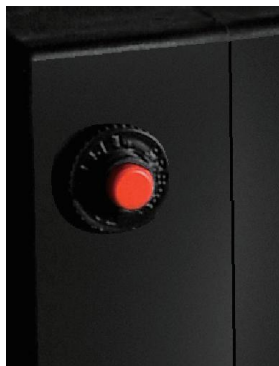

ADJUST TABLE EXTENSION (J)

Attention: this adjustment is already factory set ok ,in order to avoid to effecting the function of the machine . need to check again.

1. Put the engine body rise to a suitable height , so that it is easily assembly.
2. Place a horizontal rule on the main worktable, use rule to measure the table extension (J) and main worktable's level.
3. If the table extension (J) are not flush with the main worktable, loosen the nut and turn the screw until table extension's rollers and the main worktable touch the ruler, Adjust both the left and right -hand table extensions (J).



ENGINE BODY LEVEL ADJUSTING

ATTENTION: This adjustment is already factory set ok. in order to avoid effecting the function of the machine. need to check again. Poor parallelism is usually caused by misaligned blades or A fall in transit caused the body to tilt. Always check that the blade holder and the work table parallel before attempting to adjust the parallelism setting.

Engine body is lowered to a certain height by rotating the handle, two wooden blocks of the same height are placed at the lower end of the body and clamped tightly

1. Loosen the two screws on the handle of the right panel using a cross screwdriver, see picture 1 Attention: only need adjusting right panel
2. Take off right pane
3. Use 24mm open wrench +30mm open wrench to adjusting engine body up and down. Position 1 use 24mm open wrench, position 2 use 30mm open wrench. 24mm open wrench clamp 24mm nut do not rotate and turn the 30mm open wrench one turn to the left (clockwise) to keep the screw nut loose
4. Use 24mm open wrench adjust 24mm nut, rotate clockwise to raise the engine body and counterclockwise to down the engine body, Until the engine body is level with the base
5. Use 24mm open wrench clamp 24mm nut do not rotate, use 30mm open wrench tighten 30mm nut

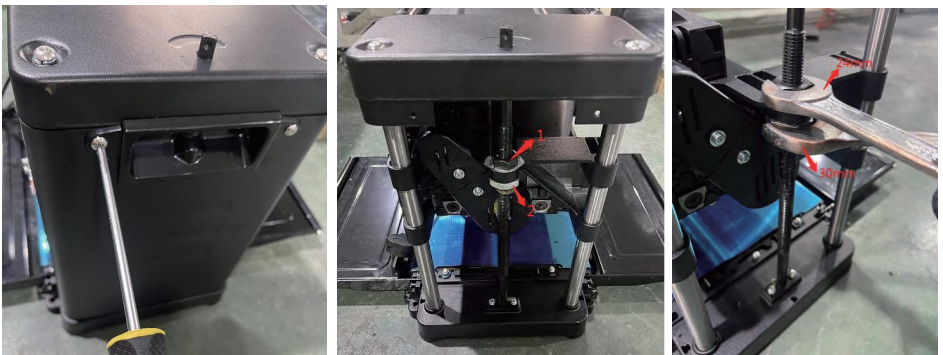

Replacing and Adjusting the blades

WARNING ! Turn off the machine, unplug the power cord and wait until all moving parts have stopped completely before replacing or adjusting the blades.

Dismantling the knife blade

1. Use allen wrench (N) to remove the dust hood (V) by loosening the screws (U), see below picture.
2. Use the double open wrench (N) to loosen the blade locking plate (B) and knife blade (C) by turning the outer hexagon bolt (A) clockwise. The knife blades are spring-loaded (D) and can be removed when the blade locking plate is removed.
3. Remove the knife blade and blade locking plate.

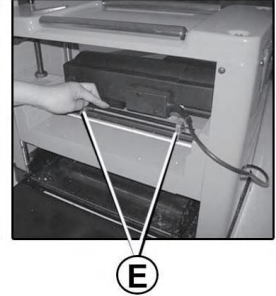
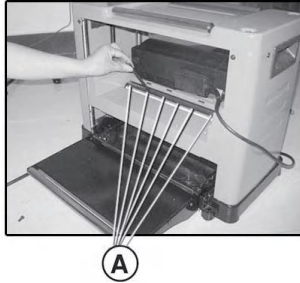
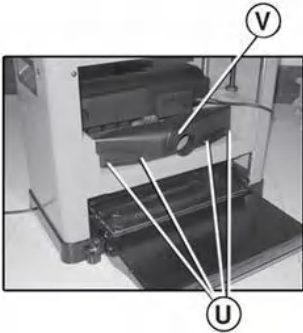

Install the knife blade

1. First ensure that the pressure springs (D) on the knife shaft are in the 2 fixed holes.
2. Align the hole in the knife blade with the pin in the blade locking plate.
3. Insert the 8 outer hexagon bolt (A) into the fixed hole of the blade locking plate.
4. Insert the knife blade (C) and knife locking plate (B) and 8 outer hexagon bolt (A) together in the slot and lock in position by turning the outer hexagon bolt (A) anticlockwise but not 100% tighten. Ensure that the blades face in the right direction (see picture).
5. Set the height of the knife shaft of the knife blades as 1mm with the bit gauge (E). That two support blocks on left and right side of bit gauge are pressed against the knife blade. (Loosen, if necessary, the clamping screws to move the blade to the correct position.) When the knife blade is positioned correctly. Hold it firmly in place and tighten all outer hexagon bolt (A).

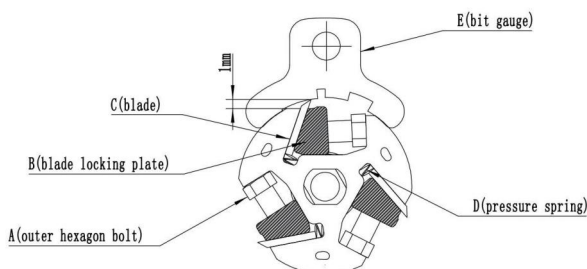

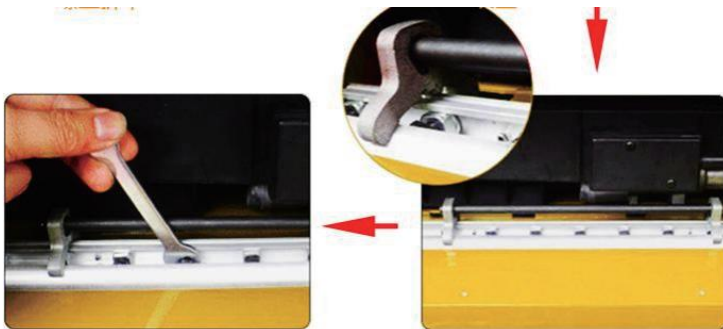

Warning! Check that total 24 screws are tightened. Turn the blade holder by hand to check that it rotates easily and smoothly. Handle the blades with caution to avoid personal injury and/or damage to property.

LUBRICATION :

1. Regularly remove shavings from the depth setting chains, reduction drive and lifting screws for the blade holder.
2. Remove chips with a cloth and brush and lightly grease with a clean brush dipped in oil.
3. Never pour oil directly on the components-- too much oil means dust will stick and impair lubrication, which in turn shortens component life.
4. The blade holder's bearings are sealed and must not be lubricated.

MAINTENANCE

1. Keep the machine clean and free of dust and chips.
2. Clean reapped materials from the blade holder and tongues and carefully lubricate with a clean brush dipped in oil.
3. Remove resin and the like from the rollers and work table with a non-flammable solvent.
4. Clean plastic parts with a damp cloth and mild detergent. Never immerse the tool in water or any other liquid. Never use detergents or alcohol.
5. Always check that all guards and other components are correctly fitted before use. Guards or other parts that are damaged must be repaired or replaced by an authorised service centre, unless otherwise specified in these instructions.

This product is subject to the provision of european Directive 2012/19/EC. The symbol showing a wheelie bin crossed through indicates that the product requires separate refuse collection in the European Union. This applies to the product and all accessories marked with this symbol. Products marked as such may not be discarded with normal domestic waste, but must be taken to a collection point for recycling electrical and electronic devices.



Manufacturer: ZHEJIANG LANGCHENG INDUSTRY&TRADE CO., LTD
Address: No.18 Weisan East Road, Hardware Machinery Industrial Zone,
Tongqin Town, Wuyi County, Jinhua City 321201 Zhejiang, P.R.China
Importer: WAITCHX
Address: 250 bis boulevard Saint-Germain 75007 Paris
Importer: FREE MOOD LTD
Address: 2 Holywell Lane, London, England, EC2A 3ET

UK	REP	EUREP UK LTD UNIT 2264, 100 OCK STREET, ABINGDON OXFORDSHIRE ENGLAND OX14 5DH
EC	REP	EUREP GmbH Unterlettenweg 1a, 85051 Ingolstadt, Germany

VEVOR[®]

E-mail: CustomerService@vevor.com

Owner's Manual

POWERTEC®

UNIVERSAL STAND



Visit us on the web at **powertecproducts.com**



You will need this manual for safety instructions, operating procedures, and warranty. Put it and the original sales invoice in a safe, dry place for future reference.

TABLE OF CONTENTS

SECTION

PAGE



SAFETY RULES

1



ASSEMBLY

2

Unpacking
Assembly
Application



MAINTENANCE

4

General Maintenance



PARTS ILLUSTRATION & LIST

4



WARRANTY

5

PRODUCT SPECIFICATIONS

Model No.	UT1002	
Top (with wood top)	A	25" x 14" (635 x 356 mm)
Leg Spacing	B	32" x 22-3/4" (813 x 578 mm)
Height (with wood top)	C	32-1/8" (816 mm)
Shelf		27" x 18" (686 x 457 mm)
Shelf height		16-1/4" (413 mm)
Weight		24 lbs (10.9 kg)

Figure 1

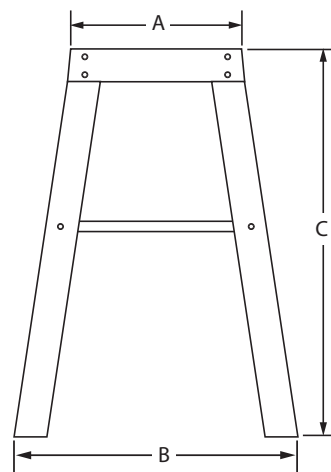
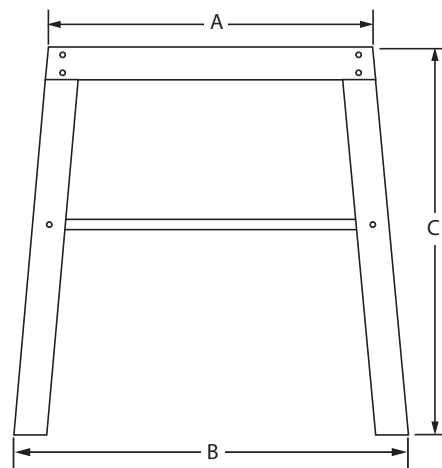

SAFETY RULES



1

WARNING

- Do not use for scaffolding or as ladder. Do not stand or climb on the universal stand; it could tip over, causing serious injury.
- Do not overload. The maximum capacity for the universal stand is 500 lbs (227 kg).
- Do not apply an unbalanced load. This could cause the universal stand to tip over.
- Store the stand properly. Do not store the universal stand outdoors or in a damp location.
- Keep the work area clean, uncluttered, and well lit. Do not work on or place the universal stand legs on floor surfaces that are slippery from sawdust, oil, water or wax.
- Keep children and bystanders away while operating a power tool. Distractions may cause you to lose control. Visitors should wear the same safety equipment as the operator.
- When using a power tool with the universal stand, always follow the safety instructions in the power tool's operator's manual.
- Always wear safety glasses or eye shields when operating power tools.
- Dress properly. Do not wear loose clothing or jewelry. Keep your hair, clothing and gloves away from moving parts. Loose clothes, jewelry or long hair can be caught in moving parts. Always wear non-slip footwear. Tie back long hair. Roll long sleeves above the elbow.
- Always use clamps or other practical ways to support the work piece and secure it to a stable platform. Holding the work piece by hand or against your body is unstable and may lead to loss of control.

- Check all hardware prior to mounting any bench top tools.
- Inspect all hardware periodically and tighten any that may be loose.
- Be sure to use the proper mounting bolts for the unit being attached to the stand.

WARNING

For your own safety, read all of the rules and precautions before operating tool.

WARNING

Do not modify this tool and/or use it for any application other than that for which it was designed.

WARNING

Always follow proper operating procedures as defined in this manual even if you are familiar with use of this tool stand or any tool used with this stand. Remember that being careless for even a fraction of a second can result in severe personal injury.

You must be familiar with the use of any tool or accessory used with this stand. The supplier cannot be held responsible for any accident, injury or damage incurred while using this stand with any tool.

READ AND SAVE THESE INSTRUCTIONS



1

2

ASSEMBLY

UNPACKING

Refer to Figure 2

Your new universal stand is shipped complete in one carton.

- Examine shipping carton for freight damage before opening. If shipping carton is damaged file a claim with the carrier immediately.
- Carefully unpack all loose items from the shipping carton and make sure all parts are accounted for.

ITEM	DESCRIPTION	QTY
A	Short upper cross brace	2
B	Table top (two pieces)	2
C	Short lower cross brace	2
D	Long lower cross brace	2
E	Long upper cross brace	2
F	Leg	4
G	Feet	4
H	Shelf (two pieces)	2
I	Pan head wood screw (table top)	10
J	Washer (table top)	12
K	Hex bolt (frame assembly)	24
L	Nut (frame assembly)	24
M	Pad (adjustable foot)	1
N	Countersink screw (adjustable foot)	1
O	Nut (adjustable foot)	2
P	Washer (adjustable foot)	1
Q	Washer (frame assembly)	24

Figure 2

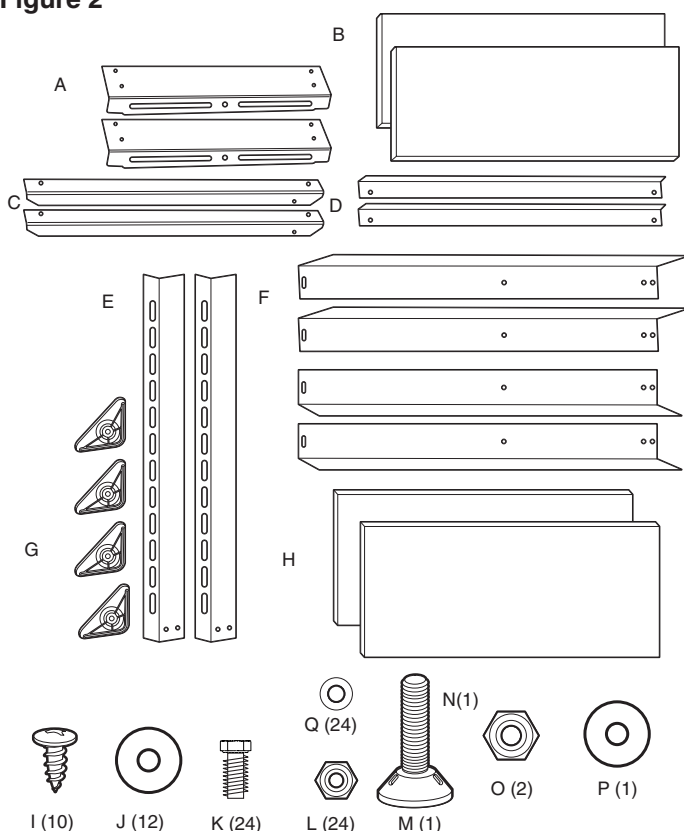

ASSEMBLY

Refer to Figure 3 - 5

⚠ WARNING

Do not use this universal stand for scaffolding or as a ladder. Make sure to tighten all screws securely prior to use. Maximum capacity is 500 lbs (227 kg).

NOTE: Use hex bolts, washers and nuts to assembly all components except the tabletop and leveling device.

NOTE: Do not fully tighten hardware until the stand is completely assembled. Always insert bolts from outside.

- Assemble one long upper cross brace to two legs using hex bolts, washers and nuts.
- Assemble the long lower cross brace to the two legs. Make sure the long lower cross brace is positioned so the flange creates a ledge for the shelf.
- Repeat assembly on other two legs, long bottom and top braces.

Figure 3

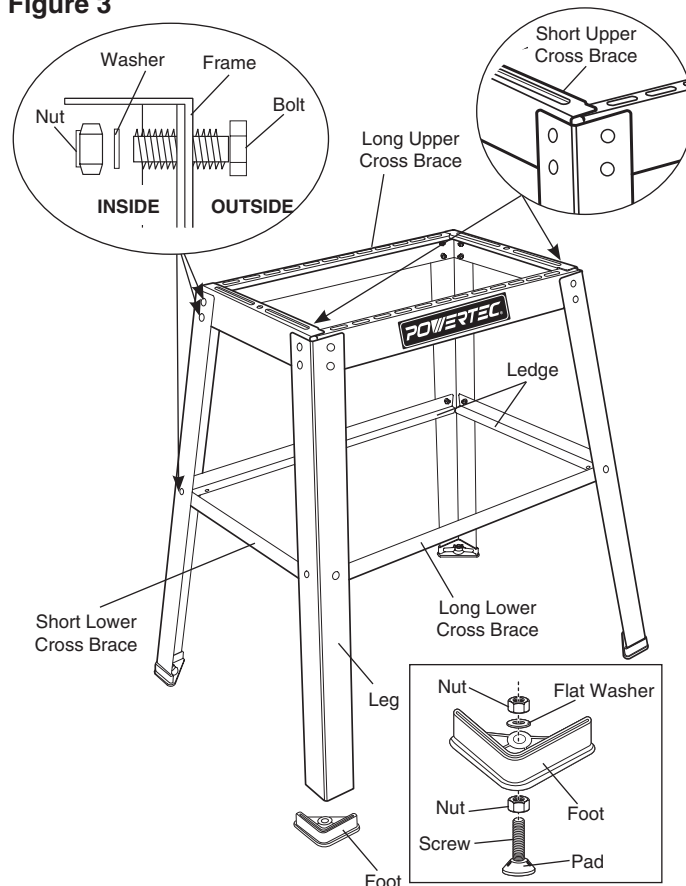

- Connect the four legs with the short top and bottom braces using hex bolts, washers and nuts. Make sure the short upper cross braces overlap the long upper cross braces as shown Figure 3 inset and the short lower cross braces are positioned so the flange creates a ledge for the shelf.
- Tighten all hardware.

- Hardware is supplied to make one of the feet adjustable. Insert the screw head into the pad, thread the nut onto the screw, now assemble the foot, flat washer and nut, Figure 3, inset.

NOTE: Adjust the foot by moving the nut on the screw up or down. If needed the feet can be interchanged to place the adjustable foot on any leg.

- Install feet to the bottom of the legs. Figure 3

NOTE: The table top will adjust from 14" to 20" for mounting larger bench tools. See **Table Top Adjustment** under **Applications**.

- Place the front and rear table top boards face down on a flat surface. Make sure the ruler printed on the table top is correct.
- Position the assembled frame onto the table top.
- Align the pre-drilled holes in the bottom of the table top with the slots in the top short braces. Attach the table top to the short upper cross braces using the eight wood screws and eight washers. Figure 4.

Figure 4

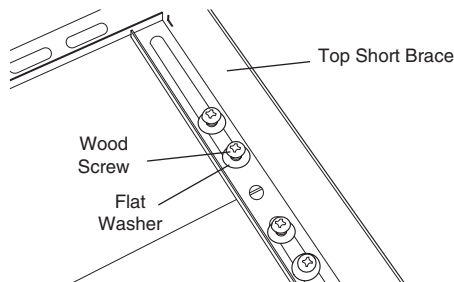

- Align the center pre-drilled holes in the table top with the slots in the long upper cross braces and secure with two wood screws and four washers. One additional washer is placed between the long upper cross brace and the table top.
- Turn the stand to the upright position.
- Slide the bottom shelves into place. Make sure they rest on the ledge. Figure 5

Figure 5

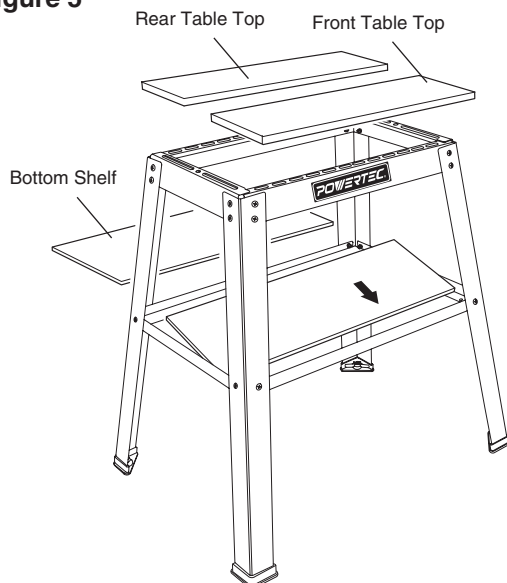

NOTE: Contact the customer service center if any of these parts are missing.

NOTE: After unit is assembled dispose of all packaging material in an environmentally safe way.

APPLICATIONS

⚠ WARNING

Do not use the universal stand for scaffolding or as a ladder. Make sure to securely tighten all fasteners before using. Maximum capacity is 500 lbs (227 kg). Power tools on the universal stand should not exceed a combined overall height of 60" (152.4 cm) from the floor.

When using the universal stand with a table saw, adjust the table top to the largest opening so debris does not accumulate.

Drill holes as needed into the table top. Mount all power tools with nuts and bolts (not supplied).

⚠ CAUTION

Be careful not to drill into the braces when drilling holes.

TABLE TOP ADJUSTMENT

Refer to Figure 6

NOTE: Assemble the table top in one of three positions. For a solid surface, place the edges of the table top boards together. For mounting larger bench tools adjust the table top to 14" or 20".

- Loosen the eight screws on the short upper cross braces. Remove the two screws and washers securing the center of the long upper cross braces to the stand.
- Slide the table top out and align the center of the long upper cross braces with the pre-drilled holes at 14 or 20". Secure in place with the two wood screws and four washers. One additional washer is placed between the long upper cross brace and the table top.
- Tighten all of the fasteners.

Figure 6





MAINTENANCE

GENERAL MAINTENANCE

WARNING

When servicing, use only identical replacement parts. Use of any other parts may create a hazard or cause product damage. To ensure safety and reliability, all repairs should be performed by a qualified service technician.

WARNING

Keep the universal stand dry, clean, and free from oil and grease. Always use a clean cloth when cleaning. Never use brake fluids, gasoline, petroleum based products or any strong solvent to clean the universal stand . Chemicals can damage, weaken or destroy plastic which may result in serious personal injury

4 UNIVERSAL STAND PARTS ILLUSTRATION & LIST

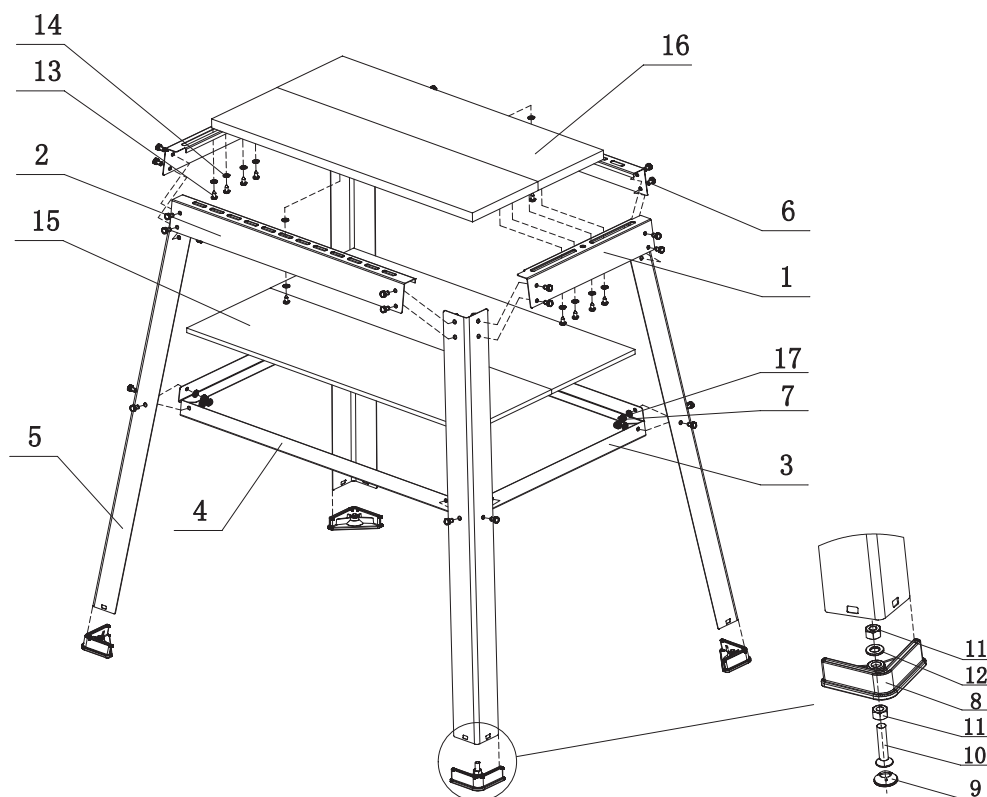

Key No.	Part No.	Description	Qty	Key No.	Part No.	Description	Qty
1	UT1002001	Short upper cross brace	2	10	UT1002010	Countersink screw (M8*40)	1
2	UT1002002	Long upper cross brace	2	11	UT1002011	Nut (M8)	2
3	UT1002003	Short lower cross brace	2	12	UT1002012	Washer 8 mm	1
4	UT1002004	Long lower cross brace	2	13	UT1002013	Pan head wood Nut (ST5.8x14)	10
5	UT1002005	Leg	4	14	UT1002014	Washer 6 mm	12
6	UT1002006	Hex bolt (M6*10)	24	15	UT1002015	Shelf (two pieces)	1
7	UT1002007	Nut (M6)	24	16	UT1002016	Tabletop (two pieces)	1
8	UT1002008	Feet	4	17	UT1002017	Washer	24
9	UT1002009	Pad	1				

WARRANTY

1 5

WARRANTY

Thank you for investing in a **POWERTEC** power tool. This product has been designed and manufactured to meet high quality standards and is guaranteed for domestic use against defects in workmanship or material for a period of 1 year from the date of purchase. This guarantee does not affect your statutory rights.

SOUTHERN TECHNOLOGIES LLC. BENCH TOP AND STATIONARY POWER TOOL LIMITED ONE YEAR WARRANTY AND 30-DAY SATISFACTION GUARANTEE POLICY

POWERTEC products are designed and manufactured by **Southern Technologies LLC**. All warranty communications should be directed to **Southern Technologies LLC** by calling 847-780-6120 (toll free), 9 AM to 5 PM, Monday through Friday, US Pacific Time.

1 5

30- DAY SATISFACTION GUARANTEE POLICY

During the first 30 days after the date of purchase, if you are dissatisfied with the performance of this **POWERTEC** tool for any reason, you may return the tool to the retailer from which it was purchased for a full refund or exchange. You must present proof of purchase and return all original equipment packaged with the original product. The replacement tool will be covered by the limited warranty for the balance of the one year warranty period.

LIMITED ONE YEAR WARRANTY

This warranty covers all defects in workmanship or materials in this **POWERTEC** tool for a one year period from the date of purchase. This warranty is specific to this tool. **Southern Technologies, LLC** reserves the right to repair or replace the defective tool, at its discretion.

HOW TO OBTAIN SERVICE

To obtain service for this **POWERTEC** tool you must return it, freight prepaid, to **POWERTEC**. You may call (toll free) 847-780-6120 for more information. When requesting warranty service, you must present the proof of purchase documentation, which includes a date of purchase. **POWERTEC** will either repair or replace any defective part, at our option at no charge to you. The repaired or replacement unit will be covered by the same limited warranty for the balance of one year warranty period.

WHAT IS NOT COVERED

This warranty applies to the original purchaser at retailer and may not be transferred.

This warranty does not cover consumable items such as saw blades, knives, belts, discs, cooling blocks and sleeves. This warranty does not cover required service and part replacement resulting from normal wear and tear, including accessory wear.

This warranty does not cover any malfunction, failure or defect resulting from:

- 1) misuse, abuse, neglect and mishandling not in accordance with the owner's manual.
- 2) damage due to accidents, natural disasters, power outage, or power overload.
- 3) commercial or rental use.
- 4) alteration, modification or repair performed by persons not recommended by **POWERTEC**.

DISCLAIMER

To the extent permitted by applicable law, all implied warranties, including warranties of MERCHANTABILITY or FITNESS FOR A PARTICULAR PURPOSE, are disclaimed. Any implied warranties, that cannot be disclaimed under state law are limited to one year from the date of purchase. **Southern Technologies LLC**. is not responsible for direct, indirect, incidental or consequential damages. Some states do not allow limitations on how long an implied warranty lasts and/or do not allow the exclusion or limitation of incidental or consequential damages, so the above limitations may not apply to you. This warranty gives you specific legal rights, and you may also have other rights which vary from state to state. **Southern Technologies LLC.**, makes no warranties, representations, or promises as to the quality or performance of its power tools other than those specifically stated in this warranty.

POWERTEC®

Southern Technologies, LLC
Chicago, Illinois 60606