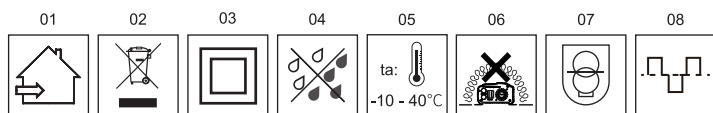

**BYGD**

DC to AC Power inverter

P series model
Last update: 10/23/2020**EN SAFETY INSTRUCTIONS—PART B**

Always consider all the technical specifications of the fitting. Verify the stated icons on the identification label on the fitting and the icons that are shown in part A of your safety instructions.

ATTENTION: Below you will find all the explanations with numeric reference to the icons at the front of these safety instructions:

01 - This fitting should only be installed indoors.

02 - WEEE 2012/19/EU.

03 - Protection class II: the fitting is double insulated and must not be connected to an earth.

04 - The product is not suitable for use under dust and moisture.

05 - Ambient temperature: -10 - 40°C

06 - The product is not suitable for covering with thermally insulated material.

07 - A safety isolating transformer between the primary circuit and secondary circuit.

08 - output wave type: modified sine wave.

09 - The power switch should be "OFF" position due intention to clean the power inverter with a dry cloth duster, do not use abrasives or solvents. Avoid liquid on all electrical parts.

10 - This product is designed for general power inverter service (excluding for example explosive atmospheres).

EN DECLARATION

Warning: This power inverter is not designed for use with hair dryers, power tools, heaters and other high power products. If used continuously do not exceed the rated power of converter.

Declaration of conformity: Hereby, BYGD declares that the whole equipment type P series model power inverter system is in compliance with Directive 2014/35/EU. This BYGD product complies with all applicable standards and regulations regarding exposure to electromagnetic fields. In the event of construction faults or material damages, the manufacturer guarantees up to 18 months for power inverter (unless otherwise stated on the packaging). Broken fuse and supply wire do not fall under the guarantee terms. Any damage caused to the light fitting in extreme conditions (coastal areas, industrial surroundings, farm environments) will not be covered by the guarantee. The period of guarantee starts from the purchase date and is only valid on presentation of the receipt.

The guarantee is void if the fitting was not installed according to the instructions, or if it has been repaired or modified.

The manufacturer does not accept any liability for damage caused as a result of misuse or incorrect application of the fitting.

(WEEE) Disposal of your old product: Your product is designed and manufactured with high-quality materials and components, which can be recycled and reused. When this crossed-out wheelie bin symbol is attached to a product, it means that the product is covered by European Directive 2012/19/EU. Please find out about your local collection system for electrical and electronic products. Please act according to your local rules and do not dispose of your old products with your normal household waste.

The correct disposal of your old product will help to prevent potential negative consequences for the environment and human health.

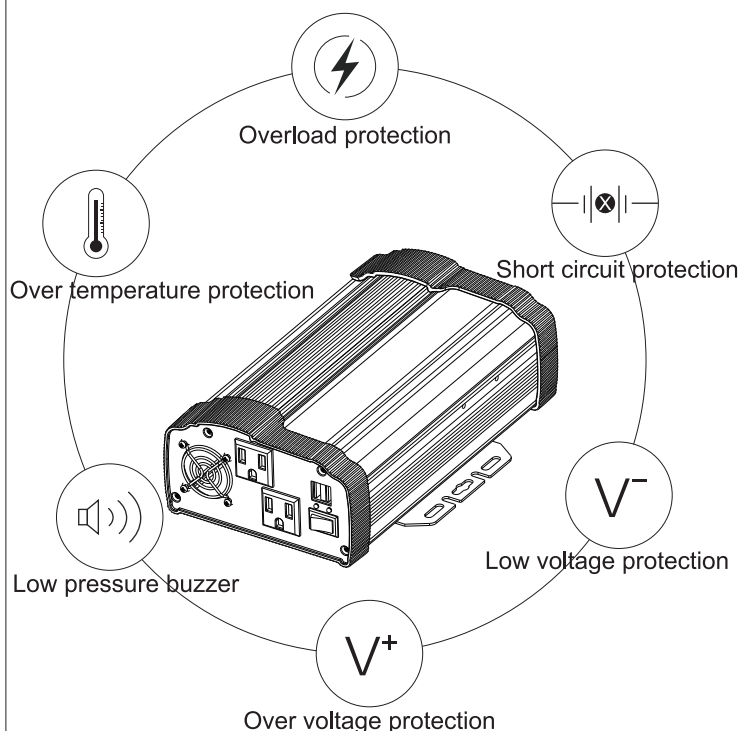
EN PROTECTION FUNCTION**EN SPECIFICATION**

Model	P800U	P1000U	P1200U	P1500U
Input rated voltage	DC 12 V (limit: DC 11 V - 15 V)			
Output rated voltage	AC 100 V / 110 V / 220 V - 240 V			
Output rated frequency	55 Hz / 60 Hz / 50 Hz			
USB output	DC 5 V 2100 mA max			
Output rated power	800 W	1000 W	1200 W	1500 W
Peak of surge power	1600 W	2000 W	2400 W	3000 W
Overload protection	900 W max	1125 W max	1470 W max	1605 W max
Output wave type	Modified sine wave			
Output rated efficiency	> 85%			
No working input current	< 0.05 A max			
Input low voltage alarm	10.5 V (limit: ±0.3 V)			
Input low voltage shut down	DC 9.5 V (limit: ±0.3 V)			
Input over voltage shut down	DC 15.5 V (limit: ±0.5 V)			
External fuse	25 A x 4	30 A x 4	35 A x 4	40 A x 4
Ambient temperature	-10 - 40°C			
Cooling method	Fan / Metal enclosure			
Accessories	Battery clip cable			Leadwire



BYGD
DC to AC Power inverter

P series model
Lastupdate:10/23/2020

User manual

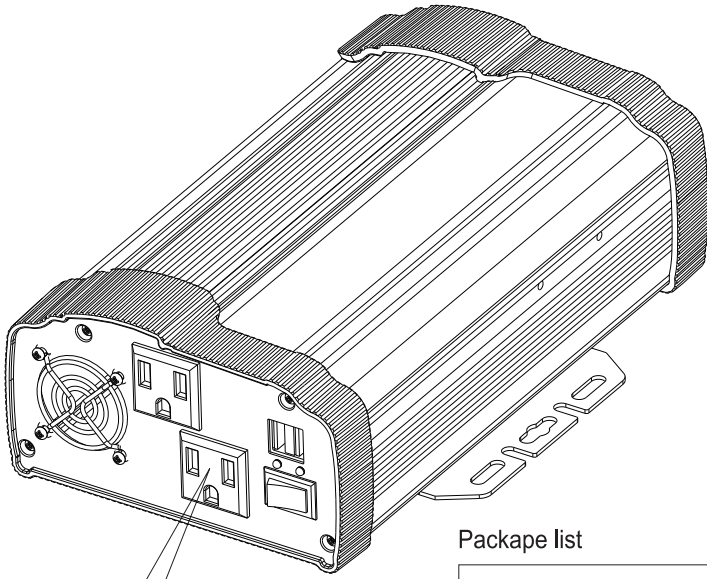

Package list

- Power inverter x 1
- Clip wire x 1
- Cigarette end line x 1
- External fuse bag x 1

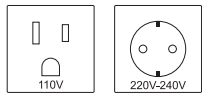

The power inverter images are for reference only and do not represent the actual product. Please refer to the final product in the box.

EN DIMENSION

	800 W	1000 W	1200 W	1500 W
L	212 mm	250 mm	285 mm	285 mm
W	167 mm	137 mm	167 mm	167 mm
H	78 mm	78 mm	78 mm	78 mm
Weight	1.35 kg	1.73 kg	2.0 kg	2.0 kg

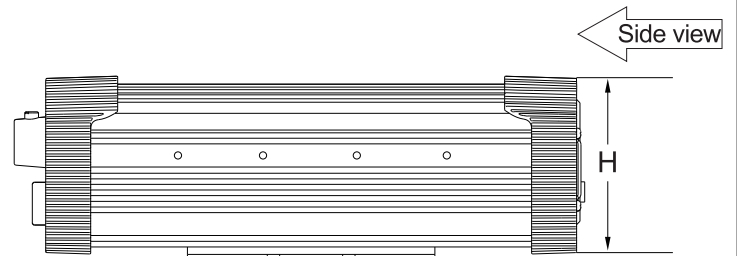
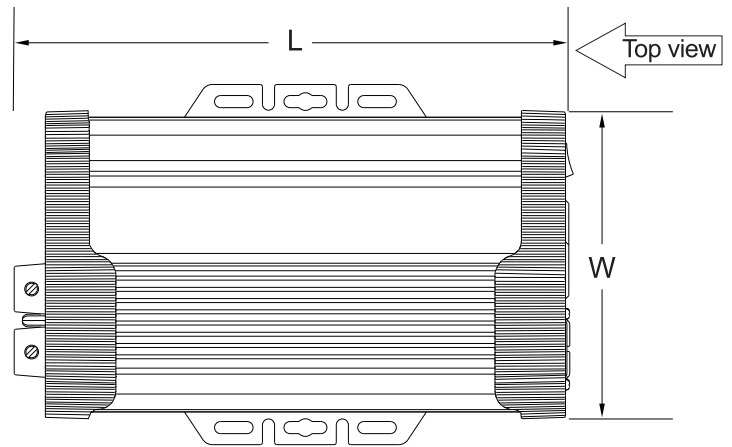

EN PRODUCT DISPLAY

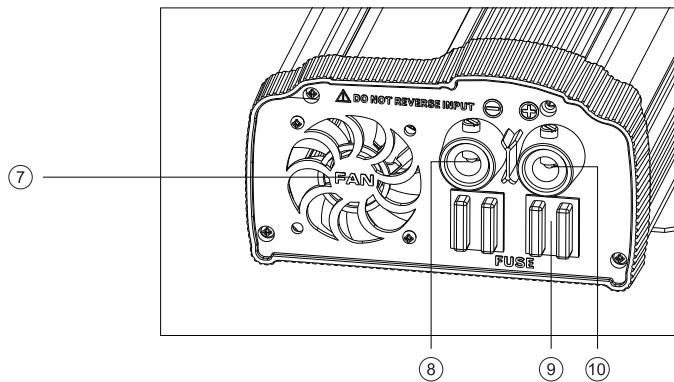
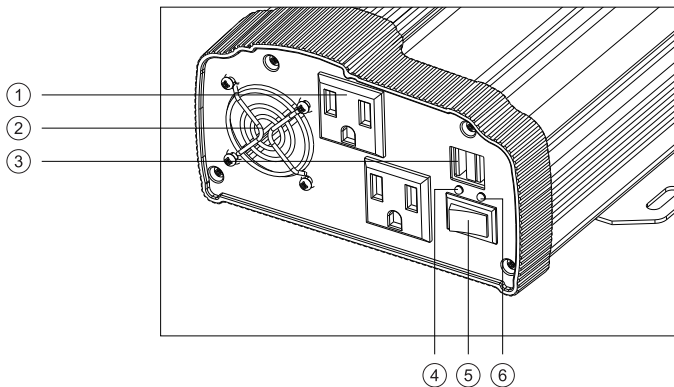

- ① AC output socket
- ② Fan
- ③ USB port
- ④ Power light (green)
- ⑤ Power switch
- ⑥ Fault light (red)
- ⑦ Fan
- ⑧ "-" DC connect Terminal (black)
- ⑨ External fusel
- ⑩ "+" DC connect Terminal (red)

EN INSTALLATION

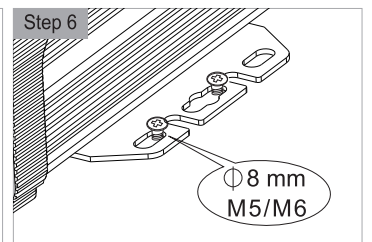
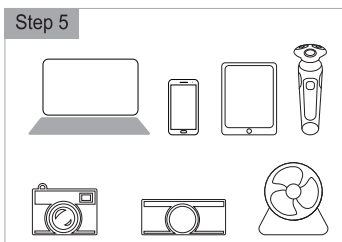
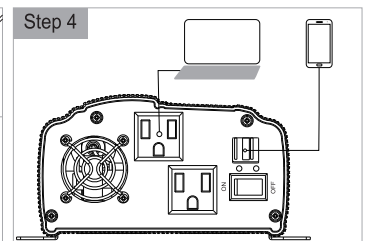
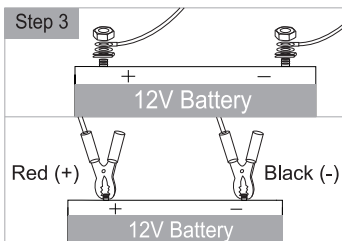
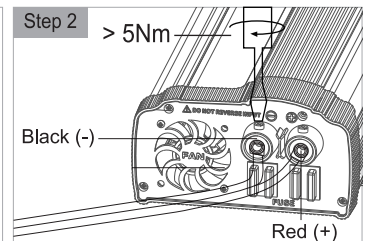
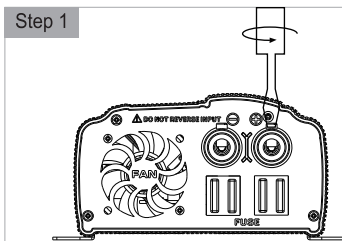

Jiangxi Baiying High-Tech Holdings Co., LTD
6th, Jingcheng Road, Yujiang Industry Park, Yujiang Town,
Yingtna City, Jiangxi Province, China