

## How to set up M30 Router (2-pack) using AQUILA PRO AI app?

- 1 Search and install the free AQUILA PRO AI app available on the App Store or Google Play



**NOTE:** Please activate your newly registered account within 7 days. If the verification email landed in your Spam folder, remember to move the email to your Inbox so that you can click on the activation button for account activation.

- 2 Launch the AQUILA PRO AI app from the home screen of your device.
- 3 Sign in on the app using an email account. If you already have a D-Link account, you can tap **Sign in**. It allows you to use cloud services to control and manage your device including the third-party voice control apps or tap **Create Account**, if you don't have an account yet then **Sign Up**.

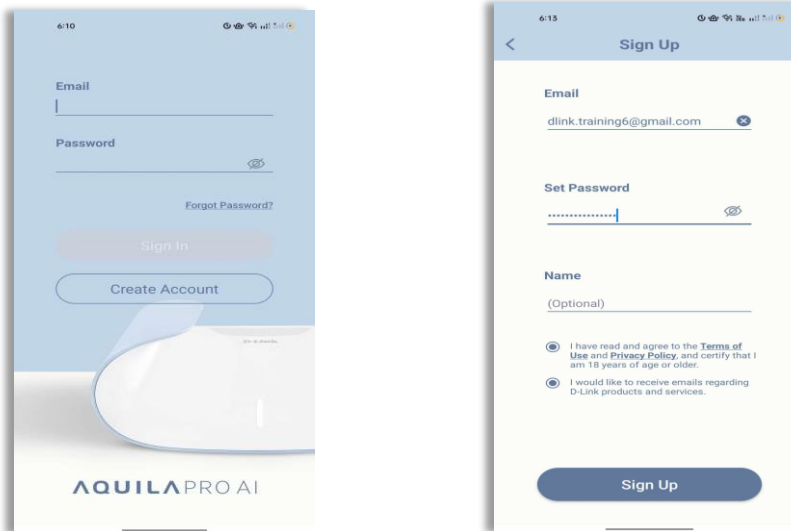

- 4 Tap **Install New Device** or **+** icon in the middle. Scan the Setup code on the device label located at the bottom of the router. Follow the on-screen instructions to complete the setup.

# D-Link® Technical Support Setup Procedure

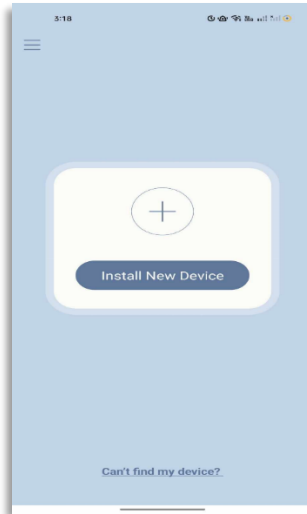

5 Select **“Set Up as Router”** if you plan to use it as a router.

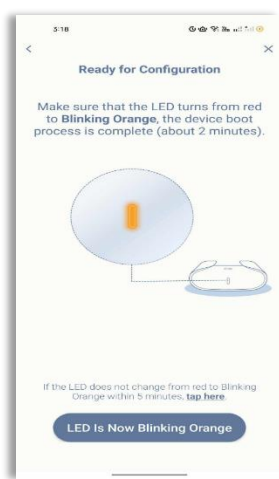
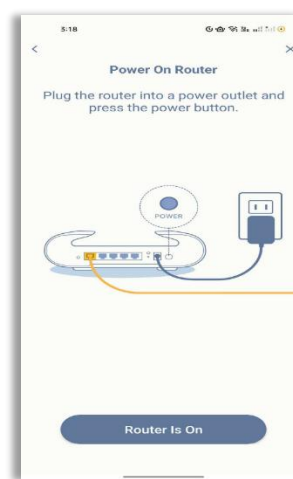
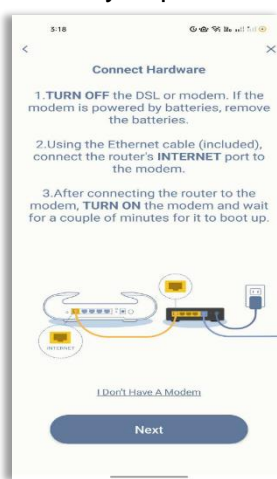

6 Modify your Wi-Fi name (SSID) and secure a unique password for security or you can use the default Wi-Fi name and Password by clicking **“Use the default Wi-Fi name and password”** at the bottom.

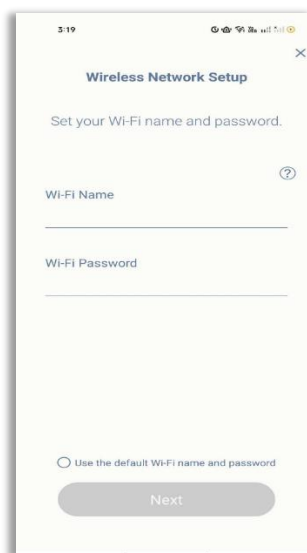

# D-Link® Technical Support Setup Procedure

- 7 Set Device Name and Device/Admin Password, then tap **NEXT**.

**NOTE:** It is strongly recommended that you change the default device password for accessing the router's configuration page.

The image shows two side-by-side screenshots of a mobile application's 'Device Configuration' screen. Both screens have a title bar with a back arrow, the title 'Device Configuration', and a close 'X' icon. Below the title bar, there is a subtitle 'Set the device name and password for device management.' and a note: 'If using Alexa or Google Assistant, the device name should be convenient for use with voice control. For example: Living Room.' The left screenshot shows the 'Device Name' field empty and the 'Device Password' field empty, with a 'Next' button at the bottom. The right screenshot shows the 'Device Name' field filled with 'Living Room' and the 'Device Password' field filled with 'password12345', with a 'Next' button at the bottom.

- 8 To save a screenshot of your device settings, tap the **camera** icon below, then hit **Next**.

The image shows a screenshot of a mobile application's 'Settings Confirmation' screen. The screen has a title bar with a back arrow, the title 'Settings Confirmation', and a close 'X' icon. Below the title bar, there is a subtitle 'Do NOT disconnect the device until it has been rebooted and keep your mobile device nearby.' and a list of settings: 'Device Name' (Living Room), 'Device Password' (password12345), 'Wi-Fi Name' (my\_home\_wifi), and 'Wi-Fi Password' (password098765). Below the list is a camera icon and a 'Next' button at the bottom.

# D-Link® Technical Support Setup Procedure

- 9 The device is now restarting and saving its settings.



- 10 Go to the network settings of your mobile device and make sure you are connected to the Wi-Fi.



- 11 Power on the second M30 and wait for it to boot up (the LED will turn blinking orange to solid white) once it becomes solid white. Click **Continue** and press **Next**.

# D-Link® Technical Support Setup Procedure

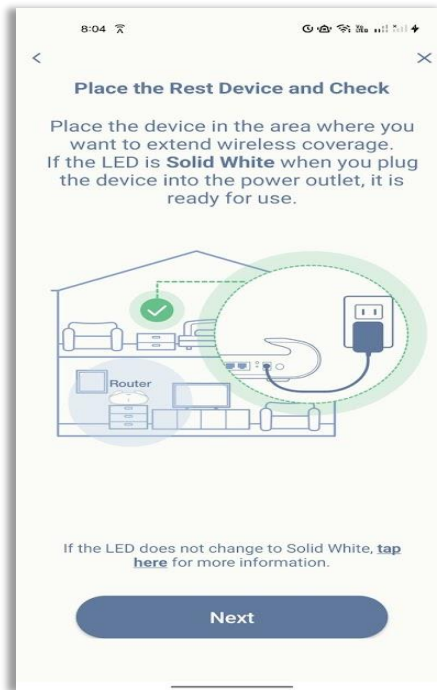
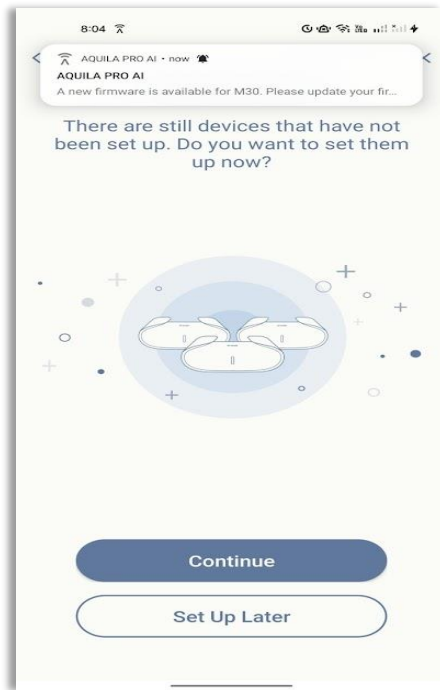

- 12 Set up is complete. After adding both M30 2 Packs, verify your connection by connecting to your D-Link router to confirm if Wi-Fi is working, or use devices to connect to your Wi-Fi network.

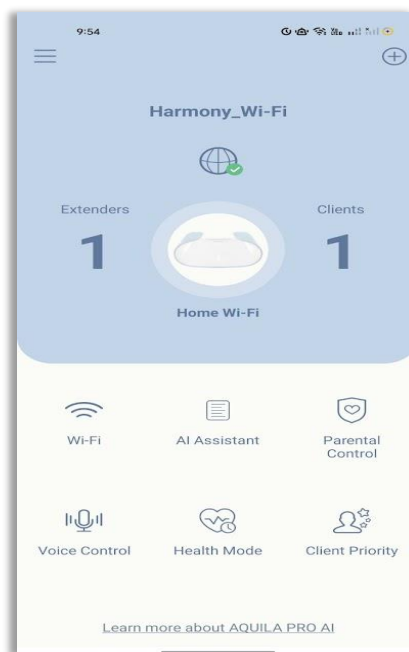
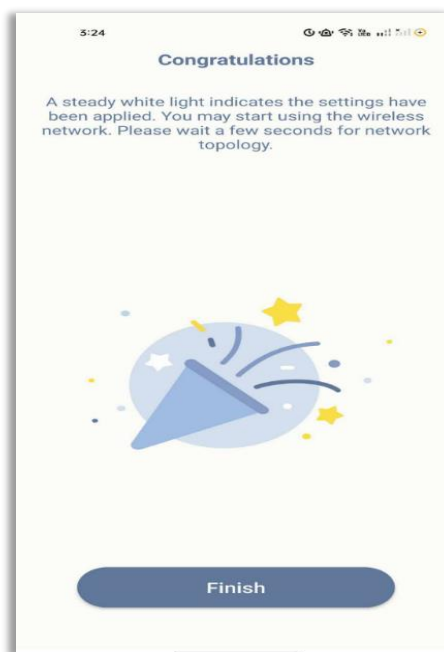

---END---