

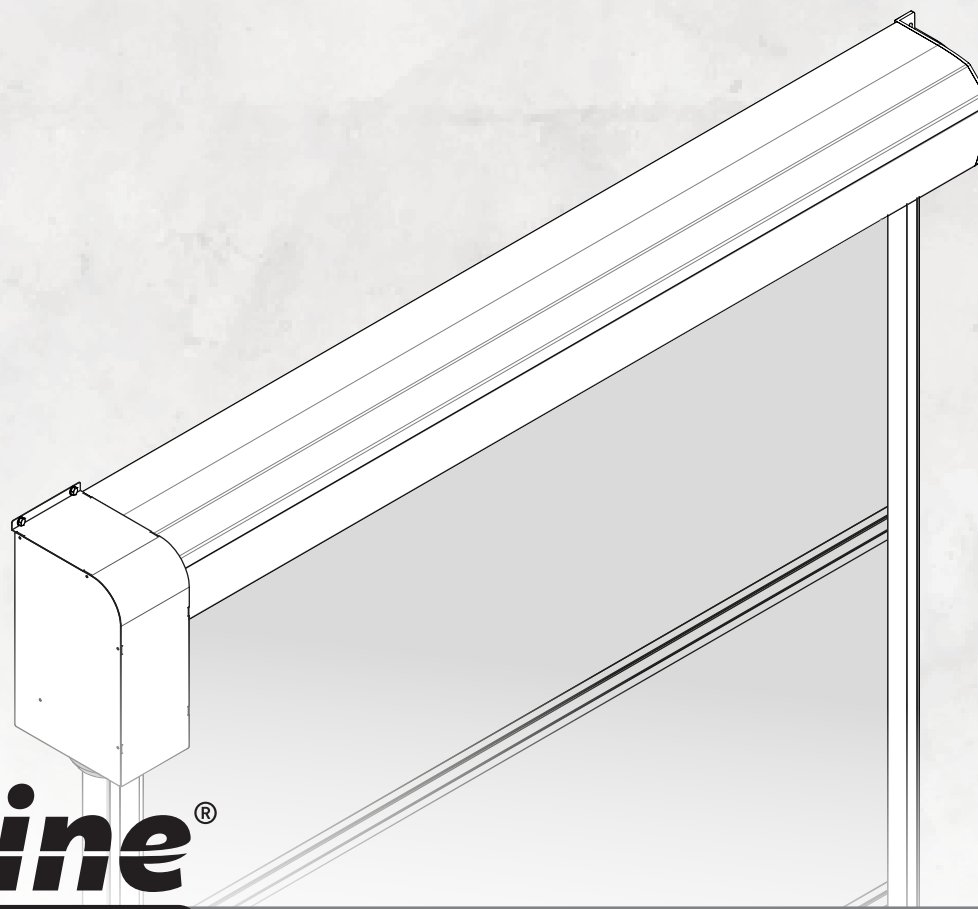

ROLL-UP RAPID DOOR SPIN

USER'S AND INSTALLER'S MANUAL



motorline[®]
PROFESSIONAL





00. CONTENT

INDEX

01. SAFETY INSTRUCTIONS	
STANDARDS TO FOLLOW	1B
02. PACKAGE	
INSIDE PACKAGE	4A
03. AUTOMATISM	
TECHNICAL SPECIFICATIONS	4B
MANUAL OPENING/CLOSING	4B
DIMENSIONS - NORMAL KIT	5
DIMENSIONS - TUNNEL KIT	6
04. INSTALLATION	
INSTALLATION MAP	7
SAFE PROFILE FIXATION	8
LATERAL GUIDES AND CONTROL BOARD FIXATION	9
05. INSTALLATION KIT TUNNEL	
SAFE PROFILE FIXATION	10
LATERAL GUIDES AND CONTROL BOARD FIXATION	11
06. LIMIT-SWITCHES	
LIMIT-SWITCHES ADJUSTMENT	12

01. SAFETY INSTRUCTIONS

STANDARDS TO FOLLOW

	This product is certified in accordance with European Community (EC) safety standards.
RoHS	This product complies with Directive 2011/65/EU of the European Parliament and of the Council, of 8 June 2011, on the restriction of the use of certain hazardous substances in electrical and electronic equipment.
	(Applicable in countries with recycling systems). This marking on the product or literature indicates that the product and electronic accessories (eg. Charger, USB cable, electronic material, controls, etc.) should not be disposed of as other household waste at the end of its useful life. To avoid possible harm to the environment or human health resulting from the uncontrolled disposal of waste, separate these items from other types of waste and recycle them responsibly to promote the sustainable reuse of material resources. Home users should contact the dealer where they purchased this product or the National Environment Agency for details on where and how they can take these items for environmentally safe recycling. Business users should contact their vendor and check the terms and conditions of the purchase agreement. This product and its electronic accessories should not be mixed with other commercial waste.
	
	This marking indicates that the product and electronic accessories (eg. charger, USB cable, electronic material, controls, etc.) are susceptible to electric shock by direct or indirect contact with electricity. Be cautious when handling the product and observe all safety procedures in this manual.

01. SAFETY INSTRUCTIONS

GENERAL WARNINGS

- This manual contains very important safety and usage information. very important. Read all instructions carefully before beginning the installation/usage procedures and keep this manual in a safe place that it can be consulted whenever necessary.
- This product is intended for use only as described in this manual. Any other enforcement or operation that is not mentioned is expressly prohibited, as it may damage the product and put people at risk causing serious injuries.
- This manual is intended firstly for specialized technicians, and does not invalidate the user's responsibility to read the "User Norms" section in order to ensure the correct functioning of the product.
- The installation and repair of this product may be done by qualified and specialized technicians, to assure every procedure are carried out in accordance with applicable rules and norms. Nonprofessional and inexperienced users are expressly prohibited of taking any action, unless explicitly requested by specialized technicians to do so.
- Installations must be frequently inspected for unbalance and the wear signals of the cables, springs, hinges, wheels, supports and other mechanical assembly parts.
- Do not use the product if it is necessary repair or adjustment is required.
- When performing maintenance, cleaning and replacement of parts, the product must be disconnected from power supply. Also including any operation that requires opening the product cover.
- The use, cleaning and maintenance of this product may be carried out by any persons aged eight years old and over and persons whose physical, sensorial or mental capacities are lower, or by persons without any knowledge of the product, provided that these are supervision and instructions given by persons with experienced in terms of usage of the product in a safe manner and who understands the risks and dangers involved.

01. SAFETY INSTRUCTIONS

- Children shouldn't play with the product or opening devices to avoid the motorized door or gate from being triggered involuntarily.

WARNINGS FOR TECHNICIANS

- Before beginning the installation procedures, make sure that you have all the devices and materials necessary to complete the installation of the product.
- You should note your Protection Index (IP) and operating temperature to ensure that is suitable for the installation site.
- Provide the manual of the product to the user and let them know how to handle it in an emergency.
- If the automatism is installed on a gate with a pedestrian door, a door locking mechanism must be installed while the gate is in motion.
- Do not install the product "upside down" or supported by elements do not support its weight. If necessary, add brackets at strategic points to ensure the safety of the automatism.
- Do not install the product in explosive site.
- Safety devices must protect the possible crushing, cutting, transport and danger areas of the motorized door or gate.
- Verify that the elements to be automated (gates, door, windows, blinds, etc.) are in perfect function, aligned and level. Also verify if the necessary mechanical stops are in the appropriate places.
- The central must be installed on a safe place of any fluid (rain, moisture, etc.), dust and pests.
- You must route the various electrical cables through protective tubes, to protect them against mechanical exertions, essentially on the power supply cable. Please note that all the cables must enter the central from the bottom.
- If the automatism is to be installed at a height of more than 2,5m from the ground or other level of access, the minimum safety and health requirements for the use of work equipment workers at the work of Directive 2009/104/CE of European Parliament and of the Council of 16

01. SAFETY INSTRUCTIONS

September 2009.

- Attach the permanent label for the manual release as close as possible to the release mechanism.
- Disconnect means, such as a switch or circuit breaker on the electrical panel, must be provided on the product's fixed power supply leads in accordance with the installation rules.
- If the product to be installed requires power supply of 230Vac or 110Vac, ensure that connection is to an electrical panel with ground connection.
- The product is only powered by low voltage safety with central (only at 24V motors)

WARNINGS FOR USERS

- Keep this manual in a safe place to be consulted whenever necessary.
- If the product has contact with fluids without being prepared, it must immediately disconnect from the power supply to avoid short circuits, and consult a specialized technician.
- Ensure that technician has provided you the product manual and informed you how to handle the product in an emergency.
- If the system requires any repair or modification, unlock the automatism, turn off the power and do not use it until all safety conditions have been met.
- In the event of tripping of circuits breakers or fuse failure, locate the malfunction and solve it before resetting the circuit breaker or replacing the fuse. If the malfunction is not repairable by consult this manual, contact a technician.
- Keep the operation area of the motorized gate free while the gate in motion, and do not create strength to the gate movement.
- Do not perform any operation on mechanical elements or hinges if the product is in motion.

01. SAFETY INSTRUCTIONS

RESPONSABILITY

- Supplier disclaims any liability if:
 - Product failure or deformation result from improper installation use or maintenance!
 - Safety norms are not followed in the installation, use and maintenance of the product.
 - Instructions in this manual are not followed.
 - Damaged is caused by unauthorized modifications
 - In these cases, the warranty is voided.

SYMBOLS LEGEND:



• Important safety notices



• Useful information



• Programming information



• Potentiometer information



• Connectors information



• Buttons information

02. PACKAGE

INSIDE PACKAGE

Inside the kit you will find the following components:

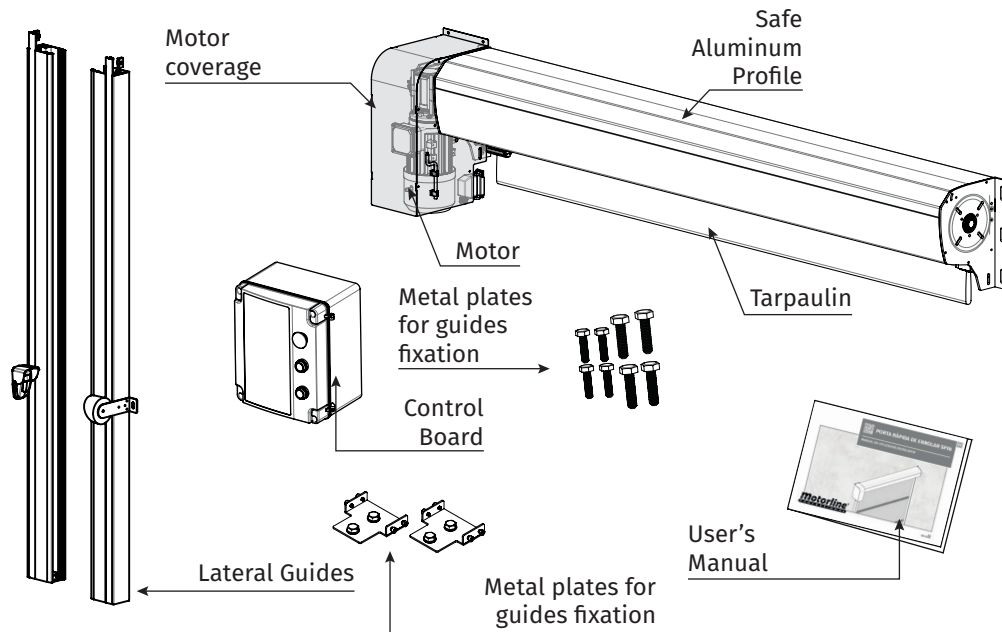

TECHNICAL SPECIFICATIONS

The **SPIN** rapid door is built with its own white lacquered aluminum profiles and is suitable for areas with medium air pressure, as it has 3 to 6 reinforcement bars. It is certified to IP23 protection level.

	TARPAULIN	
• Wire	2 x 1100 dtex PES HT	
• Weight	900/m ²	
• Tensile Strength	400/400 daN/5 cm	
• Tear Resistance	300N	
• Grip	45/45 daN	
• Operating temperature	-30°C a 70°C	

03. AUTOMATISM

TECHNICAL SPECIFICATIONS

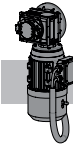

MOTOR	Doors up to 3500mm to 3500mm	Doors above 3500mm max. 5000mm
• Power Supply	230V 50/60Hz	230V 50/60Hz
• Power	750W	1500W
• Current	5A	14A
• RPM	95RPM	100RPM
• Reduction	1:15	1:15
• Noise	<60dB	<60dB
• Force	50Nm	130Nm
• Operating temperature	-25°C to 70°C	-25°C to 70°C
• Working Frequency	intensive	intensive
• Insulation class	Class F	Class F

MANUAL OPENING/CLOSING

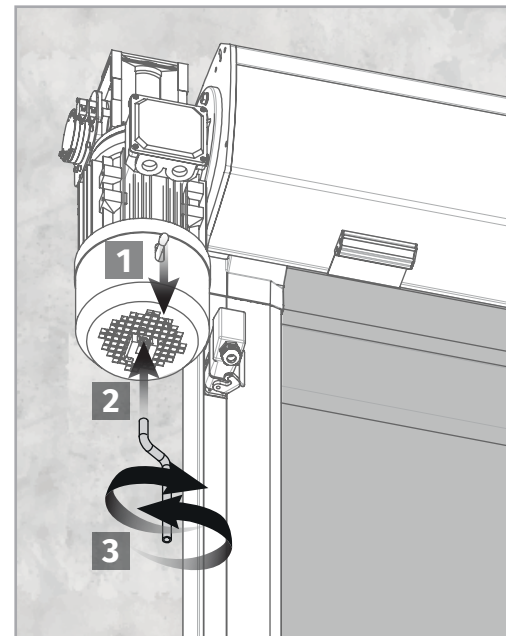

To open or close the door manually, simply pull and hold down the unlock lever and use a 6mm hexagon wrench to rotate the screw installed in the bottom of the engine, as shown on the image.

Turning to the right will open the door and turning to the left will close.



If you wish, you can use an umbrako keyed machine to open faster.

03. AUTOMATISM

DIMENSIONS - NORMAL KIT

• DOORS UP TO 3500mm WIDTH AND/OR HEIGHT

Dimensions shown in mm.

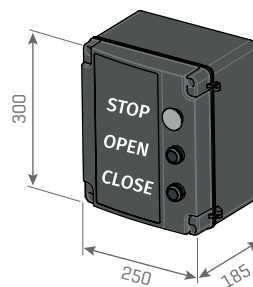
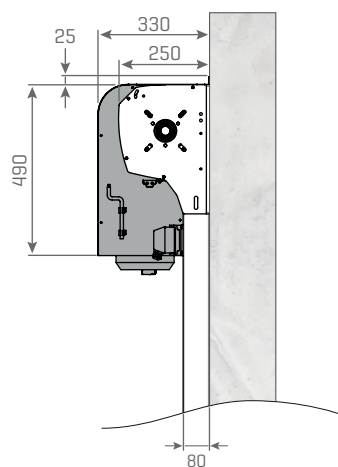
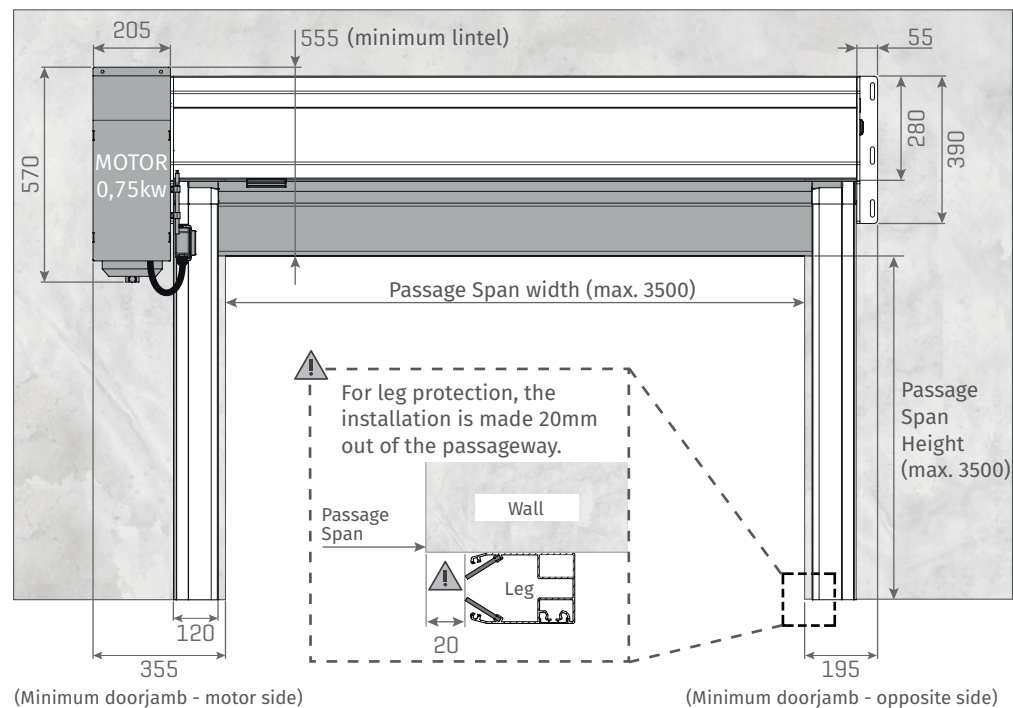

• DOORS ABOVE 3500mm WIDTH AND/OR HEIGHT

Dimensions shown in mm.

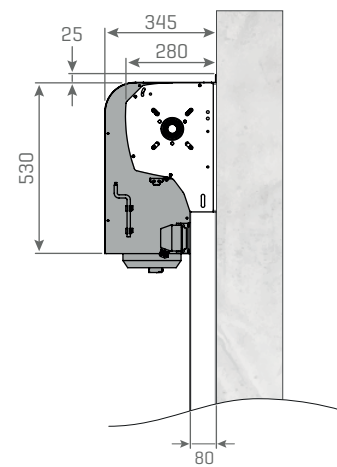
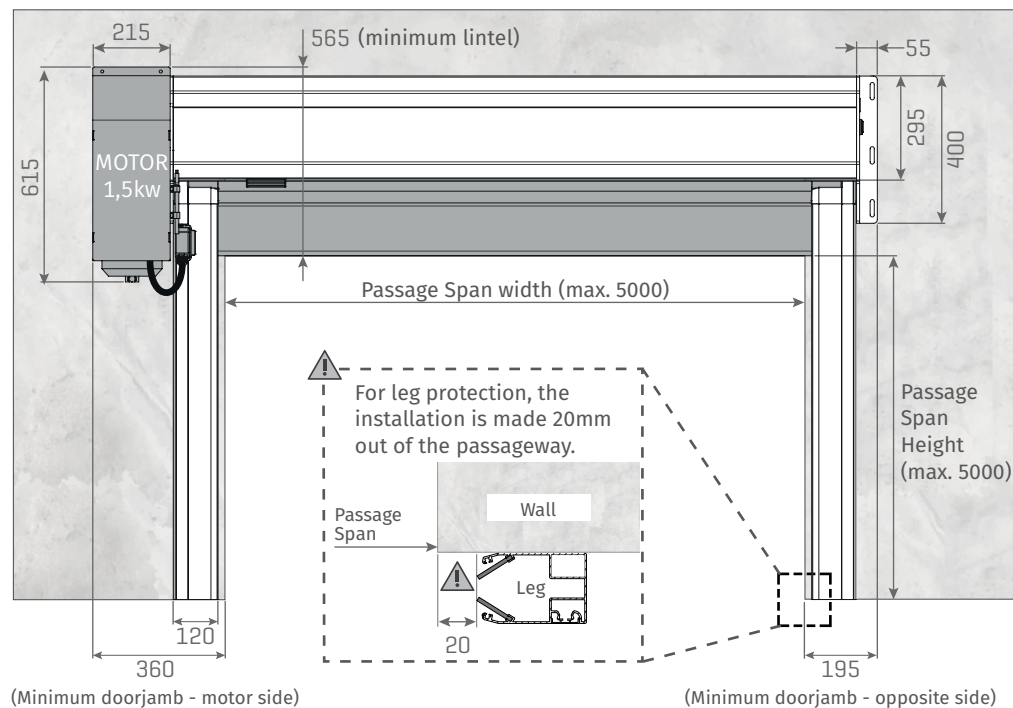

03. AUTOMATISM

DIMENSIONS - TUNNEL KIT

• TUNNEL DOORS UP TO 3500mm WIDTH AND/OR HEIGHT

Dimensions shown in mm.

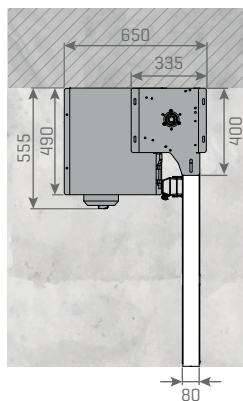
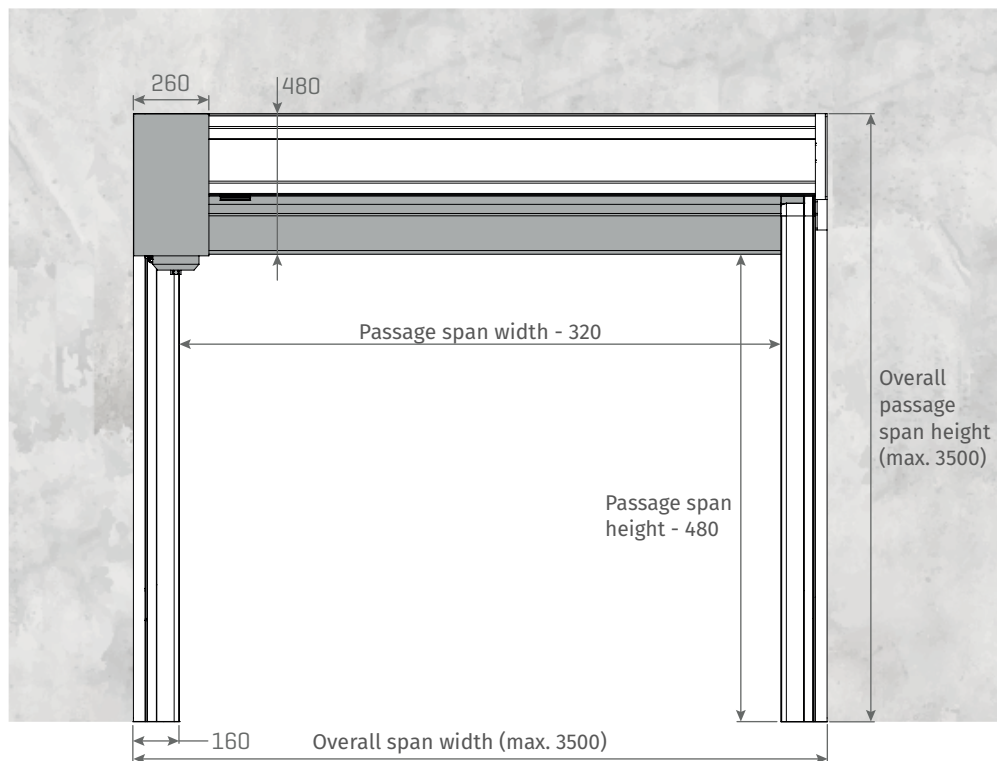

• TUNNEL DOORS ABOVE 3500mm WIDTH AND/OR HEIGHT

Dimensions shown in mm.

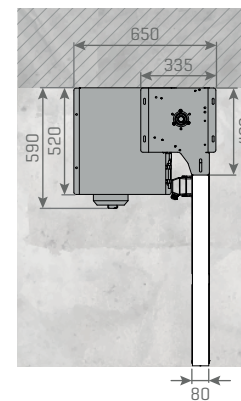
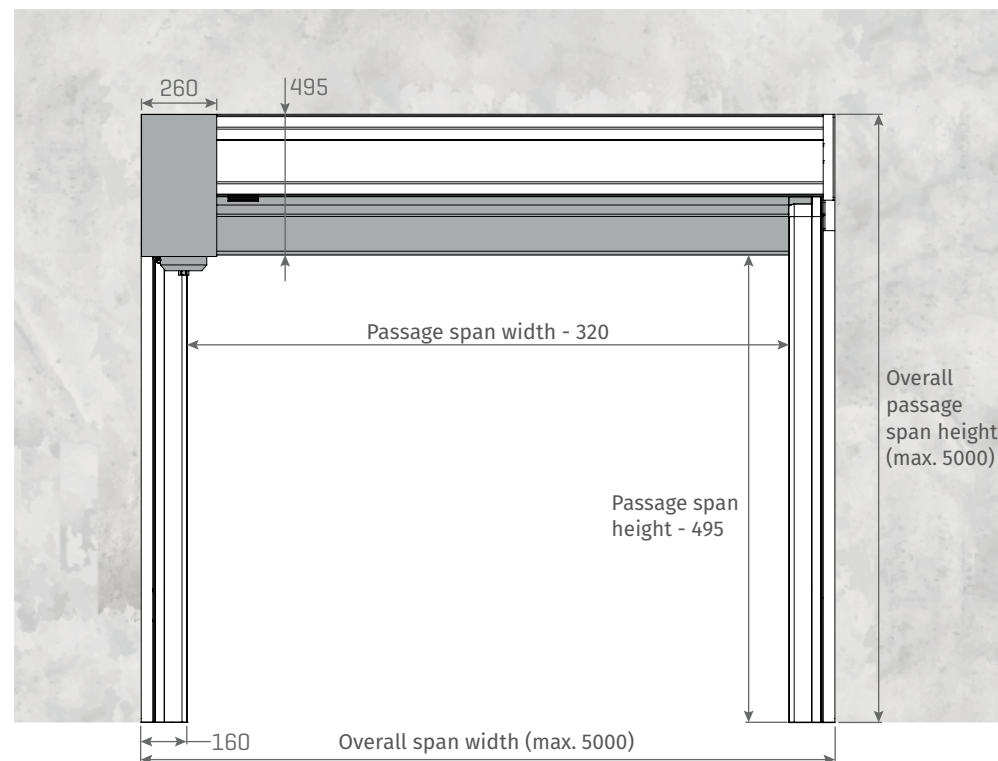

04. INSTALLATION

INSTALLATION MAP

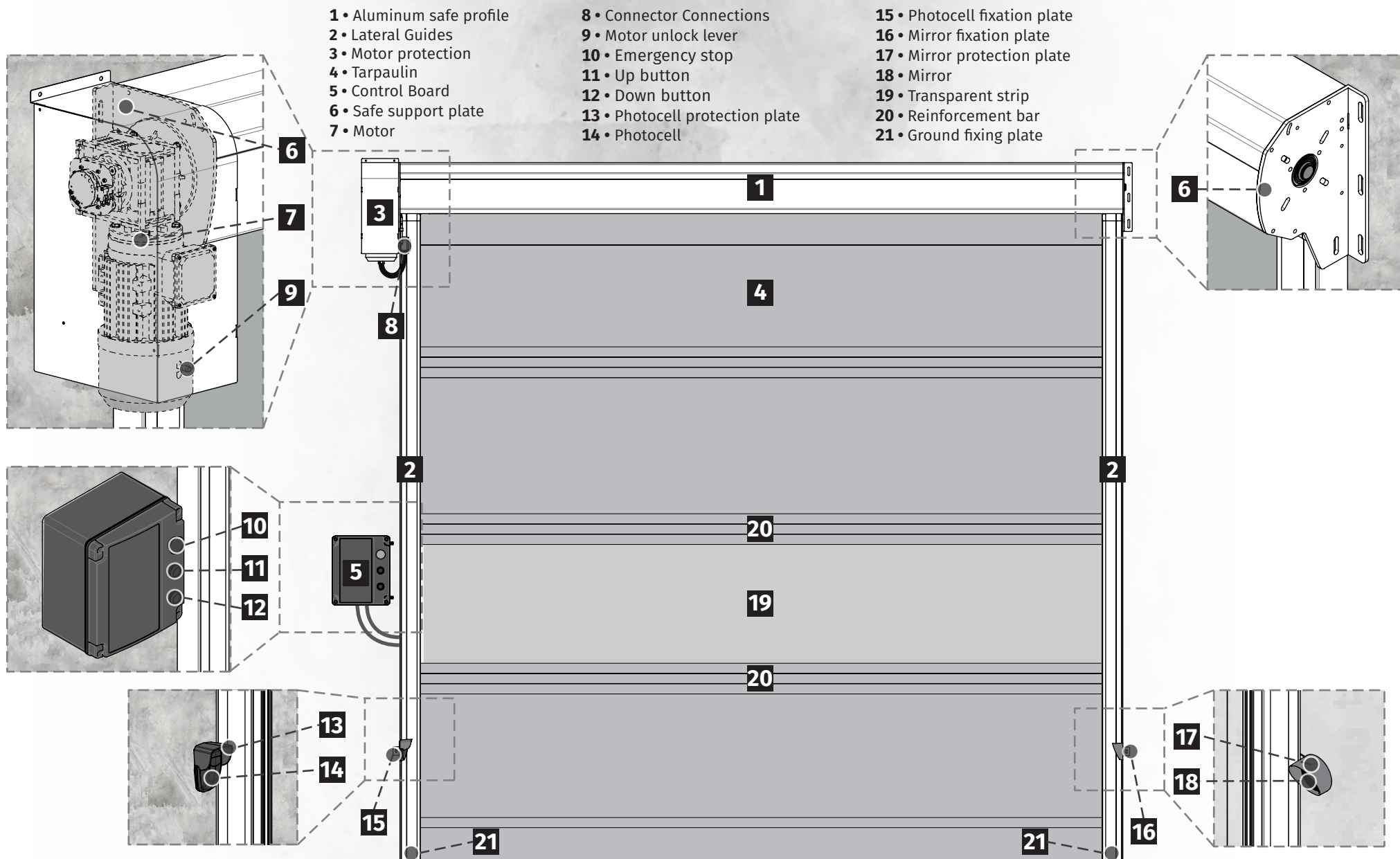

04. INSTALLATION

SAFE PROFILE FIXATION

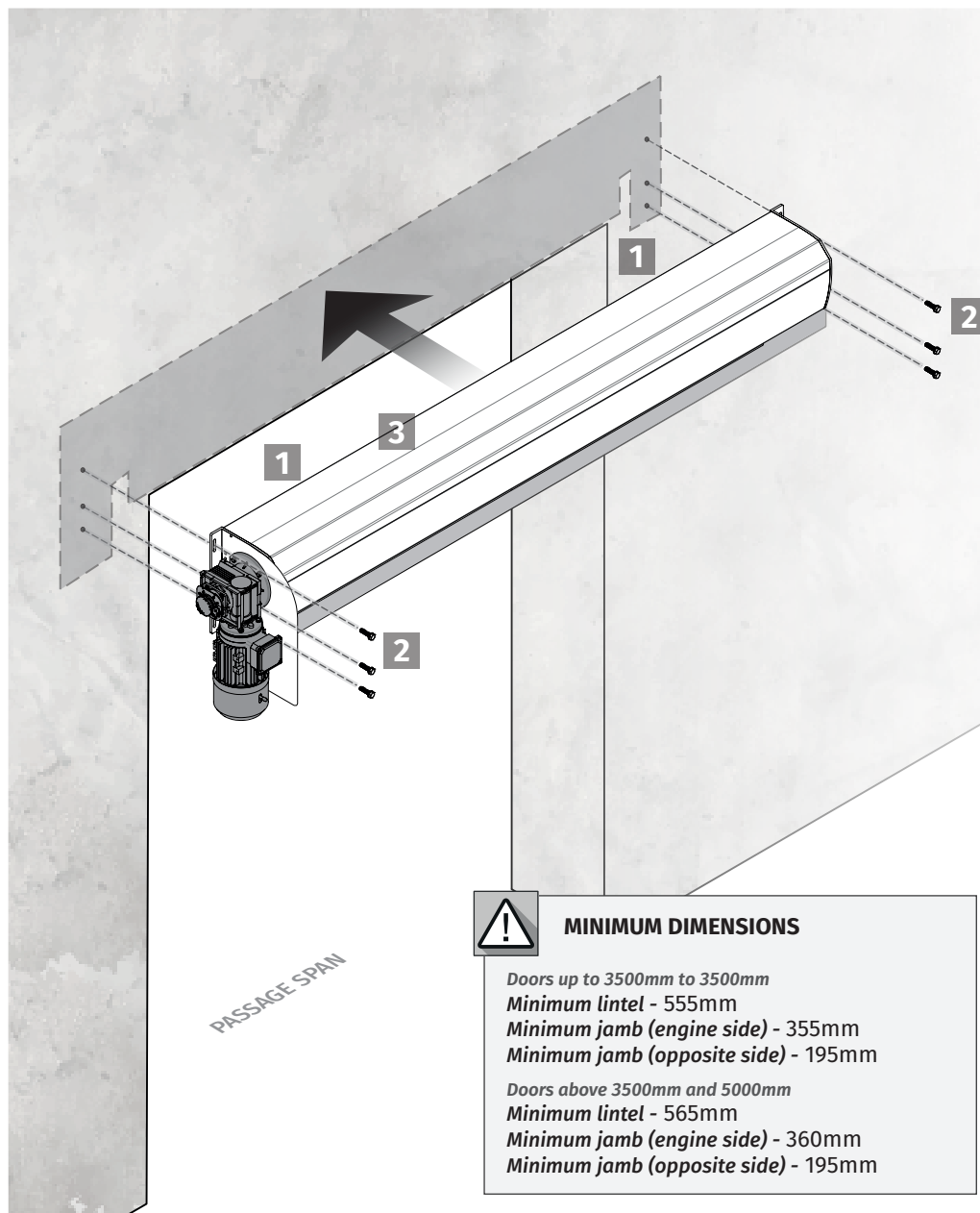

1 POSITIONING SAFE

Apply the safe to the wall of the installation site, paying attention to the horizontal level and **85mm** between the base of the support plate and the beginning of the passage span. The safe should be centered with the gap.

Based on the holes in the support plates, mark the locations for drilling.

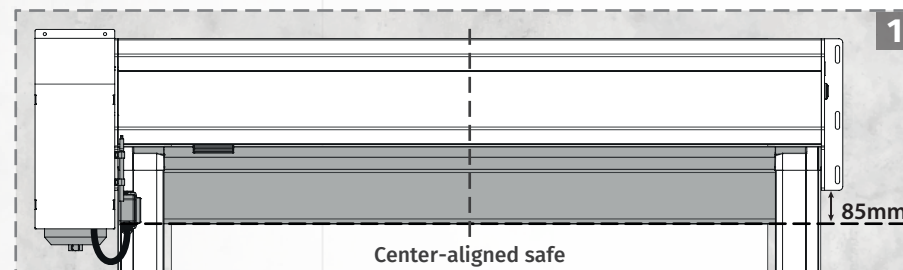

2 FIX SAFE

Drill the holes at the marked locations, and then apply the safe to the wall, fixing it with dowels and screws, suitable to the installation place.

The safe must be securely fixed to prevent accidents.

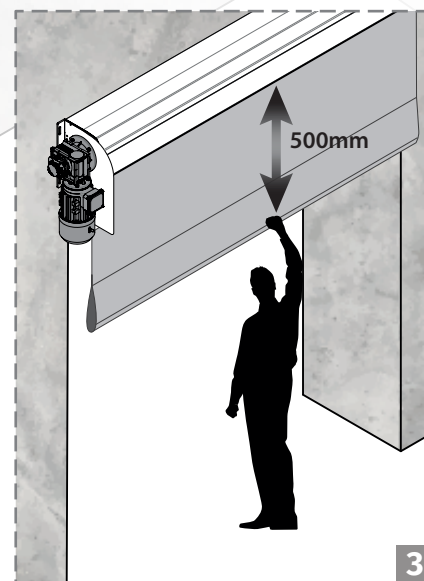

3 ADJUST TARPAULIN

Unlock the motor (page 4B) and pull the tarpaulin by hand about **500mm**.

04. INSTALLATION

LATERAL GUIDES AND CONTROL BOARD FIXATION

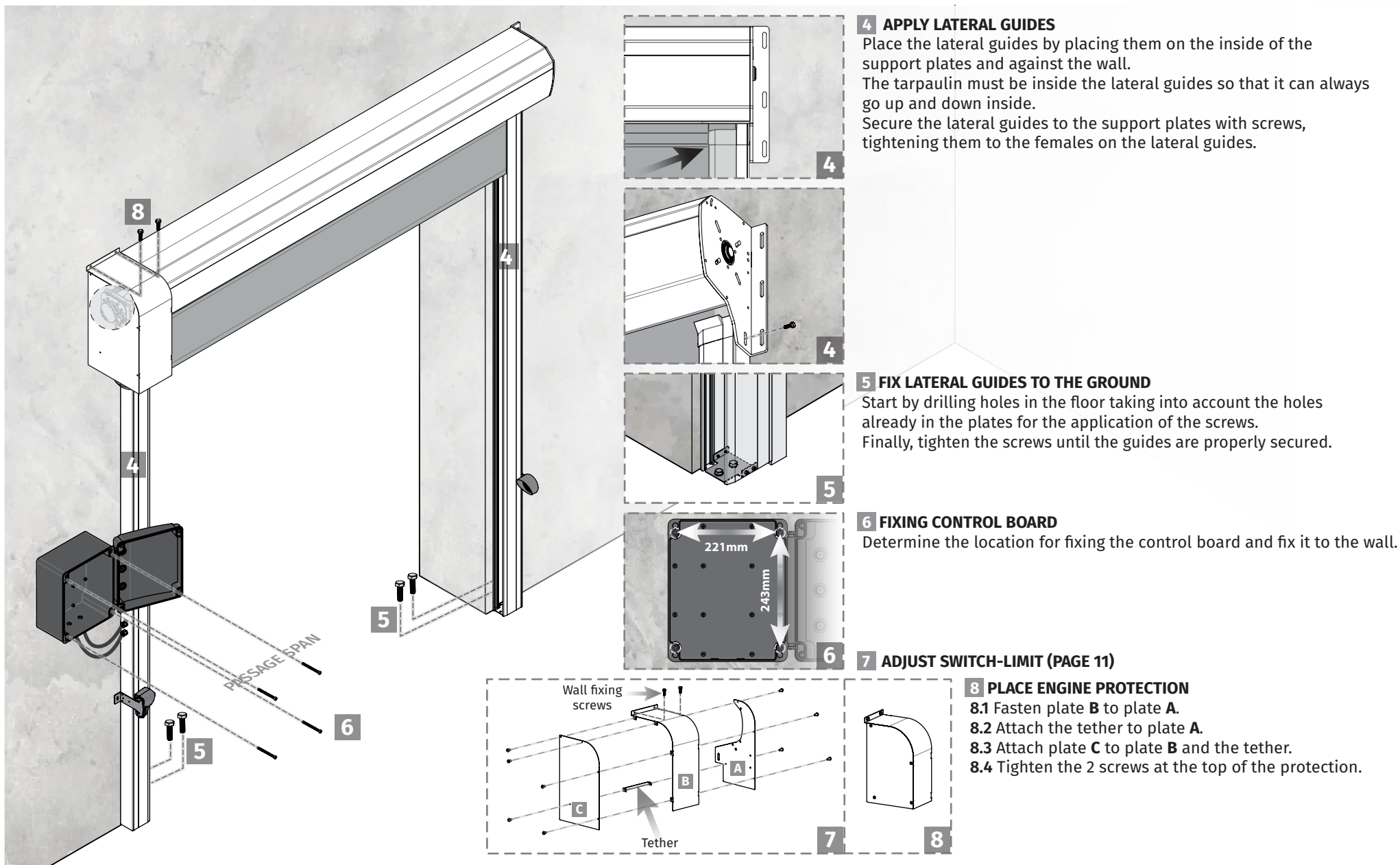

05. INSTALLATION KIT TUNNEL

SAFE PROFILE FIXATION

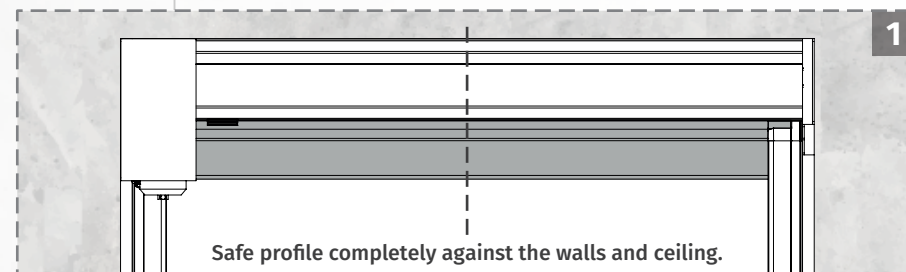
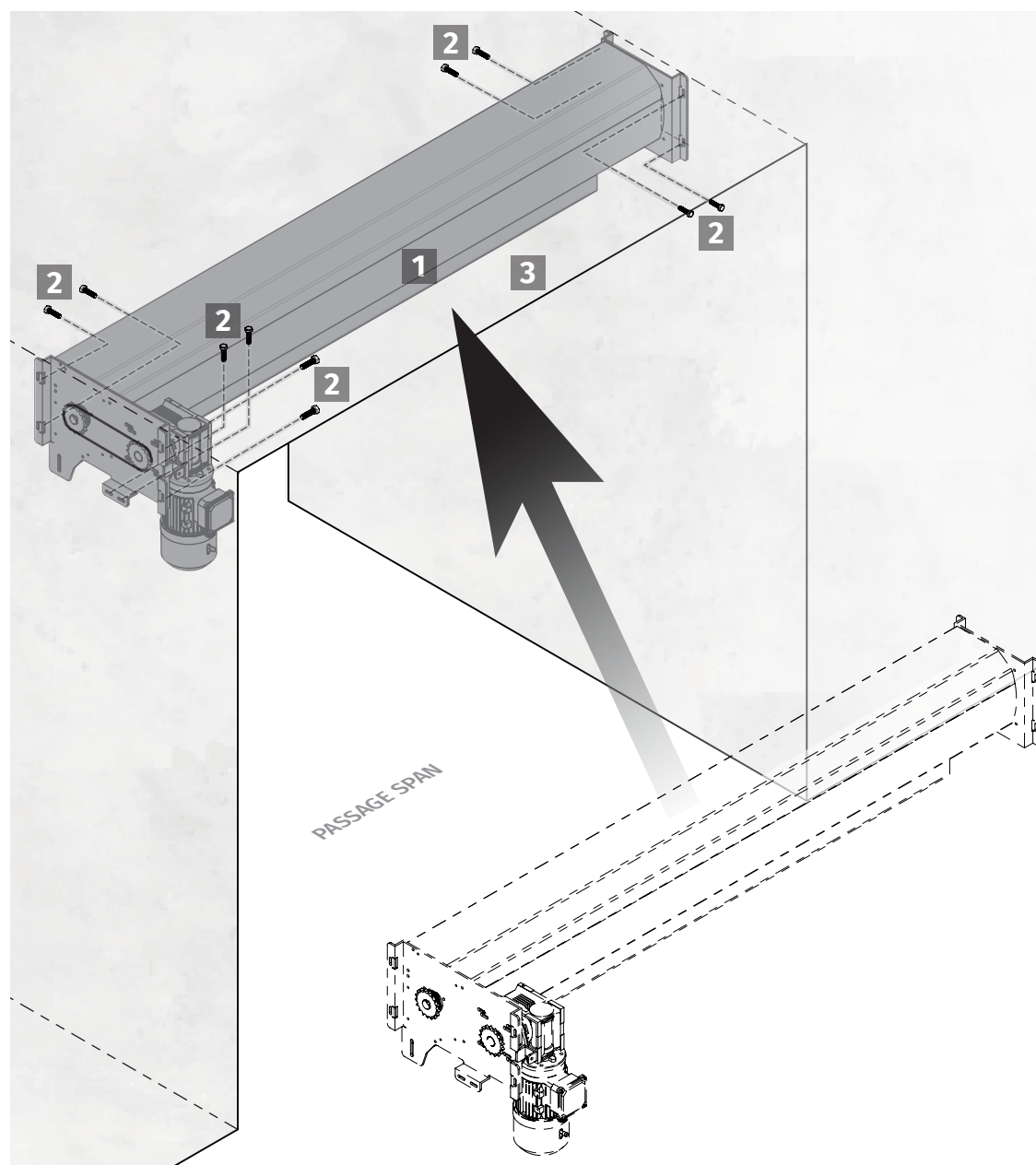

1 POSITION SAFE

Insert the safe into the tunnel and apply at the desired location for installation, taking into account the horizontal leveling. Based on the holes in the support plates, mark the locations for drilling.

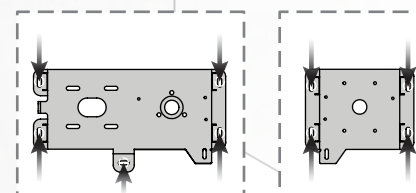

2 FIX SAFE

Drill the holes at the marked locations, and then apply the safe to the wall, fixing it with dowels and screws.

The safe must be securely fastened to prevent accidents.

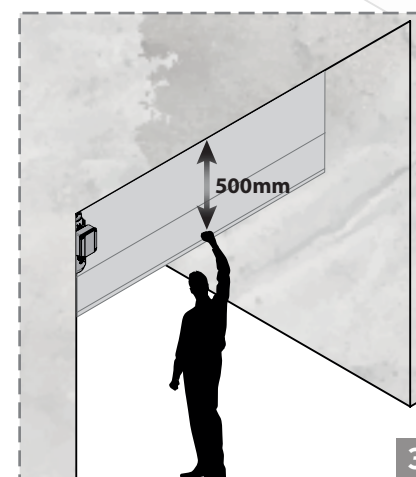

3 ADJUST TARPAULIN

Unlock the motor (page 4B) and pull the tarpaulin by hand about **500mm**.

05. INSTALLATION KIT TUNNEL

LATERAL GUIDES AND CONTROL BOARD FIXATION

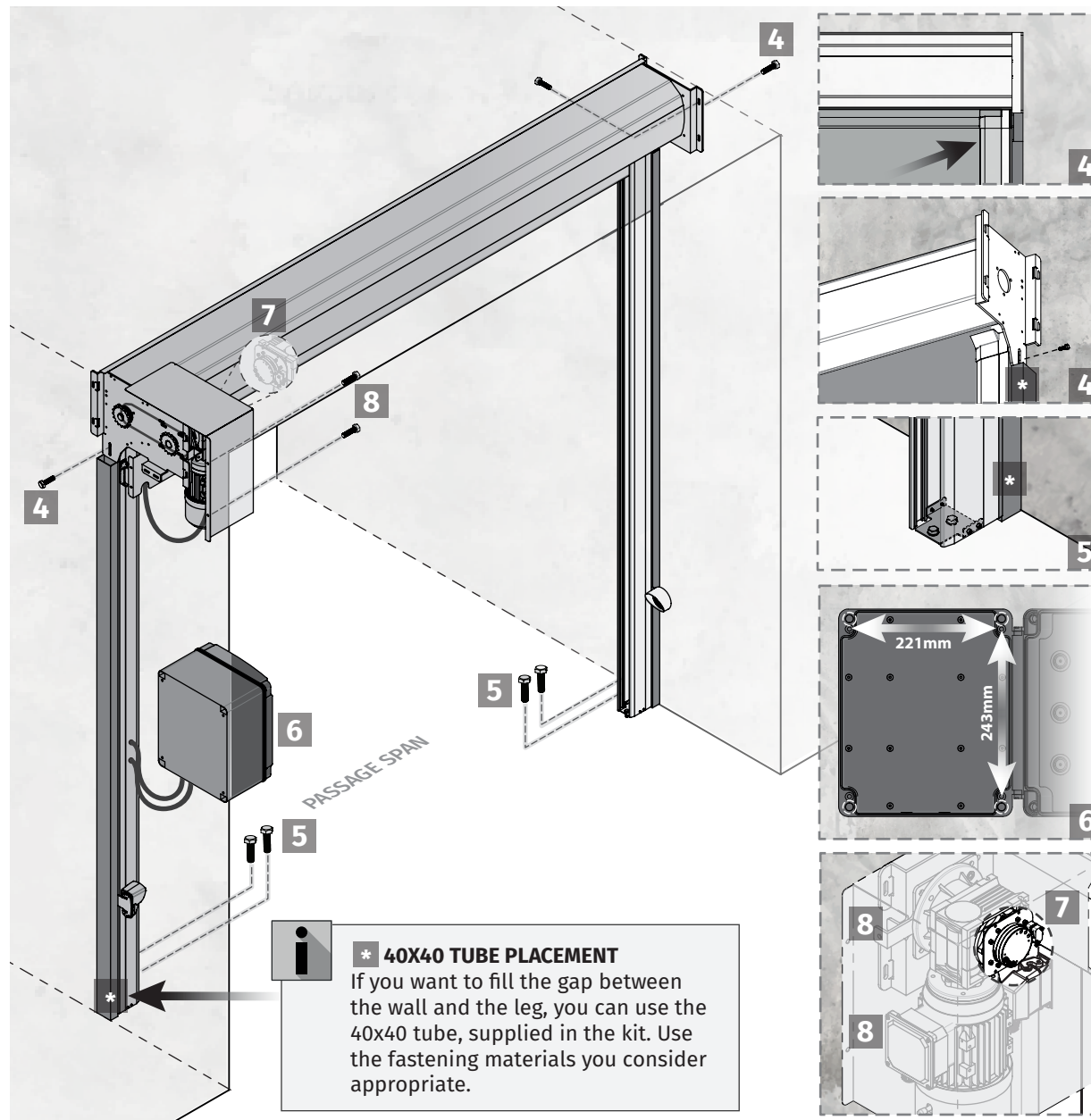

4 APPLY LATERAL GUIDES

Place the legs by placing them on the inside of the support plates and against the wall.
The tarpaulin must be inside the legs so that it can always go up and down inside.
Secure the legs to the support plates with screws, tightening them to the females on the legs.

5 FIX LATERAL GUIDES TO THE GROUND

Start by drilling holes in the floor taking into account the holes already in the plates for the application of the screws.
Finally, tighten the screws until the guides are properly secured.

6 FIXING CONTROL BOARD

Determine the location for fixing the control board and fix it to the wall.

7 ADJUSTING LIMIT-SWITCH (PAGE 12).

8 PLACING MOTOR PROTECTION

Apply the motor protection and secure it by tightening the 2 bolts.

06. LIMIT-SWITCHES

LIMIT-SWITCHES ADJUSTMENT



• ADJUSTMENT

The ring **4** should activate the micro switch from below, and the ring **3** should activate the micro switch from above.

• CONNECTIONS

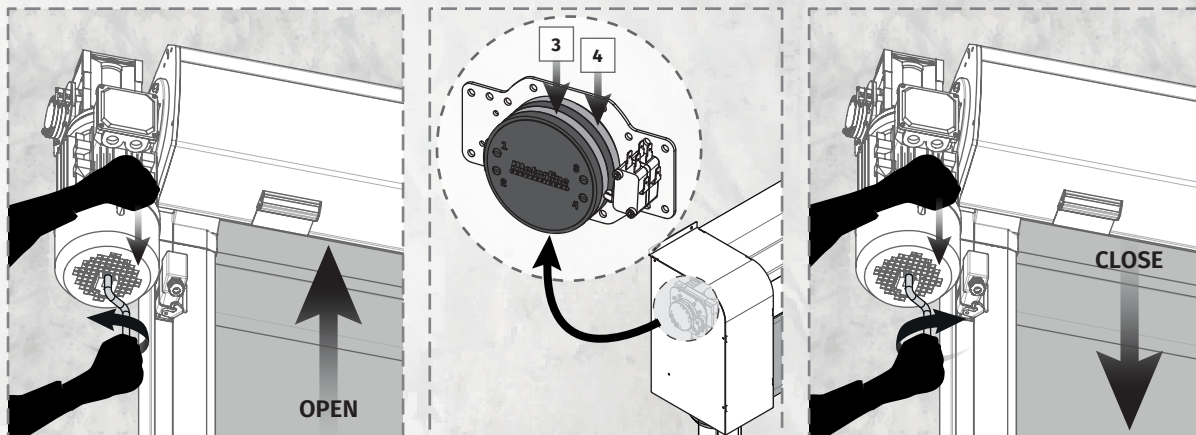
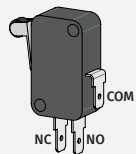

- 1 Manually place the door in the area you want for the opening slowdown.
- 2 Turn the adjusting screw **4** until the limit switch **4** activates the corresponding microswitch.
- 3 Manually place the door in the area you want for the closure slowdown.
- 4 Turn the adjusting screw **3** until the limit switch **3** activates the corresponding microswitch.

