

Installation

1. Please carefully read the manual before installation.
2. Please apply professional staff to install if possible.
3. Do not connect to power cable before other connection is done.
4. To avoid short circuit, please pack the exposed cable with insulating tape.
5. Fix all loose cable after installation completed.
6. This unit is designed to work with 12V (see label for specific) DC negative ground electrical system only. Please ensure your car meets the requirement.
7. Please connect the cables according to the color, wrong correction may lead to damage to the unit and the electrical system of the vehicle.

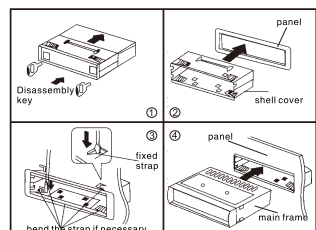

Installation steps

Troubleshooting

| Problem | Cause | Solution |
|------------------------|--|---|
| Power indicator is off | 1. The power cord is connected in reverse. | Correctly connect the power cord. Check and connect both power cord. |
| No display | 1. Yellow wiring is not connected to positive electrode of the battery. | Connect the yellow wiring to the positive electrode of the battery. |
| No sound | 1. No power. 2. Speaker wiring is disconnected. 3. No sources in supported format in TF and U disk. 4. The edge connector of TF and U disk is dirty lead to poor contact. | Connect the power cord. Connect the speaker wiring. Check the sources in TF and U disk. Clean with absolute alcohol. |
| Sound too low (noise) | 1. Internal resistance of power supply is too loud. 2. The antenna cable is loose. | Replace a new power supply. Push the antenna cable firmly into the plug. |
| Mono only | 1. One of the speakers wiring is disconnected. 2. The power amplifier IC is damaged. | Connect the speaker wiring. Replace with a new power amplifier IC. |

Note: Specifications are subject to change without prior notice.

User'Manual

Basic Operation

1. Power on/off and Mode (PWR/MOD)

Short press PWR/MOD to turn on; In working status, long press PWR/MOD to turn off.

2. Insert the U disk and SD/MMC/TF card and short press PWR/MOD, the selection sequence is as follows:

Radio → U disc → SD/MMC/TF → AUX → BT



Insert the U disc or SD/MMC/TF card and press PWR/MOD, the mode will switch as follow:

Radio → U disc or SD/MMC/TF → AUX → BT



Before inserting U disc or SD/MMC/TF card state, press PWR/MOD, the mode will switch as follow:

FM radio → AUX → BT



3. Volume (Volume knob)

1) In default status, rotate (CW) the Volume knob to increase volume; rotate (CCW) the Volume knob to decrease volume. The adjustment range is 0 --- 32.

2) Short press the Volume knob, the selection sequence is as follows: BAS, TRE, BAL, FAD, LOUD, EQ.

Short press the Volume knob once time, the display will show "BAS 00", and then rotate (CW) the volume knob to increase bass or rotate (CCW) to decrease bass.

The adjustment range is BAS-7~BAS07.

Short press twice, the display will show "TRE 00", and then rotate (CW) the volume knob to increase treble or rotate (CCW) to decrease treble. The adjustment range is TRE-7~TRE07.

Short press three times, the display will show "BAL 00", and then rotate (CW) the volume knob to decrease the volume of the left speaker; rotate (CCW) the volume knob to decrease the volume of the right speaker. The adjustment range is L7~R7.

Short press four times, the display will show "FAD 00", and then rotate (CW) the volume knob to decrease the volume of the rear speaker; rotate (CCW) the volume knob to decrease the volume of the front speaker. The adjustment range is F7~R7.

Short press five times, the display will show "LOUD OFF". Then rotate the volume knob to choose "LOUD ON";

Short press six times, the display will show "EQ OFF", rotate the volume knob to choose "POP", "ROCK", "JAZZ" and "Class";

4. EQ(EQ key)

In Mp3 status, press Volume knob to select POP, ROCK, JAZZ and CLASS in sequence.

5. Mute (MUT key)

In power-on status, press MUT key to mute the sound, the display will flash MUT; press MUT key to resume the sound.

APP Control

Noted: APP is optional

Please scan the QR code to install the APP, or also you can enter into the website to install.

For Android system: <https://play.google.com/store/apps/details?id=zddz.carlive>

For IOS system: <https://apps.apple.com/cn/app/carlive/id1450912381>

1. After installed, please find the icon  and click it to enter, shown as picture 1.

2. Press this icon  to enter in setting, then connect the phone with Bluetooth, shown as picture 2. After connected successfully, then you can control the device through your phone.



Android & IOS QR code

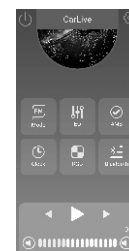

picture 1

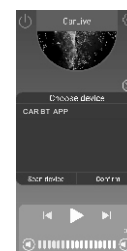

picture 2

5. Repeat (3/RPT)

In the state of MP3, shortly press 3/RPT for the first time to repeat display single song, the screen will show word "RPT"; shortly press 3/RPT to cancel repeat.

6. Random (4/RDM)

In the state of MP3, shortly press 4/RDM to random display, the screen will show word "RDM"; shortly press 4/RDM again to cancel random display.

7. -10/+10 (5/-10 and 6/+10)

In MP3 play status, short press 5/-10 or 6/+10 to select the previous 10 songs or the next 10 songs. Long press to select the songs which in the folder.

CLOCK

1. Clock display

In MP3 play status, short press CLK, the display will show "CLOCK" instead of MP3 information. The unit will turn to MP3 information if no operation within 5 seconds. The clock is 24-hour clock.

2. Clock adjustment

Short press the CLK to show the time. Long press the CLK and then rotate the knob to change the hour. Press again to change the minutes.

Bluetooth Function

1. Phone and unit matches

Frist, Please put the phone near the unit and find out the bluetooth function on the phone, and then search the Bluetooth's name " CAR BT " password is"0000") then connected it to the unit.

2. Directly talk via Bluetooth

Marking calls.

After connect to the Bluetooth, make the calls on the phone directly. Answer the phone calls.

The unit has the bell ring when coming calls. Press the BND/AS button to answer the phone calls or answer it on the phone directly hang out the calls .

When you are making calls, press the "MOD" button to hang up the calls or hang it up on the phone directly.

3. Play the music by Bluetooth

After finish to connect to the bluetooth, press the "MOD" button to change to the state of "BT", and then start the music player on the phone to play the music.

Others

AUX IN

Press PWR/MOD key to switch to AUX IN status, press PWR/MOD key again to resume.

Remote Control Indication

(Note: Available for product supplied with remote)

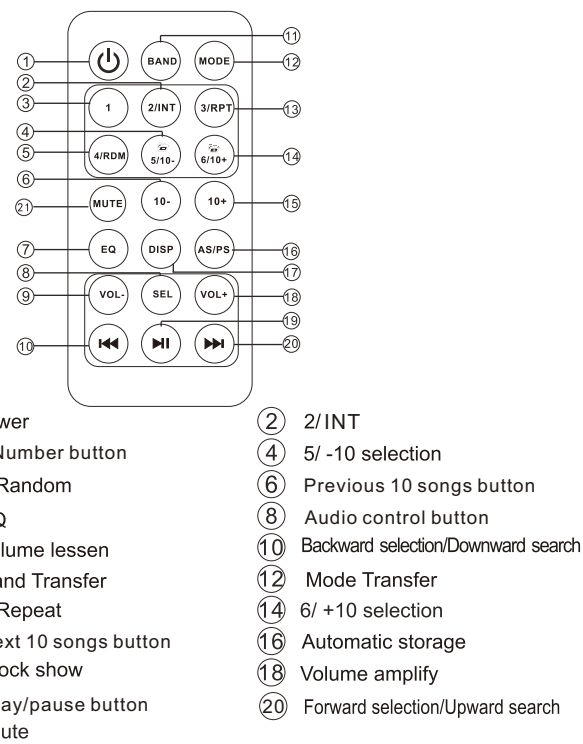

Specification

FM

Frequency range -----87.5MHz~108MHz
 Maximum sensitivity -----≤37dBf
 Signal to noise ratio -----≥40dB
 Stereo separation -----≥20dB

AM (Noted:AM is optional)

Frequency range -----522 kHz ~ 1620 kHz
 Maximum sensitivity -----≤40dBf

MP3

Support format -----MP3
 Music Storage -----U disk /TF card
 Frequency response ----- (100Hz ~ 10 kHz) ±8dB
 Signal to noise ratio -----≥50dB
 Channel separation -----≥35dB
 Harmonic voltage distortion -----≤5%
 Stereo channel balance -----≤3dB

General

Voltage -----DC 12V (see label for specific)
 Output power -----50WX4
 Speaker impedance -----4Ω~8Ω
 Dimension of main frame-----178mm(W)X50mm(H)x95mm(D)

Radio

(Noted:AM is optional)

1. The unit can store 18 FM channels (FM1/FM2/FM3 every with 6 channels) and 12 AM channels (AM1/AM2 each with 6 channels).
2. Auto search stations (**▶▶/◀◀** key)
 In radio status, press **▶▶** or **◀◀** key to automatically search the previous or next stations. If a station is found, the unit will stop searching and play the current station.
3. Manual search (**▶▶/◀◀** key)
 In radio status, press and hold **▶▶** or **◀◀** key to switch to manual search mode, the device will manually search the previous **▶▶** or **◀◀** next station. When the favorite tation is app roaching, stop holding and press **▶▶** or **◀◀** key to fine adjust the frequency until you get your favorite station. The mode will switch to auto search without pressing within 5 seconds.
4. Auto storage (BND/AS key)
 In radio status, press and hold BND/AS to automatically search stations backward and store the strong signal stations into 1- 6 keys of FM1,FM2,FM3,AM1 and Am2 band. When storage completed, the device will play every station for 5 seconds, then press BND/AS to choose the station you want.
5. Manual storage (1-6 key)
 In radio status, press and hold any one of 1-6 keys, the current station will be stored.

MP3 player

MP3 play is to play with U disc, SD/MMC/TF card.

In U disc play status, the display will show “USB”

In SD/MMC/TF card play status, the display will show “SD”

In U disc or SD/MMC/TF card play status, the display will also show the playing information as track number--Minute--Second.

1. Single (**◀◀/▶▶**)

In MP3 play status, short press **◀◀** or **▶▶** to select the previous or next.

2. FR/FF (**◀◀/▶▶**)

In MP3 play status, long press **◀◀** or **▶▶** to fastly reverse/forward.

3. Pause (1/PAU)

In MP3 play status, short press 1/PAU to pause, the display will show, short press 1/PAU again to play.

4. INT (2/INT)

In MP3 play status, short press 2/INT to play the first 10 seconds of each song, the screen will display **INT**. In this status, short press 2/INT again to cancel browse, the display will shortly show “ALL” and start normal play.

FCC Statement:

This device complies with Part 15 of the FCC rules. Operation is subject to the following two conditions: 1) this device may not cause harmful interference, and 2) this device must accept any interference received, including interference that may cause undesired operation.

This equipment has been tested and found to comply with the limits for a Class B digital device, pursuant to Part 15 of the FCC rules. These limits are designed to provide reasonable protection against harmful interference in a residential installation. This equipment generates, uses and can radiate radio frequency energy and if not installed and used in accordance with the instructions, may cause harmful interference to radio communications. However, there is no guarantee that interference will not occur in a particular installation. If this equipment does cause harmful interference to radio or television reception, which can be determined by turning the equipment off and on, the user is encouraged to try correct the interference by one or more of the following measures:

- **Reorient the receiving antenna.**
- **Increase the separation between the equipment and receiver.**
- **Connect the equipment into an outlet on a circuit different from that to which the receiver is connected.**
- **Consult the dealer or an experienced radio/TV technician for help.**

Changes or modifications not expressly approved by the party responsible for compliance could void your authority to operate the equipment.