

# Battery Security Camera

## User Manual



※Please read the Quick Guide carefully before using the product and keep it properly.

Reminder: Please charge the device for 2 hours before using it.

# Contents

1. Smart Battery Camera-----	01
Packaging List for PTZ Camera-----	02
2. Appearance Description-----	03
3. Safety Guidelines-----	08
4. Installation-----	08
5. Applications-----	09
6. Add Device-----	09
7. Add Camera to Mobile App-----	13
8. To view on EseeCloud Software on PC-----	19
9. FAQ-----	20

# Smart Battery Camera

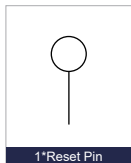
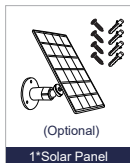
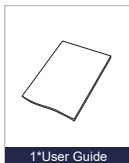
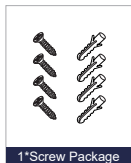
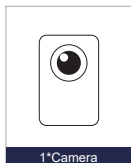

# Packaging List for PTZ Camera



1\*Camera



1\*Camera Mount



1\*USB Cable



1\*Screw Package



1\*User Guide

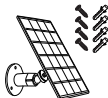

(Optional)

1\*Solar Panel



1\*Positioning sticker

# Appearance Description

(Q10)

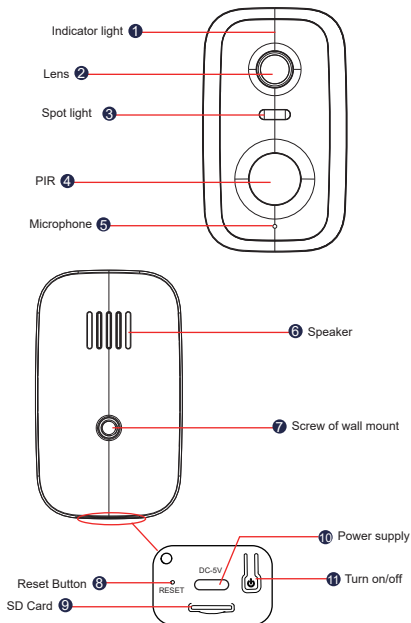

# Appearance Description

(Q11)

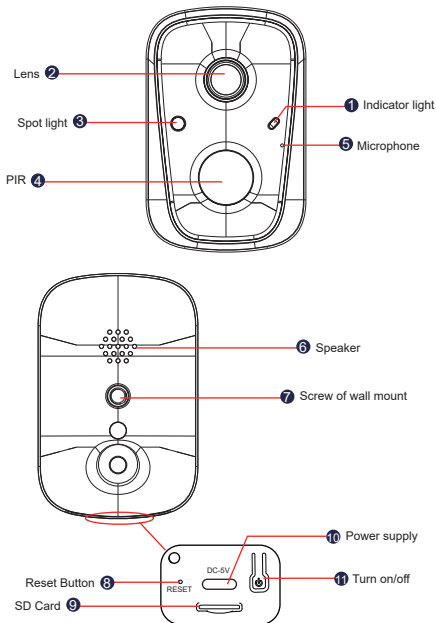

# Appearance Description

(Q12)

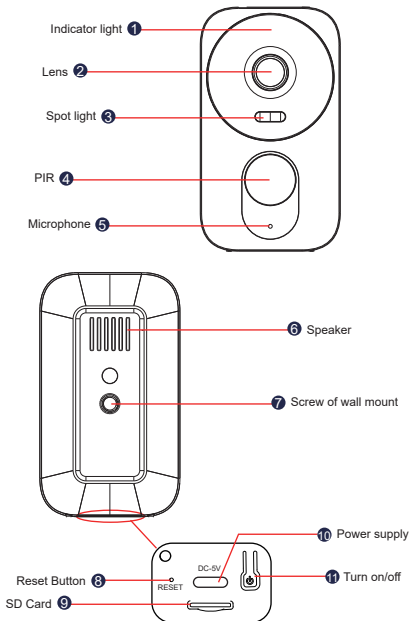

# Appearance Description

(Q15)

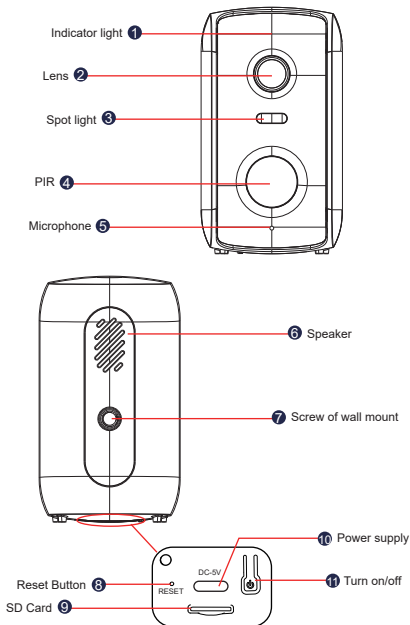



# Appearance Description

(SP1)

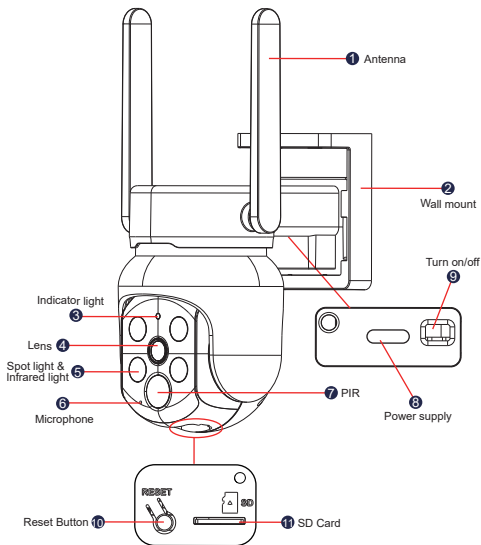

## Safety Guidelines

- 1) Please do not put any fluid container on the product.
- 2) Please charge the camera for 2 hours when using the camera for the first time.
- 3) Please use the product in ventilated environment and prevent blocking the vents.
- 4) Please use included power supply with the product to prevent damage to the product.
- 5) Please use the product under its standard working temperature and humidity.

## Installation

- Ensure that the equipment in the package is in good condition and includes all assembly parts. If you lack accessories, please contact us.
- During installation, Please ensure that the distance between the camera and the router is within the area with good WiFi signal.
- Make sure the walls are strong enough to withstand four times the weight of the camera and bracket.
- Please install the camera as close to the router as possible, and install the solar panel in a well-lit location.
- Supports 2.4 GHz&5.8 GHz (dual band)

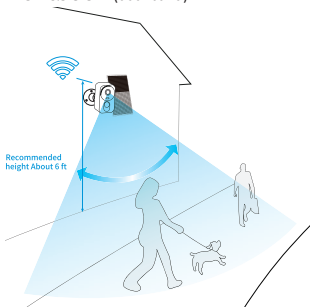

# Applications



## Add Device

### Software Download

#### 1.1 Download Free App EseeCloud

Search free APP "EseeCloud" in App store or Google play. The phone App will be updated sometimes, if your phone App menu is different from the menu on the user manual, please contact us to get the latest user manual.



EseeCloud App



EseeCloud App download

**Note: For IOS system, it requires IOS 9.0 version or above.  
For Android, Android 5.0 or above.**

### Register Account and log in .

- 1) Go to login interface , click" phone number" .
  - a: Choose the region code and input phone number
  - b: Manually press and hold the tennis ball drag it to the red and then drag it to the tennis racket to go to the next step.
  - c: You' ll receive a verification code input the verification code
  - d: Input the code and register successfully.

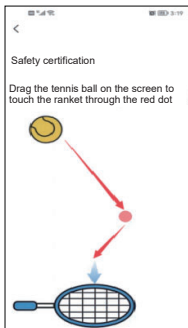
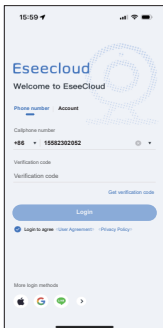

2) Account: Register account with your phone number or email to log in.

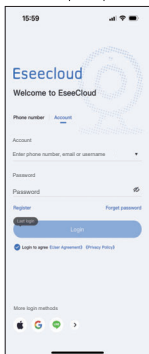

- a. Click "Register".
- b. Register with your phone number/email, and click "Confirm".

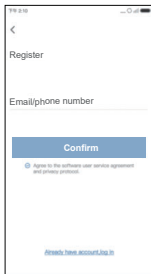

The screenshot shows a mobile app interface for registration. At the top, there is a back arrow and the title "Register". Below the title is a text input field labeled "Email/phone number". Underneath the input field is a blue button labeled "Confirm". Below the button, there is a small icon of a person and the text "Agree to the software user service agreement and privacy protocol". At the bottom of the screen, there is a link that says "Already have account? Log in".

- c. Manually press and hold the tennis ball, drag it to the red dot, then drag it to the tennis racket.
- d. Next, you'll receive a verification code. Input the verification code and set up your password. Then click "Confirm" to finish.

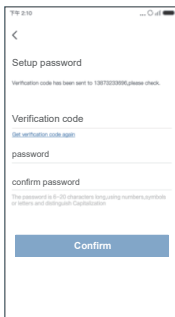
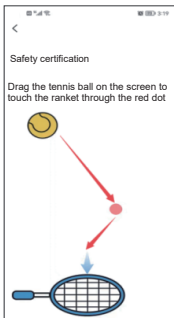

The screenshot shows a mobile app interface for setting up a password. At the top, there is a back arrow and the title "Setup password". Below the title, there is a text instruction: "Verification code has been sent to 13673233990, please check." Below this, there is a text input field labeled "Verification code". Below the input field, there is a link that says "Get verification code again". Below the link, there is a text input field labeled "password". Below the input field, there is a text input field labeled "confirm password". Below the input field, there is a text instruction: "The password is 6-20 characters long, using numbers, symbols or letters and distinguish Capitalization". At the bottom of the screen, there is a blue button labeled "Confirm".

3) Quick Login: After your first log in , the APP will automatically recognize your phone number, next time you can choose “quick login”.

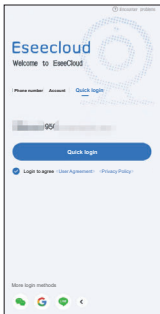

4) More login method: you can log in via Wechat, Google or Line account .

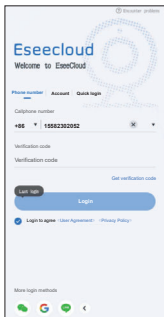

# Add Camera to Mobile App

## Method 1 - By Bluetooth Connection

Please full charge camera for 12 hours at the first time use.

1. Turn on the camera
2. Click "Add camera" on your mobile app.

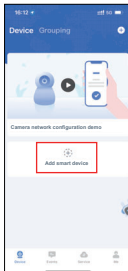

3. Please turn on Bluetooth---Enable

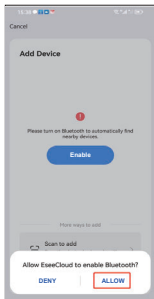
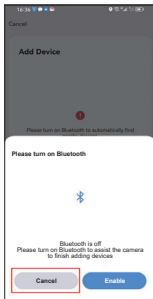

4. Find new device and click on "Add".



5. Choose your home wifi. Please note it supports 2.4ghz/5ghz WiFi.





6. Waiting for configuring successfully, then you can name your camera.

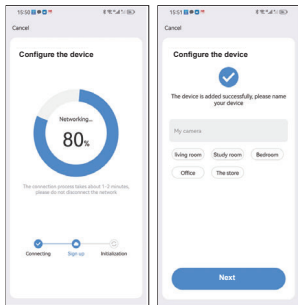

7. Setup motion detection alert if you need the function.

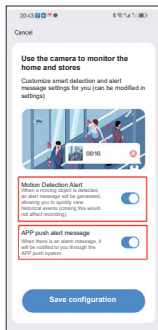

## Method 2 Scan to add

1. Please full charge camera for 12 hours at first time use. Turn on the camera

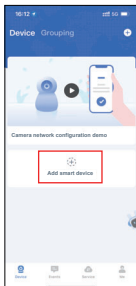

Click "Add camera" on your mobile app

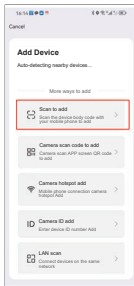

Choose the "Scan to add"

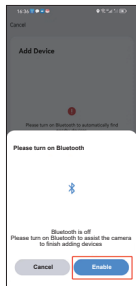

Enable your bluetooth



Scan the camera code

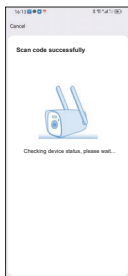

Check "hear the device prompt sound" and click on "Next".



Choose your home WiFi.  
Please note it supports  
2.4ghz/5ghz WiFi.



Waiting for configuring successfully, then  
you can name your camera.

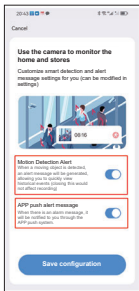
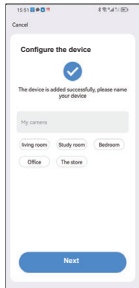

Setup motion detection alert  
if you need the function.

Please note if you can't or you don't want to use bluetooth connection, you can choose "cancel" when it pops up bluetooth connection. After you connect with your WiFi, there will be code on your phone, you can use your camera scan the code on your phone to finish configuring the device.

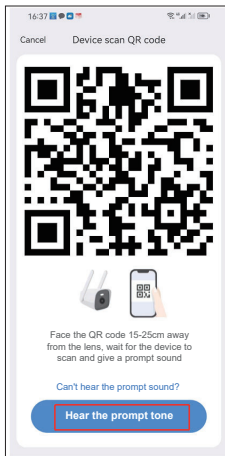

## To view on EseeCloud Software on PC

You need to register an account of EseeCloud on your mobile phone and add the device first. So that you can remote view on PC. This is the link of Eseecloud software.

**Windows:** [http://download.dvr163.com/tool/eseeccloud/EseeCloud\\_Setup\\_3.0.8.0.exe](http://download.dvr163.com/tool/eseeccloud/EseeCloud_Setup_3.0.8.0.exe)

**MAC:** [http://download.dvr163.com/tool/EseeCloud-mac-2.0.8\\_20200228.zip](http://download.dvr163.com/tool/EseeCloud-mac-2.0.8_20200228.zip)

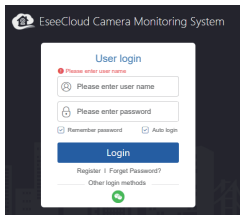

Please note the user name and password only can be entered by hand, do not paste.

- Input the same account and password of Eseecloud as your mobile terminal, click login.
- After logging in the account and password, the device will automatically synchronize to the computer.

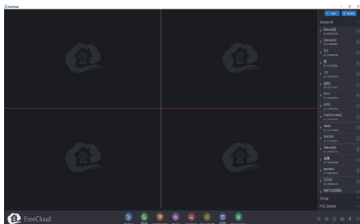

# FAQ

## Q1. The solar camera stop working?

A. 1. Take down the camera to charge it. The blue light flashes and it is charging.

2. After the camera is charged, please delete the device on the app, then press reset button for 6s, add device again.

## Q2. The camera consumes too much power?

A. 1. You can select optimal better life mode, select record time.

2. Adjust the motion detection sensitivity to low, reduce frequent camera detection and you can customize a detection area.

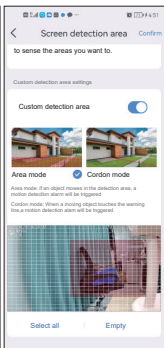
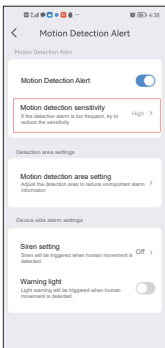
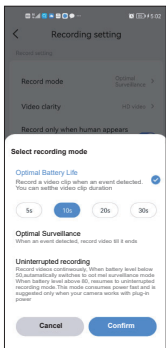

### Q3: I didn't receive the motion detection alarm from my smartphone

A: 1. go to the App -- click  icon on upper right corner -- enable "Alarm push".

2. if still not receive, go to Me -- System authority settings -- check if all permission is enable.

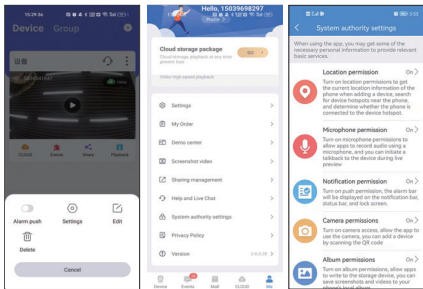

### Q4: There is no recordings when I check playback?

A: SD card storage:

1. Please go to setting interface-Storage settings-Local storage-check the status of the SD card. If there is no SD card. Please take the SD card out and insert it again.

2. If the SD card is in normal condition, for stability, please format the SD card before use.

Cloud storage:

Please go to setting interface-storage management-cloud storage-check the order for cloud storage (Cloud storage service is not free. You need pay for it) If these steps can't work, please contact with Technical Support Team for further assistance.

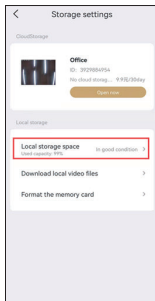

**Q5: Can i add this camera to other EseeCloud security camera system?**

A: Yes, this one camera is compatible with other EseeCloud wireless security camera system.

**Q6: How can i set it to 24/7 recording?**

A: Click  icon, click “settings”, click “Recording setting”, click “Record mode”, click “Uninterrupted recording”. Please note when battery level below 80, it will automatically switch to optimal surveillance mode, so the 24/7 recording of this camera only works with plug-in power.



## FCC Statement

This equipment has been tested and found to comply with the limits for a Class B digital device, pursuant to part 15 of the FCC Rules. These limits are designed to provide reasonable protection against harmful interference in a residential installation. This equipment generates, uses and can radiate radio frequency energy and, if not installed and used in accordance with the instructions, may cause harmful interference to radio communications. However, there is no guarantee that interference will not occur in a particular installation. If this equipment does cause harmful interference to radio or television reception, which can be determined by turning the equipment off and on, the user is encouraged to try to correct the interference by one or more of the following measures:

Reorient or relocate the receiving antenna.

Increase the separation between the equipment and receiver.

Connect the equipment into an outlet on a circuit different from that to which the receiver is connected.

Consult the dealer or an experienced radio/TV technician for help.

Caution: Any changes or modifications to this device not explicitly approved by manufacturer could void your authority to operate this equipment.

This device complies with part 15 of the FCC Rules. Operation is subject to the following two conditions: (1) This device may not cause harmful interference, and (2) this device must accept any interference received, including interference that may cause undesired operation.

## RF Exposure Information

This equipment complies with FCC radiation exposure limits set forth for an uncontrolled environment. This equipment should be installed and operated with minimum distance 20cm between the radiator and your body.