

Free Warranty Extended

Register FREE 24-Month Warranty

www.tobenone.com/warranty



THANK YOU!

Thank you for your purchase of the Tobenone 15-in-1 USB C Dual Monitor Dock UDS032. This dual-monitor docking station can help to expand Windows laptop with full-feature USB C ports to two HDMI, DP, SD & microSD card slots, 3.5mm audio & Mic, USB-A, USB-C, DC-IN, and RJ45 Gigabit Ethernet, so you can easily connect multi-devices via one USB-C cable.

Ports and connectors

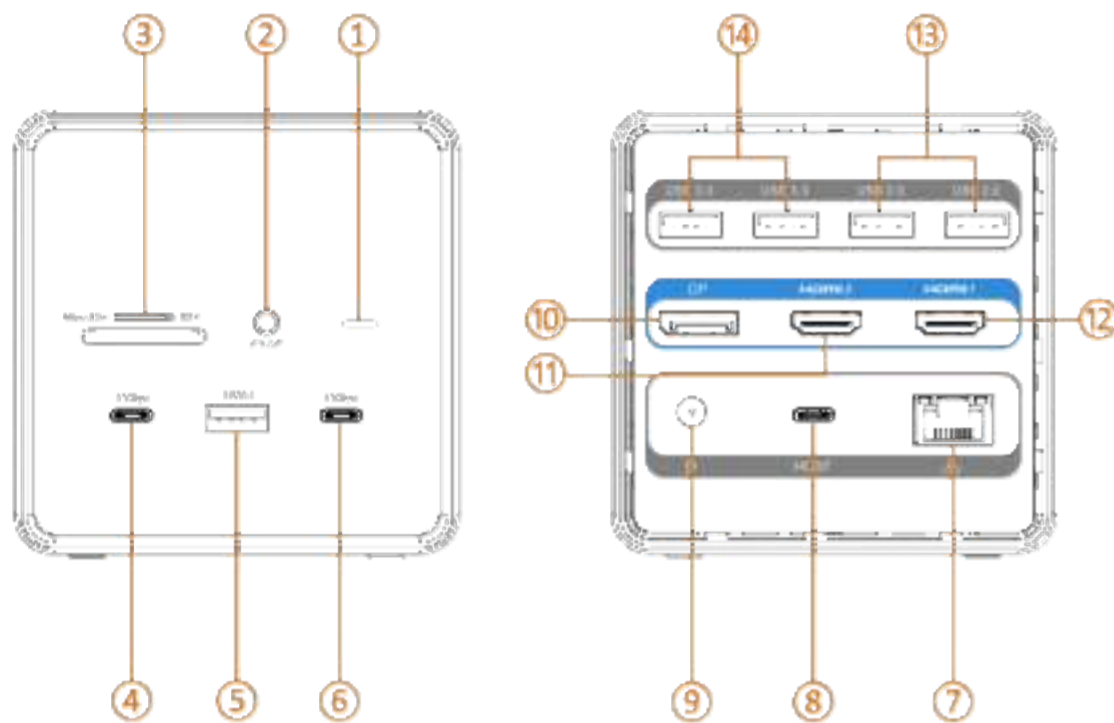

- ① Working indicator
- ② Audio Port: connect to earphones or other devices with a 3.5mm connector
- ③ Micro SD/SD
- ④ USB C 3.1 Port: support data transfer at 10 Gbps
- ⑤ USB A 3.1 Port: support data transfer at 10 Gbps
- ⑥ USB C 3.1 Port: support data transfer at 10 Gbps
- ⑦ Ethernet Port: support 10/100/1000 Mbps
- ⑧ USB-C Host: connect to your Full-feature USB C Windows laptop
- ⑨ DC-IN Port: charger your laptop through the DC-IN port
- ⑩ DP port: resolutions up to 4K@60Hz (DP1.4)
- ⑪ HDMI 2 Port: resolutions up to 4K@30Hz (DP1.4)
- ⑫ HDMI 1 Port: resolutions up to 4K@60Hz (DP1.4)
- ⑬ USB 2.0 Port: connect wireless devices such as keyboard/mouse
- ⑭ USB 3.0 Port: support data transfer at 5 Gbps

Any questions we are here to help!

Email: support@tobenone.com

WhatsApp:(307)363-0735

Because the only question we can't fix is the one we don't know

USB-C Docking Station Dual Monitor Quick Start Guide

Please Follow Below Steps for Using Your Dock

Step 1: Please plug the power adapter into the DC-IN port(⑨)

Step 2: Please use the USB C cable as provided to connect the USB C host (⑧) of the dock and your USB C Windows laptop

Step 3: Connect two monitors via any two ports of HDMI1, HDMI2, and DP. (⑩⑪⑫)

Dual Extended Monitors



Step 4: Attach the USB C devices (external USB C Hard Drive) to the USB C ports of the front of the dock(④⑥). Attach USB devices(USB Drive, printer, etc) to the USB ports(⑤⑬⑭). It's recommended to connect the wireless mouse and keyboard to the USB 2.0 port(⑬). Insert the SD/micro SD card into the SD/micro SD port(③)

Step 5: Connect speaker/headphones or Microphones to the audio port(②)

Step 6: Connect the ethernet cable to the Ethernet port(⑦)

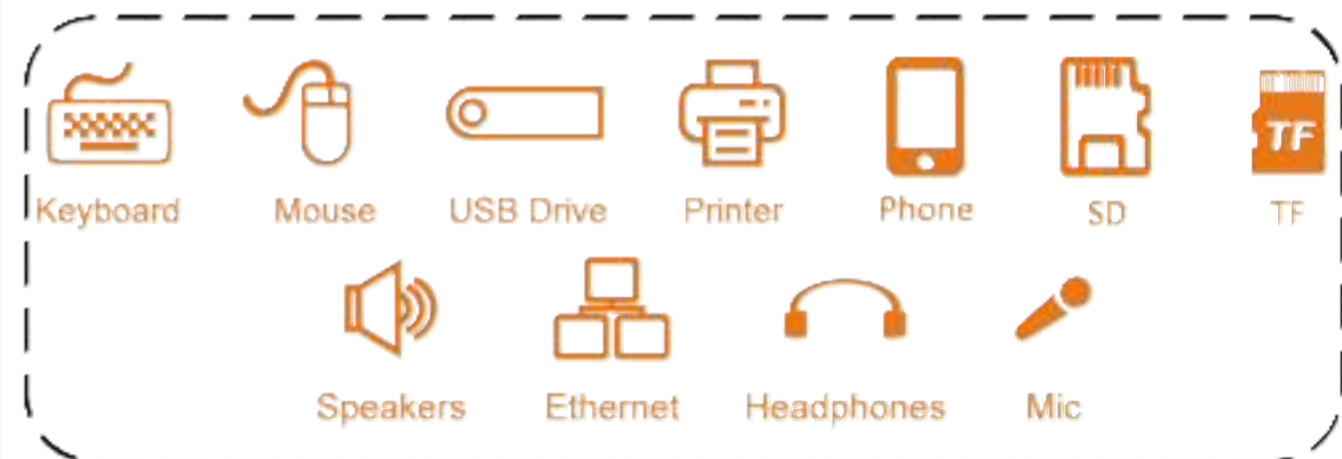

Troubleshooting:

Q: Is this docking station compatible with my laptop?

A: Please ensure the USB-C port of your laptop not only support data transfer but also support Power delivery and Alt-mode DisplayPort.

If you are not sure, please contact us so we can check.

Q: Why the HDMI/DP cannot work?

- A: 1. Please ensure your laptop's USB C port supports video output.
- 2. Please ensure the standard cable(HDMI to HDMI/DP to DP cable).
- 3. Please attach the power supply to the DC-IN port of the dock.

Any questions we are here to help!

Email: support@tobenone.com

WhatsApp:(307)363-0735

Because the only question we can't fix is the one we don't know

