



BG-C10-2

BATTERY GRIP

Designed for the Canon
EOS 70D, 80D, and 90D
DSLR Cameras



Thank you for choosing Vello

The Vello BG-C10-2 battery grip offers extended shooting time and comfort when shooting in a vertical (portrait) orientation. The grip is compatible with the Canon 90D, 80D, and 70D DSLR Cameras and accepts up to two Canon LP-E6/E6N(H) rechargeable batteries. It offers an alternate shutter release button, main dial, and access to AF-ON and autofocus and autoexposure selection buttons, making the grip ideal for shooting portrait photography. The control-lock switch disables all the grip's controls to prevent unwanted triggering.

Please read through this entire manual before using the BG-C10-2 battery grip.

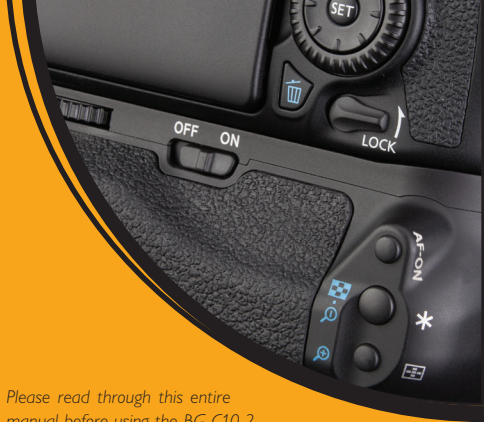

Precautions

- 1.** The BG-C10-2 should be used only with the compatible devices specified in this manual.
- 2.** Use only with the batteries and battery holders recommended in this manual.
- 3.** If you notice smoke, noise, or an unusual smell from the battery pack, discontinue use immediately. Remove the batteries, and take the device to a Vello authorized reseller.
- 4.** The battery level may not display properly if batteries are installed before mounting the grip.
- 5.** Remove batteries from the grip when not in use.
- 6.** Do not attempt to disassemble.
- 7.** Avoid exposing this product to water or extreme humidity, and keep it in a cool, dry place.
- 8.** Keep out of reach of children.
- 9.** All images are for illustrative purposes only.

Overview

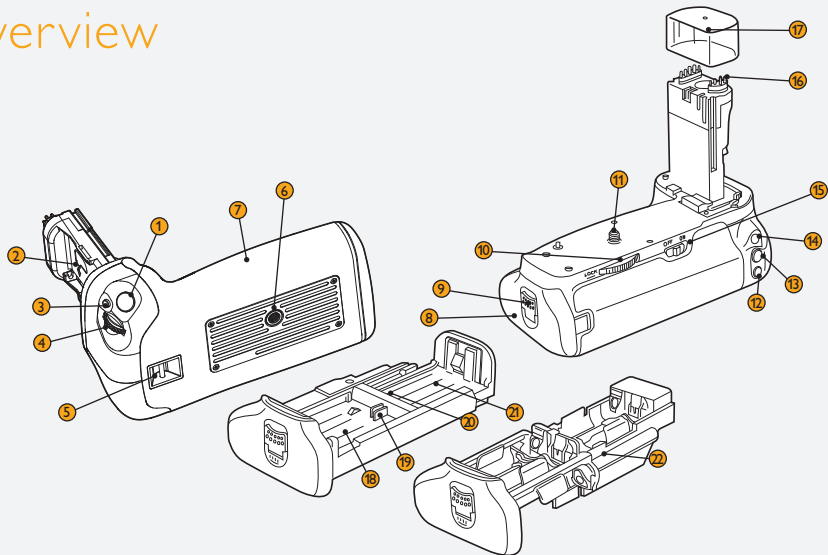

① Shutter release button

② Camera battery door holder

③ AF area/AF method

④ Main dial

⑤ Hand-strap mount

⑥ Tripod socket

⑦ Nonslip grip

⑧ Battery compartment

⑨ Battery compartment lock

⑩ Thumbwheel

⑪ Mounting screw

⑫ AF-ON selection and magnify button

⑬ AE/FE lock and Index/reduce button

⑭ AF-ON button

⑮ Control lock switch

⑯ Power contacts

⑰ Contact cap

⑱ Battery slot 1

⑲ Slot 1 contacts

⑳ Slot 2 contacts

㉑ Battery slot 2

㉒ 6-bay AA battery tray

Attaching the Battery Grip

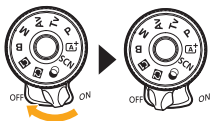

1. Ensure that the camera is turned off.

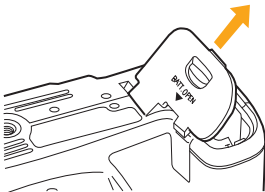

2. Remove the camera's battery chamber door. Pull gently at a 45° angle until the door detaches.

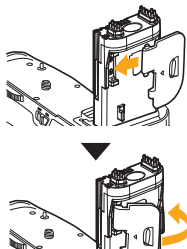

3. Slide the chamber door into the BG-C10-2's camera battery door holder for safekeeping.

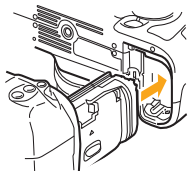

- 4.** Insert the battery grip's power contacts into the camera's battery chamber and attach the grip to the camera.



- 5.** Rotate the thumbwheel counterclockwise until the grip is secured to the camera.

Inserting Batteries



1. Turn off the camera's power, and make sure the grip's control lock switch is in the Off position.

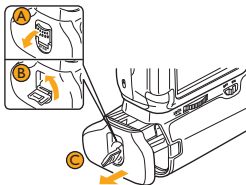

2. Twist the battery tray's lock, and remove the battery tray from the grip.

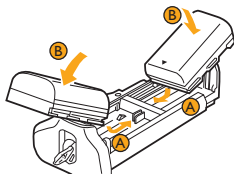

3. **Canon LP-E6 / E6N(H) batteries:** Insert the first battery into slot 1 as shown, and push down to lock the battery in place. Repeat for slot 2.

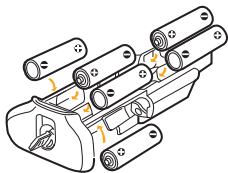

4. **AA Batteries:** Place six identical AA batteries into the AA battery tray as indicated.

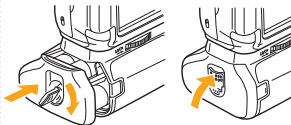

5. Insert and lock the battery tray inside the battery grip.

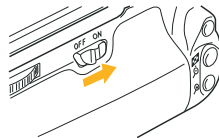

6. Turn on the camera power, and switch the grip's control lock to the On position.

Note: When removing the grip, turn off the camera's power, switch the grip's control lock to off, and then remove the batteries.

Specifications

Power source	1. Up to two Canon LP-E6/E6N(H) type rechargeable Li-ion batteries 2. Six AA/LR6 Alkaline, Ni-MH, Lithium or Nickel-Manganese batteries
Operating temperature	32°F to 104°F (0°C to 40°C)
Dimensions (H × W × D)	4.5 × 5.7 × 3.3 in. (11.4 × 14.5 × 8.5 cm)
Weight	9 oz. (254 g) without batteries

Specifications and design are subject to change without notice.

When using the AA battery tray, the battery indicator will work with only NiMH batteries.

Please note: It's not recommended to use Duracell® brand alkaline batteries.

ONE-YEAR LIMITED WARRANTY

This VELLO product is warranted to the original purchaser to be free from defects in materials and workmanship under normal consumer use for a period of one (1) year from the original purchase date or thirty (30) days after replacement, whichever occurs later. The warranty provider's responsibility with respect to this limited warranty shall be limited solely to repair or replacement, at the provider's discretion, of any product that fails during normal use of this product in its intended manner and in its intended environment. Inoperability of the product or part(s) shall be determined by the warranty provider. If the product has been discontinued, the warranty provider reserves the right to replace it with a model of equivalent quality and function.

This warranty does not cover damage or defect caused by misuse, neglect, accident, alteration, abuse, improper installation or maintenance. EXCEPT AS PROVIDED HEREIN, THE WARRANTY PROVIDER MAKES NEITHER ANY EXPRESS WARRANTIES NOR ANY IMPLIED WARRANTIES, INCLUDING BUT NOT LIMITED TO ANY IMPLIED WARRANTY OF MERCHANTABILITY OR FITNESS FOR A PARTICULAR PURPOSE. This warranty provides you with specific legal rights, and you may also have additional rights that vary from state to state.

To obtain warranty coverage, contact the Vello Customer Service Department to obtain a return merchandise authorization ("RMA") number, and return the defective product to Vello along with the RMA number and proof of purchase. Shipment of the defective product is at the purchaser's own risk and expense.

For more information or to arrange service, visit www.vellogear.com or call Customer Service at 212-594-2353.

Product warranty provided by the Gradus Group.

www.gradusgroup.com

VELLO is a registered trademark of the Gradus Group. © 2021 Gradus Group LLC. All Rights Reserved.



All other trademarks are the property of their respective owners.

GG2