



# HUGOAI

## Smart Table Lamp User Guide

---

Setup instructions for Smart Life App,  
Alexa and Google Assistant.

 2.4Ghz WiFi



Works with  
Smart Life



Works with  
alexa



Works with the  
Google Assistant



Works with  
Siri Shortcuts



Scan the QR code to read the detailed  
instruction in <https://www.hugo-ai.com>.

# CONTENTS

Product Specification .....	1
Product Diagram .....	2
Smart Life App Setup .....	3-6
APP Operation Instructions .....	7-8
Connect to Alexa .....	9-10
Connect to Google Assistant .....	11
Enable Siri Shortcuts (For use with iPhone) .....	12
Problems and Solutions .....	13-14
Federal Communication Commission (FCC) Statement for Users .....	15

# Product Specification

## Package Includes

- 1 x LED Table Lamp
- 1 x AC Adapter
- 1 x User Manual

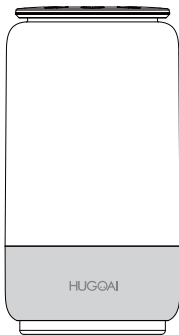

## Specification

Model	HG02
Wattage	6W
Adapter Input	100-240V/AC 50/60Hz
Adapter Output	5V/1A
Current Ripple	Flicker Free $\pm 3\%$
Network	WIFI IEEE802.11b/g/n(2.4GHz)
Luminous Flux / Intensity	450lm@4000K, Red:7.2cd, Green:12cd, Blue:6.6cd
CCT / Color	2000K-4000K / 16 Million Colors
CRI	Ra:>80, Ra:>90@2000K/3000K
IP Rating	IP20
Operation Temperature	-20°C~40°C/-4°F~104°F
Lifespan	30,000hrs
Dimensions	4.3" X 4.3" X 8.3" (110mm X 110mm X 210mm)

# Product Diagram

Control Panel

Lamp Cover

Base

Type-C Port



Press to turn on and off the lamp



Press to turn on RGB Mode

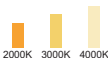

Press to switch color temperature



Slide to adjust brightness or color



Press to set timers. It will set the light to 2000K and auto-off in 30 min

# Smart Life App Setup

## Preparation

1. Connect to 2.4GHz Wi-Fi network and turn Bluetooth on.

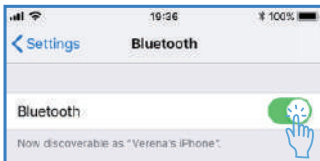

2. Install the Smart Life app from the Apple Store/ Google Play Store, or via scanning the QR code.

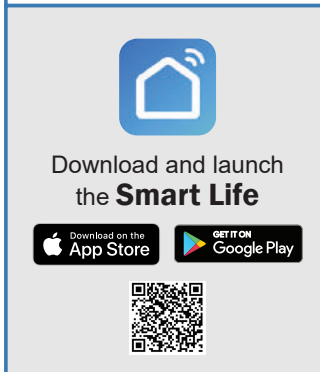

3. Register an account and allow the app to use Bluetooth.

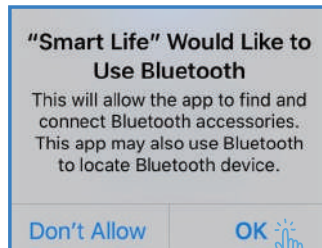
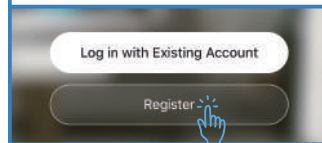

# Smart Life App Setup

## Prepare the Lamp for Connection

① Charge and turn on the lamp.



ON OFF



② Press the timer button for more than 5s until the indicator flashes quickly in green.

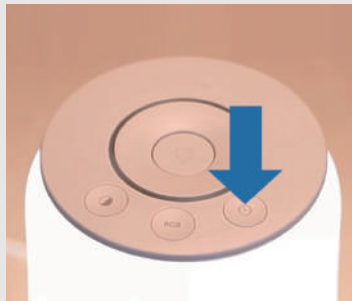
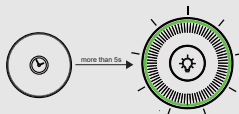

# Smart Life App Setup

## Add the Lamp to Smart Life (via Bluetooth)

① The lamp will appear automatically waiting to be added when you open the Smart Life App.

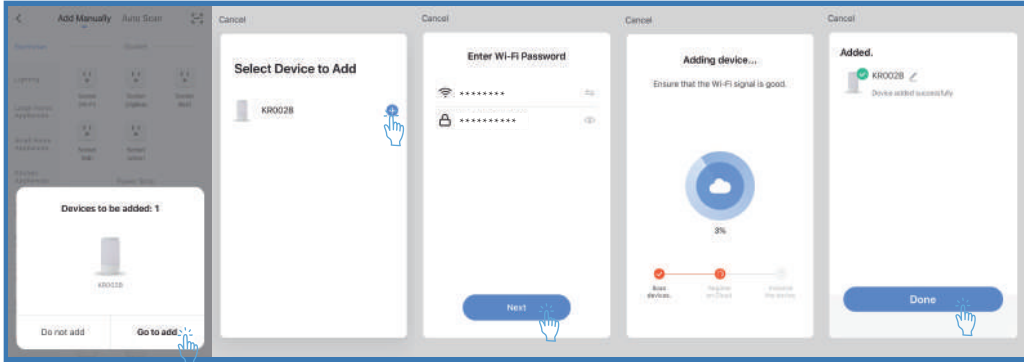

Click "Go to add".

Select the table lamp.

Enter 2.4GHz Wi-Fi network name and password, then tap "Next".

Wait for adding device.

You can edit the lamp name and click "Done".

# Smart Life App Setup

## Add the Lamp to Smart Life (Manually)

② Or you could add the lamp to Smart Life manually.

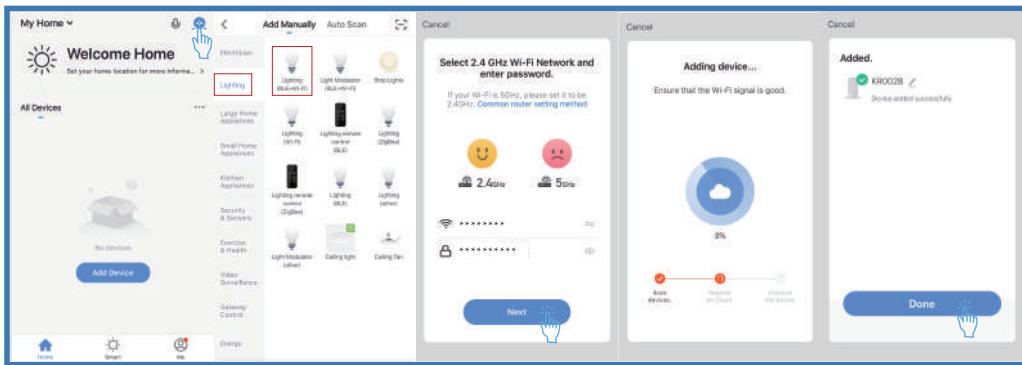

Tap "+" in the upper right corner or you can also select "Add Device".

Tap "Lighting" and then tap "Lighting(BLE+Wi-Fi)".

Enter 2.4GHz Wi-Fi network name and password, then tap "Next".

Wait for adding device.

You can edit the lamp name and click "Done".

NOTE: If you have trouble setting up the lamp, please contact us via [support@hugo-ai.com](mailto:support@hugo-ai.com).



# APP Operation Instructions

## Tunable White

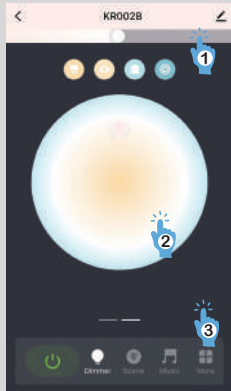

- ① Brightness Control
- ② Color Temperature Control
- ③ Slip these area can enter the color selector

## RGB Mode

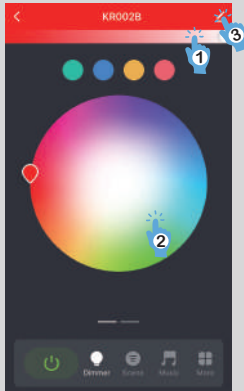

- ① Brightness Control
- ② Brightness Saturation / Color Control
- ③ Click to know more details of the device, or rename the lamp, share it to your families

## Scene Mode

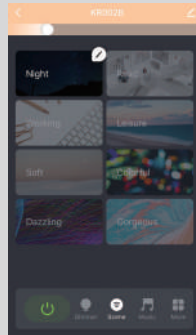

Note: For the scene modes: Night, Read, Working and Leisure, their color settings are fixed and could not be customized. However, you can customize the color setting of other scene modes (Soft, Colorful, Dazzling, and Gorgeous) according to your requirements.

# APP Operation Instructions

## Music Mode

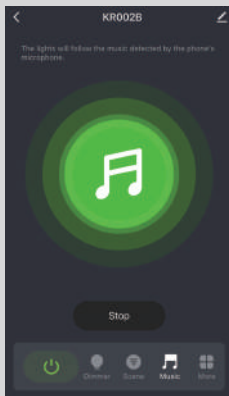

Choose Music Sync to match color changes to the beat of the music playing on your speakers.

## Schedules & Timers

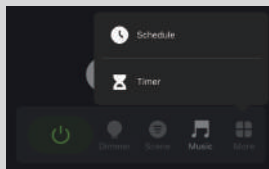

### Schedules

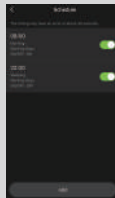

Set schedules based around your preferences and daily needs.

### Timer



Set the timer to turn off the lamp automatically.

# Connect to Alexa

Launch the Alexa App then tap on the Menu. Choose "Skills & Games" in the option bar.

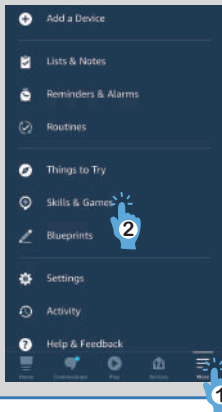

Search "Smart Life" in the input box and select Smart Life App in the search results.

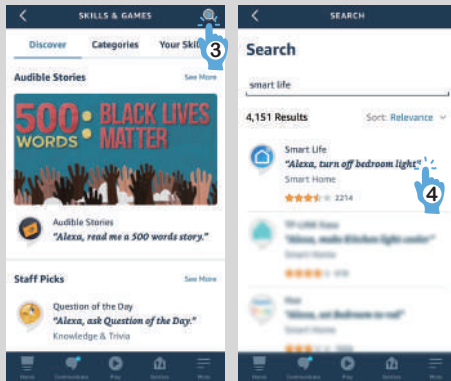

Click "ENABLE TO USE".

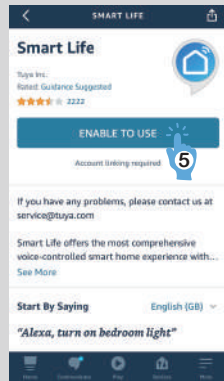

# Connect to Alexa

Log in Smart Life account and authorize Alexa. Then click "CLOSE".

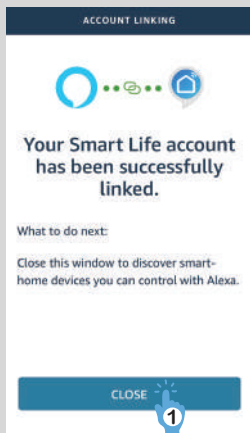

Tap "Devices" on the Menu. Here is a message "1 light discovered" on the top. The lamp is connected to alexa successfully.

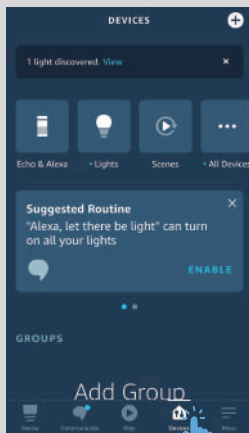

Then you could control the lamp via Alexa.

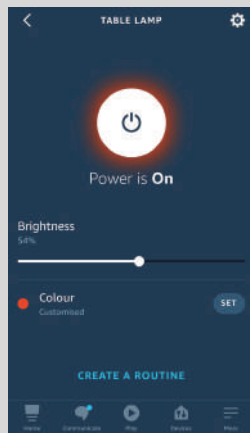

# Connect to Google Assistant

Launch the Google Assistant App then tap on the icon in the upper right.

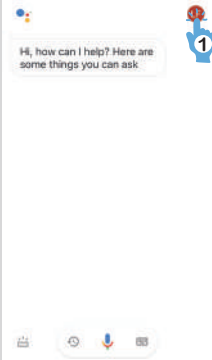

Tap "Assistant" and Choose "Home Control".

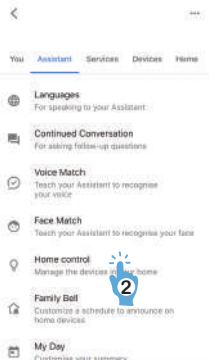

To add a device tap on the Circle(+) located in the lower right corner.

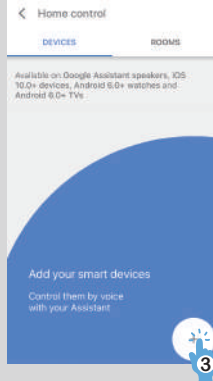

Search "Smart Life" App. Then log in your Smart Life account, tap "Link Now".

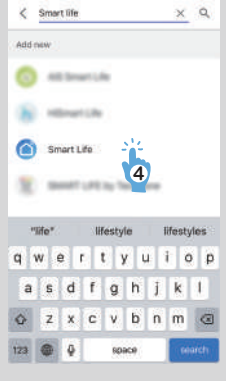

After you assign rooms for devices, your devices will be listed in the Home Control Page. Then you can control the lamp through Google Home.

# Enable Siri Shortcuts (For use with iPhone)



Tap "Smart" on the bottom menu bar and then create a "Tap to Run" command.

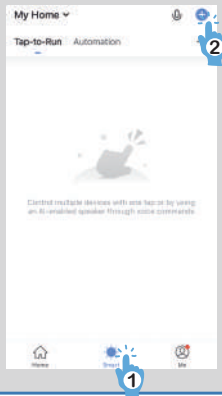

Set a condition and setting of "Tap-to-Run" command.

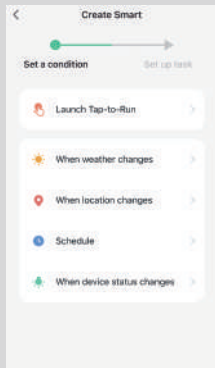

Click "Add to Siri" on the right corner.

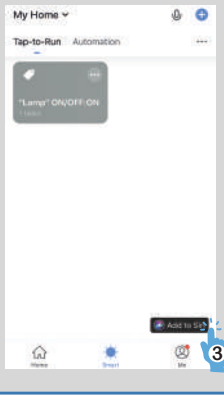

Edit the wake-up command and save shortcut.

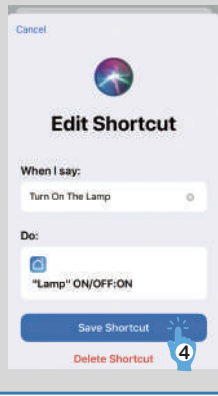

Now you can use the "Hey Siri" command to control this action from your iOS device.

# Problems and Solutions

## **If the app can't control your lamp but its status shows "on":**

Check if the device you're using is connected to network and if the lamp is within range of your Wi-Fi.

Check if the power supply of the lamp is working and make sure the power adapter is plugged into a working socket.

## **If the indicator turns red:**

The red light indicates that the lamp is disconnected with the network. Please check your WI-FI and make sure that the lamp is in good connection with network. Usually, the red light will stop in about 2 minutes and then the status of lamp on the app will be "offline". When the network is back up, the lamp will reconnect automatically.

## **Unbind the Lamp from a Certain Account**

To unbind the lamp from a certain account, please press the Timer button for more than 5 seconds till the indicator flashes quickly in green. Then the device will return to the initial connecting status and be available for another account.

# Problems and Solutions

## How to find Mac Address of the lamp?

Here are two ways to find the MAC address of your smart lamp out.

The first way is to connect your lamp with AP mode:

1. Click "Switch Paring Mode" in the Smart Life App when you fail to connect the lamp with Wifi.
2. Press the "Timer" button on the lamp for about 10-15 seconds till the indicator blinks slowly in green. Then click "confirm indicator slowly blink".
3. Click "Go to Connect" and then choose the WiFi of your lamp.
4. Click and link the Table Lamp's WiFi.

When the connection succeed, please click the lamp icon on the app home page and enter the lamp setting interface by clicking the "pencil" icon on the top right corner. Then, press "Device Information" and you will see the detailed information about the table lamp, in which the MAC address is included.

(If you cannot find the MAC address by this way successfully, please try the second way.)

The second way is to use a hotspot from another phone:

1. Please prepare 2 phones and use one of them as a hotspot (Setting-->Hotspot-->Switch On).
2. Connect the other phone to that hotspot.
3. Switch the smart table lamp on and hold the "Timer" button for 10-15 seconds until the indicator flashes green rapidly.
4. Open the app "Smart Life" on the connected phone and press "+"-->"Lighting"-->"Lighting(BLE+Wi-Fi)".
5. Enter the hotspot password and connect the lamp to the app.
6. When the connection succeed, please click the lamp icon on the app home page and enter the lamp setting interface by clicking the "pencil" icon on the top right corner.
7. Press "Device Information" and you will see the detailed information about the table lamp, in which the MAC address is included.



# Federal Communication Commission (FCC) Statement for Users

## Federal Communication Commission (FCC) Statement for Users

Warning: Changes or modifications to this unit not expressly approved by the party responsible for compliance could void the user's authority to operate the equipment.

This device complies with Part 15 of the FCC Rules.

Operation is subject to the following two conditions:

(1) This device may not cause harmful interference, and (2) This device must accept any interference received, including interference that may cause undesired operation.

NOTE: This equipment has been tested and found to comply with the limits for a Class B digital device, pursuant to Part 15 of the FCC Rules. These limits are designed to provide reasonable protection against harmful interference in a residential installation. This equipment generates, uses and can radiate radio frequency energy and, if not installed and used in accordance with the instructions, may cause harmful interference to radio communications.

However, there is no guarantee that interference will not occur in a particular installation. If this equipment does cause harmful interference to radio or television reception, which can be determined by turning the equipment off and on, the user is encouraged to try to correct the interference by one or more of the following measures:

- Reorient or relocate the receiving antenna.
- Increase the separation between the equipment and receiver.
- Connect the equipment into an outlet on a circuit different from that to which the receiver is connected.
- Consult the dealer or an experienced radio/TV technician for help.

FCC RF Radiation Exposure Statement Caution: To maintain compliance with the FCC's RF exposure guidelines, place the product at least 20cm from nearby persons.

HUGO..AI