

## INSTRUCTION MANUAL

**Tasmota is not a commercial product and support is limited. You have to be willing to research and solve potential problems yourself.**

Detailed information about connecting, changing settings and modifications is shown on the website  
["https://tasmota.github.io/docs/"](https://tasmota.github.io/docs/)

### How to connect and use

Separate the upper and tower parts from the switch by screwdriver

Demension:3.4x3.4x1.39in

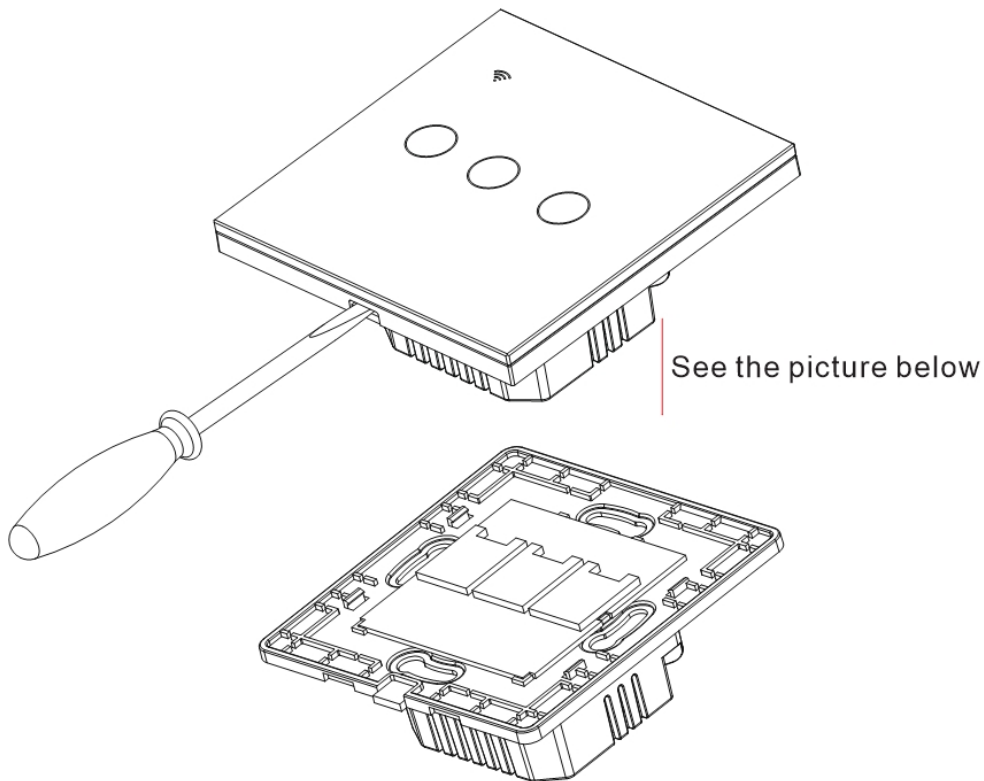

**Attention: Neutral wire is required.**

Prepare to install wiring

1. Live Wire connects "L" terminal
  2. Bulb Wire connects "L1, L2" terminal
  3. Neutral Wire connects "N" terminal
- 1 gang connects "L1"Terminal  
2 gang connects "L1, L2" terminal

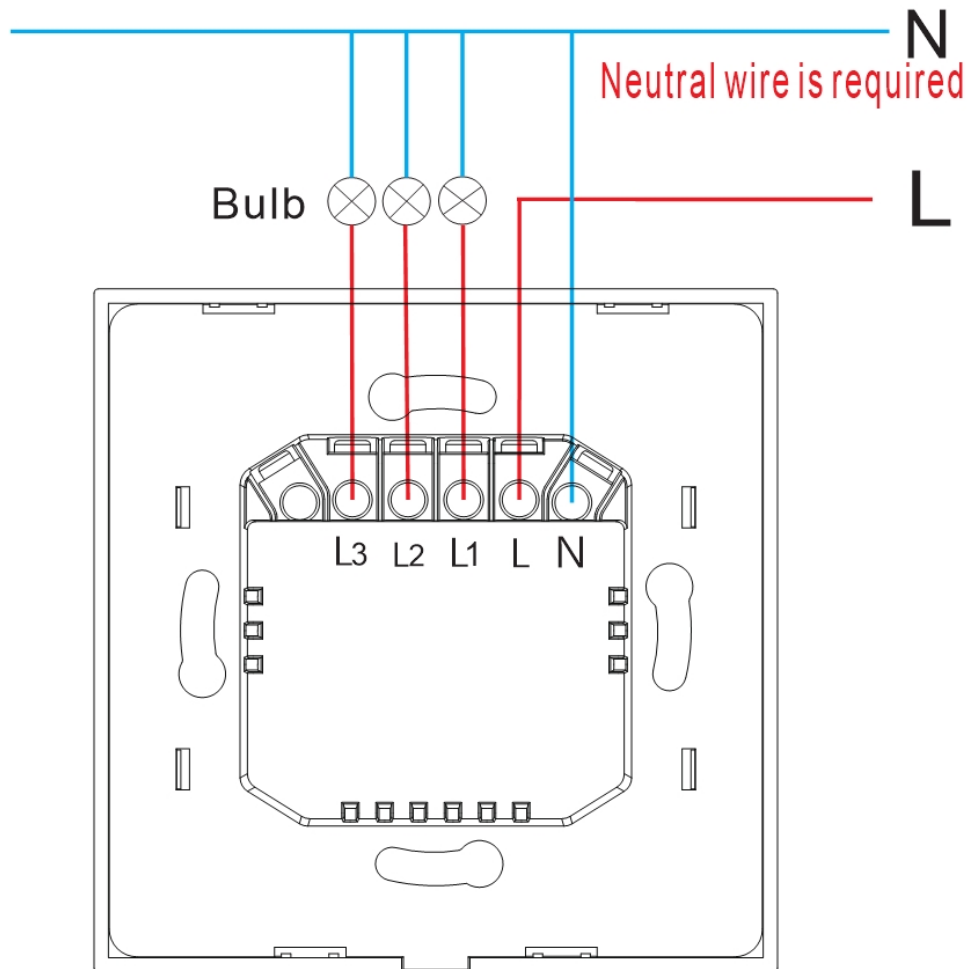

### Fitting switch on the wall

## How to connect:

1. Plug in the device
2. Find open wifi hotspot with Tasmota word in name
3. Connect to it and go to 192.168.4.1 address in browser
4. Enter your wifi network name and password
5. After confirming network data, power strip will show you IP address that it will be available from, copy it, just in case.
6. It will automatically redirect you to this address after you network data is filled and saved.
7. Power strip is ready to use. Template and rules already activated, but in case you will need it later - you can find it below

## Template Parameters:

```
{ "NAME": "NOUS
L1T", "GPIO": [544,0,1,32,0,0,0,0,224,288,0,0,0], "FLAG": 0,
  "BASE": 1 }
```

## NOUS L1T

# Tasmota

### Template parameters

<b>Name</b>	NOUS L1T		
<b>Based on</b>	Sonoff Basic (1) ▾		
<b>GPIO0</b>	LedLink ▾		
<b>GPIO1</b>	None ▾		
<b>GPIO2</b>	User ▾		
<b>GPIO3</b>	Button ▾	1 ▾	
<b>GPIO4</b>	None ▾		
<b>GPIO5</b>	None ▾		
<b>GPIO9</b>	None ▾		
<b>GPIO10</b>	None ▾		
<b>GPIO12</b>	None ▾		
<b>GPIO13</b>	Relay ▾	1 ▾	
<b>GPIO14</b>	Led ▾	1 ▾	
<b>GPIO15</b>	None ▾		
<b>GPIO16</b>	None ▾		
<b>GPIO17</b>	None ▾		

Save

Configuration

Tasmota 12.5.0 by Theo Arends

if there is power button:

Hold the power button 40+ seconds, until light blinks and device restarts

if there is no power button:

Plug the device in and out 6 times and leave plugged in on the 7th - LED should start to blink, that means socket is ready to be connected again

if have access to the web interface:

type **reset 1** in console and press enter

## Smart Home Intergrations

Tasmota is Incredibly expandable and flexible and can be integrated with:

Alexa, AWS IoT, Domoticz, Home Assistant, Homebridge, HomeSeer, IP Symcon, KNX, NodeRed, nymea, OctoPrint, openHAB, Otto, IOBroker, Mozilla WebThings Adapter, SmartThings, Tasmohab, Homematic ip, etc.