

PLUG IN THE POWER CORD

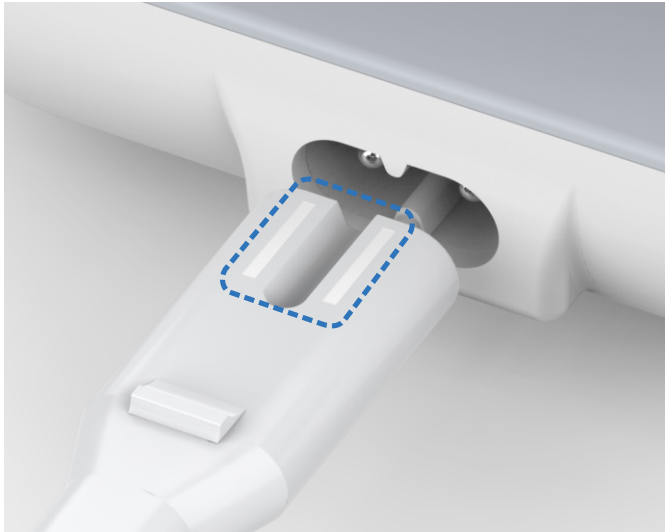

Step1:
Use your **Powerful way** to plug the Figure-8 female connector into the socket of the Charging Station. Make sure the **two white strips** are all in the Socket.



Step2:
Plug the male connector of the Power Cord into a standard outlet.

CHARGE 6 DEVICES SIMULTANEOUSLY

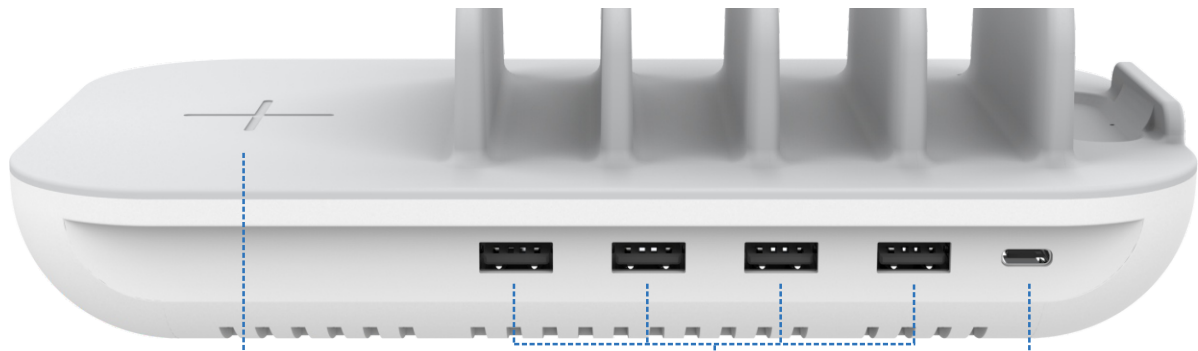

Wireless Charging

Wireless Charging 10W Max
Case ≤ 5mm



Powerful Charging

Recognizes your devices
and charges at the highest speed.

Power Delivery 3.0 18W

Fast Charge your iPhone XS/iPhone XS Max/
iPhone XR up to 50% in 30 minutes.

UNIVERSAL FAST-CHARGING COMPATIBILITY

with Power Delivery & Qi Wireless Charging

Apple
Fast Charging

Samsung
Fast Charging

Wireless Charging
10W Max

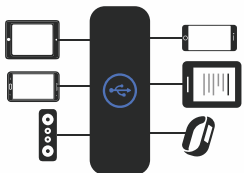

Compatible
With Any Device
That Uses a USB
Charging Port



FAST CHARGE YOUR IPAD PRO WITH A USB-C TO USB-C CABLE INCLUDED



NOTES

- This Charging Station cannot charge any Laptop, Computer.
- Not compatible with Qualcomm Quick Charge, and Xiaomi Air.
- Only the USB-C port supports fast charging.
- Use a USB-C to Lightning cable for Lightning devices with Power Delivery 3.0 fast charging, and use a USB-C to USB-C cable for Power Delivery 3.0 fast charging for your USB-C Devices.
(*USB-C to Lightning cable is not included in Package.)
- This Charging Station is Compatible with Note 10 / Note 10+ / S20 / S20+ / S20 Ultra, but the charging speed may be slower than the original 25W charger.



TROUBLESHOOT



Did you break something or need a spare part? Cables not enough?

We usually have the spare parts available:
Power Cords,
Cables(Apple Lightning, Micro USB, Type-C,
Wide Apple cables for old iPads / iPhone4)
Contact us at Service@soopii.cn,
we will be happy to replace it for you.



What to do if Charging Station is not working?

Check if the Figure-8 Female Connector is tightly connected into the socket of the Charging Station. Try other charging cables to connect the USB ports, to exclude if it's the problem of charging cables.



Item stopped working?

Don't worry, you have 1 year Warranty, and Lifetime Customer Care.
Contact us at Service@soopii.cn,
Within 24-hours, we will provide you Solution and Guidance to your satisfaction immediately.

Specification

Charging Technology: Power Delivery 3.0 & AI Smart & Qi Wireless Charging
1 x PD Port Output: 5V/3A, 9V/2A, 12V/1.5A
4 x AI Ports: 5V = 2.4A
1 x Qi Wireless Charging 10W
Total Wattage: 60W
Size: 8.7 x 4.9 x 3.0 inches
Weight: 18 oz

What you get in Box

1 x SooPii 5-Port Charging Station with Wireless Charging Pad
1 x 5ft Power Cord
5 x Pack short Charging Cables
1 x Quick Instructions
1 x Service Card