

STARLINK | PERFORMANCE PIPE ADAPTER

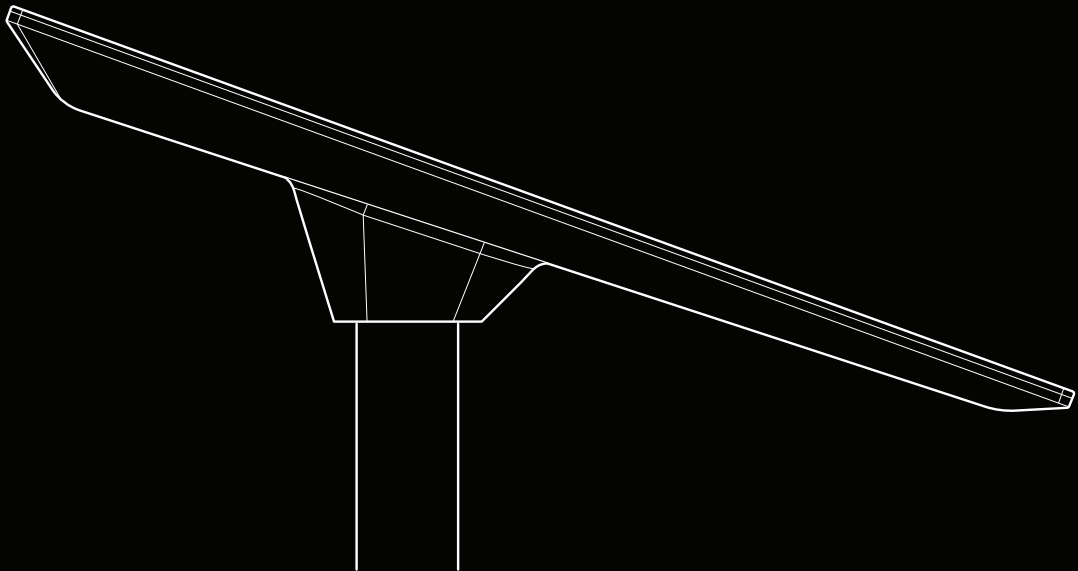

What's in the Box

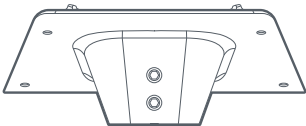

Pipe Adapter Mount



M6 Button Head Screws
(4x)



Hex Key
(2x)

99 mm
(3.9 in)

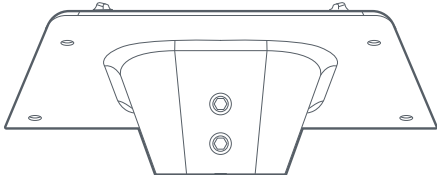

252 mm
(9.9 in)

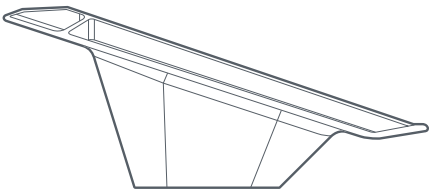

233 mm
(9.2 in)

218 mm
(8.6 in)

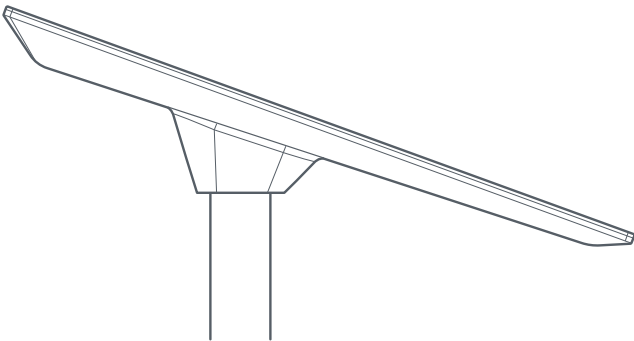

38-60 mm
(1.5 - 2.4 in)

1 | Download the Starlink App

Scan the QR code to download the Starlink App.

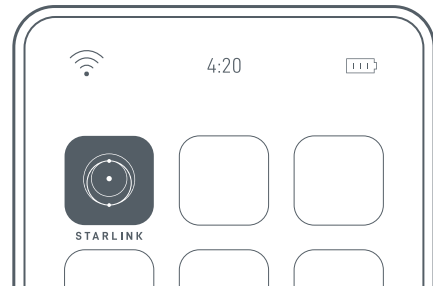
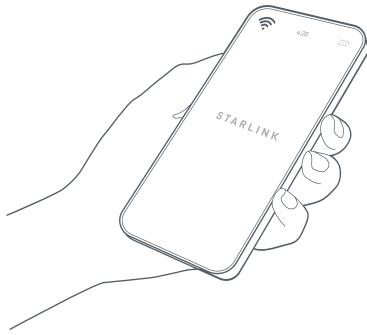

2 | Plug in Starlink Cable

Align the Performance connector end of the Starlink cable indicated by the red notch and plug into your Starlink by holding the end of the plug and firmly inserting into the dish.

If the Starlink cable needs to be removed, rotate the collar counterclockwise and pull to disconnect from your Starlink.

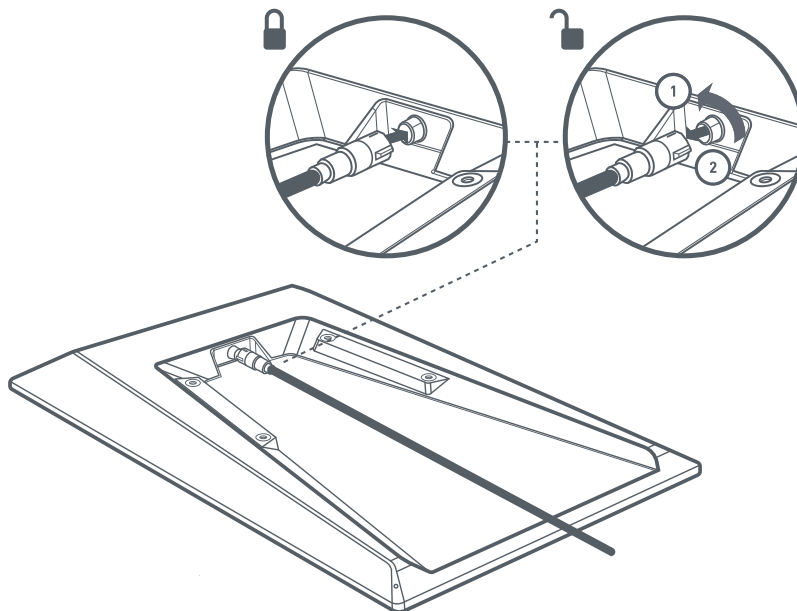

3 | Install Pipe Adapter Onto Starlink

Install the provided machine screws through the pipe adapter into the back of the Starlink and tighten the four screws using the hex key. Tighten screws in all 4 corners until bolts reach 7 N-m (5.2 lb-ft). Ensure the mount is firmly attached to the Starlink.

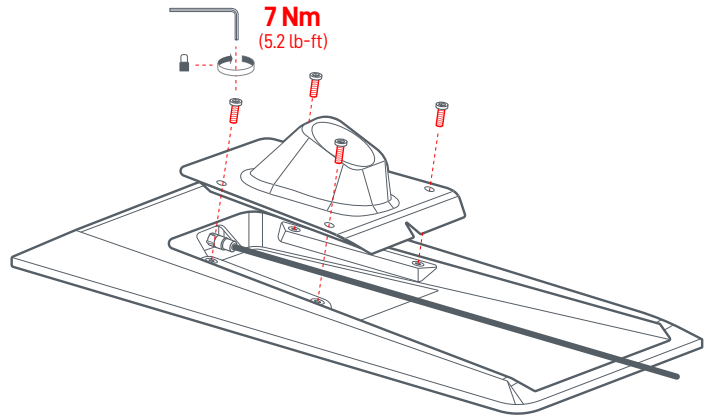

4 | Loosen Attachment Screws

Using the hex key, loosen the attachment screws in the Pipe Adapter until the opening is large enough to fit your mounting pipe.

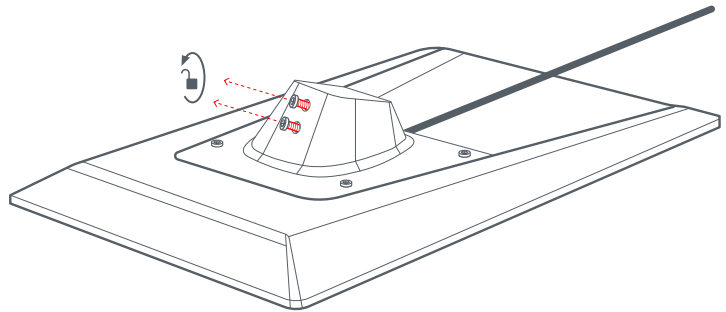

5 | Mount Starlink to Pipe

Slide the Pipe Adapter onto your mounting pipe. Temporarily tighten the attachment screws to stabilize Starlink onto pipe.

Connect the other end of the Starlink cable to the power supply and plug it into power outlet.

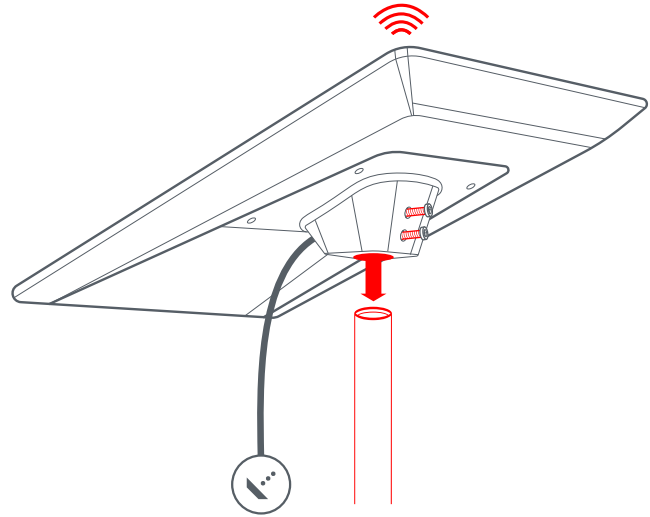

6 | Align Your Starlink

An alert on the App will show if you need to rotate Starlink to be properly aligned.

Click the alert to use the alignment tool.

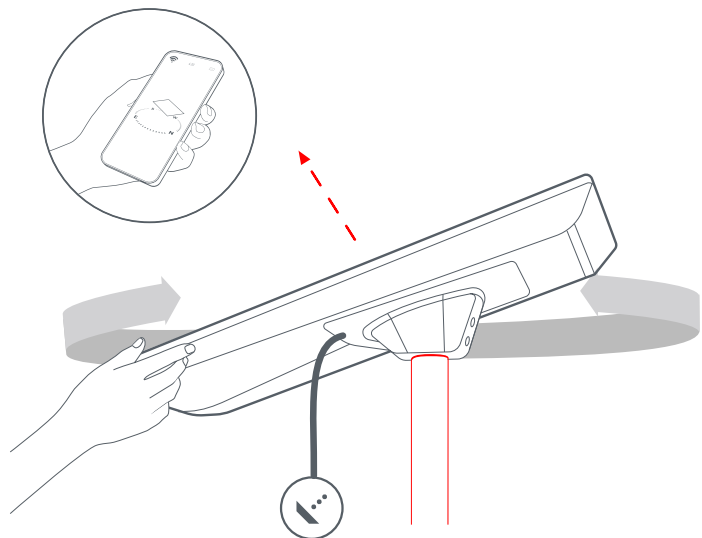

7 | Lock Alignment

Using the hex key, tighten the attachment screws on the Pipe Adapter to lock your Starlink in place.

Ensure your Starlink is firmly attached.

