

# LOCKN LUBE LOCKN FLATE

## PRO SERIES HOSE REELS



# LOCKN LUBE LOCKN FLATE

**WARNING:**

Read carefully and understand all **INSTRUCTIONS** before operating. Failure to follow the safety rules and other basic safety precautions may result in serious personal injury. Save these instructions in a safe place and on hand so they can be read when required.

**WARNING:**

The warnings, cautions, and instructions discussed in this instruction manual cannot cover all possible conditions or situations that could occur. It must be understood by the operator that common sense and caution are factors that cannot be built into this product but must be supplied by the operator.

**CAUTION:**

Make sure the line pressure does not exceed the rated operating pressure of your model hose reel; refer to the Specifications section.

**CAUTION:**

Exposure of the skin directly to pressurized air or fluid could result in severe bodily injury.

**CAUTION:**

Always close the supply of fluid / gas to the reel and release the line pressure / vent the hose before carrying out any maintenance on the reel.

## GENERAL SAFETY

The following general warnings should be observed when installing, operating or maintaining hose reel equipment.

1. Keep the work area clean and dry. Damp or wet work areas can result in injury.
2. Keep children away from the work area. Do not allow children to handle this product.
3. Use reel in well-ventilated areas if toxic or flammable fluids / gases are in use.
4. The operator should wear appropriate protection equipment to protect against personal injury.
5. Do not let go of the hose when rewinding, always hold and drive the hose while rewinding it, to avoid damage to the machine, surrounding objects or injuries to people.
6. Do not attempt to stop leaks with your hand or body. Caution should be observed against burning due to hot water temperature when using hot water reels.
7. Do not overreach. Always keep proper footing and balance to prevent tripping, falling, back injury, etc.
8. Do not use the equipment when tired or under the influence of drugs, alcohol, or medication. A moment of inattention while operating this equipment may result in serious personal injury.
9. Use the right tool for the job. Do not attempt to force small equipment to do the work of larger industrial equipment. There are certain applications for which this equipment was designed. It will do the job better and more safely at the capacity for which it was intended. Do not modify this equipment, and do not use this equipment for a purpose for which it was not intended.
10. Only use compatible fluids / gases with this reel. (Refer to compatible fluids / gases in the Technical Details)
11. Do not exceed the maximum working pressure for this reel. (Refer to the Technical Details)
12. Check for damaged parts. Before using this product, carefully check that it will operate properly and perform its intended function. Check for damaged parts and any other conditions that may affect the operation of this product. DO NOT use damaged equipment.
13. It is recommended that leak tests on all equipment be carried out at least once a month, or when replacing any supply equipment.
14. Always close the supply of fluid / gas to the reel and release the line pressure / vent the hose before carrying out any maintenance on the reel.

TECHNICAL DETAILS

SPECIFICATIONS & DIMENSIONS

Type	Compressed Air / Water	Grease
Part Number	LNL65471	LNL81150
Hose Size (ID)	1/2" (12mm)	1/4" (6mm)
Hose Length	75 ft (23m)	50 ft (15m)
Hose Color	Yellow	Black
Reel Inlet	3/8" NPT (F)	1/4" NPT (F)
Hose Outlet	3/8" NPT (M)	1/4" BSPT (M)
Hose Material	Hybrid Polymer	Wire Reinforced Synthetic Rubber (SAE 100R2)
Working Pressure	300 psi	5,000 psi
Temperature Range	-40°F to 140°F / -40°C to 60°C	-40 °F to +212 °F (-40 °C to +100 °C)

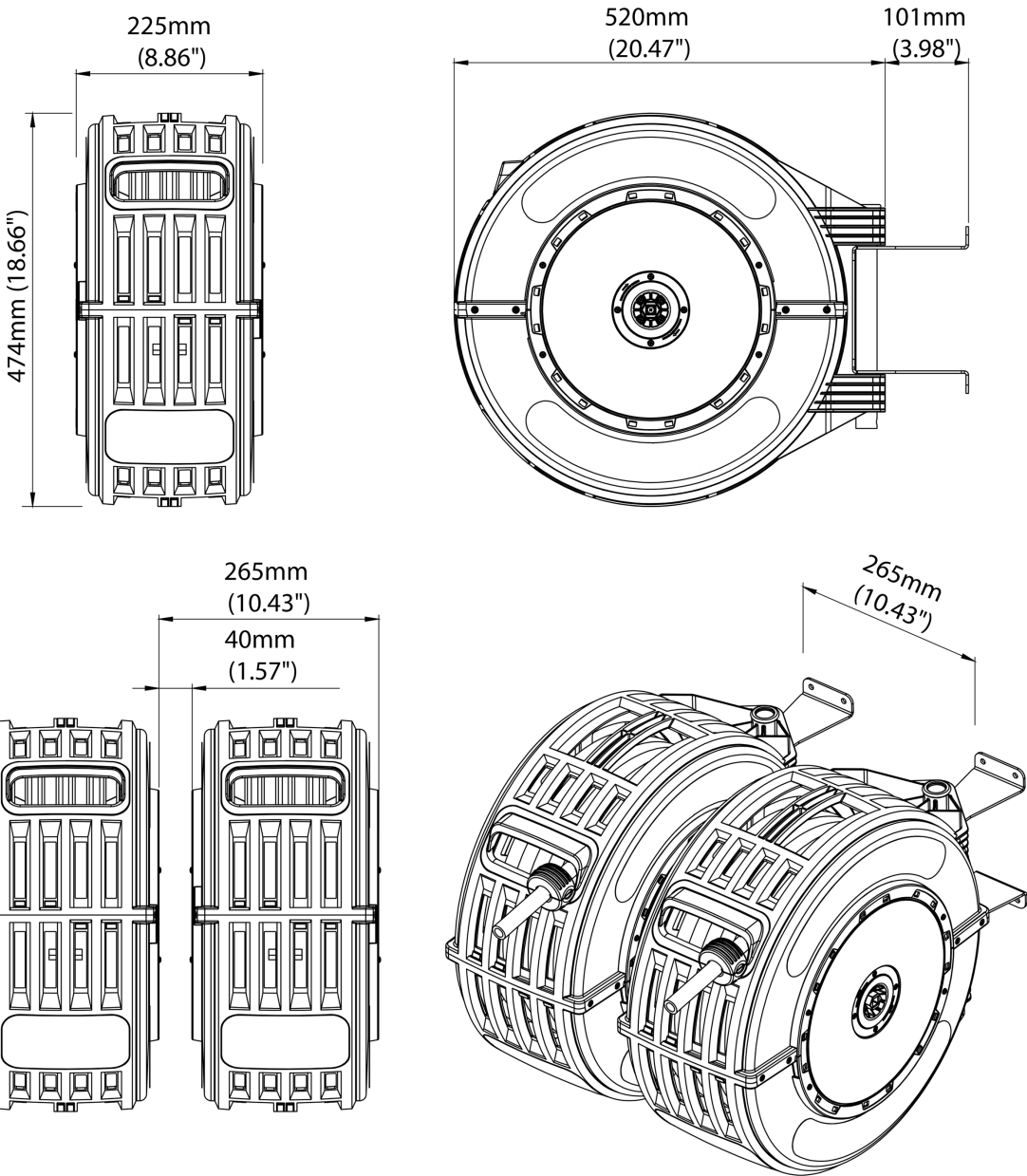

IMPORTANT:  
 Drawings are not to scale.

# WALL BRACKET

Included as standard with all reels.

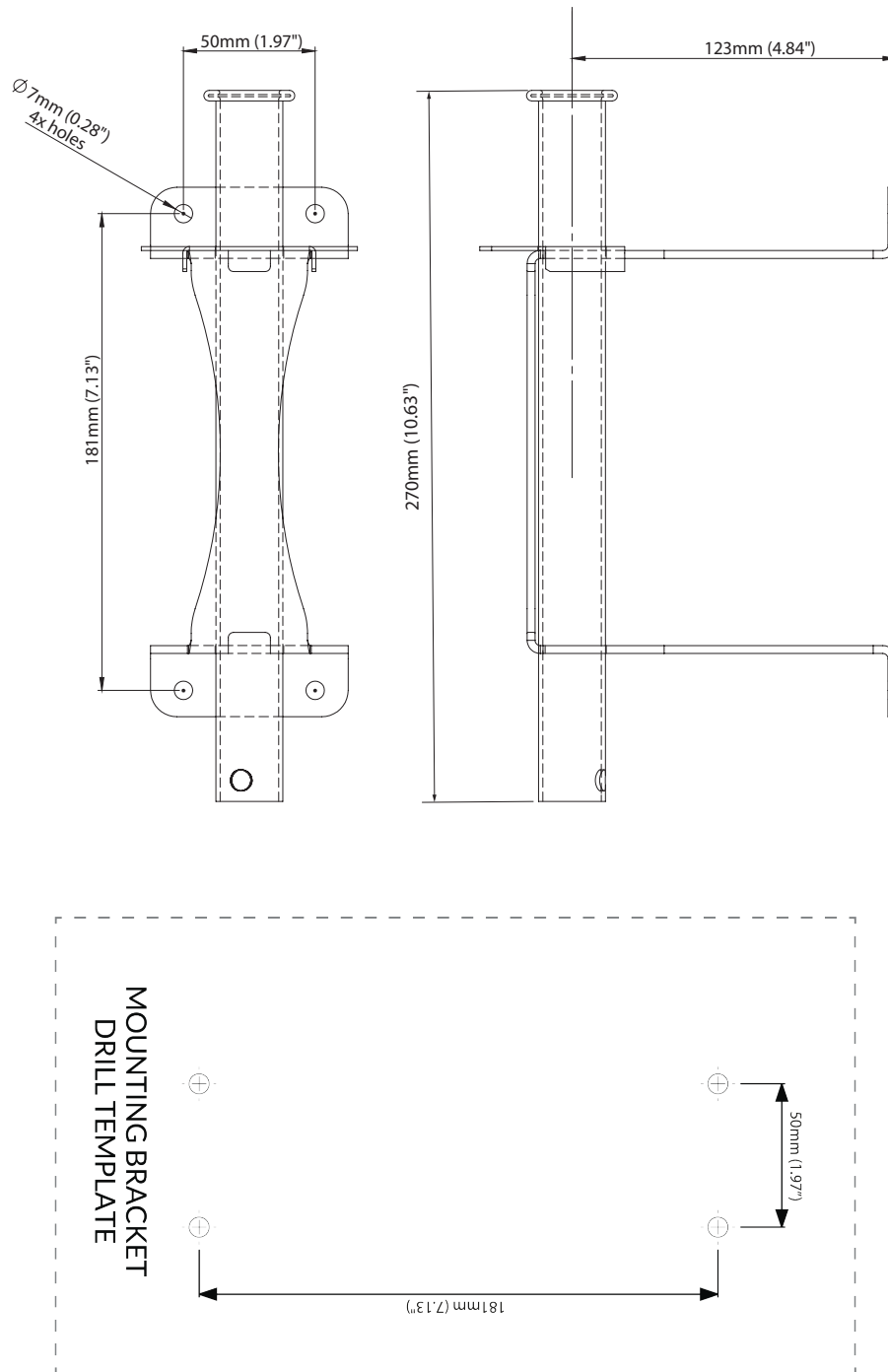

**IMPORTANT:**  
 Drawings are not to scale.

# INSTALLATION PROCEDURE

## INSTALLATION



### IMPORTANT:

Any installation including plumbing should be carried out by a suitably qualified person carefully following the information provided in this manual and in conformance to any applicable country, state and local regulations and laws.

1. Unpack and inspect the reel for damage. Turn by hand to check for smooth operation, pulling the hose out and recoiling it back into the reel.
2. You need to purchase suitable hardware based on the reel weight (including fluid type) and surface type on which you are mounting the reel. The mounting bracket has four 7mm diameter drilled holes for mounting on a suitable flat surface.
3. Ensure the location selected to mount the reel has adequate clearance and will not interfere with other objects.
4. For overhead mounting positions, the reel should not exceed 4.5m / 14.7 feet in height.
5. The template provided on the packaging can be used to mark holes for hardware. A copy of the template is also included in the Dimensions section of this instruction manual.
6. Using the four holes install the mounting bracket. Be sure to use appropriate hardware and tighten securely.
7. With the mounting bracket installed, the reel can now be mounted to the bracket using the Pivot Tube. To prevent the reel from swiveling in the overhead position (figure 2) use the locking bracket. See Fitting the Locking Bracket section of this instruction manual for fitting instructions.
8. Adjust the hose stopper to the desired location using an appropriate screwdriver.
9. If the spring recoil tension requires adjusting refer to "Add Spring Tension" for the correct procedure.

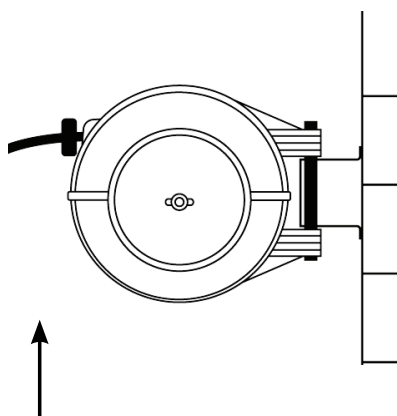

Fig.1 Wall mounting  
(max height 1.4m / 4.6ft)

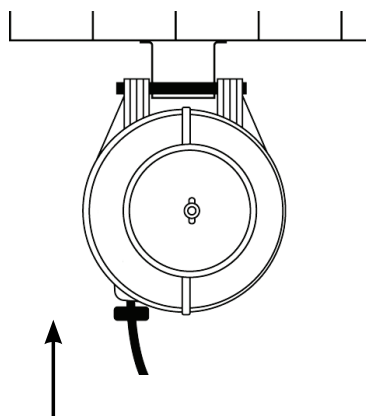
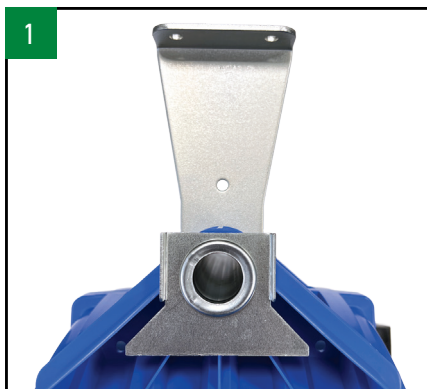

Fig.2 Overhead mounting  
(max height 4.5m / 14.7ft)

## FITTING THE LOCKING BRACKET



1. Locking bracket position out of the box.



2. Remove the pivot tube and flip over the locking bracket, placing it on top of the wall bracket.

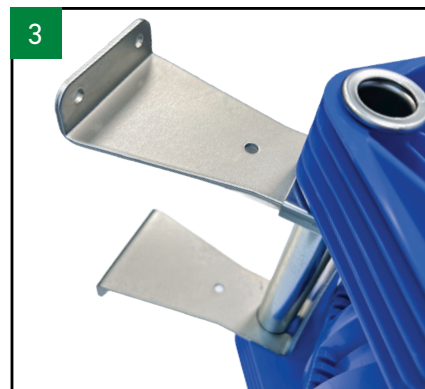

3. Mount the reel to the wall bracket and insert the pivot tube.

## CONNECTION - FLUIDS

(COMPRESSED AIR / WATER / GREASE)



### IMPORTANT:

**Always connect the hose reel to the supply line with hose and couplers suitable for the fluid, pressure and temperature.**

1. Ensure an appropriate fluid shut-off valve is installed to the supply line prior to connection. This will make maintenance easier and can act as a safety valve in dangerous situations.
2. Apply Teflon tape or pipe sealant to the supply line threads, attach to reel inlet and tighten. The other end of the incoming line can now be connected to the desired supply source.
3. Apply Teflon tape or pipe sealant to the outlet fitting on the reel hose, then attach it to the desired tool, or nozzle.
4. Check connections for leakage, and also check the hose reel for correct operation. (See Operation section.)

## OPERATION

### UNWINDING THE HOSE REEL

1. Holding the hose, carefully pull the hose out by hand.
2. Once reaching the desired hose length, slowly allow the hose to retract without releasing the hose from the hand hold.
3. When the reel reaches a latched position, the hose will slacken (indicating it has been locked in place) and it can then be fully released.

**CAUTION:**

**Do not direct a gas flame at the hose or hose reel.**

### WINDING THE HOSE REEL

1. Firmly pull the hose to release the latch.
2. Once the latch is released the length of the hose will tighten as the reel begins to retract the hose.
3. Walk the hose back to the reel whilst guiding the hose from left to right; allowing it to sit neatly into the reel housing.

**CAUTION:**

**Always hold and drive the hose while rewinding it, to avoid damage to the machine, surrounding objects or injuries to people.**

4. Check the hose condition daily for wear or damage and check the swivel fitting for leakage. Replace any worn, damaged, or leaking parts with original parts from LockNLube.



## MAINTENANCE



**IMPORTANT:**

Any maintenance should be carried out by a suitably qualified person, carefully following the information provided in this manual.



**IMPORTANT:**

Replacement seal kits are fluid / gas specific. Only use seal kits that match the correct fluid / gas type.



**CAUTION:**

Always close the supply of fluid / gas to the reel and release the line pressure / vent the hose before carrying out any maintenance on the reel.

## GENERAL MAINTENANCE

1. Always close the supply of fluid / gas to the reel and release the line pressure / vent the hose before carrying out any maintenance on it.
2. It is recommended that leak tests on all equipment be carried out at least once a month, or when replacing any supply equipment.
3. Replace the flexible hose as soon as it shows any sign of wear and tear, or deterioration, due to the different conditions of the environment. We advise you to replace it every 12 months.
4. Replace the seal inside the revolving joint in case of leaks due to wear and tear.
5. Any replacement of hose reel parts should be done using original spare parts (see the spare parts list).
6. We advise you to contact LockNLube for any possible anomaly and before replacing any part.
7. After every maintenance operation, ensure you replace every protection that has been removed.

## INCREASING SPRING TENSION

**CAUTION:**

Always close the supply of fluid / gas to the reel and release the line pressure / vent the hose before carrying out any maintenance on the reel.

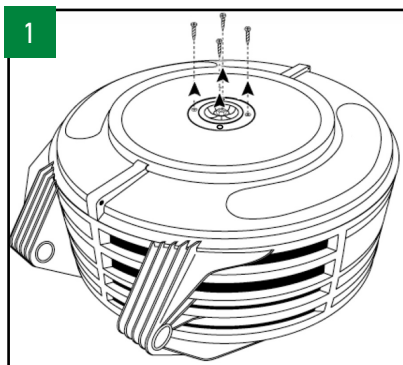

1. Remove screws.

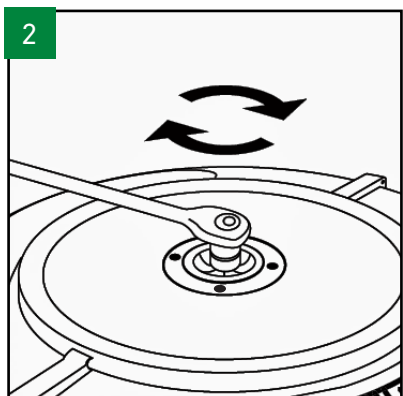

2. Add two complete turns. Note one click on the hub equals 90°.

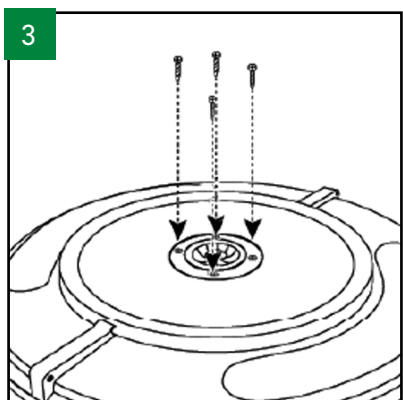

3. Replace screws.

# REMOVING & REPLACING TENSION SIDE PLATE



## CAUTION:

Always close the supply of fluid / gas to the reel and release the line pressure / vent the hose before carrying out any maintenance on the reel.

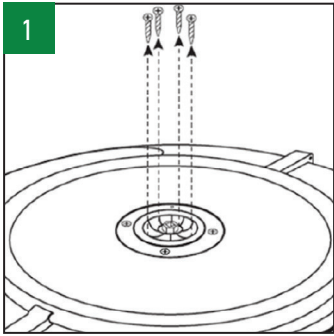

1. Remove screws with magnetic screwdriver.

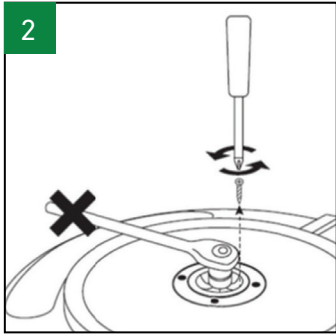

2. Hold hub and the four outside screws.

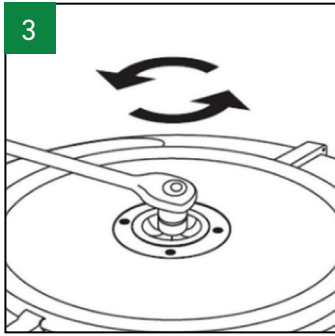

3. Release spring tension.

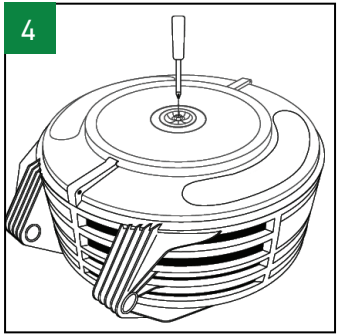

4. Remove screw and center hub.

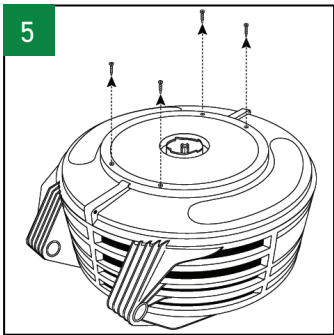

5. Remove screws.

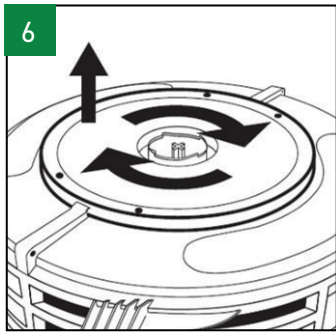

6. Remove side plate.

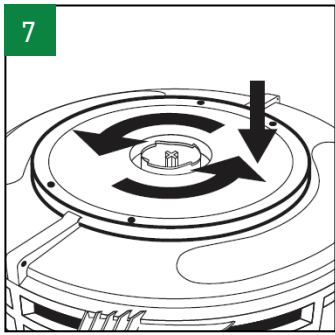

7. Fit new side plate.

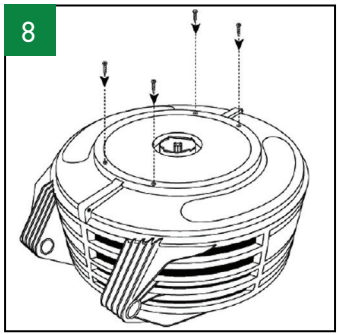

8. Fit screws.

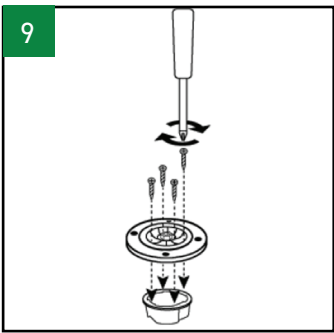

9. Fit screws.

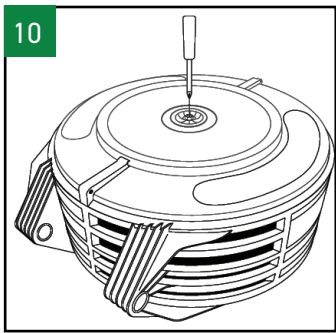

10. Fit screw.

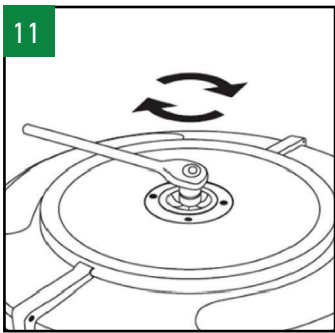

11. Add 2 complete turns.

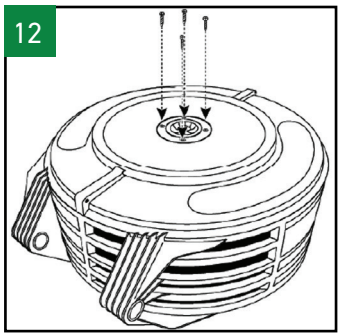

12. Fit screws.

## HOSE REPLACEMENT - FLUIDS (Excluding Grease)

### (COMPRESSED AIR / WATER)



#### CAUTION:

Always close the supply of fluid to the reel and release the line pressure before carrying out any maintenance on the reel.

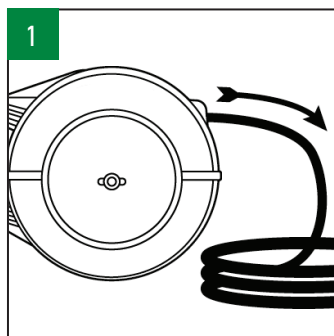

1. Pull out hose and latch.

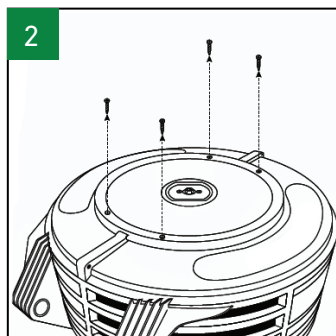

2. Remove screws.

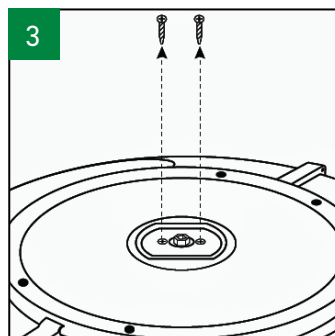

3. Remove screws.

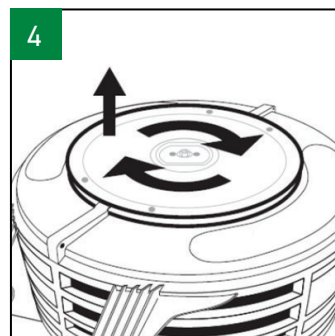

4. Remove plate.

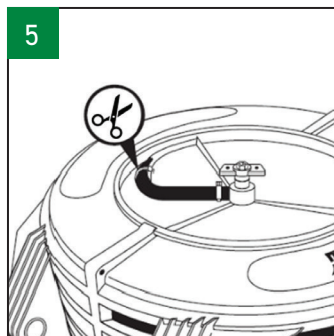

5. Remove cable tie.

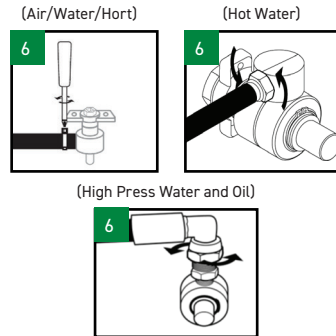

6. Remove swivel.

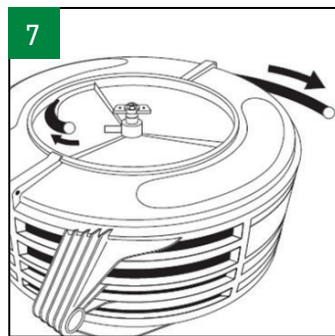

7. Remove old hose.

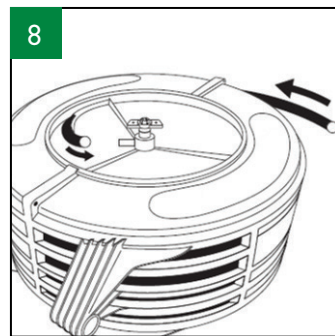

8. Fit new hose.

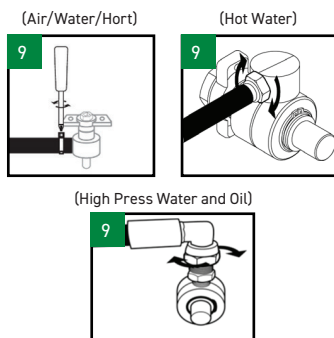

9. Attach hose to the swivel.

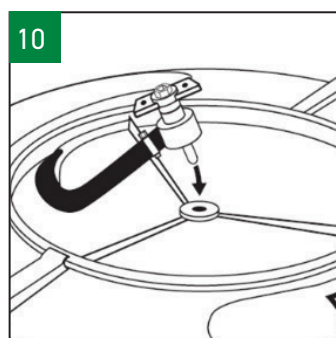

10. Fit swivel assembly.

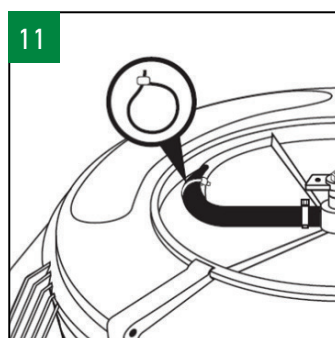

11. Fit cable tie.

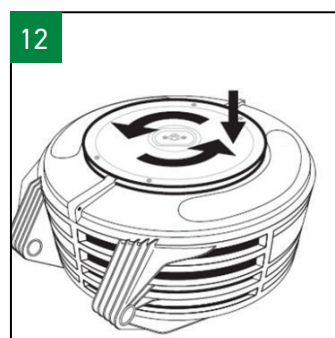

12. Fit side plate.

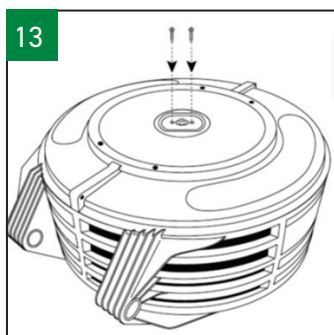

13. Fit screws.

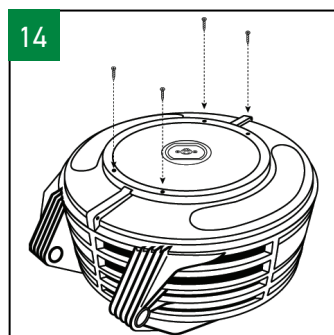

14. Fit screws.

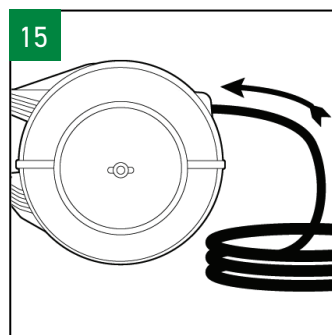

15. Recoil hose evenly into reel.



# HOSE REPLACEMENT - GREASE



**CAUTION:**  
Always close the supply of fluid to the reel and release the line pressure before carrying out any maintenance on the reel.

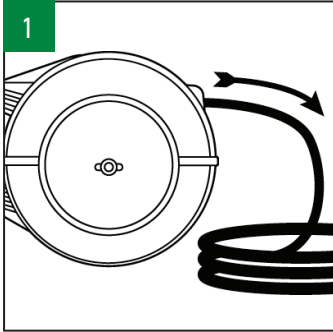

1. Pull out hose and latch.

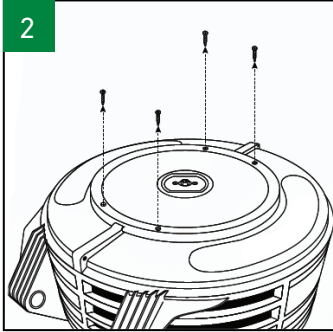

2. Remove screws.

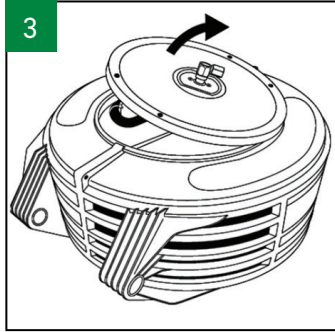

3. Remove side plate.

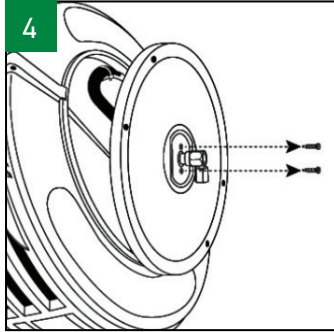

4. Remove screws.

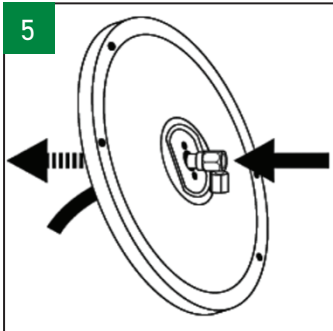

5. Remove swivel.

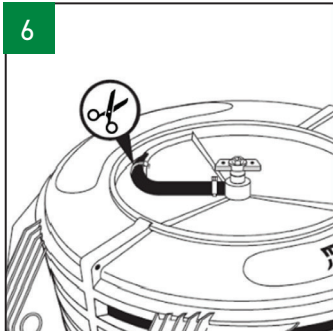

6. Remove cable tie.

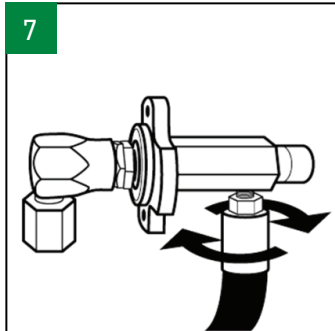

7. Remove hose from swivel.

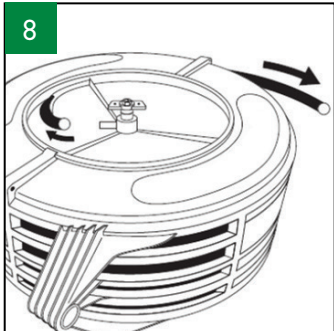

8. Remove old hose.

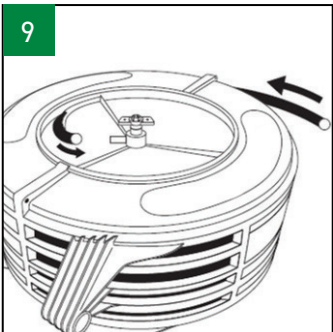

9. Fit new hose.

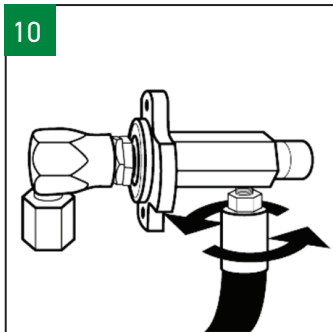

10. Fit swivel assembly.

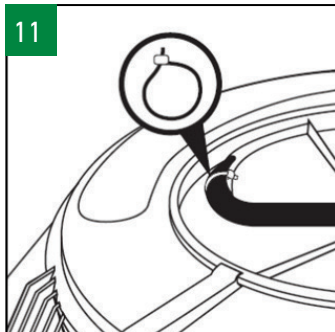

11. Fit cable tie.

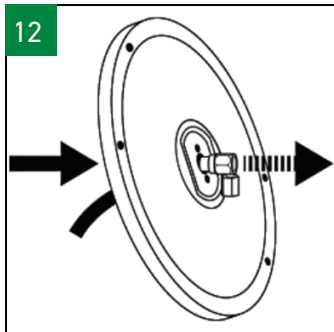

12. Fit swivel through side plate.

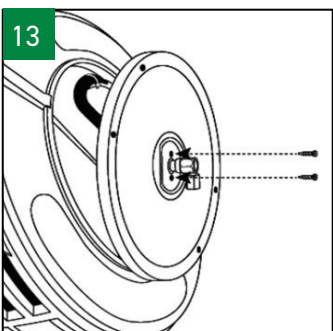

13. Fit screws.

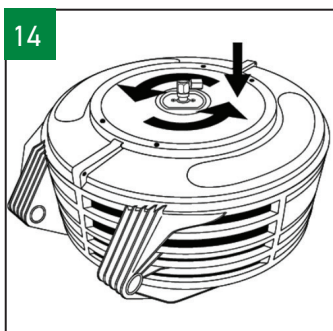

14. Fit side plate.

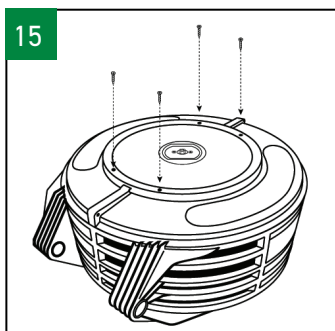

15. Fit screws.

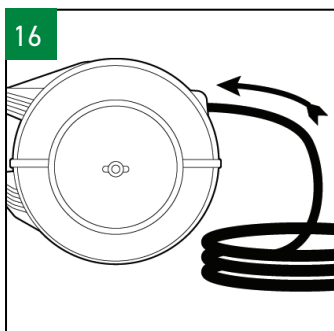

16. Recoil hose evenly into reel.

# SWIVEL & SWIVEL SEALS REPLACEMENT - FLUIDS (Excluding Grease) (COMPRESSED AIR / WATER)



## CAUTION:

Always close the supply of fluid to the reel and release the line pressure before carrying out any maintenance on the reel.

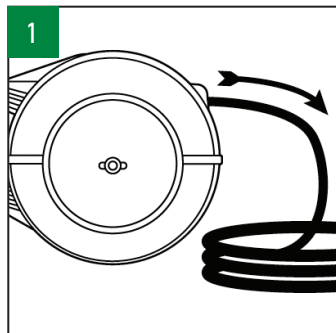

1. Pull out hose and latch.

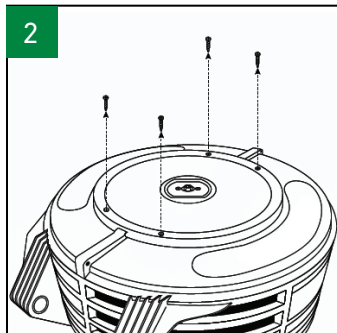

2. Remove screws.

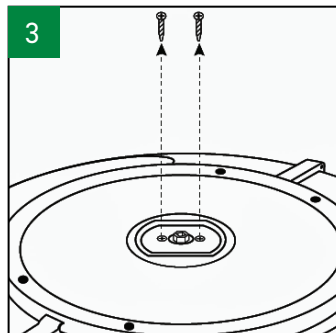

3. Remove screws.

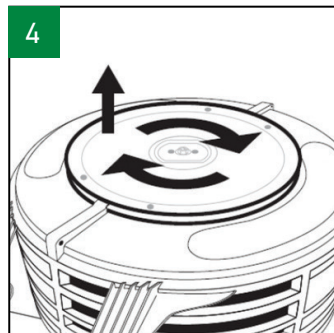

4. Remove plate.

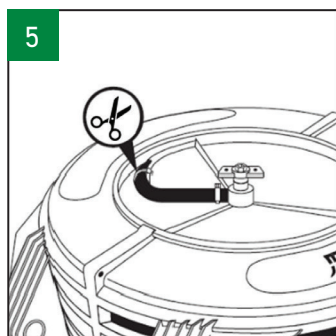

5. Remove cable tie.

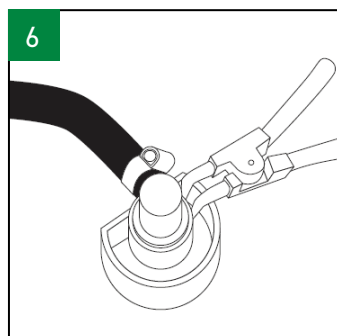

6. Remove snap ring.

## Swivel O'ring Replacement instructions (use steps 1-7 & 9-14)

7. a) Remove body from shaft.
- b) Replace O'rings.
- c) Apply water resistant grease.
- d) Re-fit swivel body and snap ring.

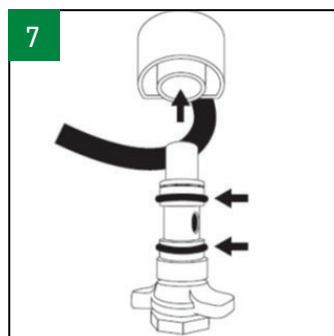

## Swivel replacement Instructions (use steps 1-5 & 8-14)

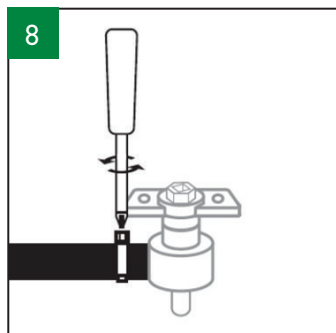

8. Remove swivel.

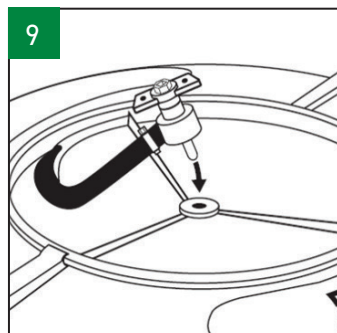

9. Fit swivel assembly.

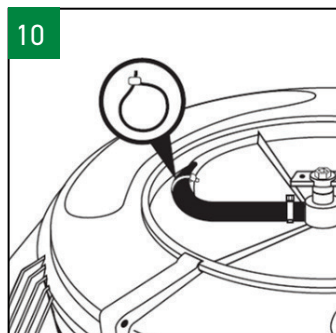

10. Fit cable tie.

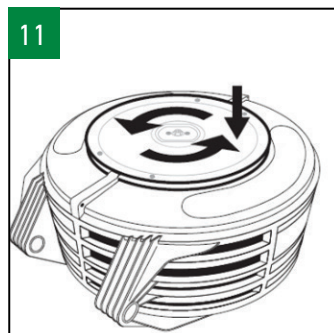

11. Fit side plate.

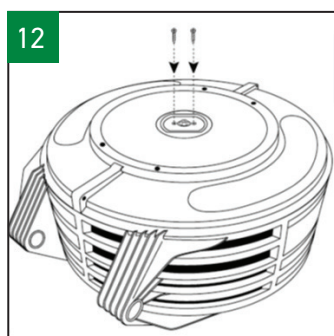

12. Fit screws.

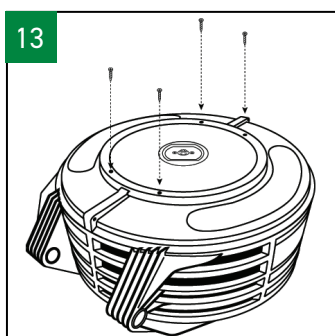

13. Fit screws.

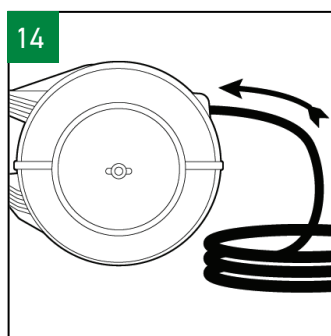

14. Recoil hose evenly into reel.

# SWIVEL REPLACEMENT - FLUIDS (GREASE)



## CAUTION:

Always close the supply of fluid to the reel and release the line pressure before carrying out any maintenance on the reel.

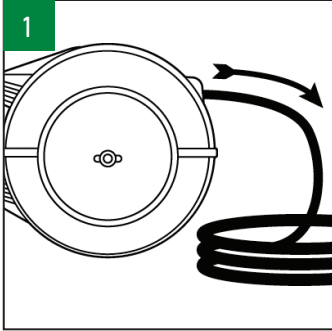

1. Pull out hose and latch.

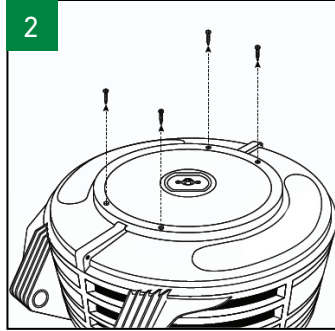

2. Remove screws.

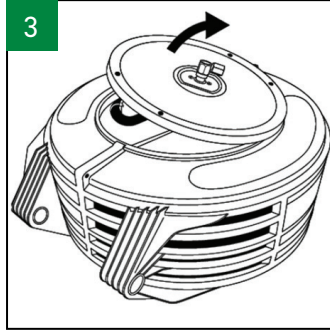

3. Remove side plate.

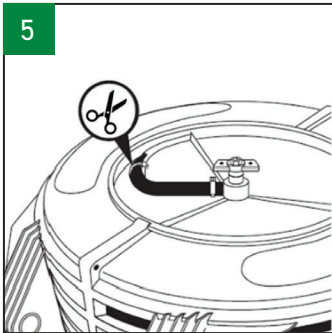

4. Remove screws.

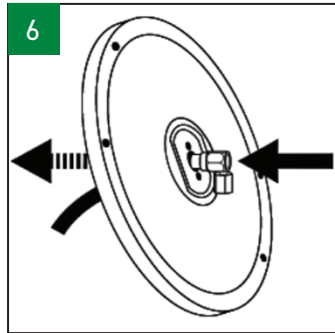

5. Remove swivel.

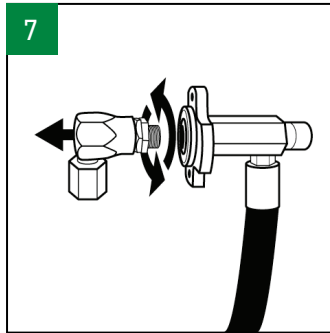

6. Remove cable tie.

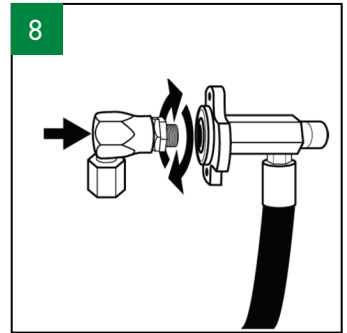

7. Remove SB6 swivel.

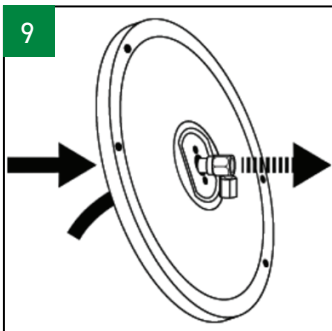

8. Fit new SB6 swivel.

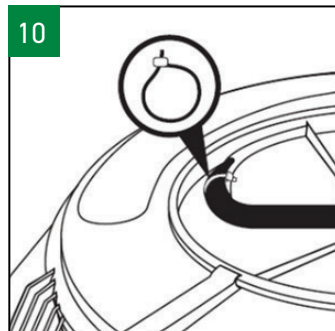

9. Fit swivel through side plate.

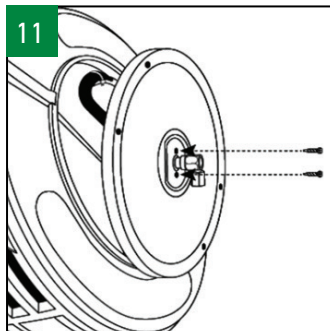

10. Fit cable tie.

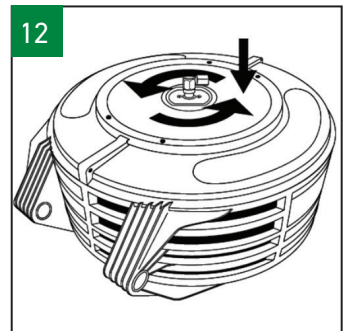

11. Fit screws.

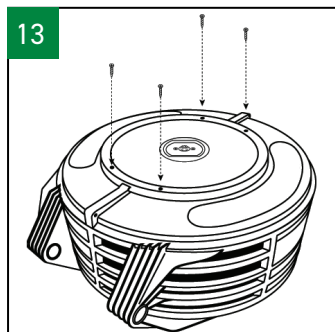

12. Fit side plate.

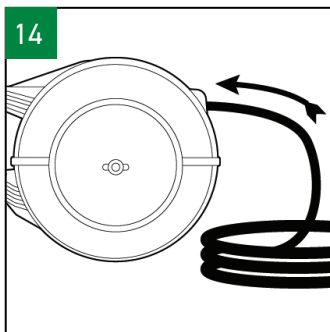

13. Fit screws.

14. Recoil hose evenly into reel.

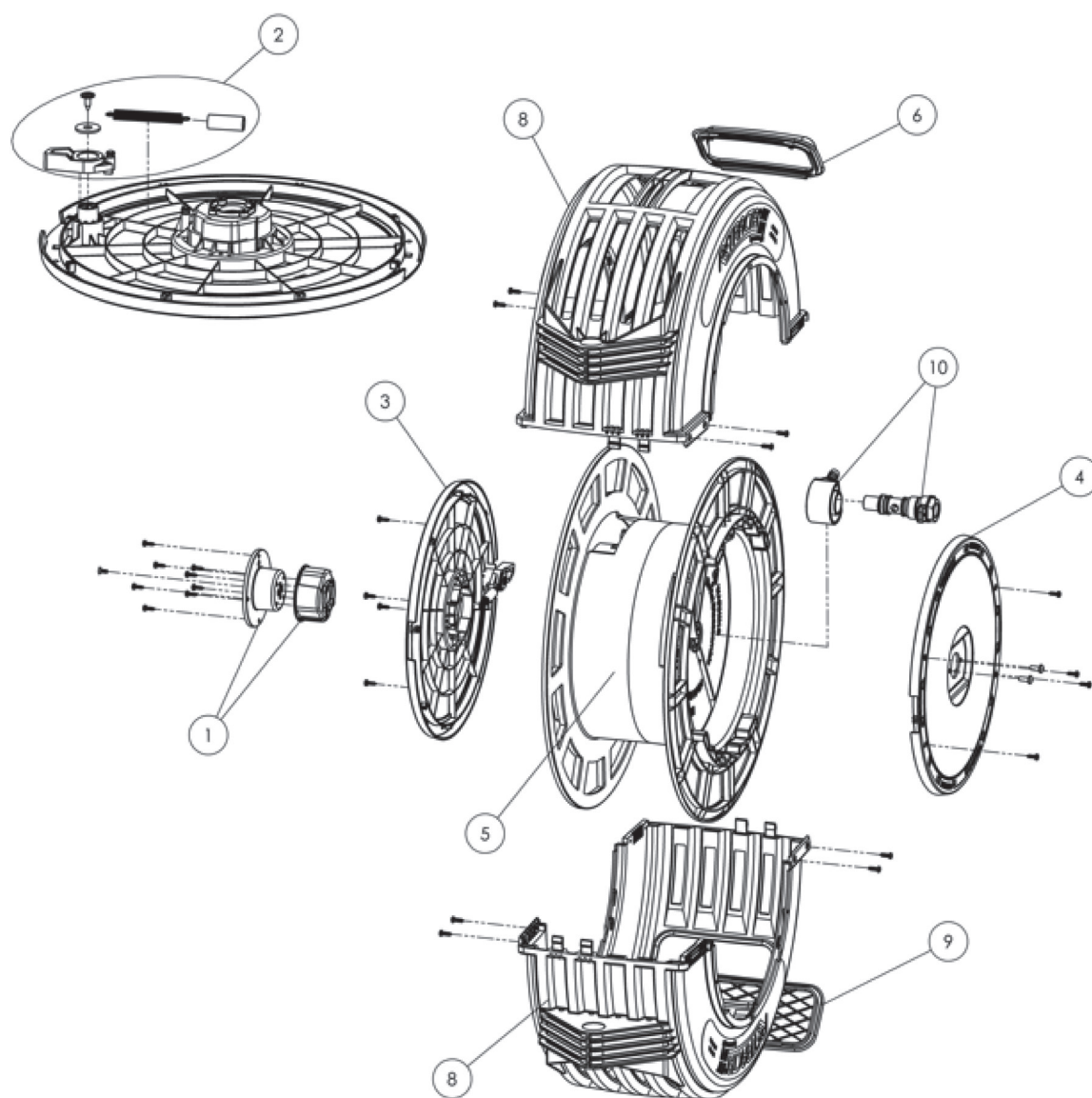

## EXPLODED PARTS DIAGRAMS

**Note:**

1. Outer casing set is supplied with screws, mouth set and lower insert
2. Standard bracket not shown



## GENERIC SPARE PARTS

Item no	Description	Spare part no
1	Tension Hub Set	R3THS
2	Latch Set	R3LS
3	Latching Side Plate	R3LPS
4	Inlet Side Plate	R3IPS
5	Drum Assembly	R3DAS
6	Mouth Set	R3MS
7	Standard Bracket (incl locking plate)	R3SBS
8	Outer Casing Set (nominate color)	R30C-* (replace * with color)
9	Lower Insert (nominate color)	R3LIS-* (replace * with color)
10	Swivel	Fluid / Gas Specific
not pictured	Bracket - Wall Mount	BU200-LNL

## HOSE & HOSE STOPPER SPARE PARTS

Hose Outlet Thread	Hose Type	Hose ID	Length	Hose Part No.	Hose Stopper Part No.
NPT	Air / Water (FLEX Yellow)	12mm (1/2")	75ft	RH173AFS-LNL	RP156-2S-LNL
	Grease	5mm (1/4")	50ft	RH197S-LNL	RP156-5S-LNL

## SWIVEL & SEAL KIT SPARE PARTS

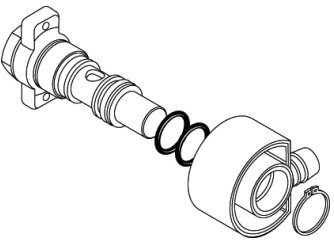
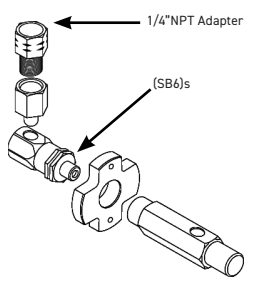
Assembly	Fluid / Gas	Swivel Part No.	Seal Kit Part No.
	Air / Water 1/2" NPT (12mm)	RS129AS-LNL	BS115VS-LNL
	Grease	RS124AS-LNL	Complete Swivel Req

## TROUBLESHOOTING GUIDE

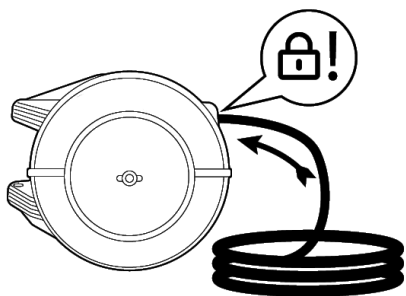
**Hose does not retract correctly**

A) Outlet nozzle, gun or tool is too heavy.

B) Spring is fatigued and lost tension.

Refer to **INCREASE SPRING TENSION** on page 10.

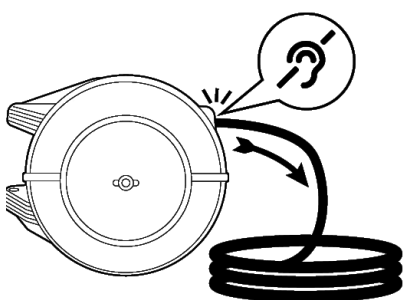
**Reel does not latch**

A) Incorrect operation.

B) Latch assembly is broken.

Refer to **REMOVE/ REPLACE TENSION SIDE PLATE** on page 11.

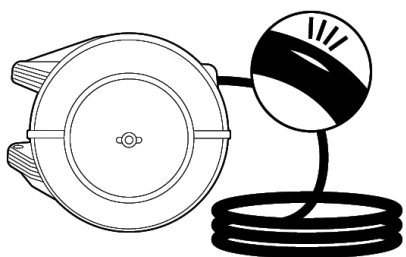
**Reel does not latch**

Split in hose.

Refer to **HOSE REPLACEMENT** on pages 12 or 13.

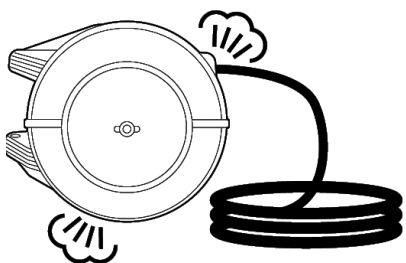
**Reel does not latch**

Swivel or swivel seals are worn.

Refer to **SWIVEL OR SWIVEL SEAL REPLACEMENT** on pages 14 or 15.





24 Interchange Drive, West Lebanon NH 03784  
Phone: (603) 795-2298 Fax: (603) 795-9307  
Email: [info@locknlube.com](mailto:info@locknlube.com)

**For Warranty Terms and Conditions see: [www.locknlube.com](http://www.locknlube.com)**

This product should be disposed of according to all applicable local and national government environment regulations and guidelines.

