

ClipOn Hearing Aid

Model: PSA5033

User's Guide

- Please read this instruction manual carefully and use it correctly.
- Please read before use.
- Please keep the instruction manual in a safe place and use it when necessary

Package contents and names of each part

Main unit (front)

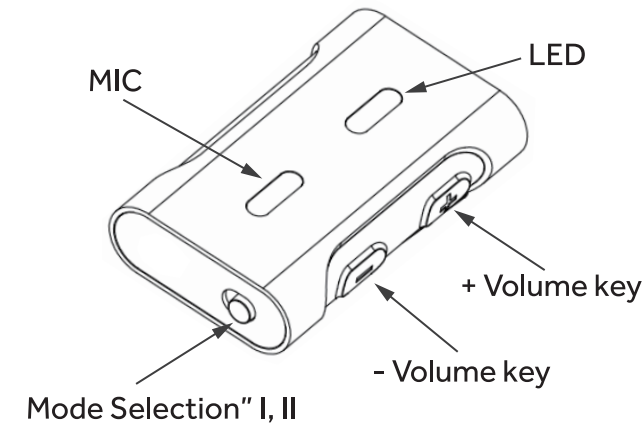

Main unit (back)

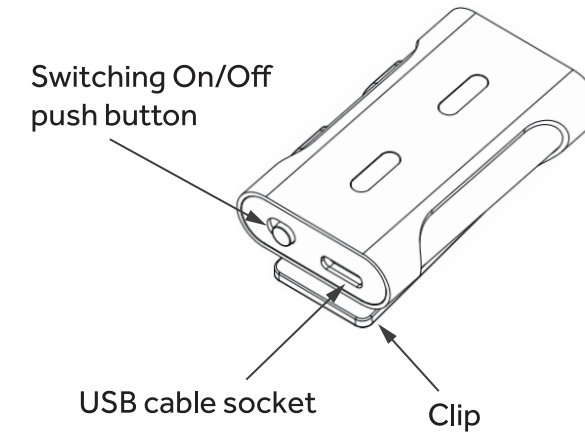

Earphone

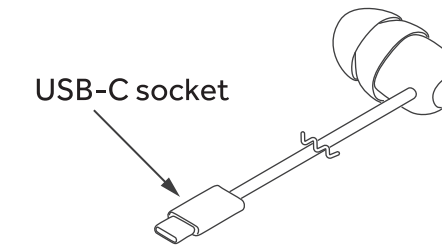

Charging cable

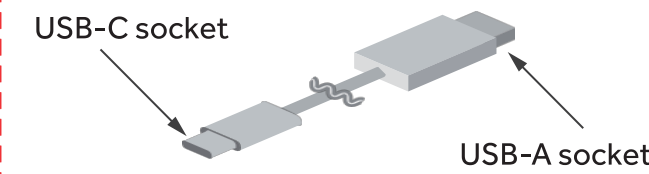

earplugs

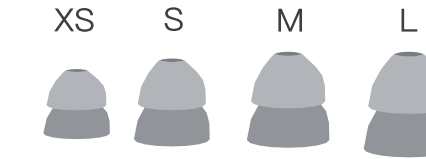

Pouch

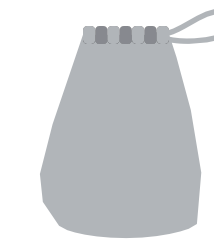

Charging method

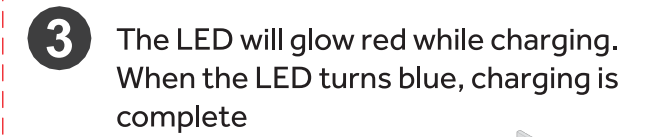
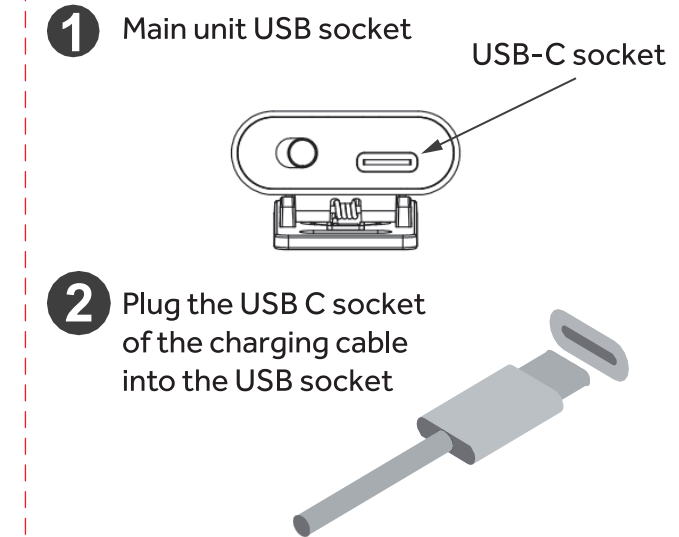

Charge once a day

4 How to replace hearing plugs

The earpiece can be removed by pinching the rubber part with your fingers and pulling

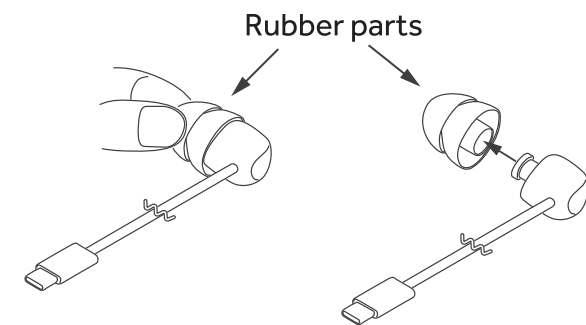

Do not hold the cable and pull it

How to use:

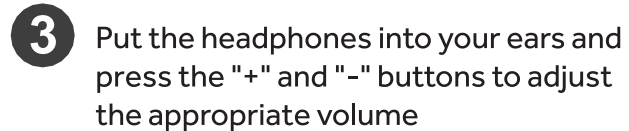
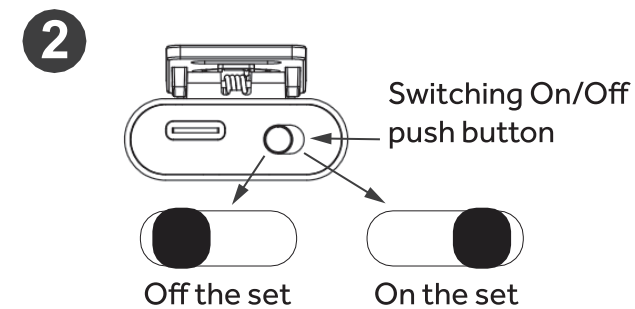
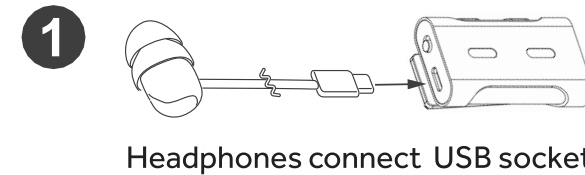

If the earpiece is small or large, replace it with another size

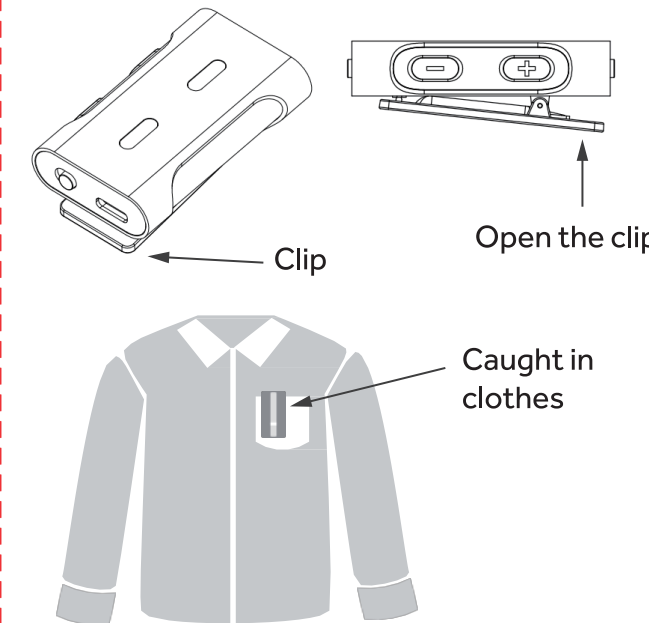
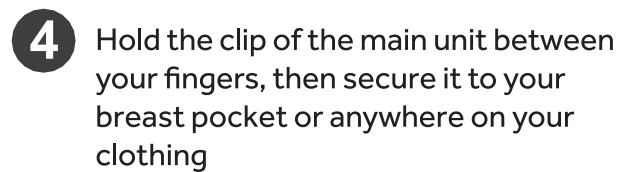

5 Select the switching mode according to the environment

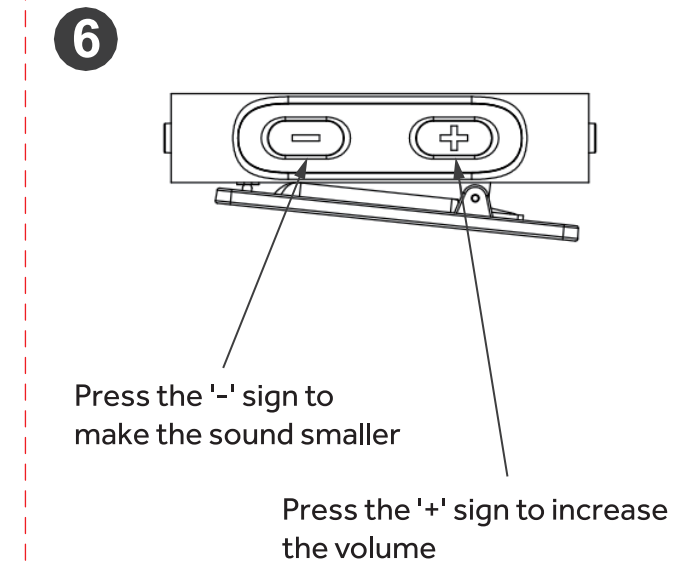
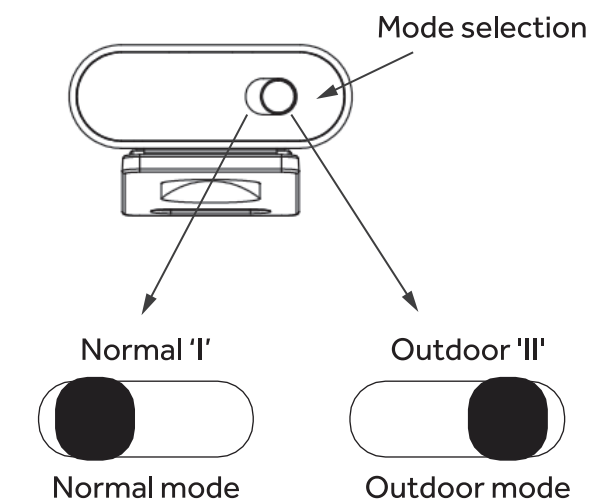

Remark

- Nightly charging guarantee extends battery life
- Free replacement for non-human damage within one year

FCC Statement

This equipment has been tested and found to comply with the limits for a Class B digital device, pursuant to part 15 of the FCC Rules. These limits are designed to provide reasonable protection against harmful interference in a residential installation. This equipment generates, uses and can radiate radio frequency energy and, if not installed and used in accordance with the instructions, may cause harmful interference to radio communications. However, there is no guarantee that interference will not occur in a particular installation. If this equipment does cause harmful interference to radio or television reception, which can be determined by turning the equipment off and on, the user is encouraged to try to correct the interference by one or more of the following measures:

- Reorient or relocate the receiving antenna.
- Increase the separation between the equipment and receiver.
- Connect the equipment into an outlet on a circuit different from that to which the receiver is connected.
- Consult the dealer or an experienced radio/TV technician for help.

Caution: Any changes or modifications to this device not explicitly approved by manufacturer could void your authority to operate this equipment.

This device complies with part 15 of the FCC Rules. Operation is subject to the following two conditions: (1) This device may not cause harmful interference, and (2) this device must accept any interference received, including interference that may cause undesired operation.

RF Exposure Information
The device has been evaluated to meet general RF exposure requirement.
The device can be used in 0mm exposure condition, compliance with exposure requirements.

