



INSTALLATION INSTRUCTIONS One-Piece Toilet

www.clovisgoods.com
(628) 800-9999
buyer@clovisgoods.com





PRIOR TO INSTALLATION:

- Inspect toilet to ensure no damages have occurred while in shipping.
- Observe all plumbing and building codes in accordance with your state and local requirements.
- All dimensions are nominal! Be sure to measure your toilet prior to installation.
- The step-by-step guidelines in the installation instructions are a general reference. Should there be any discrepancies, CLOVIS cannot be held liable. It is recommended to install all CLOVIS products by hiring a licensed professional.
- Read installation and maintenance instructions thoroughly before installing. Be sure to use proper tools and always wear proper personal safety accessories for your protection.
- Two people are recommended to handle and install this product as it is fragile.

If you have any questions or concerns please contact us:

(628) 800-9999

buyer@clovisgoods.com

SUGGESTED TOOLS & MATERIALS:



Safety Glasses



Putty Knife



Wrench



Tape Measure



Level



Flexible Supply Tube



Hacksaw



Screwdriver

INCLUDED PARTS:

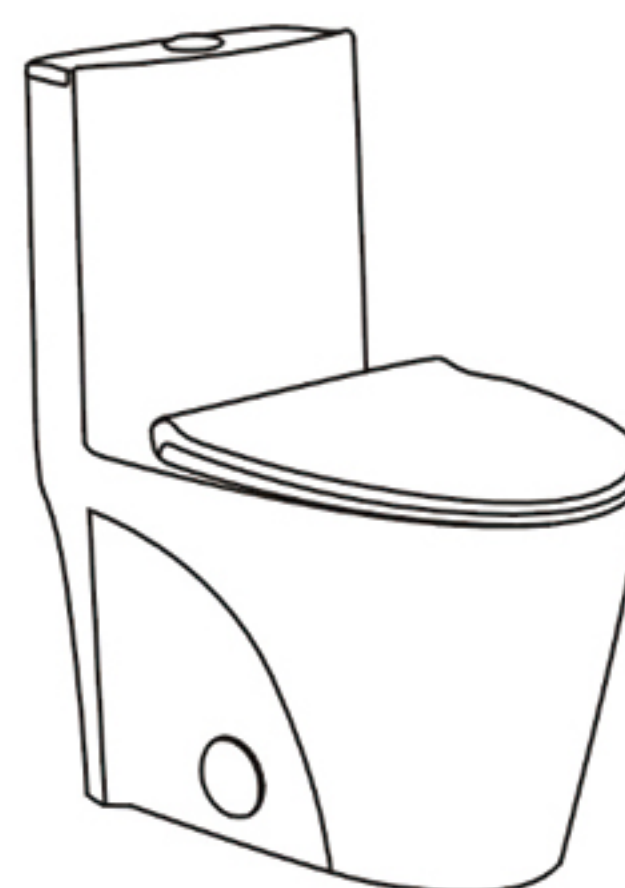

One-Piece Toilet



Wax Ring/
Gasket



Bolts



Cover Caps

1 REMOVING OLD TOILET

- (a.) Turn off the toilet supply valve and flush toilet completely. Wipe any remaining from the tank and bowl with a towel or sponge.
- (b.) Disconnect and remove the supply tube. NOTE: If replacing the valve, shut off the main water supply first.
- (c.) Remove the old mounting bolts, remove the old toilet, and plug the floor waste opening to prevent sewer odours.
- (d.) Remove the toilet flange bolts and clean the old wax, putty, etc. from the base.

NOTE: The mounting surface must be clean and level before installing the new toilet.

2 ROUGH-IN DIMENSIONS

NOTE: The distance between the wall and the centreline of the toilet flange must be 12 in. (30.5 cm).

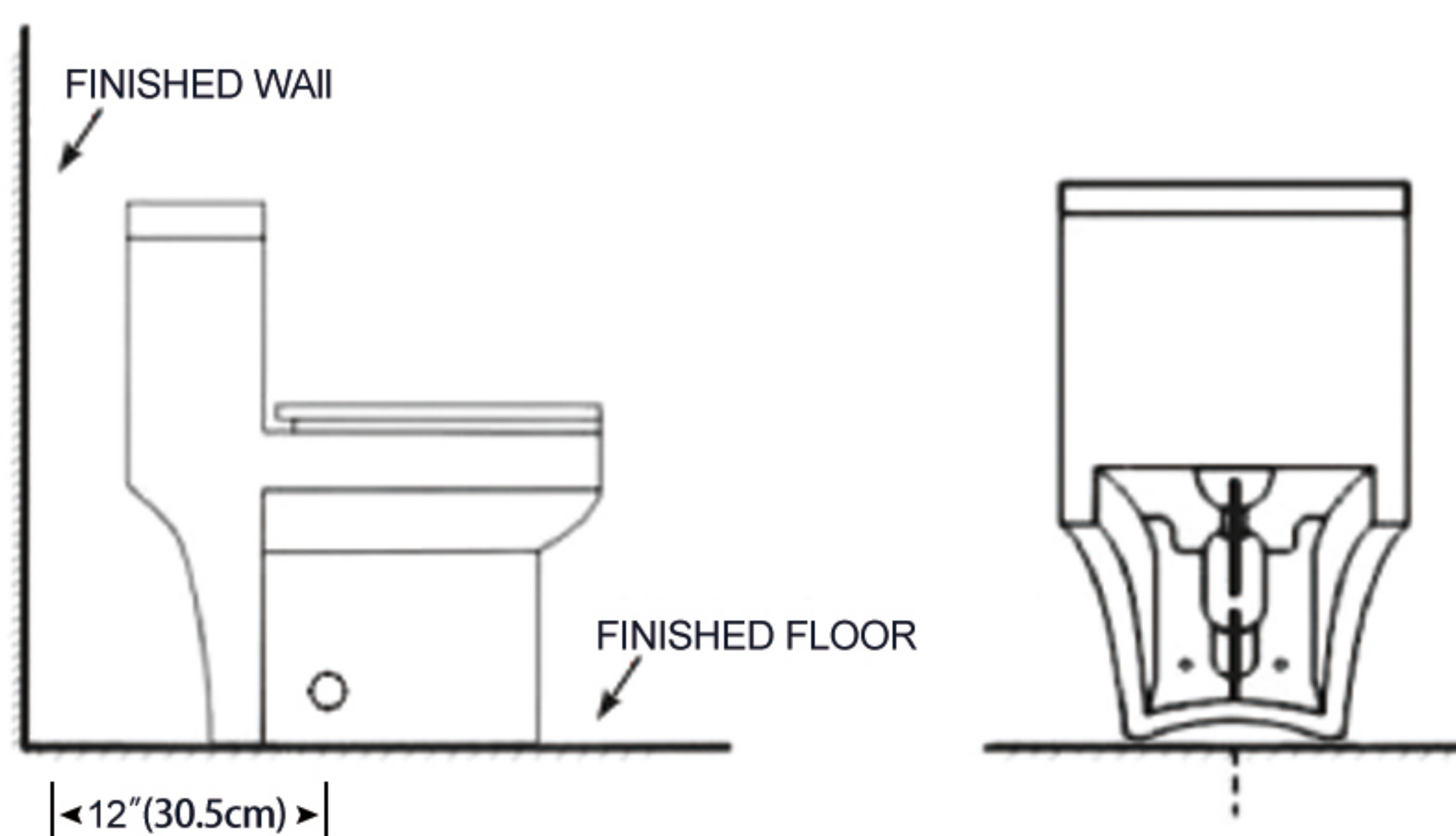

3 INSTALLING MOUNTING BOLTS

Install closet bolts to flange channel, turn 90° and slide into place 6" (152mm) apart and parallel to wall.

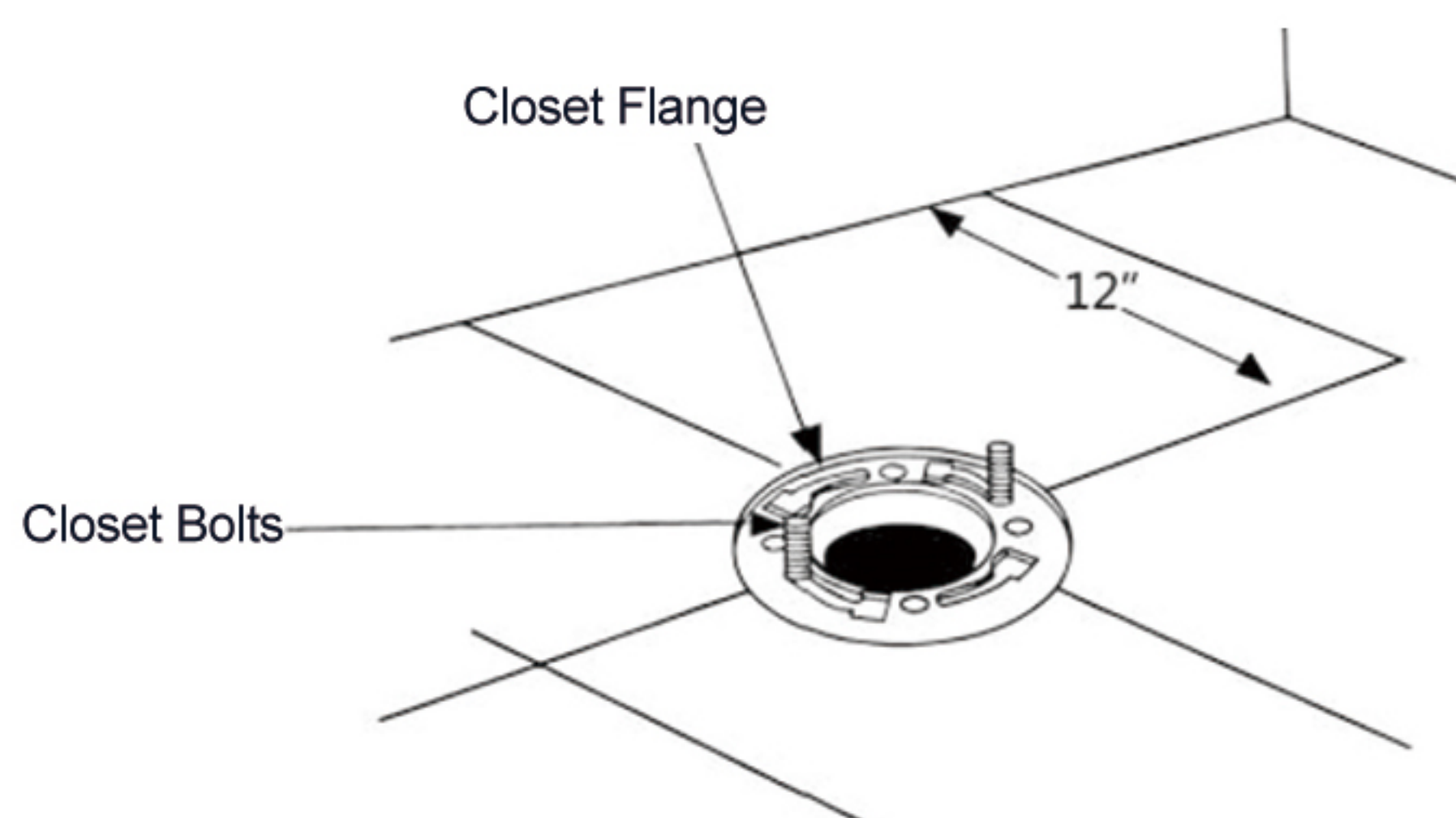

4 INSTALLING WAX RING

Invert the toilet on the floor (cushion to prevent damage) and install the wax ring evenly around the floor drain with the tapered end of the ring facing the toilet.

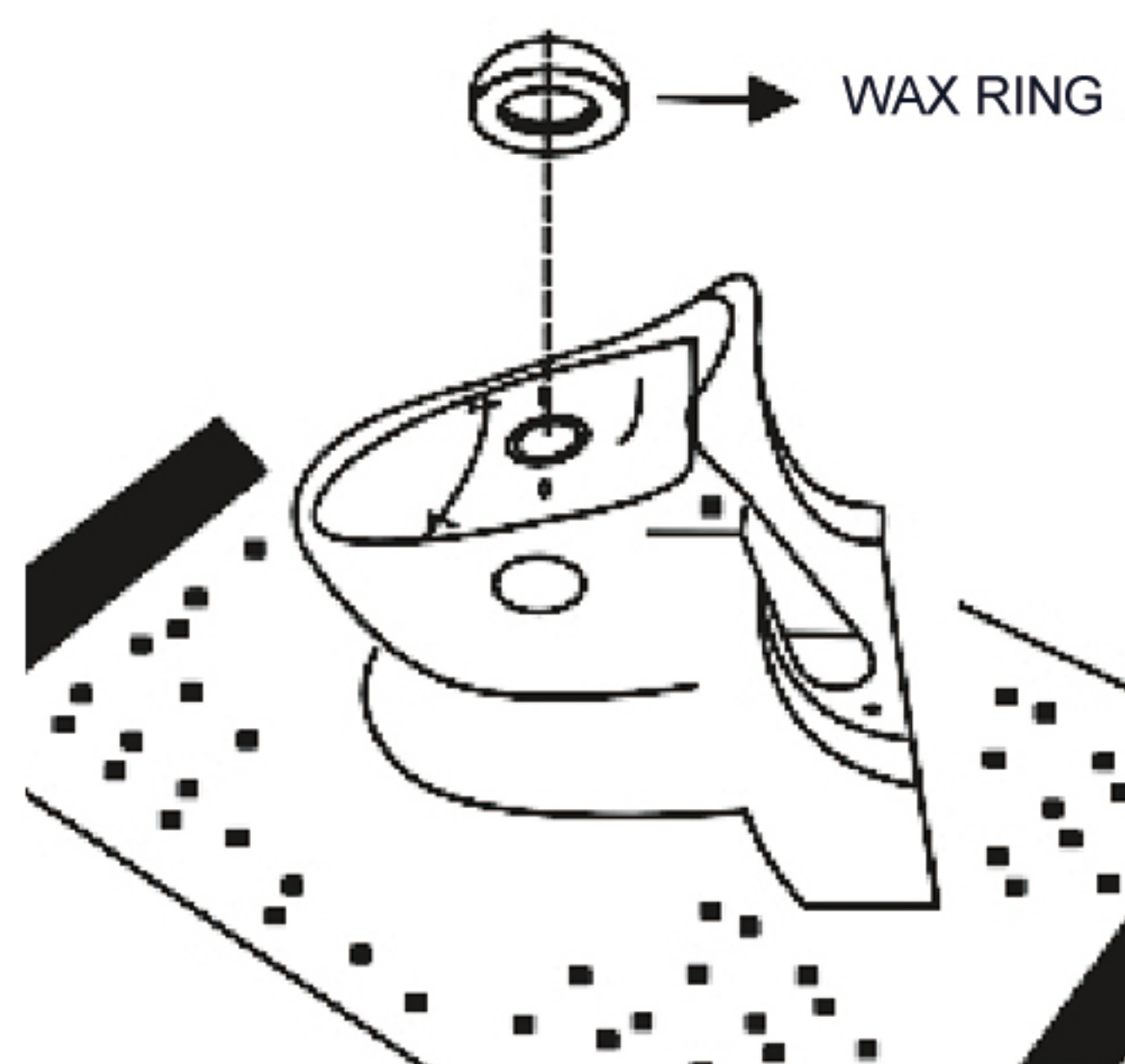

5 PLACING TOILET ON FLANGE

- Clear the floor waste opening and place the toilet on the flange so that the bolts pass through the mounting holes.
- Loosely install the retainer washers and nuts. The washer sides marked "THIS SIDE UP" must face up.

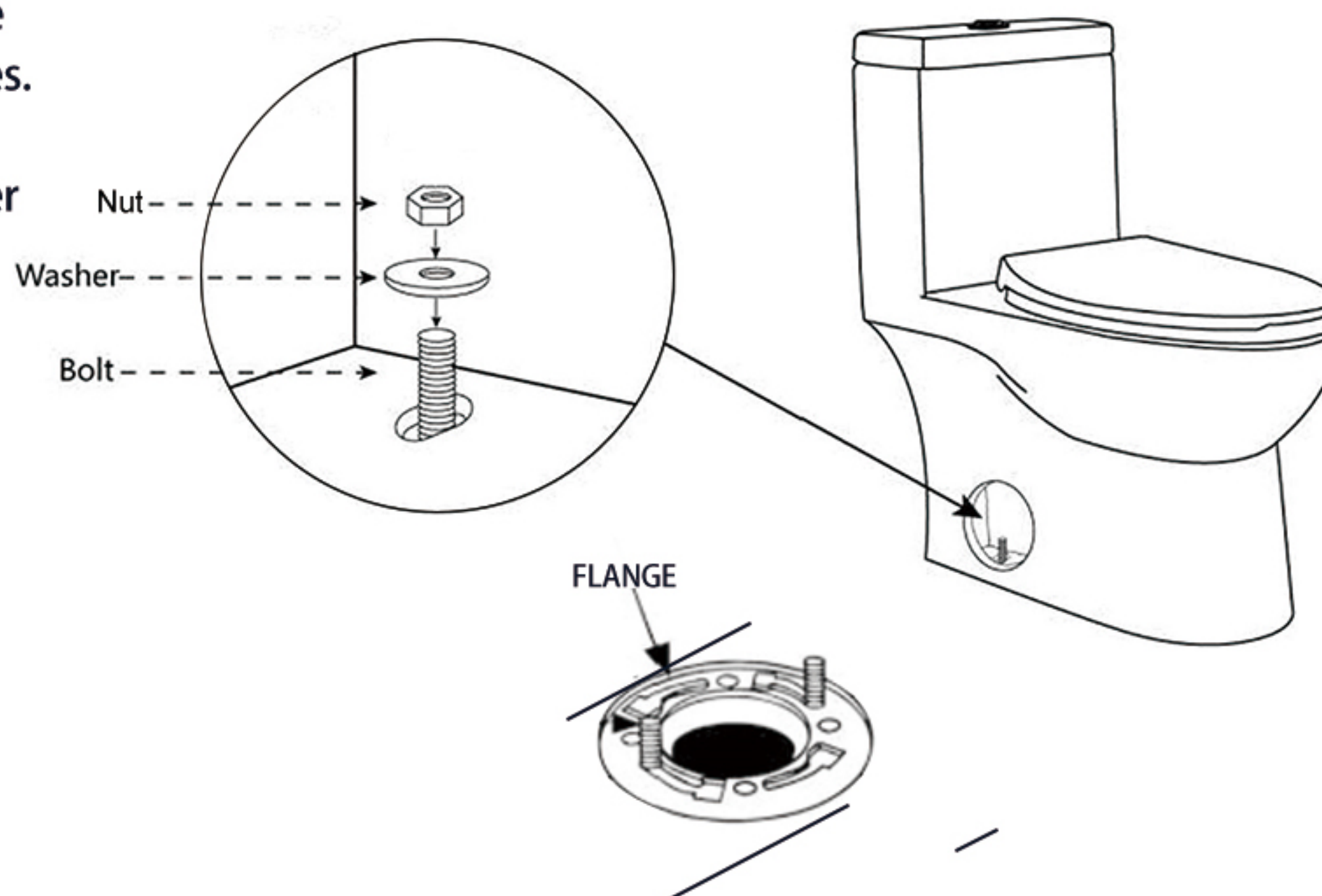

6 TOILET INSTALLATION

- Position the toilet square to the wall and, with a rocking motion, press the bowl down on the wax ring and flange. Alternately tighten the bolts until toilet is firmly mounted to the ground.



WARNING: DO NOT OVER TIGHTEN NUTS, AS THIS COULD DAMAGE THE BASE.

- Install the bolt caps on the washers. (If necessary, cut the bolt height to the correct length before installing bolt caps).



WARNING: DO NOT OVER TIGHTEN THE NUTS, PORCELAIN COULD BREAK.

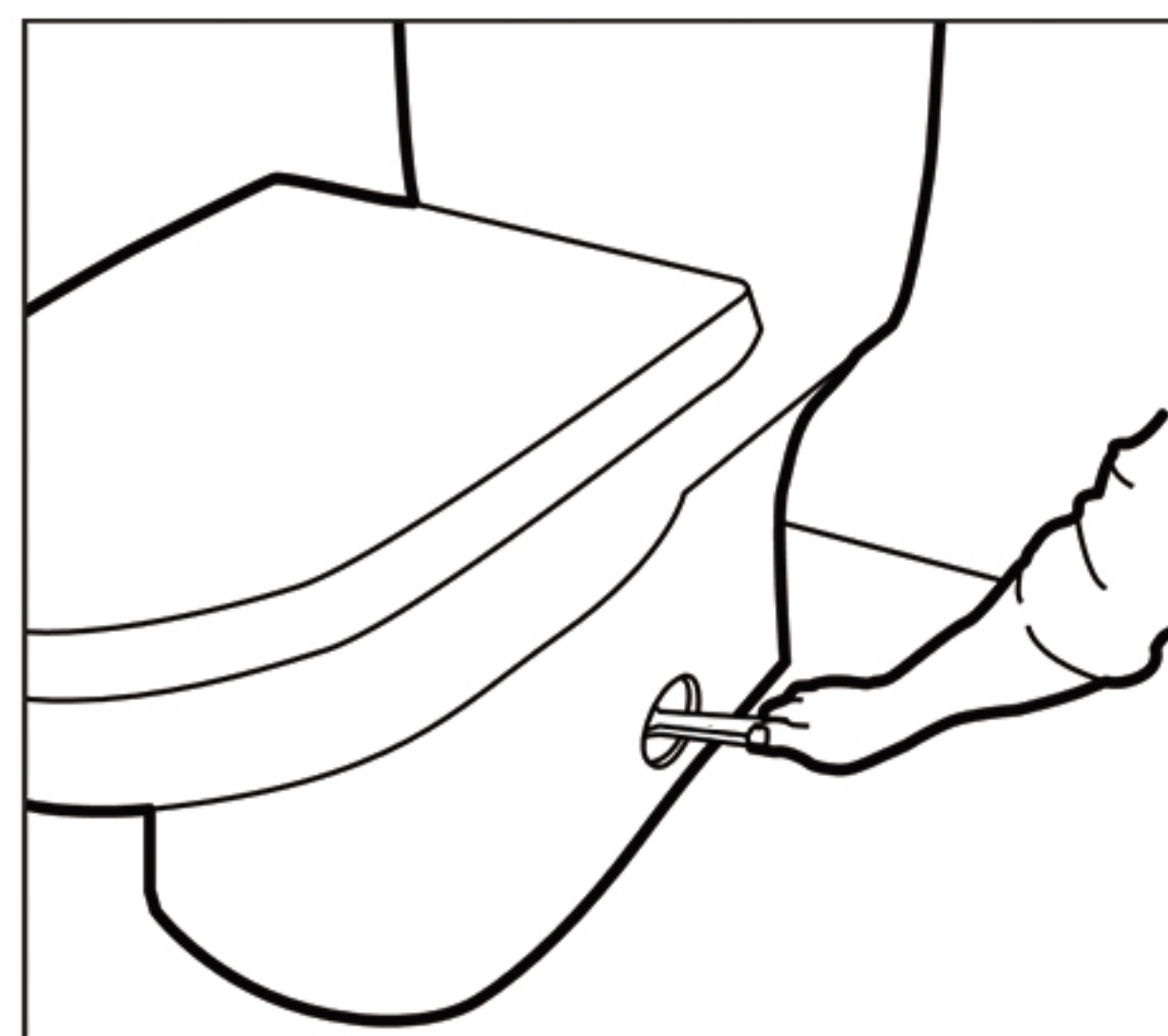
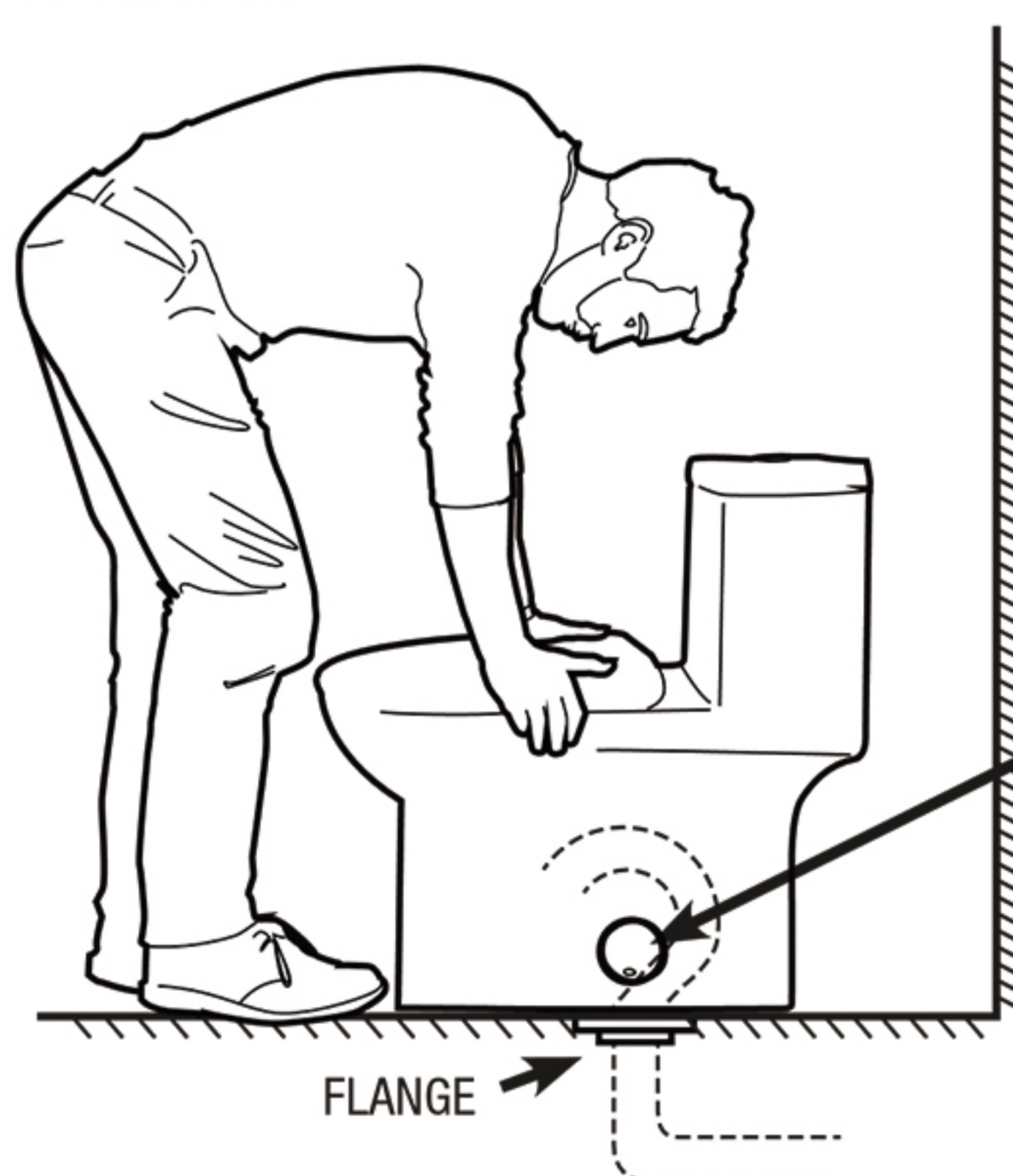

- Join the water intake valve and the supply valve with the flexible connecting hose (if the part consists of a separate filter, connect the filter first). Turn on the water supply and make sure that all of the connections have been properly joined and that there are no leaks. **NOTE:** Tightening the nuts further can prevent leakage.

- Apply a bead of sealant around the base. Remove any excess sealant.

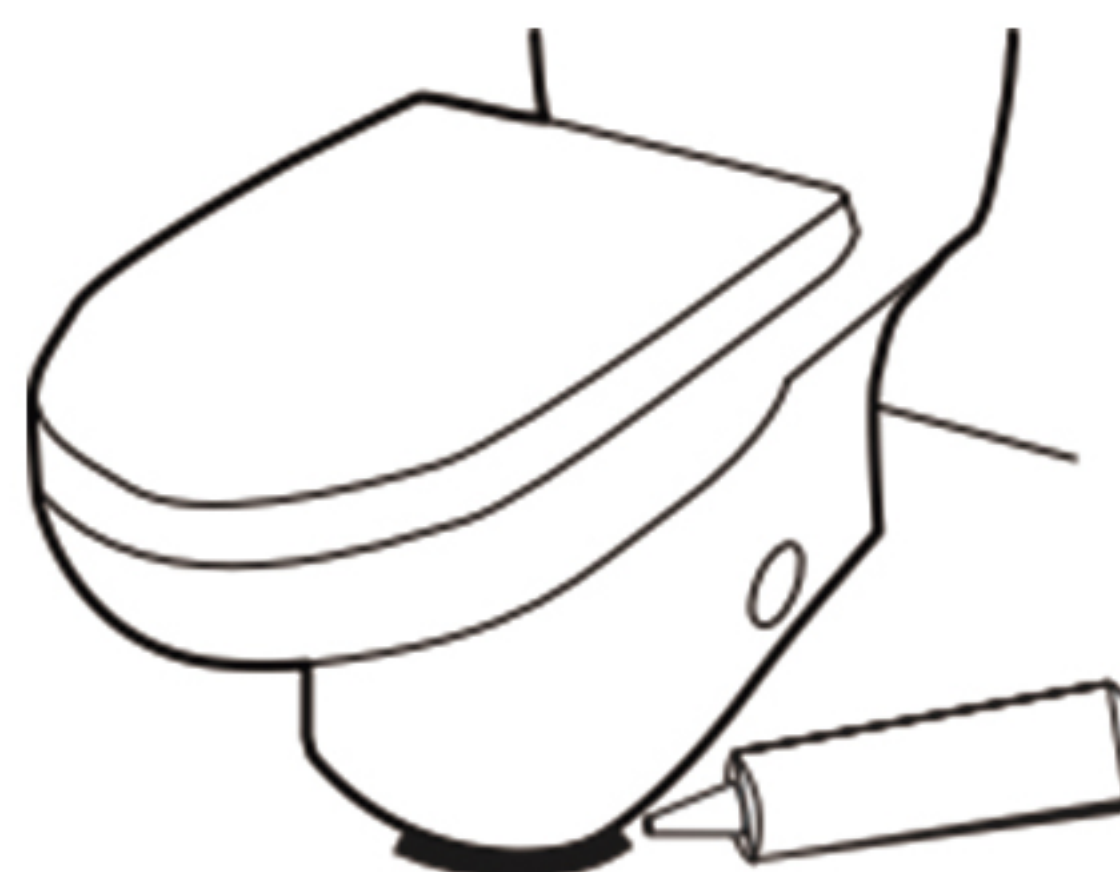

CLEANING & MAINTENANCE

To clean the toilet, use warm, soapy water; rinse thoroughly with fresh water and dry with a soft cloth. Avoid detergents, disinfectants, or cleaning products in aerosol cans. NEVER use abrasive powders scouring powders or pads on the toilet seat. Some bathroom chemicals and cosmetics may damage the seat's finish.



WARNING: Do not use in-tank cleaners. Products containing chlorine (calcium hypochlorite) can seriously damage fittings in the tank. This can cause leakage and property damage.

TROUBLESHOOTING GUIDE

PROBLEM	POSSIBLE CAUSE	SOLUTION
Does not flush	a. Water supply valve is closed. b. Supply line blocked.	a. Open valve and allow water to fill tank. b. Shut off water supply, disconnect supply line, and inspect all gaskets and washers. Reassemble. See "Maintenance".
Slow or weak flush	a. Bowl water level too low. b. Supply valve partly closed. c. Partially clogged trapway. d. Supply pressure too low.	a. Check that the refill tube is connected to the water fill control regulator and inserted into the refill float without being kinked or damaged. b. Open the supply valve completely. Be sure that the proper supply tube is used. c. Remove any obstruction. Consult a plumber if necessary. d. Normal supply pressure must be at least 20 psi.
Toilet leaks	a. Poor supply line connection. b. Poor bowl to tank/floor connection.	a. Review step 9 of the installation procedure. b. Reviews steps 4 to 6 of the installation procedure.
Toilet does not shut off	a. Flush valve seat and/or seal worn or deformed.	a. Replace seal/flush valve assembly as needed.

TOILET SEAT

INSTALLATION GUIDE

NOTES

1. Make sure all the parts are included in the package, should one be missing, please contact the retailer where you have purchased this product.
2. When you take the parts from the carton, keep them together in a container to avoid losing them.
3. When the installation is completed, make sure the seat and cover is firmly installed.
4. For maintenance, do not use corrosive products or solvents (such as gasoline, thinner or turpentine), or sharp objects. Clean the surface with a mild soap and water and dry with a clean and soft cloth.
5. Do not remove the plastic protector before using the seat and cover.
6. Some bathroom chemicals and cosmetics may damage the finish.
7. The closing speed of seat with slow closure mechanism may vary according to room temperature and frequency of use.
8. Do not place heavy objects on the seat and do not stand as the weight could damage the seat or you could fall.
9. Do not expose the product to direct sunlight to avoid fading it.
10. Do not let children handle the seat to avoid pinching their fingers.

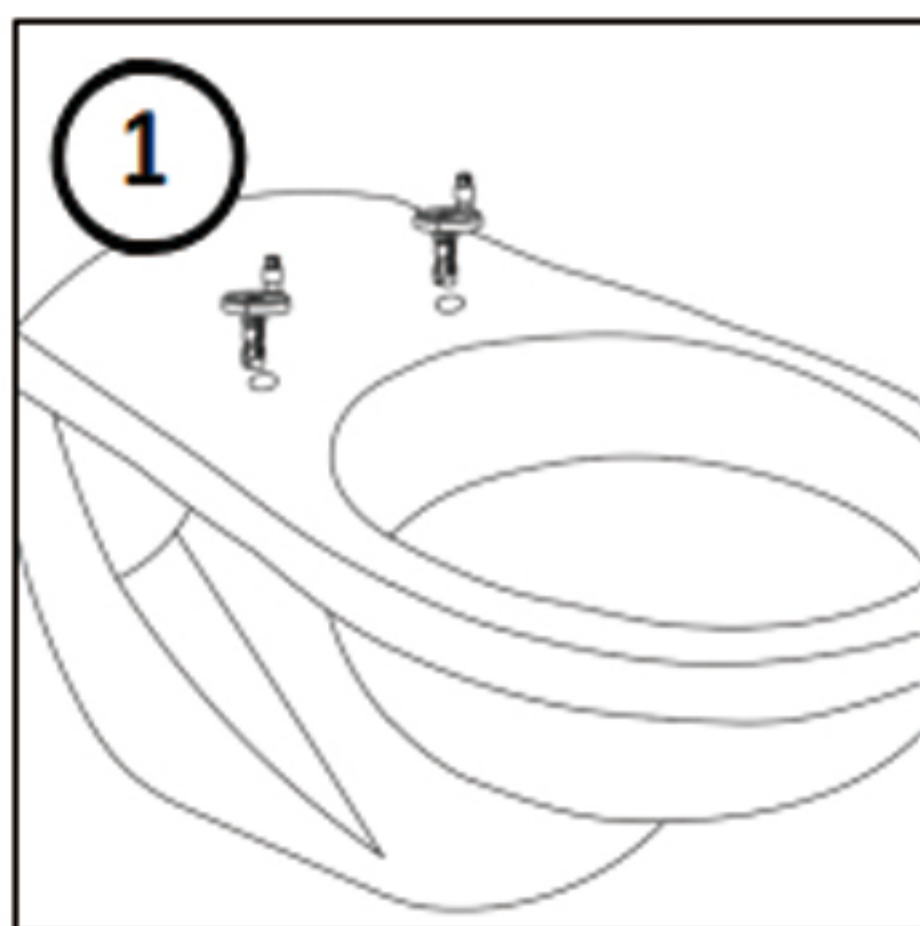

Insert the fittings into the bowl openings.

NOTE: Do not fully tighten screws.

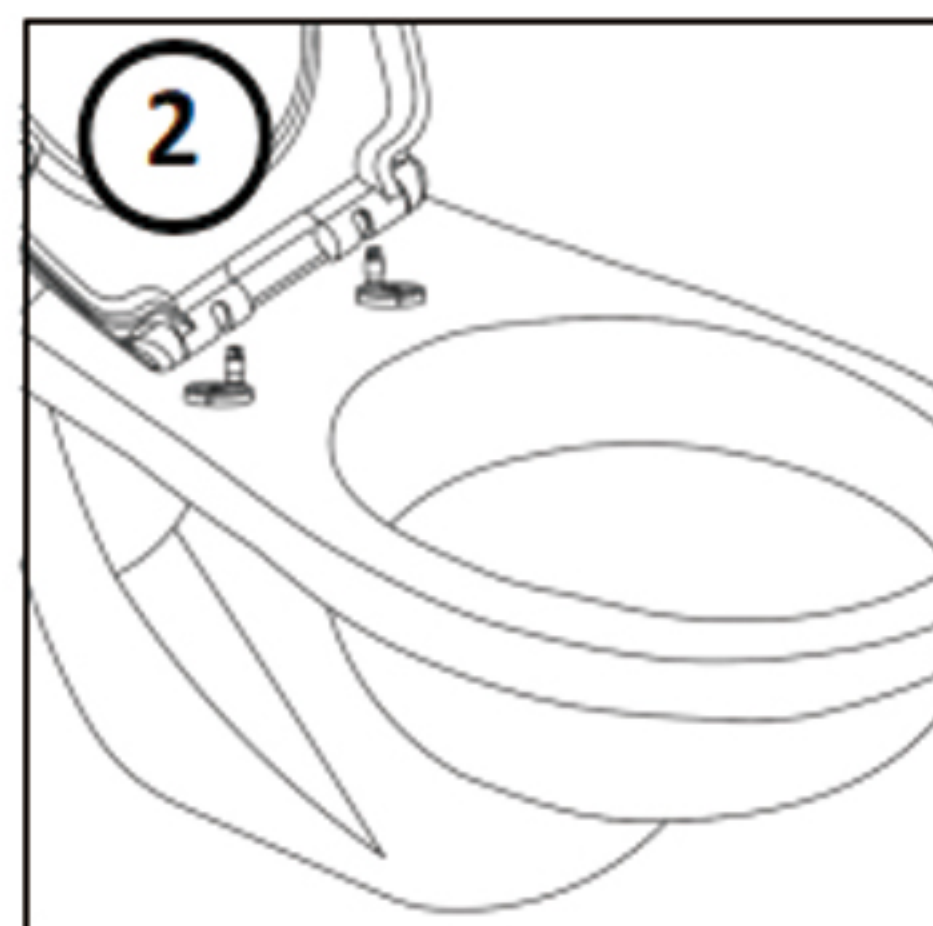

With the toilet seat in vertical position, push it onto the fittings and adjust the seat position to the toilet bowl.

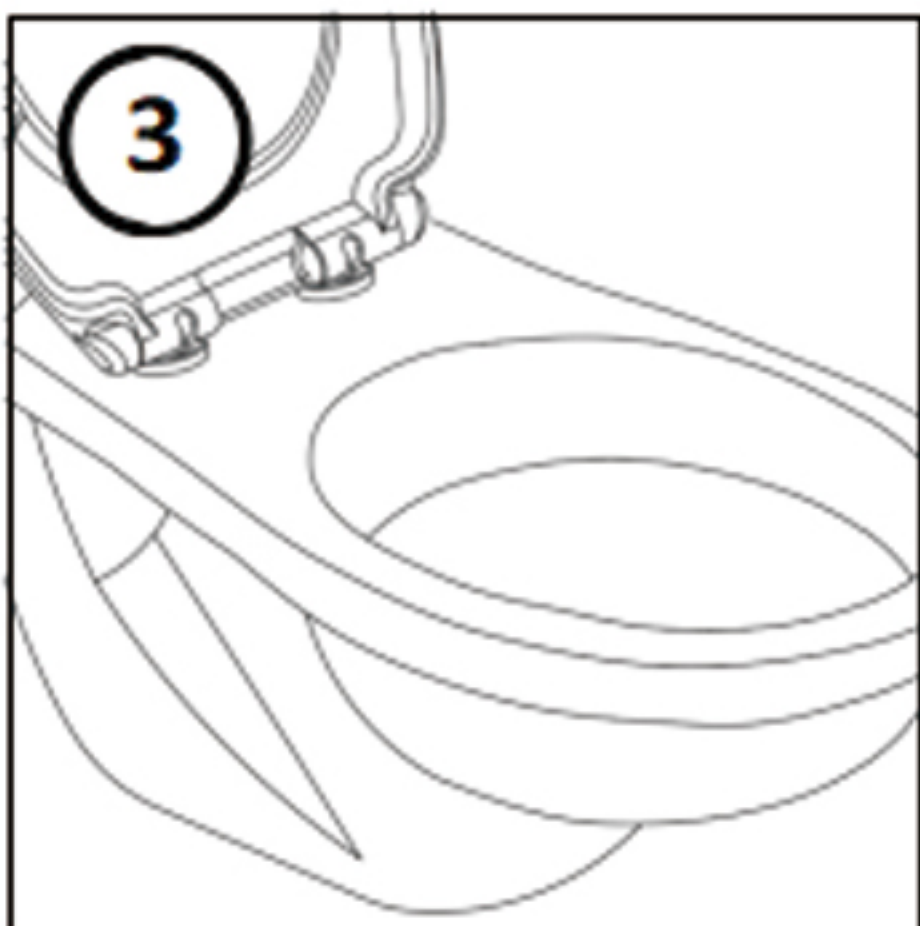

Remove the seat by lifting it vertically, tighten fittings, and cover them with caps.

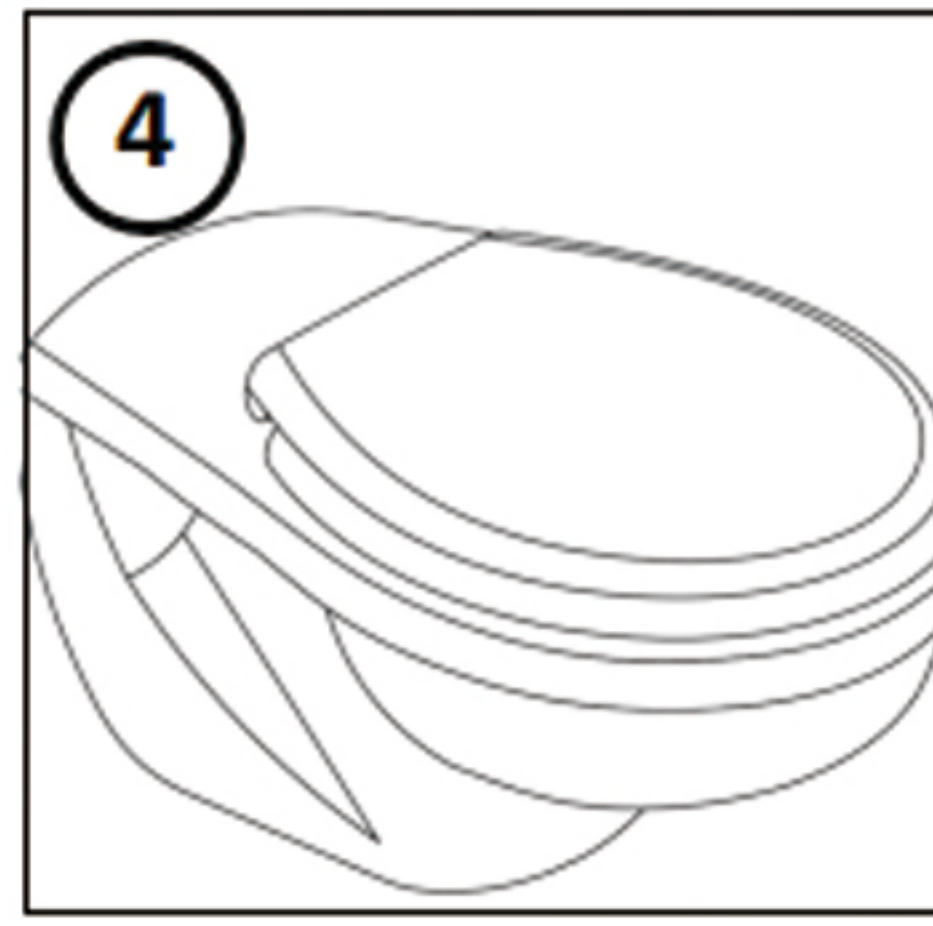

Reattach the seat: place it in a vertical position push it onto the fittings until you hear a click.

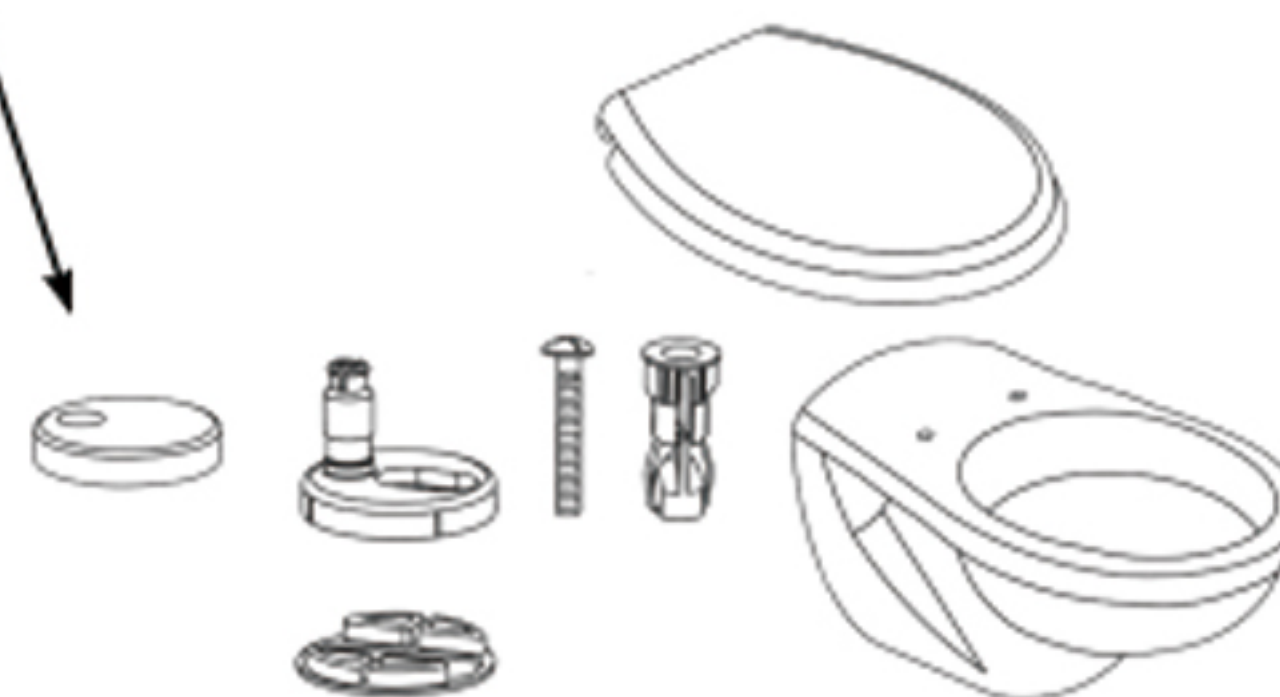

www.clovisgoods.com

(628) 800-9999

buyer@clovisgoods.com

CLOVIS



Wrong or Damaged orders?

We try hard to make sure all orders are perfect and care much about your shopping experience, and we're sorry if your order was damaged or you received the wrong item!

If you would like us to set up the return for you, please feel free to contact us through email. We'll be more than happy to help make everything right!

CLOVIS

Q.CLOVIS

Walmart ✱

 overstock

MENARDS

amazon

wayfair ✱

HOME
DEPOT

THANK YOU!

To our valued customers,

Thank you for choosing Clovis Goods! We hope you had a good shopping experience with us! We value your opinions, and we'd like to hear your opinion on our services and products. Furthermore, it would be great if you'd take a few minutes to leave your review and feedback under our products. This would help us improve and serve you better in the future! Many thanks for your time!

Sincerely,
The Clovis Goods Team

Questions or concerns?
Please contact us:
buyer@clovisgoods.com

CLOVIS

Walmart ✱

overstock

MENARDS

amazon

wayfair ✱

HOME
DEPOT