



Triple Lens Endoscope User Manual



Product Overview

This new digital Video recording endoscope is a portable, high quality multifunction inspection system featuring 4.3 full-view IPS screen with powerful recording capability. Users can capture images(JPG) or Video(AVI) on the TF card with up to 2.0 MP resolution for the image, 720P high definition for the videos.

Applications

This premier tool is an economical solution for:
Automotive / Diesel Repair and Maintenance
Inspection of hard to reach or hard to see area or equipment.
Plumbing, construction, restoration applications
Science Education
Outdoor Exploration

Safety & Care

WARNING! Please read all safety warnings and all instructions before using this product. Failure to follow the warnings and instructions may result in electric shock, fire and serious injury.

1. Keep the tool dry, clean, free from oil, water or other materials causing corrosion.
2. Keep work area clean and well lit.
3. This appliance is not intended for use by persons with limited physical, sensory or mental capabilities.
3. This appliance is not intended for medical use or personal inspection.
4. Keep bystanders, children away while operating the tool.
5. Do not overreach, keep proper footing and balance at all times.

Feature

1. View live inspection video instantly in the 4.3 full-view IPS screen
2. Up to 2.0 mega pixel resolution for image capture,1080P HD for recording videos.
3. 8mm tri-cameras tip can easily exchange between Fron t-view and Side-view. Also, both view display.
4. 8 pcs adjustable led lights.

Technical Specifications

Monitor:

Screen Type: 4.3inch full-view IPS
Rotation: 360° rotation
Menu language: English, Germany, Chinese, Japanese
Port: Connect port; USB, TF card slot

Camera:

Diameter: 8 MM
Resolution: 1280X720 1920X1080
Viewing angle: 90°
Focus Length: Front camera 2 inch
B-Side camera 1.2 inch
C-Side camera 0.8 inch

Light source: 8 adjustable High-Intensity LEDs

Maintenance:

1. Always keep the camera lens clean.
2. Any other components not mentioned need to be replaced, please contact our service agents.



Description



- ①QUIT Button & Lens Setting ②UP Button ③DOWN Button
④OK Button ⑤LED Light Adjust ⑥ON/OFF Button
⑦SD Card Port ⑧Power Indicator

Select , press to snap photos.
Select , press to start record video, press again to finish record.
Select , press to view captured pictures and videos.
Select , press to enter general settings.
All of the icons can be selected by using the UP/DOWN buttons.

Menu Tree

With the unit powered on, press the UP/DOWN buttons to move the icon , then press the OK button to enter into system setting

- Resolution setting: 1280X720 1920X1080
- Language setting: English, Germany, Japanese, Chinese.
- Brightness : Adjust screen brightness.
- Rotate Mode: Adjust the display screen 360 degree rotation.
- Format: Formatting SD Card.

Installation

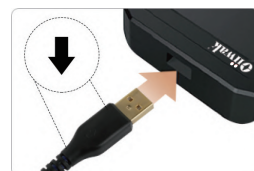

- 1.Connect the endoscope to the monitor.(The mark of arrow is on the top.)



- 2.Put the TF card into the TF card port.(Don't insert the wrong memory card direction.)



- 3.Press the 'ON' Button



4. Set up general setting then you can use it.

Exchange Camera Mode

- 1.Long press button 2s to exchange cameras.



Front View

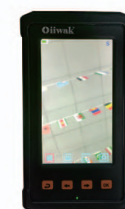

Side View



Split-Screen View

Transfer picture/video Files to Computer

Connect to a computer with the USB cable to transfer files.



Delete the File

In the video/ picture Album, press the QUIT Button(3 seconds) to delete the current video or photo.



1. Select Album

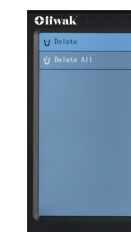

2. Press QUIT Button 3 Seconds



- 3.Press OK Button to delete

How to Charge the Endoscope

Recharge: turn off the ON/OFF. When recharge the battery, power LED is on (red light), after it is full recharged, power LED off.
The recharging time is about 3 hours with 5V/2A adapter

