

COSTWAY®



USER'S MANUAL

Vertical Garment Steamer

ES10039US

THIS INSTRUCTION BOOKLET CONTAINS **IMPORTANT** SAFETY INFORMATION. PLEASE READ AND KEEP FOR FUTURE REFERENCE.

Please give us a chance to make it right and do better!

Contact our friendly customer service department for help first.

Replacements for missing or damaged parts will be shipped ASAP!

Follow Costway



Contact Us!

Do NOT return this item.

Contact our friendly customer service department for help first.



Before You Start

- ⚠ Please read all instructions carefully.
- ⚠ Retain instructions for future reference.
- ⚠ Separate and count all parts and hardware.
- ⚠ Read through each step carefully and follow the proper order.
- ⚠ We recommend that, where possible, all items are assembled near to the area in which they will be placed in use, to avoid moving the product unnecessarily once assembled.
- ⚠ Always place the product on a flat, steady and stable surface.
- ⚠ Keep all small parts and packaging materials for this product away from babies and children as they potentially pose a serious choking hazard.

VERTICAL GARMENT STEAMER**PRODUCT INTRODUCTION**

Thanks for choosing us! The working theory of this product is touching the fabric by hot steam at 208 ℉ to soften the fibers, to make the fabric smooth and neat by the movements of pull and press. The fabric steamer can clean, disinfect and remove the smell, it popularly used in the garment shops, hotels, restaurants, home, etc, normally with hanger and hook. Only 45 seconds for heat-up and steam, iron to the fabric, no need ironing board, 60 minutes continuous steam, it helps decrease many traditional ironing steps and save the time. Please use our products without worry, we have double safety protection device : auto power-off for over-heat or shortage of water! The product is suitable for the cleanse and ironing of any fibers of the garments, curtains, carpets, bed-sheets, etc, easy-operating, portable and time-saving.

NOTICE**Danger**

- Don't wash under the tap and immerse the machine into water or any liquid;
- Be careful to the hot steam, it may burn the skin.

Caution

- Make sure the power supply accord with the power symbol on the product before connecting the power supply, don't use it with other high voltage appliance under the same power supply.
- Please stop using the machine if any part is obviously damaged: the plug, cord, air hose, water reservoir or the machine.
- Repair the machine in the designated service centre, do not repair by yourself, inappropriate repair may result in leakage of electricity or other accident.
- Don't walk away when the machine is working.
- This appliance can be used by children aged from 8 years and above and persons with reduced physical, sensory or mental capabilities or lack of experience and knowledge if they have been given supervision or instruction concerning use of the appliance in a safe way and understand the hazards involved. Children shall not play with the appliance. Cleaning and user maintenance shall not be made by children without supervision.
- The sprinkler will get hotter and hotter, don't touch it to avoid burnt.
- Don't twist the hose and block the steam hole to avoid the accident due to high air pressure.
- Please hold the heat insulation part when hose head is hot.
- Don't insert hot water into the reservoir.
- Don't mix any cleaner in water.
- Make sure the plug is off when cleaning or adding water.

Remark

- The outlet demands to connect the ground wire.
- Must be used on the level ground.
- The steam will cool down and condensate in the hose if the hose is in U status, the steam will be interrupted or water drop come out.
- Please power off and unplug after ironing, for cleaning or leaving away for a short while.

VERTICAL GARMENT STEAMER

USING GUIDANCE

- Make sure the reservoir is full of water on the relative position.
- Controlling the angle of ironing steam by the handle which is the connection between the sprinkler and hose.
- Lift and hang the sprinkler on the hook.
- The steam generator is inside the machine.
- Please raise up the sprinkler timely to stretch the hose if you hear grunt or you see the steam is interrupted.
- Easy to move wheels are installed at the bottom, making the machine more convenient to use.

CLEAN AND MAINTAIN

- Please unplug before cleaning the machine.
- Don't use abrasive cleaner or corrosive liquid(e.g.: alcohol, gas oil or acetone) and steel cleaning material.
- Use wet cloth or in-corrosive cleaner, remove the impurities in the sprinkler.
- Because of the different mineral materials in water in different areas, impurities or sediment will lay at the steam generator. In that case, please unscrew the drain plug of steam generator, clean and remove impurities and sediment.
- We suggest to clear the steam generator after using continuously for 15 days.

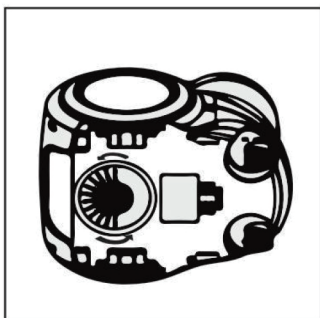

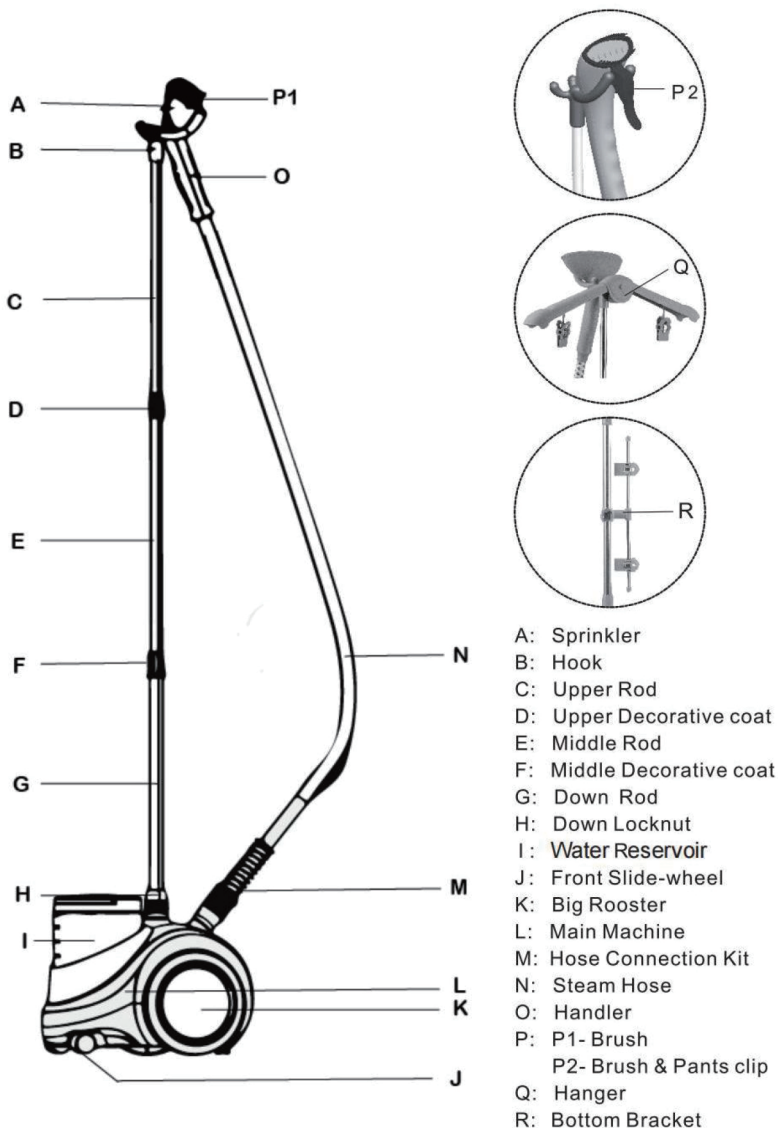
VERTICAL GARMENT STEAMER
PARTS AND ACCESSORIES

VERTICAL GARMENT STEAMER

INSTALLATION

Step 1 Install Stainless Steel Rods, Hook or Hanger

1. Put the main machine on the level ground.
2. Flexible rods: hold rod 2 and rod 3, rotate counterclockwise way for loosening and expanding the rod to right length, then clockwise way for tightening. (Fig. A and Fig. B)
3. Insert hook 1 into top of rod 2 and fix it well. The hook is for 360° rotating. (Fig. A and Fig. C)
4. Insert the rod into the bottom locknut and tighten. (Fig. D)

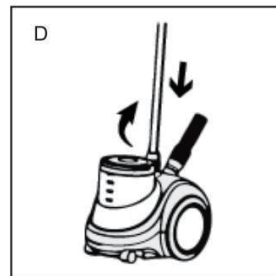
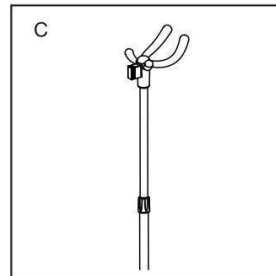
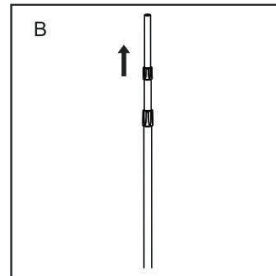
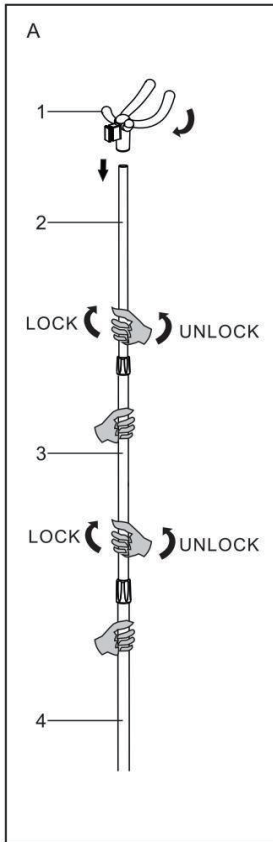

VERTICAL GARMENT STEAMER**INSTALLATION****Step 2** Install the steam hose

1. Insert the hose into the hole, rotate and tighten it. (Fig. 1)
2. Put sprinkler on the hook.(Fig. 2)

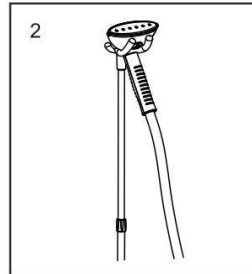
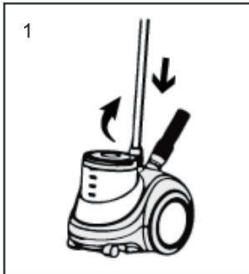
**Step 3** Install the brush/pant hook

1. Suit the brush on sprinkler.(Fig. 1)
2. Insert the pant hook into the prompt position of the sprinkler.(Fig. 2)

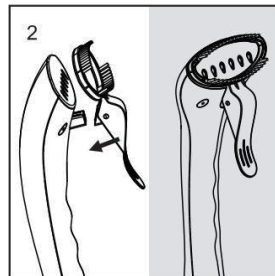
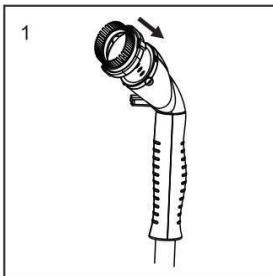

VERTICAL GARMENT STEAMER**INSTALLATION****Step 4** Install the hanger

1. Insert the hook on the top of rod set.(Fig.1)
2. Insert the hanger on the hook.(Fig.2)
3. Hold the both Arm A & Arm B to open the hanger outward,it's open in place when a cracking sound is heard.(Fig.3)

Remark:

1. No Push to open the hanger.(Fig.3)
2. Close the hanger: Press "PUSH" button,hold Arm A & Arm B to close the hanger inward.(Fig.3、 4)

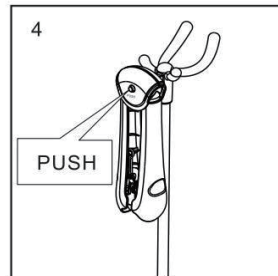
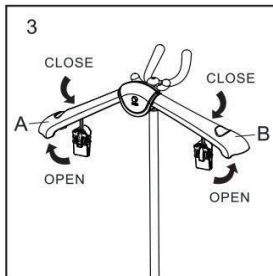
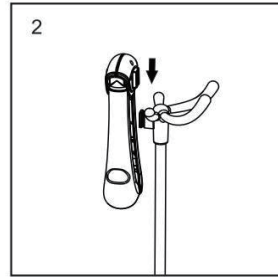
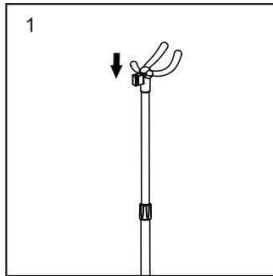

VERTICAL GARMENT STEAMER

OPERATION

Step 1 Preparation

1. Put the machine on the ground, take out the water reservoir.(Fig. 1)
2. Check the reservoir, if there's deposition, clear it according to the instruction.
3. Reverse the reservoir, press the valve for 2 or 3 times to make sure it works.
Notice: Do not open the valve to avoid damage.(Fig. 2)
4. Fill in the water reservoir.(Fig. 3)
5. Tighten the cover.(Fig. 4)

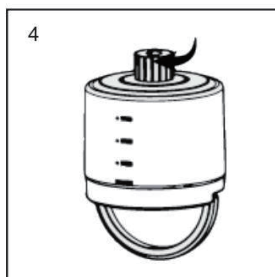
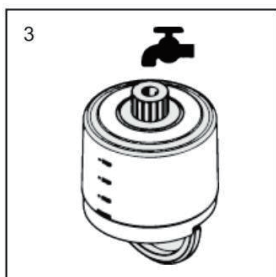
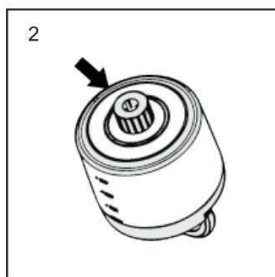
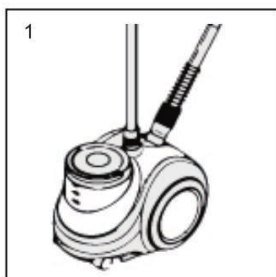

Step 2 Injection

- Available water types: common running water. You may mix the distilled water with the running water for better.
- Do not mix the perfume, vinegar, cleaner or other chemicals into water.

1. Disconnect the power supply before injection.

2. Put the full storage onto the machine.

Remark: Water storage is set in front or at the back of the main machine, as shown in picture 1 and picture 2.

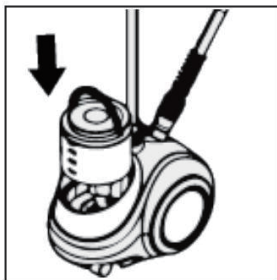
VERTICAL GARMENT STEAMER**OPERATION**

1. water reservoir in front

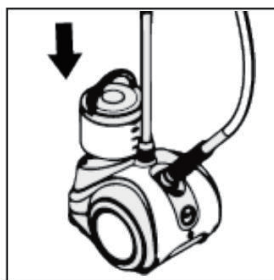

2. water reservoir at back

Step 3 Start

1. Make sure the machine is powered off.
2. Insert plug into right outlet.
3. Power on the on/off switch.
4. The machine starts when it lights.
5. Steam starts after 45 seconds.

Remarks:

- Double-temperature control model : When you switch on the button, the heat power is at 660W(perfect for thin fabrics).When the two buttons are on the power is at 1500W (perfect for heavy fabrics).



Remark: Power switch or operation panel is separately set in front or at the back of the machine, please work it according to the actual condition.

VERTICAL GARMENT STEAMER**IRONING METHODS**

- Leave the steam away from people.
 - Don't touch sprinkler holes when the machine works long time, keep 20cm(7.87") away with body.
 - Hose will be getting hotter, it's normal in ironing.
 - Easier removal for the fabric with less wrinkles.
 - Level the fabric before starting.
 - Fix the hanger or hook before ironing a towel, handkerchief or other soft material.
 - Ironing repeatedly for thick fabric.
1. Hang the fabric or garment.(Fig. 1)
 2. Upwards the sprinkler, move the sprinkler up and down for wrinkles removal.(Fig. 1)
 3. Level the fabric or garment by hands when moving the sprinkler for better.(Fig. 2)
 4. Pants clamp: level and clip pants tightly, move the sprinkler slightly for several times, a flat straight line can be seen.(Fig. 3)
 5. Using brush to remove dust, not for soft fabrics: silk and satins.(Fig. 4)

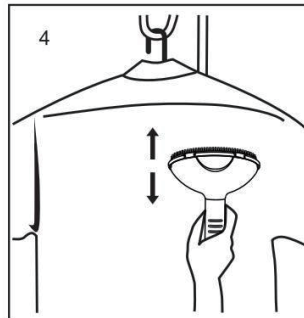
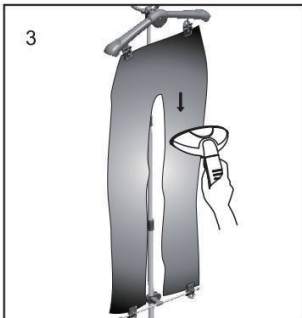
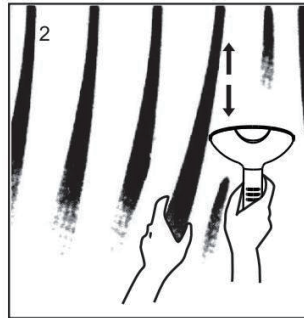
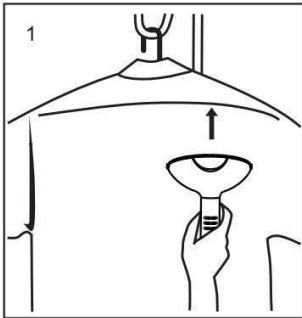

VERTICAL GARMENT STEAMER**DRAIN THE WATER RESERVOIR AND STOW THE MACHINE**

1. Power off. It's normal for steaming after power off for a short while.
2. Unplug from the outlet.
3. Cooling down the machine for 30 minutes at least.
4. Open the water reservoir cover and drain the water in the tank.(Fig. 1)
5. Loosen the down locknut, take out the rods. Flexible rods length is easy for storing up.(Fig. 2 and Fig. 3)
6. Loosen the steam hose front end, take out the hose.(Fig. 2 and Fig. 3)
7. Empty the rest water in the steam generator.(Fig. 4)
8. Stow the machine in a safe and dry position.

Notice: clear and drain the water reservoir and steam generator twice a month.
In order to assuring safe operation, please clean the machine and keep it dry after using.

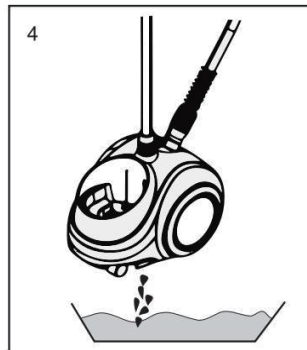
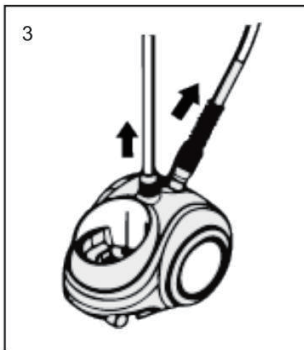
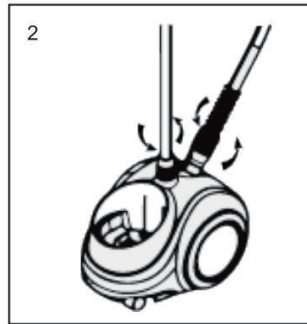
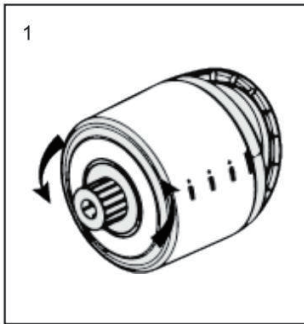

VERTICAL GARMENT STEAMER

TROUBLESHOOTS

In this page, we have concluded all problems probably happened, please check the machine according to the information below. If you can't solve the problem by yourself, please contact our customer service.

Problem	Reason	Solution
Fail to heat	No power supply Switch off Cord loosen Components broken	Connect power supply Switch on Check it out and fasten it Replace components
No steam	Lack of water	Switch it off, inject water
Sprinkler drips water	Condensation in the pipe Sprinkler broken	Lift the sprinkler, let the drips flow back to the water reservoir Replace the sprinkler
Steam pipe buzzes	Pipe curls Sprinkler is lower than horizon	Straighten the pipe Lift the sprinkler
Light problem	Blow a fuse Poor contact	Replace fuse Check the plug and outlet

CIRCUIT DIAGRAM

There're 3 series of fabric steamer, they are: Double Temperature Control Type, Nimble Type and Digital type. The related circuit diagrams are as below. It's available to refer to similar type for the following without remarkable circuit diagram.

1. Double Temperature Control Type:

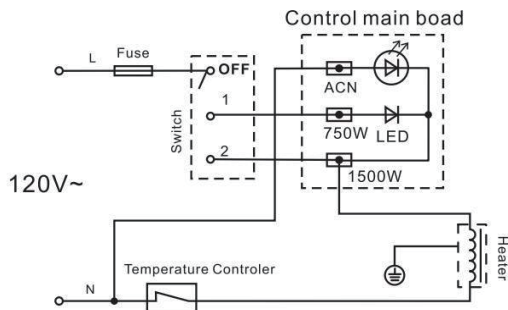

VERTICAL GARMENT STEAMER

MODELS & SPECIFICATIONS

You may find the related product specifications on the actual merchandise for the model which is not included in this user's manual.

Model	Voltage	Frequency	Power	Storage	Steam Output
ES10039US	110-120V~	60Hz	660/1500W	1.8L	40g/min

Packing List

Main machine 1Set	Hook 1Set
Rod 1Set	Instruction 1Set
Sprinker 1Set	Pants clip 1Set
Brush 1Set		

Note: Special Model without Pants Clip.

Welcome to visit our website and purchase our quality products!

With your inspiring rating, COSTWAY will be more consistent to offer you
EASY SHOPPING EXPERIENCE, GOOD PRODUCTS and EFFICIENT SERVICE!

US office: Fontana, California

UK office: Ipswich



- * Reward Points
- * Exclusive Customer Service
- * Personalized Recommendations
- * Permanent Shopping Cart
- * Order History

5 Star Rating



We would like to extend our heartfelt thanks to
all of our customers for taking time to assemble
this product and giving us valuable feedbacks.

THANK
you
😊

