

## L-Shape Mount Plate with Wooden Handle for FUJIFILM X100VI

富士X100VI 木头L型手柄

- Thank you for purchasing SmallRig's product.  
感谢您购买 SmallRig 产品。
- Please read this Operation Guide carefully.  
使用本产品之前，请仔细阅读操作指引。
- Please follow the safety warnings.  
请注意所有警告提示并遵循使用操作指引的所有指令。

## In the Box / 包装清单

L-shaped Grip	× 1	Hot Shoe Cover	× 1
L型手握		热靴盖	
Shutter Release Button	× 1	Guarantee Card	× 1
快门按钮		保修卡	

## Product Details / 产品介绍

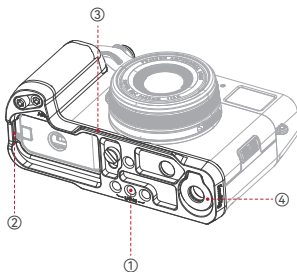

- |  |                                 |
|--|---------------------------------|
| ① 1/4"-20 Threaded Hole<br>1/4"-20 螺纹孔   | ③ Arca-Swiss Plate<br>阿卡规格快装板   |
| ② Shoulder / Wrist Strap Slot<br>肩带/腕带接口 | ④ Flat-Head Screwdriver<br>一字扳手 |

# L-shaped Grip Installation Instruction

## L型手握安装步骤

1

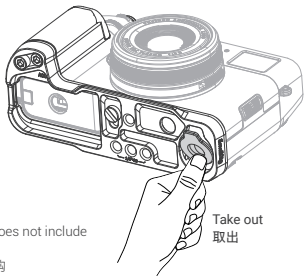

\* The package does not include the camera.

\* 相机机身需另购

2

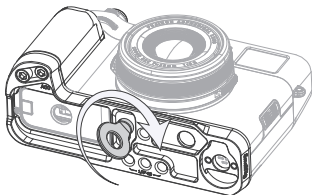

\* The package does not include the camera.

\* 相机机身需另购

## Hot Shoe Cover and Shutter Release Button Installation

### 热靴盖和快门按钮安装步骤

1

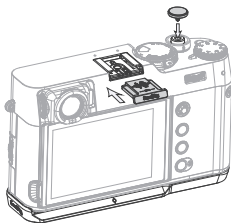

\* The package does not include the camera.

\* 相机机身需另购

2

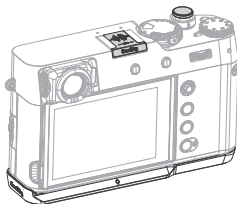

\* The package does not include the camera.

\* 相机机身需另购

## Product Parameters / 产品参数

Product Dimensions 产品尺寸	5.1 × 2.1 × 2.3in 130.2 × 54 × 59.7mm
Product Weight 产品重量	2.7 ± 0.2oz 77.0 ± 5.0g
Compatibility 兼容性	FUJIFILM X100VI 富士 X100VI
Material(s) 主要材质	Aluminum Alloy, Wooden 铝合金、木头

- \* Specifications subject to change without prior notice. Please refer to the physical product for the most up-to-date information.

技术参数如有改动，以实物为准，恕不另行通知。

Manufacturer Email: support@smallrig.com

Manufacturer: Shenzhen Leqi Innovation Co., Ltd.

Add: Rooms 101, 701, 901, Building 4, Gonglianfuji Innovation Park, No. 58, Ping'an Road,  
Dafu Community, Guanlan Street, Longhua District, Shenzhen, Guangdong, China.

制造商：深圳市乐其创新股份有限公司

地址：中国广东省深圳市龙华区观澜街道大富社区平安路58号共联富基创新园4栋101、701、901

Consignor: Shenzhen LC Co., Ltd.

Add: Room 201, Building 4, Gonglianfuji Innovation Park, No. 58, Ping'an Road,  
Dafu Community, Guanlan Street, Longhua District, Shenzhen, Guangdong, China.

委托商：深圳市乐长科技有限公司

地址：中国广东省深圳市龙华区观澜街道大富社区平安路58号共联富基创新园4栋201

执行标准：GB/T 26572-2011

**RoHS** **CE**



Séparez les éléments avant de trier



中国制造

Made in China