



SHENZHEN MINTION TECHNOLOGY CO., LTD

Distribution: [sales@mintion.net](mailto:sales@mintion.net)  
Support: [support@mintion.net](mailto:support@mintion.net)  
FB Group: Mintion Official Group



BEAGLE V2

3D Printer Camera

**Quick Guide Manual**



## Beagle V2 Firmware Download

Beagle V2 camera supports  
online upgrade



## Beagleprint App Download

## PACKING LIST



Beagle V2



Gimbal x1  
Tripod x1



Micro SD  
Card x1  
(Insert in camera)



Quick Guide  
Manual x1



Power  
Plug x1



USB-Type-C  
Cable 1.5M x1  
(For power)



USB-Micro-B  
Cable 1M x1  
(Connect to printer)

## CAMERA INTRODUCTION

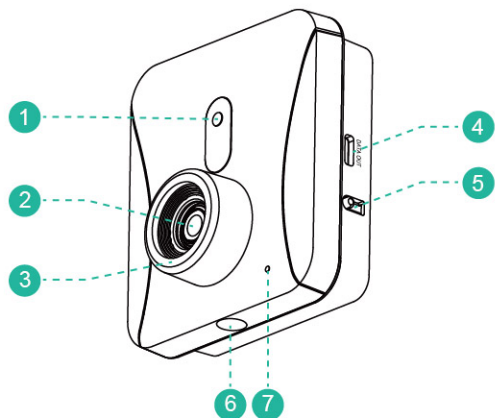

- 1 IR-Cult Sensor
- 2 Lens
- 3 Focus Ring
- 4 Data Port (With Cover)
- 5 Reset Button
- 6 Tripod Mount (size 1/4"-20)
- 7 Microphone

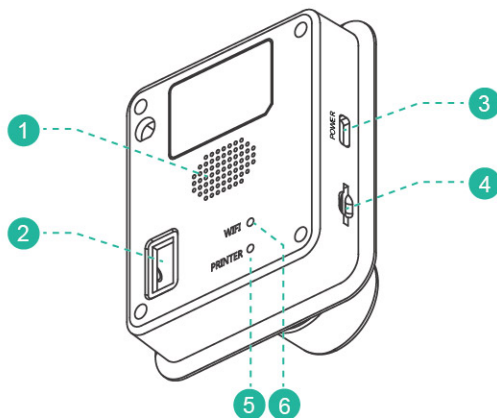

- 1 Speaker
- 2 USB Socket
- 3 Power Socket
- 4 Micro SD Card
- 5 Printer Indicator
  - Solid Red: Printer connected
  - Flashing Red: Printer disconnected
- 6 WiFi Indicator
  - Solid Green: WiFi connected
  - Flashing Green: WiFi disconnected

## INSTALLATION BRACKET

Assemble the gimbal and tripod

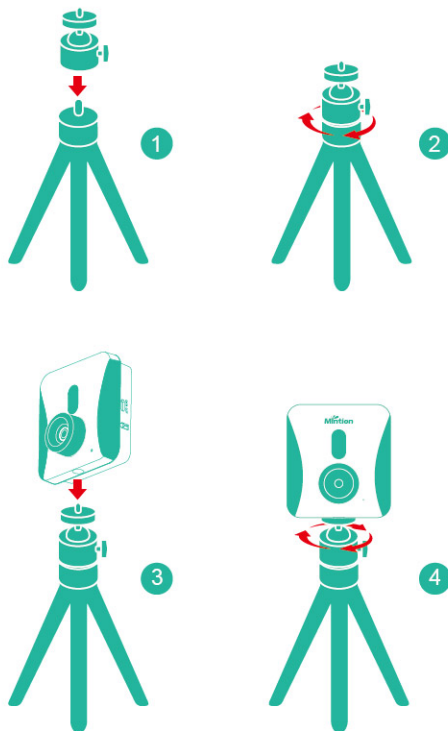

## ADD THE CAMERA

Download Beagleprint,  
Register an account and log in.



Power up the Camera until you hear the voice prompt "Camera is ready for Wi-Fi configuration", (expected within 1 minute).

Click + to add the camera and select the "QR Scan Configuration" for WiFi connection.

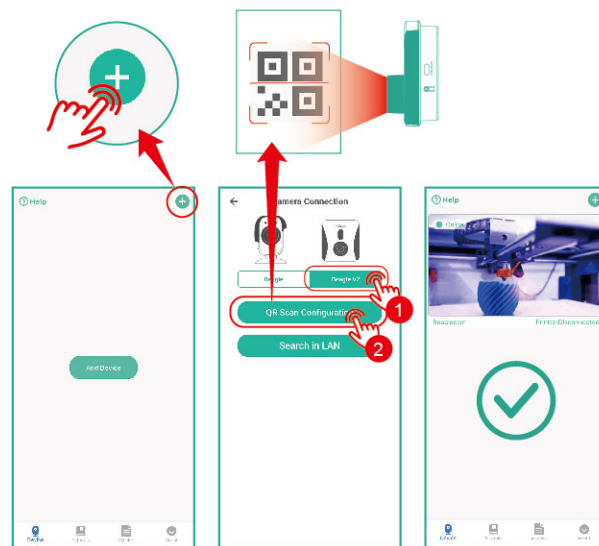

## FIRST USE

Click on the device on the device page to enter the device control page and set the printer model.

\*Click on the corresponding space to perform the operation.

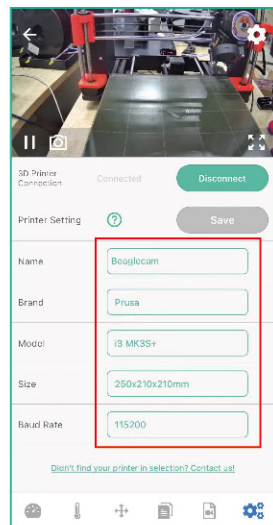

Use a USB cable to connect the Camera to the printer USB port.

\*After the printer is started (when the printer screen is operable, the printer is considered to have completed the startup).

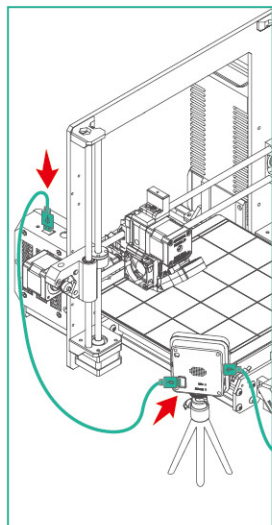

Connect the Camera by clicking the "connect" button to connect the printer.

\*After successful connection, the button will change to "Disconnect". Also, Print off only indicates that there is no current printing process.

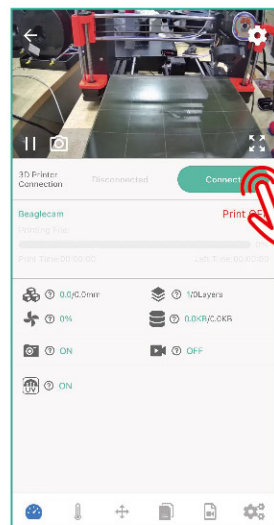

Click "+", upload the G-code file, and click "{print icon}" to start printing.

\*If your printer is an automatic bed leveling printer, please insert M420 S1 below G28 in the Star Gcode section of your slicing software to enable automatic bed leveling compensation.

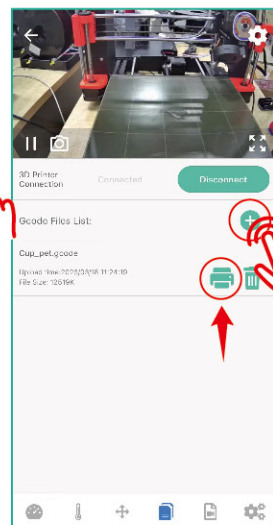

On the dashboard page or device page, you can monitor the progress of the printer's printing task and pause or stop the printing operation.

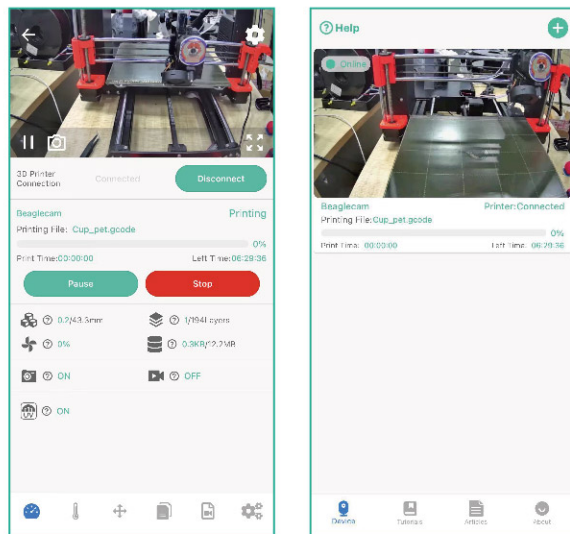

## WEB PAGE

In the Beagleprint app, click on Settings, find the IP address in the Camera information page, and use a browser to enter it to access the login page.

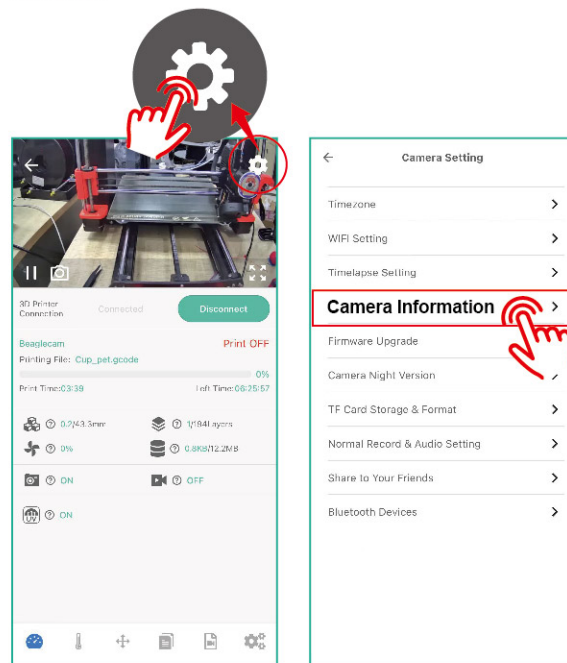

← Camera Information

Camera ID: MKFC-138123-KVXWY

Camera Model: Beagle

Current Firmware: 1.1.9

User Online: 1

Mac Address: B4:8D:C2:8C:D8:7A

IP Address: **192.168.0.15**

Subnet Mask: 255.255.255.0

Gateway: 192.168.0.1

DNS1: 192.168.0.1

DNS2: 192.168.0.1

Restart Camera

Reset Camera (Saved WiFi)

Reset Camera (No WiFi)

Find the IP address

Enter IP address, Enter the password (default password is "admin") and click the confirm button to log in. ▼

Beagleprint

← → ↻ ⚠ Not secure 192.168.0.15

Please sign in

Account: admin

Password: **admin**

☒ Remember Me

Login

The default account and password of camera is "admin".

\*The Camera is connected to the same network (same subnet) as the computer/tablet/phone using the browser.

Once logged in successfully, you can connect to the printer via the "Connect" button in the upper left corner.

\*If it says "Disconnect", it means the camera has been connected to the printer.

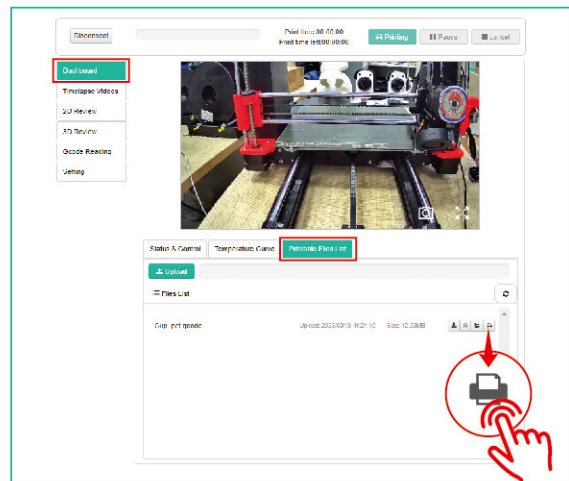

Then, on the Dashboard page, find "Printable Files List", click "Upload", select the G-code file to be uploaded, and click the  to start printing.

\*If your printer is an automatic bed leveling printer, please insert M420 S1 below G28 in the Star Gcode section of your slicing software to enable automatic bed leveling compensation.

On the Dashboard page, find the "Status & Control" page, where you can monitor the printing progress, such as the number of layers and height, and pause or cancel printing as needed.

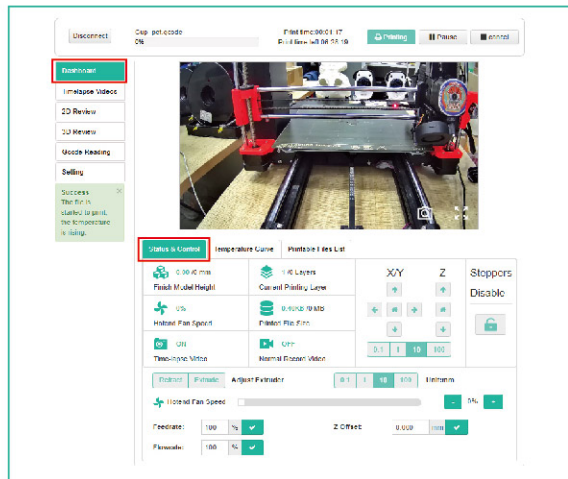

## CUSTOMER SUPPORT

Please visit the Minton official website for more machine usage and maintenance tutorials:



Join our Facebook group to communicate with us, our users, fans, and other members through Facebook.



### FB Group: Minton Official Group

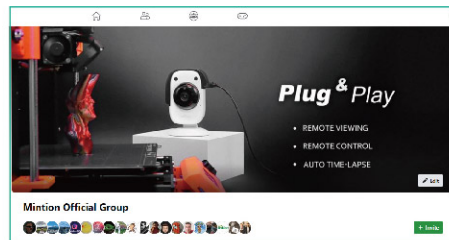

If you need human assistance, you can email: [support@minton.net](mailto:support@minton.net) and we will contact you within 24 hours.



## ATTENTION

Please **DO NOT** cut off the power of the Beagle V2 camera when it's connecting to the 3d printer on printing; **DO NOT** disconnect the camera from the printer when it is connected to the printer and transmit gcode files through the camera for printing. Otherwise, it will cause printing failure and damage the camera's firmware. In this case, the camera cannot work typically; this problem is the user problem, not a quality problem. Hence, please ensure that you cannot disconnect the camera from the power supply and the USB cable connected to the printer when the camera is working, and the 3d printer is printing.

The Beagle camera only supports one printer connection for control, allowing four users to simultaneously log in and access the camera (including mobile phone and computer users). Therefore, please make sure it's securely accessing the device to prevent bad guys from accessing the camera or printer and the environment to cause damage.

At the same time, we recommend that you do not let the 3d printer perform the 3d printing work completely unattended. Please come to the printer and watch the real printing progress of the printer regularly to prevent further deterioration of the situation when an abnormal condition occurs.

This camera shortens the distance between the user and the printer. The user is obliged to ensure the reasonableness and legality of the use of the product and avoid infringement of third-party rights, including but not limited to publicity rights, intellectual property rights, data rights, or privacy rights. At the same time, since the customers' use and storage of this camera are beyond our control, we are not responsible for possible personal injury or property loss.

This manual is for reference only. In any case, we have the right to modify and improve it without notifying users. If you want to know the latest instruction manual, you can go to the official website for more information.

## FCC WARNING STATEMENT

Changes or modifications not expressly approved by the party responsible for compliance could void the user's authority to operate the equipment. This equipment has been tested and found to comply with the limits for a Class B digital device, pursuant to Part 15 of the FCC Rules. These limits are designed to provide reasonable protection against harmful interference in a residential installation. This equipment generates uses and can radiate radio frequency energy and, if not installed and used in accordance with the instructions, may cause harmful interference to radio communications. However, there is no guarantee that interference will not occur in a particular installation. If this equipment does cause harmful interference to radio or television reception, which can be determined by turning the equipment off and on, the user is encouraged to try to correct the interference by one or more of the following measures: ealer or an experienced radio/TV technician for help.

- Reorient or relocate the receiving antenna.
- Increase the separation between the equipment and receiver.
- Connect the equipment into an outlet on a circuit different from that to which the receiver is connected.
- Consult the dealer or an experienced radio/TV technician for help.

## FCC RADIATION EXPOSURE STATEMENT

The antennas used for this transmitter must be installed to provide a separation distance of at least 20 cm from all persons and must not be co - located for operating in conjunction with any other antenna or transmitter.



## SPECIFICATION

Model	Beagle V2
Video Compression	H.264/MJPEG
Video Resolution	1080P
Night Version	Yes
Frame Rate	Up to 25fps
Auto Time-lapse Video	Yes
WiFi Connectivity	Supports 2.4GHz/5GHz
Compatibility	Marlin 3D Printers
Connect to Printer	USB Cable
Files Storage	Micro SD Card
Power Source	Plug-in
Lens Adjustable	Manual Knob
1/4" Screw for Tripod	Yes

This device complies with part 15 of the FCC Rules. Operation is subject to the following two conditions: (1) This device may not cause harmful interference, and (2) this device must accept any interference received, including interference that may cause undesired operation.

Any Changes or modifications not expressly approved by the party responsible for compliance could void the user's authority to operate the equipment.

**Note:** This equipment has been tested and found to comply with the limits for a Class B digital device, pursuant to part 15 of the FCC Rules. These limits are designed to provide reasonable protection against harmful interference in a residential installation. This equipment generates uses and can radiate radio frequency energy and, if not installed and used in accordance with the instructions, may cause harmful interference to radio communications. However, there is no guarantee that interference will not occur in a particular installation. If this equipment does cause harmful interference to radio or television reception, which can be determined by turning the equipment off and on, the user is encouraged to try to correct the interference by one or more of the following measures:

- Reorient or relocate the receiving antenna.
- Increase the separation between the equipment and receiver.
- Connect the equipment into an outlet on a circuit different from that to which the receiver is connected.
- Consult the dealer or an experienced radio/TV technician for help.

This equipment complies with FCC radiation exposure limits set forth for an uncontrolled environment. This equipment should be installed and operated with minimum distance 20cm between the radiator & your body.