

AirCraft

POWERGLIDE

Cordless hard floor cleaner

Welcome

Thank you for purchasing this **AirCraft POWERGLIDE** hard floor cleaner.

Please read the following important Safety Advice:

- This appliance is for domestic, indoor use only.
- **POWERGLIDE** is not intended for use by persons (including children) with reduced physical, sensory or mental capabilities, or lack of experience and knowledge, unless supervised or instructed by a person responsible for their safety.
- Do not expose the electronics of your **POWERGLIDE**, or attempt to open the Battery Pack. There are no user serviceable parts inside. Refer servicing to qualified service agents.
- Please ensure voltage rating for the Charger matches your outlet voltage.
- Before using, remove any items that could become entangled in the rotating discs. Pick up objects like clothing, loose papers, cords, cables, and any fragile objects.
- Do not use to clean volatile liquids such as petrol or white spirit.
- Remove the Battery Pack if not in use for extended periods.
- Only use the the Battery Pack and AC Power Adaptor supplied, or an original replacement. Visit AirCraftVacuums.com for original replacement parts and accessories.
- Do not handle the Power Adaptor plug or power cable with wet hands.
- Disconnect from the Charger and remove the Battery Pack before cleaning.
- Operate in room temperature environments only.
- Only suitable for use on smooth (free from protruding screws etc) hard floors, such as tiles, stone, laminate, wooden floors or vinyl.
- Do not submerge in water or any other liquid.
- Do not touch the rotating discs during operation.
- Always apply Pads to rotating discs before use.
- Avoid using excess waxing oil or cleaning solution as this may cause floors to become slippery.
- Avoid operating continuously for over 20 minutes as this may cause overheating.
- For technical assistance, please contact us via support@aircraftvacuums.com.

POWERGLIDE



Getting Started

Inside the box with your **POWERGLIDE** and Battery Pack you will find:

- 2 Pink Pads
- 2 Blue Pads
- AC Charging Adaptor
- Top-up Cup
- 2 x AAA batteries (inside Handle, in protective plastic wrapping)

Assembly

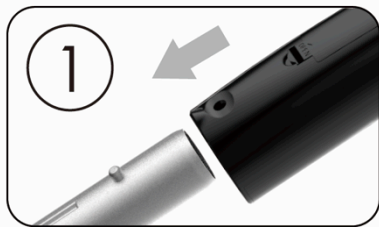

Insert the top of the aluminium tube into the Handle, until the ball spring clicks into place.



Insert the bottom of the aluminium tube into the base of your POWERGLIDE until the ball spring clicks into place.

Before starting, please ensure that:

1. Your **POWERGLIDE** Battery Pack is charged using the included AC Charging Adaptor; and
2. The 2 x AAA batteries have been unwrapped from their plastic covering and have been correctly fitted in the handle.

Let's Glide!

1. Select your Pads: for general cleaning, we recommend using either the pink or blue Pads. For the application of a wax or oil-based solution on a wooden floor, or for a brilliant finish on high gloss floors, please use the blue Pads.



Cleaning Pads



Cleaning /
Polishing Pads

Pads are self-attaching using velcro, and may simply be applied onto the two rotating discs, with the coloured side (pink or blue) facing the floor.

Pads may be machine- or hand-washed as often as required. Additional or replacement Pads are available from AirCraftVacuums.com.

2. Use the Top-up Cup to fill **POWERGLIDE**'s tank (capacity is 300ml) with water via the Water Inlet; you may also use a liquid floor cleaner (please dilute exactly as per the directions on the label of your chosen cleaner, to avoid any blockages of the nozzle).

*You may alternatively choose to spray floors directly with water, cleaning solution or liquid wax before going over with your **POWERGLIDE**, using a spray bottle. Do not dispense wax or polishing solution into the tank itself.*

3. Ensure 2 x AAA batteries are fitted to the handle, and that the main Battery Pack is charged and fitted. Press the **Power Switch (foot pedal)** on the base of your **POWERGLIDE**. The white LED headlights on the base will illuminate.

*If left idle for 10 minutes, **POWERGLIDE** will automatically enter Sleep mode. To re-awaken, press on the Power Switch pedal twice.*

4. Press the **Start/Stop** button on the handle to begin cleaning.

5. Press the **Spray** button on the Handle to apply liquid to your floor surface, sufficient to keep the Pads damp.

6. Guide **POWERGLIDE** by turning your wrist to easily steer to the left and right, cleaning and buffing as you go. Spray and then hover over any stains, to let the rotating Pads do the hard work. Simply guide over the same area after spraying to dry and buff. Play Clean!

Charging

Use **only** the AC Power Adaptor supplied with your **POWERGLIDE**.

There are three levels of battery capacity, as indicated on the detachable Battery Pack when connected to the Power Adaptor. Please charge the Battery Pack when you see one blue light flashing on it when using your **POWERGLIDE**.

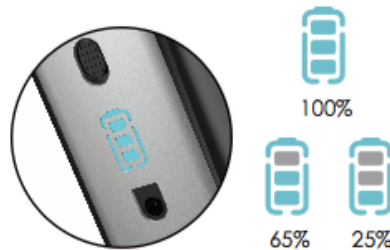

POWERGLIDE will not operate whilst connected to the Power Adaptor. This is a safety feature.

We recommend charging the Battery Pack whilst detached from your **POWERGLIDE**. Charge time is approximately 2 hours. Please disconnect the Battery Pack from the Power Adaptor once charged (when 3 solid blue lights are visible on the Battery Pack).

***Important:** Use only the original **AirCraft** AC Power Adaptor supplied, or a replacement from an authorized **AirCraft** retailer. Using any other type of Power Adaptor will damage the Battery Pack.*

Storage and Maintenance

To ensure best performance, it is recommended that your **POWERGLIDE** is regularly cleaned and maintained. You can clean the exterior of your **POWERGLIDE** using a soft, damp cloth. Pads may be machine-washed (at 30°, *without* fabric softener) or hand-washed. Please rinse the spray nozzle through with clean, fresh water each week to prevent blockages.

Please empty the water tank and remove the Battery Pack when storing. We recommend storing the Battery Pack with at least 65% charge to prolongue its lifespan.

Additional or replacement Pads and Battery Packs are available from AirCraftVacuums.com.

Troubleshooting

Symptom	Cause	Solution
No reaction to pressing buttons on handle	AAA batteries in handle not present or expired	Install fresh AAA batteries into handle
	Main Power turned off	Press Foot Switch on base
Spray not functioning	Lack of liquid in tank	Fill tank with liquid
	Air blockage in pipe	Press spray button several times to expel air
Uneven spray	Spray nozzle blocked	Fill tank with clean hot water and spray through
Nozzle drips when spraying	Nozzle blockage from cleaning solution	Rinse nozzle through with clean warm water
Battery LED lit, spray functioning but discs not rotating	Self-protection circuit engaged	Allow to cool before re-starting
		Remove Battery Pack, reinsert and re-start
One single light flashing on Battery Pack	Low power	Charge Battery Pack

Technical Specifications

- Rated Voltage: 14.4v
- Rated Power: 60w
- Rechargeable Battery Pack: Lithium 2550mAh (36.72Wh)
- Charge Time: 2 hrs
- Operating Time: 30 minutes
- Remote battery type: 2 x AAA (alkaline recommended)
- Remote frequency: 2.4Ghz
- Dimensions: 122 x 39 x 8.5cm
- Net Weight: 3.2kg
- Tank Capacity: 300ml
- Noise level: <60dB

POWERGLIDE has been awarded a Quiet Mark™. Quiet Mark is the International award programme for low-noise, high performance technology and solutions to combat global noise pollution. For more information please see www.quietmark.com.



Guarantee

We hope that you are delighted with this product. We aim to provide the best possible standard of customer care.

We support this product with a 12-month guarantee from the date of delivery, with the exception of the Battery Pack, which carries a guarantee period of 6 months, and the Pads, which carry a guarantee of 3 months. Guarantees are valid only if the product has been properly maintained and is used for domestic purposes, in line with this User Guide, and has received only manufacturer-authorised repairs, servicing or alterations. It excludes defects arising from fair wear and tear.

Please see AirCraftVacuums.com for full terms and conditions.

Under-guarantee products that meet these conditions and that function improperly will be repaired or replaced at our sole discretion. It is your responsibility to securely package items for their safe return to us using a trackable service. Not doing so will void your guarantee.

We may be contacted at support@AirCraftVacuums.com.

AirCraft disclaims any liability for incidental or consequential damages. Your statutory rights are not affected.

Correct Disposal (Waste, Electrical & Electronic Equipment)



This symbol means that according to local laws and regulations your product and/or its battery shall be disposed of separately from general household waste. When this product reaches its end of life, contact your supplier or take it to a collection point designated by local authorities. The separate collection and recycling of your product and/or its battery at the time of disposal will help conserve natural resources and ensure that it is recycled in a manner that protects human health and the environment.

AirCraft

AirCraftVacuums.com

Customer services: support@aircraftvacuums.com

© 2020 AirCraft Home. All rights reserved.