



Lumary

USER MANUAL

Specifications

Color	RGB
Power supply	USB
Input voltage	5V
Control method	Remote/App Control/Control Box
Working temperature	-20℃-60℃
Special features	Dimmable/16 Million Colors/Timing/Music Sync

Dimmable, 16 Million Color, Music Sync, App Control, Local control.



Please note that **all colorful lights** cannot be DIY cut!

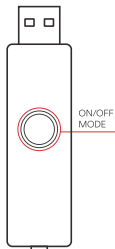

1. Quickly double-click the button to control the on/off of the light string.
2. Long press the button for three seconds, the color light, music, and scene modes will cycle in sequence.
3. In the color light mode, click the button to switch to the next color, and cycle in sequence; in the music mode, click the button to switch to the next music rhythm mode, cycle in sequence; in the scene mode, click the button to switch to the next scenes, loop in turn.

To activate pairing mode for the light, follow these steps:

1. If the light is off when powered on, press the button for 5s.
2. If the light is already on when powered on, press the button 5 times quickly.
3. If you're in the second scenario, press the button twice in a row to turn off the device first, and then use the 1 method.

IR Remote Controller 24KEY

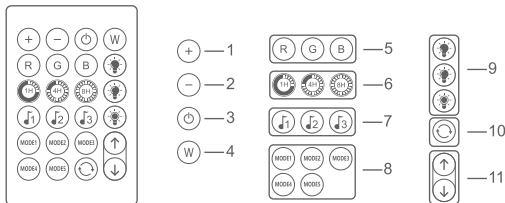

1. LED brightness adjustment button[+], increase sensitivity in music mode.
2. LED brightness adjustment button[-], reduce sensitivity in music mode.
3. ON/OFF button.
4. LED white button [switch between cold and warm white colors].
4. LED white button [switch between cold and warm white colors].
5. LED color buttons! Red, green, blue, 3 colors.
6. Timing function ON/OFF lights: 1 hour, 4 hours, 8 hours.
7. 3 music modes.

- | |
|---|
| 8. 5 fixed colorful scene modes. mode |
| 9. Brightness button: 25%, 50%, 100% from top to bottom. |
| 10. Scene mode loop, switching every 30 seconds. |
| 11. Switch the mode of light forward or backward in the scene or monochrome mode. |

Please pull out the plastic tab from the bottom of the IR remote to ensure that the battery is powered properly.

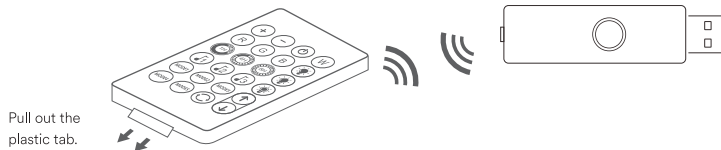

Make sure the IR remote aims at the IR receiver within the sensing distance. The angle of the IR receiver is 120° and the sensing distance is 16.4 ft. Please use the remote control within the sensing range.

Setting Lumary App

1. Download the "Lumary" App from App Store or Google Play Market, or scan the QR code and install the "Lumary" for either iOS or Android.



2. Register a Lumary account.

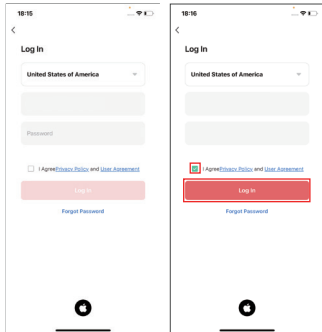

Enter your email address.

Log into the App.

Note: Please select your region and country.

3. Connect

To activate pairing mode for the light, follow these steps:

1. If the light is off when powered on, press the button for 5s.
2. If the light is already on when powered on, press the button 5 times quickly.
3. If you're in the second scenario, press the button twice in a row to turn off the device first, and then use the 1 method.

Steps:

1. Advised to enable Bluetooth;
2. Each time the device without distribution network is powered on, confirm the light is pairing mode;
3. Open the Lumary App, In the top corner of the Devices screen, click "+" and select "Add Device" to confirm that the device is paired.

If not, you need hold light controller button for 5s ensure the light is pairing mode.

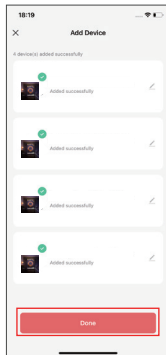
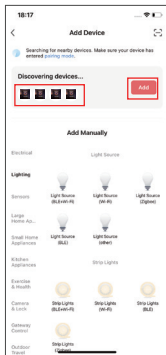
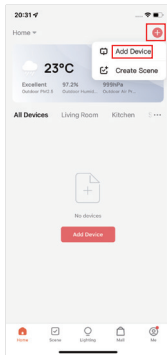

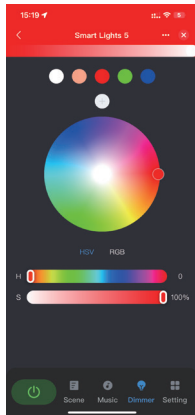
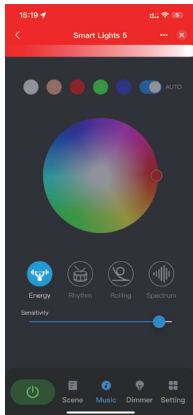
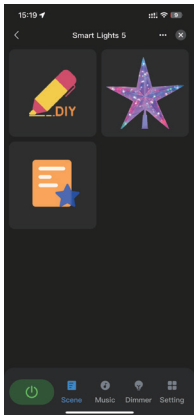

Light string can provide 16 million kinds of colorful light with 7 single colors, more than 80 kinds of scenes, 4 kinds of music modes, customizable DIY, scene modes in mobile App. The light controller has a built-in highly sensitive microphone, which can make the light of the light change with the surrounding sound, open the favorite song list, the light will move with the music, and make a better atmosphere for the party. The control of the lights is diverse and simple, the remote control can quickly adjust the lights, both thought that is obtained; mobile App can be more refined adjustment of the lights, while the buttons on the controller allow you to cope with a variety of unexpected situations. The light has memory function, after closing and turning on again, the curtain light is still the last set light, with the timer function, you can let the curtain light up your favorite light at any time.

FCC ID:2AKBP-HELLOFAIRY

Made in China



RoHS



VOICE CONTROL GUIDE

If you want voice control, you'll need to purchase a separate gateway. Then, the device can be linked with the gateway to support this feature.

Name and Control Each Device by Voice



Work With Amazon Alexa

1. Log in to Lumary App, tap the smart device and enter into, click "✎" in the top right corner.
2. Tap "Alexa" in Third-party Control.
3. Tap "Sign In With Amazon".

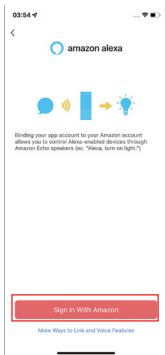
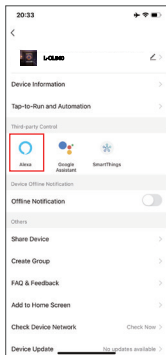

4. Tap "Allow";
5. Linked successfully, when add new device, there is no need to link again, just discover new device in Alexa.

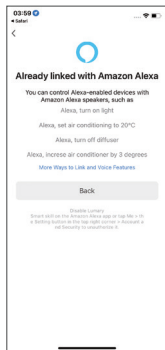



To control your Lumary smart device, just ask Alexa.

Make sure your devices are already set up using the Lumary app.

Things you can say*:

"Alexa, discover my devices."

"Alexa, turn on the bedroom light."

"Alexa, set the bedroom light to orange."

"Alexa, turn off the coffee machine."

"Alexa, set the living room to 50%."

"Alexa, dim porch light."

*Some commands require compatible devices.

Work With Google Assistant

1. Log in to Lumary App, tap the smart device and enter into, click "⌵" in the top right corner.
2. Tap "Google Assistant" in Third-party Control.
3. Tap "Link with Google Assistant".

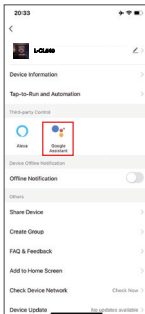

4. Click "Agree and link";
5. Linked successfully, when add new device, there is no need to link again, just discover new device in Google Home.

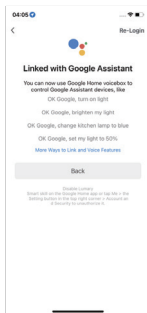
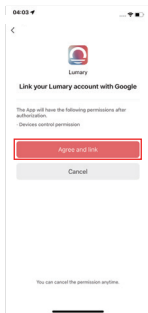

To control your Lumary smart device, just say "Hey Google", and ask.

Make sure your devices are already set up using the Lumary app.

Things you can say*:

"Hey Google, turn on all the lights in my bedroom."

"Hey Google, turn off the light."

"Hey Google, set the bedroom light to orange."

"Hey Google, turn off the coffee machine."

"Hey Google, set the living room to 50%."

"Hey Google, dim porch light."

*Some commands require compatible devices.

WARNING

INGESTION HAZARD: This product contains a button cell or coin battery.

DEATH or serious injury can occur if ingested.

A swallowed button cell or coin battery can cause Internal Chemical

Burns in as little as 2 hours.

KEEP new and used batteries OUT OF REACH OF CHILDREN.

Seek immediate medical attention if a battery is suspected to be swallowed or inserted inside any part of the body.



REQUIREMENTS FOR CONSUMER PRODUCTS CONTAINING BUTTON CELL OR COIN BATTERIES:

- [a]. The statement "Remove and immediately recycle or dispose of used batteries according to local regulations and keep away from children. Do NOT dispose of batteries in household trash or incinerate."
- [b]. The statement "Even used batteries may cause severe injury or death."
- [c]. The statement "Call a local poison control center for treatment information."
- [d]. A statement indicating the compatible battery type [e.g, LR44, CR2025].
- [e]. A statement indicating the nominal battery voltage.[3V]

[f]. The statement "Non-rechargeable batteries are not to be recharged."

[g]. The statement "Do NOT force discharge, recharge, disassemble, heat above [manufacturer's specified temperature rating) or incinerate. Doing so may result in injury due to venting, leakage or explosion resulting in chemical burns.

Products with replaceable button/coin cell batteries shall additionally include:

[a]. The statement "Ensure the batteries are installed correctly according to polarity [+ and -]."

[b]. The statement "Do not mix old and new batteries, different brands or types of batteries, such as alkaline, carbon-zinc, or rechargeable batteries."

[c]. The statement "Remove and immediately recycle or dispose of batteries from equipment not used for an extended period of time according to local regulations."

[d]. The statement "Always completely secure the battery compartment. If the battery compartment does not close securely, stop using the product, remove the batteries, and keep them away from children."

Can't connect? Need help?



HAVING AN EASY TALK TO US BEFORE YOU RETURN
THE PRODUCT WILL FIX A PROBLEM MORE QUICKLY

Lumary support:

support@Lumary.tech

Visit us at:

www.lumary.tech

www.lumarysmart.com