

Inverter Air Conditioner **Indoor/Outdoor Units Disassembly Manual**

Models:

| | |
|-----------------------|-----------------------|
| RYT009GLSI24RL | RYT012GLSI24RL |
| RYT018GLSI24RL | RYT024GLSI24RL |

Duct (IDU) Disassembly

Indoor Unit Model Numbers: RT009GLSILCFHG | RT012GLSILCFHG | RT018GLSILCFHG | RT024GLSILSFHG

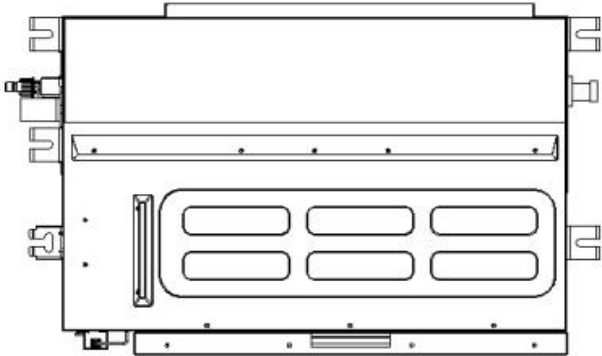
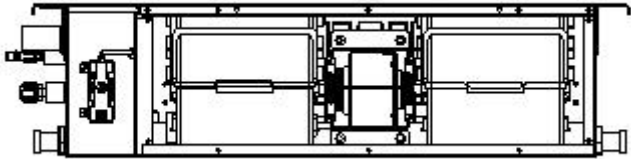
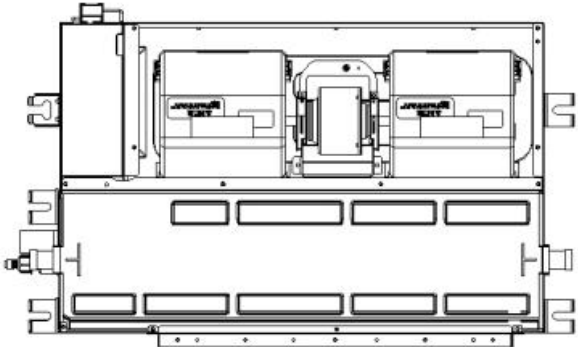
| Steps | Reference Photo |
|---|--|
| <p>Before disassembly</p> |  |
| <p>1. Disassemble the filter assembly</p> | |
| <p>A. Disassemble the filter assembly. B. Remove the filter.</p> |  |
| <p>2. Disassemble the base part and air return plate</p> | |
| <p>A. Remove the base part by unfixing the screws on the left and right side panels, as well as the center partition. B. Remove the screws between the air return plate, left side plate, and electric control box. Then, remove the air return plate. C. Remove the Wi-Fi fixing cover and take the USB connection cable out.</p> |  |

3. Disassemble the front panel assembly

Unfix the screws on the front panel and remove the assembly.

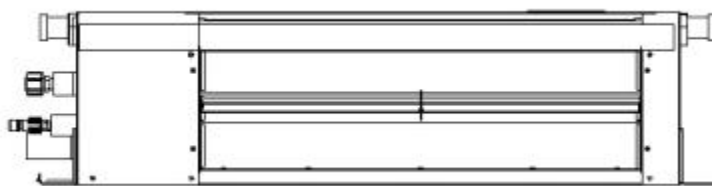
**4. Remove the electrical box cover and hooks**

A. Unfix the screws on the electrical box cover and remove the cover.

B. Unfix the screws on the hooks, then remove the hooks.

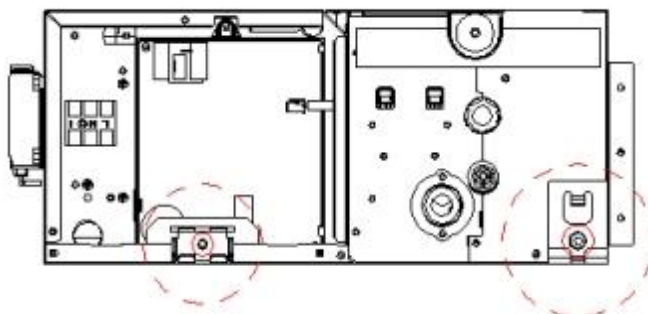
**5. Remove the electric control box assembly**

Unfix the screws on the electric control box, then remove the electric control box.

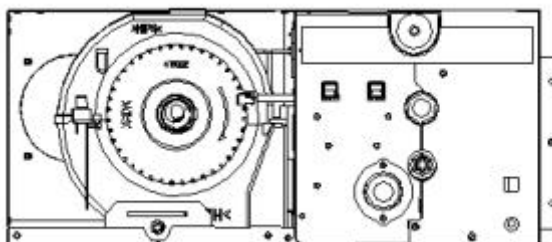
**6. Remove the water tray assembly**

A. Remove the base plate.

B. Lift the drain nozzles up on both sides to take the water tray out.

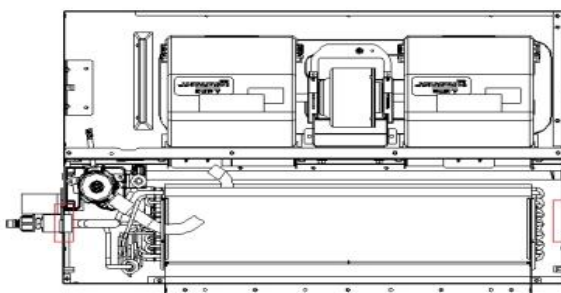

7. Disassemble the right side plate and drainage mounting assembly

A. Unfix the screws between the right side plate, evaporator end plate, top plate, and drain mounting assembly. Then, remove the right side plate.

B. Remove the drain nozzle on the drain mounting assembly, then take the assembly out.

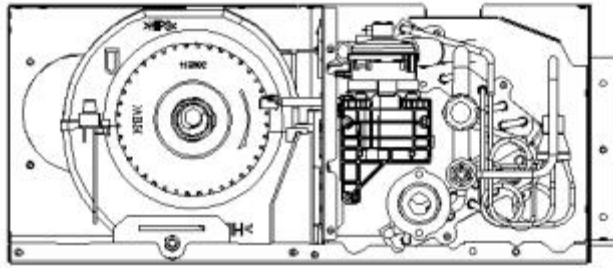
**8. Remove the water pump assembly, evaporator module, and left side panel parts**

A. Unfix the screws on the water pump assembly and center divider. Then, remove the water pump assembly.

B. Unfix the screws on the evaporator module and left side panel assembly. Then, take the left side panel out.

C. Unfix the screws on the left side panel part, top panel, and center partition. Remove the left side panel part.

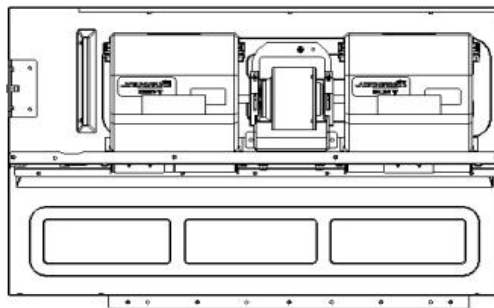
**9. Remove the centrifugal fan volute assembly and DC motor**

Remove the motor limit clasp, then take the volute assembly and DC motor out in the direction shown in the reference photo.

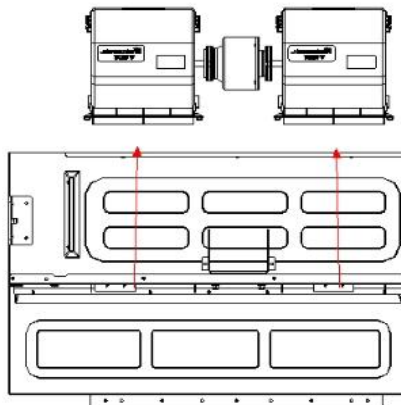
**10. Remove the center divider assembly**

Unfix the screws on the center divider assembly and top cover. Remove the center divider.

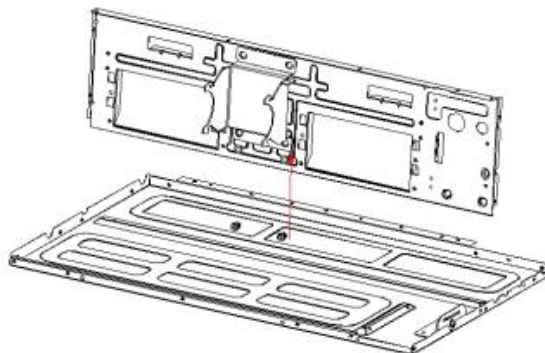

ODU Disassembly

Outdoor Unit Model Numbers: YN009GLSI24RPG | YN012GLSI24RPG | YN018GLSI24RPG | YN024GLSI24RPG

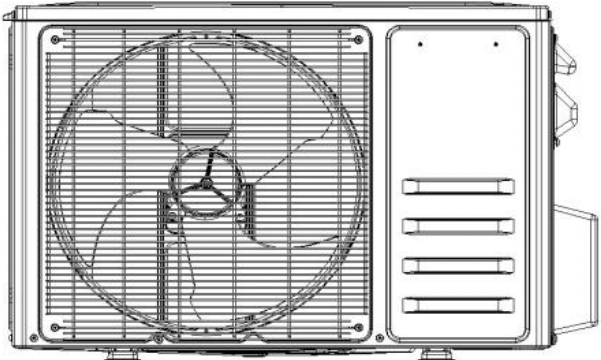
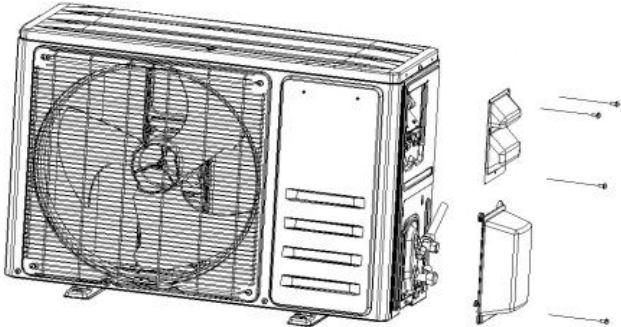
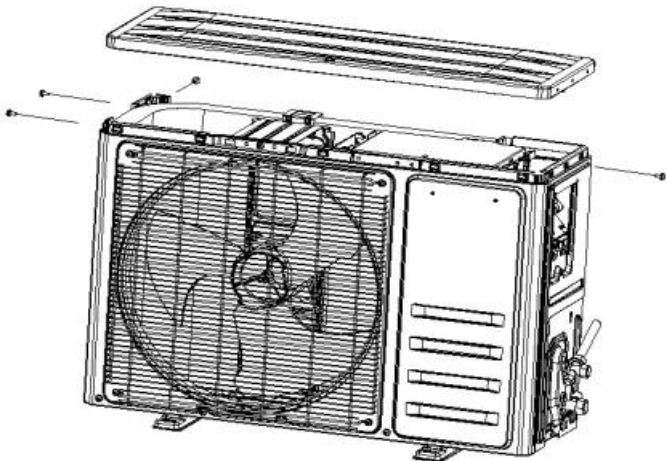
| Steps | Reference Photo |
|--|--|
| <p>Before disassembly</p> |  |
| <p>1: Remove the PCB cover, valve cover, and top cover</p> | |
| <p>A</p> <p>1). Unfix 1 screw on the PCB cover, then you can remove the cover from the unit.</p> <p>2). Unfix 1 screw on the valve cover, and then you can take it out.</p> |  |
| <p>B</p> <p>Unfix the screws on the top/left/right plates, and then you can take the top cover off.</p> |  |

8" 8lgUggYa V'Y'H Y'ZUb' i UfX'UbX'ZcbhdUbY

5

Remove the grille screws from the front panel, then take out the grille.

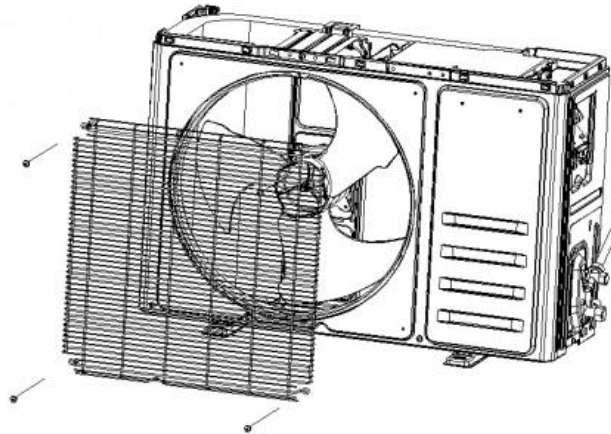

B

Unfix the screws on the front panel of the fan guard.

Separate the ODU middle plate and base plate. Lift the front panel so you can take it out from the unit.

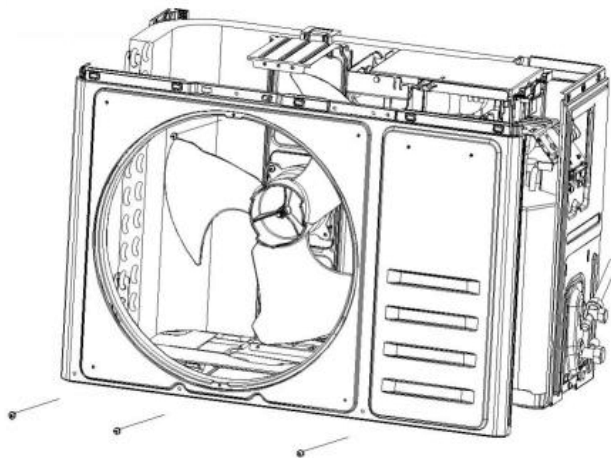

' " 8lgUggYa V'Y'H Y'ZUbX'f i \ Hd'UfY

5

Unfix the screws on the right plate, electric box assembly, valve plate, and base plate. You can then remove the right plate.

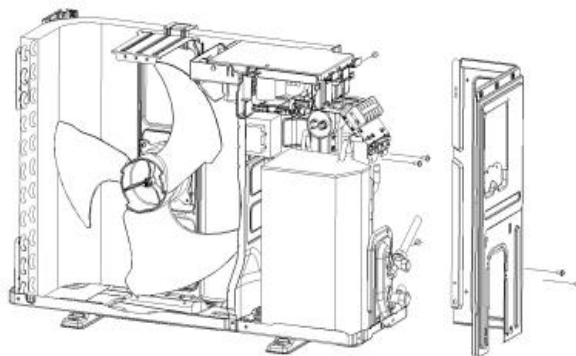

B

Unfix the screws on the left plate, base plate, and condenser plate. You can then take the left plate out.

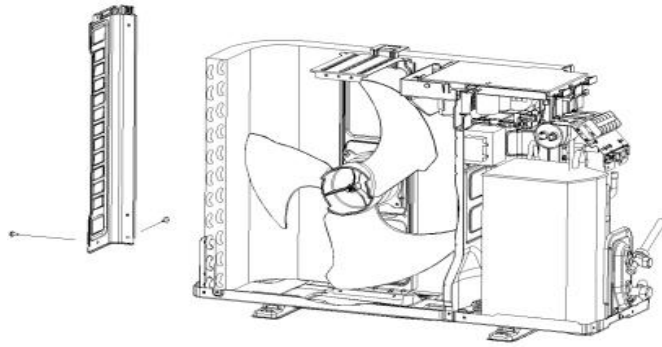

4. Disassemble the axis fan blade

A

Unscrew the fan blade nut. Remove the blade.

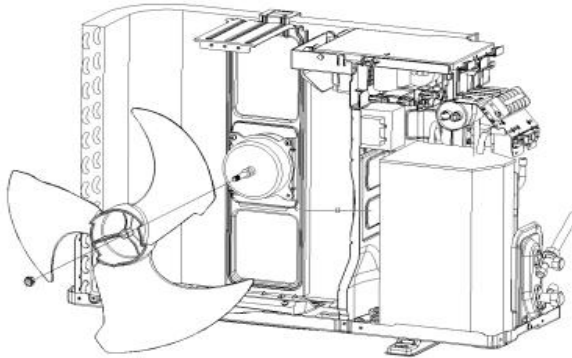

5. Disassemble the electric box

A

Unfix the screws on the electric box and motor supporter. Loosen the wiring clamp, then you can take the control box out.

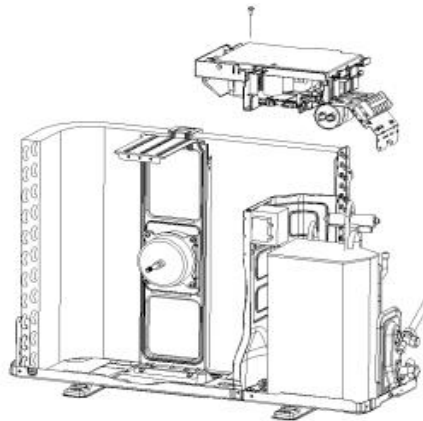

6. Remove the noise cotton**A**

Take the cotton out, as shown in the picture.

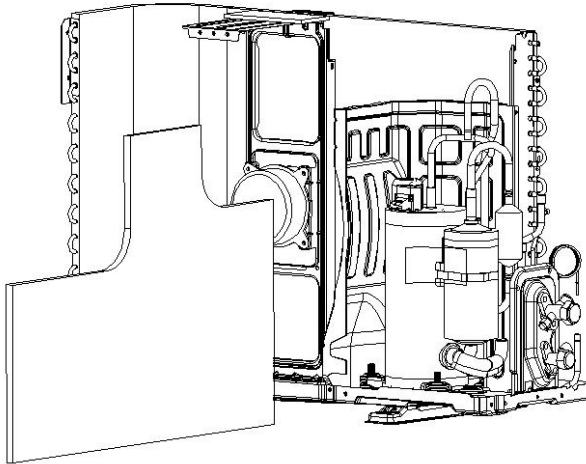
**7. Disassemble the separate plate****A**

Unfix the screw on the separate plate and unit, then take it out.

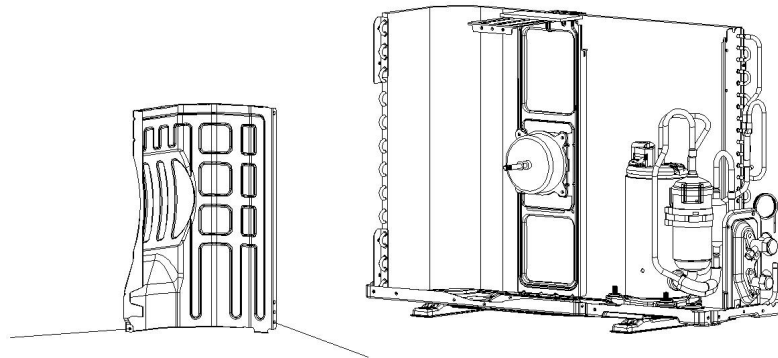
**8. Disassemble the 2-way and 3-way valve****A**

Unfix the screws on the valve plate and base. You can take the 2-way and 3-way valve out by welding.

Note:
1). Welding can only occur while there is no gas in the unit.
2). Pay attention to the fire to prevent any injury.

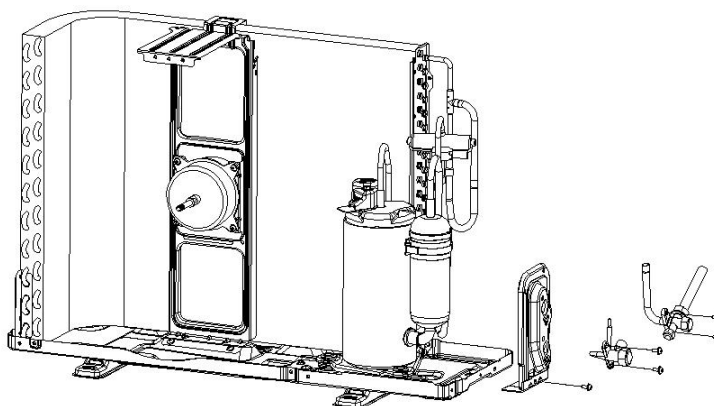

9. Disassemble the 4-way valve assembly**A**

Remove the 4-way valve from the system by welding. Ensure there is no damage to the compressor, nameplate, etc.

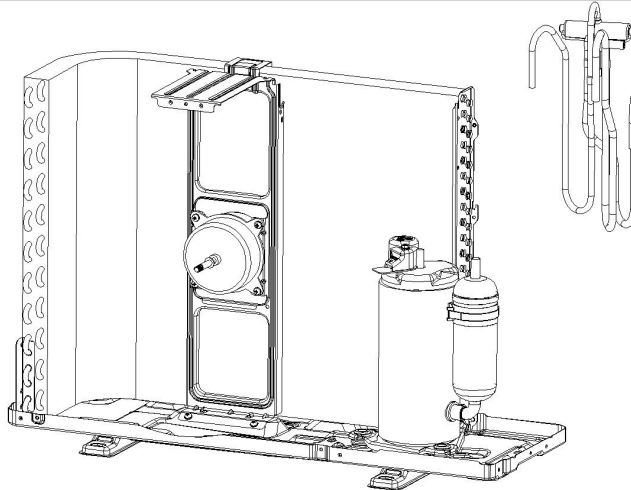
**10. Disassemble the compressor****A**

Unscrew the nuts and remove the compressor.

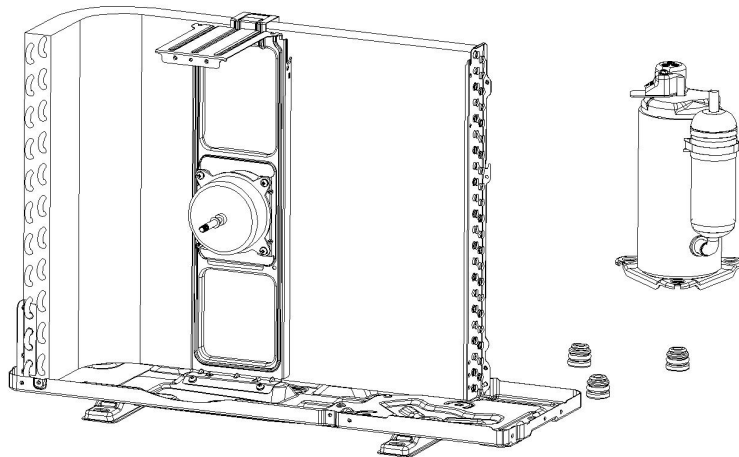
**11. Remove the fan motor and fan supporter****A**

Unfix the screws on the fan motor and supporter, then remove the supporter of the base plate.

Note:
Pay attention to the motor wiring. It can't be taken out by force.

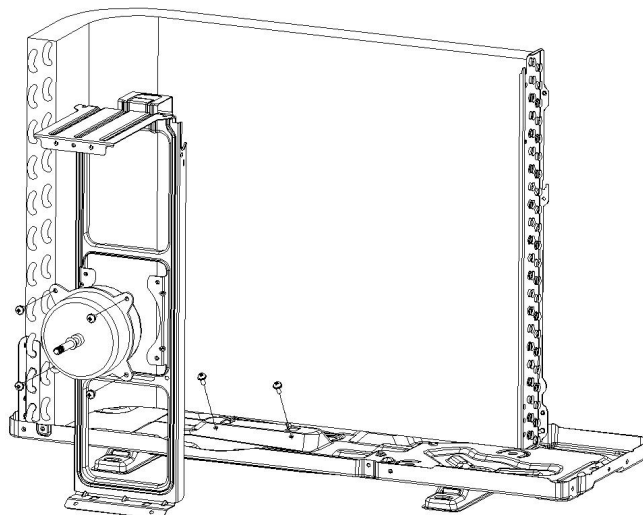

The design and specifications of this product are subject to change without prior notice as development continues. Consult with the sales agency or manufacturer for details. Refer to the equipment nameplate for all other applicable specifications.



is a registered trademark of Parker Davis HVAC International, LLC.

Parker Davis HVAC International
7290 NW 77 Court, Miami, FL 33166 - USA
Tel : (305) 513-4488
Fax : (305) 513-4499
E-mail : info@pdhvac.com
Website: www.pdhvac.com

Pioneer product line, parts, and supplies are
available online for convenient ordering at:
www.highseer.com
www.pioneerminisplit.com

Scan the below code to visit our support page
where you can find more installation materials:

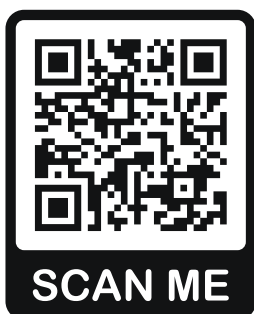

Copyright © Parker Davis HVAC International, LLC. All rights reserved.
