

**Exhibit N: User Manual**

**FCC ID: CGGAA2**

# Sentrol RCR

## Range-Controlled Radar Detector

Model: RCR-50

### Installation Instructions



## Description Preliminary

The RCR detector combines range-controlled radar (RCR) technology with a passive infrared (PIR) system to increase false alarm immunity by allowing it to sense human-sized objects within a specified range. Both the RCR and PIR systems must be triggered to set off an alarm, unless in radar only mode.

The detector is designed to use a 12VDC power supply provided by a UL Listed alarm control panel.

## Features

The detector provides the following features:

- **High-security mode** - Internal jumper allows you to disable the PIR, and use the radar only mode to detect intruders faster. This mode can be used for covert installations (mounted behind ceiling panels or walls).
- **Selectable range up to 50 feet (15.2m)** - Internal jumper allows radar range selection to optimize coverage.
- **LED indicator** - A multi-color LED provides detector status.
- **Tamper switch** - Activated when the pins on the circuit board are removed from the terminal sockets on the base.

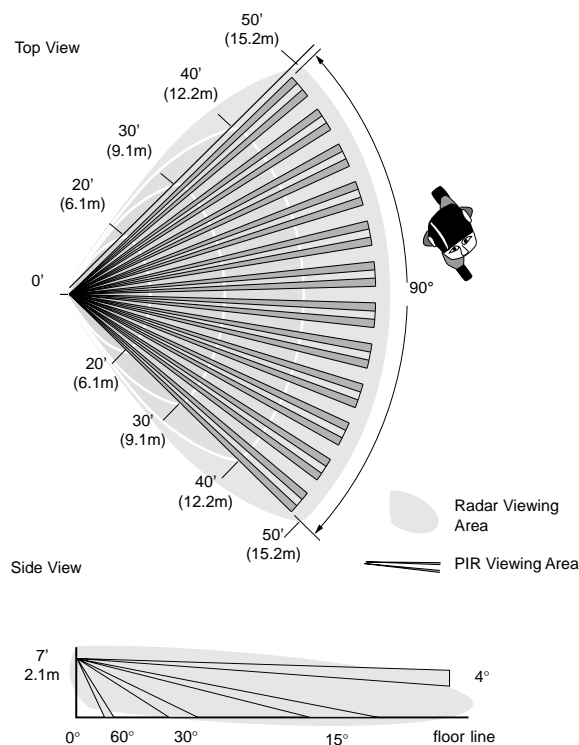

Figure 1. Coverage Patterns

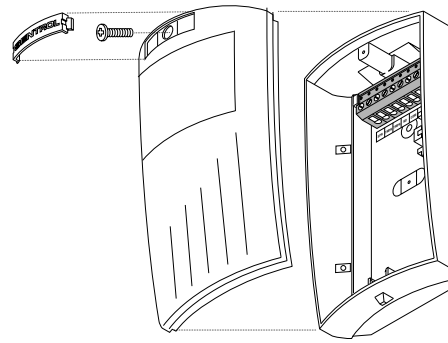

Figure 2. Detector (Exploded)

## Parts

The following parts are included with the detector:

- RCR detector
- 1 screw to join the case halves
- 3 factory-installed jumpers

## Selecting a Location for the Detector

The detector can be mounted in a corner or on a flat wall. Use the following guidelines to determine the best location to install the detector:

- Mount the detector so the expected movement of an intruder is across the detection pattern. See Figure 1.
- Mount the detector on a stable surface 7 to 9 feet (2.1 to 2.7m) high.
- DO NOT mount the detector within 2 feet (0.6m) of metallic objects or within 5 feet (1.5m) of florescent lights.
- DO NOT place objects in front of the detector that may prevent a clear line of sight. (Not applicable in radar only mode.)
- Avoid locations that expose the detector to possible false alarm sources such as:
  - Moving or vibrating objects (fans, pulleys, conveyor belts)
  - Electronic fields (electric motors, high voltage equipment)
  - Water spray or corrosive environments
  - Heat sources in the field of view (heaters, radiators)
  - Windows in the field of view
  - Strong air drafts on the detector (fans, air conditioners)
- When installing multiple detectors:
  - DO NOT mount detectors facing each other.
  - Mount them at least 20 feet (6.1m) apart.
  - Use shorter range settings to avoid overlapping radar coverage.
  - Mounting detectors back to back is not recommended, but if an application requires such mounting, use the 20-foot (6.1m) range and walk test the installation to ensure proper operation.

## Installing the Detector

All wiring must conform to the National Electric Code (NEC) and/or local codes having jurisdiction.

**Important: DO NOT use this device for safety interlock applications.**

To install the detector:

1. Run the security system wiring to the detector location.
2. To remove the front cover/electronic module, remove the nameplate and loosen the screw if necessary. To remove the nameplate, insert a small screwdriver into one of the nameplate side slots and gently push in and pry up with the screwdriver. See Figure 2. Then press down on the top of the front cover with one hand, while holding the sides at the top of the back cover and squeezing in and pulling back with the other hand.



### CAUTION

**You must be free of all static electricity before handling sensor circuit boards. Touch a grounded, bare metal surface before touching circuit boards or wear a grounding strap.**

3. If necessary, set the jumpers on the circuit board. See *Setting the Jumpers*.
4. Remove the appropriate wiring and mounting knockouts from the back cover. The detector can be mounted on a flat wall or in a corner. See Figure 3.
5. Pull the wires through the knockout holes and use screws to attach the base to the wall. Use screw anchors if necessary.
6. Strip 1/4 inch (6.4mm) of insulation from each wire.
7. Run each wire through the strain relief and under the appropriate screw terminals on the base and tighten the screws. See Figure 3.
8. Line up the tabs on the bottom of the cover/electronic module with the corresponding tabs on bottom of the base and snap the cover/electronic module firmly down onto the base.
9. Tighten the screw and replace the nameplate. See Figure 2.
10. Apply power. The green LED should light for approximately 25 seconds and then go out.
11. Walk test the coverage pattern as follows:
  - Walk throughout the intended coverage area.
  - Verify the detector alarms. See *Understanding the LED*.

### Note

Most units walk test more accurately if the person testing waits 10 seconds between tripping the unit and walking again. This allows the detector to stabilize between trips.

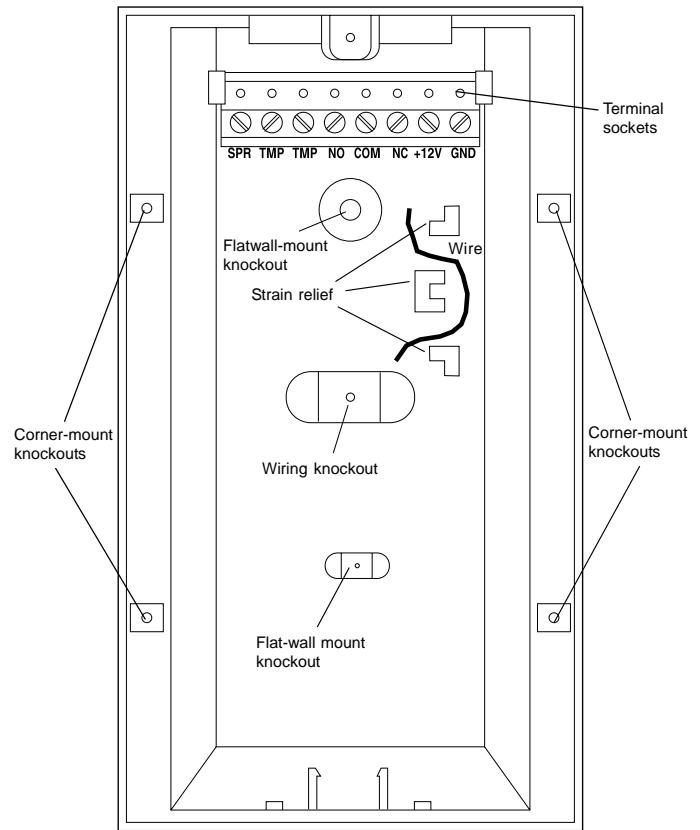

Figure 3. Detector Base

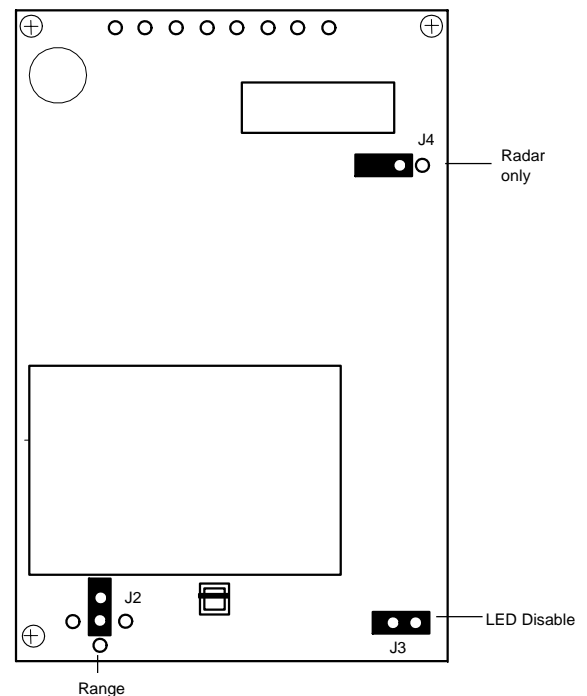
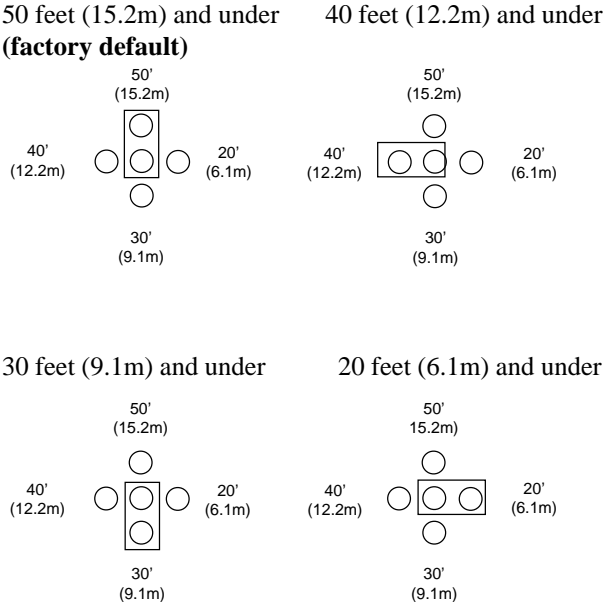

Figure 4. Main Circuit Board

# Setting the Jumpers

The detector provides jumpers to select the detection range and PIR and LED operation. See Figure 4.

**J2 Range** - Use the jumper to cover the center pin and the pin indicating the desired range. No jumper = 50 feet (15.2m) and under.



**Note**  
 You need to set J2 as close to the intended coverage range as possible. Overshooting the coverage area may cause false alarms.

## J3 LED -

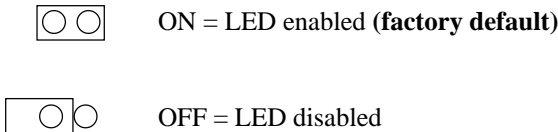

## J4 PIR -

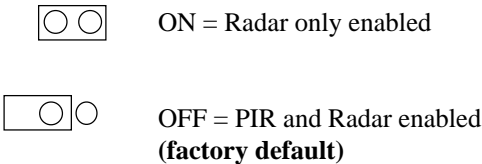

# SB01 Swivel-Mount Bracket

For ceiling-mount applications that require 90 degree coverage, an optional swivel-mount bracket (SB01) is available from GE Interlogix. See Figure 5.

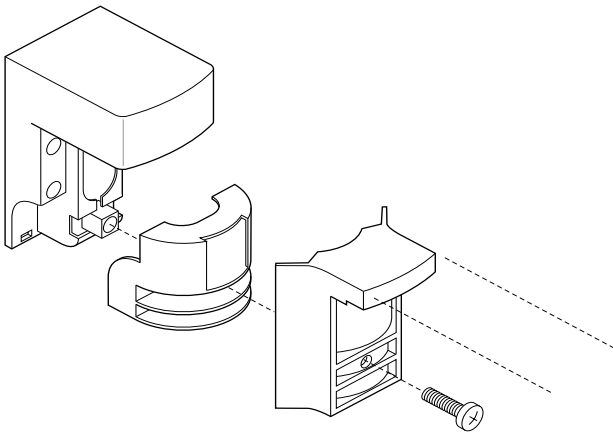

Figure 5. SBO1 Swivel-Mount Bracket

# Maintaining the Detector

When installed and used properly, the detector provides years of service with minimal maintenance. You should walk test the detector annually to ensure proper operation.

When the cover is removed, power is interrupted to the sensor. Once the cover has been replaced, the green LED will illuminate for 25 seconds while the sensor warms up. After the green LED goes off, wait one minute and walk test the sensor.

# Understanding the LED

The multi-color LED located on the bottom of the detector indicates the status of the unit as described in the following table.

LED	Status
Red	PIR and Radar detection. The detector is in alarm and the relay has switched.
Green	PIR detection only (no alarm).
Yellow	Radar detection only (no alarm).

## In Radar only mode:

LED	Status
Red	Radar detection.

## Specifications

Input voltage	8.5 to 18VDC (UL: 10 to 16VDC)
Typical current	20mA
Maximum current	27mA
Electrical configuration	Form C
Relay rating	28VDC, 100mA max.
Tamper	100ma, 40VDC
Detection range	50' (15.2m) x 90°
Target velocity	0.5 ft/sec to 5 ft/sec
Alarm duration	5 sec
Mounting height	7' to 9' (2.1m to 2.7m)
Operating temperature	32° F to 122° F (0° C to 50° C)
Relative humidity	5 to 93% non-condensing
Dimensions:	2.8" (7.1cm) W 5.1" (13cm) H 2.3" (5.7cm) D
Weight	6 oz (170g)
Color	white
Field wiring size	12-24 AWG
Microwave frequency	5.8GHz
Listing	C-UL US

## FCC Compliance

This device complies with Part 15 of the FCC rules. Operation is subject to the following three conditions:

- (1) This device may not cause harmful interference.
- (2) This device must accept any interference received, including interference that may cause undesired operation.
- (3) Changes or modifications not expressly approved by the party responsible for compliance could void the user's authority to operate the equipment.

**FCC ID:** CGGAA2

## Product Ordering

Model Number	Description
RCR-50	Range-controlled radar, passive infrared detector with form C relay, stealth mode, tamper contacts, 50 foot (15.2m) maximum range
<b>Accessories</b>	
SB01	Swivel-mount bracket



PH 503.692.4052  
USA & Canada: 800.547.2556  
Technical Service: 800.648.7424 FaxBack: 800.483.2495  
www.sentrol.com www.interlogixsecurity.com

©2001 Interlogix, Inc.  
Interlogix, Caddx, ESL, ITI and Sentrol are trademarks of Interlogix, Inc.  
All other trademarks are properties of their respective owners.

1036806 Rev A 04/02

Sentrol RCR-50