

User Guide

Bluetooth Ear Protector

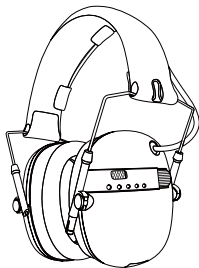

SPECIAL PIE TECHNOLOGY
 +86 134 2442 5927
 market@special314.com
 www.special314.com



SPECIAL PIE

Caution

Please do not cover your hands at the headset housing to avoid whistling.

Operation

1. Power On/Off

Power on: Long press the knob on the left side of the headset for 2 seconds, and then you will hear a "Power on" reminder sound.

Power off: Long press the knob on the left side of the headset for 2 seconds, and then you will hear a "Power off" reminder sound.

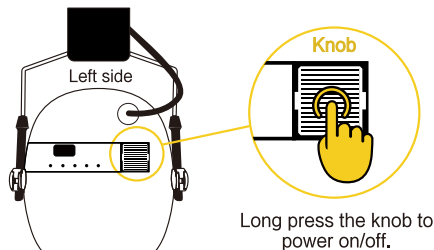

2. Automatic Shutdown

The headset has a vibration detection function. After 10 minutes of no operation or movement, the headset will automatically shut down to save power.

3. Volume Adjustment

It has 8-level adjustable microphone pickup volume.

Turn up the volume: Scroll the knob up

Turn down the volume: Scroll the knob down

There will be a reminder sound every time you turn the knob and there will be a long reminder sound when the maximum volume is reached.

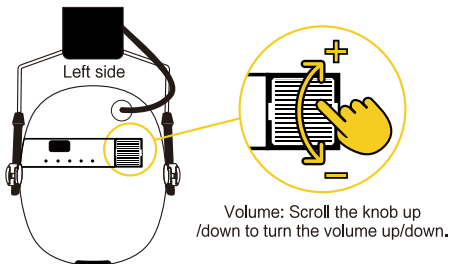

4. Indicator Light

Each time you operate the knob, the indicator lights on the left side of the headset will light up and be off after 5 seconds. The remaining battery level of the headset will be shown by the 5 lights on the left side of the headset. 1 light stands for 20% battery power. 5 lights on means full charge.

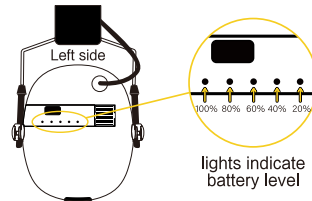

Function

1. Bluetooth Function

● Bluetooth Connection

Wear the headset and turn it on. For first-time Bluetooth pairing, press the knob twice quickly to switch on pairing. The left indicator light will flash rapidly, and you will hear a "Pairing" reminder sound. Then please turn on Bluetooth on your phone and select the Bluetooth name: "SPECIAL PIE HEADSET" on the cell phone to connect. Once connected, you will hear a "Connected" reminder sound. After a successful connection, the left indicator light will turn off.



If your cell phone has been paired with the headset, the next time you just need to turn on the Bluetooth on your cell phone and short press the headset knob once, and then the Bluetooth will be automatically connected and you will hear a "Connected" reminder sound.

● Bluetooth Disconnection

Method 1: Turn off the Bluetooth on your cell phone to disconnect, and then you will hear a "Disconnected" reminder sound.

Method 2: Short press the knob on the left side of the headset once.

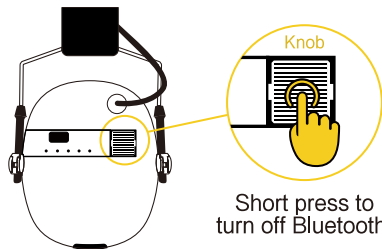

2. Entertainment and Communication

When Bluetooth is connected, the headset can be used for music playback and phone answer.

Music playback: Just operate the playback on your cell phone.

Phone answer: Short press the knob once to answer the call and short press once again to hang up.

When listening to music or answering a phone call, the Bluetooth function and the noise-cancelling pickup sound function will work simultaneously, allowing the user to be aware of their surroundings to ensure safety.

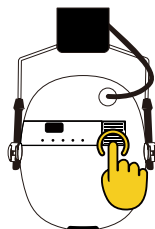

Short press to answer the call.
Short press again to hang up.

3. AUX Port

The headset is equipped with an AUX port at the bottom of the right side, and the rubber plug can be opened to connect a walkie-talkie or other audio devices.

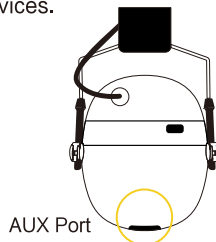

5. Foldable and Portable

The headset can be folded into a small size and hung on your belt by using the D-ring for carrying.

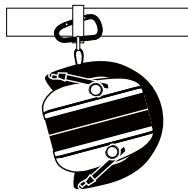

4. Charging Way

The headset is equipped with a type-C charging port at the bottom of the left side, and the rubber plug can be opened to charge. It can be used continuously for about 72 hours after a full charge.

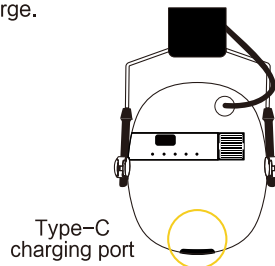

Warranty

If there is any quality problem (not caused by human damage), free warranty is provided within twelve (12) months from the purchase. If you have any quality problems within 30 days after receiving the product, please contact us. You have the right to choose to replace the product free of charge.

This warranty does not cover any failure due to abuse, mishandling, failure to follow operating instructions, uninstructed private disassembly or accident. For warranty service, please contact us to return the product and prepaid freight.



Scan the code to contact us for the after-sale service.
email: service@special314.com

FCC Statement

This device complies with part 15 of the FCC rules. Operation is subject to the following two conditions: (1) this device may not cause harmful interference, and (2) this device must accept any interference received, including interference that may cause undesired operation.

Changes or modifications not expressly approved by the party responsible for compliance could void the user's authority to operate the equipment.

NOTE: This equipment has been tested and found to comply with the limits for a Class B digital device, pursuant to part 15 of the FCC Rules. These limits are designed to provide reasonable protection against harmful interference in a residential installation. This equipment generates uses and can radiate radio frequency energy and, if not installed and used in accordance with the instructions, may cause harmful interference to radio communications. However, there is no guarantee that interference will not occur in a particular installation. If this equipment does cause harmful interference to radio or television reception, which can be determined by turning the equipment off and on, the user is encouraged to try to correct the interference by one or more of the following measures:

- Reorient or relocate the receiving antenna.
- Increase the separation between the equipment and receiver.
- Connect the equipment into an outlet on a circuit different from that to which the receiver is connected.
- Consult the dealer or an experienced radio/TV technician for help.

The device has been evaluated to meet general RF exposure requirement. The device can be used in portable exposure condition without restriction.