



INSTRUCTION MANUAL

ELECTRIC BICYCLE



www.actbestbike.com

service@actbest.net



Table of Contents

1. SERVICE
2. IMPORTANT SAFETY WARNING
3. POWER SUPPLY PRECAUTIONS
4. PRECAUTIONS FOR INSTALLATION
5. PACKAGE LIST
6. BICYCLE PARTS
7. ASSEMBLY
8. Boot Method
9. HANDLEBAR CONTROLS
10. OPERATIONS
11. TROUBLESHOOTING

SERVICE

IMPORTANT: FOR ACTBEST ONLY

For damaged or defective product, questions, replacement parts or any other service support, please contact our customer service department by the below methods:

service@actbest.net

Response Time: 24-48 hours. Please email us with the order number so we can offer more help and reply as soon as possible during peak business hours.

**PLEASE DO NOT RETURN THIS PRODUCT WITHOUT ASKING
OUR CUSTOMER SERVICE.**



Scan me to get the installation video

IMPORTANT SAFETY WARNING

Battery Care

+ Charge the battery indoors, in a dry location, and at room temperature as often as possible.

+ Regularly charge the battery when not using the ebike for prolonged periods of time.

- Do not let the battery completely drain when not used for prolonged periods of time.

+ Clean the battery with a damp cloth.

+ Remove the battery before cleaning the bike.

- Do not expose the battery to direct water contact when cleaning the battery.

- Do not expose the charged battery to high temperature (80 degrees+). Take it to a cooler place and/or drain the battery

Please turn off the battery power before folding

Procedure for charging the battery. Charging time is 5-6 hrs.

Note - The bike motor needs to be turned off.

1. Plug the charger power cord into a standard 110 volt outlet. (The charger light will turn red.)

2. Open the flap coving the plug receptacle on the battery.

3. Insert the charging cord into the battery receptacle. (The charge light remains red.) When the charger light turns green the battery has been charged.

4. When charged, first remove the charger power cord from the standard 110 volt outlet.

5. Next remove the charger cord from the battery receptacle.

6. Close the flap covering the battery receptacle.

7. If the battery has been removed from the bike, return it to the holder, inserting the bottom first and then snap it in place. Remove the key if it is still in the bike.

Charger Care

Do not store the charger outdoors or on a wet service.

Do not use with wet hands or in extreme humidity.

Do not use it with defective or damaged wires.

Do not place it in direct sunlight.

Do not use in flammable or explosive areas.

Do not drag it by the cord.

Do not cover the charger vent and keep it 10 cm or less from other objects.

Do not disassemble, repair, or modify the charger.

Always unblock it before attempting any cleaning, etc.

Always place it in a clean and ventilated area.

Always plug and unplug it holding the plug, not the cord.

For usage safety, please use the original battery power charger to charge the bike.

Riding:

Do not use it until you read the instructions carefully and understand the performance of the product; do not lend it to someone who can't manipulate the product for riding. Before riding the bicycle, check whether the brakes are working. Pay attention to the brake tightness. If the brake is too loose, use an Allen key to tighten it. Pay attention to increasing the braking distance when riding in rain or snow.

Applicable age: 16 to 65 years old.

Tips for Maximizing E-bike Range:

- Pedal more for greater distance, and try to avoid frequent stops and starts.
- Cold weather can decrease battery capacity, so keep this in mind when planning your trip.

- Wind can be a factor, with tailwinds helping you go further and headwinds reducing your range.

- Smoother terrain, such as paved roads, can help you travel further.

Proper bike maintenance, including tire pressure and battery care, will help maximize range.

Please be sure to wear a safety helmet when riding a bicycle, follow the traffic rules, and do not drive on motorized lanes and roads with many pedestrians. Please check the tire pressure before riding, the recommended tire pressure is 40 ~ 65PSI.

Downhill and non-paved roads do not exceed 15MPH.

-When using the motor, please be careful not to hit it vigorously and keep the rotating shaft lubricated.

Riding beyond the maximum load is not allowed.

After use, the car can not be parked in the building hall, evacuation stairs, safety exits, and must be parked correctly in accordance with the safety rules.

One-handed riding is prohibited!

Disclaimer:

After riding, please store the bike in a place without sunlight and rain, not in residential buildings; always check the motor and brake; check the screws and the places that need to be fastened regularly, and tighten them regularly. The front and rear wheels of the vehicle should be located in the center of the front fork or frame.

Always check the tire for scratches, cracks or excessive wear. The inner tube and the valve should be perpendicular to the wheel hub. Damaged or excessively worn tires need to be replaced immediately. Please find a professional technician to replace your tire. If your tire accidentally punctures and leaks, please contact a professional technician for repair or replacement.

Maintenance and care:

For the product model, specifications or related information mentioned in this User Manual, the company reserves the right of modification and final interpretation; the functions of the specific model mentioned in this User Manual are only applicable to that specific model.

The product models, specifications, or related information mentioned in the User Manual may be changed without notice; without prior written permission of the company, the User Manual may not be copied, modified, reproduced, transmitted, or published in any form. Please read the Manual carefully before using the product, and operate in accordance with the Manual, otherwise the company will not be liable for product damage or personal or property damage caused by improper use or error.

SAFETY CHECKLIST

Before first ride, it is important to carry out the following safety checks:

1. Brakes

Ensure front and rear brakes work properly.

Ensure brake shoe pads are not over worn and are correctly positioned in relation to the rims.

Ensure brake control cables are lubricated, correctly adjusted and display no obvious wear.

Ensure brake control levers are lubricated and tightly secured to the handlebar.

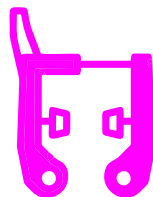

2. Wheels and tires

Ensure tires are inflated to within the recommended limit as displayed on the tire sidewall.

Ensure tires have tread and have no bulges or excessive wear.

Ensure rims run true and have no obvious wobbles or kinks.

Ensure all wheel spokes are tight and not broken.

Check that axle nuts are tight. If your bicycle is fitted with quick release axles, make sure locking levers are correctly tensioned and in the closed position.



3. Steering

Ensure handlebar and stem are correctly adjusted and tightened, and allow proper steering.

Ensure that the handlebars are set correctly in relation to the forks and the direction of travel.

Check that the headset locking mechanism is properly adjusted and tightened.

If the bicycle is fitted with handlebar end extensions, ensure they are properly positioned and tightened.





4. Chain

Ensure chain is oiled, clean and runs smoothly.
Extra care is required in wet or dusty conditions.

5. Bearings

Ensure all bearings are lubricated, run freely and display no excess movement, grinding or rattling.
Check headset, wheel bearings, pedal bearings and bottom bracket bearings.

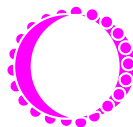

6. Cranks and Pedals

Ensure pedals are securely tightened to the cranks.
Ensure cranks are securely tightened to the axle and are not bent.

7. Derailleurs

Check that the front and rear mechanisms are adjusted and function properly.
Ensure shift and brake levers are attached to the handlebar, shift and brake.
Ensure derailleurs, shift levers and shift and brake cables are properly lubricated.



8. Frame and Fork

Check that the frame and fork are not bent or broken either. If bent or broken, they should be replaced.

9. Accessories

Ensure that all reflectors are properly fitted and not obscured.

Ensure all other fittings on the bike are properly and securely fastened, and functioning.



10. Motor Drive Assemble and Throttle

Ensure all motor drive components are correctly mounted and functioning properly.

11. Battery Pack

Ensure the batteries are in good operation condition and kept fully charged.



POWER SUPPLY PRECAUTIONS

	Parameter	standard Edition
Dimensions	Main material	Aluminum alloy
	Size	64.6* 24.4*45.7 inches
	Tire size	20x3.0 inches
Performance Parameter	Weight	55.1lbs
	Best Riding Speed	18MPH
	Maximum Speed	20MPH
	Range	20-25 Miles (throttle mode) 30-40 Miles (pedal assist)

	Parameter	standard Edition
performance parameter	Maximum climbing angle	15 degrees
	operating temperature	-20 ~ 40 degrees
	Waterproof Level	Ip54
Electrical specifications	Battery Type	18650 lithium ion power batter
	Battery capacity	10.4AH
	Rated battery voltage	36v
	Motor line type	power
	Motor rated voltage	36v
	charging voltage	DC42V/2A
	npu voltage	AC110V
	undervoltage protection value	29V
	overcurren protection value	14A
Features	charging time	5~6 hours
	Display	Multi-function LCD Screen
	Front light	Yes
	Braking method	Disc brakes
	speed transmission	7 SPEEDS

Remarks: Electricity, load, tire pressure, road environment, chain and wheel axle lubrication, etc. will affect the maximum speed; the range refers to the data obtained from continuous testing from fully charged to completely exhausted with a riding speed of 15-25MPH and a load of 60kg on a flat hardened road; driving habits, temperature, load, tire pressure, road environment and other factors will affect the range.

PRECAUTIONS FOR INSTALLATION

⚠ Important Reminder: Before installation, please confirm that all product components and assembly parts are present and accounted for. Please check the product structure and make sure there are no missing parts or components before assembly. (Check the following PACKAGE LIST & PRODUCT STRUCTURE)

PACKAGE LIST



Charger



Charger cable



Pedals*2



Front Reflector



Phillips Head

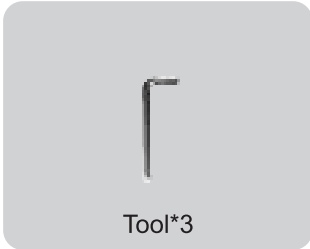

Tool*3



Open End Wrench*2

Accessories list, as shown above

BICYCLE PARTS

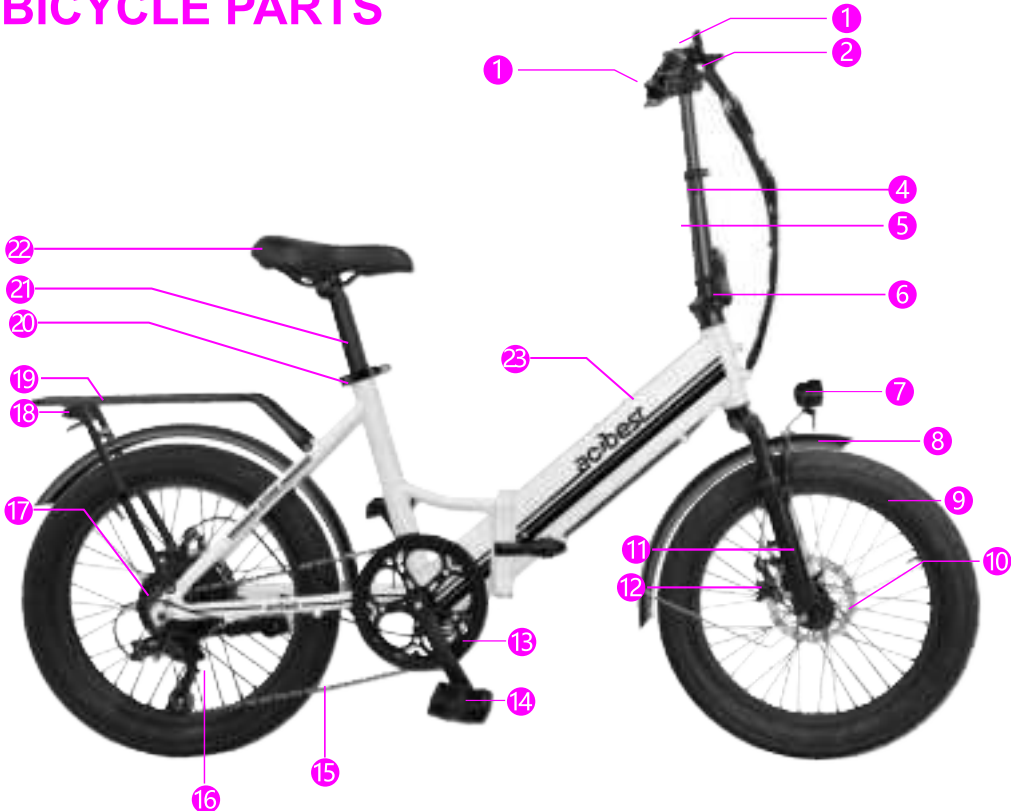

Figure 1 (Bicycle Diagram)

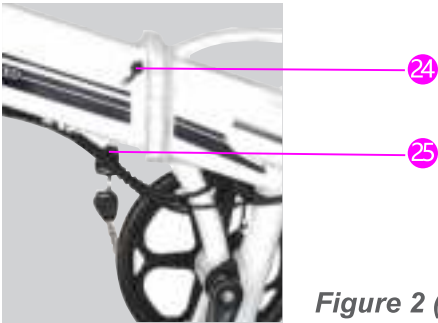

Figure 2 (Left side of the frame)

- | | |
|--|---------------------------------------|
| 1 Rear Gear Shift Lever | 14 Pedal |
| 2 Brake Level | 15 Chain |
| 3 LCD Screen | 16 Rear Derailleur |
| 4 Handlebars Stem Adjustment Quick Release | 17 Motor |
| 5 Foldable Stem | 18 Tail Light |
| 6 Foldable Stem Quick Release | 19 Rear rack |
| 7 Headlight | 20 Seat Tube Adjustment Quick Release |
| 8 Front Fender | 21 Seat Tube |
| 9 Tire | 22 Saddle |
| 10 Brake Disc | 23 Lithium Battery |
| 11 Front Fork | 24 Battery Charging Hole |
| 12 Disc Brake | 25 Battery Lock Key Hole |
| 13 Chainwheel | |

ASSEMBLY

Here is the link to the assembly video:

https://www.youtube.com/playlist?list=PLQJGYnGRy4DoHfb4SwLLI2_LQis06hoEd

STEM INSTALLATION

Remove the bicycle from the shipping carton. Cut the nylon straps so the front wheel can be removed from the frame and the rear wheel can freely rotate.



Align and insert the upper section of the stem into the lower section of the stem to a position above the safety line, then tighten the quick-release wrench.



Lift up the handlebars stem and close the folding lock and lock up the ring clockwise to the folding lock.

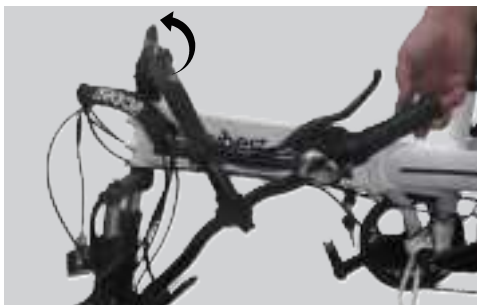

SADDLE INSTALLATION

Insert the seat tube and adjust it to the appropriate height. Close the seat tube adjustment quick release.



Set the bicycle upside down. Make sure to place some protective materials under the handlebars to avoid damaging the LCD screen.

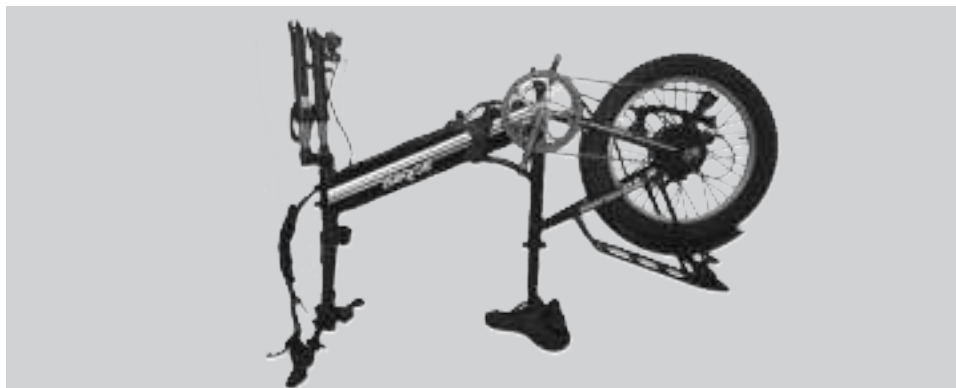

HEADLIGHT FENDER INSTALLATION

Install the front fender and the headlight. First, insert the fender with the front forward. Second, insert the headlight using the same screw hole. Attach the fender rods to the front wheel.



ASSEMBLY FRONT WHEEL



Turn the bicycle upside down to facilitate the installation of the front wheel, loosen the fixing screws of the front fork and the protective rod with an adjustable wrench, and remove the front fork protective rod.



Take out the quick disconnecting rod and insert it into the front drum as shown in the figure. The safety washer is matched with the front fork hole.

Take out the quick disconnecting rod and insert it into the front drum as shown in the figure. The safety washer is matched with the front fork hole.

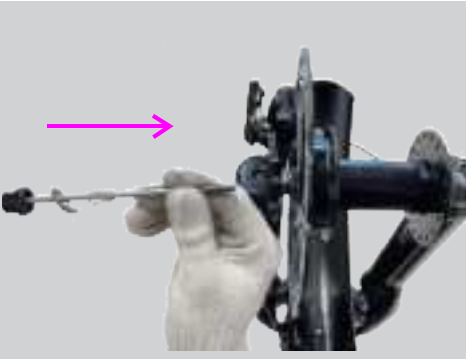

Insert the quick release rod into the front drum, and pay attention to the two sides of the gasket hooks in the front hole.



Prelock and secure the quick release nut. The M5 hex socket is used for locking on the opposite side.

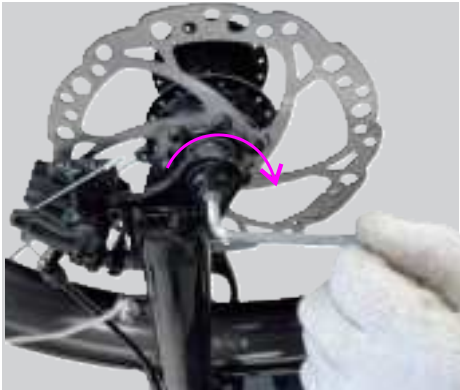

ASSEMBLY FRONT WHEEL



Loosen the screw and install the reflector on the handle, tighten the screw

PEDAL INSTALLATION

Attach the right and left peddle according to the R & L labels.
Note: The left pedal is tightened to the left, and the right pedal is tightened to the right.

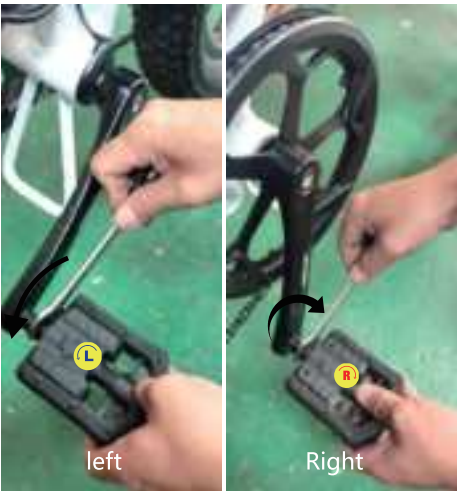

LINE CONNECTION

Finally, make sure you align all the wires by color before plugging them in. Once you have completed the installation, you can test the front and rear brakes as well as the headlights to see if they are working properly.

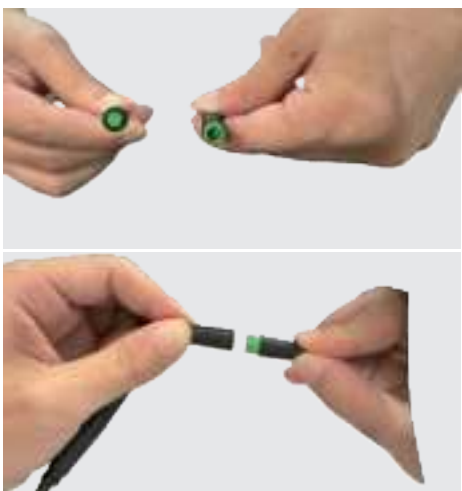

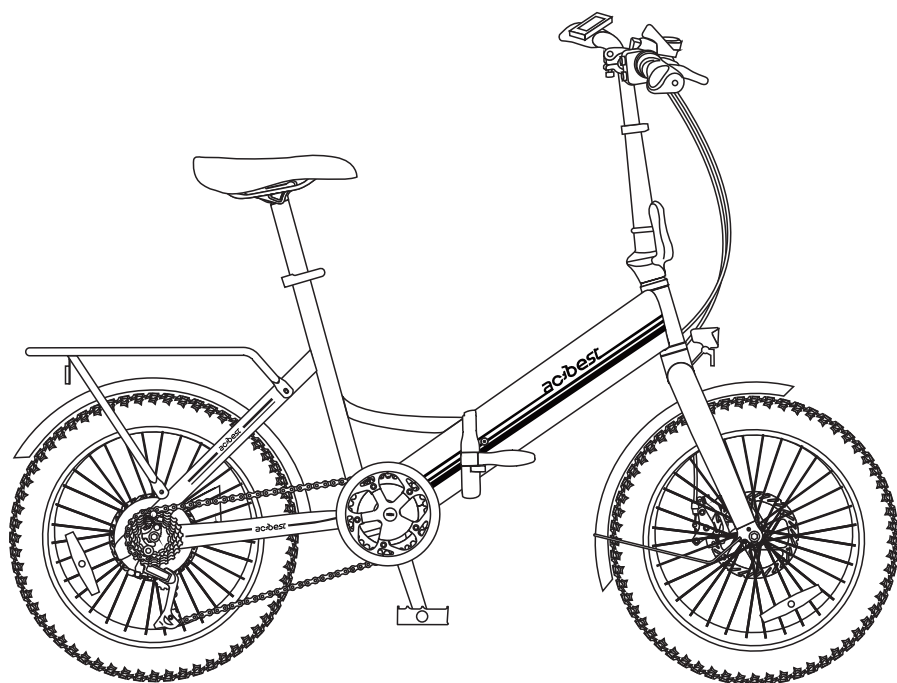

The finished bike

Boot Method

1. Take off the key from the handlebars.
2. Find out the key hole at the bottom of the folded frame and insert the key. Turn the key to the right to connect the screen power.

(When the battery is lock , turn the key only one grid to the right can connect the screen power.

However, when the battery is unlock , the key needs to be turned two grids: first ,turn the key one grid to the right locks the battery, and then turn it one grid to the right can connect the screen power.)

Note: The factory setting of our product is that the key is not inserted into the keyhole, and the battery is in a locked state.

3. Long press the "⏻" on/off button on the screen for 3 seconds to turn on the bike.
4. Short press + button to increase the speed level(0-5 level). The bike will not work in the level 0.
5. Short press - button to lower the speed level(5-0 level).



HANDLEBAR CONTROLS



Handlebar

The caps at the ends of the handlebar are removable, allowing standard fitting bike review mirrors to be installed into the handlebar.

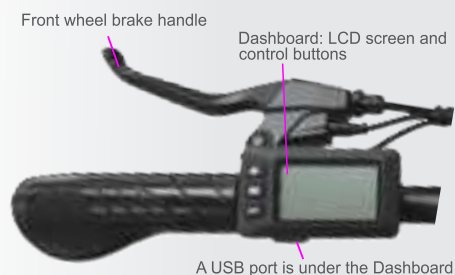

Long press to turn “**M**” on/off power.
Long press “+” to turn on/off lights.
(Bike still or moving.)
Press “+” to increase PA level.
Press “-” to decrease PA level.
Long press “-” for Walk Mode.
Release to end.
*Applying the brake turns off the motor.

Left side of Handlebar

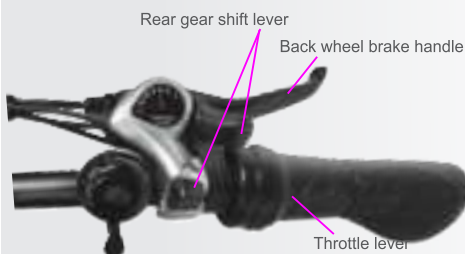

Press gear shift button to increase gear level.
Press gear shift lever to decrease gear level.
Press thumb throttle for acceleration.
Hold it down 8 seconds for Cruise Control .
*Applying the brake turns off the motor.

Right side of Handlebar

Display user instructions

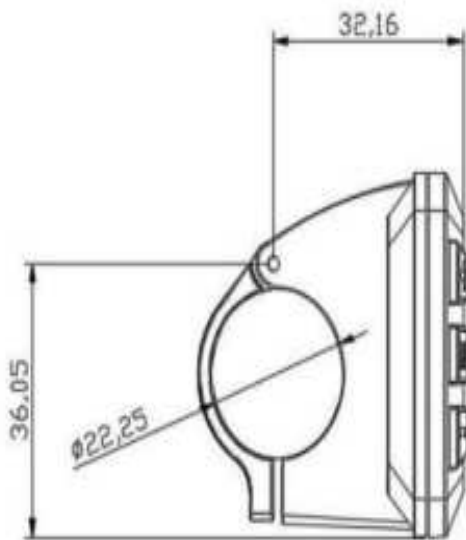
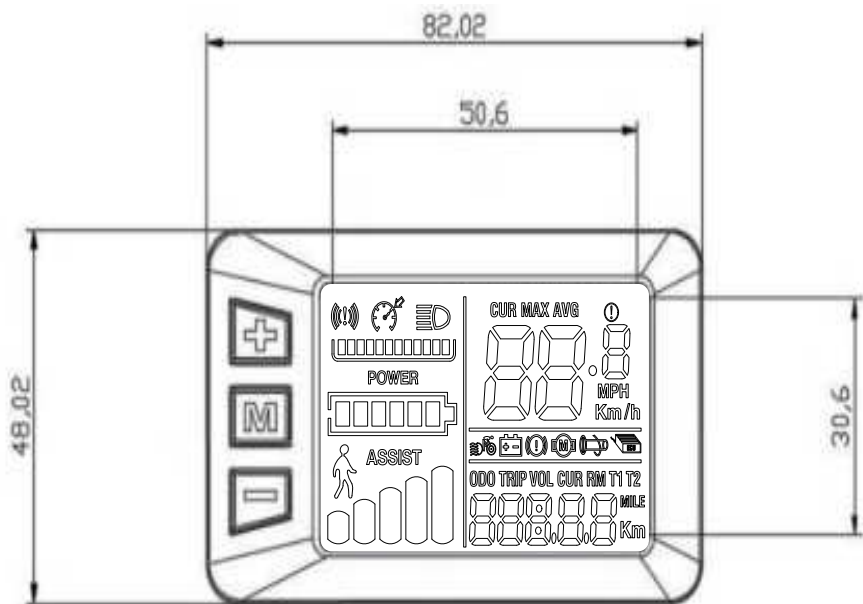

Size

Understanding and Using the LCD Display Screen

M	Power On / off Button	<div>1.Press “M” when off for 1 second to turn on full display, which is followed by riding display.</div> <div>2.Press “M” when on and showing riding display for full display to show.</div> <div>3.Press “M” when on and hold to turn off bike.</div>
+	【+】 Button	<div>1. Parameter adjustment</div> <div>2. Menu operation</div>
-	【-】 Button	<div>1. Parameter adjustment</div> <div>2.Menu operation</div>

Understanding and Using the LCD Display Screen

Power on and off

In the off state, press and hold the “M” button to enter the boot full display interface, enter the boot interface after 1 second, and enter the riding interface after 2 seconds:

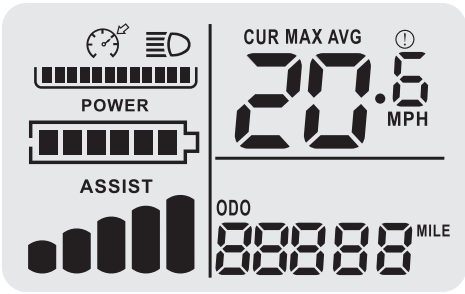
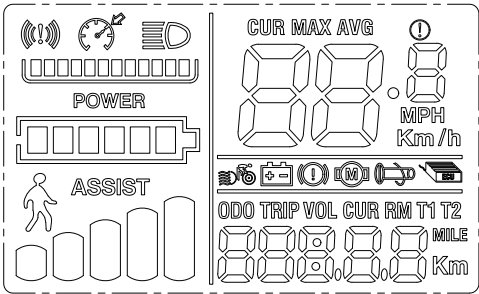

On any interface after booting, press and hold the “M” button to shut down.

Cycling display interface

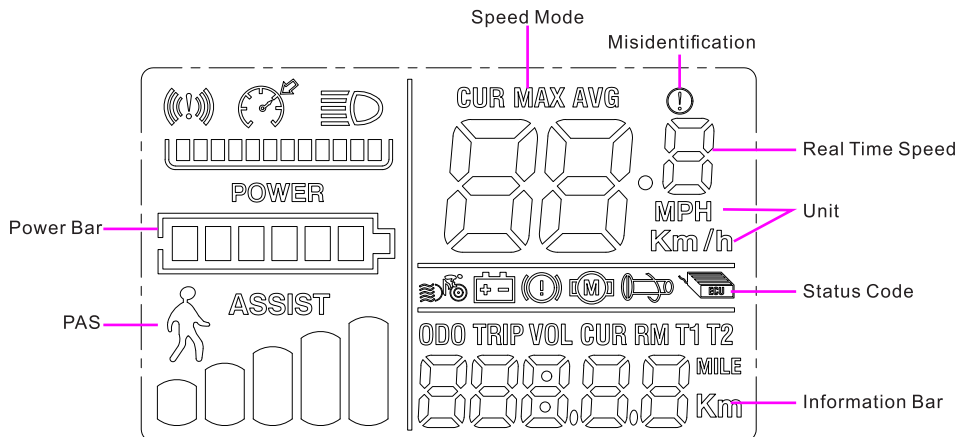

Full display with icons label

SPEED LEVEL: Press the “+” or “-” button to increase/lower the SPEED LEVEL.

PA (Power Assist): Press the “+” or “-” button to increase/lower the SPEED LEVEL and Press gear shift button/lever to increase/decrease gear level to reach up to highest speed.

Walk Mode: With bike on and stationary long press the “-” button and hold. (Bike can lurch at first.) To end walk mode release the “-” button.

⚠ Precautions for LCD screen/controls

1. Always be sure the bike's power is turned off before plugging it in or unplugging it from the bike's wiring.
2. Do not immerse it in water.
3. Only use a soft damp cloth with no detergent or cleaner to clean it.
4. Protect the USB port on the bottom by keeping it tightly closed when not in use and do not connect to it in rain.

Below are common error codes.(The codes are related to other vehicle accessories and are for reference only.

Error code (hexadecimal)	Meaning	Solution
E33	Abnormal current or MOS tube damage	Take out the battery, wait 1 minute, and then install it. It also shows 33 that the controller needs to be replaced
E35	Motor phase missing, this motor is waterproof wire	If this error occurs, disconnect the waterproof wire of the motor and plug it in again
E36	Motor Hall, this motor is waterproof wire	If this fault occurs, disconnect the motor waterproof wire and plug it again. If 36 still occurs, change the motor
E37	Brake handle abnormal	Brake handle switch is not returned to position, forcefully knead carbon release power brake to position or shut down and restart
E30	Communication failure	Check whether the waterproof cable at the instrument end still exists. Replace the instrument or controller

**If there is any problem during the assembly, please feel free to contact us.
service@actbest.net**

HOW TO MODIFY THE CONTROL SETTINGS

Procedure

1. In the off state, press and hold the “M” button to turn on the bike; short press the “ M ” button to switch the interface between ODO, TRIP, VOL, CUR, and TIME. On any interface after booting, press and hold the “M” button to shut down.
2. With the bike on, press the “ + ” or “ - ”button to increase / lower the speed level.
3. To open the User Menu, long press the “ + ” and “ - ” buttons simultaneously while the bike is stationary.
4. Use the “ + ” button to scroll forward and the “ - ” button to scroll backwards through the open control settings that can be modified.
5. Press the “ M ” button to confirm the current control setting and advance to the next one.
6. Repeat the process until you have finished adjusting the settings. Long press the “ + ” and “ - ” buttons simultaneously to close the User Menu or the User Menu will close after 8 seconds of inaction and the Riding display will return.

P01: Brightness of the LCD screen, level 1 is the darkest and level 3 is the brightest;

P02: Mileage unit, 0: KM; 1: MILE;

P04: Auto sleep time setting: (unit: minute)The adjustment range is 0-60, and 0 is to disable the automatic power-off function;

P16: Clear ODO Miles. Press and hold the “ + ” button for 5 seconds to clear ODO miles.

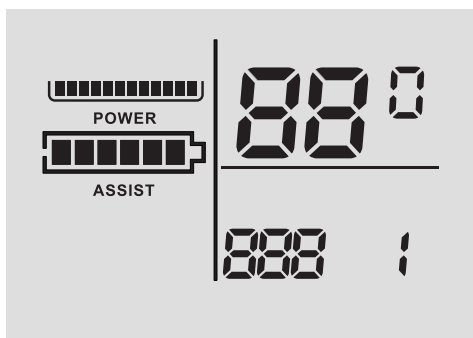
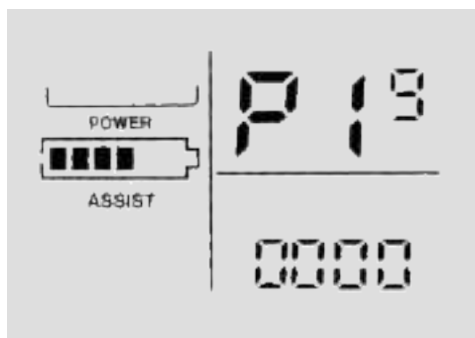



Precautions for LCD screen/controls

1. Always be sure the bike's power is turned off before plugging it in or unplugging it from the bike's wiring.
2. Do not immerse it in water.
3. Only use a soft damp cloth with no detergent or cleaner to clean it.
4. Protect the USB port on the bottom by keeping it tightly closed when not in use and do not connect to it in rain.

Battery can be charged on the bike or after removing it.
Handle the battery carefully. It is heavy and expensive to replace.

Warning: Stick to the IMPORTANT SAFETY



First, pull out the plastic plug of the charging port, and then fold the frame.



Insert the key into the battery lock and rotate it one grid to the left to turn off battery power; After pressing the key all the way in, rotate it one more grid to the left to unlock the battery lock.



Remove the key.



Pull the battery handle to remove the battery from the frame.



Battery charging hole

OPERATIONS

UNDERSTANDING THE BIKE EQUIPMENT



Remove the bicycle from the shipping carton. Cut the nylon straps so the front wheel can be removed from the frame and the rear wheel can freely rotate.



Lift up the handlebars stem and close the folding lock and lock up the ring counterclockwise to the folding lock.



Insert the seat tube and adjust it to the appropriate height. Close the seat tube adjustment quick release.

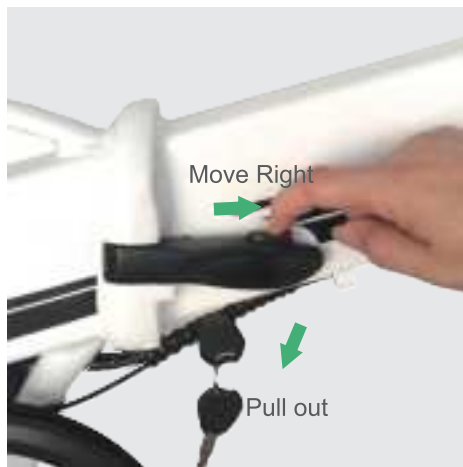

Set the bicycle upside down. Make sure to place some protective materials under the handlebars to avoid damaging the LCD screen.



Install the front fender and the headlight.
First, insert the fender with the front forward. Second, insert the headlight using the same screw hole. Attach the fender rods to the front wheel.

E-Bicycle folded state

OPERATIONS

UNDERSTANDING THE BIKE EQUIPMENT

Lights

Long press the “+” button to turn on lights. Repeat to turn off. This activates front, rear, and break lights. They run off the bike battery.

No extra battery is needed. They turn off when bike is turned off.

Dual-crown Suspension Fork

Adjustable preload and lockout feature

How do dual crown forks work?

Double crown forks attach both above and below the head tube, hence the name double crown. Single crowns mount only below the head tube, meaning that they can be made far lighter, are more maneuverable but are less stiff.

Preload will adjust how stiff the fork is. More plush (soft), or hard to compress.

Lockout will LOCK the fork out, as a rigid fork (no suspension) would be like, which makes it a no front suspension bike. This is handy for riding on the road because when pumping hard a lot of the power your using to go forward is being absorbed by the fork compressing. This prevents that.



Shimano 7 Speed Gear Shift System

The current gear setting is shown on the gear control.

Push the button to go to a higher gear.

Push the lever to go to a lower gear.

These gears range from 1, which is the lowest and easiest gear, to 7, which may be.

referred to as a “ high gear ” and is most suitable for riding fast downhill or on the flat.

You want to shift to an easier/lower gear on climbs, or when you're riding into the wind.

Use a higher gear on flats or if the wind is blowing from behind (a tail wind).

Going up inclines at higher gear setting while using the motor is not recommended as it can result in damage to the electric motor.



USING THE POWER FEATURES OF THE ELECTRICBIKE MOTOR

Walk Mode

With bike on and stationary long press the - button and hold. (Bike can lurch at first.) To end walk mode release the “-” button.

Power Assist (PA)

Use PA with rider mounted and pedaling.

Press the + or - button to increase or lower Power Assist.

The bike uses Smart Sensors which “provides an intelligent riding experience.

These sensors detect the rider's movements and adjust the bike's speed and power accordingly, making it easier and safer to ride.” PA works best if the top speed of the bike is set at the upper limit of 20 MPH.

PA 1-5 provide a boost to the set speeds shown below. These speeds can vary and are based on the reports of experienced riders.

(A bike can travel up to a 25 mile range in PA.)

PA1: 11MPH

PA2: 13MPH

PA3: 16MPH

PA4: 18MPH

PA5: 20MPH

At the higher PA levels more active peddling becomes less effective.

Throttle

Throttle is activated by pushing the throttle switch. It can be used with or without pedaling. With throttle only (no pedaling) top speed is up to 20 MPH, and distance is up to 20 miles.

Note: Throttle is linked to PA. PA needs to be on to use Throttle.

If not pedaling, the set PA's top speed is the throttle top speed.

Power Indicator

The power indicator appears at the bottom left of the screen when the motor is ON. It is a growing/receding L to R green bar which indicates how much power is being used.

TROUBLESHOOTING

Problem	Possible Cause	Remedy
Gear shifts not working properly	-Deraillieur cables sticking/stretched/damaged	-Lubricate/tighten/replace cables
	-Front or rear deraillieur not adjusted properly	-Adjust deraillieurs
	-Indexed shifting not adjusted properly	-Adjust indexing
Slipping chain	-Excessively worn/chipped chainring or freewheel sprocket teeth	-Replace chainring, sprockets and chain
	-Chain worn/stretched	-Replace chain
	-Stiff link in chain	-Lubricate or replace link
	-Non-compatible chain/chainring/freewheel	-Seek advice at a bicycle shop
Chain jumping off freewheel sprocket or chainring	-Chainring out of true	-Re-true if possible, or replace
	-Chainring loose	-Tighten mounting bolts
	-Chainring teeth bent or broken	-Repair or replace chainring/set
	-Rear or front deraillieur side-to-side travel out of adjustment	-Adjust deraillieur travel
Constant clicking noises when pedaling	-Stiff chain link	-Lubricate chain/Adjust chain link
	-Loose pedal axle/bearings	-Adjust bearings/axle nut
	-Loose bottom bracket axle/bearings	-Adjust bottom bracket
	-Bent bottom bracket or pedal axle	-Replace bottom bracket axle or pedals
	-Loose crankset	-Tighten crank bolts

Grinding noise when pedaling	<ul style="list-style-type: none"> -Pedal bearings too tight -Bottom bracket bearings too tight -Chain fouling derailleurs -Derailleur jockey wheels dirty/binding 	<ul style="list-style-type: none"> -Adjust bearings -Adjust bearings -Adjust chain line -Clean and lubricate jockey wheels
Freewheel does not rotate	<ul style="list-style-type: none"> -Freewheel internal pawl pins are jammed 	<ul style="list-style-type: none"> -Lubricate. If problem persists, replace freewheel
Brakes not working effectively	<ul style="list-style-type: none"> -Brake blocks worn down -Brake blocks/rim greasy, wet or dirty -Brake cables are binding/ stretched/damaged -Brake levers are binding -Brakes out of adjustment 	<ul style="list-style-type: none"> -Replace brake blocks -Clean blocks and rim -Clean/adjust/replace cables -Adjust brake levers -Center brakes
When applying the brakes they squeal/squeak	<ul style="list-style-type: none"> -Brake blocks worn down -Brake block toe-in incorrect -Brake blocks/rim dirty or wet -Brake arms loose 	<ul style="list-style-type: none"> -Replace blocks -Correct block toe-in -Clean blocks and rim -Tighten mounting bolts
Knocking or shuddering when applying brakes	<ul style="list-style-type: none"> -Bulge in the rim or rim out of true -Brake mounting bolts loose -Brakes out of adjustment -Fork loose in head tube 	<ul style="list-style-type: none"> -True wheel or take to a bike shop for repair -Tighten bolts -Center brakes and/or adjust brake block toe-in -Tighten headset

Wobbling wheel	<ul style="list-style-type: none"> -Axle broken -Wheel out of true -Hub comes loose -Headset binding -Hub bearings collapsed -QR mechanism loose 	<ul style="list-style-type: none"> -Replace axle -True wheel -Adjust hub bearings -Adjust headset -Replace bearings -Adjust QR mechanism
Steering not accurate	<ul style="list-style-type: none"> -Wheels not aligned in frame -Headset loose or binding -Front forks or frame bent 	<ul style="list-style-type: none"> -Align wheels correctly -Adjust/tighten headset -Take bike to a bike shop for possible frame realignment
Frequent punctures	<ul style="list-style-type: none"> -Inner tube old or faulty -Tire Tread/casing worn -Tire unsuited to rim -Tire not checked after previous puncture -Tire pressure too low -Spoke protruding into rim 	<ul style="list-style-type: none"> -Replace Inner tube -Replace tire -Replace with correct tire -Remove sharp object embedded in tire -Correct tire pressure -File down spoke

If there is any problem during the assembly, please feel free to contact us.
service@actbest.net

