



58259

©2022 Bestway Inflatables & Material Corp.

All rights reserved/Tous droits réservés/Todos los derechos reservados/Alle Rechte vorbehalten/Tutti i diritti riservati

Trademarks used in some countries under license from/

Marques utilisées dans certains pays sous la licence de/

Marcas comerciales utilizadas en algunos países bajo la licencia de/

Die Warenzeichen werden in einigen Ländern verwendet unter Lizenz der/

Marchi utilizzati in alcuni paesi concessi in licenza a

Bestway Inflatables & Material Corp., Shanghai, China

Manufactured, distributed and represented in the European Union by/

Fabriqués, distribués et représentés dans l'Union Européenne par/Fabricado, distribuido y representado en la Unión Europea por/

Hergestellt, vertrieben und in der Europäischen Union vertreten von/Prodotto, distribuito e rappresentato nell'Unione Europea da

Bestway Europe S.p.a., Via Resistenza, 5, 20098 San Giuliano Milanese (Milano), Italy

Distributed in Latin America by/Distribué en Amérique latine par/Distribuido en Latinoamérica por/Distribuido na América Latina por

Bestway Central & South America Ltda, Salar Ascotan 1282, Parque Enea, Pudahuel, Santiago, Chile

Distributed in Australia & New Zealand by **Bestway Australia Pty Ltd, Unit 2/98-104 Camarvon St Silverwater, NSW 2128, Australia**

Tel: Australia: (+61) 2 9037 1388; New Zealand: 0800 142 101

Distributed in United Kingdom by **Bestway Corp UK Ltd, 8 Wentworth Road, Heathfield Industrial Estate, Newton Abbot, Devon, TQ12 6TL**

Exported by/Exporté par/Exportado por/Exportiert von/Esportato da

Bestway (Hong Kong) International Ltd./Bestway Enterprise Company Limited

Suite 713, 7/Floor, East Wing, Tsim Sha Tsui Centre, 66 Mody Road, Kowloon, Hong Kong

www.bestwaycorp.com



bestwaycorp.com/support



POOL HEATER OWNER'S MANUAL

Visit Bestway YouTube
channel 



SAFETY INSTRUCTIONS

WARNING

When installing and using this electrical appliance, basic safety precautions should always be followed, including the following:

IMPORTANT SAFETY INSTRUCTIONS READ AND FOLLOW ALL INSTRUCTIONS

WARNING:

- The Pool Heater must be tested before each use. To test, follow the instructions in the Operation section of this manual.
- The Pool Heater must be supplied through a residual current device (RCD) having a rated residual operating current not exceeding 30mA.
- The power source on the wall of building should keep more than 4m away from pool and at a height of 1.2m at least.
- Parts containing live parts, except parts supplied with safety extra-low voltage not exceeding 12V, must be inaccessible to a person in the pool; Parts incorporating electrical components, except remote control devices, must be located or fixed so that they cannot fall into the swimming pool.
- **RISK OF ELECTRIC SHOCK** - The Pool Heater can not be used while people are inside the pool.
- If the supply cord is damaged, it must be replaced by the manufacturer, its service agent or similarly qualified persons in order to avoid a hazard.
- Extension cords can't be used.
- Do not bury cord. Locate cord to minimize abuse from lawn mowers, hedge trimmers, and other equipment.
- The Pool Heater should not be setup or left out in temperature lower than 4°C (40°F).
- It is necessary to have the plug accessible after installation of the pool.
- Before using the Pool Heater, make sure the pool has been filled with water.

- Pool Heaters are designed for use with specific water volume; ensure your Pool Heater matches your pool's water volume along with your Filter Pump or Sand Filter's designated water flow rate.

- **RISK OF ELECTRIC SHOCK** - Install at least 2m from all metal surfaces.

- The heater must be supplied by earthed power source.

- **WARNING: Always keep plug dry, plug in with wet plug is definitely forbidden!**

- This appliance can be used by children aged from 8 years and above and persons with reduced physical, sensory or mental capabilities or lack of experience and knowledge if they have been given supervision or instruction concerning use of the appliance in a safe way and understand the hazards involved. Children shall not play with the appliance. Cleaning and user maintenance shall not be made by children without supervision. (For EU market)

- **WARNING** - This appliance is not intended for use by persons (including children) with reduced physical, sensory or mental capabilities, or lack of experience and knowledge, unless they have been given supervision or instruction concerning use of the appliance by a person responsible for their safety. Children should be supervised to ensure that they do not play with the appliance. (For market other than EU)

Cleaning and user maintenance must be performed by an adult above 18 years old who is familiar with the risk of electric shock.

Caution: Read the instruction before using the appliance and installation/reassemble each time.

Warning: For electric safety, a PRCD device is incorporated in the power cord, if the leakage current is detected more than 10mA, the device will operate and cut-off the power supply, in such case, please unplug and stop using the product at once. Don't reset the product by yourself. And you must contact the local service agent to check and repair the product.

- Don't plug or unplug the appliance if hand is wet.
- Always unplug the appliance:
 - on raining days
 - before cleaning or other maintenance
 - Leave it unattended on holidays

When the appliance will be not used for long time, such as in the winter, the pool set should be disassembled and stored indoor.

- Safekeeping the instruction. For reconstruction the pool set every time, please always refer to the instructions.
- If instruction is missed, please contact with Bestway or search it in website: www.bestwaycorp.com

CAUTION:

- Pool Heater is for use with storable pools only. Do not use with permanently-installed pools. A storable pool is constructed so that it is capable of being readily disassembled for storage and reassembled to its original integrity. A permanently-installed pool is constructed in or on the ground or in a building such that it cannot be readily disassembled for storage.
- Never add water to chemicals. Always add chemicals to water to avoid strong fumes or violent reactions that may result in hazardous chemical spray.

Electric installations should follow national wiring rules, consult a qualified electrician with any questions.

After using your heater for 3-5 years, you should contact your local qualified maintenance technician to ensure the safety and performance.

The main components, such as heating element, within the electric unit should be checked and replaced(if necessary) by professional persons.

NOTE:

- Handle the Pool Heater with care. Do not pull or carry the Pool Heater by the power cord. Keep cords free from abrasions. Sharp objects, oil, moving parts, and heat should never be exposed to the Pool Heater.
- Please examine all equipment before use. Notify Bestway through our customer service address listed on this manual for any damaged or missing parts at the time of purchase. Verify all components represent the model that you purchased.
- This product is not intended for commercial use.

IMPORTANT: Using the Pool Heater with an unmatched electrical supply is dangerous and will result in catastrophic failure of the Pool Heater.

SAVE THESE INSTRUCTIONS

PRCD WARNING

WARNING: The PRCD plug must be tested before each use to avoid risk of electric shock.

WARNING: Before inserting plug into a power outlet, make sure the current rate of the power outlet is suitable for the pump.

WARNING: Do not use the heater if this test fails. For assistance, please visit the support section on our website, www.bestwaycorp.com.

DISPOSAL



Waste electrical products should not be disposed of with household waste. Please recycle where facilities exist. Check with your local authority or retailer for recycling advice.

PARTS REFERENCE OVERVIEW

Before assembling the Pool Heater become familiar with all parts.

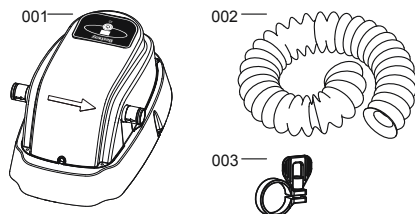

REF. NO.	DESCRIPTION	QTY	PART NO.
001	Pool Heater	1	58259ASS19
002	Hose	1	P6176ASS16
003	Hose Clamp	2	P6124ASS16

SPECIFICATIONS

Voltage:	220-240V
Power:	2,800W at 20°C
Frequency:	50Hz
Max. Heat Capability:	40°C
Increased Heat Rate (*):	Approximately 0.5°C/h-1.5°C/h depending on total water volume
Suitable Pool Water Volume:	400-4,500gal (1,520-17,035 L)
Filter Pump/Sand Filter	3,785 L/h (1,000 gal/h) and below
Compatibility:	3,785 L/h (1,000 gal/h)
Pool Compatibility:	15' and smaller

NOTE: The increased Heat Rate is just for reference. The actual heating time may vary according to the pool's water volume, environmental temperatures, desired temperatures and other conditions. Usually, if the pool has a large water volume or if environment temperatures are low and the desired temperature is high, longer heating time is required. However, if the temperature increase is less than 0.2°C after one heating hour, the water temperature can be thought to have reached the highest balance temperature.

Alarms

Phenomenon	Reasons	Solutions
	Filter pump or sand filter does not operate, no water flow.	Refer to the filter pump or sand filter user's manual.
	Water flow sensor broken.	For assistance, please visit the support section on our website, www.bestwaycorp.com
	The water temperature is lower than 4°C (39°F) .	The pool heater was not designed to operate with water temperatures lower than 4°C (39°F). Unplug the heater and only re-start the heater when the water temperature reaches 6°C (43°F).
	The water temperature is higher than 50°C (122°F) .	The pool heater was not designed to operate with water temperatures higher than 50°C (122°F). Unplug the heater and only re-start the heater when the water temperature reaches 38°C (100°F).
	The temperature sensor does not work	For assistance, please visit the support section on our website, www.bestwaycorp.com
	The manual reset thermal cut-out has been tripped	1. Push the reset button, then check if the heater can work normally. 2. In case the alarm still remains, check the RESET BUTTON section in manual. 3. For assistance, please visit the support section on our website, www.bestwaycorp.com
	The fuse is disconnected	For assistance, please visit the support section on our website, www.bestwaycorp.com

Troubleshooting		
Problem	Cause	Solution
1. The heating light does not work.	A. Power failure.	A. Check power source.
2. Pool Heater not heating properly.	A. The Pool Heater is not working. B. Heating time is too long. C. Filter pump or Sand Filter does not match the Pool Heater appropriately or Filter Pump or Sand Filter failed, resulting in high or low water flow rates. D. Pool Heater set-up failed. E. The thermal cut out cut off. F. Pool Heater failed.	A. Check the LED light to see whether the heater is working. B. Highly recommend the use of a Bestway pool cover. C. Replace the Filter Pump or Sand Filter following the specification of this owner's manual, and perform maintenance according to the instructions of Filter Pump or Sand Filter. D. Reset-up the Pool Heater according to the instructions. E. Press the "Reset" button on the Pool Heater. F. For assistance, please visit the support section on our website, www.bestwaycorp.com
3. Inlet and Outlet Valves leak.	A. Hose Clamps are loose. B. Hose O-ring not in correct position. C. Hose Broken.	A. Tighten the hose clamps. B. Check whether O-Ring are damaged. C. Hose needs to be replaced.
4. Water does not flow.	A. Filter Pump or Sand Filter does not work. B. Filter Pump or Sand Filter broken.	A. Reset-up the Filter Pump or Sand Filter according to the instructions. B. Check and repair the Filter Pump or Sand Filter according to the relevant instructions in the Filter Pump or Sand Filter's owner's manual.
5. The heating light turns off but the Pool Heater heats.	A. The light is broken.	A. The heating light is wrong and the heater still works.

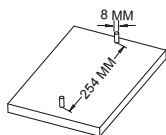

Pedestal Fixing

The pool heater must be vertically fixed on ground or a certain pedestal made of wood or concrete before it can be used. There should be two holes, 8mm in diameter on the pedestal, the space between which should be 254mm. Put the pool heater on the pedestal and fix them together with bolts and nuts. The pedestal should weigh over 18kgs in order to prevent the pool heater from accidentally falling.

ASSEMBLY

- Set-up and fill the pool with water to the required level according to the pool's owner's manual.
- Attach the Filter Pump or Sand Filter's Inlet Valve to the Pool:
 - Place the loose Hose Clamps on both ends of a Filter Pump or Sand Filter Hose.
 - Attach the hose to Filter Pump or Sand Filter's Inlet Valve and the Pool's Outlet Valve B.
 - Tighten the Hose Clamps.

- Connect the Filter Pump or Sand Filter to the Pool Heater:
 - Place the loose Hose Clamps on both ends of the Pool Heater Hose.
 - Attach the hose to the Filter Pump or Sand Filter's Outlet Valve and the Pool Heater's "INLET" Valve and tighten the Hose Clamps.
- Attach the Pool Heater to the Pool's Inlet Valve A.
- Loosen the Hose Clamps on the Pool's Inlet and Outlet Valves; replace the Stopper Plugs with Debris Screens. Water now flows to the Filter Pump or Sand Filter and the Pool Heater. With the Hoses and the Debris Screens in position, tighten the Hose Clamps.
- Check that every port and valve is connected correctly.

PRCD TEST

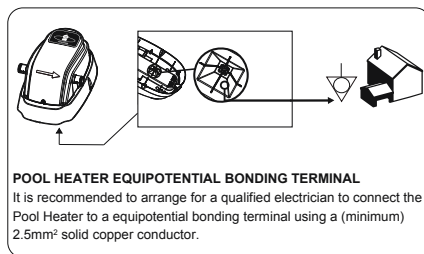
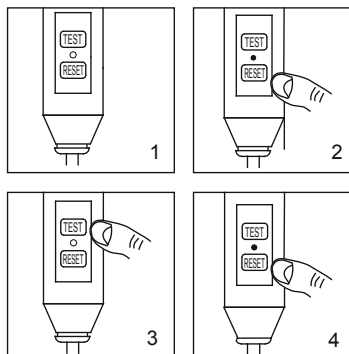

NOTE: To order spare parts for the Pool Heater, please provide us with part no. and part name. Drawings for illustration purposes only. May not reflect actual product. Not to scale.

Above Ground Pool

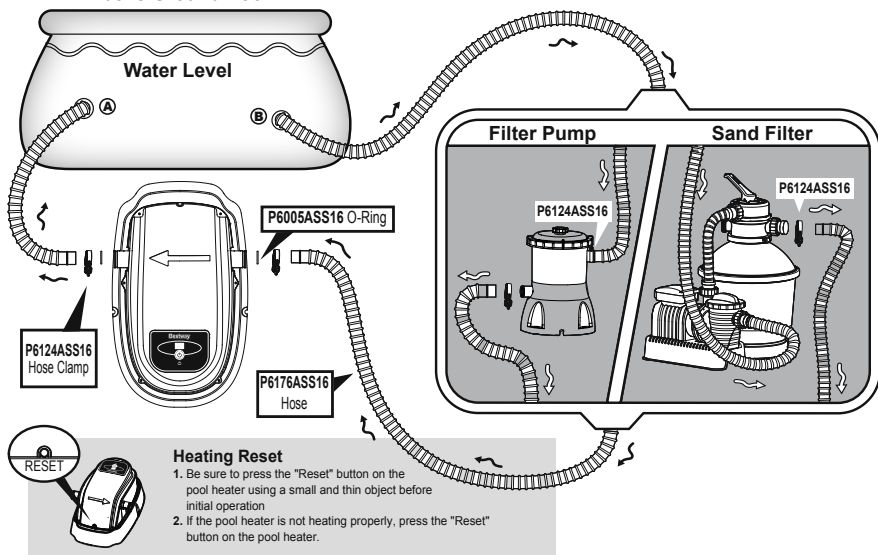

RESET BUTTON IMPORTANT INSTRUCTION FOR USING

If the water temperature has not changed 4-5 hours after activation of the heating system, use a thin object to press the RESET BUTTON, and restart the heating system.

IMPORTANT: The heating system will not operate if the outside temperature is above 40°C (104°F) or if the Pool Heater is under direct sunlight. Under these conditions, please wait until a cooler time of day before pressing the RESET BUTTON with a thin object and restart the heating system.

OPERATION

NOTE: Check the pool for correct installation and make sure both the pool's Inlet and Outlet Valves are fully covered with water before operating the Filter Pump or Sand Filter with the Pool Heater. Make sure that the Pool Heater and Filter Pump or Sand Filter are correctly connected.

1. Start the Filter Pump or Sand Filter according to the owner's manual.
2. With the pump operating, insert the plug of the Pool Heater into a socket, after test PRCD . The LED will light up for 0.5 seconds with a "beep" sound, and the LED displays **Ed**.
3. Press the "POWER" button for 2 seconds, the LED turns on and the heater starts to work, the LED display **5n**.
4. Press the "POWER" button for 2 seconds again, the Pool Heater will turn off.

NOTE: When the water temperature reaches the maximum temperature 40°C (104°F), the LED turns green.

NOTE: Never plug in the Pool Heater until the Filter Pump or Sand Filter has been plugged in.

WARNING: To prevent the risk of electrical shock, ensure your hands are completely dry when plugging-in the Filter Pump or Sand Filter and the Pool Heater.

NOTE: To prevent the risk of electrical shock, never run the Filter Pump or Sand Filter and the Pool Heater when people are in the pool.

NOTE: Do not dry run the Pool Heater. Damage caused by dry running the Pool Heater is not covered by the manufacturer's warranty.

5. Remember to disconnect the Pool Heater first. Never unplug the Filter Pump or Sand Filter when the Pool Heater is running.

6. Unplug the Filter Pump or Sand Filter and enjoy warm pool water!

MAINTENANCE

CAUTION: YOU MUST UNPLUG THE POOL HEATER FIRST, THEN

UNPLUG THE FILTER PUMP OR SAND FILTER BEFORE PERFORMING MAINTENANCE OR SEVERE RISK OF INJURY OR DEATH EXISTS.

1. Stop Water Flowing to the Filter Pump or Sand Filter and the Pool Heater:
 - a) Disconnect the Pool Heater and THEN the Filter Pump or Sand Filter.
 - b) Loosen the Hose Clamps on the pool's Inlet and Outlet Hoses.
 - c) Replace the Debris Screens with the Stopper Plugs in the pool's Inlet and Outlet Valves.
 - d) Refer to the Filter Pump or Sand Filter's Owner's Manual for information on Filter Pump or Sand Filter maintenance.
2. After Filter Pump or Sand Filter maintenance, replace the Stopper Plugs with the Debris Screens in the pool's Inlet and Outlet Valves. Water will now flow to the Filter Pump or Sand Filter and the Pool Heater.
3. Operate as outlined in the Operation section of this manual.

STORAGE

CAUTION: YOU MUST UNPLUG THE POOL HEATER AND THE FILTER PUMP OR SAND FILTER BEFORE MAINTENANCE BEGINS OR SEVERE RISK OF INJURY OR DEATH EXISTS.

To avoid damage, pool equipment must be winterized when temperatures are lower than 4°C (40°F). Allowing water to freeze will damage the Pool Heater and void the warranty.

NOTE: Do not leave the heater out in the open air for long periods of time. When it is not in use, please clean and dry it and then store it in a cool, dry place.

1. Follow the instructions previously outline to stop water flowing to the Filter Pump or Sand Filter and the Pool Heater.
2. Detach all hoses.
3. Drain any water in the Pool Heater and clean all components thoroughly.
4. Put the Pool Heater in a cool, dry place, out of children's reach.

OPERATING TIME TABLE

Pool Size (Bestway Above Ground Pools)		Time to increase by 1 degree Celsius
		Hours
Fast Set™ Pools	2.44m x 66cm (8' x 26")	1.4
	2.74m x 76cm (9' x 30")	2.2
	3.05m x 76cm (10' x 30")	2.2
	3.66m x 76cm (12' x 30")	2.9
	3.66m x 91cm (12' x 36")	3.6
	4.57m x 91cm (15' x 36")	6.5
	4.57m x 1.07m (15' x 42")	7.0
	4.57m x 1.22m (15' x 48")	9.0
Steel Pro™ Oval Pools	4.88m x 3.05m x 1.07m (16' x 10' x 42")	6.5
	5.49m x 3.66m x 1.22m (18' x 12' x 48")	10.0
	6.10m x 3.66m x 1.22m (20' x 12' x 48")	10.0
Round Frame Pools	2.44m x 51cm (8' x 20")	1.0
	2.44m x 61cm (8' x 24")	1.0
	3.05m x 76cm (10' x 30")	2.6
	3.05m x 1.00m (10' x 39.5")	3.6
	3.30m x 1.02m (130" x 40")	3.6
	3.66m x 76cm (12' x 30")	3.6
	3.66m x 1.00m (12' x 39.5")	6.0
	3.66m x 1.22m (12' x 48")	6.5
	4.27m x 1.22m (14' x 48")	10.0
Rectangular Frame Pools	4.57m x 91cm (15' x 36")	7.0
	4.57m x 1.22m (15' x 48")	10.0
	2.87m x 2.01m x 1.00m (113" x 79" x 39.5")	2.6
	3.00m x 2.01m x 66cm (118" x 79" x 26")	2.2
	4.00m x 2.11m x 81cm (157" x 83" x 32")	3.0
	4.04m x 2.01m x 1.00m (159" x 79" x 39.5")	4.0
	4.12m x 2.01m x 1.22m (162" x 79" x 48")	6.0
Hydrium Oval Pool	4.88m x 3.66m x 1.22m (16' x 12' x 48")	10.0
Hydrium Pool	3.66m x 1.22m (12' x 48")	6.5
Hydrium Pool	3.05m x 1.22m (10' x 48")	4.0

Water capacity (Calculated at 90% for Frame Pool and 80% for Fast Set & Oval Pool)		Time to increase by 1 degree Celsius
Gallons	Liters	Hours
500	1,890	1.0
1,000	3,750	2.5
1,500	5,680	3.0
2,000	7,500	4.0
2,500	9,460	6.0
3,000	11,350	7.0
3,500	13,250	8.0
4,500	17,035	10.0

NOTICE:

- The table above is for reference only. Data are relevant for a covered pool with water at 25 degrees Celsius on a clear day.
- Ambient air and water temperature has an effect on water heating efficiency.