

**EKSA** Telecom

**H5**

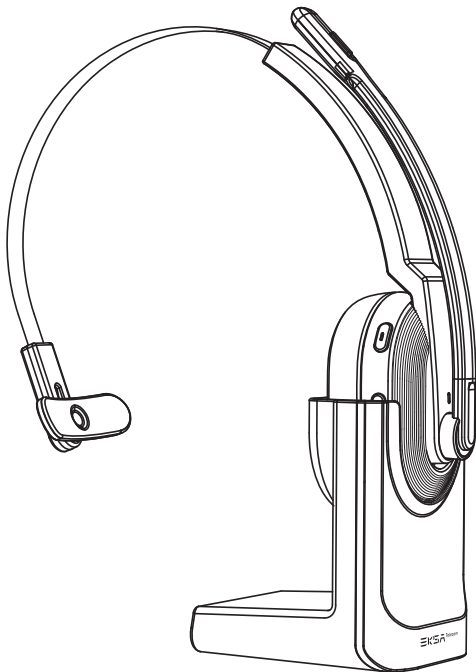

**User Manual**



# Package Contents

- ① EKSAtelecom H5 Wireless Headset
- ② EKSA PC Adapter
- ③ Type-C Charging Cable
- ④ Charging Stand
- ⑤ Carry Pouch
- ⑥ User Manual

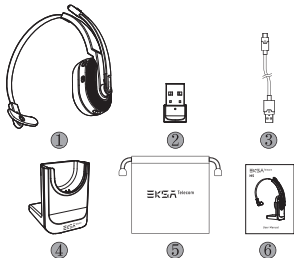

# Specifications

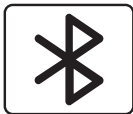

Headset Bluetooth Version: 5.0  
 Adapter Bluetooth Version: 5.2  
 Effective Wireless Range: 10 m / 32 ft



Music Time: ≈45 hours (70% volume)  
 Talk Time: ≈25 hours (70% volume)  
 Charging Time: ≈1.5 hours



Speaker Diameter: 30 mm  
 Impedance:  $32 \Omega \pm 15\%$   
 Sensitivity:  $125 \pm 3$  dB  
 Frequency Response: 20 Hz – 20 kHz



Size: 2.7 mm \* 1.85 mm  
 Sensitivity:  $-25 \pm 1$  dB  
 Frequency Response: 100 Hz – 10 kHz  
 Impedance: 2.2 k $\Omega$   
 Polar Pattern: Omnidirectional  
 Mic: EKSAtelecom VoicePure Technology



# Product Overview

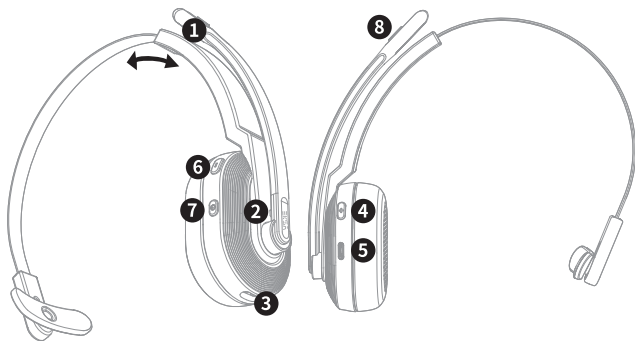

❶ 🎤 EKSAtelecom VoicePure Technology

❷ 📶 Bluetooth & Charging Indicator

❸ 🔌 Charging Contacts

❹ + Volume + / next track

❺ 🔌 Type-C Charging Port

❻ 📶 Volume - / previous track

❼ 📶 Multi-Function Button (MFB)

❽ 📶 Mic Mute Button

❾ 🔌 Type-C Charging Port

❿ • Charging Indicator

⓫ 📶 EKSA PC Adapter

⓬ 🔌 Charging Contacts

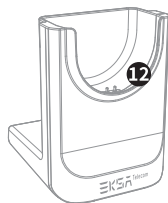
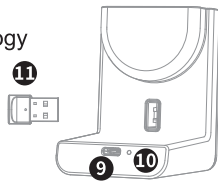



# Operation Guide



## Multi-Function Button:



Press for 3 seconds: Headphone on/off



Click: Play/Pause



Triple Click: Voice Assistant/Siri



## Volume Button:



Click: Volume + / -



Press for 2 seconds to next/previous track



## Mic Mute Button:



Click: Microphone on/off



# Call Functions

## Call Handling:

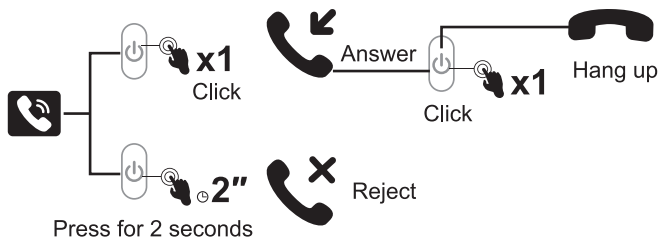

## Redial:

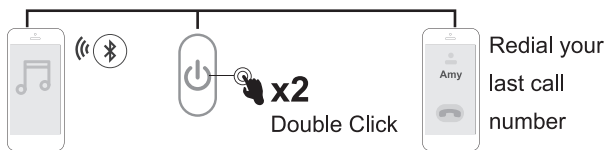

## Audio Switching:



Press for 2 seconds:

During a call, you can switch your audio device.



# Call Functions



## Three-Way Calling:

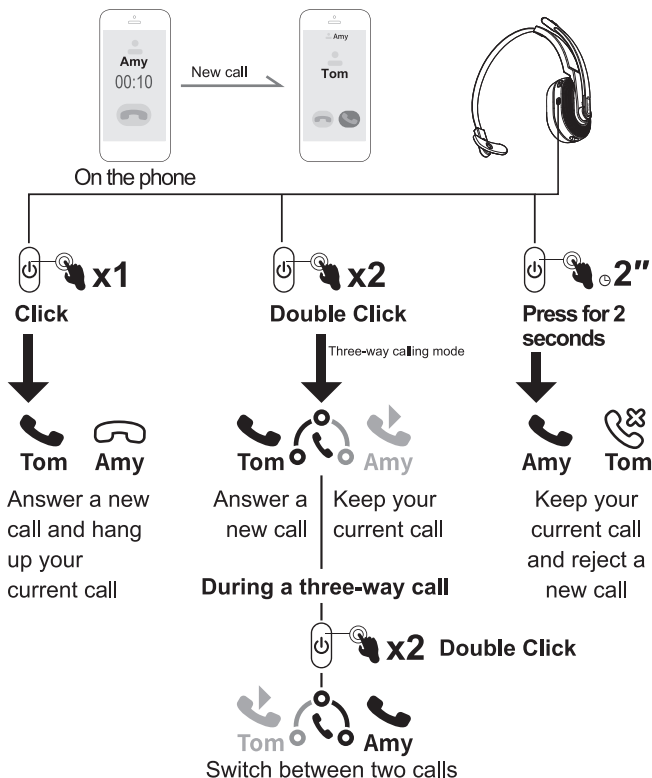



# Bluetooth Pairing

## Mobile Phone:

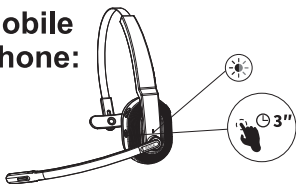

1. Turn on EKSAtelecom H5, until its Bluetooth indicator flashes alternately between red and blue, indicating that the headset is in pairing mode.

2. Turn on the Bluetooth of your device, activate the search feature, and select "EKSA-H5". After pairing, the Bluetooth indicator flashes slowly in blue light with a voice prompt "**your headset is connected**", confirming a successful connection.

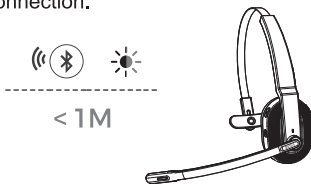
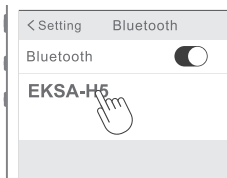

### Note:



1. Ensure that the distance between the EKSAtelecom H5 and the device you want to pair should be kept within 1 meter.
2. If necessary, the pin code to complete pairing is "0000".
3. While in pairing state, if a connection cannot be established within 10 minutes, the headset **will** automatically turn off.
4. When the headset is turned on again, it **will** connect to the last connected device automatically.

3. To connect to a new device, turn off the Bluetooth of the currently paired device and follow the above steps to connect successfully to a new device.

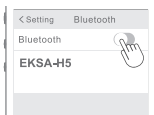

device A

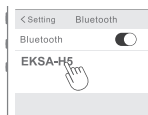

device B





# Bluetooth Pairing

## PC:

If you want to connect the headset to a PC, you can use the EKSA PC adapter provided in the package. Then, you can enjoy the call function and compatibility of the third-party software of the PC. Follow the steps below to get it done.

1. Plug the EKSA PC adapter into your PC's USB port. The adapter will turn on automatically with a name of "EKSA PC Adapter" displaying on your computer.

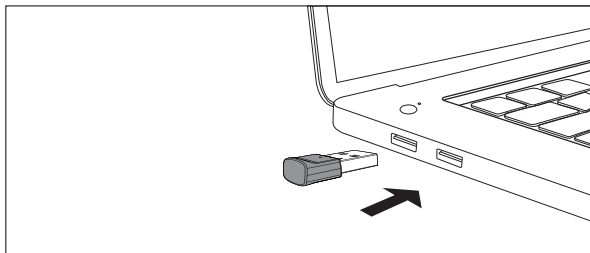

USB-A interface

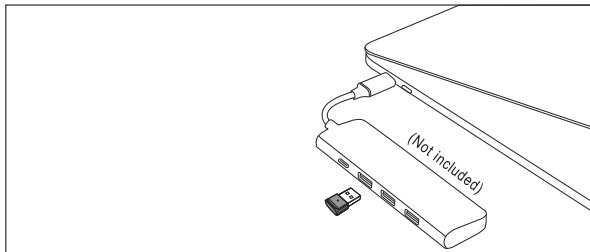

Type-C interface





# Bluetooth Pairing

- When enabled, the indicator on the EKSA PC adapter will flash a blue light, which indicates that it is in pairing mode. Then, put the headset on pairing mode and place it as close to the EKSA PC adapter as possible (within 8 inches). The headset will automatically connect to the EKSA PC adapter.

Note: It takes about 20 seconds to establish a connection between the headset and a PC for the first time. Suppose the connection is unsuccessful, please unplug the adapter and plug it back into the PC. Then restart the headset's pairing mode and reconnect to your computer.

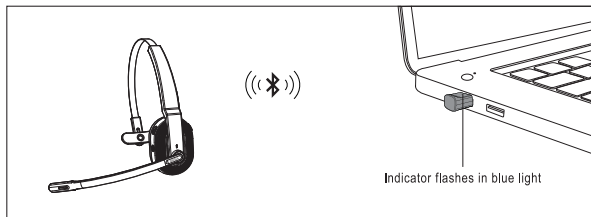

USB-A interface

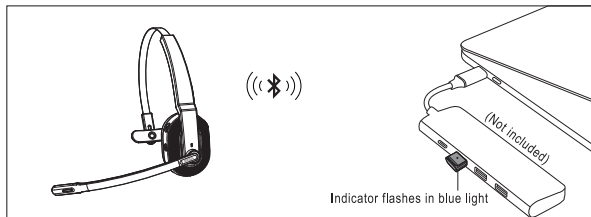

Type-C interface

- After the headset is successfully connected, the Bluetooth indicator on the headset will slowly flash a blue light while the EKSA PC adapter's indicator will always be blue.

Note: When the EKSA PC adapter is not in use, please insert the adapter into the storage hole of the charging stand to avoid misplacing it.



# Dual Pairing

1. After successfully connecting the EKSAtelecom H5 to device A, turn off the Bluetooth of device A. The headset's Bluetooth indicator flashes in red and blue alternately to signify pairing mode.

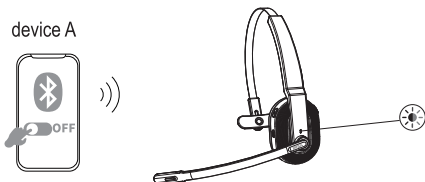

2. Turn on the Bluetooth of device B, activate search mode, and connect to "EKSA-H5".

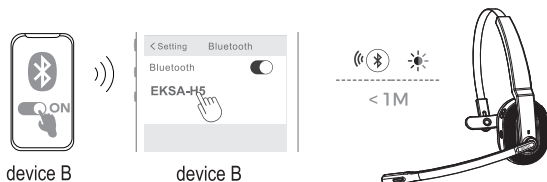

3. Turn on the Bluetooth of device A to connect with "EKSA-H5". This puts both devices A and B in a simultaneous connection with "EKSA-H5".

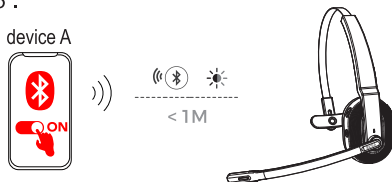

## Reset

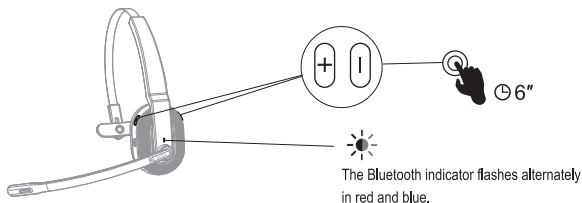

When EKSatelecom H5 is in connected/pairing mode, press and hold the "volume + " and "volume - " buttons simultaneously for 6 seconds until the LED lights up in red and blue, indicating the pairing information is cleared.

## Charging

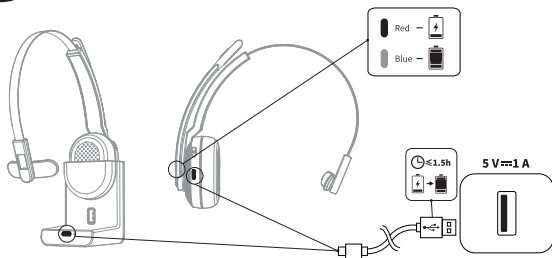

1. When the battery is less than 10%, the headset will give a voice prompt "**battery low**" every 3 minutes. Please charge it as soon as possible.
2. When EKSatelecom H5 is not in use, please charge it at least once every 2 months.
3. Please use the original charging cable for charging. Charging voltage can't exceed 5 V.

# **Limited Warranty / 保証 / Garantie Limitée / Eingeschränkte Garantie / Garantía Limitada / Garanzia Limitata**

Our friendly customer service team is ready and waiting to help. Feel free to contact us:

私たちのカスタマーサービスチームはいつでもお手伝いします。連絡先は次のとおり:

Notre amicale équipe de service à la clientèle est prête et attend de vous aider. N'hésitez pas à nous contacter :

Unser freundliches Kundenservice-Team ist bereit, Ihnen zu bedienen. So können Sie uns kontaktieren:

Nuestro amable equipo de servicio al cliente está listo y esperando para ayudarlo. Bienvenido a contactarnos:

Il nostro cordiale team di assistenza clienti è pronto e in attesa di aiutare. Non esitate a contattarci:

☎ GLOBAL: +852 6940 4955 (Mon to Fri 9:00 am-6:30 pm, UTC +8 HKT)  
INDIA: +91-8929-369-620 (Mon to Fri IST 9:30 am-5:30 pm)

✉ GLOBAL: [info@eksatelecom.com](mailto:info@eksatelecom.com)  
INDIA: [support@eksatelecom.co.in](mailto:support@eksatelecom.co.in)

🌐 [www.eksatelecom.com/pages/warranty](http://www.eksatelecom.com/pages/warranty)

Manufacturer: YI ZHAO (SHENZHEN) CO., LIMITED

Add.: 6th Floor, T3 Creative Building, Shenzhen Colorful Huiwei  
Cultural and Creative Expo City, No.5010 Baoan Avenue, Caowei  
Community, Hangcheng Street, Baoan District, Shenzhen City,  
Guangdong Province, China



C&E Connection E-Commerce (DE) GmbH

Add.: Zum Linnegraben 20, 65933, Frankfurt am Main, Germany

Tel.: +4906927246648

Email: info@ce-connection.de



APEX CE SPECIALISTS LIMITED

Add.: 89 Princess Street, Manchester, M1 4HT, UK

Tel.: +441616371080

Email: info@apex-ce.com



FR

Cet appareil,  
ses accessoires  
et piles  
se recyclent

À DÉPOSER  
EN MAGASIN



OU

À DÉPOSER  
EN DÉCHÈTERIE



Points de collecte sur [www.quefairedemesdechets.fr](http://www.quefairedemesdechets.fr)  
Privilégiez la réparation ou le don de votre appareil !



FR

BARQUETTE  
+ ÉTUI



R 214-116997



R 214-117078



FCC ID: WSG-M7

FCC ID: WSG-KH50

Made in China

**Be Heard Anywhere**