

**NiTHO**

# ***DRIVE PRO® ONE***

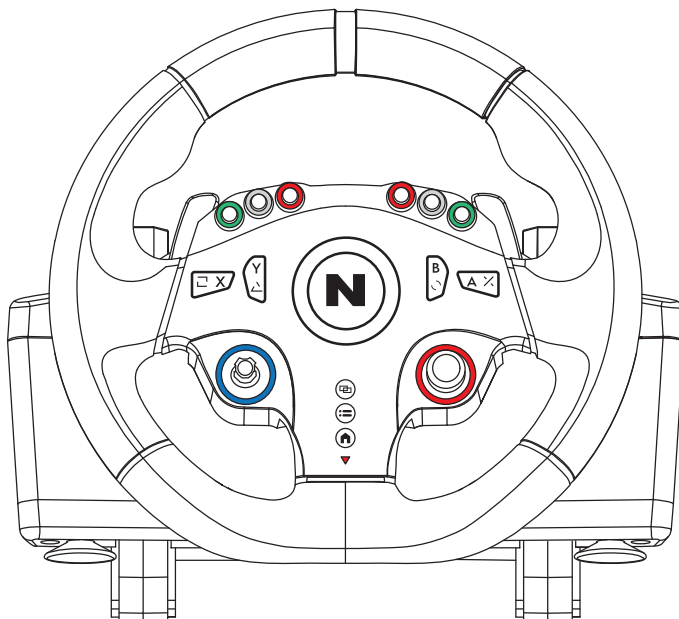

Quick start guide

Thank you for choosing NITHO ***DRIVE PRO® ONE***

This start guide will help you through the racing wheel's basic setup for all platforms.

The setup has been developed and tested on every level of racing difficulty.

From the beginners to experienced drivers, NITHO ***DRIVE PRO® ONE***

is greatly performing in all kinds of racing games as Gran Turismo, Rally, Formula 1, Formula Drift and allows you to win the podium.

BE THE ***ONE*** !

## Main features

- DRIVE PRO™ ONE racing wheel performs in all main gaming platforms: PC, PS4®, PS3®, Xbox®One, Xbox®Series X/S and Nintendo® Switch®
- PC can be setup in both D-Input and X-Input modes
- Zero deadzone technology for PS4®, Xbox® (all versions) and PC D-Input
- 28 buttons designed for in-race comfort and quick actions
- D-pad stick allows a quicker menu selection and easy in-race control
- Analog stick can be setup as view control or as a D-pad
- Hardened metallic paddles increasing shifting feeling and providing higher race immersion
- Solid clamps can be fastened to any desk with 5.5 cm maximum thickness
- Removable and sturdy suction cups
- Analog and metal plated accelerator and brake pedals
- Separated sequential gear shifter ideal for rally and formula drift races

Play Hard!  
With NITHO

# Index

Page 1.....	Package content
Page 2.....	First setup
Page 3.....	Clamps installation
Page 4.....	LED compatibility indicator
Page 5.....	PlayStation®4 setup
Page 7.....	Xbox®One setup
Page 8.....	Xbox®Series X S setup
Page 10.....	PC D-input setup
Page 12.....	PC X-input setup
Page 14.....	Nintendo® Switch® setup
Page 16.....	PlayStation®3 setup

# Package content

- (1) Racing wheel
- (2) Sequential gear shifter
- (3) Pedals set
- (4) Connection cable USB-A to USB Micro B (for PS4® or Xbox®One controller)
- (5) Connection cable USB-A to USB-C (Type C) (for Xbox®Series X/S controller)
- (6) Connection cable LAN to LAN (for gear shifter)

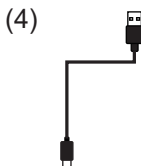
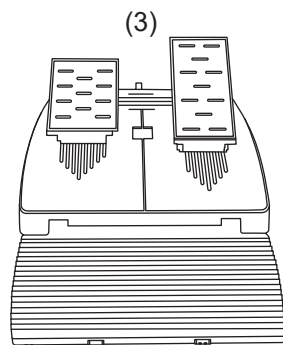
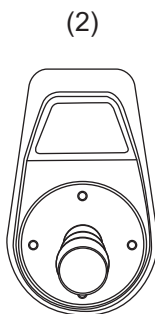
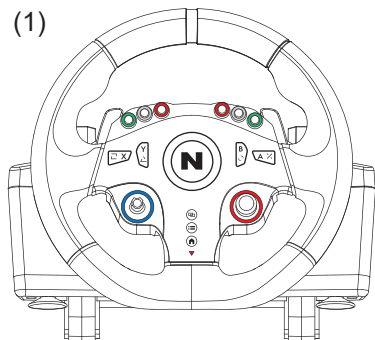

PS4® and Xbox®One

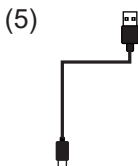

Xbox®Series X/S

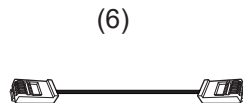

# First setup

The following step is same for all the platforms:

- (1) Fasten the racing wheel to a steady desk or wheel stand
- (2) Connect the pedals to the wheel by the LAN port on the back side
- (3) Secure the gear shifter to a steady structure and use the provided detachable LAN cable to connect it to the dedicated port on the back of the wheel

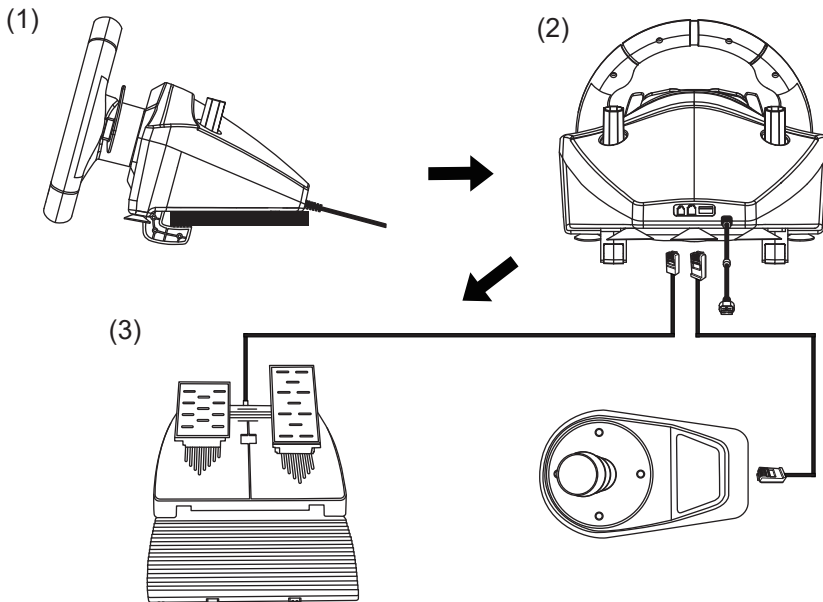

# Clamps installation

- (1) 2x C-shape clamps
- (2) 2x Fastening bolts
- (3) 2x Removable extensions

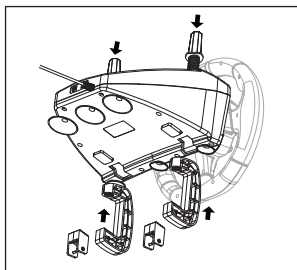
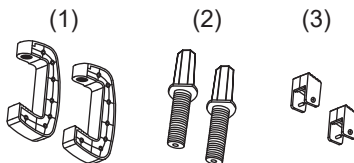

Step 1 - Insert the bolts from the top and the clamps from the bottom, then fasten them together.

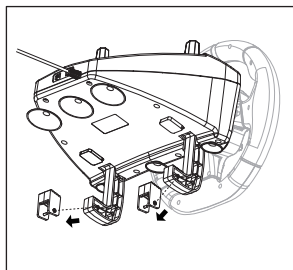

Step 2 - The extensions can be removed if the wheel is mounted on a thick desk.

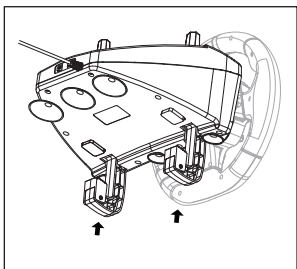

Step 3 - Fasten the clamps according to the thickness of the desk.

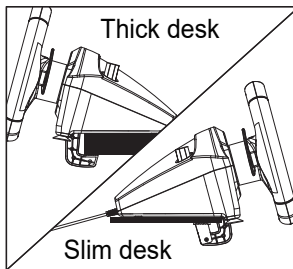

# LED compatibility indicator

Different colours LED light indicates to which console the wheel is connected.



Blue - Indicates the connection with PlayStation®



Green - Indicates the connection with Xbox®



Purple - Indicates the connection with PC (D-Input)



Orange - Indicates the connection with PC (X-Input)



Red - Indicates the connection with Nintendo® Switch®

# PlayStation®4 setup

- (1) After you have setted the wheel and gear shifter as indicated in page 2, connect the original SONY® controller to the wheel with the USB-A to USB Micro B cable, provided in the packaging.
- (2) Connect the wheel to the console's USB port and turn the console on.
- (3) The wheel's LED automatically switch on blue colour, then press the PS® button on the wheel.
- (4) At this point, the wheel is ready. Play the game and customize your in-game setup, following the “PS4® buttons layout” as displayed in page 6.

## Note:

In case you lose the USB-A to USB Micro B cable, you can replace it with any similar cable available in the market, paying attention that it has DATA function.

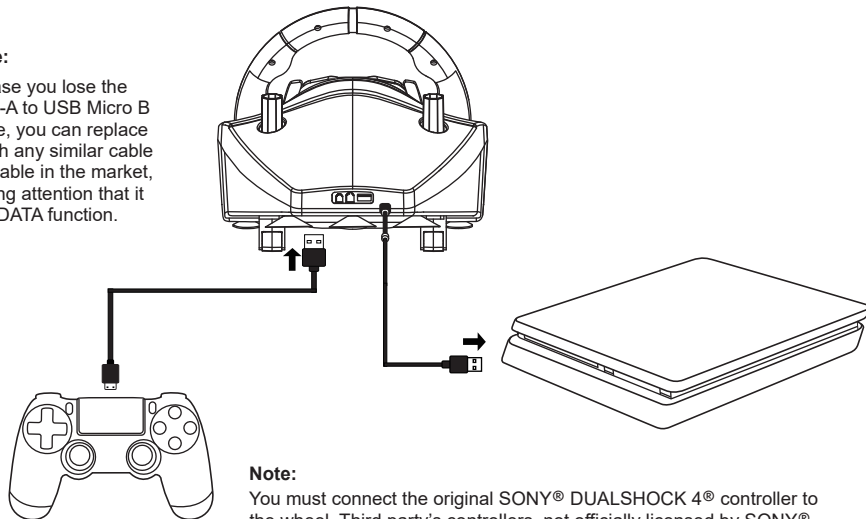

## Note:

You must connect the original SONY® DUALSHOCK 4® controller to the wheel. Third party's controllers, not officially licensed by SONY®, are not going to work.



# PS4® buttons layout

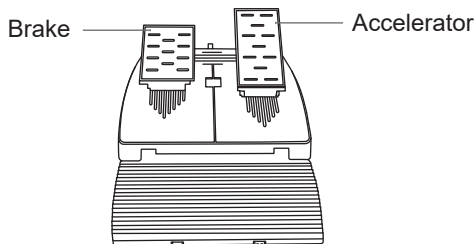
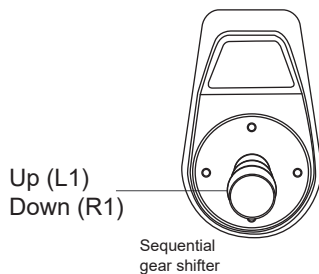
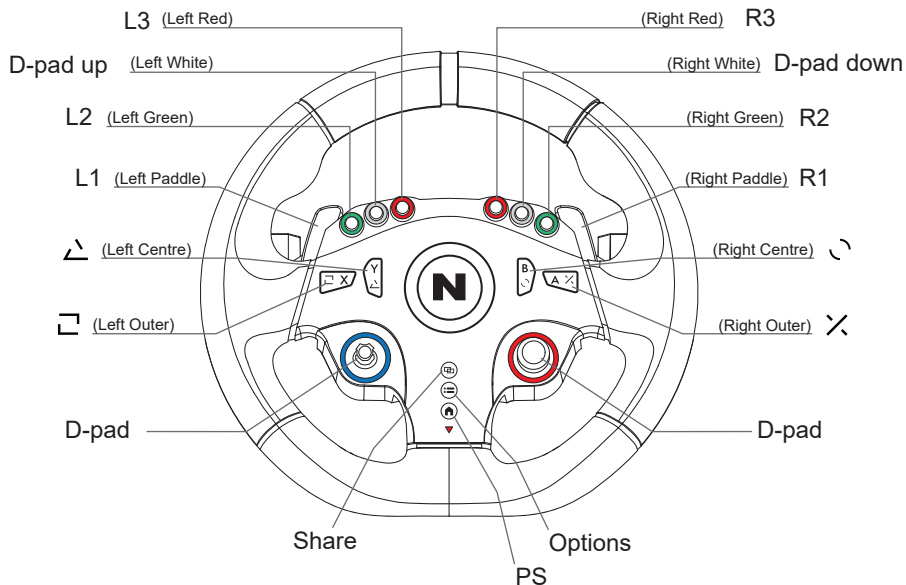

# Xbox®One setup

- (1) After you have setted the wheel and gear shifter as indicated in page 2, connect the original Xbox® One controller to the wheel with the USB-A to USB Micro B cable, provided in the packaging.
- (2) Connect the wheel to the console's USB port and turn the console on.
- (3) The wheel's LED automatically switch on green colour, then press the Home button on the wheel.
- (4) At this point, the wheel is ready. Play the game and customize your in-game setup, following the "Xbox® One buttons layout" as displayed in page 9.

**Note:**

In case you lose the USB-A to USB Micro B cable, you can replace it with any similar cable available in the market, paying attention that it has DATA function.

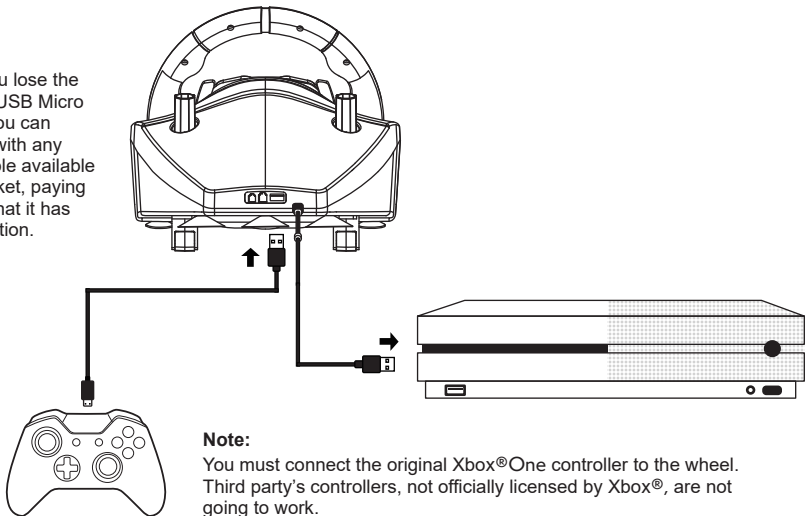

**Note:**

You must connect the original Xbox®One controller to the wheel. Third party's controllers, not officially licensed by Xbox®, are not going to work.

# Xbox®Series X|S setup

- (1) After you have setted the wheel and gear shifter as indicated in page 2, connect the original Xbox®Series X|S controller to the wheel with the USB-A to USB-C Type C cable, provided in the packaging.
- (2) Connect the wheel to the console's USB port and turn the console on.
- (3) The wheel's LED automatically switch on green colour, then press the Home button on the wheel.
- (4) At this point, the wheel is ready. Play the game and customize your in-game setup, following the "Xbox®Series X|S buttons layout" as displayed in page 9.

## Note:

In case you lose the USB-A to USB-C cable, you can replace it with any similar cable available in the market, paying attention that it has DATA function.

## Note:

You must connect the original Xbox®Series X|S controller to the wheel. Third party's controllers, not officially licensed by Xbox®, are not going to work.

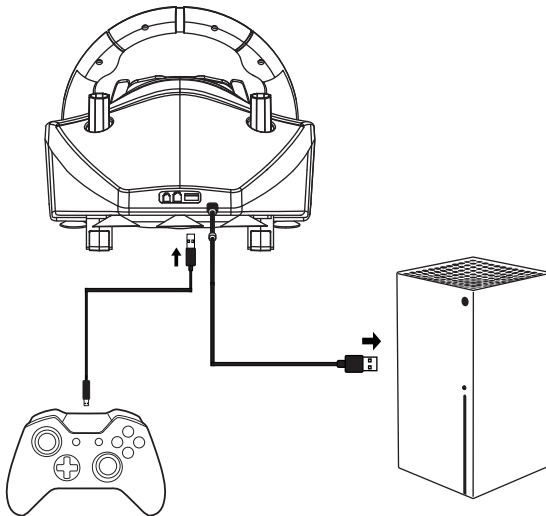

# Xbox® One & Xbox® Series X|S

## buttons layout

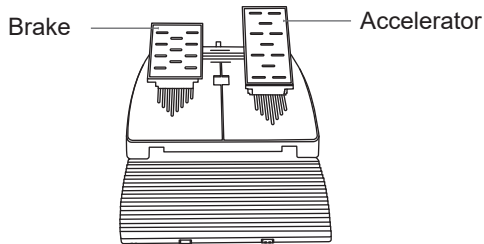
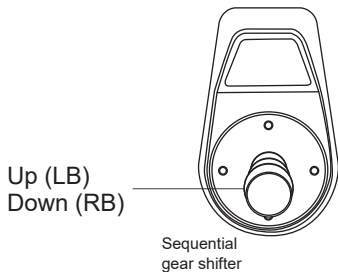
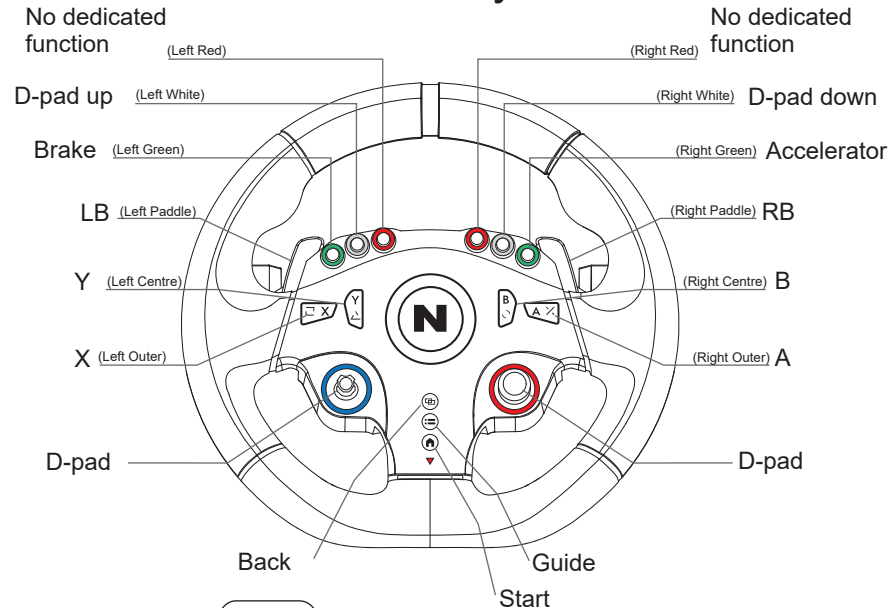

# PC D-Input setup

- (1) After you have setted the wheel and gear shifter as indicated in page 2, connect the wheel to the PC's USB port.
- (2) The wheel's LED automatically switch on purple colour.
- (3) At this point, the wheel is ready. Play the game and customize your in-game setup, following the "PC D-Input buttons layout" as displayed in page 11.

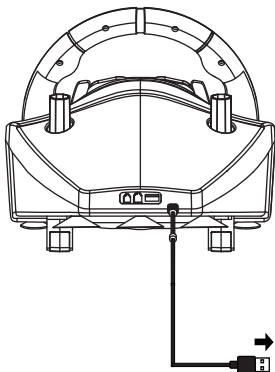

**Note :**

From D-Input is possible to switch to X-Input pressing the button 13 (Home) for few seconds until the LED light changes color to orange.

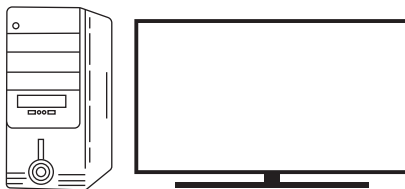

# PC D-Input buttons layout

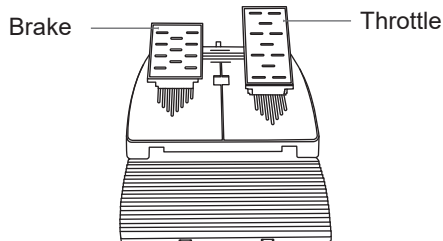
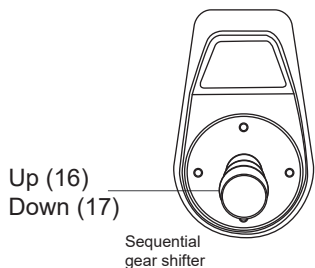
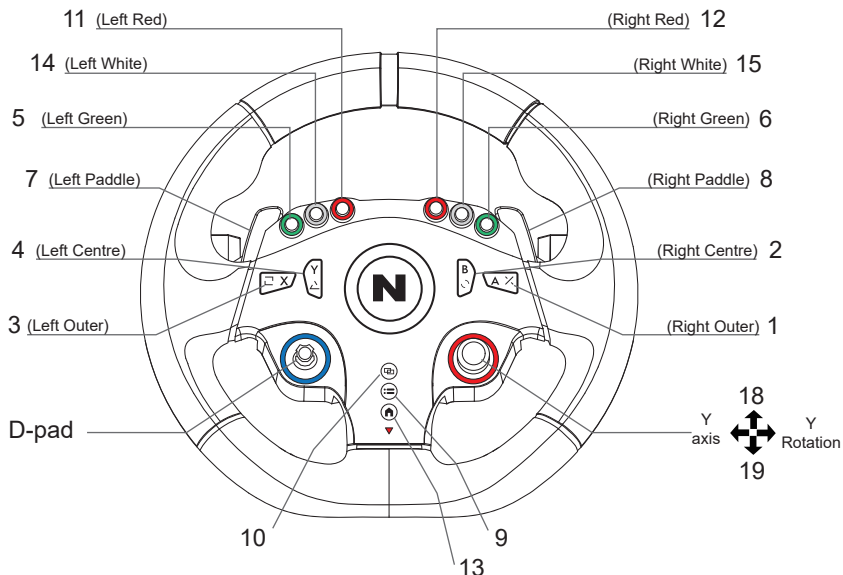

# PC X-Input setup

- (1) After you have setted the wheel and gear shifter as indicated in page 2, connect the wheel to the PC's USB port.
- (2) The wheel's LED automatically switch on orange colour.
- (3) At this point, the wheel is ready. Play the game and customize your in-game setup, following the "PC X-Input buttons layout" as displayed in page 13.

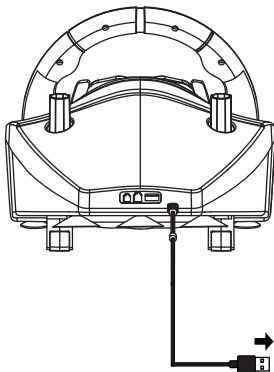

**Note :**

From X-Input is possible to switch to D-Input pressing the button 13 (Home) for few seconds until the LED light changes color to purple.

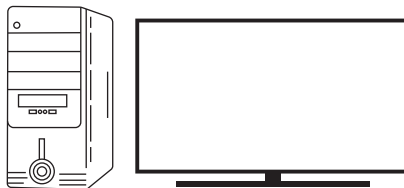

# PC X-Input buttons layout

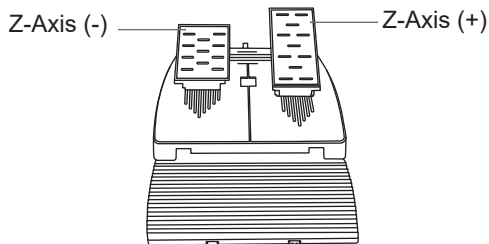
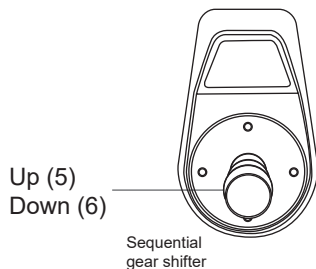
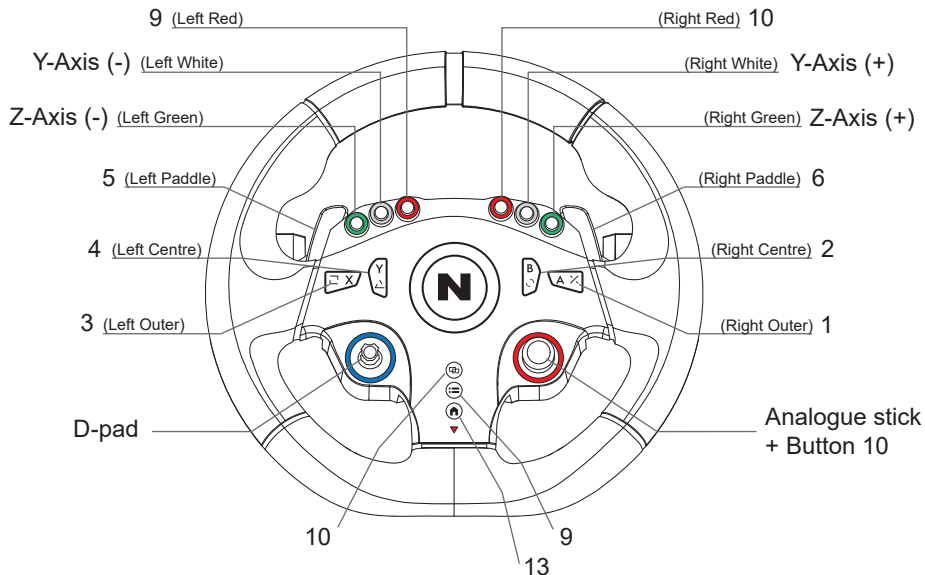



# Nintendo® Switch® setup

- (1) After you have setted the wheel and gear shifter as indicated in page 2, connect the wheel to the Switch® Dock's USB port and turn the console on.
- (2) The wheel's LED automatically switch on red colour, then press the Home button on the wheel.
- (3) At this point, the wheel is ready. Play the game and customize your in-game setup, following the "Switch® buttons layout" as displayed in page 15.

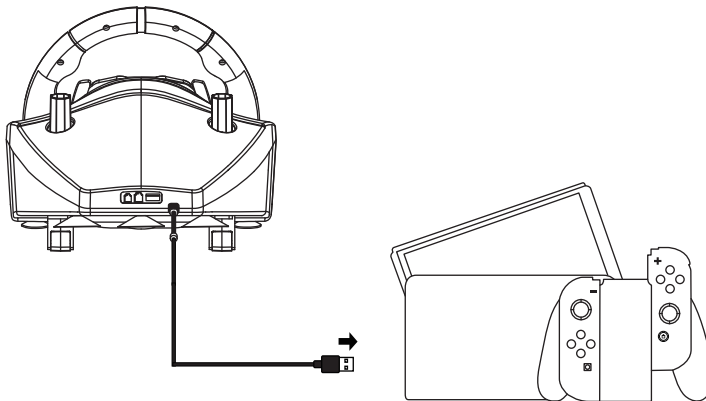

# Nintendo® Switch® buttons layout

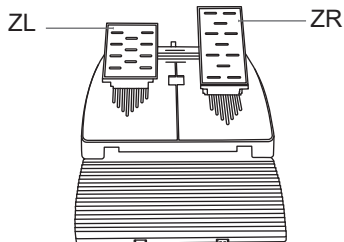
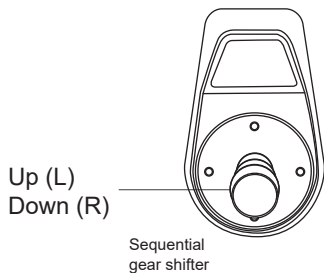
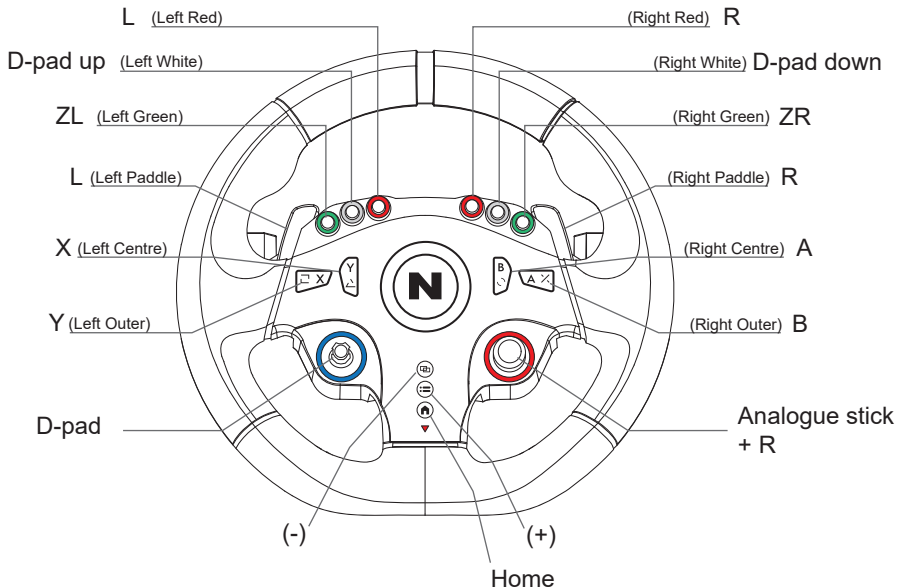

# PlayStation®3 setup

- (1) After you have setted the wheel and gear shifter as indicated in page 2, connect the wheel to the PS3® USB port and turn the console on.
- (2) The wheel's LED automatically switch on blue colour, then press the Home button on the wheel.
- (3) At this point, the wheel is ready. Play the game and customize your in-game setup, following the “PS3® buttons layout” as displayed in page 17.

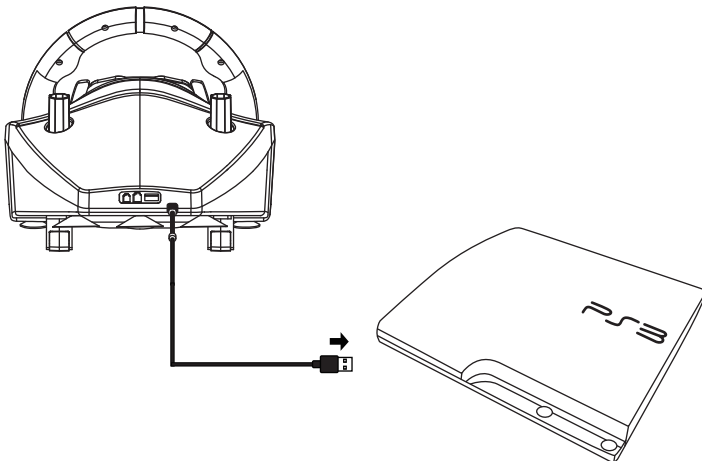

# PS3® buttons layout

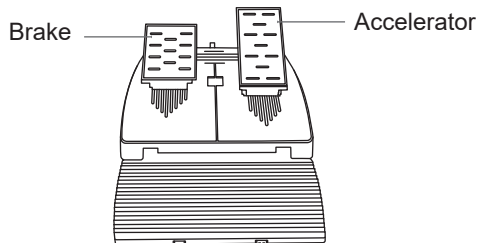
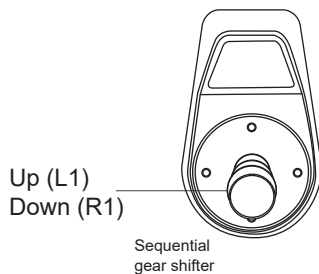
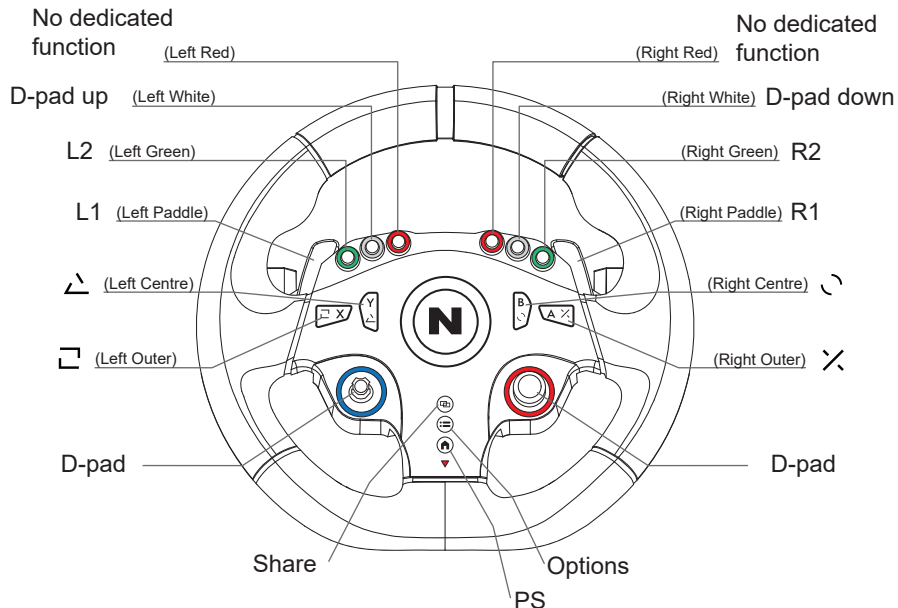

# Sequential gear shifter

- Sequential gear shifter
- Adjustable table mounting

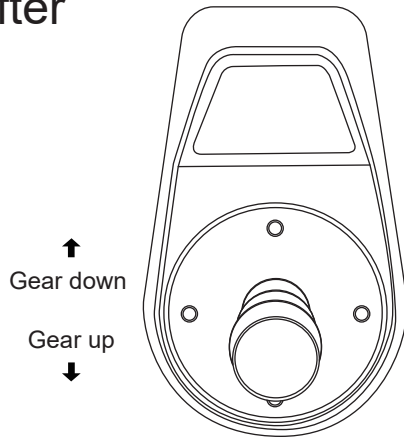

## Pedal set

- Potentiometered (analog) pedals
- Metal plated
- Foldable footrest

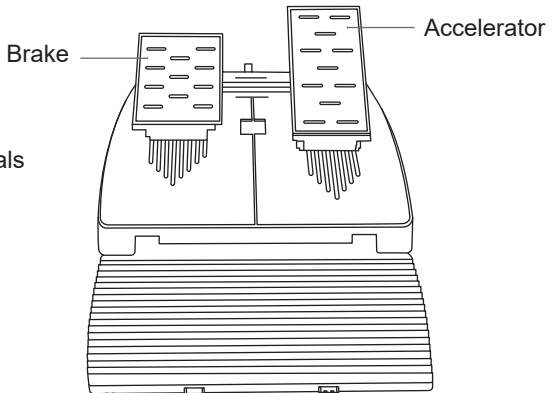

# NiTHO

[www.nitho.com](http://www.nitho.com)

## SERVICE & SUPPORT

For any question and support contact us on:

[support@nitho.com](mailto:support@nitho.com)  
or visit [www.nitho.com](http://www.nitho.com)

All other copyrights, marks and trademarks are property of their respective owners.

This product is not designed, manufactured, sponsored or endorsed by Nintendo®  
Co., Ltd., Sony® Computer Entertainment Inc. or Microsoft® Corporation.



[SUPPORT@NITHO.COM](mailto:SUPPORT@NITHO.COM)



[WWW.NITHO.COM](http://WWW.NITHO.COM)



[NITHOGAMES](https://www.facebook.com/NITHOGAMES)



[NITHOGAMES](https://www.instagram.com/NITHOGAMES)

**NiTHO**

# ***DRIVE PRO<sup>®</sup> ONE***

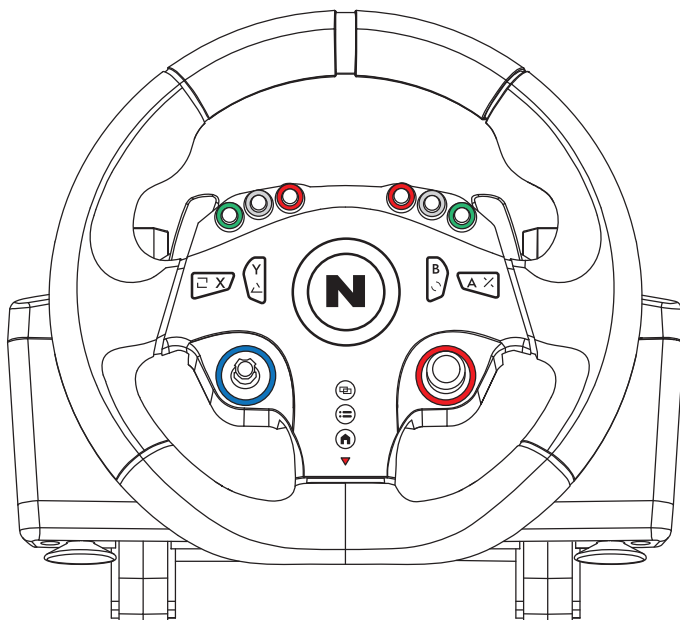

**快速使用手冊**

感谢您选购 NITHO *DRIVE PRO® ONE*

本使用指南将帮助您完成所有游戏平台的赛车方向盘基本安装。

本安装已针对各种级别的赛车难度进行了开发和测试。

从初学者到经验丰富的驾驶，*DRIVE PRO® ONE*

在 Gran Turismo、Rally、Formula 1、Formula Drift 等各种赛车游戏中表现出色，并帮助您站上领奖台。

BE THE *ONE* !

## · 主要功能

- DRIVE PRO™ ONE 赛车方向盘可在所有主要游戏平台上运作：PC, PS4®, PS3®, Xbox®One, Xbox®Series X/S 和 Nintendo® Switch®。
- PC 可以设定为 D-Input 或 X-Input 模式。
- 零死角技术可适用于 PS4®, Xbox® (所有版本) and PC D-Input。
- 28个按钮专为赛车比赛中的舒适性和快速反应而设计。
- D-pad摇杆式方向键方便更快的选单操作和轻松的比赛控制。
- 类比摇杆可以设定为视角操作或方向键D-pad。
- 强化金属换挡拨片增加换挡手感，并提升游戏沉浸感。
- 稳固的C型夹具，可以固定在最大厚度为5.5厘米的桌子上。
- 可拆卸且强力的吸盘。
- 仿真金属的电镀加速器及刹车踏板。
- 独立式排档杆，最适合拉力赛和方程式甩尾的游戏比赛。

Play Hard!

With NITHO



# 目 录

第1页.....	包装内容
第2页.....	第一次安装
第3页.....	夹具安装
第4页.....	LED 相容性指示灯
第5页.....	PlayStation®4 设定
第7页.....	Xbox®One 设定
第8页.....	Xbox®Series X S 设定
第10页.....	PC D-input 设定
第12页.....	PC X-input 设定
第14页.....	Nintendo® Switch® 设定
第16页.....	PlayStation®3 设定

# 包装内容

- (1) 赛车方向盘
- (2) 独立序列式排档杆
- (3) 踏板组
- (4) USB 连接线 USB-A 转 USB Micro B（用于 PS4® 或 Xbox®One 手柄）
- (5) USB 连接线 USB-A 转 USB-C（用于 Xbox®Series X/S 手柄）
- (6) 排档杆连接线

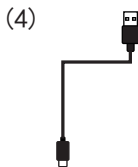
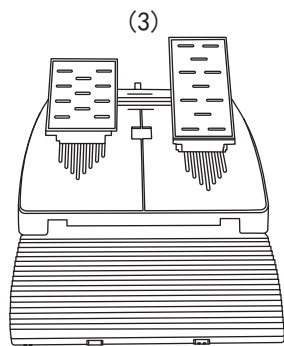
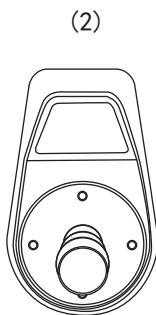
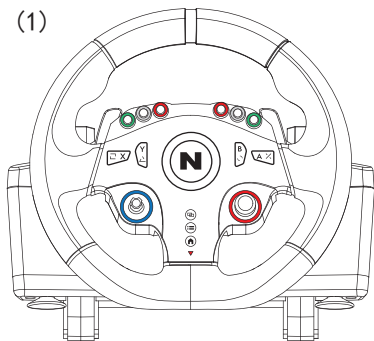

PS4® 和 Xbox®One

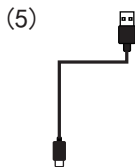

Xbox®Series X/S

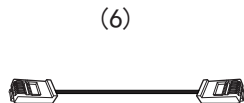

# 第一次安装

以下步骤适用所有游戏平台：

- (1) 将赛车方向盘固定在稳固的桌面或方向盘支架上
- (2) 将踏板连接到方向盘背面的 LAN 端口
- (3) 将排档杆固定在稳固的地方，并使用包装内的连接线将其连接到方向盘背面的专用端口

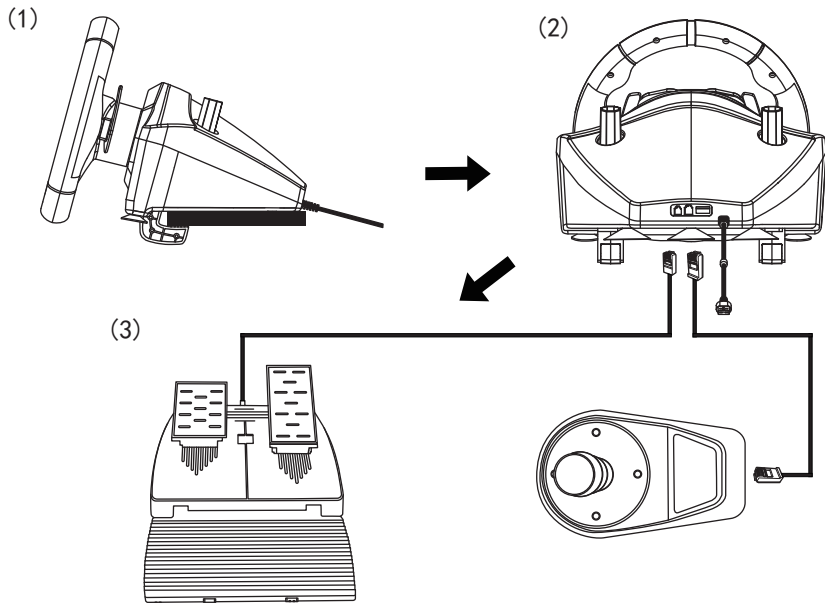

# 夹具安装

- (1) 2个C型夹具
- (2) 2个紧固螺栓
- (3) 2个可拆卸脚垫

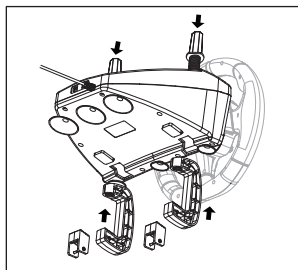
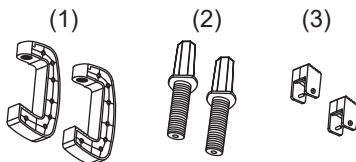

步骤1 - 从顶部插入螺栓，从底部插入夹具，然后将螺栓对准夹具螺丝式锁入。

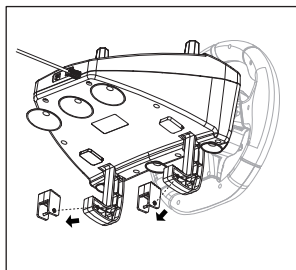

步骤2 - 如果方向盘安装在较厚的桌面，可将脚垫加高部分单独拆除后安装。

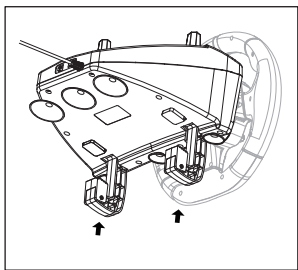

步骤3 - 根据桌子的厚度锁紧夹具。

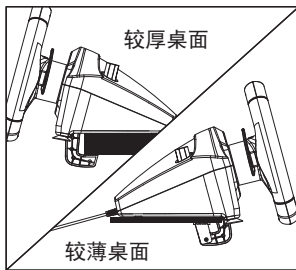

# LED相容性指示灯

不同颜色的 LED 指示灯代表方向盘连接到哪个游戏平台。



蓝色 - 表示与 PlayStation® 连接



绿色 - 表示与 Xbox® 连接



紫色 - 表示 PC (D-Input) 连接



橙色 - 表示与 PC (X-Input) 连接



红色 - 表示与 Nintendo® Switch® 连接

# PlayStation®4 设定

- (1) 按照第 2 页所示设置好方向盘和排档杆后，使用包装中提供的 USB 线(4) 将原厂 SONY® 手把连接到方向盘。
- (2) 将方向盘连接到主机的 USB 端口并打开电源。
- (3) 方向盘的 LED 会自动亮起蓝色，然后按下方向盘上的 PS® 按钮。
- (4) 此时，方向盘已准备就绪，按照第 6 页所示的“PS4® 按钮布局”开始游戏并进行您的游戏设定。

## 备注：

如果您遗失了 USB-A 转 USB Micro B 连接线，您可以用市面上任何类似的连接线替代，注意需有数据传输功能。

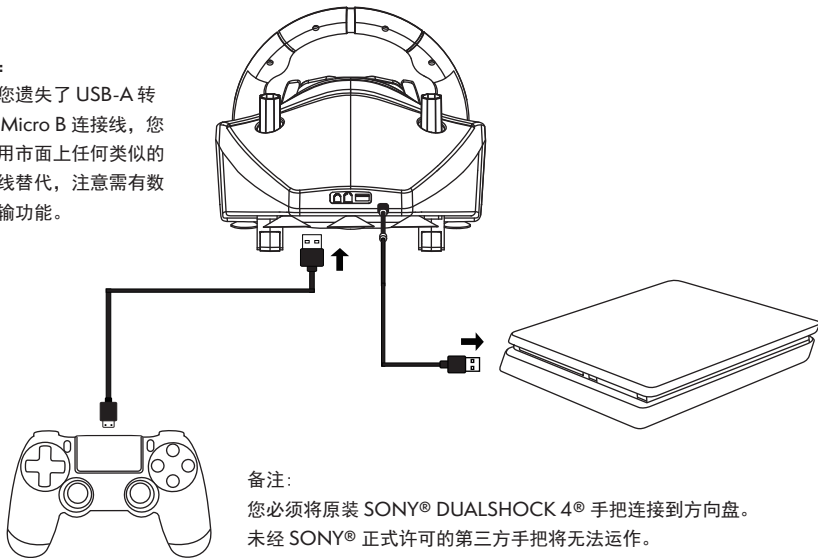

## 备注：

您必须将原装 SONY® DUALSHOCK 4® 手把连接到方向盘。  
未经 SONY® 正式许可的第三方手把将无法运作。

# PS4® 按键布局

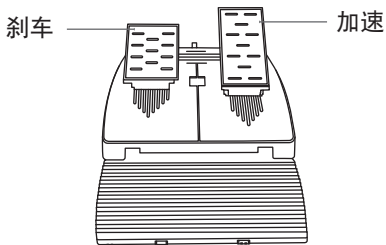
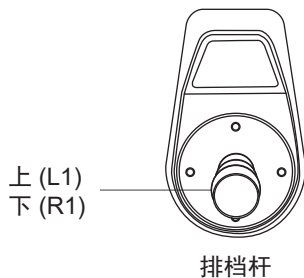
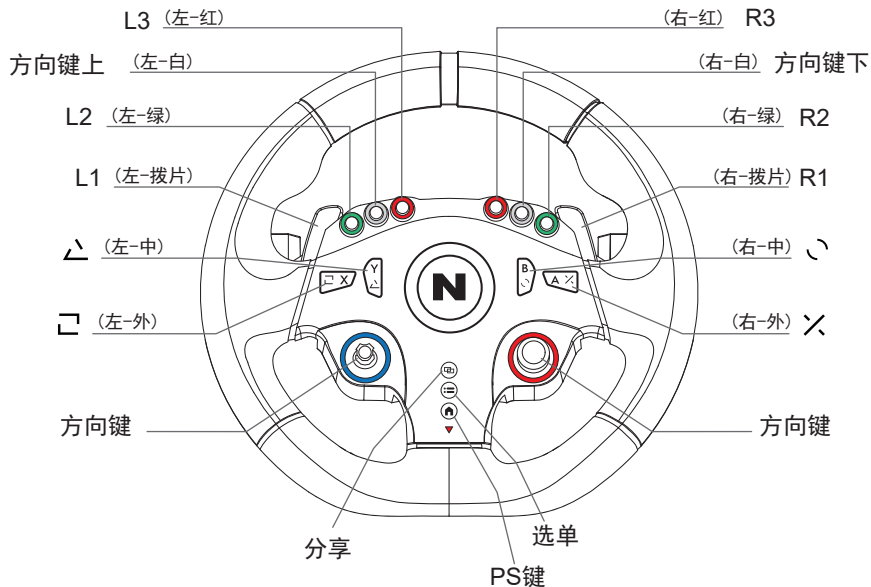

# Xbox®One 设定

- (1) 按照第 2 页所示设置好方向盘和排档杆后，使用包装中提供的 USB 线 (4) 将原厂 Xbox® 手把连接到方向盘。
- (2) 将方向盘连接到主机的 USB 端口并打开电源。
- (3) 方向盘的 LED 会自动亮起绿色，然后按下方向盘上的首页按钮。
- (4) 此时，方向盘已准备就绪。按照第 9 页所示的“Xbox®One 按钮布局”开始游戏并进行您的游戏设定。

## 备注：

如果您遗失了 USB-A 转 USB Micro B 连接线，您可以用市面上任何类似的连接线替代，注意需有数据传输功能。

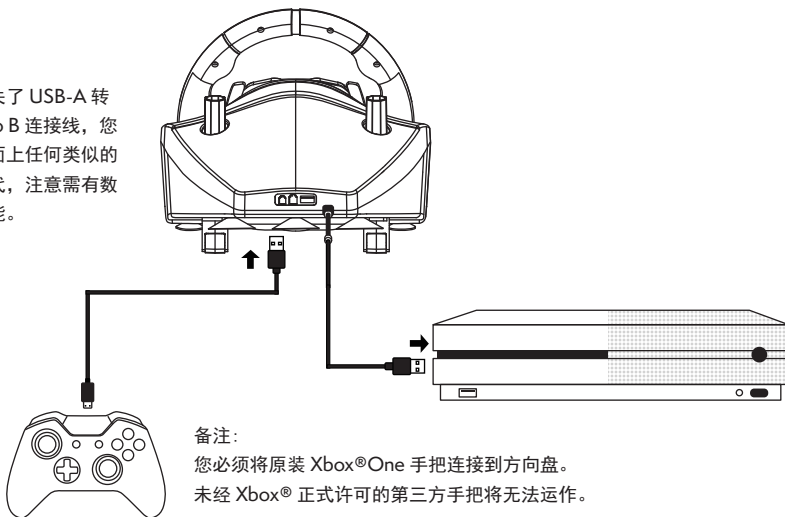

## 备注：

您必须将原装 Xbox®One 手把连接到方向盘。  
未经 Xbox® 正式许可的第三方手把将无法运作。



# Xbox®Series X|S 设定

- (1) 按照第 2 页所示设置好方向盘和排档杆后，使用包装中提供的 USB 线 (5) 将原厂 Xbox®Series X|S 手把连接到方向盘。
- (2) 将方向盘连接到主机的 USB 端口并打开电源。
- (3) 方向盘的 LED 会自动亮起绿色，然后按下方向盘上的首页按钮。
- (4) 此时，方向盘已准备就绪。按照第 9 页所示的“Xbox®Series X|S 按钮布局”开始游戏并进行您的游戏设定。

备注：

如果您遗失了 USB-A 转 USB-C 连接线，您可以  
用市面上任何类似的连接  
线替代，注意需有数据传  
输功能。

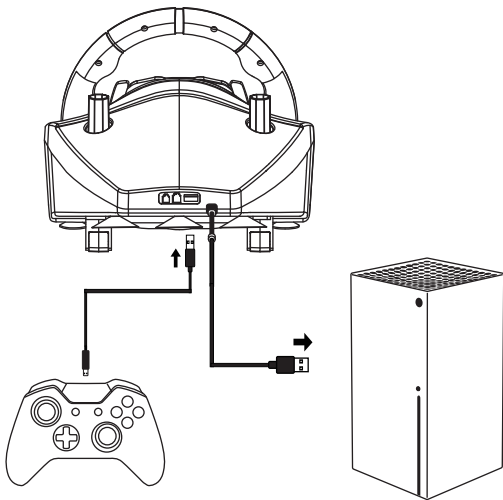

备注：

您必须将原装 Xbox®Series X|S 手把连接到方向盘。  
未经 Xbox® 正式许可的第三方手把将无法运作。

# Xbox® One & Xbox® Series X|S

## 按键布局

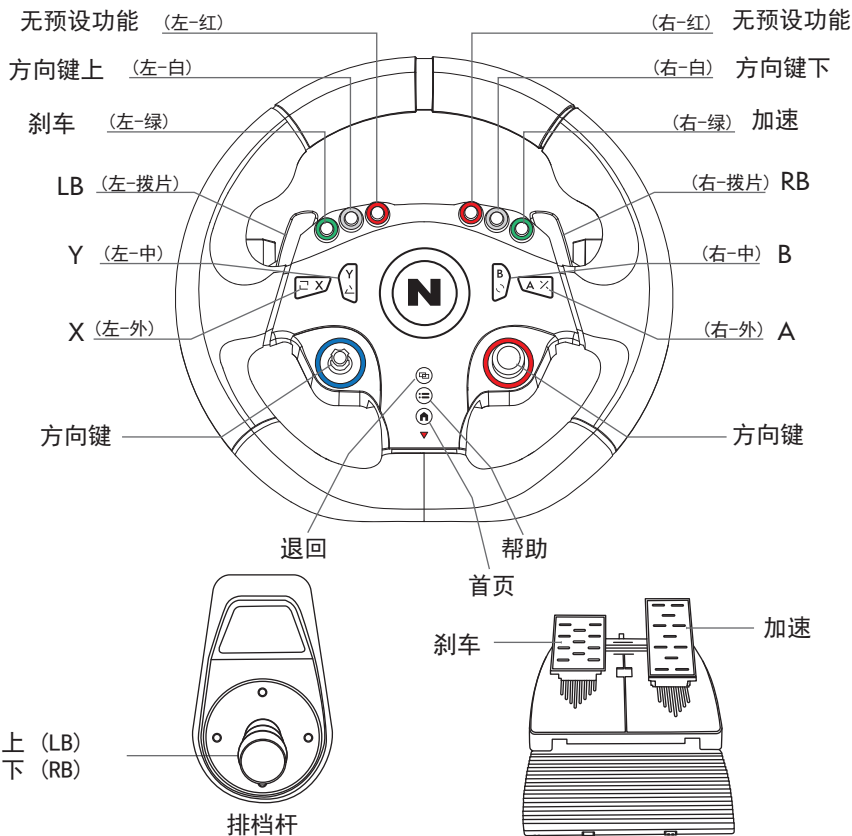

# PC 电脑 D-input 设定

- (1) 按照第 2 页所示设置好方向盘和排档杆后，使用电脑的 USB 端口连接方向盘。
- (2) 方向盘的 LED 会自动亮起紫色。
- (3) 此时，方向盘已准备就绪。按照第 11 页所示的“PC D-Input按钮布局”开始游戏并进行您的游戏设定。

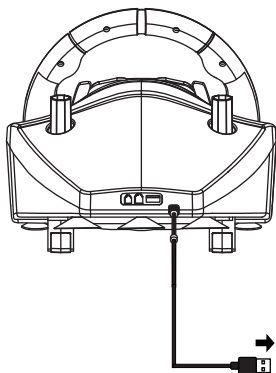

备注：

按下按钮 13（首页）几秒钟，直到 LED 灯的颜色变为橙色，可以从 D-Input 切换到 X-Input。

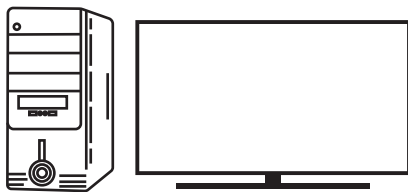

# PC 电脑 D-Input 按键布局

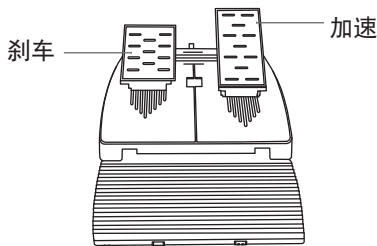
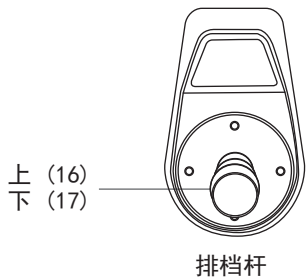
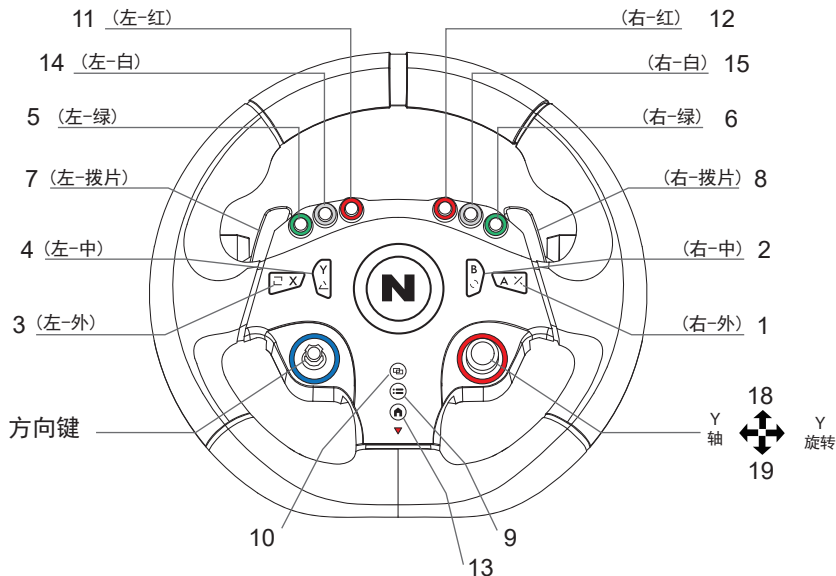

# PC 电脑 X-input 设定

- (1) 按照第 2 页所示设置好方向盘和排档杆后，使用电脑的 USB 端口连接方向盘。
- (2) 方向盘的 LED 会自动亮起橙色。
- (3) 此时，方向盘已准备就绪。按照第 13 页所示的“PC 按钮布局”开始游戏并进行您的游戏设定。

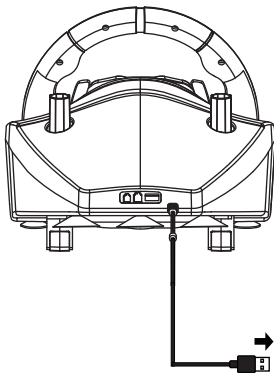

备注：

按下按钮 13（首页）几秒钟，直到 LED 灯的颜色变为紫色，可以从 X-Input 切换到 D-Input。

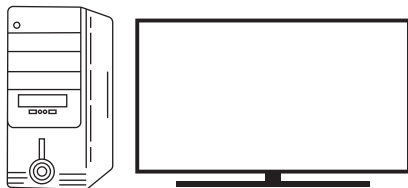

# PC 电脑 X-input 按键布局

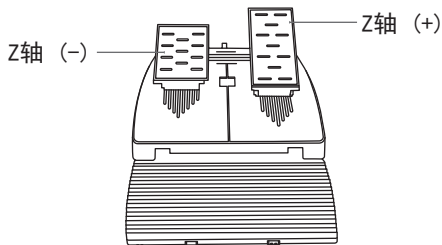
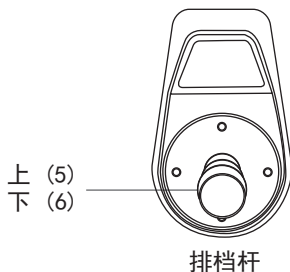
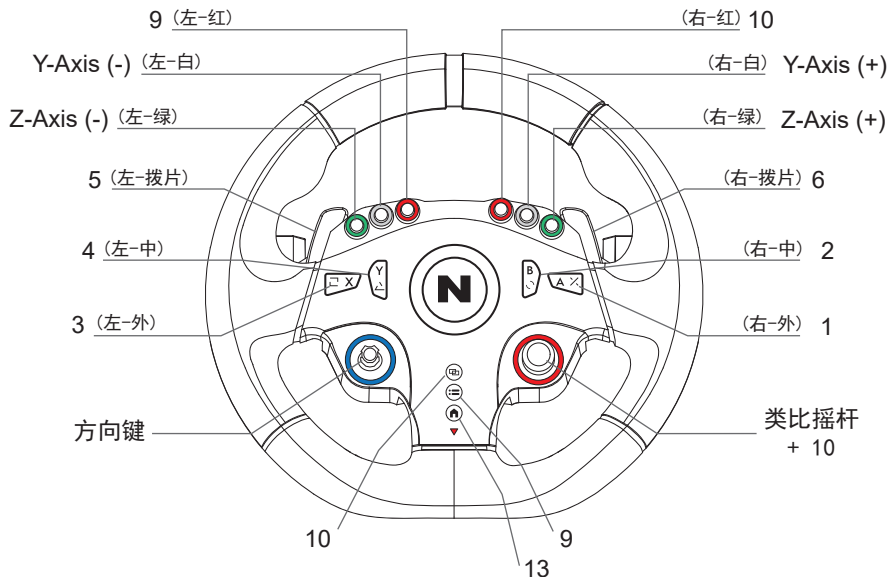

# 任天堂® Switch® 设定

- (1) 按照第 2 页所示设置好方向盘和排档杆后，使用 Switch® 底座的 USB 端口连接方向盘。
- (2) 方向盘的 LED 会自动亮起红色。
- (3) 此时，方向盘已准备就绪。按照第 15 页所示的“Switch® 按钮布局”开始游戏并进行您的游戏设定。

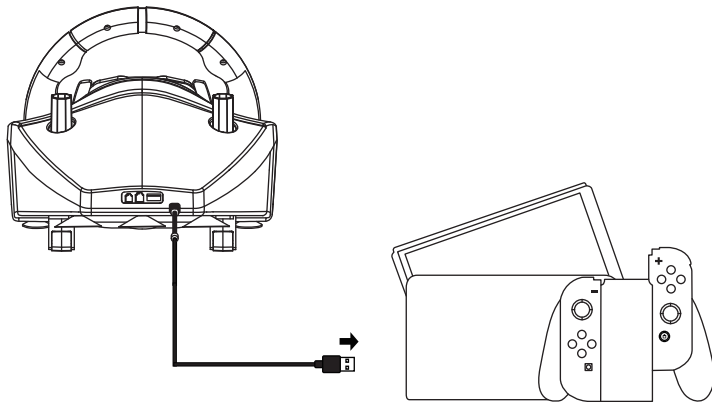

# 任天堂® Switch® 按键布局

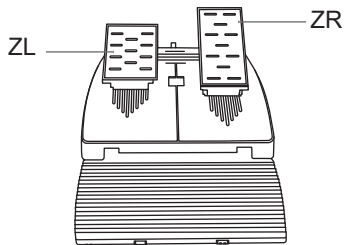
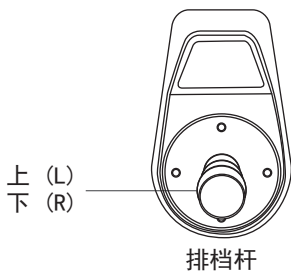
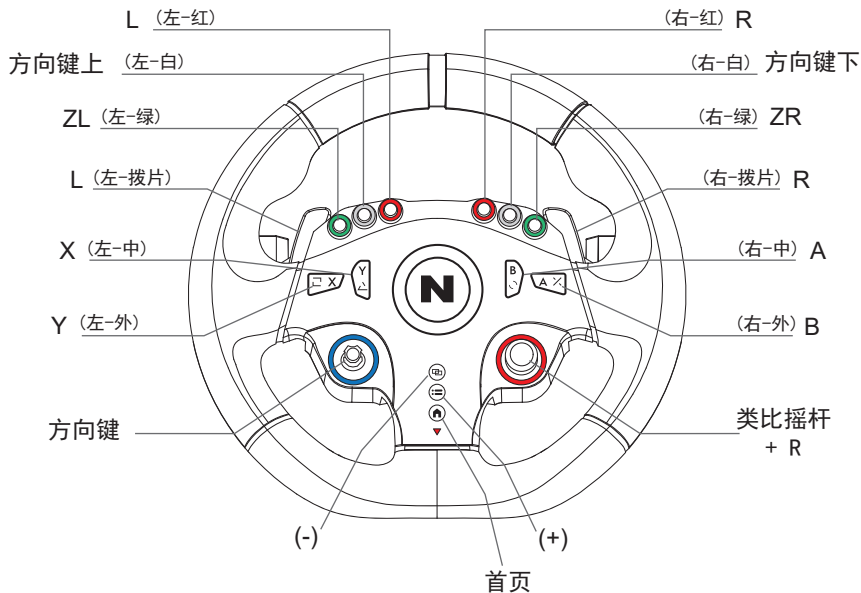



# PlayStation®3 设定

- (1) 按照第 2 页所示设置好方向盘和排档杆后，使用 PS3® 的 USB 端口连接方向盘并打开电源。
- (2) 方向盘的 LED 会自动亮起蓝色，然后按下方向盘上的 PS® 按钮。
- (4) 此时，方向盘已准备就绪。按照第 17 页所示的“PS3® 按钮布局”开始游戏并进行您的游戏设定。

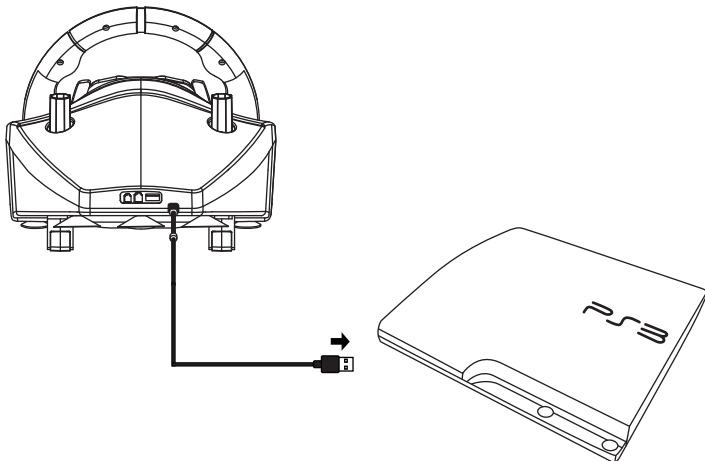

# PS3® 按键布局

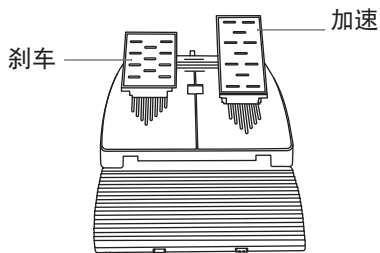
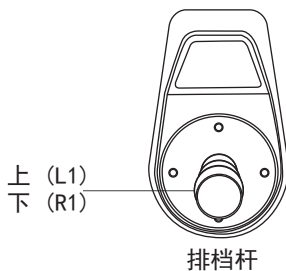
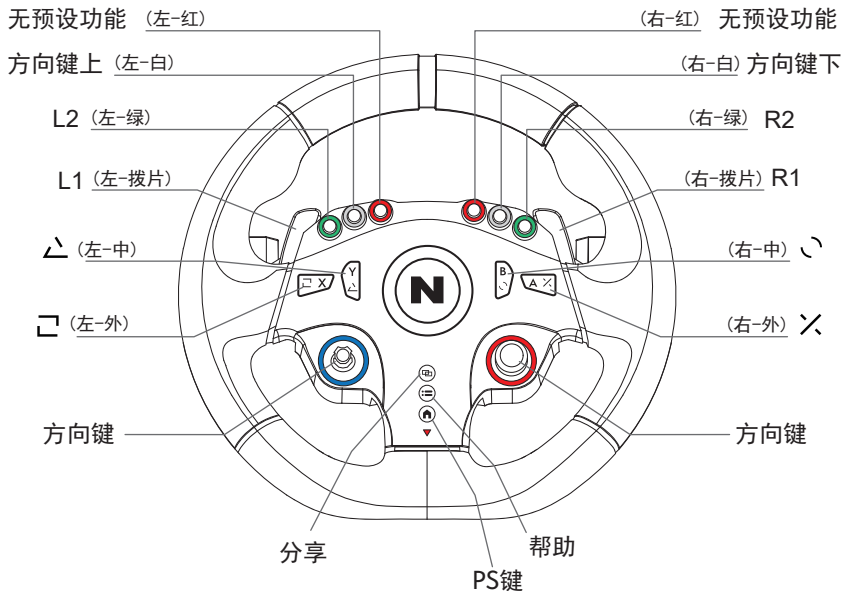

# 序列式排档杆

- 序列式排档
- 可调整桌面夹具

↑  
进档  
退档  
↓

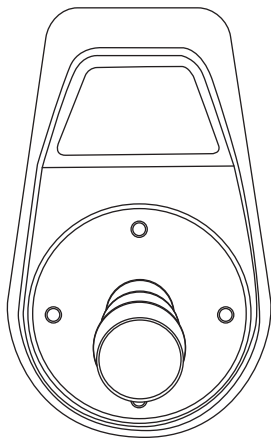

## 踏板组

- 电位式（类比）踏板
- 电镀表面处理
- 可折叠脚垫

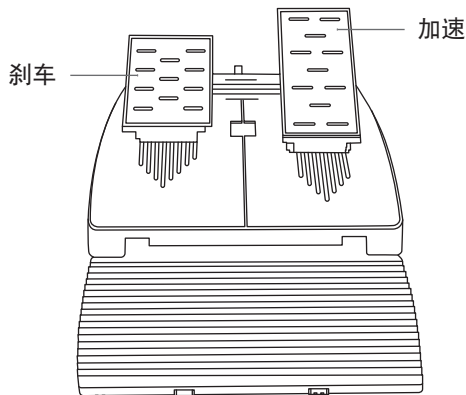

# NiTHO

www.nitho.com

## 服务及支援

如有任何问题，请联系我们：

support@nitho.com

或前往 [www.nitho.com](http://www.nitho.com)

提及的所有其它版权、商标和注册商标均为其各自所有者的财产。

本产品并非由 Nintendo®，Sony®，Microsoft®

等公司，设计、制造、赞助或认可。



SUPPORT@NITHO.COM



WWW.NITHO.COM



NITHOGAMES



NITHOGAMES