

Loqee

SMART SLIM

Installation Guide

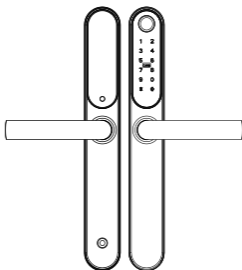

V1.01

Precautions for Installation

WARNING: FAILURE TO FOLLOW THESE INSTRUCTIONS COULD RESULT IN DAMAGE TO THE PRODUCT AND COULD LEAD TO FAILURE OF THE PRODUCT TO PROVIDE ACCESS.

- For best results, avoid installing the product in a rainy, humid, or saline environment (e.g. coastal area), or a place exposed to direct sunlight for a long period of time.
- Excessive dew condensation may affect product performance.
- You must not repair this product without authorisation.
- Install the product while the **door is open**. Even after completing the installation, **do not close the door** until you check if the product is operating properly.
- While installing the product, do not let it **fall to the ground**. If the product falls or is dropped during installation, you may be injured or the product may be damaged.

Component Overview



Interior
Panel

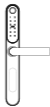

Exterior
Panel



Rubber
Gaskets



Screws



Detachable
Key Cylinder
(Version Specific)



Square
Spindle



Screw
Stubs



Mechanical
Key



Allen
Key



U-Clip



Key
Fob

User Guide

1. Product Overview

Exterior (Built-in Key Cylinder Version)

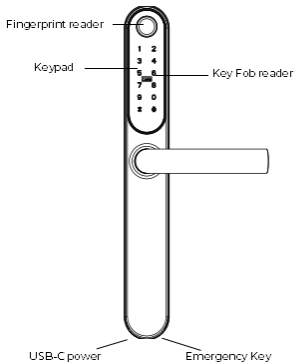

Exterior (Detachable Key Cylinder Version)

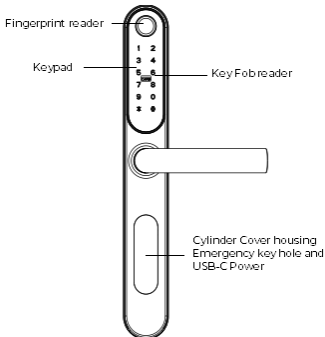

Interior

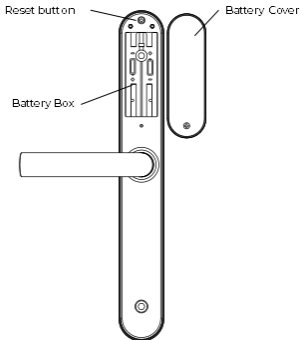

2. Basic operation

1.1. Cleaning the Keypad and Finger Reader

Use a microfiber cloth and wipe across the Anti-peep Keypad, Fingerprint Reader and Key Fob Reader.

1.2. Lock Activation

Place a finger on the Fingerprint Reader, touch the Anti-peep keypad with the back of your hand or fingers, or, scan the Fob on the Key Fob Reader.

1.3. Unlock from outside

Unlock by Code

1. Place a finger on the Anti-peep Keypad to activate.
2. Input the 4-8 digit User Code from a registered user and press #.
3. Rotate the handle down to unlock.

Unlock by Fingerprint

1. Press the finger from a registered user on the middle of the Fingerprint Reader to unlock it.
2. Rotate the handle down to unlock.

Unlock by Key Fob

1. Scan the Key Fob from a registered user on the Key Fob Reader.
2. Rotate the handle down to unlock.

Unlock by Smartphone

1. Press the Unlock Button in the TLock App.
2. Rotate the handle down to unlock.

Backup Key (Built-in Key Cylinder version)

1. Locate the keyhole at the bottom of the Exterior Assembly.
2. Insert the backup key vertically and then rotate it clockwise to a horizontal position.

Important: Turning the key counterclockwise or applying force to turn it can result in damage to the locking mechanism.

3. Rotate the handle down to unlock.

Backup Key (Detachable Key Cylinder version)

1. Use a magnet (any magnet will also work) to open the cylinder cover at the bottom of the Exterior Assembly to locate the keyhole.
2. Insert the backup key in a vertical position and rotate 180° clockwise to unlock the deadbolt. Continue rotating a further 220° clockwise to release the latch.
3. Pull the handle to open the door.

1.4. Unlock from inside

1. Rotate the handle down to unlock.

1.5. Lock from outside

Lock Latch

When Auto-Lock is on:

Loqee Slim will lock the Latch automatically 5 seconds after the last unlock (time duration can be configured using the TTLock app).

When Auto-Lock is off:

1. Place a finger on the Anti-peep Keypad to activate.
2. Press and hold the # key for 3 seconds.

Or Tap the 'Padlock' icon on the TTLock App.

Lock Bolt

Lift the Outside Handle up to lock the Bolt.

1.6. Lock from inside

Lock Latch

When Auto-Lock is on:

Loqee Slim will lock the Latch automatically 5 seconds after the last unlock (time duration can be configured using the TTLock app).

When Auto-Lock is off:

Tap the 'Padlock' icon on the TTLock App.

Lock Bolt

Lift up the Inside Handle to lock the Bolt.

1.7. Anti-peep Keypad

The lock supports 4-8 digit key codes. You can choose to enter any 16-digit code, as long as a correct code is included within the sequence of numbers you have entered.

Example User Code: **1234**

Example Valid Keypad Input: 045**1234**794

1.8. Finger Placement

- Your finger should cover the Reader completely with some pressure, touching the surrounding metal ring.
- Make sure that your finger and the Fingerprint Reader are clean and dry. For the Fingerprint Reader, use a clean microfiber cloth to wipe off any dirt or debris.
- While scanning your finger, you shouldn't tap too quickly or move your finger around.
- If you have trouble enrolling one finger, try another.

1.9. Use the Key Fob

When using the Key Fob access, please place the Key Fob at the centre to cover the reader.

Approach the sensor with medium speed (instead of sudden motion). If it's not working, move the Key Fob away and re-try.

1.10. Lock Status

Normal Mode

This is the default mode. Users must pass the fingerprint, code, fob or App access verification to unlock Logee Slim from outside.

Passage Mode

Loqee Slim will stay unlocked for convenient free passage (time duration can be configured using the TTLock app).

1.11. Temporary Lockout

In the event of 5 successive unsuccessful passcode attempts, an alarm will activate, accompanied by a 2-minute keypad lockout.

Throughout this duration, Smart lock will remain unresponsive to any operation for enhanced security.

1.12. Factory Reset

Important: All data will be erased if you reset Loqee Slim to factory default settings.

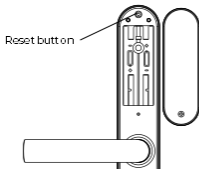

1. Open the battery cover.
2. Use a paper clip and press the "Reset" button for 5 seconds.
3. Press "000#" to complete the reset process.

1. Installation Guide

1. Preparing the door

1.1. If you are installing the Logee Slimsmart door lock on an existing door, please remove existing door hardware and latch or bolts before installing the new lock.

You can remove most existing door locks with a screwdriver.

If you are having problems removing your existing door lock or unsure if what you are doing can damage the existing door, please contact a locksmith or the current door hardware manufacturer for assistance.

1.2. After removing the existing lock, make sure your door is properly prepared. If you need to drill holes in your door, please use supplied templates to assist.

2. Adjust the latch throw

Based on your door closing direction, you have to orient the slanted side of the latch throw to face towards the closing direction of the door.

You may skip this step if your door closing direction matches the slanted side of the latch throw.

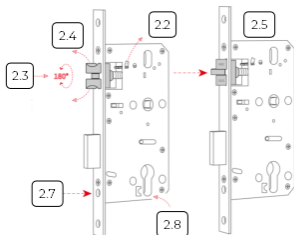

2.1 Move the metal barrier upwards.

2.2 Push the latch throw into the mortise entirely.

2.3 While the latch is inside the mortise, rotate the latch 180°.

2.4 Release the latch and it will come out of the mortise.

2.5 And, move the metal barrier back to the default position.

3. Change the handle direction

How to check if your door is a Right Swing or Left Swing door?

While facing the door from the secure side of the door (i.e. from outside of the house for a front door), if the door hinges are on the right side of the door, you have a Right Swing Door. If the hinges are on the left side of the door, you have a Left Swing Door.

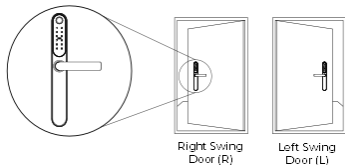

(Facing the door from secure side)

Changing the exterior handle orientation

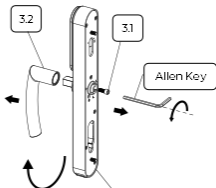

3.1 Remove the handle using the Hex/Allen key provided, turning anticlockwise.

3.2 Rotate the handle 180° to face the opposite direction.

3.3 Re-attach the handle by turning the Hex/Allen key clockwise to secure the new handle orientation.

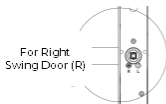

For Right
Swing Door (R)



For Left Swing
Door (L)

3.4 Remove the screw under the spindle hole.

3.5 Re-install the screw (in the side the handle is facing) to set the clutch position.

Changing the interior handle orientation

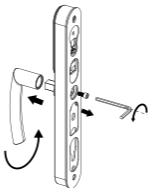

3.6 Remove the handle using the Hex/Allen key provided, turning anticlockwise.

3.7 Rotate the handle 180° to face the opposite direction.

3.8 Re-attach the handle by turning the Hex/Allen key clockwise to secure the new handle orientation.

4. Installation

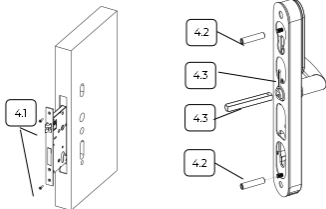

4.1 Insert the mortise into the door hole and secure it with two screws.

Steps 4.2 to 4.3 - For Detachable Key Cylinder Version Only

4.2 Insert the key cylinder into the mortise.

4.3 Secure it by inserting the screw horizontally through the mortise faceplate and fastening it to hold the cylinder in place.

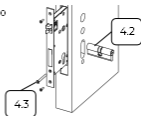

4.4 Install the top and bottom screw cylinders if not already in place.

4.5 Insert the square spindle and secure it with the U-clip.

4.6 Ensure the U-clip passes through the clutch and spindle holes, then bend its tail to lock it.

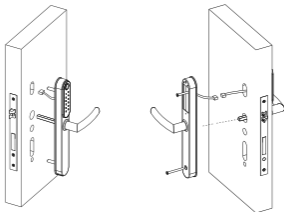

4.7 Fit the rubber gasket to the external assembly.

4.8 Install the exterior lock, while passing the spindle through the round hole in the mortise. Make sure that the connection cable passes through the door also.

4.9 Secure using a small double-sided tape or hold it until the internal handle is fixed.

4.10 Remove the battery cover and set it aside.

4.11 Attach the rubber gasket to the internal assembly.

4.12 Connect the cables, ensuring proper alignment.

4.13 Align the square spindle with the interior assembly and position it flush against the door, carefully tucking excess cable into the door cavity.

4.14 Secure the interior lock with the supplied long M5 screws at the top and bottom.

4.15 Insert four AA batteries, ensuring they match the (+) and (-) markings in the battery chamber. Secure the battery cover.

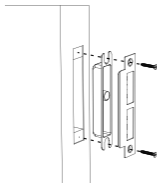

4.16 Make sure the slanted side of the mortise latch is closing against the slanted part of the strike plate before fixing it on to door frame.

4.17 Fix the door strike to the door frame.

4.18 You're all done! You have completed the physical lock installation and now you're ready to get the lock set up.

5. Power and Test

Activate the lock

1. Make sure fresh batteries are installed.
2. Place your palm on the keypad, applying gentle pressure.
3. This action will activate the keypad, causing it to illuminate.

Test Lock and Unlock

Important

- It is important to have the **door in an open position** during these operations.
- **Do not close the door** until you have completed the programming and verified the proper functioning of the product.

From outside

4. Lift the outside handle up, the Bolt should lock.
5. Turn down the outside handle, the Bolt or the Latch should not unlock.
6. Enter the default passcode "123456#" and turn down the outside handle, the Bolt and the Latch should unlock.

From inside

7. Lift the inside handle up, the Bolt should lock.
8. Turn down the inside handle, the Latch and Bolt should unlock.

6. Next Steps

You are now ready to proceed with the programming of the Logee Slim. To initiate the programming process, refer to the dedicated 'Programming Guide' for detailed instructions and steps.

However, if any of the previous steps were unsuccessful, carefully re-install the Logee Slim following the instructions provided in the 'Installation Guide' section.

Before beginning the programming process, it is advisable to review the '**User Guide**' to familiarise yourself with the lock's functionality. Once you have become familiar with the lock's functionality, you can proceed with the programming as per the instructions in the Programming Guide.

Programming Guide

Important

- Enable Bluetooth on your smart phone before continuing.
- All the operations related to configuring the new smart lock should be performed within one meter radius to the lock.

1. Download the app

Scan to download the APP or search 'TTLock' on your app store.



2. Login to TTLock Account

If this is your first time using the TTLock app, you have to register a new user account. Once an account has been created, you can use the same account to manage all of your locks.

If you already have an account you can skip the registration and login to the application with your account credentials.

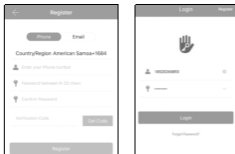

Registering a new account

1. Open the TTLock application.
2. Follow the prompts to register a new account.

Login to the account

3. Login to your account with your username and password.

Login Successful

Once you are logged into the application you will be taken to the Home page of the TTLock application.

3. Adding the lock to the TTLock app

Important

- The default password is 123456#.
- Once you complete this step, you will become the Bluetooth administrator of the lock. And, there can be only one Bluetooth administrator for a given lock.
- You can add more users with administrator privileges. But, the Bluetooth administrator has the highest permission level.
- To remove a Bluetooth Administrator, go to the 'Factory Reset' and follow the steps to reset the lock to the factory default.



1. Tap the add button.
2. Tap the 'All Locks' button.
3. Now the application will scan for nearby locks and once a lock is found, tap the '+' button next to the correct lock.
4. Enter a lock name. E.g. Mainstreet

5. If successful, you will be taken to the Home page of the new lock. Now the lock is added to your account and ready to be configured.

4. Configuring the lock access using TTLock application

Unlock using the TTLock application

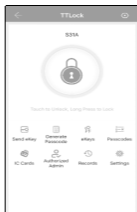

1. Make sure you are on the Home page of the newly added lock.
2. Tap the 'Padlock' icon to unlock the smart lock.
3. If successful, you will hear the sound of the lock mechanism working and you should be able to pull the lid open.

Setting a passcode

There are multiple types of passcodes such as permanent, time-limited, one-time, etc. You can choose to create any type based on your access requirements for each user.

You can also choose to generate a random passcode from the Application or a custom passcode based on your needs.



1. From the Home page options, tap 'Generate Passcode'.
2. Choose the type of passcode you want to create by navigating the tabs.
3. Generate the new passcode.

Send e-key

You can send e-keys to other users to grant application access to the lock.

Important: The receiver must have the TLock application installed and registered with TLock prior to receiving the e-key.

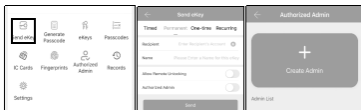

1. Tap 'Send eKey' on the lock Home screen.
2. Select the e-key type by navigating the tabs (i.e. timed, permanent, one-time, recurring).
3. Enter the recipient's TLock account username and name.
4. You can choose to 'Allow Remote Unlocking' capability, if necessary.
5. Select 'Authorized Admin' if you want to make this user an administrator.
6. Tap 'Send'.

Register IC Card/Key Fob



1. Tap 'IC Cards' on the lock Home screen.
2. Select 'Add IC Card' from the context menu.
3. Enter IC card details.
4. Tap the IC Card to the exterior lock panel IC card reader area.

Register fingerprint



1. Tap 'Fingerprints' on the lock Home screen.
2. Select 'Add fingerprint' from the context menu.
3. Enter fingerprint details.
4. Start the fingerprint scan process and follow the on-screen instructions.

Check Logs

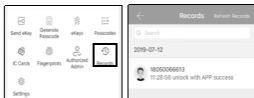

1. Tap 'Records' from the lock Home screen.

5. Configuring the Wi-Fi Gateway (optional)

Important

- You should install the Wi-Fi Gateway only after you have successfully finished installation and set up your Smart Lock using Bluetooth.
- When configuring, your phone and the Wi-Fi gateway must be connected to the same 2.4GHz network.
- If the process times out at any point, power off the Gateway and start the process again.

Understanding indicator light status



When the gateway is power on:

- Light flashes alternately with red and blue: Stand-by mode, ready for connection
- Blue light: working mode
- Red light: network failure

Pairing the Wi-Fi Gateway with the TTLock App



1. Open the TTLock App.
2. Tap the '≡' button.
3. Select 'Gateway'.
4. Select 'G2'.
5. Plug the Gateway and power it on. The indicator light should flash red and blue alternatively.



6. Tap the '+' next to the correct Gateway.

7. Add Gateway.

8. Select the 'WiFi' and enter the password.

9. Pairing is now complete.

Enabling remote unlock

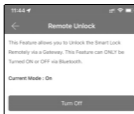

1. Tap 'Settings' on the lock Home screen.

2. Select 'Remote Unlock'.

3. Tap 'Turn On'.

Unlocking remotely (using Wi-Fi)

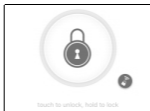

4. Go back to the Home screen. There should be a new remote unlock button next to the main Padlock icon.

5. Tap and confirm to unlock remotely.

We are here to help!

For additional support,
contact your Logee Retailer.

Logee