

ZLINE

ATTAINABLE **LUXURY**®

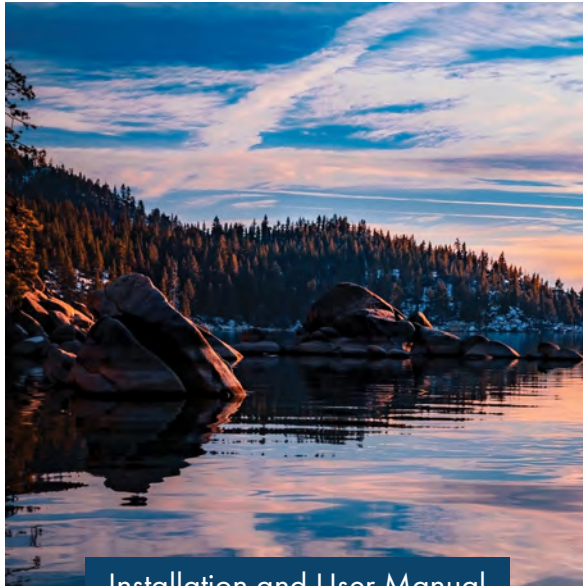

Installation and User Manual

RUBICON SHOWER SYSTEMS RBCN1-SHS & RBCN2-SHS MODELS

zlinekitchen.com



ZLINE Kitchen and Bath provides Attainable Luxury, where the kitchen and bath of your dreams is never out of reach. Through our unique designs and unparalleled quality, we're dedicated to providing you an elevated experience in the heart of your home. With an endless selection of features and finishes, our inspiration is your reality.

ZLINE
ATTAINABLE LUXURY®



ZLINE is fueled by a passion for innovation; A relentless pursuit of bringing the highest end luxury designs and professional features into everyone's homes.

Because we continually strive to improve our products, we may change specifications and designs without prior notice.

Scan the QR code to view the most up-to-date version of the Installation Manual and User Manual.

⚠ WARNING: This product can expose you to chemicals including nickel, which is known to the State of California to cause cancer. For more information, go to www.P65Warnings.ca.gov.

This page left intentionally blank.

TABLE OF CONTENTS

IMPORTANT SAFETY INSTRUCTIONS 1

 Before Installation 1

 Operating Conditions 1

 Parts Included 1

 Tools Needed 1

 Installation Preparation 2

INSTALLATION 3

 RBCN1-SHS Single Handle Tub & Shower Faucet. 3

 RBCN2-SHS Single Handle Tub & Shower Faucet. 13

CARE AND MAINTENANCE 23

TROUBLESHOOTING 24

WARRANTY 26

IMPORTANT SAFETY INSTRUCTIONS

BEFORE INSTALLATION

- Make sure that the cold and hot water lines are turned off.
- Wrap all threaded connections with plumber's tape or thread sealant. Always wrap in a clockwise direction.
- Cover your drain to avoid losing parts during installation.
- Unless soldering connections, do not disassemble the main system body, as it has been precision manufactured and tested prior to leaving the factory.
- To prevent clogging of the faucet, flush the water lines prior to installation.

OPERATING CONDITIONS

- **Working pressure:** 20–125 psi/0.1–0.9 MPa.*
- **Water temperature:** 50 °F–149 °F/10 °C–65 °C.
- * Follow local building codes.

PARTS INCLUDED

- Allen wrench
- Mounting screws
- Sealing cap

TOOLS NEEDED

- 3M tape
- Adjustable wrench
- Bucket or suitable water container
- Cold expansion tools
- Crimping tools
- Flat head screwdriver
- Groove joint pliers
- Phillips head screwdriver
- Silicon/caulking
- Thread sealant or Teflon tape
- Water pipe (optional)
- Soldering materials (optional)

IMPORTANT SAFETY INSTRUCTIONS

INSTALLATION PREPARATION

1. Shut off the water and let the water in the current system drain.
 2. Assemble needed tools.
 3. Loosen the hardware that keeps the current system in place. Remove system.
- Do not over tighten screws/nuts. Finger tighten, then use a wrench/flat head screwdriver to tighten the fixing screw/nut until snug. Do not over tighten screws/nuts. Finger tighten, then use a wrench/flat head screwdriver to tighten the fixing screw/nut until snug.

INSTALLATION

RBCN1-SHS SINGLE HANDLE TUB & SHOWER FAUCET

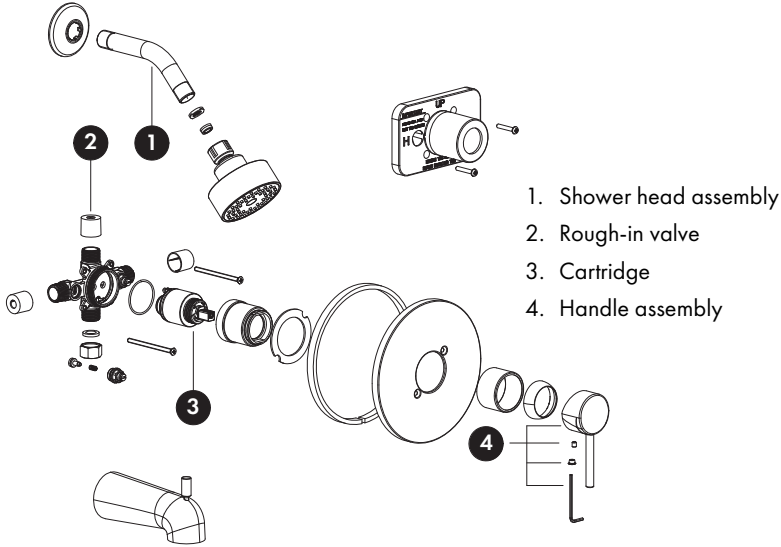

1. Shower head assembly
2. Rough-in valve
3. Cartridge
4. Handle assembly

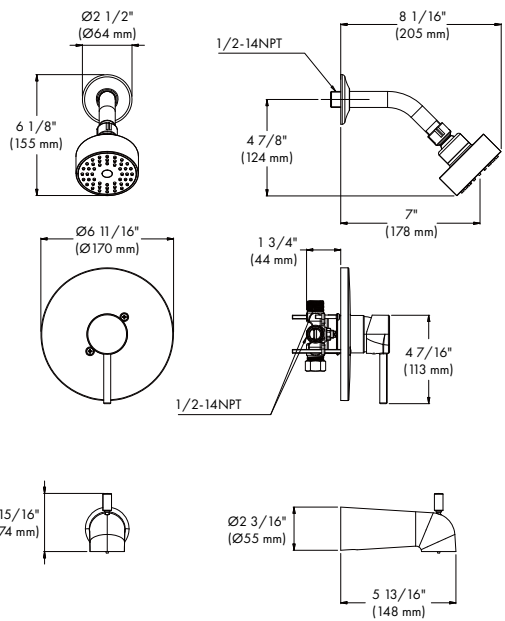

INSTALLATION

RBCN1-SHS SINGLE HANDLE TUB & SHOWER FAUCET

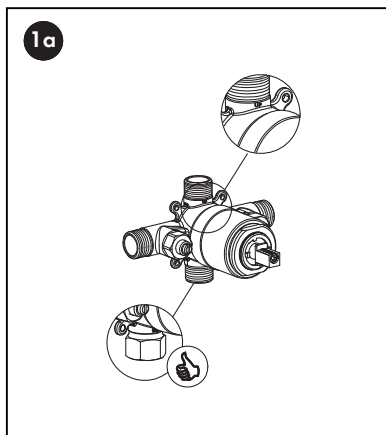

If installing only the shower head, a sealing cap must be installed.

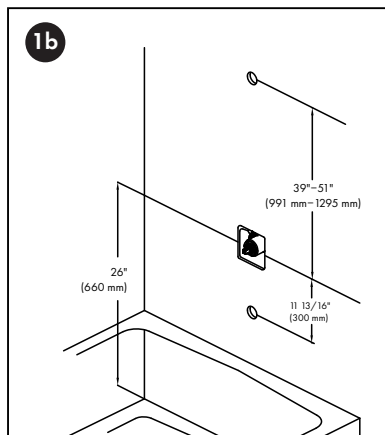

Use a level, tape measure, and pencil to mark the location where the holes will need to be drilled for the handle, shower head, and bath tub faucet.

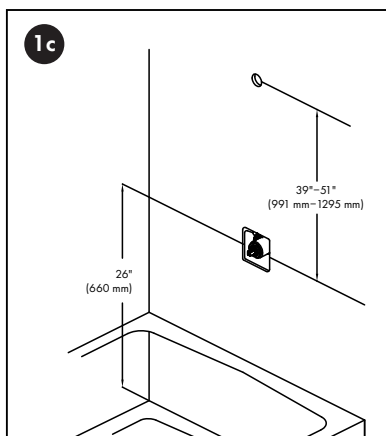

Use a level, tape measure, and pencil to mark the location where the holes will need to be drilled for the handle and shower head.

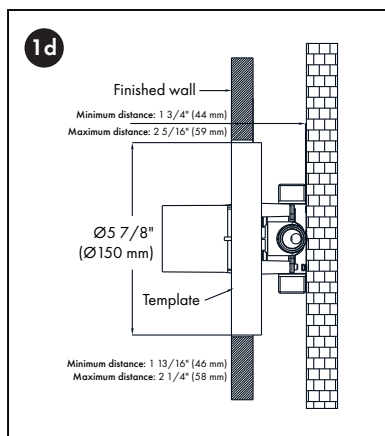

Install the rough-in valve body so that the front of the plastic cover is flush with the wall. Make sure to include the depth of any tile that may be placed on the wall.

INSTALLATION

RBCN1-SHS SINGLE HANDLE TUB & SHOWER FAUCET

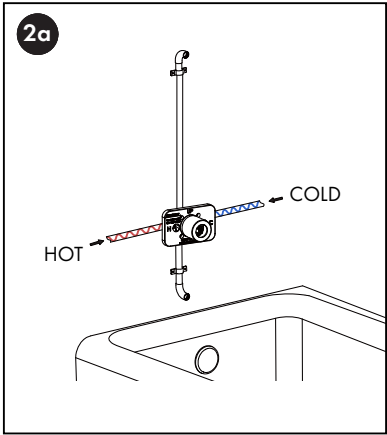

Water connections can either be threaded or soldered.

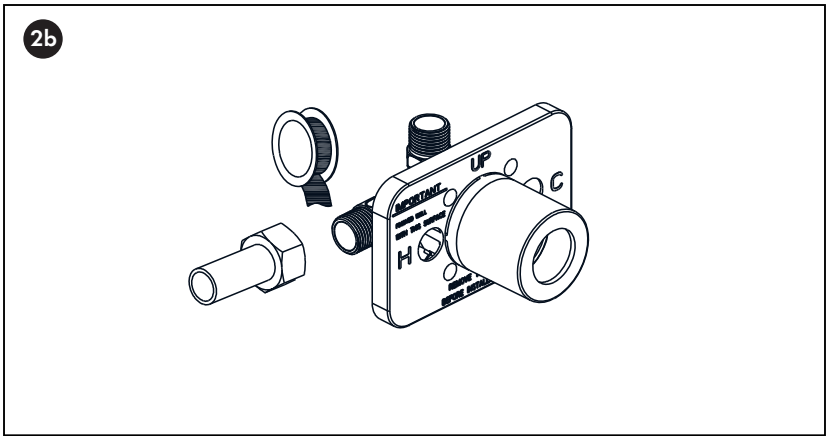

If using a threaded connection, make sure to apply thread sealant or plumber's tape in a clockwise direction to prevent leaks.

INSTALLATION

RBCN1-SHS SINGLE HANDLE TUB & SHOWER FAUCET

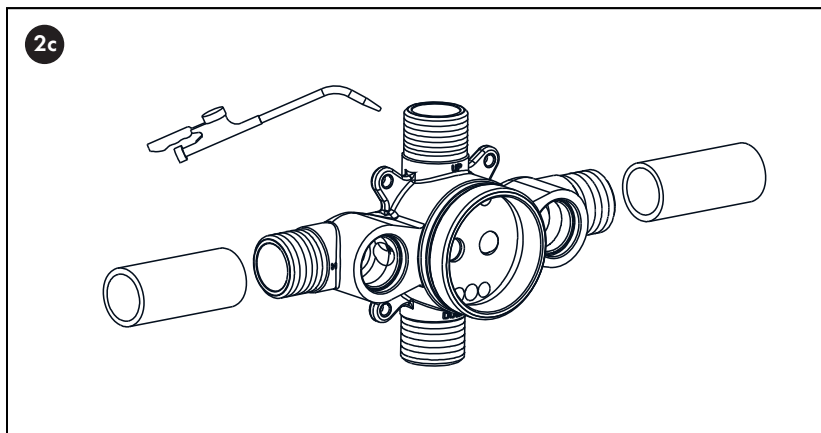

Cartridges must be removed prior to soldering to avoid damage to the seals due to the heat from the soldering process.

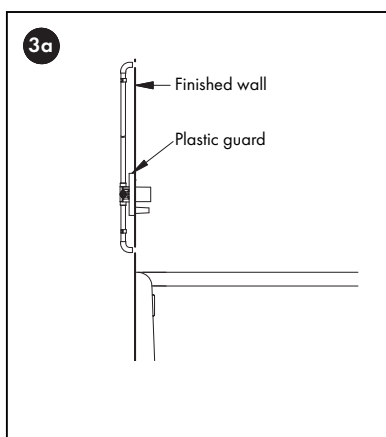

Make sure to account for the depth of any tile that may be used on the wall.

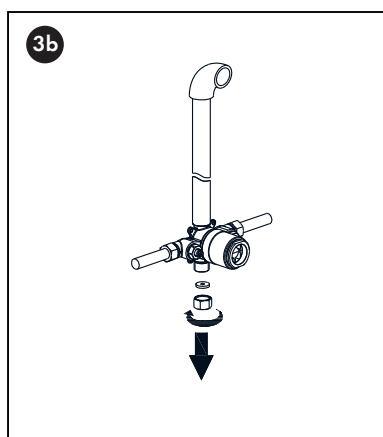

If a tub faucet is used, remove the cap from the bottom connection of the rough-in valve body.

INSTALLATION

RBCN1-SHS SINGLE HANDLE TUB & SHOWER FAUCET

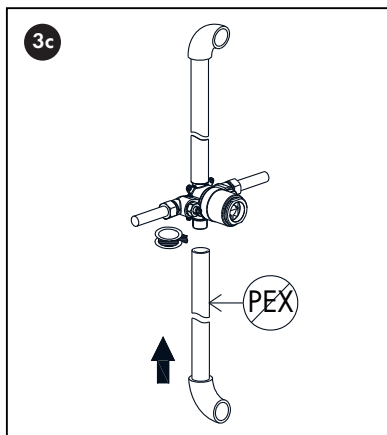

Do not use PEX tubing for the tub faucet water connection.

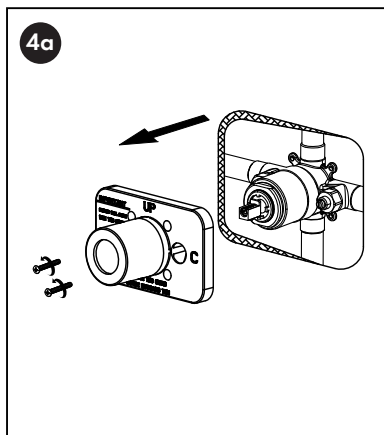

Remove the plastic cover from the rough-in valve. Use this cover to determine the proper depth at which the valve body should be mounted.

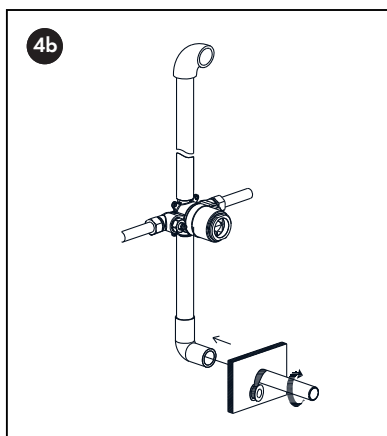

Attach a 5/8" (16 mm) diameter pipe to the water line. When doing so, ensure the pipe is long enough to protrude through the finished wall for the tub filler to connect to. If pipe joint is threaded, apply Teflon tape in a clockwise direction to seal the connection and prevent leaks.

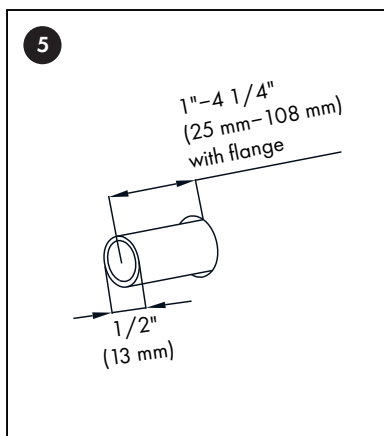

Ensure there is 1"-4 1/4" (25 mm-108 mm) of connecting pipe exposed to allow for attachment of the tub filler.

INSTALLATION

RBCN1-SHS SINGLE HANDLE TUB & SHOWER FAUCET

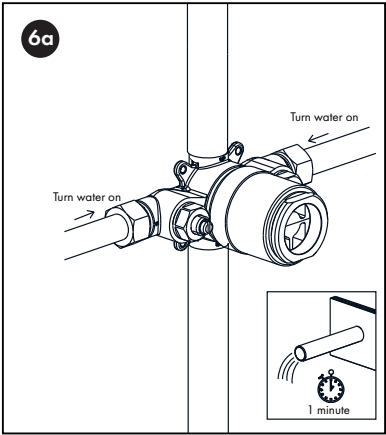

After the water supply lines are connected, the shower system should be flushed for at least 1 minute to remove any contaminants. To do this, turn on the hot and cold water supply and separately turn the hot/cold stopper valves until maximum water flow comes out of the shower pipe or bath tub filler stub out (if installed) when the cartridge is fully turned to the respective hot or cold position. The stopper valves can be used if there is too much hot or cold water supply or to reduce the water pressure by partially closing them. To set the temperature limit on the cartridge, check Step 9 to line up with our manuals)

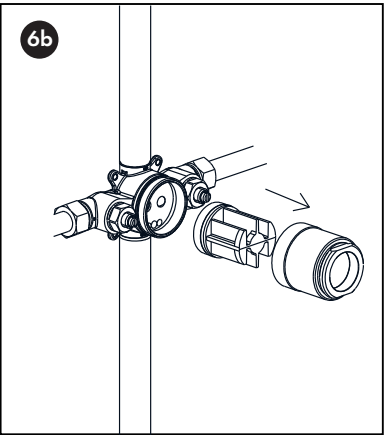

Remove cover and bypass plug.

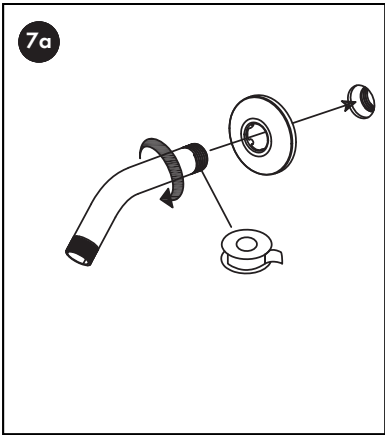

Install the connecting pipe of the shower head through the decorative cover by threading it into the water line. Apply Teflon tape in a clockwise direction to seal the connection and prevent leaks.

INSTALLATION

RBCN1-SHS SINGLE HANDLE TUB & SHOWER FAUCET

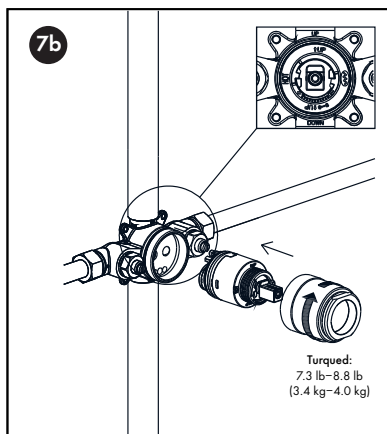

Ensure that the cartridge base is clear of any debris. Install the cartridge, noting the position of the locating pins. Reinstall the cover and tighten to 7.3 lb–8.8 lb (3.4 kg–4.0 kg).

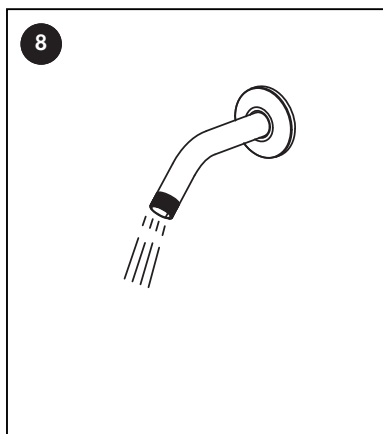

Turn on the water to ensure that water can flow through the system properly and there are no leaks.

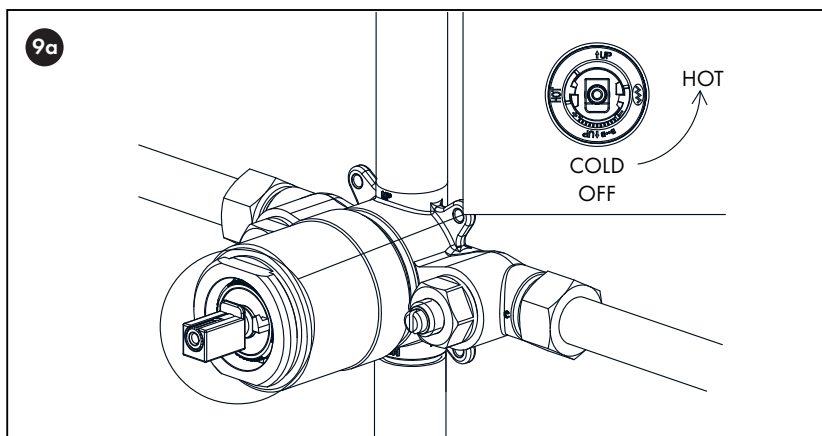

Remove the plastic limiter ring and rotate it to adjust the flow. Rotate counterclockwise to allow for more hot flow and rotate clockwise to reduce the amount of hot flow.

INSTALLATION

RBCN1-SHS SINGLE HANDLE TUB & SHOWER FAUCET

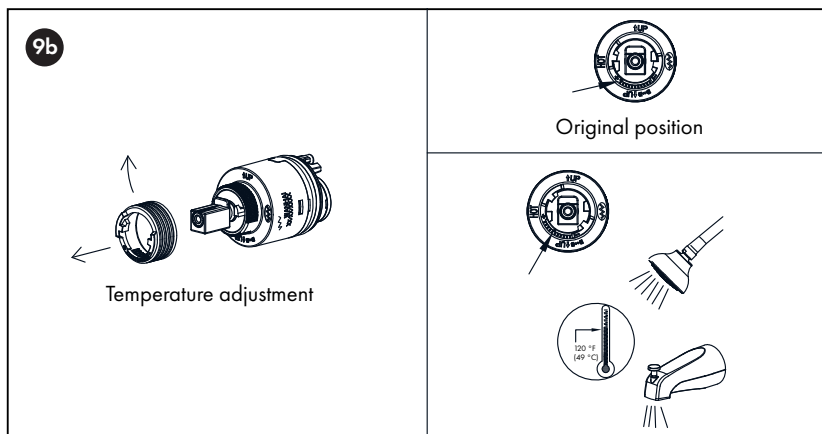

Using a thermometer, test the maximum hot water temperature coming out of the shower head and tub filler (if installed) when changing the position of the limiter ring. For safety, we recommend the maximum hot water temperature be no higher than 120 °F (49 °C).

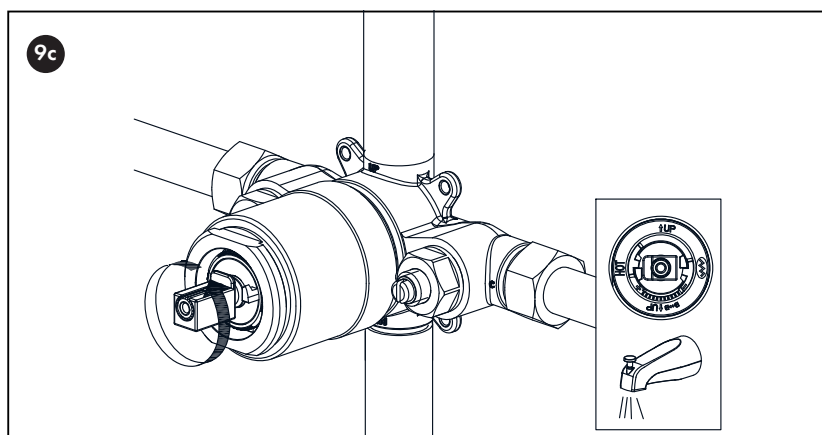

If installing the tub filler, follow steps 9d and 9e. Turn on the water to the tub filler by turning the handle. Make sure that water flows through the system and that the water temperature range is suitable using steps 9b and 9c above.

INSTALLATION

RBCN1-SHS SINGLE HANDLE TUB & SHOWER FAUCET

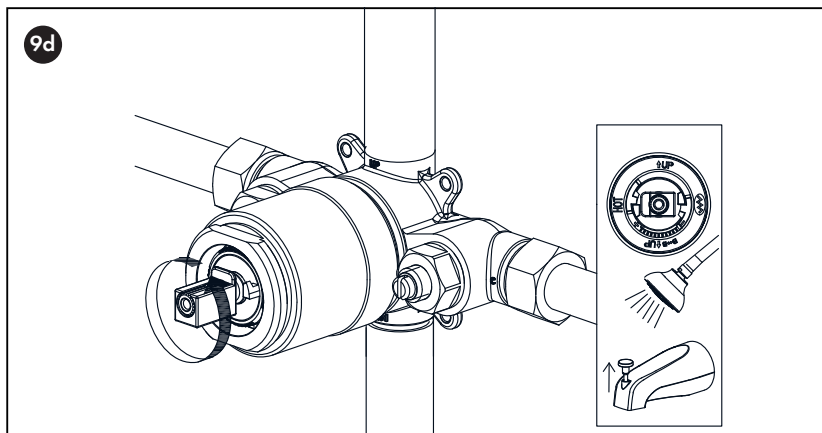

Turn on the water so that it is flowing from the tub filler. Lift the tub filler handle to activate the shower head. Check for leaks.

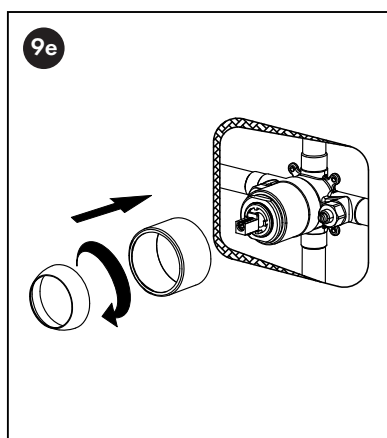

Place the cartridge sleeve over the rough-in valve cartridge and thread the cap onto the cover.

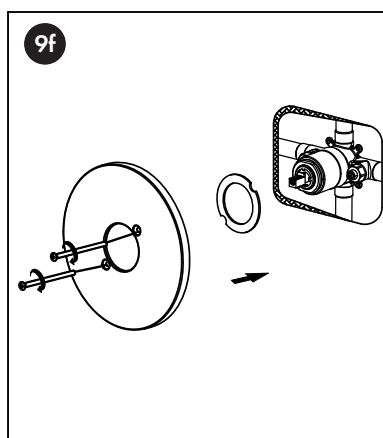

Install the face plate onto the rough-in valve assembly using the 2 screws provided. **NOTE:** Silicone or caulking should be used around the edge after installation to ensure a seal.

INSTALLATION

RBCN1-SHS SINGLE HANDLE TUB & SHOWER FAUCET

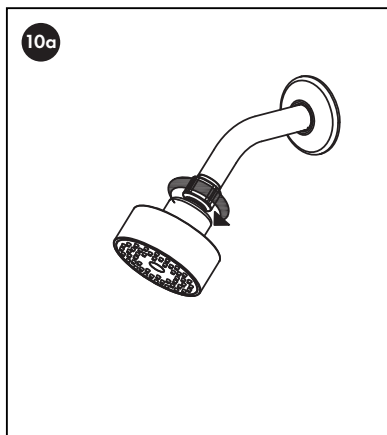

Install the shower head to the threaded connection pipe. Make sure to apply Teflon tape in a clockwise direction to prevent leaks

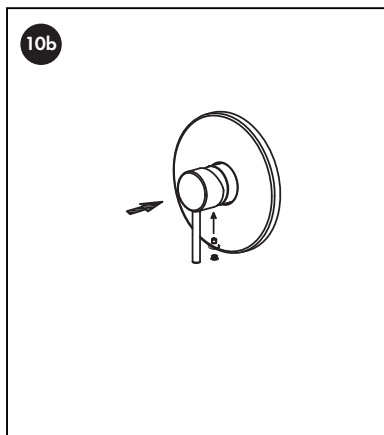

Install the shower head to the threaded connection pipe. Make sure to apply Teflon tape in a clockwise direction to prevent leaks

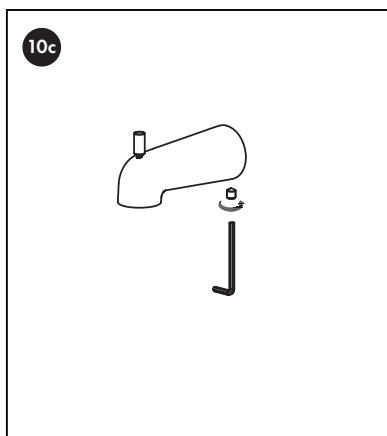

Install the handle in the off position and secure it in place using the provided set screw and the included Allen wrench. Seal the seam between the tub filler and the wall with silicone.

INSTALLATION

RBCN2-SHS SINGLE HANDLE TUB & SHOWER FAUCET

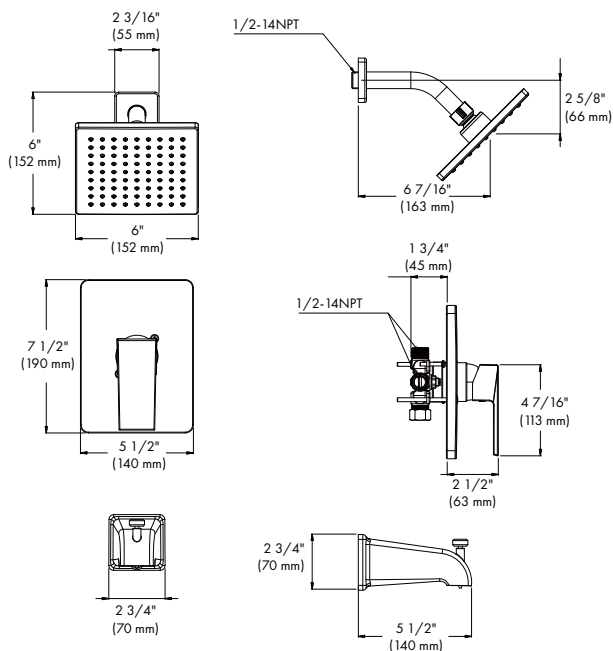
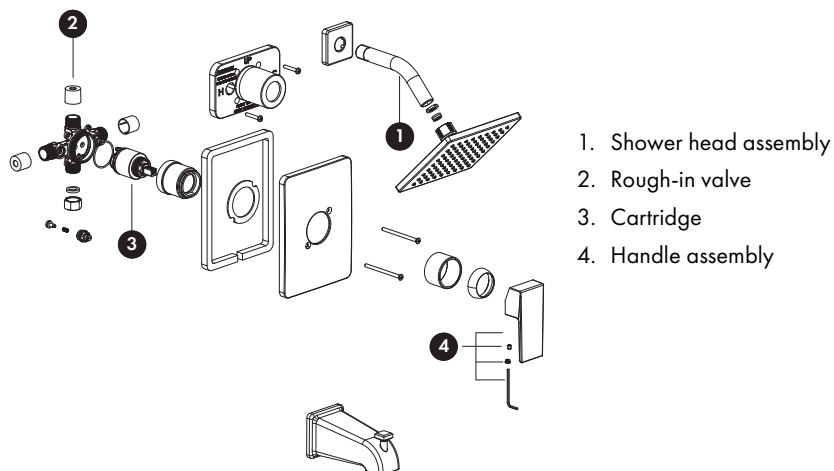

INSTALLATION

RBCN2-SHS SINGLE HANDLE TUB & SHOWER FAUCET

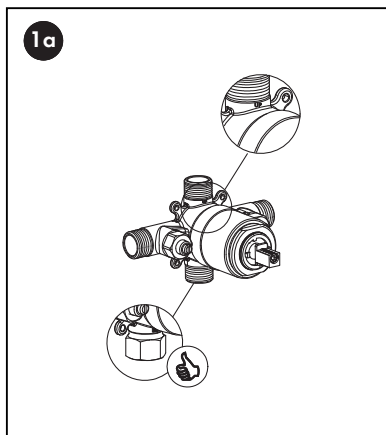

If installing only the shower head, a sealing cap must be installed.

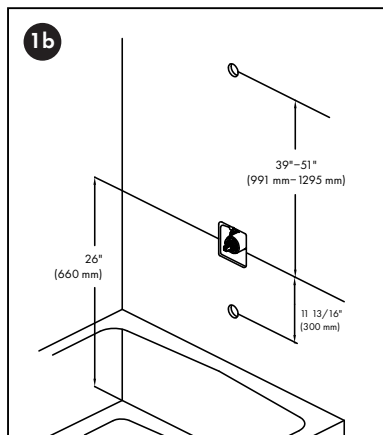

Use a level, tape measure, and pencil to mark the location where the holes will need to be drilled for the handle, shower head, and bath tub faucet.

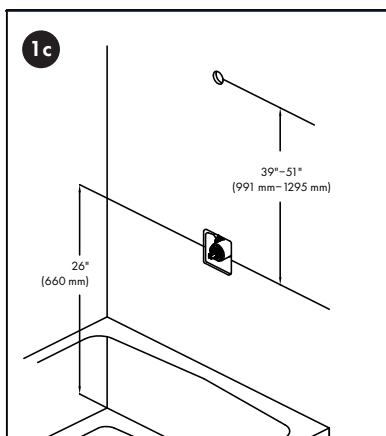

Use a level, tape measure, and pencil to mark the location where the holes will need to be drilled for the handle and shower head.

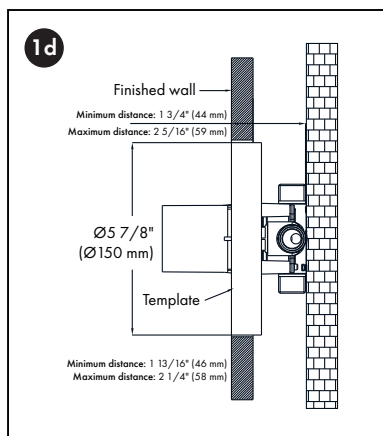

Install the rough-in valve body so that the front of the plastic cover is flush with the wall. Make sure to include the depth of any tile that may be placed on the wall.

INSTALLATION

RBCN2-SHS SINGLE HANDLE TUB & SHOWER FAUCET

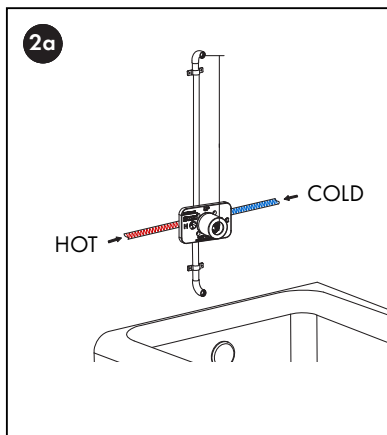

Water connections can either be threaded or soldered.

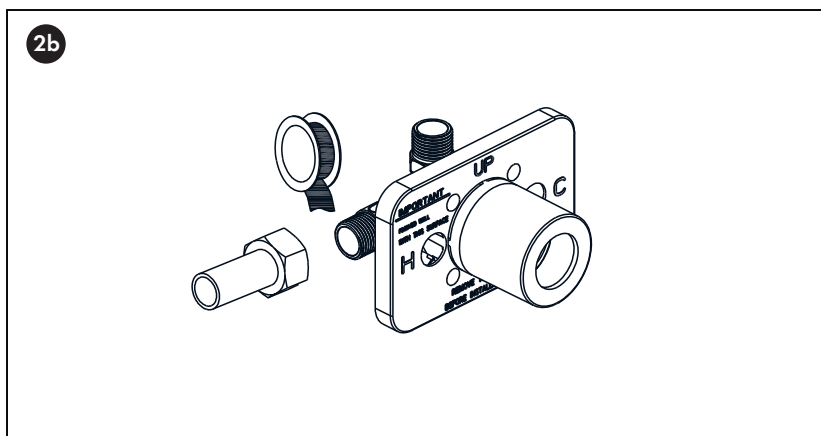

If using a threaded connection, make sure to apply thread sealant or plumber's tape in a clockwise direction to prevent leaks.

INSTALLATION

RBCN2-SHS SINGLE HANDLE TUB & SHOWER FAUCET

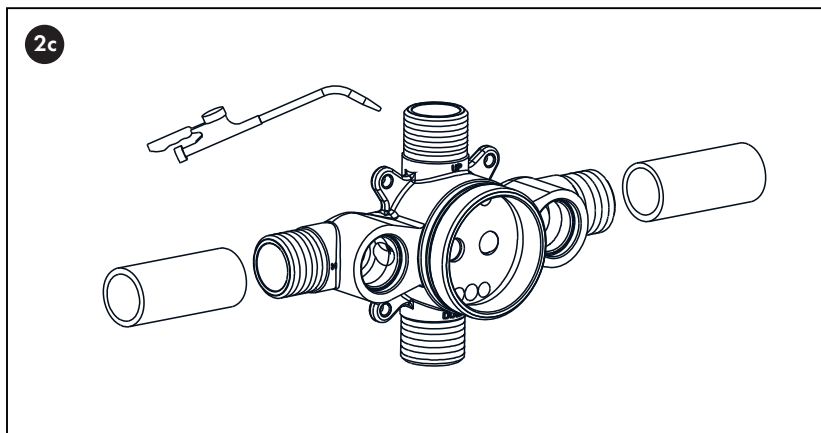

Cartridges must be removed prior to soldering to avoid damage to the seals due to the heat from the soldering process.

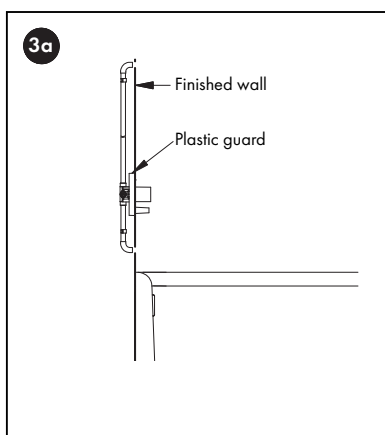

Make sure to account for the depth of any tile that may be used on the wall.

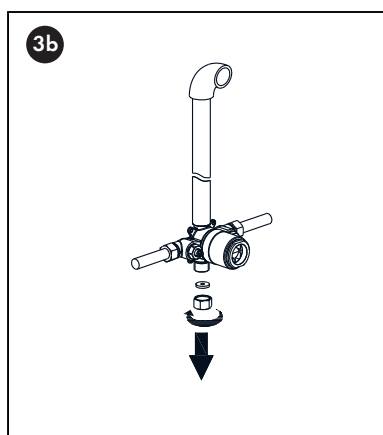

If a tub faucet is used, remove the cap from the bottom connection of the rough-in valve body.

INSTALLATION

RBCN2-SHS SINGLE HANDLE TUB & SHOWER FAUCET

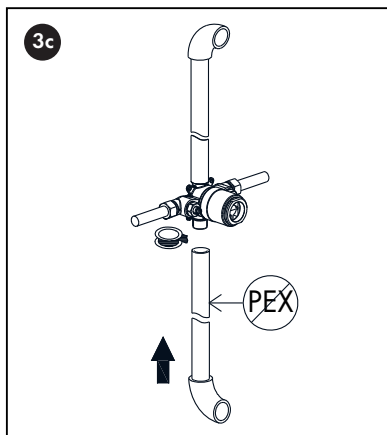

Do not use PEX tubing for the tub faucet water connection

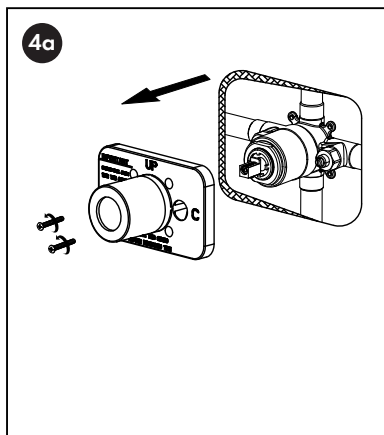

Remove the plastic cover from the rough-in valve. Use this cover to determine the proper depth at which the valve body should be mounted.

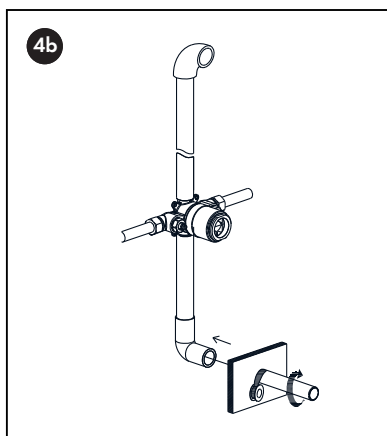

Attach a 5/8" (16 mm) diameter pipe to the water line. When doing so, ensure the pipe is long enough to protrude through the finished wall for the tub filler to connect to. If pipe joint is threaded, apply Teflon tape in a clockwise direction to seal the connection and prevent leaks.

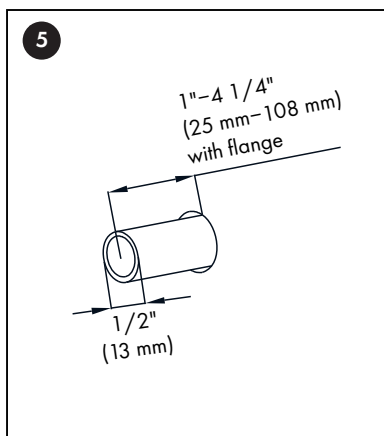

Ensure there is 1"-4 1/4" (25 mm-108 mm) of connecting pipe exposed to allow for attachment of the tub filler.

INSTALLATION

RBCN2-SHS SINGLE HANDLE TUB & SHOWER FAUCET

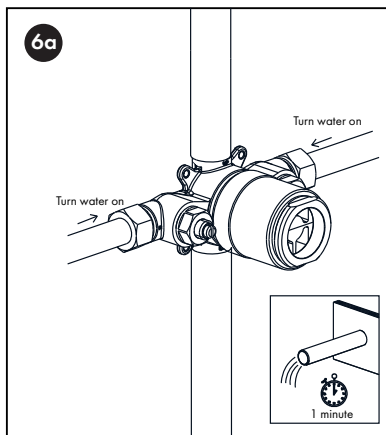

After the water supply lines are connected, the shower system should be flushed for at least 1 minute to remove any contaminants. To do this, turn on the hot and cold water supply and separately turn the hot/cold stopper valves until maximum water flow comes out of the shower pipe or bath tub filler stub out (if installed) when the cartridge is fully turned to the respective hot or cold position. The stopper valves can be used if there is too much hot or cold water supply or to reduce the water pressure by partially closing them. To set the temperature limit on the cartridge, check Step 9 to line up with our manuals)

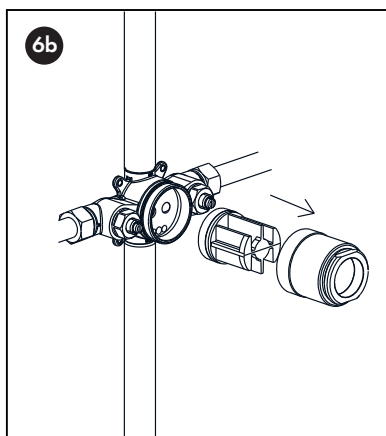

Remove cover and bypass plug.

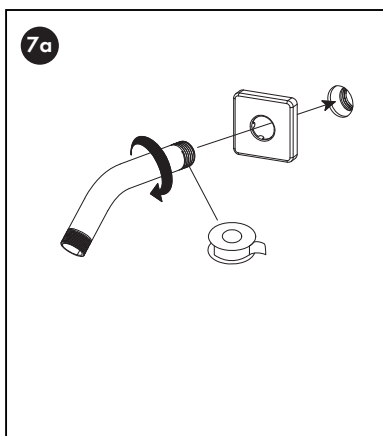

Install the connecting pipe of the shower head through the decorative cover by threading it into the water line. Apply Teflon tape in a clockwise direction to seal the connection and prevent leaks.

INSTALLATION

RBCN2-SHS SINGLE HANDLE TUB & SHOWER FAUCET

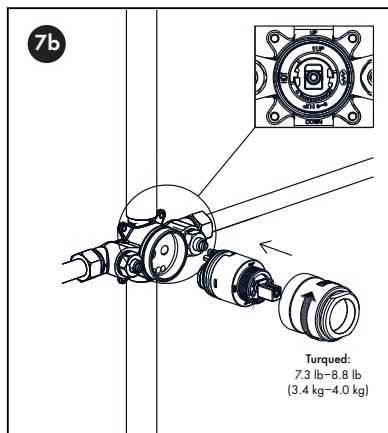

Ensure that the cartridge base is clear of any debris. Install the cartridge, noting the position of the locating pins. Reinstall the cover and tighten to 7.3 lb-8.8 lb (3.4 kg-4.0 kg).

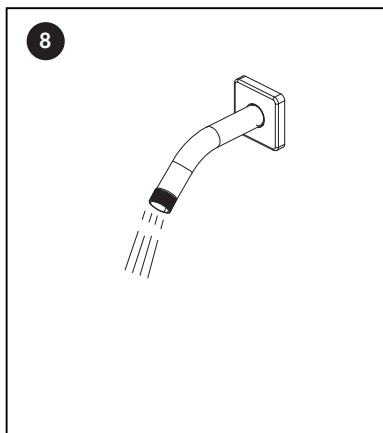

Turn on the water to ensure that water can flow through the system properly and there are no leaks.

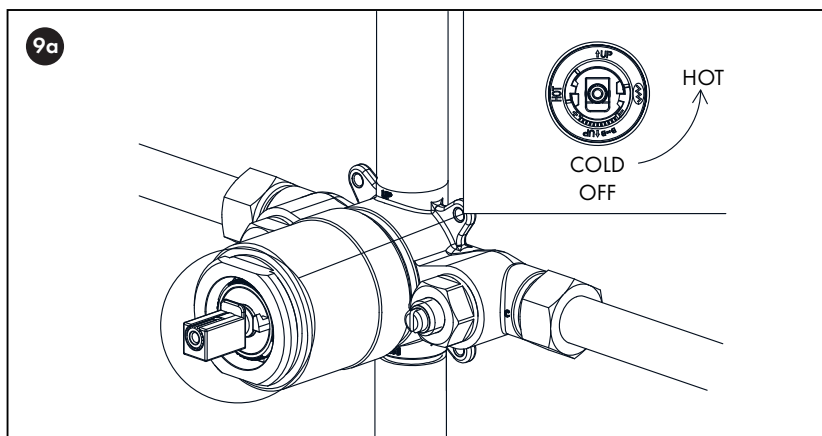

Remove the plastic limiter ring and rotate it to adjust the flow. Rotate counterclockwise to allow for more hot flow and rotate clockwise to reduce the amount of hot flow.

INSTALLATION

RBCN2-SHS SINGLE HANDLE TUB & SHOWER FAUCET

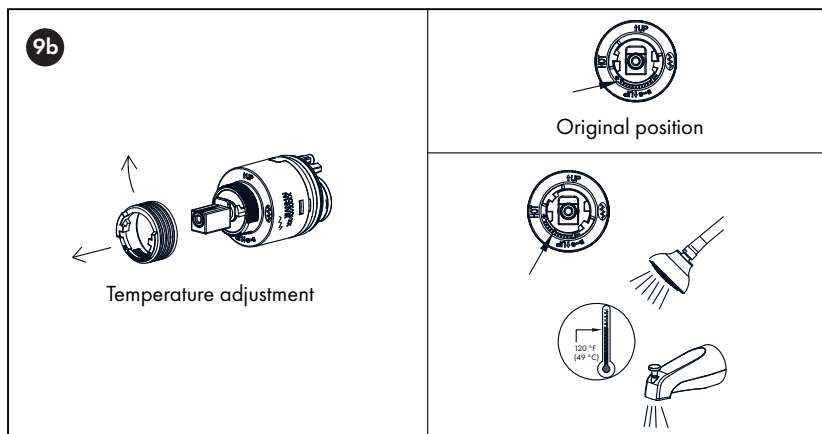

Using a thermometer, test the maximum hot water temperature coming out of the shower head and tub filler (if installed) when changing the position of the limiter ring. For safety, we recommend the maximum hot water temperature be no higher than 120 °F (49 °C).

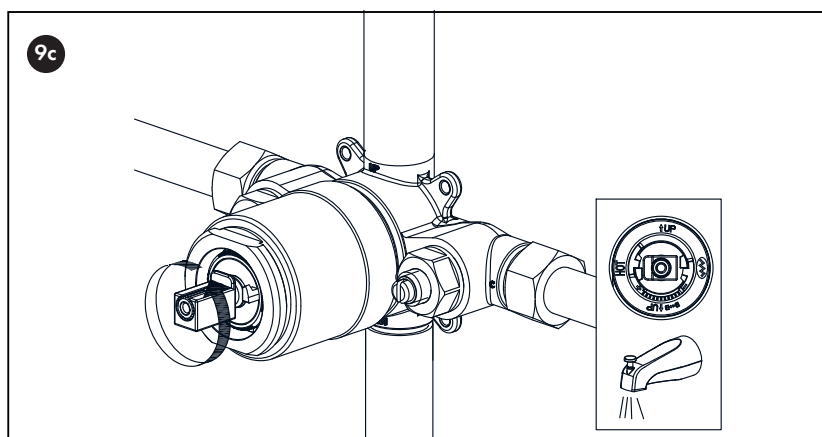

If installing the tub filler, follow steps 9d and 9e. Turn on the water to the tub filler by turning the handle. Make sure that water flows through the system and that the water temperature range is suitable using steps 9b and 9c above.

INSTALLATION

RBCN2-SHS SINGLE HANDLE TUB & SHOWER FAUCET

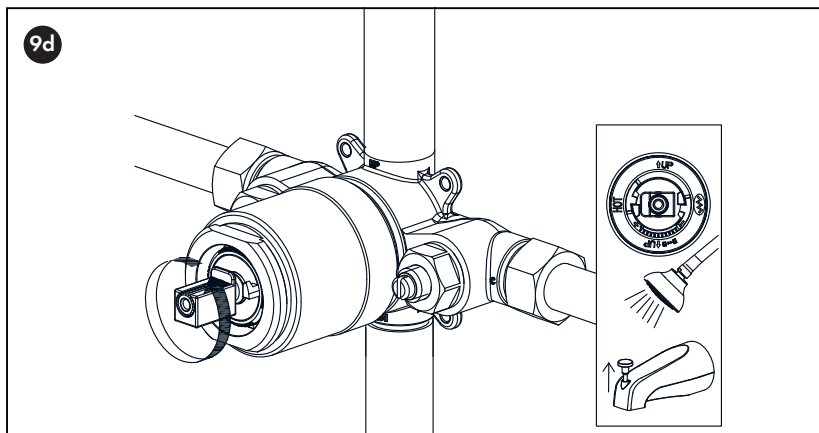

Turn on the water so that it is flowing from the tub filler. Lift the tub filler handle to activate the shower head. Check for leaks.

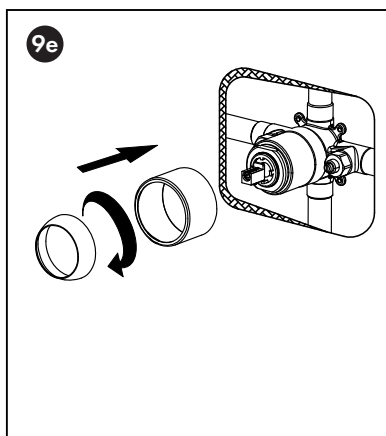

Place the cartridge sleeve over the rough-in valve cartridge and thread the cap onto the cover.

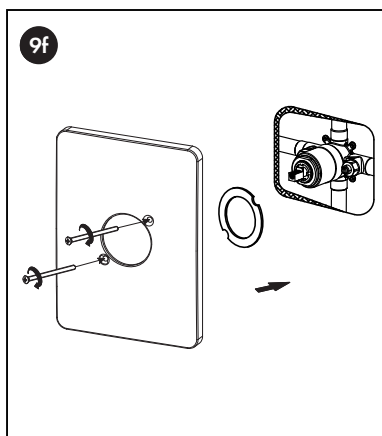

Install the face plate onto the rough-in valve assembly using the 2 screws provided. **NOTE:** Silicone or caulking should be used around the edge after installation to ensure a seal.

INSTALLATION

RBCN2-SHS SINGLE HANDLE TUB & SHOWER FAUCET

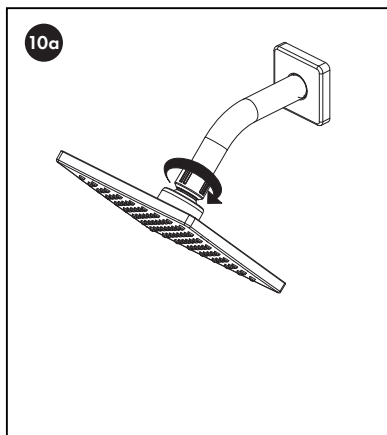

Install the shower head to the threaded connection pipe. Make sure to apply Teflon tape in a clockwise direction to prevent leaks

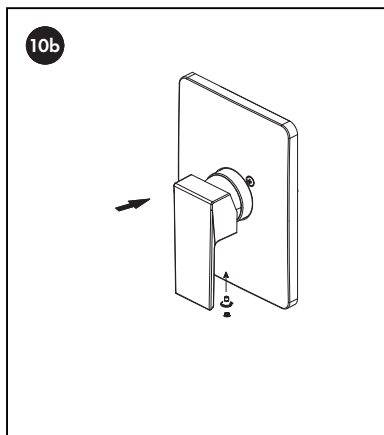

Install the handle in the off position and secure it in place using the provided set screw and the included Allen wrench.

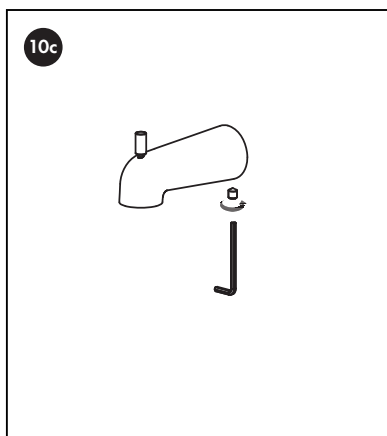

Install the handle in the off position and secure it in place using the provided set screw and the included Allen wrench. Seal the seam between the tub filler and the wall with silicone.

CARE AND MAINTENANCE

To keep your shower system clean, follow the steps below:

1. Rinse clean with water and dry with a soft cloth.
2. Do not clean with soaps, acid, polish, abrasives, or harsh cleaners.
3. Do not use cloths with a coarse surface.

TROUBLESHOOTING

PROBLEM	POSSIBLE CAUSE	SOLUTIONS
There is leakage under the handle.	The locking nut has come loose.	Unscrew the lever on the handle by hand. Loosen set screw with an Allen wrench. Remove the handle and unscrew trim cap by hand. Tighten locking nut with an adjustable wrench.
Water will not shut off completely.	Cartridge may be defective.	Unscrew the level on the handle by hand. Loosen set screw with an Allen wrench. Remove the handle and unscrew trim cap by hand. Unscrew the locking nut with an adjustable wrench. Remove ceramic disc cartridge. Check for cracks.
	Lines were not flushed prior to completing the installation and debris may made its way into the cartridge.	Remove ceramic disc cartridge and inspect for debris or damage.
	Handle is not placed correctly. If the set screw is loose, the handle may be able to be turned without turning the valve.	Tighten the screw and turn the handle to turn off the water. Loosen the screw, realign the handle, and tighten the screw.
There is a leak between the shower head and the connection pipe.	The shower head may be loose or the washer is not seated correctly in the hose connection.	Tighten the shower head by hand until snug. Make sure the washer is seated correctly.

TROUBLESHOOTING

PROBLEM	POSSIBLE CAUSE	SOLUTIONS
Water pressure is too low.	Debris blocking cartridge or shower head.	Remove the cartridge or shower head to inspect and reinstall.
	The hot and cold water inlet valves are not fully opened.	Ensure both valves are fully opened prior to installing the face plate cover.

WARRANTY

COVERAGE

ZLINE Kitchen and Bath shower systems have a limited lifetime warranty from the original date of product delivery for the original purchaser of the product.

ZLINE warranty periods begin from the original date of product delivery and solely cover the original purchaser of the product, delivered new and in its original carton. ZLINE will provide free-of-charge, non-consumable replacement parts for the components that failed due to manufacturing defects.

It is the responsibility of the customer to install all replacement parts, as ZLINE does not perform service repairs on its shower systems.

ZLINE's liability is limited to the original purchase price of the product. Additional injuries, losses, damages, or other inconveniences caused by product malfunction or defects in materials are not covered under the terms of this warranty.

TERMS

ZLINE warranties apply only to the original purchaser of a ZLINE product installed for normal residential use. This is defined as a single-family, residential dwelling in a non-commercial setting. Any warranty claim stemming from installation, operation, or any other use within a commercial setting is not covered under this limited warranty.

Commercial settings include, but are not limited to: schools, churches, hotels, restaurants, vacation rentals such as Airbnb, daycare centers, private clubs, fire stations, common areas in multi-family dwellings, nursing homes, food service locations, and institutional food service locations such as hospitals or correctional facilities.

This warranty is non-transferable and will not under any circumstance be extended based on the date of installation — the warranty period takes effect from the date of delivery and only covers the original purchaser. The warranty applies only to products installed in the contiguous United States and the District of Columbia.

WARRANTY

Out-of-pocket payments will not be reimbursed for replacement parts unless prior approval is received from ZLINE. Unapproved out-of-pocket payments for parts will not be reimbursed. Out-of-pockets for any type of service will not be reimbursed, as ZLINE does not perform service repairs on shower systems. All warranty procedures must be followed to maintain warranty coverage.

If ZLINE is unable to replace the defective part after a reasonable number of attempts, ZLINE reserves the right to offer to replace the product or provide the original purchaser a full refund of the purchase price of the product (not including installation, removal, or other charges that were not included in the original purchase price).

The original purchaser of the product must provide the original proof of purchase, including the purchase date, when filing a claim to obtain replacement parts or refunds. Additionally, the original purchaser of the product must provide the serial number of the product when filing a claim to obtain replacement parts or refunds.

This warranty shall not apply to any ZLINE product in which the original factory serial number has been removed, altered, or cannot be readily determined for any reason. Further, ZLINE is not responsible for damage resulting from, but not limited to: shipment, delivery, or improper installation; negligence or improper maintenance, misuse, or abuse of the product; unauthorized alteration, modification, or tampering with the product; accident, fire, floods, pest infestations, pandemics, natural disasters, or any other unpreventable or unexplained acts of nature, commonly referred to as "acts of God"; flare-up fires or damages caused by improper electric supply, electrical line current, voltage, or power surges; and service to correct installation not in accordance with the instructions contained in ZLINE's product manuals and/or with local government codes.

Additionally, this warranty does not apply to aesthetic damage, scratches, or natural wear caused by normal use; second-hand, open box products, or products purchased from an unauthorized retailer; and damages, problems, or any type of performance-related issues stemming from alteration or tampering with the accessory, including, but not limited to, painting stainless steel, black stainless, or Satin Stainless Steel finishes or any portion of the product's interior or exterior.

WARRANTY

Information contained within ZLINE's installation and user manuals, in addition to product information included on ZLINE's website and all related digital listings, do not cover every possible condition and situation that may occur during the installation or operation of ZLINE products.

ZLINE reserves the right to make changes at any time to its products when considered safe, necessary, and useful. Always check the ZLINE website for the most up-to-date version of its product manuals: www.zlinekitchen.com/pages/manuals.

Do not install or operate any ZLINE product if it has missing or broken parts or if it arrives damaged due to shipping. If ZLINE products arrive damaged, contact ZLINE Customer Experience at 1-614-777-5004 for help. Failure to report a damaged appliance prior to installation or operation may void the warranty. ZLINE does not perform service repairs on its shower systems.

ZLINE disclaims responsibility for damage or injury caused by improper installation or use of any of its products. ZLINE is under no obligation, by law or otherwise, to provide concessions, including repairs, prorates, rebates, discounts, or replacements, once the warranty has expired.

WARRANTY



Please contact ZLINE Customer Service for questions and troubleshooting help at 1-614-777-5004 or visit www.zlinekitchen.com/contact to utilize our online Customer Experience Portal.



Scan the QR code to view the most up-to-date version of our Installation Manual and User Manual.



Need to purchase a part or accessory for your ZLINE product? Visit www.zlineparts.com, ZLINE's official parts distribution partner.

This page left intentionally blank.

1.1.2

zlinekitchen.com

1-614-777-5004

contact@zlinekitchen.com

ZLINE
ATTAINABLE LUXURY®