



# POWERSMART<sup>®</sup>

## INSTRUCTION MANUAL

### DRYWALL SANDER

Model # PS4001A

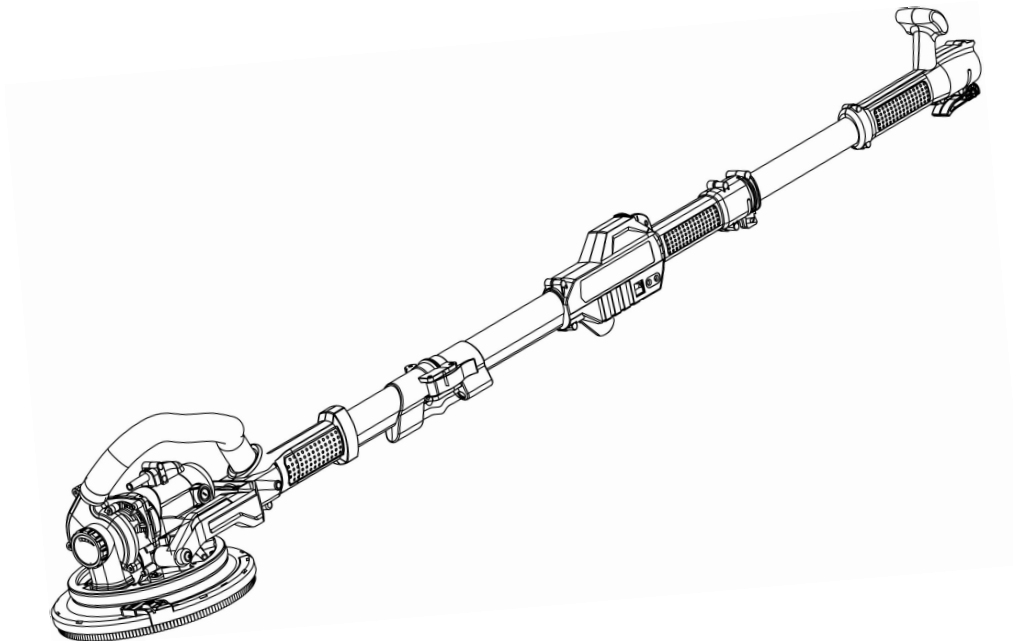

Have product questions or need technical support? Please scan the QR code to enter our official website and contact us!

Website: [www.powersmartusa.com](http://www.powersmartusa.com)

Toll free: 1-800-791-9458 / 1-888-293-0024 Mon-Fri 9-5 EST

Email: [support@amerisuninc.com](mailto:support@amerisuninc.com) / [support@powersmartusa.com](mailto:support@powersmartusa.com)



Website



## **CONTENTS**

TECHNICAL DATA .....	3
INTRODUCTION .....	4
SAFETY INFORMATION .....	4
GENERAL SAFETY RULES .....	5
SPECIFIC SAFETY RULES FOR DRYWALL SANDER .....	8
SYMBOLS .....	10
KNOWING YOUR DRYWALL SANDER .....	11
ASSEMBLY INSTRUCTION .....	12
OPERATING INSTRUCTION .....	14
MAINTENANCE .....	16
TROUBLE SHOOTING .....	17
EXPLODED VIEW & PARTS LIST .....	18
WARRANTY .....	21

## **TECHNICAL DATA**

Drywall Sander	Model # PS4001A
Motor:	120 V, 60 Hz, 7.2A
No load speed:	900-1800 rpm
Round sanding pad :	8-4/5 inch
Sandpaper Diameter:	8-4/5 inch
Hort-length (without extension tube):	41 inch
Long-length (with extension tube):	66.3 inch
Package dimensions (L x W x H):	27x11.3x9.8 inch
Weight:	15.4 lb.

## **INTRODUCTION**

Thank You for Purchasing a PowerSmart® Product. This manual provides information regarding the safe operation and maintenance of this product. Every effort has been made to ensure the accuracy of the information in this manual. PowerSmart® reserves the right to change this product and specifications at any time without prior notice.

Please keep this manual available to all users during the entire life of the power tool.



This manual contains special messages to bring attention to potential safety concerns, power tool damage as well as helpful operating and servicing information. Please read all the information carefully to avoid injury and machine damage.

## **QUESTIONS? PROBLEMS?**

Please contact our Customer Service Dept. with any questions and/or comments, either by Email: [support@amerisuninc.com](mailto:support@amerisuninc.com) / [support@powersmartusa.com](mailto:support@powersmartusa.com), or Toll Free at (800)791-9458 / (888)293-0024. We are available Mon-Fri 9am-5pm EST to help solve any issues that you might encounter.

## **SAFETY INFORMATION**

Before operating this power tool, read and observe all warnings, cautions, and instructions on the power tool and in this Owner's Manual.

NOTE: The following safety information is not meant to cover all possible conditions and situations that may occur. Read the entire Owner's Manual for safety and operating instructions. Failure to follow instructions and safety information could result in serious injury or death.

This safety alert symbol is used to identify safety information about hazards that can result in personal injury.



A signal word (DANGER, WARNING, or CAUTION) is used with the alert symbol to indicate the likelihood and the potential severity of injury. In addition, a hazard symbol may be used to represent the type of hazard.

**DANGER** Indicates a hazard, which, if not avoided, will result in death or serious injury.

**WARNING** Indicates a hazard, which, if not avoided, could result in death or serious injury.

**CAUTION** Indicates a hazard, which, if not avoided, might result in minor or moderate injury.

**CAUTION** Without the alert symbol, indicates a situation that could result in damage.

## **GENERAL SAFETY RULES**

Safety is a combination of common sense, staying alert, and knowing how your power tool works.  
**SAVE THESE SAFETY INSTRUCTIONS.**



**WARNING:** Do not operate this unit until you read this instruction manual for safety, operation and maintenance instructions. Failure to follow all instructions listed below may result in electric shock, fire, and/or serious personal injury.

### **Work Area Safety**

- Keep your work area clean and well lit. Cluttered benches and dark areas invite accidents.
- Do not operate power tools in explosive atmospheres, such as in the presence of flammable liquids, gases, or dust. Power tools create sparks which may ignite the dust or fumes.
- Keep bystanders, children, and visitors away while operating a power tool. Distractions can cause you to lose control.

### **Electrical Safety**

#### **Grounding instructions**

IN THE EVENT OF A MALFUNCTION OR BREAKDOWN, grounding provides the path of least resistance for electric current and reduces the risk of electric shock. This tool is equipped with an electric cord that has an equipment grounding conductor and a grounding plug. The plug **MUST** be plugged into a matching outlet that is properly installed and grounded in accordance with ALL local codes and ordinances.

**DO NOT MODIFY THE PLUG PROVIDED.** If it will not fit the outlet, have the proper outlet installed by a licensed electrician.

**IMPROPER CONNECTION** of the equipment grounding conductor can result in electric shock. The conductor with the green insulation (with or without yellow stripes) is the equipment grounding conductor. If repair or replacement of the electric cord or plug is necessary, **DO NOT** connect the equipment grounding conductor to a live terminal.

**CHECK** with licensed electrician or service personnel if you do not completely understand the grounding instructions, or if you are not sure if the tool is properly grounded.

**USE ONLY THREE-WIRE EXTENSION CORDS** that have 3-pronged plugs and outlets that accept the tool's plug as shown in Fig. A. Repair or replace a damaged or worn cord immediately.

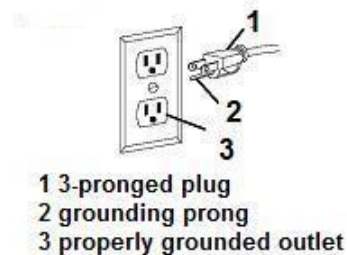

**CAUTION:** In all cases, make certain the outlet in question is properly grounded. If you are not sure if it is, have a licensed electrician check the outlet.



**WARNING:** Do not expose to rain or use in damp locations.

## Guidelines for using extension cords

Make sure your extension cord is in good condition. When using an extension cord, be sure to use one heavy enough to carry the current your product will draw. An undersized cord will cause a drop in line voltage resulting in loss of power and overheating. The table below shows the correct size to be used according to cord length and nameplate ampere rating. If in doubt, use the next heavier gauge. The smaller the gauge number, the heavier the cord.

### Minimum Gauge for Extension Cords (AWG)

(When using 120 V only)

Ampere Rating		Total Length of Cord in feet			
More Than	Not More Than	25	50	100	150
0	6	18	16	16	14
6	10	18	16	14	12
10	12	16	16	14	12
12	16	14	12	Not Recommended	

- Make sure your extension cord is properly wired and in good condition. Always replace a damaged extension cord or have it repaired by a qualified person before using it.
- Protect your extension cords from sharp objects, excessive heat and damp or wet areas.
- Use a separate electrical circuit for your tools. This circuit must not be less than a #12 wire and should be protected with a 15 A time-delayed fuse. Before connecting the motor to the power line, make sure the switch is in the OFF position and the electric current is rated the same as the current stamped on the motor nameplate. Running at a lower voltage will damage the motor.



**WARNING:** This tool must be grounded while in use to protect the operator from electric shock.

## Personal Safety

- This tool should not be used by people under the age of 16 years. Ensure that children do not play with the tool.
- This tool is not intended for use by persons (including children) with reduced physical, sensory or mental capabilities, or lack of experience and knowledge, unless they have been given supervision or instruction concerning use of the tool by a person responsible for their safety.
- Stay alert, watch what you are doing and use common sense when operating the tool. Do not use the tool while you are tired or under the influence of drugs, alcohol or medication. A moment of inattention while operating tools may result in serious personal injury.
- Dress properly. Do not wear loose clothing or jewelry. Contain long hair. Keep your hair, clothing, and gloves away from moving parts. Loose clothes, jewelry, or long hair can be caught in moving parts.
- Avoid accidental starting. Be sure switch is off before connecting to power source, pick up or carrying the tool. Carrying power tools with your finger on the switch or energizing power tools that have the switch on invites accidents.
- Do not overreach. Keep proper footing and balance at all times. Proper footing and balance enable better control of the power tool in unexpected situations.
- Wear personal protective equipment. Depending on application, use face shield, safety goggles or safety glasses. As appropriate, wear dust mask, hearing protectors, non-skid safety shoes, gloves and shop apron capable of stopping small abrasive or work piece fragments. The eye protection must be

capable of stopping flying debris generated by various operations. The dust mask or respirator must be capable of filtering particles generated by your operation. Prolonged exposure to high intensity noise may cause hearing loss.

- Only use safety equipment that has been approved by an appropriate standards agency. Unapproved safety equipment may not provide adequate protection. Eye protection must be ANSI-approved and breathing protection must be NIOSH-approved for the specific hazards in the work area.

## **Power Tool Use And Care**

- Do not use accessories which are not specifically designed and recommended by the tool manufacturer. Just because the accessory can be attached to your power tool, it does not assure safe operation.
- The arbour size of wheels, flanges, backing pads or any other accessory must properly fit the spindle of the power tool. Accessories with arbour holes that do not match the mounting hardware of the power tool will run out of balance, vibrate excessively and may cause loss of control.
- Do not force tool. Use the correct tool for your application. The correct tool will do the job better and safer at the rate for which it is designed.
- Disconnect the plug from the power source before making any adjustments, changing accessories, or storing the tool. Such preventive safety measures reduce the risk of starting the tool accidentally.
- Inspect guards before using a tool. Keep guards in place. Check moving parts for binding or any other condition that may affect the normal operation or safety features of the tool. If damaged, have tool serviced before using the tool. Many accidents are caused by poorly maintained tools.
- Do not alter or misuse tool. Any alteration or modification is a misuse and may result in serious personal injury.
- Maintain power tools. Check for misalignment or binding of moving parts, breakage of parts and any other condition that may affect the power tool's operation. If damaged, have the power tool repaired before use. Many accidents are caused by poorly maintained power tools.
- The use of any other accessories not specified in this manual may create a hazard. Accessories that may be suitable for one type of tool, may become hazardous when used on an inappropriate tool.
- Store idle power tools out of reach of children and other untrained persons. Power tools are dangerous in the hands of untrained users.
- Use the power tool, accessories and tool bits etc., in accordance with these instructions, taking into account the working conditions and the work to be performed. Use of the power tool for operations different from those intended could result in a hazardous situation.
- Save these instructions. Refer to them frequently and use them to instruct others who may use this tool. If you lend this tool to someone else, also lend them these instructions.

## **Service**

- Tool service must be performed only by qualified repair personnel. Service or maintenance performed by unqualified personnel could result in a risk of injury.
- When servicing a tool, use only identical replacement parts. Follow instructions in the maintenance section of this manual. Use of unauthorized parts or failure to follow maintenance instructions may create a risk of electric shock or injury.

## **SPECIFIC SAFETY RULES FOR DRYWALL SANDER**

- This tool is not suitable for wet sanding.
- Do not use a damaged accessory. Before each use inspect the accessory such as abrasive wheels for chips and cracks, backing pads for cracks, tear or excess wear, wire brushes for loose or cracked wires. If the power tool or accessory is dropped, inspect for damage or install an undamaged accessory. After inspecting and installing an accessory, position yourself and bystanders away from the plane of the rotating accessory and run the power tool at maximum no load speed for one minute. Damaged accessories will normally break apart during this test time.
- Never lay the power tool down until the accessory has come to a complete stop. The spinning accessory may grab the surface and pull the power tool out of your control.
- Do not run the power tool while carrying it at your side. Accidental contact with the spinning accessory could snag your clothing, pulling the accessory into your body.
- Regularly clean the power tool's air vents. The motor's fan will draw the dust inside the housing and excessive accumulation of powdered metal may cause electrical hazards.
- Do not operate with any guard disabled, damaged, or removed. Moving guards must move freely and close instantly.
- Maintain labels and nameplates on the tool. These carry important safety information.

### **Kickback And Related Warnings**

- Kickback is a sudden reaction to a pinched or snagged rotating wheel, backing pad, brush or any other accessory. Pinching or snagging causes rapid stalling of the rotating accessory which in turn causes the uncontrolled power tool to be forced in the direction opposite of the accessory's rotation at the point of the binding.
- For example, if an abrasive wheel is snagged or pinched by the workpiece, the edge of the wheel that is entering into the pinch point can dig into the surface of the material causing the wheel to climb out or kick out. The wheel may either jump toward or away from the operator, depending on the direction of the wheel's movement at the point of pinching. Abrasive wheels may also break under these conditions.

Kickback is the result of power tool misuse and/or incorrect operating procedures or conditions and can be avoided by taking proper precautions as given below:

- Maintain a firm grip on the power tool and position your body and arm to allow you to resist kickback forces. Always use auxiliary handle, if provided, for maximum control over kickback or torque reaction during start-up. The operator can control torque reactions or kickback forces, if proper precautions are taken.
- Never place your hand near the rotating accessory. The accessory may kickback over your hand.
- Do not position your body in the area where power tool will move if kickback occurs. Kickback will propel the tool in the direction opposite to the wheel's movement at the point of snagging.
- Use special care when working corners, sharp edges etc. Avoid bouncing and naggling the accessory. Corners, sharp edges or bouncing have a tendency to snag the rotating accessory and cause loss of control or kickback.



**WARNING:** Some dust created by power sanding, sawing, grinding, drilling, and other construction activities contains chemicals known to the state of California to cause cancer, birth defects or other reproductive harm. Some examples of these chemicals are:

- Lead from lead-based paints, crystalline silica from bricks and cement and other masonry products, and
- arsenic and chromium from chemically-treated lumber.

- Your risk from these exposures varies, depending on how often you do this type of work. To reduce your exposure to these chemicals: work in a well ventilated area, and work with approved safety equipment, such as those dust masks that are specially designed to filter out microscopic particles.
- Avoid prolonged contact with dust from power sanding, sawing, grinding, drilling, and other construction activities. Wear protective clothing and wash exposed areas with soap and water. Allowing dust to get into your mouth, eyes, or lay on the skin may promote absorption of harmful chemicals.



**WARNING:** Use of this tool can generate and/or disperse dust, which may cause serious and permanent respiratory or other injury. Always use NIOSH/OSHA approved respiratory protection appropriate for the dust exposure. Direct particles away from face and body.



**WARNING:** Do not operate this tool for long periods of time. Vibration caused by the operating action of this tool may cause permanent injury to fingers, hands, and arms. Use gloves to provide extra cushion, take frequent rest periods, and limit daily time of use.















## Vibration Safety

This tool vibrates during use. Repeated or long-term exposure to vibration may cause temporary or permanent physical injury, particularly to the hands, arms and shoulders. To reduce the risk of vibration-related injury:

- Anyone using vibrating tools regularly or for an extended period should first be examined by a doctor and then have regular medical check-ups to ensure medical problems are not being caused or worsened from use. Pregnant women or people who have impaired blood circulation to the hand, past hand injuries, nervous system disorders, diabetes, or Raynaud's Disease should not use this tool. If you feel any medical or physical symptoms related to vibration (such as tingling, numbness, and white or blue fingers), seek medical advice as soon as possible.
- Do not smoke during use. Nicotine reduces the blood supply to the hands and fingers, increasing the risk of vibration-related injury.
- Use tools with the lowest vibration when there is a choice between different processes.
- Include vibration-free periods each day of work.
- Grip work-piece as lightly as possible (while still keeping safe control of it). Let the tool do the work.
- To reduce vibration, maintain the tool as explained in this manual. If any abnormal vibration occurs, stop use immediately.

## **SYMBOLS**

Some of the following symbols may be used on this product. Please study them and learn their meaning. Proper interpretation of these symbols will allow you to operate the product better and safer.

<b>SYMBOL</b>	<b>NAME</b>	<b>DESIGNATION/EXPLANATION</b>
V	Volts	Alternating voltage
Hz	Hertz	Frequency (cycles per second)
W	Watts	Power
RPM	Per minute	Revolutions per minute
dB(A)	Decibel(A-rated)	Decibel(A-rated)
mm	Millimetre	Size
	Safety Alert	Precautions that involve your safety.
	Lock	To tighten or secure
	Unlock	To loosen
	Read the user's manual	To reduce the risk of injury, user must read and understand user's manual before using this product.
	Beware of the fragments of the work piece	Keep bystanders a safe distance away from work area. Fragments of the work piece or of a broken accessory may fly away.
	Eye protection	Wear eye protection when operating this equipment.
	Hearing protection	Use proper hearing protection when operating this equipment.
	Respiratory protection	Use proper respiratory protection when operating this equipment.
	Protective gloves	Wear protective gloves when operating this equipment.
	Protective , slip-resistant footwear	Wear protective , slip-resistant footwear when operating this equipment.
	Switch the product off	Switch the product off and disconnect it from power supply before assembly, cleaning, adjustments, maintenance, storage and transportation.
	Wet conditions alert	Do not expose to rain or use in damp locations.
	Electric shock alert	Beware of electric shock hazard.
	Protection class II	This products is of protection class II. That means it is equipped with enhanced or double insulation.

## KNOWING YOUR DRYWALL SANDER

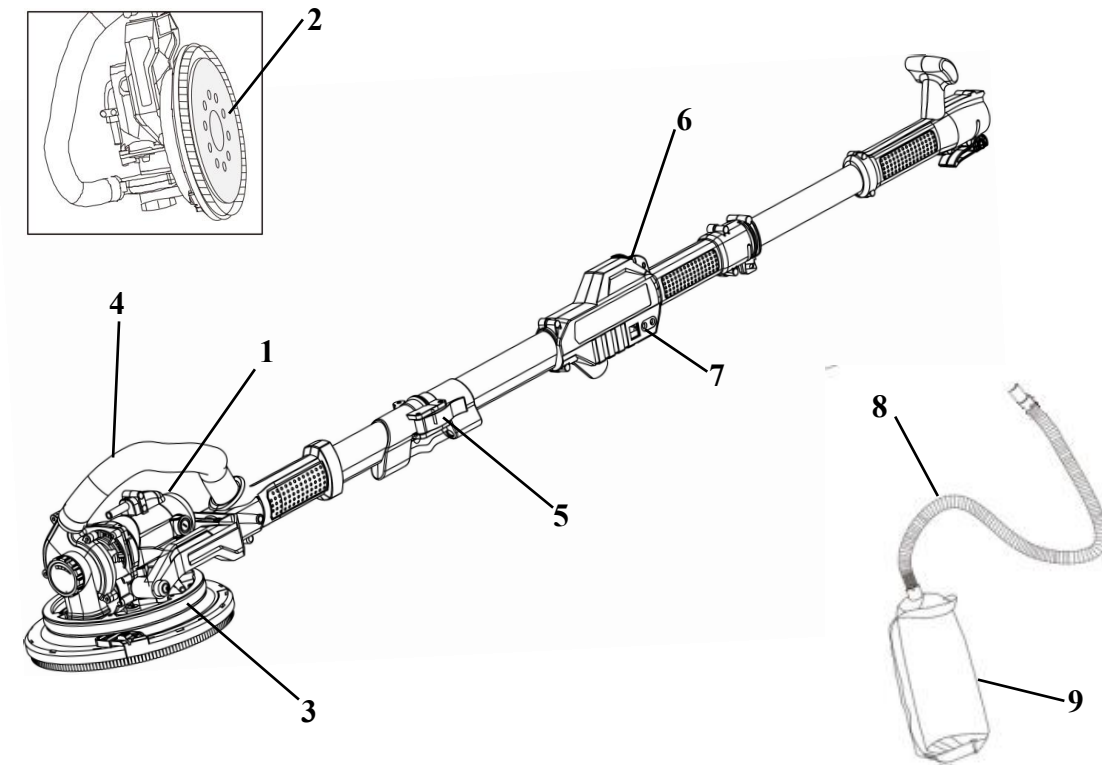

- |   |                   |   |               |
|---|-------------------|---|---------------|
| 1 | Motor             | 6 | On/off switch |
| 2 | Round sanding pad | 7 | Speed switch  |
| 3 | LED light         | 8 | Vacuum hose   |
| 4 | Dust guide pipe   | 9 | Dust bag      |
| 5 | Foldable part     |   |               |

### Unpacking

Unpack the power tool and all its parts, and compare against the list below. Do not discard the carton or any packaging materials. Please call 1-800-791-9458/1-888-293-0024 or E-mail us at [support@amerisuninc.com](mailto:support@amerisuninc.com) / [support@powersmartusa.com](mailto:support@powersmartusa.com) if any parts are damaged or missing.

**Including: Drywall Sander / Sanding Paper Each 1pc(80#,100#,120#,150#,180#,240#) / Dust Bag With Vacuum Hose / Hex Wrench s5 / Carbon Brush / Drive Screw / Glasses / User Manual**

## **ASSEMBLY INSTRUCTION**



**WARNING:** Do not use this product if any parts on the packing list are already assembled to your product when you unpack it. Parts on this list are not assembled to the product by the manufacturer and require customer installation. Use of a product that may have been improperly assembled could result in serious personal injury.



**WARNING:** If any parts are damaged or missing do not operate this product until the parts are replaced. Use of this product with damaged or missing parts could result in serious personal injury.



**WARNING:** Do not connect to power supply until assembly is complete. Failure to comply could result in accidental starting and possible serious personal injury. Do not attempt to modify this product or create accessories not recommended for use with this product. Any such alteration or modification is misuse and could result in a hazardous condition leading to possible serious personal injury.

### **Shaft Assembly**

1. Lay the sander on a flat surface, fold the front and back part together.
2. Push the folding lock to the right position and lock the lock wrench. Unfold the handle by pushing the lock wrench to the inside.

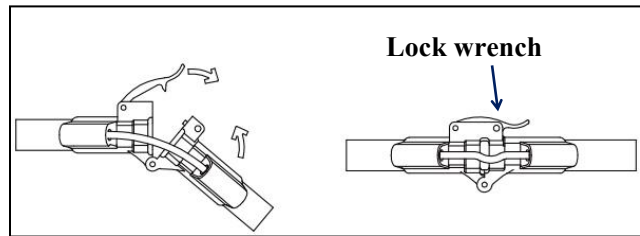

### **Extension Shaft Assembly**

Use the extension shaft according to the intended operation for higher work surface. Insert the adjustable extension tube with the shape fitted, then push in to adjust to the desired length and lock it by lock wrench.

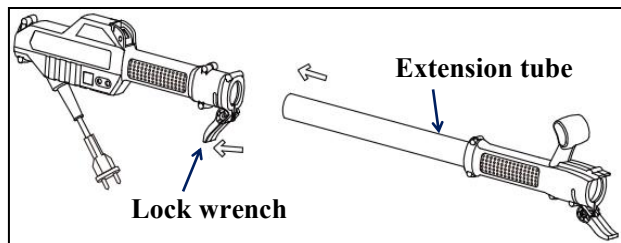

### **Handle Length Adjustment**

For the convenience of sanding walls of different heights tube length of this type of drywall sander can be adjusted.

Adjusting procedures of the Drywall Sander:  
Loose the lock wrench and pull out or push in the extension tube handle to adjust the length to a proper position then tighten the lock wrench.

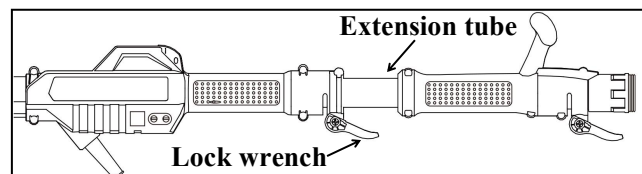

**Note:** We can only push the extension tube as far to 1.7m as the tube marked, or the dust may get out from the pipe connection.

## Attaching And Changing Sanding Disc

1. Place the sanding paper in the center of the sanding pad and press on. The holes in the sanding paper must be in alignment with the extraction holes in the sanding pad.
2. For round sanding pad only conduct a test run to check that the sanding paper is clamped in the centre.

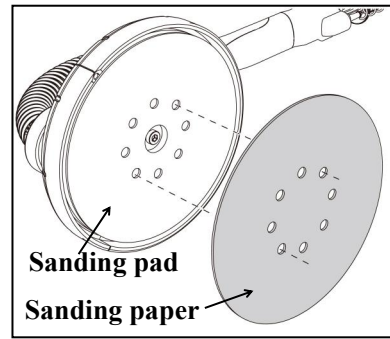

**WARNING:** Only install the specified sanding pad on the machine. In order to ensure optimal performance, the machine should be run at slightly lower speed for several minutes to make the grinding pad fit the sealing surface perfectly. During this process, the white foam particles will come out from the sanding head. However, this won't damage the machine.

## Replace Sanding Pad

1. Insert the hex wrench into the hexagonal screw bolt on the sanding block.
2. Hold the sanding pad firmly, and then turn the sanding pad clockwise to dismount the pad.
3. Install new sanding pad by mounting the pad anticlockwise.

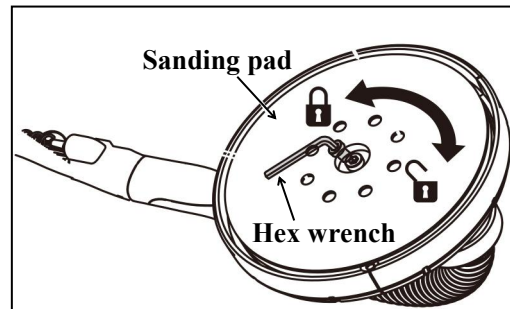

## Connecting The Dust Bag

1. Connect the suction hose to dust collection bag with a click lock.
  2. Insert the suction hose into the extension rod and lock it with the lock wrench.
- When connecting the vacuum bag and the vacuum pipe, a gasket needs to be added in the middle to prevent dust leakage.

**Note:** The vacuum hose can be stretched to 4 meters.

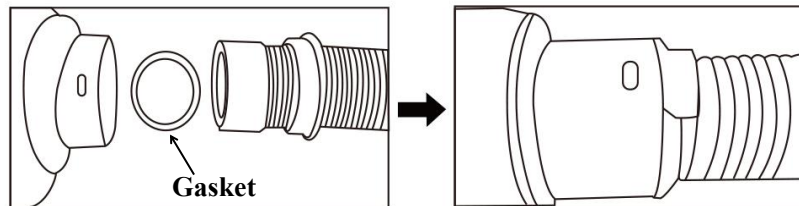

# **OPERATING INSTRUCTION**



**WARNING:** This tool is for indoor use only. DO NOT expose to rain or use in damp locations.

## **Switch On And Off The Machine**

- Turn on/off the drywall sander by the On/Off switch.
- Adjust the speed by turning the speed switch, we can adjust different speed for different sanding surface(6 steps).
- Constant speed control. Keep the machine running at the same speed as selected.
- Do not overload by excessive pressure.

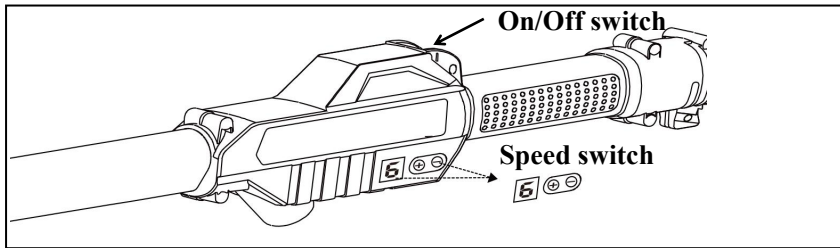

## **Switch On /Off The LED light**

Turn on/off the LED light with the lamp button.

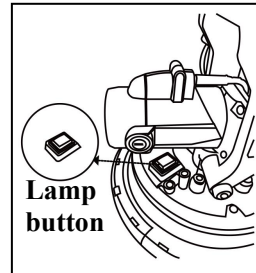

## **Airflow Control**

Control the airflow by adjusting the suction switch (There are 6 steps to adjust the suction speed) .

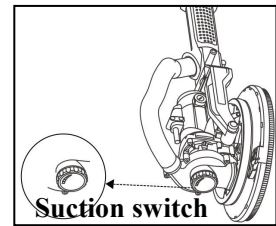

## **Sanding Operations**

1. Once the machine is set up and all safety measures and equipment are in place. Connect the plug into main supply.
2. Switch on the machine by ON/OFF switch.
3. Hold the product by both hands to do your job. Begin sanding and carefully contact the work surface as lightly as possible-just enough to keep the sanding head flat against the surface. Do not over-push on the surface.

**NOTE:** Ensure that the sanding disc you are using is suited to the task. Overly coarse grit paper may remove material too quickly to control. While overly fine grit paper may clog too often and not shape down the surface. Take care to avoid sharp projections and nails, etc. This will wipe out the sandpaper and probably damage the sponge pad as well.

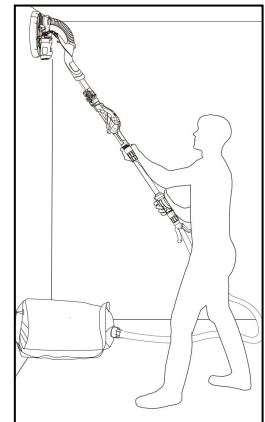

## Sanding Ceiling

When grinding the top floor, pull the spring and lock it onto the protruding bolt as shown.

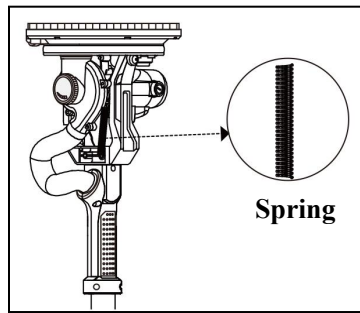

The sander brush should be close to the wall or ceiling to prevent dust from falling.

As shown in the below picture when sanding the ceiling it should not be perpendicular to the ceiling. It needs to be angled so that the handle can move the sander and prevent dust from falling out.

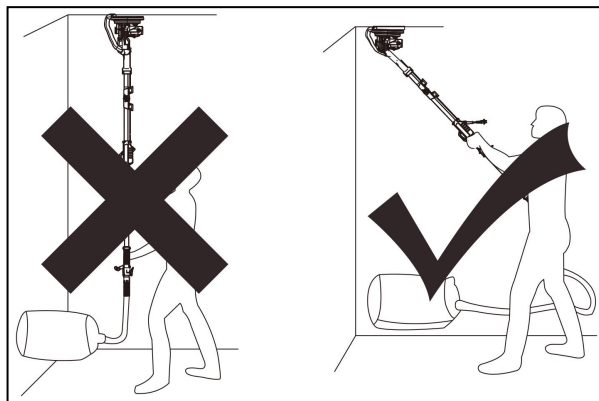

## Dust Collection Bag Clip Installation

When the dust bag is full of dust, we can slip the clip out and dump the dust. Then install the bag clip back.

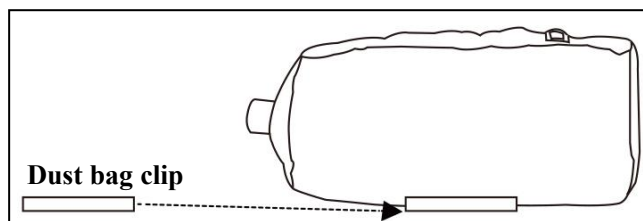

## **MAINTENANCE**



**WARNING:** Always turn the switch OFF, and unplug the power cord from the outlet before maintaining the drywall sander.



**WARNING:** When servicing, use only identical replacement parts. Use of any other parts could create a hazard or cause product damage.

### **Cleaning**

Some cleaning work shall be performed regularly or after sanding operation onto the drywall sander.

1. Cleaning the tool regularly will prolong the service life of the tool and reduce repair rate. Do not use water to clean the connection structures and the electrical motor.
2. We suggest that immediate cleaning should be done to the tool after every use.
3. Use a hairbrush or dry cloth to clean it or to purge it with high-pressure air.

### **Replacement Of Carbon Brush**

There is one pair of spare carbon brushes with the tool. When the old carbon brushes are worn out, the backup ones can be used to replace them. Operate like this:

1. Screw off anti-clockwise the carbon brush cover with a straight screw driver
2. Remove the worn-out brushes and install the new ones into the carbon brush holder
3. Make sure that the brushes can move freely in the holder.

### **Storage**

- Store the tool in its protective case in a clean and dry location, out of reach of children.
- Always keep tool and cord clean (especially ventilation slots ).
- Do not dispose of electric tools, accessories and packaging together with household waste material (only for EU countries)

## **TROUBLE SHOOTING**



**WARNING:** Read instruction manual first! Remove plug from the power source before trouble shooting.

<b>Problem</b>	<b>Possible Cause</b>	<b>Possible Solution</b>
Motor is not working	<ol style="list-style-type: none"><li>1. Wires in the main plug or in the socket are loose.</li><li>2. The switch is faulty.</li></ol>	<ol style="list-style-type: none"><li>1. Have the socket and plug checked by an authorized technician.</li><li>2. Have the switch replaced by an authorized technician.</li></ol>
Unusual noises occur during operation. Motor is not working properly.	<ol style="list-style-type: none"><li>1. Switch contact has failed.</li><li>2. Components have jammed.</li><li>3. Too high of load has been applied.</li><li>4. Too much dust in the tube even motor.</li></ol>	<ol style="list-style-type: none"><li>1. Have the switch replaced by an authorized technician.</li><li>2. Have the tool checked and repaired.</li><li>3. Use less pressure during sanding operations.</li><li>4. Clean with vacumm cleaner.</li></ol>
Suddenly stop of motor	<ol style="list-style-type: none"><li>1. Motor is too high and thermal protector is action.</li><li>2. Foreign substances have gotten inside the motor.</li><li>3. Too high of load has been applied.</li></ol>	<ol style="list-style-type: none"><li>1. Waiting for a moment and let the motor cool.</li><li>2. Have the foreign substances removed.</li><li>3. Use less pressure during sanding operations.</li></ol>
Strong sparks occur	Carbon brush worn.	Replace carbon brush.

**EXPLODED VIEW & PARTS LIST**

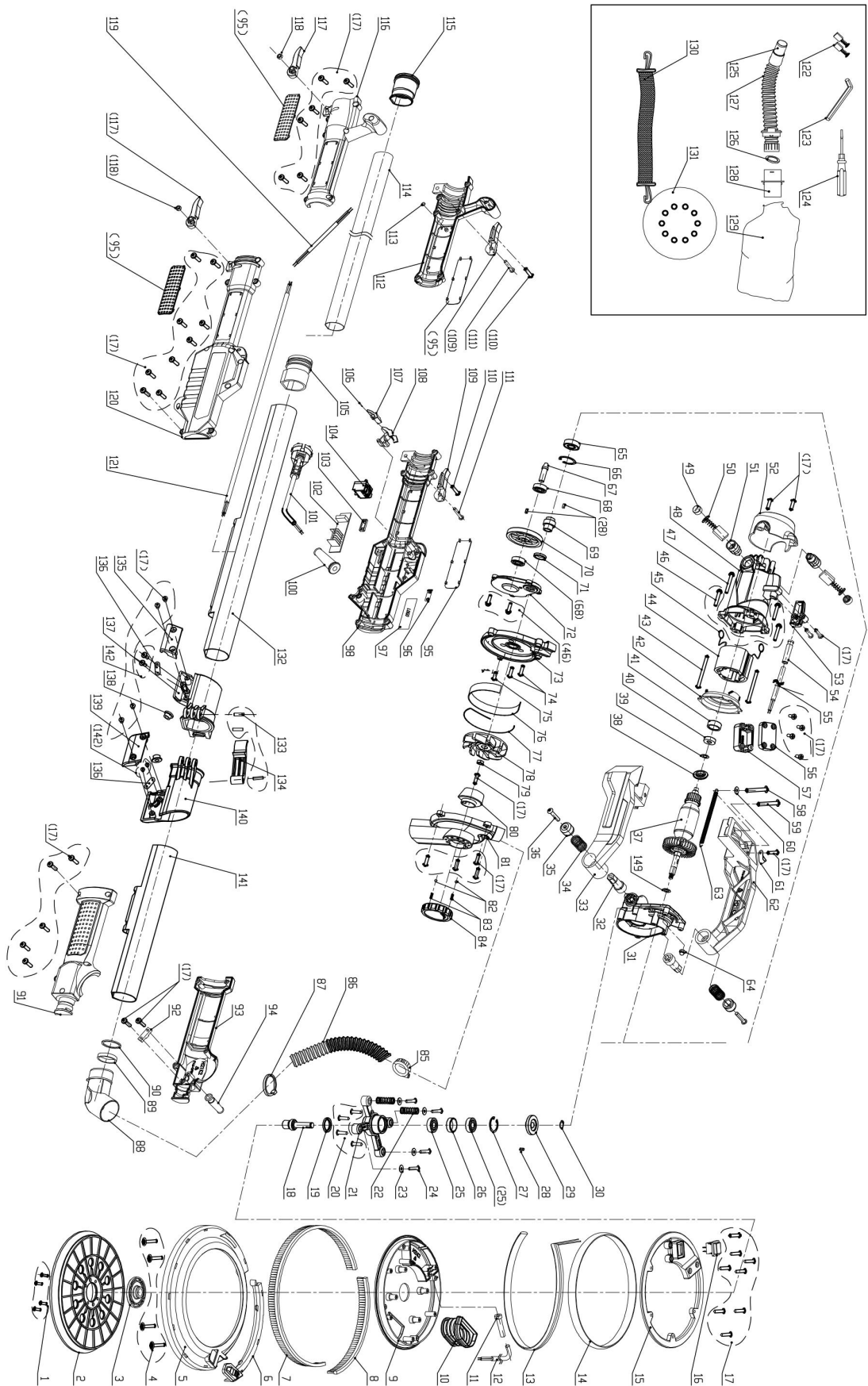

Item	Stock#	Description	Qty.
1	PS4001A-001	Screw M4×8	4
2	PS4001A-002	Sanding pad	1
3	PS4001A-003	connecting base	1
4	PS4001A-004	Screw ST4X15	4
5	PS4001A-005	disc wheel	1
6	PS4001A-006	Side round	1
7	PS4001A-007	Long brush	1
8	PS4001A-008	Short brush	1
9	PS4001A-009	stator	1
10	PS4001A-010	silicone hose	1
11	PS4001A-011	Sleeve	1
12	PS4001A-012	Cover line	1
13	PS4001A-013	Led light strip	1
14	PS4001A-014	transparent cover	1
15	PS4001A-015	LED fixed cover	1
16	PS4001A-016	Small switch	1
17	PS4001A-017	Screw ST4X14	51
18	PS4001A-018	Output shaft	1
19	PS4001A-019	Oil seal	1
20	PS4001A-020	Screw M4×16	4
21	PS4001A-021	front cover	1
22	PS4001A-022	Spring	2
23	PS4001A-023	flat gasket	4
24	PS4001A-024	Screw ST4X18	4
25	PS4001A-025	bearing 609RS	2
26	PS4001A-026	sleeve	1
27	PS4001A-027	Spring ø24	1
28	PS4001A-028	flat key	3
29	PS4001A-029	Big gear	1
30	PS4001A-030	Spring ø9	1
31	PS4001A-031	Gear box	1
32	PS4001A-032	Sleeve	2
33	PS4001A-033	Right Supporter	1
34	PS4001A-034	Spring ø17.2	2
35	PS4001A-035	Lock hat	2

Item	Stock#	Description	Qty.
36	PS4001A-035	Screw M5×45	2
37	PS4001A-036	Rotor	1
38	PS4001A-037	Dust-proof plate	1
39	PS4001A-038	stainless mat	1
40	PS4001A-039	Bearing 607RS	1
41	PS4001A-040	Bearing sleeve	1
42	PS4001A-041	Windshield	1
43	PS4001A-042	Screw ST4×55	2
44	PS4001A-043	Stator	1
45	PS4001A-044	Spring	2
46	PS4001A-045	Screw M4X20	5
47	PS4001A-046	Screw M4X30	1
48	PS4001A-047	Housing	1
49	PS4001A-048	Brush cap	2
50	PS4001A-049	Carbon Brush	2
51	PS4001A-050	Brush holder	2
52	PS4001A-051	Rear cover	1
53	PS4001A-052	Housing cover	1
54	PS4001A-053	Sleeve	1
55	PS4001A-054	Connecting line	1
56	PS4001A-055	terminal box lid	1
57	PS4001A-056	connecting box	1
58	PS4001A-057	Screw ST5X45	1
59	PS4001A-058	Screw ST5X40	1
60	PS4001A-059	gasket	1
61	PS4001A-060	Line buckle	1
62	PS4001A-061	Left brace	1
63	PS4001A-062	Tension spring	1
64	PS4001A-063	M4 Nut	1
65	PS4001A-064	Bearing 6000RS	1
66	PS4001A-065	Spring ø26	1
67	PS4001A-066	Axis teeth	1
68	PS4001A-067	Bearing 608RS	2
69	PS4001A-068	Small gear	1
70	PS4001A-069	Big gear	1

Item	Stock#	Description	Qty.
71	PS4001A-071	Oil seal	1
72	PS4001A-072	Gear box cover	1
73	PS4001A-073	Under plate	1
74	PS4001A-074	Screw M4×20	2
75	PS4001A-075	Screw M4×12	1
76	PS4001A-076	Wind disk file	1
77	PS4001A-077	Seal tape	1
78	PS4001A-078	Dust leaf components	1
79	PS4001A-079	M6 Screw nut	1
80	PS4001A-080	Wind speed knob	1
81	PS4001A-081	upper hand plate	1
82	PS4001A-082	steel ball	2
83	PS4001A-083	Spring	2
84	PS4001A-084	knob	1
85	PS4001A-085	Throat card	1
86	PS4001A-086	Dust hose	1
87	PS4001A-087	Rubber band	1
88	PS4001A-088	Aluminium pipe connector	1
89	PS4001A-089	Rectangular ring	1
90	PS4001A-090	O ring	1
91	PS4001A-091	Right handle	1
92	PS4001A-092	Cable plate	1
93	PS4001A-093	Left handle	1
94	PS4001A-094	Small cable sleeve	1
95	PS4001A-095	pinch plate	4
96	PS4001A-096	Button label	1
97	PS4001A-097	block	1
98	PS4001A-098	Handle cover	1
100	PS4001A-100	Cable sleeve	1
101	PS4001A-101	Cable	1
102	PS4001A-102	Switch pushing lever	1
103	PS4001A-103	Switch mat	1
104	PS4001A-104	Switch	1
105	PS4001A-105	Rubber sleeve	1
106	PS4001A-106	Round pin	1

Item	Stock#	Description	Qty.
107	PS4001A-107	Unlock button	1
108	PS4001A-108	Switch button	1
109	PS4001A-109	Tightening ring	2
110	PS4001A-110	Screw ST4×18	2
111	PS4001A-111	Screw M5X30	2
112	PS4001A-112	Left back handle	1
113	PS4001A-113	O ring	1
114	PS4001A-114	Aluminium pipe	1
115	PS4001A-115	Rear rubber sleeve	1
116	PS4001A-116	Right back handle	1
117	PS4001A-117	Tightening ring	2
118	PS4001A-118	Nut M5	2
120	PS4001A-120	Right cover	1
122	PS4001A-122	Carbon Brush	2
123	PS4001A-123	Wrench S5	1
124	PS4001A-124	wrench	1
125	PS4001A-125	Connector	1
126	PS4001A-126	Sealing mat	1
127	PS4001A-127	Dust tube	1
128	PS4001A-128	connector	1
129	PS4001A-129	Dust bag	1
130	PS4001A-130	Shoulder Strap	1
131	PS4001A-131	Sanding paper	1
132	PS4001A-132	Aluminium pipe	1
133	PS4001A-133	Round pin	3
134	PS4001A-134	wrench	1
135	PS4001A-135	Lower joint cover	1
136	PS4001A-136	Pressure wire plate (iron)	2
137	PS4001A-137	lower contact	1
138	PS4001A-138	Rubber sleeve	2
139	PS4001A-139	Upper joint cover	1
140	PS4001A-140	upper contact	1
141	PS4001A-141	Aluminium pipe	1
142	PS4001A-142	Screw ST4×10	4

## **TWO (2) YEARS LIMITED WARRANTY**

PowerSmart® is committed to building tools that are dependable for years. Our warranties are consistent with our commitment and dedication to quality.

### **TWO (2) YEARS LIMITED WARRANTY OF POWERSMART PRODUCTS FOR HOME USE.**

PowerSmart ("Seller") warrants to the original purchaser only, that all PowerSmart consumer power tools will be free from defects in material or workmanship for a period of two (2) years from date of purchase. Ninety (90) days for all PowerSmart Products, if the tool is used for professional or commercial use.

SELLER'S SOLE OBLIGATION AND YOUR EXCLUSIVE REMEDY under this Two (2) Years Limited Warranty and, to the extent permitted by law, any warranty or condition implied by law, shall be the repair or replacement of parts, without charge, which are defective in material or workmanship and which have not been misused, carelessly handled, or misrepaired by persons other than Seller or Authorized Service Center. To make a claim under this Limited Warranty, you must return the entire power tool product; transportation prepaid, to PowerSmart Include a legible copy of the original receipt, which lists the date of purchase (month and year) and the name of the company purchased from.

THIS LIMITED WARRANTY DOES NOT APPLY TO ANY ACCESSORY ITEMS INCLUDED WITH THE TOOL SUCH AS CIRCULAR SAW BLADES OTHER RELATED ITEMS OR TO ANY REPLACEMENT PARTS LISTED UNDER MAINTENANCE.

ANY IMPLIED WARRANTIES SHALL BE LIMITED IN DURATION TO TWO (2) YEARS FROM DATE OF PURCHASE. SOME STATES IN THE U.S. AND SOME CANADIAN PROVINCES DO NOT ALLOW LIMITATIONS ON HOW LONG AN IMPLIED WARRANTY LASTS, SO THE ABOVE LIMITATION MAY NOT APPLY TO YOU.

IN NO EVENT SHALL SELLER BE LIABLE FOR ANY INCIDENTAL OR CONSEQUENTIAL DAMAGES (INCLUDING BUT NOT LIMITED TO LIABILITY FOR LOSS OF PROFITS) ARISING FROM THE SALE OR USE OF THIS PRODUCT. SOME STATES IN THE U.S. AND SOME CANADIAN PROVINCES DO NOT ALLOW THE EXCLUSION OR LIMITATION OF INCIDENTAL OR CONSEQUENTIAL DAMAGES, SO THE ABOVE LIMITATION OR EXCLUSION MAY NOT APPLY TO YOU.

THIS LIMITED WARRANTY GIVES YOU SPECIFIC LEGAL RIGHTS, AND YOU MAY ALSO HAVE OTHER RIGHTS WHICH VARY FROM STATE TO STATE IN THE U.S., PROVINCE TO PROVINCE IN CANADA AND FROM COUNTRY TO COUNTRY.

For questions / comments, technical assistance or repair parts –  
Please call toll free at: 1-800-791-9458/1-888-293-0024 (M-F 9am – 5pm EST)  
Email: [support@amerisuninc.com](mailto:support@amerisuninc.com) / [support@powersmartusa.com](mailto:support@powersmartusa.com)

**SAVE YOUR RECEIPTS. THIS WARRANTY IS VOID WITHOUT THEM.**